

FORM B - BUILDING

MASSACHUSETTS HISTORICAL COMMISSION  
Office of the Secretary, State House, Boston

In Area no.	Form no.
	473

2. Photo (3x3" or 3x5")  
Staple to left side of form  
Photo number \_\_\_\_\_

4. Map. Draw sketch of building location  
in relation to nearest cross streets and  
other buildings. Indicate north.

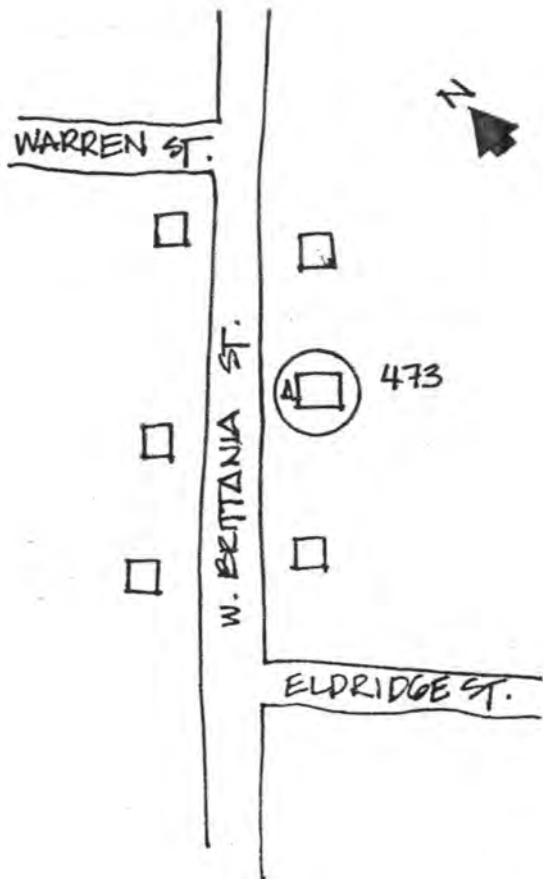

1. Town Taunton ✓  
Address West Erittania Street ✓  
Name Leonard School ✓  
Present use School

Present owner City of Taunton

3. Description:

Date 1888

Source School Reports

Style Elements of Late Italianate

Architect Gustavus L. Smith

Exterior wall fabric Brick

Outbuildings (describe) None

Other features Central pavilion, segmental arched window openings; hipped roof; corbeled cornice.

Altered Wings added Date 1911

Moved No Date \_\_\_\_\_

5. Lot size: WARD 8 <sup>PLAN-</sup> BK-36 LOT-22

One acre or less x Over one acre \_\_\_\_\_

Approximate frontage 123'

Approximate distance of building from street 50'

6. Recorded by C.C./T.W.

Organization T.C.H.S.

Date 3/80

(over)

UTM: 19/325115/4642560

7. Original owner (if known) City of Taunton

Original use School

Subsequent uses (if any) and dates N/A

8. Themes (check as many as applicable)

Aboriginal	<input type="checkbox"/>	Conservation	<input type="checkbox"/>	Recreation	<input type="checkbox"/>
Agricultural	<input type="checkbox"/>	Education	<input checked="" type="checkbox"/>	Religion	<input type="checkbox"/>
Architectural	<input checked="" type="checkbox"/>	Exploration/ settlement	<input type="checkbox"/>	Science/ invention	<input type="checkbox"/>
The Arts	<input type="checkbox"/>	Industry	<input type="checkbox"/>	Social/ humanitarian	<input type="checkbox"/>
Commerce	<input type="checkbox"/>	Military	<input type="checkbox"/>	Transportation	<input type="checkbox"/>
Communication	<input type="checkbox"/>	Political	<input type="checkbox"/>		
Community development	<input checked="" type="checkbox"/>				

9. Historical significance (include explanation of themes checked above)

The Leonard School is one of several local schools designed by architect Gustavus L. Smith. It was among many public buildings -- firestations, schools, post offices and city hall-- financed by the City during the 1880's and '90's that were designed or built by Gustavus Smith and built by L.M. Wetherell or Franklin D. Williams. The school was built to relieve overcrowded conditions in other Whittenton area schools stemming from the increased immigrant population attracted by jobs in the Reed and Barton Co. and Whittenton Mills.

The Leonard School is named, not for one individual, but for the entire Leonard Family, for their pioneering work in the iron industry and continued contributions to Taunton's development.

Description: The rectangular structure features a double projecting front pavilion, terminating in a truncated tower, and gabled wall dormer. Of 2 story height, it has a partially exposed basement level and a hipped roof, lit by dormers. A small, enclosed entrance porch fronts the building. Windows range from segmental arched 6/6 to grouped, elongated 4/4 windows (central bay), to a large, multi-paned semi-circular window in the gable.

The Leonard School possesses integrity of location, design, setting, materials, workmanship and association. It meets criteria A and C of the National Register of Historic Places as a distinguished local

10. Bibliography and/or references (such as local histories, deeds, assessor's records, early maps, etc.)

Municipal Records  
Charles Crowley, Notes.

INVENTORY FORM CONTINUATION SHEET

MASSACHUSETTS HISTORICAL COMMISSION  
Office of the Secretary, Boston

Community: Taunton	Form No: 473
Property Name: Leonard School	

Indicate each item on inventory form which is being continued below.

9. Historical Significance (cont.)

example of Late Italianate architecture and one of three masonry schools (see #141 and #259) designed by an area architect, constructed in response to the expansion of the industrial Whittenton area in the late 19th century.

*Boundaries conform to current lot lines.*

Staple to Inventory form at bottom

United States Department of the Interior  
National Park Service

National Register of Historic Places  
Inventory—Nomination Form

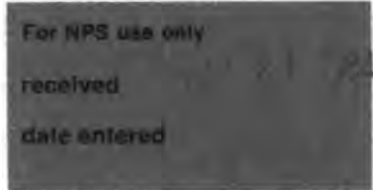

Continuation sheet

Item number

Page 5 of 9

Multiple Resource Area  
Thematic Group

Name Taunton Multiple Resource Area  
State Bristol County, MASSACHUSETTS

Nomination/Type of Review

Date/Signature

41. Leonard, James, House

Entered in the  
National Register

for Keeper

Delores Byers 7/5/84

Attest

42. Leonard School

Entered in the  
National Register

for Keeper

Delores Byers 7/5/84

Attest

43. Lincoln, Ambrose Jr., House

Entered in the  
National Register

for Keeper

Delores Byers 7/5/84

Attest

44. Lincoln, Asa, House

Entered in the  
National Register

for Keeper

Delores Byers 7/5/84

Attest

45. Lincoln, Gen. Thomas,  
House

Entered in the  
National Register

for Keeper

Delores Byers 7/5/84

Attest

46. Lord-Baylies-Bennett House

Entered in the  
National Register

for Keeper

Delores Byers 7/5/84

Attest

47. Lothrop, H. B., Store

Entered in the  
National Register

for Keeper

Delores Byers 7/5/84

Attest

48. Lothrop Memorial Building-  
G.A.R. Hall

Entered in the  
National Register

for Keeper

Delores Byers 7/5/84

Attest

49. Macomber, Calvin T., House

Entered in the  
National Register

for Keeper

Delores Byers 7/5/84

Attest

50. Marvel, Theodore L., House

Entered in the  
National Register

for Keeper

Delores Byers 7/5/84

Attest

NATIONAL REGISTER OF HISTORIC PLACES  
EVALUATION/RETURN SHEET

Leonard School (Taunton MRA)  
Bristol County  
MASSACHUSETTS

Working No. MAY 21 1984  
Fed. Reg. Date: 2.5.85  
Date Due: 6/21/84 - 7/5/84  
Action:  ACCEPT 7-5-84  
 RETURN  
 REJECT  
Federal Agency: \_\_\_\_\_

Entered in the  
National Register

- resubmission
- nomination by person or local government
- owner objection
- appeal

Substantive Review:  sample  request  appeal  NR decision

Reviewer's comments:

Recom./Criteria \_\_\_\_\_  
Reviewer \_\_\_\_\_  
Discipline \_\_\_\_\_  
Date \_\_\_\_\_  
\_\_\_\_\_ see continuation sheet

Nomination returned for: \_\_\_\_\_ technical corrections cited below  
\_\_\_\_\_ substantive reasons discussed below

1. Name

2. Location

3. Classification

Category	Ownership Public Acquisition	Status Accessible	Present Use

4. Owner of Property

5. Location of Legal Description

6. Representation in Existing Surveys

Has this property been determined eligible?  yes  no

7. Description

Condition	Check one	Check one
<input type="checkbox"/> excellent	<input type="checkbox"/> unaltered	<input type="checkbox"/> original site
<input type="checkbox"/> good	<input type="checkbox"/> altered	<input type="checkbox"/> moved date _____
<input type="checkbox"/> fair	<input type="checkbox"/> deteriorated	
	<input type="checkbox"/> ruins	
	<input type="checkbox"/> unexposed	

Describe the present and original (if known) physical appearance

- summary paragraph
- completeness
- clarity
- alterations/integrity
- dates
- boundary selection

---

**8. Significance**

Period \_\_\_\_\_ Areas of Significance—Check and justify below

Specific dates \_\_\_\_\_ Builder/Architect \_\_\_\_\_  
Statement of Significance (*in one paragraph*)

- summary paragraph
- completeness
- clarity
- applicable criteria
- justification of areas checked
- relating significance to the resource
- context
- relationship of integrity to significance
- justification of exception
- other

---

**9. Major Bibliographical References**

---

**10. Geographical Data**

Acres of nominated property \_\_\_\_\_  
Quadrangle name \_\_\_\_\_  
UTM References \_\_\_\_\_

Verbal boundary description and justification \_\_\_\_\_

---

**11. Form Prepared By**

---

**12. State Historic Preservation Officer Certification**

The evaluated significance of this property within the state is:

\_\_\_\_ national    \_\_\_\_ state    \_\_\_\_ local

State Historic Preservation Officer signature

title \_\_\_\_\_ date \_\_\_\_\_

---

**13. Other**

- Maps
- Photographs
- Other

Questions concerning this nomination may be directed to \_\_\_\_\_

Signed \_\_\_\_\_ Date \_\_\_\_\_ Phone: \_\_\_\_\_



#473

Leonard School  
Taunton MRA, Ma

MAY 1980



by Berkey

W

T B R J T A

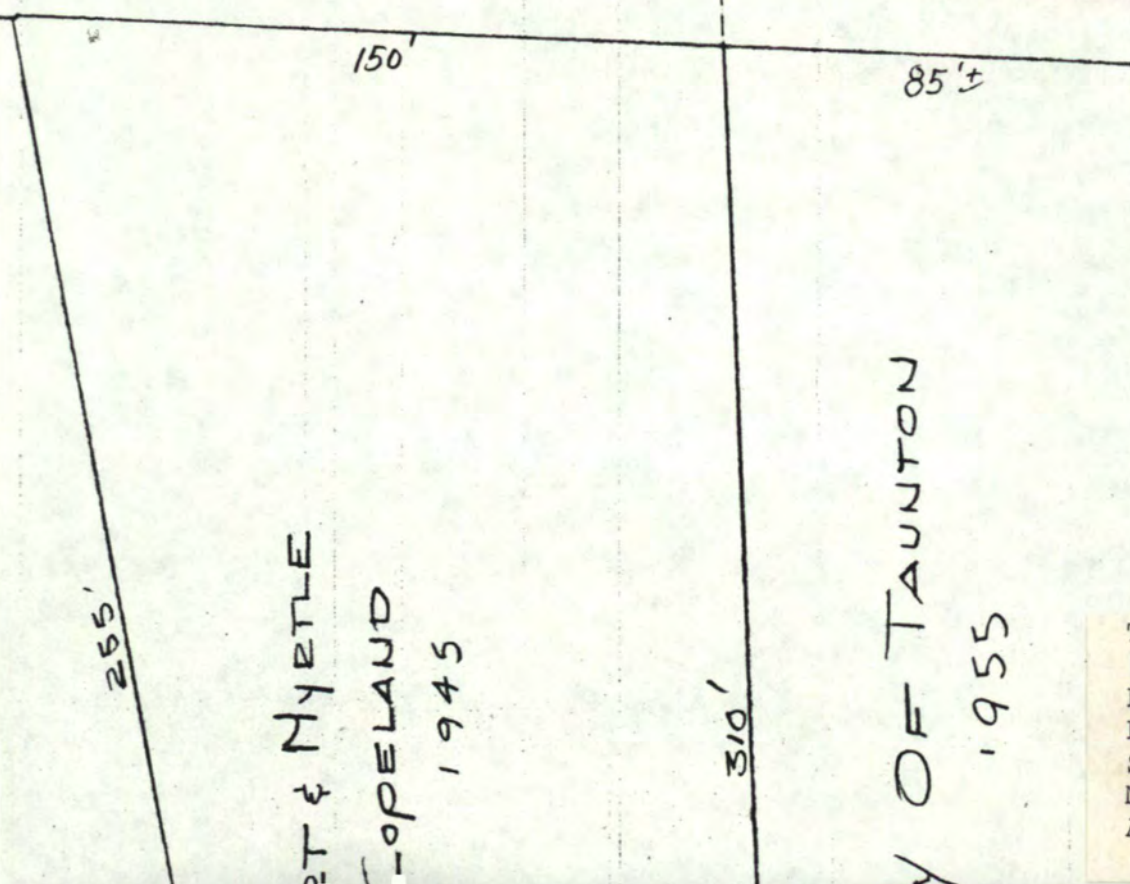
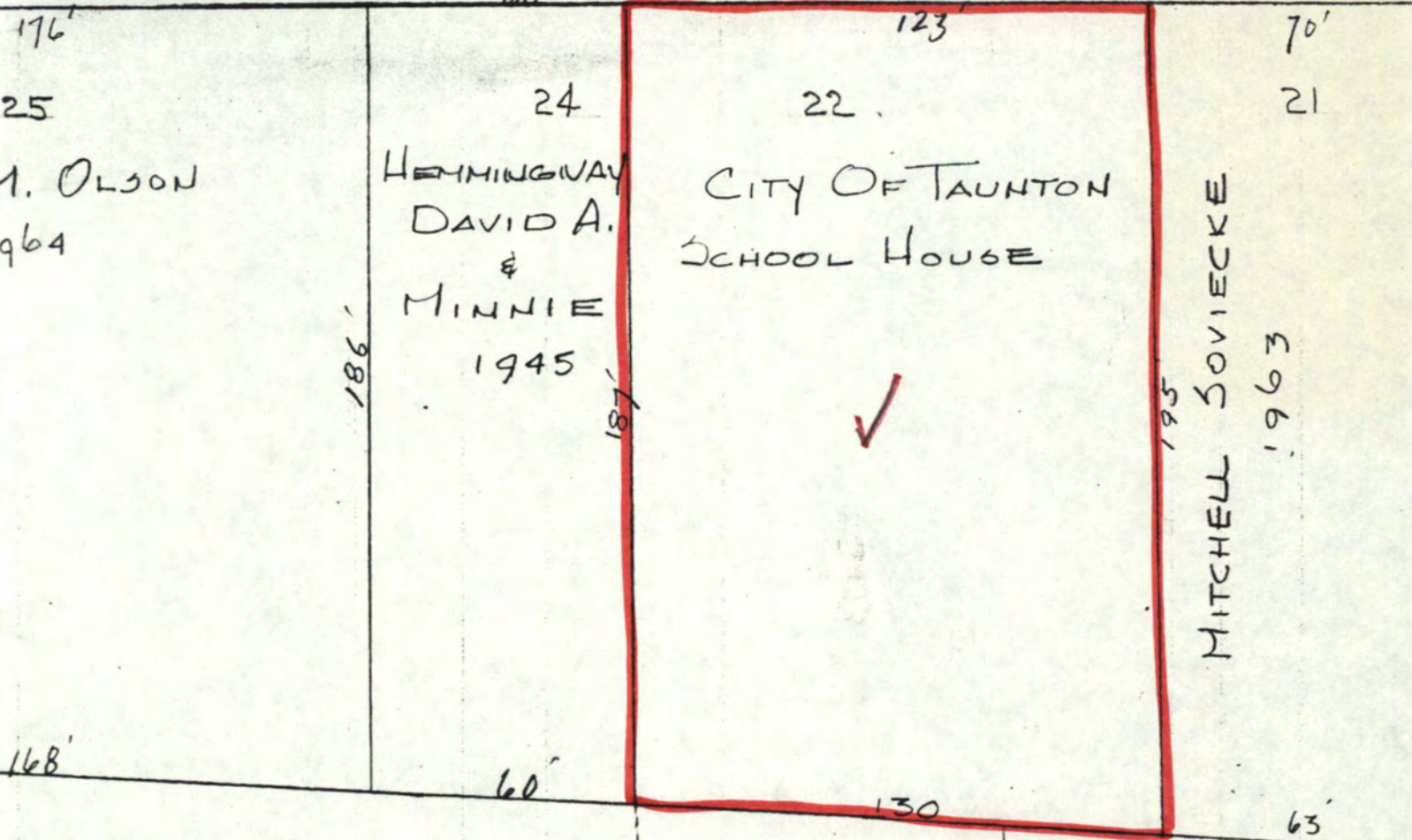

TAUNTON MULTIPLE RESOURCE  
 NOMINATION  
 FORM NO. 473  
 LEONARD SCHOOL  
 SCALE: 1" = 40'  
 MAP NO. WD 8, Pg. 20, Lot 22  
 ACREAGE *less than one*

Please refer to the map in the  
Multiple Property Cover Sheet  
for this property

Multiple Property Cover Sheet Reference Number: 64000297