

**United States Department of the Interior  
Heritage Conservation and Recreation Service**

**National Register of Historic Places  
Inventory—Nomination Form**

See instructions in *How to Complete National Register Forms*  
Type all entries—complete applicable sections

**1. Name**

historic McGehee House

and/or common same

**2. Location**

street & number 1106 S. Holly St. N/A not for publication

city, town Hammond N/A vicinity of congressional district 6th--Henson Moore

state La. code 22 county Tangipahoa Parish code 105

**3. Classification**

Category	Ownership	Status	Present Use
<input type="checkbox"/> district	<input type="checkbox"/> public	<input checked="" type="checkbox"/> occupied	<input type="checkbox"/> agriculture
<input checked="" type="checkbox"/> building(s)	<input checked="" type="checkbox"/> private	<input type="checkbox"/> unoccupied	<input type="checkbox"/> commercial
<input type="checkbox"/> structure	<input type="checkbox"/> both	<input type="checkbox"/> work in progress	<input type="checkbox"/> educational
<input type="checkbox"/> site	<b>Public Acquisition</b>	<b>Accessible</b>	<input checked="" type="checkbox"/> private residence
<input type="checkbox"/> object	<u>N/A</u> in process	<input checked="" type="checkbox"/> yes: restricted	<input type="checkbox"/> entertainment
	<u>N/A</u> being considered	<input type="checkbox"/> yes: unrestricted	<input type="checkbox"/> government
		<input type="checkbox"/> no	<input type="checkbox"/> industrial
			<input type="checkbox"/> military
			<input type="checkbox"/> museum
			<input type="checkbox"/> park
			<input type="checkbox"/> religious
			<input type="checkbox"/> scientific
			<input type="checkbox"/> transportation
			<input type="checkbox"/> other:

**4. Owner of Property**

name Mr. and Mrs. Edward L. McGehee III

street & number 1106 S. Holly Street

city, town Hammond N/A vicinity of state La. 70401

**5. Location of Legal Description**

courthouse, registry of deeds, etc. Tangipahoa Parish Courthouse

street & number corner of Mulberry and Bay Streets (no specific address) P. O. Box 667

city, town Amite state La. 70422

**6. Representation in Existing Surveys**

title La. Historic Sites Survey has this property been determined eligible?  yes  no

date 1980  federal  state  county  local

depository for survey records La. State Historic Preservation Office

city, town Baton Rouge state La.

---

## 7. Description

---

**Condition**

excellent  
 good  
 fair

deteriorated  
 ruins  
 unexposed

**Check one**

unaltered  
 altered

**Check one**

original site  
 moved date           N/A          

---

**Describe the present and original (if known) physical appearance**

Until the 1950's the McGehee House was alone in the wooded countryside east of the town of Hammond. Since then several shops and ranch houses have been built in the vicinity, though the area is still largely rural.

The two story frame house has 14 foot ceilings on both floors. The ground floor has a central hall plan but with a variation inspired by the then dying influence of the Queen Anne Revival. The hall has a massive brick fireplace and merges with a large front room through a monumental composite order colonnade. The staircase is set at right angles to the central hall and turns back on itself, leaving a large landing open to the aforementioned front room in a boldly 3 dimensional effect. Thus the house contains what amounts to a Queen Anne living hall.

The other rooms on the ground floor have shoulder height paneled wainscotting and simple corner fireplaces with shallow brick arches. Major ground floor rooms are connected by sets of double sliding doors with horizontal panels. The upstairs has a central hall plan with a central door leading to the front balustraded balcony. This balcony is set within a composite order colossal portico with a shingled tympanum containing a lunette. In the 1940's the upper portion was screened in for a sleeping porch, but this is an easily reversible change. This has been the only noteworthy change in the house since construction, and it should be regarded as minor.

**SUMMARY PARAGRAPH:**

The McGehee House (1907) is a frame, two-story, Colonial Revival residence located in a suburban setting in the city of Hammond. The house has been altered very little since construction, and consequently there is no integrity problem.

## 8. Significance

Period	Areas of Significance—Check and justify below			
<input type="checkbox"/> prehistoric	<input type="checkbox"/> archeology-prehistoric	<input type="checkbox"/> community planning	<input type="checkbox"/> landscape architecture	<input type="checkbox"/> religion
<input type="checkbox"/> 1400–1499	<input type="checkbox"/> archeology-historic	<input type="checkbox"/> conservation	<input type="checkbox"/> law	<input type="checkbox"/> science
<input type="checkbox"/> 1500–1599	<input type="checkbox"/> agriculture	<input type="checkbox"/> economics	<input type="checkbox"/> literature	<input type="checkbox"/> sculpture
<input type="checkbox"/> 1600–1699	<input checked="" type="checkbox"/> architecture	<input type="checkbox"/> education	<input type="checkbox"/> military	<input type="checkbox"/> social/ humanitarian
<input type="checkbox"/> 1700–1799	<input type="checkbox"/> art	<input type="checkbox"/> engineering	<input type="checkbox"/> music	<input type="checkbox"/> theater
<input type="checkbox"/> 1800–1899	<input type="checkbox"/> commerce	<input type="checkbox"/> exploration/settlement	<input type="checkbox"/> philosophy	<input type="checkbox"/> transportation
<input checked="" type="checkbox"/> 1900–	<input type="checkbox"/> communications	<input type="checkbox"/> industry	<input type="checkbox"/> politics/government	<input type="checkbox"/> other (specify)
		<input type="checkbox"/> invention		

**Specific dates** 1907 **Builder/Architect** Builder: Dr. E. L. McGehee, Jr.

**Statement of Significance (in one paragraph)** Criterion C

The McGehee House is locally significant in the area of architecture within the context of the city of Hammond for two reasons:

- (1) Its living hall is unusually large and pretentious. A modest number of period residences in Louisiana have living halls, but the 14 foot ceiling and the composite order colonnade give the McGehee living hall additional distinction. It is certainly the finest living hall in Hammond. \*\*
- (2) The McGehee House is a landmark in Hammond. With its massive portico, it has one of the city's most impressive residential facades.

\*\*Although it is possible to speak of the living hall within the context of the state, the State Historic Preservation Office does not feel that a sufficient scholarly basis exists to make a plausible case for significance on the state level. We do know that the McGehee House's living hall is significant within the context of Hammond.

# 9. Major Bibliographical References

Chain of Title, Tangipahoa Parish Courthouse

# 10. Geographical Data

Acreeage of nominated property approx..65acre

Quadrangle name Ponchatoula, La.

Quadrangle scale 1:24,000

UMT References

A 

1	5	7	4	4	2	5	0	3	3	7	6	2	0	0
Zone			Easting					Northing						

B 

Zone			Easting					Northing						

C 

Zone			Easting					Northing						

D 

Zone			Easting					Northing						

E 

Zone			Easting					Northing						

F 

Zone			Easting					Northing						

G 

Zone			Easting					Northing						

H 

Zone			Easting					Northing						

Verbal boundary description and justification

See attached sketch map.

List all states and counties for properties overlapping state or county boundaries

state N/A code county code

state code county code

# 11. Form Prepared By

name/title Mr. and Mrs. Edward L. McGehee III

organization N/A

date December 1980

street & number 1106 S. Holly

telephone 345-5075

city or town Hammond

state La. 70401

# 12. State Historic Preservation Officer Certification

The evaluated significance of this property within the state is:

national  state  local

As the designated State Historic Preservation Officer for the National Historic Preservation Act of 1966 (Public Law 89-665), I hereby nominate this property for inclusion in the National Register and certify that it has been evaluated according to the criteria and procedures set forth by the Heritage Conservation and Recreation Service.

State Historic Preservation Officer signature

*Robert B. DeBlieux*

Robert B. DeBlieux

title State Historic Preservation Officer

date September 9, 1982

For HCERS use only

I hereby certify that this property is included in the National Register

*Anna Lee Pruzel*  
Keeper of the National Register

date 11/2/82

Attest: *Patrick Andrews*  
Chief of Registration

date 11/2/82

# McGenee House

Hammond, LA

NOTE: SITE BOUNDARIES PARALLEL  
BLDG. FACADES + CURB LINES AT  
DISTANCES SHOWN.

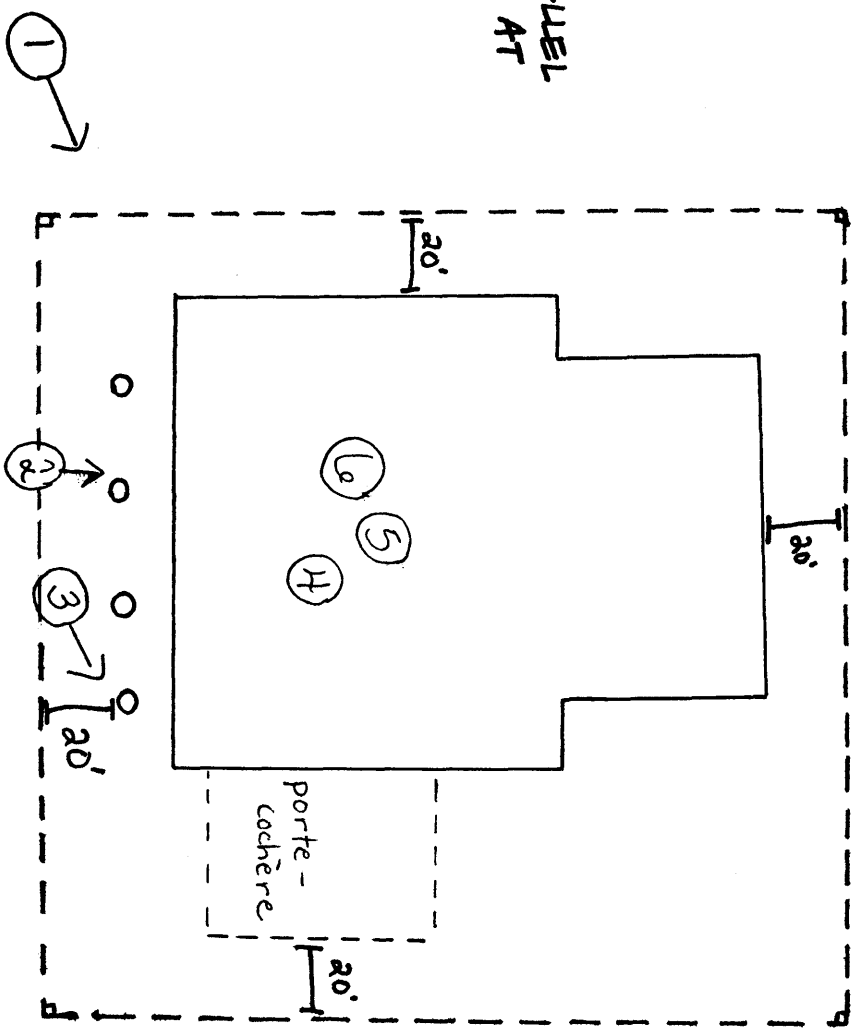

SCALE 1" = 40' APPROX.

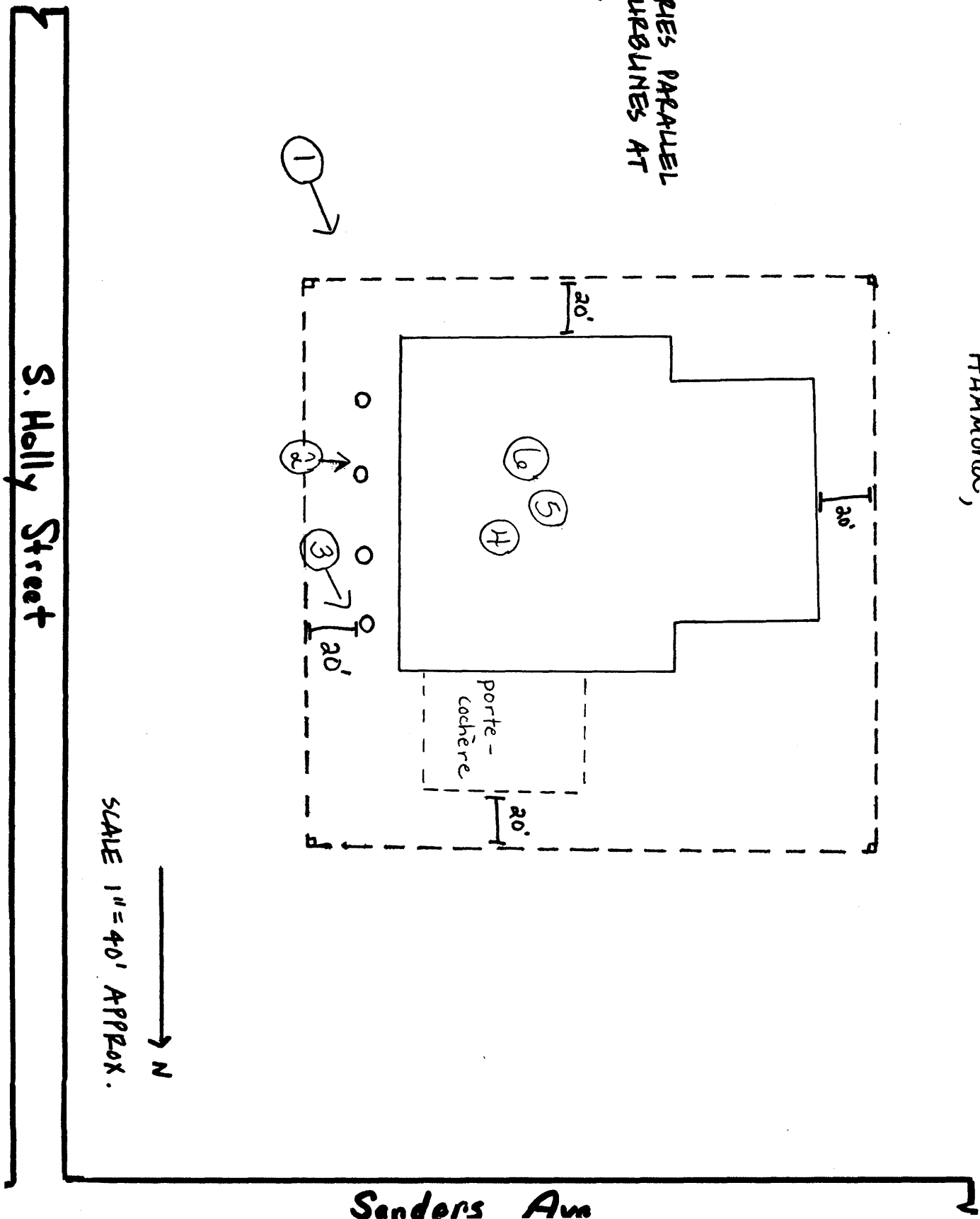

S. Holly Street

Sanders Ave