

United States Department of the Interior  
National Park Service

National Register of Historic Places  
Inventory—Nomination Form

See instructions in *How to Complete National Register Forms*  
Type all entries—complete applicable sections

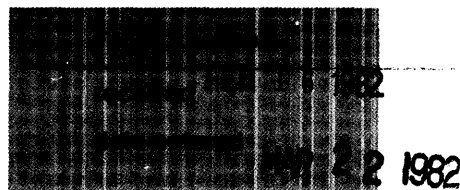

1. Name

historic Kincaid House

and/or common Kincaid-Russell House

2. Location

NE of Speedwell on

street & number Russell Lane \_\_\_ not for publication

city, town Speedwell, inc.  vicinity of ~~Congressional district~~ 2

state Tennessee code 047 county Claiborne code 025

3. Classification

<b>Category</b>	<b>Ownership</b>	<b>Status</b>	<b>Present Use</b>
<input type="checkbox"/> district	<input type="checkbox"/> public	<input checked="" type="checkbox"/> occupied	<input type="checkbox"/> agriculture
<input checked="" type="checkbox"/> building(s)	<input checked="" type="checkbox"/> private	<input type="checkbox"/> unoccupied	<input type="checkbox"/> commercial
<input type="checkbox"/> structure	<input type="checkbox"/> both	<input type="checkbox"/> work in progress	<input type="checkbox"/> educational
<input type="checkbox"/> site	<b>Public Acquisition</b>	<b>Accessible</b>	<input checked="" type="checkbox"/> private residence
<input type="checkbox"/> object	<input type="checkbox"/> In process	<input checked="" type="checkbox"/> yes: restricted	<input type="checkbox"/> religious
	<input type="checkbox"/> being considered	<input type="checkbox"/> yes: unrestricted	<input type="checkbox"/> scientific
		<input type="checkbox"/> no	<input type="checkbox"/> transportation
			<input type="checkbox"/> other:

4. Owner of Property

name Bill Russell

street & number Box 53, Route 1

city, town Speedwell \_\_\_ vicinity of state Tennessee 37870

5. Location of Legal Description

courthouse, registry of deeds, etc. Registrar of Deeds

street & number Claiborne County Courthouse

city, town Tazewell state Tennessee 37879

6. Representation in Existing Surveys

title Historic Sites Survey-ETDD has this property been determined eligible? \_\_\_ yes \_\_\_ no

date June 1974 \_\_\_ federal \_\_\_ state  county \_\_\_ local

depository for survey records Tennessee Historical Commission, 4721 Trousdale Drive

city, town Nashville state Tennessee 37219

## 7. Description

### Condition

excellent  
 good  
 fair

deteriorated  
 ruins  
 unexposed

### Check one

unaltered  
 altered

### Check one

original site  
 moved date \_\_\_\_\_

### Describe the present and original (if known) physical appearance

The Kincaid House, which faces southeast, is located near the intersection of Russell Lane and Back Valley Road on gently rolling farm land. Large trees and shrubs surround the house and outbuildings. Constructed on a limestone foundation, with full basement, the two-story brick structure has an L-shaped plan with a gable roof sheathed in patterned asphalt shingles. Because of the slope of the site the basement story is exposed on the northeast elevation of both the main sections and the ell. There are three exterior end chimneys, one on each gable end of the main section and one on the gable end of the ell. The ell also has one central brick chimney. A decorative brick cornice extends across the front and rear elevations of the main section.

Laid in Flemish bond, the five bay front (SE) facade contains large twelve over twelve light double hung sash windows with stone lintels beneath a brick header course and stone slip sills. A three-bay brick front porch was added ca. 1935. The paneled entrance door, located in the central bay, is framed by sidelights and a rectangular transom. A six-panel basement door with ventilating transom is located at the right of the front porch.

The southwest facade is distinguished by a stepped parapet wall. A pair of two over two light double hung sash windows on the first story and nine over nine light double hung sash windows on the second story flank the chimney. All the windows have a header course above and brick slip sills covered with stucco. An open porch originally extended the full length of the ell along the southwest elevation. This was enclosed around 1935 to provide additional kitchen space. The enclosed porch has ten sash windows and one door. Asphalt pattern shingles cover the catslide roof of the ell.

The rear elevation of the main section has three windows up and three down with the same brick lintels and sills as on the southwest facade. The rear or northwest facade of the ell is dominated by the large chimney which has a large cooking fireplace in the basement. A window is to the right of the chimney and a basement door with rectangular transom is to the left of the chimney.

The northeast elevation shows the main house flush with the ell. In the main section a pair of six over six double hung windows in both the basement and first story, and two over two double hung windows in the second story flank the chimney. These windows have stone slip sills and stuccoed brick lintels. A pair of small four light windows flank the chimney in the attic story. A molded brick cornice above two projecting courses extends across the northeast elevation of the ell. A paneled door with a rectangular three light transom is centered in the three bays of the ell.

The interior has been altered by closing off the large fireplaces and installing smaller wood stoves, lowering ceilings, and putting up new light fixtures and paneling. The original wood mantels with fluted pilasters remain intact. The two flight original staircase with ornamental string brackets and turned balusters also remains.

**United States Department of the Interior  
Heritage Conservation and Recreation Service****National Register of Historic Places  
Inventory—Nomination Form**

Continuation sheet

Item number 7

Page 2

There are two outbuildings located within the boundaries of the nominated property, a smoke house and spring house. The two story brick smokehouse is laid in the common bond and has small four light windows, a corbelled interior-exterior chimney and a wood shingled gable roof. A one-story brick lean-to with a shed roof is located on the west side. Large hand hewn beams with long nails to hold the meat are still intact. A two-story brick springhouse with gable roof, built ca. 1930 by Fred Russell, stands at a right angle to the smokehouse. They are both located approximately fifty feet north of the house.

# 8. Significance

Period	Areas of Significance—Check and justify below			
<input type="checkbox"/> prehistoric	<input type="checkbox"/> archeology-prehistoric	<input type="checkbox"/> community planning	<input type="checkbox"/> landscape architecture	<input type="checkbox"/> religion
<input type="checkbox"/> 1400–1499	<input type="checkbox"/> archeology-historic	<input type="checkbox"/> conservation	<input type="checkbox"/> law	<input type="checkbox"/> science
<input type="checkbox"/> 1500–1599	<input type="checkbox"/> agriculture	<input type="checkbox"/> economics	<input type="checkbox"/> literature	<input type="checkbox"/> sculpture
<input type="checkbox"/> 1600–1699	<input checked="" type="checkbox"/> architecture	<input type="checkbox"/> education	<input type="checkbox"/> military	<input type="checkbox"/> social/
<input type="checkbox"/> 1700–1799	<input type="checkbox"/> art	<input type="checkbox"/> engineering	<input type="checkbox"/> music	<input type="checkbox"/> humanitarian
<input checked="" type="checkbox"/> 1800–1899	<input type="checkbox"/> commerce	<input type="checkbox"/> exploration/settlement	<input type="checkbox"/> philosophy	<input type="checkbox"/> theater
<input type="checkbox"/> 1900–	<input type="checkbox"/> communications	<input type="checkbox"/> industry	<input type="checkbox"/> politics/government	<input type="checkbox"/> transportation
		<input type="checkbox"/> invention		<input type="checkbox"/> other (specify)

**Specific dates** ca. 1840 **Builder/Architect** John Kincaid II

**Statement of Significance (in one paragraph)**

An example of the work of master builder John Kincaid II, the William Harrison Kincaid House is an architecturally distinctive house within the context of Claiborne County. In an area where most early houses were built of log or frame, the use of brick construction is unusual. Other uncommon features used to embellish the exterior are stepped parapet gables, the use of Flemish bond later than it appears elsewhere in East Tennessee and molded brick cornices. These elements do occur in other sections of East Tennessee but occur infrequently in this county, thus marking the house as very fine for its locale.

The Kincaid House was built for William Harrison Kincaid by his brother John Kincaid II around 1840. John II built six houses in the Powell Valley for members of his family. John Kincaid II's father, John I was one of the first settlers of the Powell Valley. He and wife Nancy, had nine children and farmed in the valley. Though they achieved no great wealth, their offspring fared much better. John II and his brother, William, became large land and slave owners.

William Kincaid sold his property around 1880 to the Bryant family. They sold to Bill Russell (uncle of the present owner) around 1898. He then passed it on to his brother, who left it to his son Bill Russell Jr., the present owner.

# 9. Major Bibliographical References

Coddington, John. Historic Sites Survey. Knoxville: East Tennessee Development District, 1974.  
 Brisban, Mrs. John F., Editor. "Kincaid Family Newsletter." Dec. 15, 1958, Lansing, Mich.  
 Interview with Bill Russell. Speedwell, August 1980.  
 Interview with Col. Edgar Holt, Claiborne County Historian. August 25, 1980.

# 10. Geographical Data

Acreage of nominated property Less than 1  
 Quadrangle name Ausmus

UTM NOT VERIFIED  
 ACREAGE NOT VERIFIED  
 QUADRANGLE SCALE 1:24000

UMT References Latitude 36° 28' 05"  
 Longitude 83° 49' 22"

A	<input type="text"/>	<input type="text"/>	<input type="text"/>
	Zone	Easting	Northing
C	<input type="text"/>	<input type="text"/>	<input type="text"/>
E	<input type="text"/>	<input type="text"/>	<input type="text"/>
G	<input type="text"/>	<input type="text"/>	<input type="text"/>

B	<input type="text"/>	<input type="text"/>	<input type="text"/>
	Zone	Easting	Northing
D	<input type="text"/>	<input type="text"/>	<input type="text"/>
F	<input type="text"/>	<input type="text"/>	<input type="text"/>
H	<input type="text"/>	<input type="text"/>	<input type="text"/>

**Verbal boundary description and justification :** The boundaries of this nomination are outlined in red on the attached map and includes the area traditionally considered the farmhouse yard. A stone retaining wall along Russell Lane is the east boundary; a stone retaining wall approximately 85' in length is the south boundary; a row of trees extending 180' on the west, and the driveway on the north and part of the east comprise the remainder of the boundaries.

**List all states and counties for properties overlapping state or county boundaries**

state	code	county	code
state	code	county	code

# 11. Form Prepared By

name/title Nissa Dahlin Brown, Historic Preservationist  
 organization East Tennessee Development District date August 25, 1980  
 street & number P.O. Box 19806 telephone (615) 584-8553  
 city or town Knoxville state Tennessee 37919

# 12. State Historic Preservation Officer Certification

The evaluated significance of this property within the state is:

national  state  local

As the designated State Historic Preservation Officer for the National Historic Preservation Act of 1966 (Public Law 89-665), I hereby nominate this property for inclusion in the National Register and certify that it has been evaluated according to the criteria and procedures set forth by the National Park Service.

Deputy State Historic Preservation Officer signature Herbert L. Hays

title Executive Director, Tennessee Historical Commission date 2/5/82

For NPS use only	
I hereby certify that this property is included in the National Register	
<u>Ann A. Beebe</u>	date <u>3/22/1982</u>
Keeper of the National Register	
Attest: <u>Ann A. Beebe</u>	date <u>3/22/82</u>
Chief of Registration	

# KINGCRO - RUSSELL HOUSE

APPROX. NORTH

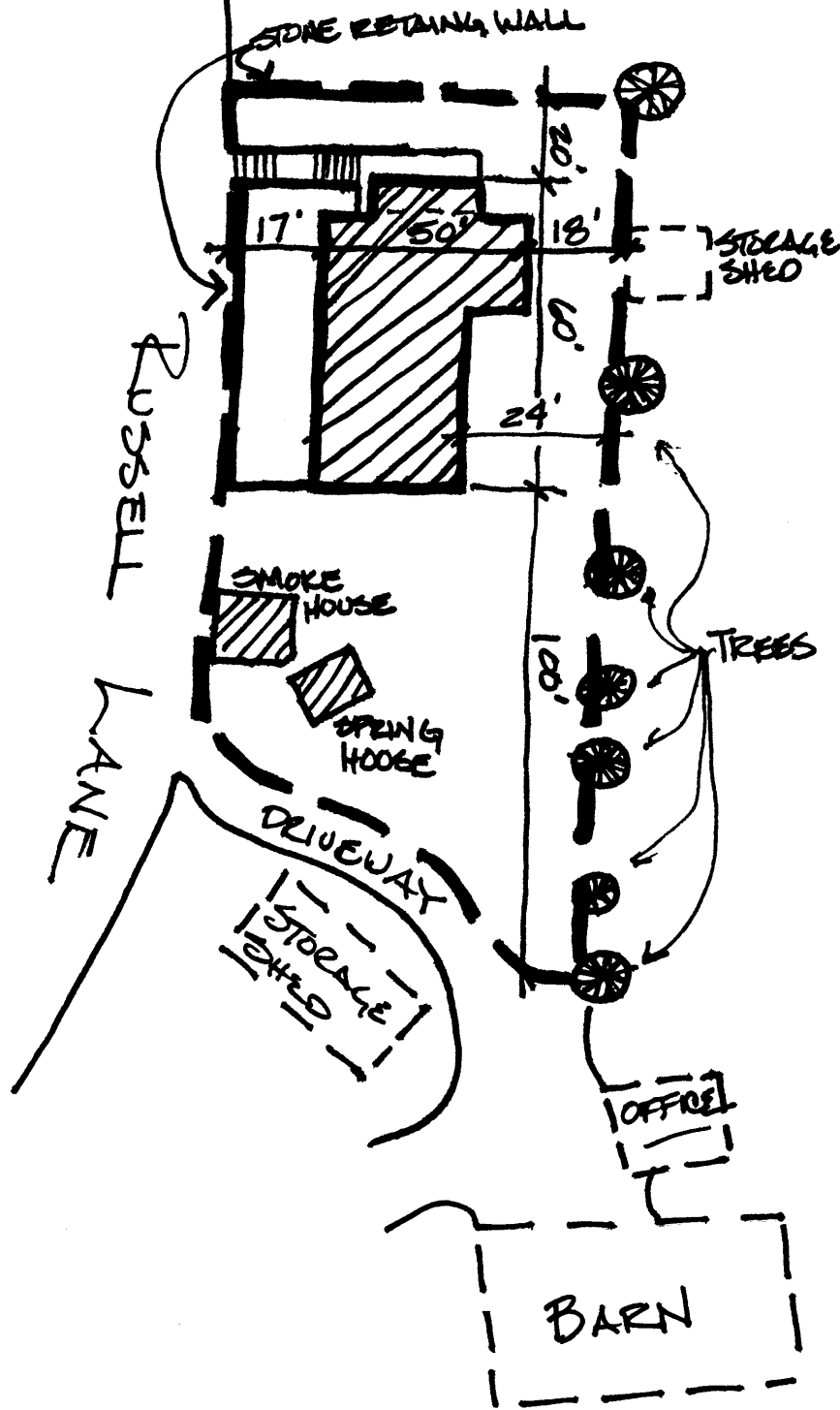

- BOUNDARY LINE
- ▨ - NOMINATED STRUCTURES

BOUNDARY IS DEFINED BY A STONE RETAINING WALL ON THE EAST & SOUTH ; A ROW OF TREES ON THE WEST ; AND RUSSELL LANE AND DRIVEWAY ON THE NORTH AND SMALL PORTION OF THE EAST.

DEC 8 1980