



236

GARNETT STATION PLACE

GARNETT STATION PLACE

GARNETT STATION PLACE

GARNETT STATION PLACE



**SOUTHERN BELTING COMPANY BUILDING**

**Atlanta, Fulton County, Georgia**

**Photographer: James R. Lockhart**

**Negative: Filed with the Georgia Department  
of Natural Resources**

**Date: October 1987**

**1 of 9: Front facade; photographer facing  
southeast**



SOUTHERN BELTING COMPANY BUILDING

Atlanta, Fulton County, Georgia

Photographer: James R. Lockhart

Negative: Filed with the Georgia Department  
of Natural Resources

Date: October 1987

2 of 9: Northeast facade; photographer facing  
southwest.



SOUTHERN BELTING COMPANY BUILDING

Atlanta, Fulton County, Georgia

Photographer: James R. Lockhart

Negative: Filed with the Georgia Department  
of Natural Resources

Date: October 1987

3 of 9: North view; photographer facing  
south.



SOUTHERN BELTING COMPANY BUILDING

Atlanta, Fulton County, Georgia

Photographer: James R. Lockhart

Negative: Filed with the Georgia Department  
of Natural Resources

Date: October 1987

4 of 9: Southwest facade; photographer  
facing north.





SOUTHERN BELTING COMPANY BUILDING

Atlanta, Fulton County, Georgia

Photographer: James R. Lockhart

Negative: Filed with the Georgia Department  
of Natural Resources

Date: October 1987

5 of 9: First floor view of atrium;  
photographer facing south.

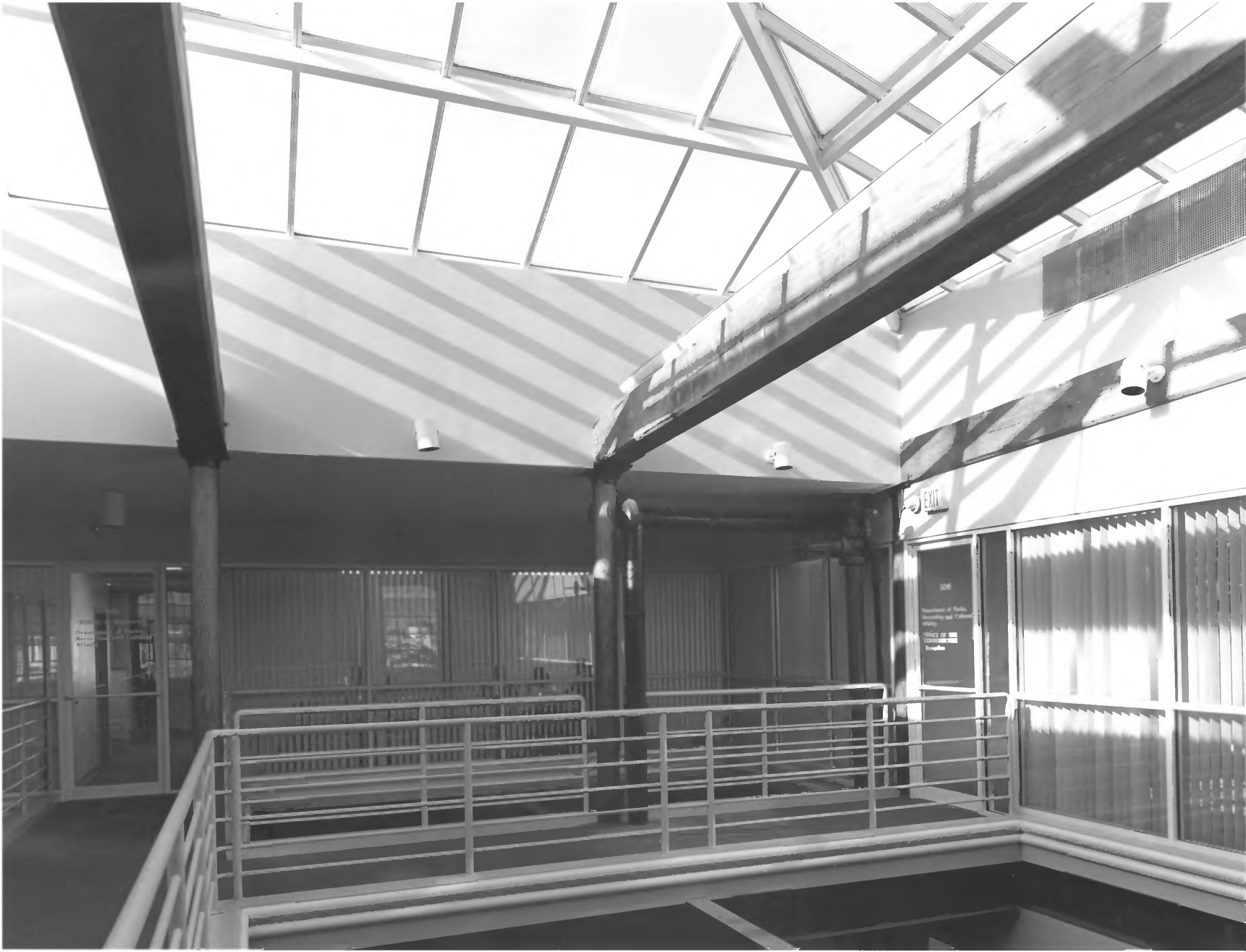

**SOUTHERN BELTING COMPANY BUILDING**

**Atlanta, Fulton County, Georgia**

**Photographer: James R. Lockhart**

**Negative: Filed with the Georgia Department  
of Natural Resources**

**Date: October 1987**

**6 of 9: Fifth floor at atrium;  
photographer facing south.**



5

WINDMILL  
MILL  
ATLANTA

SOUTHERN BELTING COMPANY BUILDING

Atlanta, Fulton County, Georgia

Photographer: James R. Lockhart

Negative: Filed with the Georgia Department  
of Natural Resources

Date: October 1987

7 of 9: Stairwell; photographer facing  
east.



SOUTHERN BELTING COMPANY BUILDING

Atlanta, Fulton County, Georgia

Photographer: James R. Lockhart

Negative: Filed with the Georgia Department  
of Natural Resources

Date: October 1987

8 of 9: Elevator shaft and machinery;  
photographer facing south.





SOUTHERN BELTING COMPANY BUILDING

Atlanta, Fulton County, Georgia

Photographer: James R. Lockhart

Negative: Filed with the Georgia Department  
of Natural Resources

Date: October 1987

9 of 9: Office Space; photographer facing  
northeast.