

Area	Form no.
3000	132

MASSACHUSETTS HISTORICAL COMMISSION  
 294 Washington Street, Boston, MA 02108

Town Springfield

Address Howard Street and E. Columbus Ave

Historic Name St. Joseph's Church (DSMRA)

PHOTO (3x3" or 3x5", black & white)  
 Staple to left side of form  
 Photo number \_\_\_\_\_

Use: Original church

Present church

Ownership:  Private individual  
 Private organization Roman Catholic Bishop of Springfield  
 Public \_\_\_\_\_

Original owner Roman Catholic Bishop of Springfield

SKETCH MAP

Draw map showing property's location in relation to nearest cross streets and other buildings or geographical features. Indicate north.

DESCRIPTION:

Date 1873-1877

Source Centennial Church History

Style Romanesque Revival

Architect unknown

Exterior wall fabric brick

Outbuildings none

Major alterations (with dates) \_\_\_\_\_

1911 - vestibules added

1940's, '60's - interior modernized

Moved no Date N/A

Approx. acreage less than one acre

Setting Mixed use area; bounded by East

Columbus Av. and Rt. 91 to west, across

street from parish house. Other uses nearby are a school and church parking lot.

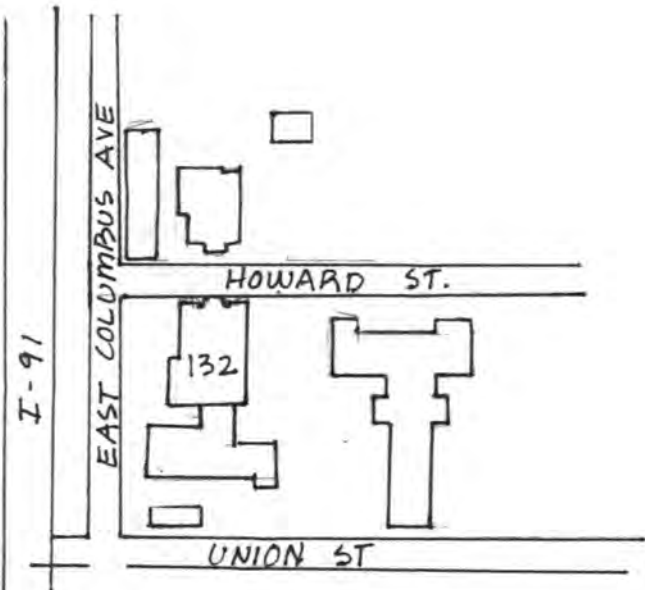

Recorded by Marqo Webber

Organization Anderson Notter Finegold Inc.

Date June, 1981

Assessor's Map #308

UTM Ref: 18/699480/4663240

Springfield South Quadrangle (Staple additional sheets here)

## CRITERIA STATEMENT

Saint Joseph's Church possesses integrity of location, setting, design, materials and workmanship. It is architecturally significant as a fine local example of an early Romanesque Revival Church. It is historically important for its role in the development of the Catholic Church and as one of the most visible symbols of the early French-Canadian community. It meets criteria A & C of the National Register of Historic Places.

### ARCHITECTURAL SIGNIFICANCE (describe important architectural features and evaluate in terms of other buildings within community)

This structure is a fine example of late 19th-century ecclesiastical architecture built for a growing young parish. Its tall tower and spire rise above the smaller-scaled buildings of the surrounding blocks and create a "landmark" identity within the neighborhood to the south.

The building is of brick with brownstone trim. Its massing is the traditional form of a central nave flanked by buttressed aisles. A square clock tower rises above the roofline in the front, center bay flanked by one-story gabled entry vestibules of brick. The window openings give a Romanesque Revival character to the design.

The majority of openings have round-arched heads, brownstone sills and voussoirs.

### HISTORICAL SIGNIFICANCE (explain the role owners played in local or state history and how the building relates to the development of the community)

The establishment of Catholic churches in Springfield coincided with the influx of immigrant groups in the latter half of the 19th century. These people came to find jobs in the factories and developed small communities within the city.

The first Catholic church in the city was St. Michael's Church on State Street, which was organized in 1860. The Diocese of Springfield was created in 1870, with the Rev. P.T. O'Reilly appointed as its first bishop. In the next few years, the French Catholics, who had previously been part of St. Michael's Parish, decided to recognize a French parish. Under the direction of the Canadian priest, Friar Louis Gagnier, a French-Canadian parish was organized in 1873. It consisted of 240 families and included the towns of West Springfield, Mittineague and Longmeadow, as well as the city of Springfield.

Land was acquired by the Roman Catholic Bishop on Howard Street to build a church. The site selected was part of the estate of Caleb Rice, Springfield's first mayor. The Rice Homestead was at first used as the parochial residence. In 1873, the basement of the new church was completed and services were held there until 1877, when the entire church was completed. Friar Gagnier is reported to have designed the church himself, modelling it after brick and fieldstone churches of his native Quebec. St. Joseph's Church continues to serve the needs of the surrounding neighborhood to the south, and has grown to include a parochial school, rectory building and additional facilities.

### BIBLIOGRAPHY and/or REFERENCES

- St. Joseph's Church, Springfield, MA, 1873 - 1973, Centennial Review  
History of the Catholic Church in the Diocese of Springfield, 1900  
King's Handbook of Springfield, 1884, p. 204

United States Department of the Interior  
National Park Service

St. Joseph's Church (Downtown Springfield MRA)  
Hampden County  
MASSACHUSETTS

Working No. 11/10/82-3025

Fed. Reg. Date: \_\_\_\_\_

Date Due: 12/9/82 - 12/25/82

Action:  ACCEPT

RETURN 12/24/82

REJECT

Federal Agency: \_\_\_\_\_

- resubmission
- nomination by person or local government
- owner objection
- appeal

Substantive Review:  sample  request  appeal  NR decision

Reviewer's comments:

Recom. / Criteria \_\_\_\_\_

Reviewer \_\_\_\_\_

Discipline \_\_\_\_\_

Date \_\_\_\_\_

see continuation sheet

Nomination returned for:  technical corrections cited below  
 substantive reasons discussed below

1. Name

2. Location

3. Classification

Category	Ownership	Status	Present Use
	Public Acquisition	Accessible	

4. Owner of Property

5. Location of Legal Description

6. Representation in Existing Surveys

has this property been determined eligible?  yes  no

7. Description

Condition	Check one	Check one
<input type="checkbox"/> excellent	<input type="checkbox"/> deteriorated	<input type="checkbox"/> unaltered
<input type="checkbox"/> good	<input type="checkbox"/> ruins	<input type="checkbox"/> original site
<input type="checkbox"/> fair	<input type="checkbox"/> unexposed	<input type="checkbox"/> moved date _____
	<input type="checkbox"/> altered	

Describe the present and original (if known) physical appearance

- summary paragraph
- completeness
- clarity
- alterations/integrity
- dates
- boundary selection

## 8. Significance

Period \_\_\_\_\_ Areas of Significance—Check and justify below

Specific dates \_\_\_\_\_ Builder/Architect \_\_\_\_\_

Statement of Significance (in one paragraph)

- summary paragraph
- completeness
- clarity
- applicable criteria
- justification of areas checked
- relating significance to the resource
- context
- relationship of integrity to significance
- justification of exception
- other

## 9. Major Bibliographical References

## X 10. Geographical Data

Acreage of nominated property \_\_\_\_\_

Geographic name \_\_\_\_\_

UMT References \_\_\_\_\_

Verbal boundary description and justification

X Please provide

## 11. Form Prepared By

## 12. State Historic Preservation Officer Certification

The evaluated significance of this property within the state is:

\_\_\_\_ national \_\_\_\_ state \_\_\_\_ local

State Historic Preservation Officer signature \_\_\_\_\_

title \_\_\_\_\_ date \_\_\_\_\_

## 13. Other

- Maps
- Photographs
- Other

Questions concerning this nomination may be directed to \_\_\_\_\_

Signed *J. Byers* Date 12/22/82 Phone: 202 272-3504

Comments for any item may be continued on an attached sheet

United States Department of the Interior  
National Park Service

National Register of Historic Places  
Inventory—Nomination Form

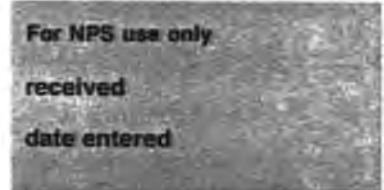

Continuation sheet

Item number

Page 5245

Multiple Resource Area  
Thematic Group

Name Downtown Springfield Multiple Resource Area  
State MA

Nomination/Type of Review

Date/Signature

41. Colonial Block

Entered in the  
National Register

for  
Keeper

Melvin Byers 2/24/83

Attest

42. McKinney Building

Entered in the  
National Register

for  
Keeper

Melvin Byers 2/24/83

Attest

43. Bangs Block

Entered in the  
National Register

for  
Keeper

Melvin Byers 2/24/83

Attest

44. Burbach Block

Entered in the  
National Register

for  
Keeper

Melvin Byers 2/24/83

Attest

45. Apremont Triangle Historic  
District

Substantive Review

Keeper

Melvin Byers 5/27/83

Attest

46. WCA Boarding House

Entered in the  
National Register

for  
Keeper

Melvin Byers 2/24/83

Attest

47. French Congregational  
Church

Entered in the  
National Register

for  
Keeper

Melvin Byers 2/24/83

Attest

48. St. Joseph's Church

Entered in the  
National Register

for  
Keeper

Melvin Byers 2/24/83

Attest

49. Milton-Bradley Company

Entered in the  
National Register

for  
Keeper

Melvin Byers 2/24/83

Attest

50.

Keeper

Attest

United States Department of the Interior  
National Park Service

St. Joseph's Church (Downtown Springfield MRA)

HAMPDEN COUNTY

MASSACHUSETTS

Working No. 11/10/82-3021

Fed. Reg. Date: 2.7.84

Date Due: 4/1/83

Action:  ACCEPT 2/21/83

Entered in the  RETURN

National Register  REJECT

Federal Agency: \_\_\_\_\_

- resubmission
- nomination by person or local government
- owner objection
- appeal

Substantive Review:  sample  request  appeal  NR decision

Reviewer's comments:

Recom./Criteria \_\_\_\_\_

Reviewer \_\_\_\_\_

Discipline \_\_\_\_\_

Date \_\_\_\_\_

see continuation sheet

Nomination returned for:  technical corrections cited below  
 substantive reasons discussed below

1. Name

2. Location

3. Classification

Category	Ownership	Status	Present Use
	Public Acquisition	Accessible	

4. Owner of Property

5. Location of Legal Description

6. Representation in Existing Surveys

has this property been determined eligible?  yes  no

7. Description

Condition	Check one	Check one
<input type="checkbox"/> excellent	<input type="checkbox"/> deteriorated	<input type="checkbox"/> original site
<input type="checkbox"/> good	<input type="checkbox"/> ruins	<input type="checkbox"/> moved date _____
<input type="checkbox"/> fair	<input type="checkbox"/> unexposed	<input type="checkbox"/> altered

Describe the present and original (if known) physical appearance

- summary paragraph
- completeness
- clarity
- alterations/integrity
- dates

## 8. Significance

Period \_\_\_\_\_ Areas of Significance—Check and justify below

Specific dates \_\_\_\_\_ Builder/Architect \_\_\_\_\_

Statement of Significance (in one paragraph)

- summary paragraph
- completeness
- clarity
- applicable criteria
- justification of areas checked
- relating significance to the resource
- context
- relationship of integrity to significance
- justification of exception
- other

## 9. Major Bibliographical References

## 10. Geographical Data

Address of nominated property \_\_\_\_\_

Geographic name \_\_\_\_\_

USIT Reference

Verbal boundary description and justification

## 11. Form Prepared By

## 12. State Historic Preservation Officer Certification

The evaluated significance of this property within the state is

national  state  local

State Historic Preservation Officer signature

Site \_\_\_\_\_ date \_\_\_\_\_

## 13. Other

- Maps
- Photographs
- Other

Questions concerning this nomination may be directed to \_\_\_\_\_

Signed \_\_\_\_\_ Date \_\_\_\_\_ Phone: 202 272 - 3500



• Newtown Springfield MRA, Ma

• St. Joseph's Church

St. Joseph's Church #132  
Howard St.  
1"=50' Springfield MPA

UNI

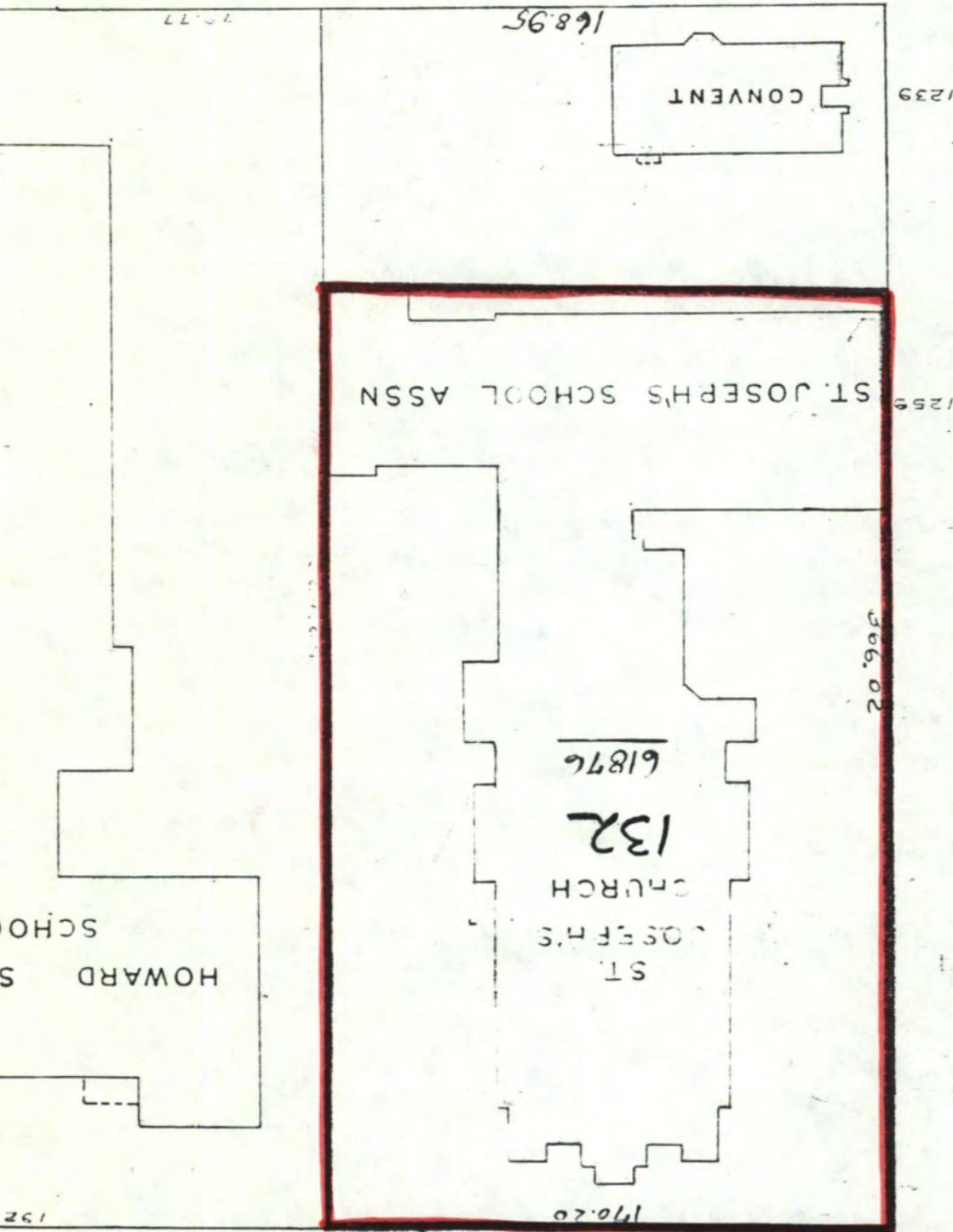

EAST COLUMBUS

303

HOWARD SCHO

HOWARD