

ARCHITECTURAL/HISTORICAL SURVEY

DAVENPORT, IOWA

The Architects Office
Wehner, Nowysz, Pottschull and Pfiffner
501 day building, Iowa city, Iowa 52240

DAVENPORT COMMUNITY DEVELOPMENT DEPARTMENT
IOWA DIVISION OF HISTORIC PRESERVATION

SITE #82-10-1352 MAP # 2

HIST. DIST. _____

NAME Peters' Barber Shop (H) C

ADDRESS 1352 W. 3rd

LEGAL DES. Cook & Sargent's Pt. lot 30
SUB-DIVISION BLOCK PARCEL SUB-PARCEL

UTM 15 7001780 45998150 ACREAGE -1 ZONE M-1
EASTING NORTHING

OWNER Edward Buchelder
2110 Mound St., Davenport, IA 52803

TITLE H. Leo S. & Mardell Byrne
(if diff)

See 3-W1354

PHOTO

SITE SHEET

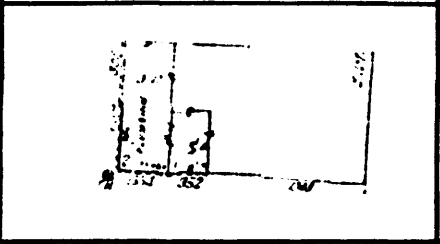

DESCRIPTION

FORM 1 story commercial block CONST. DATE 1904-05

MATERIALS Brick ARCH STYLE _____

FENESTRATION Plate glass shopfront

DIST. FEATURES Metal cornice w/decorative frieze

ALTERATIONS Shopfront modernized

SITE & RELATED STR. _____

ARCHITECTURE

STATEMENT

Proximity to the pivotal 1354 W. 3rd makes this little commercial building an integral part of the W. 3rd - Fillmore group. It is a relatively intact example of small-scale commercial architecture from the turn of the century, similar to stores found in many small (and large) Iowa communities.

SOURCES

SIGNIFICANCE

DESCRIPTION

This building was probably constructed in 1904-05 by owners of the adjacent meat market. Adolph Peters operated a barber shop from this location beginning in 1906 and other barbers occupied the shop in succeeding years. The barbershop was and is a part of a commercial intersection serving the West Third Street neighborhood.

SOURCES

City Directories, 1902-03, 1906-07, 1908, 1915.

ARCHITECTURAL HISTORIAN: Martha Bowers

HISTORIAN: MARLYS SVENSOSEN - ROESLER

SURVEY COMP 1981

EVALUATION

ARCHITECTURAL

- I. ARCH. EVALUATION Good
- II. ENVIR. STATURE Tissue
- III. INT. OF CONTEXT Good-Fair
- IV. INT. OF FABRIC Good

LEVEL OF SIGNIFICANCE:

- NAT. STATE LOCAL N. ELIG.

HISTORICAL

I. THEME(S) OF SIGNIFICANCE:

- A. PRIMARY _____
- B. SECONDARY _____

II. LEVEL OF SIGNIFICANCE:

- NAT. STATE LOCAL

III. N.R.H.P.

- ELIGIBLE NOT ELIGIBLE

HISTORIC DISTRICT CLASSIFICATION

- A. B. C

FOR DIVISION OF HISTORIC PRESERVATION USE ONLY

1. DATE RECEIVED _____

2. DATE OF STAFF EVALUATION _____

- | | | |
|---------------------------|--------------------------|--------------------------|
| | A. ARCHITECTURAL | B. HISTORICAL |
| ELIGIBLE FOR N.R.H.P. | <input type="checkbox"/> | <input type="checkbox"/> |
| NOT ELIGIBLE FOR N.R.H.P. | <input type="checkbox"/> | <input type="checkbox"/> |

3. N.R.H.P. ACTION

- A. STATE REVIEW COMM. APP. DISAPP. TABLED DATE _____
- B. FEDERAL REVIEW APP. DISAPP. TABLED DATE _____

4. D.H.P. SOURCES

- COUNTY RESOURCES
- W. SHIELD SURVEY
- N.R.H.P.
- GRANT _____
- DET. OF ELIGIBILITY
- R. & C. _____
- DAVENPORT A/H SURVEY

5. SUBJECT TRACES

6. PHOTO

ARCHITECTURAL/HISTORICAL SURVEY

DAVENPORT, IOWA

The Architects Office

Wehner, Nowysz, Pattschull and Pfiffner

801 day building, iowa city, iowa 52240

DAVENPORT COMMUNITY DEVELOPMENT DEPARTMENT
IOWA DIVISION OF HISTORIC PRESERVATION

82 - 10 - 1352

Legal Description:

Part of the Northeast Quarter of Section 34, Township 78 North, Range 3 East of the 5th P.M., being more particularly described as follows: Commencing as a point of reference at the Southwest corner of lot 30, Cook & Sargent's Addition to the City of Davenport, Iowa; thence East 25 feet more or less along the South line of lot 30 to the Point of Beginning; thence East 20 feet more or less along the South line of lot 30; thence North 35 feet more or less; thence West 20 feet more or less; thence South 35 feet more or less to Point of Beginning.

CONTINUATION