

KENTUCKY HISTORIC RESOURCES INVENTORY

Site No. JF 671

1. Historic Name(s) The Midlands
 Original Owner Mrs. Morris Belknap

2. Present Name
The Midlands

3. Location
25 Poplar Hill Rd, Louisville, Ky. 40207

4. Owner's Name
Rodney & Margaret W. Henderson

5. Owner's Address
25 Poplar Hill Rd, Lou. 40207

6. Open to Public Yes No 7. Visible from road Yes No 8. Ownership Private Local State Federal

9. Local Contact/Organization Jefferson County Office of Historic Preservation and Archives

22. ADD/County Jefferson/Jefferson 05 16

23. U.S.G.S. Quadrant (15'/75') Jeffersonville, Ind. 08 16 G.I.S. Mod.

24. UTM Reference 16 6, 17, 0, 00 42, 38, 9, 0, 0
 Zone Easting Northing

25. Coordinate Accuracy

26. Prehistoric Site Object
 Historic Site Structure
 Building Other

27. National Register District Name:

28. Significance Evaluation Meets N.R. criteria d

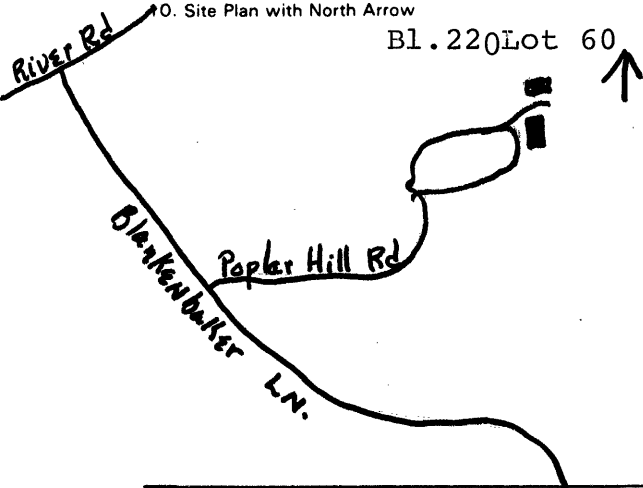

11. Architect E.T. Hutchings

12. Builder

13. Date 1913-15 A. 6 B.

14. Style A. Georgian Rev. 23
 B.

15. Original Use Single Fam. Res. 1

16. Present use Single Fam. Res.

17. Condition excellent 1

No. Stories three d

Single Pile NA Double Pile

Floor Plan other 0

Structural Fabric Brick A. c B.

Decorative Fabric Flemish bond A. g
varient B.

Roof Form hipped

29. Status Date

National Landmark

National Register

Landmark Certificate

Kentucky Survey

Local Landmark

HABS/HAER

30. Historic Theme Primary architecture 3
 Secondary
 Other

31. Endangered Yes No

32. Preservation Project Status

Actual Cost in \$1,000s

18. Description see next page

(Continue on Back)

33. ATTACH PHOTO

Roll No. _____

Picture No. _____

Direction _____

34. Prepared by:
Mary Jean Kinsman

35. Organization Historic Preservation and Archives J

36. Date 1983

37. Revision Dates _____ 38. Staff Review _____

19. History see next page

20. Significance see next page

21. Source of Information see next page

18. Description

The Belknap house is a three-story, brick structure with a hipped roof, dormers, and large exterior chimneys. The asymmetrical massing is emphasized by the arrangement of bays and chimneys on the front facade. The entry which has a vestibule flanked by small closets, is sheltered by a heavy portico with paired Doric columns. On the rear elevation, a smaller portico is topped by a Palladian window. The brickwork is a variation of Flemish bond, having two stretchers alternating with each header. The interior has classical details used in a restrained manner. These include crown moldings, paneled wainscoting, and reeded pilasters. At the east end of the house is a brick-walled, terrace garden and gazebo. A two-story brick garage and servants' house is west of the house.

A series of photographs taken during construction of the house (1913-14) indicate that few, if any changes have been made to the exterior. A pergola once stood in front of the service wing at the west end of the house. The present site of about six acres (the estate originally contained about 50 acres) includes a large expanse of lawn, the original circular driveway, and large trees and other plantings.

19. History

The Midlands was built in 1913-14 for Marion Dumont Belknap, widow of Colonel Morris B. Belknap, well-known Louisville businessman and civic leader who died in 1910. According to family history, Mrs. Belknap and three of Colonel Belknap's adult children from his first marriage bought land from the nearby estate of Colonel Belknap's brother, William R. Belknap, (see JF531) and built this house. A series of photographs chronicled the construction of the house from 1913, when the foundation was laid, to 1915 when the house and landscaping were completed.

Mrs. Belknap selected the Louisville architectural firm of J.B. Hutchings and Sons to design the house. Family tradition attributes the design specifically to one of the sons, Eusebius T. Hutchings (1886-1958). However, this cannot be documented since no plans or records of the Hutchings firm have survived. John Bacon Hutchings (1859-1916) and his son, Eusebius, designed numerous fine residences for prominent Louisville families. A number of their early 20th-century houses were built in the hills along the Ohio River. (see JF 546, JF 547, and JF 551 - Glenview Historic District.) Their work encompassed a wide range of Revival styles and motifs, including Georgian, Tudor, and Colonial, with frequent use of Arts and Crafts details.

After Mrs. Belknap's death in 1966 the house was sold and most of the land was subdivided.

20. Significance

The Midlands is significant architecturally as an example of an early 20th-century country house in a Georgian Revival style, and as the work of one of Louisville's outstanding architectural firms. The six-acre site retains a rural ambience. The Midlands illustrates the early 20th-century phenomenon whereby Louisville's well-to-do, aided by improved rail transportation and the private motor car, found a "country" life in the city's farthest suburbs possible. As its English-sounding name implies, this estate was meant to capture a style of living not found in the city's center (though Belgravia and St. James succeeded in producing an urban counterpart).

21. Source of Information

Jefferson County (Ky.) Deed Books; Will Books.

Interview with Mrs. Arthur G-T Courteau, 17 March 1983.

Belknap Family Photograph Album, 1911-1918. Owned by Mrs Arthur G-T Courteau.

Colonel Morris B. Belknap obituary. The (Louisville) Courier-Journal, 14 April 1910, p. 1.

KENTUCKY HISTORIC RESOURCE INVENTORY SUPPLEMENT
BOUNDARY AND LOCATION INFORMATION

Historic Property Name The Midlands Site # JF-671

Multiple Resource/Thematic Nomination Title Jefferson County, Ky MRA

U.T.M. Coordinates - List multiple UTMs if property is ten or more acres.

A. 16 617000 4238900 D. _____

B. _____ E. _____

C. _____ F. _____

Verbal Boundary Description _____ Acreage 6.18

The nominated property comprises all of Lot 60 in _____ County Block 220 of the Jefferson County Property Valuation Administrator: approximately 6.18 acres.

Sketch of Site Plan (Showing outbuildings, structures, landscape features and the site boundary as described above.)

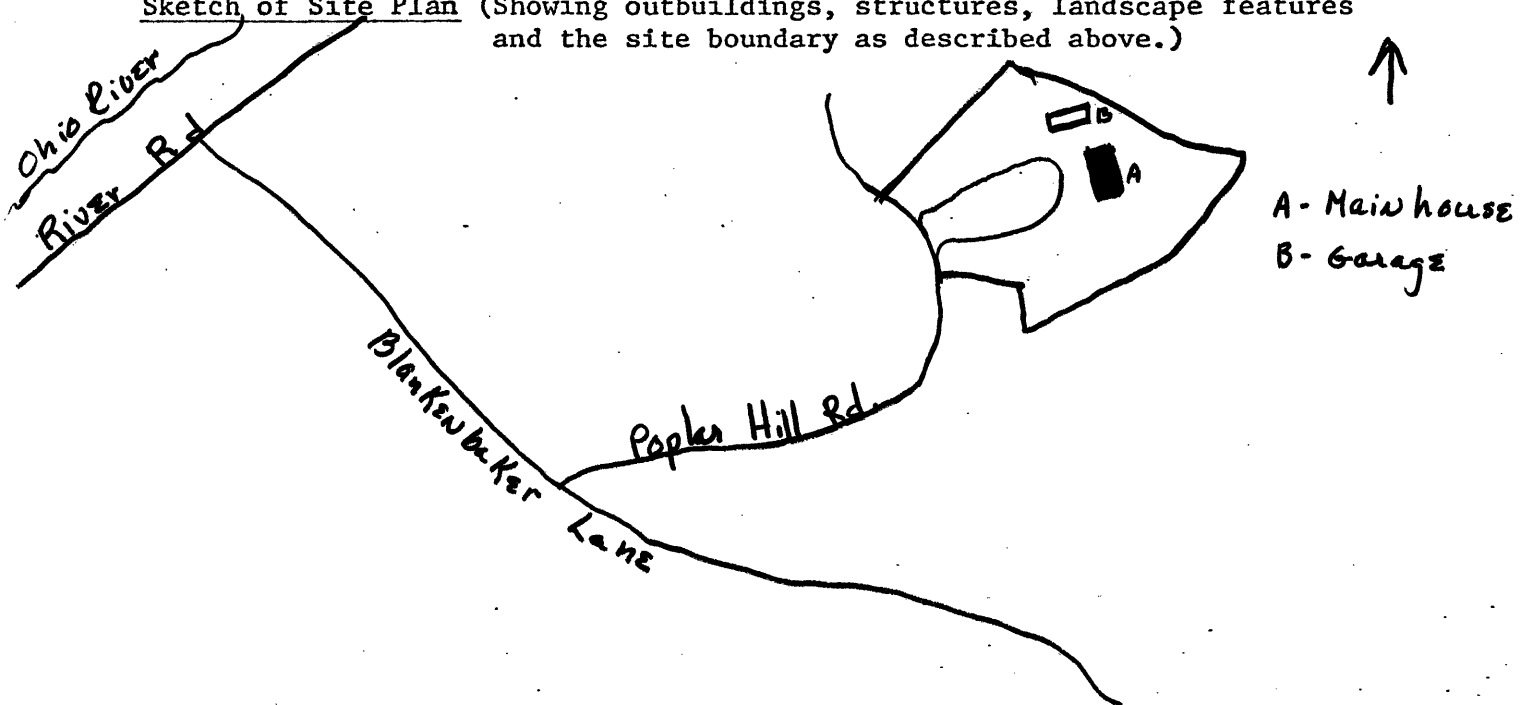

Official Courthouse Property Reference:

Description as recorded in Deed Book 5330 page 669, January 1983.