

MONTCLAIR MRA, MONTCLAIR, ESSEX COUNTY, NJ (Representative Styles)
NEW JERSEY OFFICE OF CULTURAL AND ENVIRONMENTAL SERVICES
HISTORIC PRESERVATION SECTION
INDIVIDUAL STRUCTURE SURVEY FORM

HISTORIC SITES INVENTORY NO. 0713 881

HISTORIC NAME:
LOCATION: 52 Wayside Place
MUNICIPALITY: Montclair
USGS QUAD: Orange
OWNER/ADDRESS: Paisley, David M. & Nancy
See above

COMMON NAME: Paisley house
BLOCK/LOT: 1102/39: 54-G/5
COUNTY: Essex
UTM REFERENCES: Zone/Northing/Easting

DESCRIPTION

Construction Date: 1930 Source of Date: Tax Assessor
Architect: Arthur E. Ramhurst Builder:
Style: Spanish Revival Form/Plan Type: L shape
Number of Stories: 2 + B
Foundation: Stucco
Exterior Wall Fabric: Stucco
Fenestration: 7 bays; paired multi-light casement windows.
Roof/Chimneys: Low pitched hip & gable to the front/red tile; exterior chimney south-east corner.

Additional Architectural Description:

Bays 1 - 4 show 2nd floor wall recessed back w/ paired casement windows; 1st floor roof extends below w/ large single light window in the 4th bay.
Bay 5 extends slightly forward w/ low pitched gable; double entrance door, wrought-iron work in transom below compound arched portal, foliated motif in spandrels & deep console brackets on either side below denticulated stone cornice w/ ornamental decorative panel above.
Paired 2nd floor casement shows wide surround & forms curvilinear motif above; rope-like molding on colonettes around the entrance.
Recessed vertical panels flanking entrance show raised circular motif.
Bays 5 & 6 recessed back, rope molded columns w/ enriched capitals form open loggia, extends in front & wraps around the south elevation.

PHOTO Negative File No. R83, 19

Map (Indicate North)

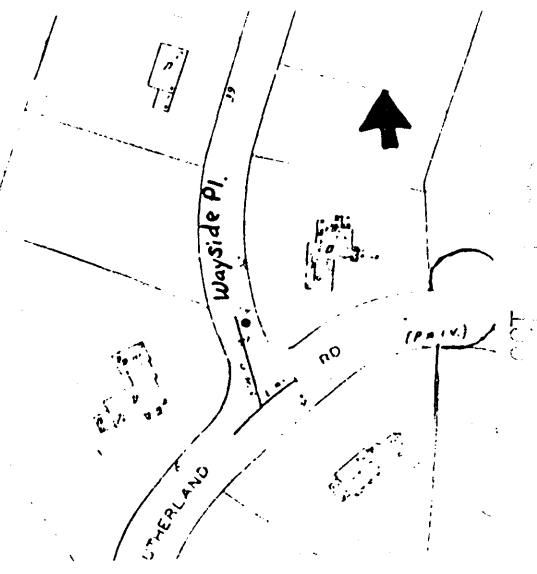

HISTORIC PRESERVATION SECTION, 109 WEST STATE STREET, TRENTON, NEW JERSEY 08625 (609) 292-2023

SITING, BOUNDARY DESCRIPTION, AND RELATED STRUCTURES:

House close to north property line near the street on extensive 168' x 186' corner lot; well laid out terrace to the east.

Less than one acre.

SURROUNDING ENVIRONMENT: Urban Suburban Scattered Buildings
Open Space Woodland Residential Agricultural Village
Industrial Downtown Commercial Highway Commercial Other

SIGNIFICANCE:

The delicate carving around the entrance portal & the open loggia w/ its rope-like molding on the slender columns are just some of the unusual details that distinguish this well designed Spanish residence. The home is unusual both in style and proportion for the Stonebridge Road neighborhood.

The original owner was Harrow P. Harrsen. A photograph of this house appeared in the publication "Montclair, Glen Ridge and Verona", The Montclair Times Co., 1939.

The Spanish Revival was another period style for the American Suburban home, popular throughout the country in the late 1920's and '30's. Never as popular here as the Tudor or Colonial Revival styles, only a few Spanish-type houses were built in Montclair. This is one of the finest examples of the style.

ORIGINAL USE: Residence
PHYSICAL CONDITION: Excellent Good Fair Poor
REGISTER ELIGIBILITY: Yes Possible No Part of District
THREATS TO SITE: Roads Development Zoning Deterioration
No Threat Other

COMMENTS:

REFERENCES:

Franklin Survey Company. Atlas of Montclair, Glen Ridge, Cedar Grove & Verona, 1933.

RECORDED BY: Eleanor Price DATE: 6/16/81
ORGANIZATION: Preservation Montclair

Form revised by Eleanor Price, November 14, 1984.

Montclair, Glen Ridge, Verona
A Story in Pictures
The Montclair Times Co., 1939
p. 31

Thematic Listing: Montclair Architecture, Representative Styles

7-278



RESIDENCE OF H. P. HARSEN
52 WAYSIDE PLACE (0713-8813)



RESIDENCE OF MRS. DONALD CHRISTOPHER
63 UNDERCLIFF ROAD