

3052

UNITED STATES DEPARTMENT OF THE INTERIOR  
NATIONAL PARK SERVICE

**NATIONAL REGISTER OF HISTORIC PLACES  
INVENTORY -- NOMINATION FORM**

FOR FEDERAL PROPERTIES

FOR NPS USE ONLY

RECEIVED NOV 22 1988

DATE ENTERED

SEE INSTRUCTIONS IN *HOW TO COMPLETE NATIONAL REGISTER FORMS*  
TYPE ALL ENTRIES -- COMPLETE APPLICABLE SECTIONS

**1 NAME**

HISTORIC Hospital Reservation Historic District

AND/OR COMMON

**2 LOCATION**

STREET & NUMBER See individual inventory forms

NOT FOR PUBLICATION  
CONGRESSIONAL DISTRICT

CITY, TOWN Bremerton

VICINITY OF

STATE Washington

CODE

COUNTY Kitsap

CODE

**3 CLASSIFICATION**

CATEGORY	OWNERSHIP	STATUS	PRESENT USE	
<input checked="" type="checkbox"/> DISTRICT	<input checked="" type="checkbox"/> PUBLIC	<input checked="" type="checkbox"/> OCCUPIED	<input type="checkbox"/> AGRICULTURE	<input type="checkbox"/> MUSEUM
<input type="checkbox"/> BUILDING(S)	<input type="checkbox"/> PRIVATE	<input type="checkbox"/> UNOCCUPIED	<input type="checkbox"/> COMMERCIAL	<input type="checkbox"/> PARK
<input type="checkbox"/> STRUCTURE	<input type="checkbox"/> BOTH	<input type="checkbox"/> WORK IN PROGRESS	<input type="checkbox"/> EDUCATIONAL	<input type="checkbox"/> PRIVATE RESIDENCE
<input type="checkbox"/> SITE	<b>PUBLIC ACQUISITION</b>	<b>ACCESSIBLE</b>	<input type="checkbox"/> ENTERTAINMENT	<input type="checkbox"/> RELIGIOUS
<input type="checkbox"/> OBJECT	<input type="checkbox"/> IN PROCESS	<input checked="" type="checkbox"/> YES: RESTRICTED	<input type="checkbox"/> GOVERNMENT	<input type="checkbox"/> SCIENTIFIC
Thematic Group	<input type="checkbox"/> BEING CONSIDERED	<input type="checkbox"/> YES: UNRESTRICTED	<input type="checkbox"/> INDUSTRIAL	<input type="checkbox"/> TRANSPORTATION
	N/A	<input type="checkbox"/> NO	<input checked="" type="checkbox"/> MILITARY	<input type="checkbox"/> OTHER:

**4 AGENCY** Department of Defense/United States Navy

REGIONAL HEADQUARTERS: (If applicable) Puget Sound Naval Shipyard

STREET & NUMBER N/A

CITY, TOWN Bremerton

VICINITY OF

STATE Washington 98314

**5 LOCATION OF LEGAL DESCRIPTION**

COURTHOUSE, REGISTRY OF DEEDS, ETC. Kitsap County Courthouse

STREET & NUMBER 614 Division Street

CITY, TOWN Port Orchard

STATE Washington 98366

**6 REPRESENTATION IN EXISTING SURVEYS**

TITLE Historic Survey of Puget Sound Naval Shipyard

DATE April, 1986  FEDERAL  STATE  COUNTY  LOCAL

DEPOSITORY FOR SURVEY RECORDS Puget Sound Naval Shipyard

CITY, TOWN Bremerton

STATE Washington 98314

# 7 DESCRIPTION

CONDITION		CHECK ONE	CHECK ONE
<input checked="" type="checkbox"/> EXCELLENT	<input type="checkbox"/> DETERIORATED	<input checked="" type="checkbox"/> UNALTERED	<input checked="" type="checkbox"/> ORIGINAL SITE
<input checked="" type="checkbox"/> GOOD	<input type="checkbox"/> RUINS	<input checked="" type="checkbox"/> ALTERED	<input type="checkbox"/> MOVED      DATE _____
<input type="checkbox"/> FAIR	<input type="checkbox"/> UNEXPOSED		

DESCRIBE THE PRESENT AND ORIGINAL (IF KNOWN) PHYSICAL APPEARANCE

The Hospital Reservation Historic District is located in the northwesterly section of the Puget Sound Naval Shipyard west of the Radio Station and Officers' Row Historic Districts and east of the Marine Reservation Historic District. The facility was established at this location in 1909. At its period of maximum historical development (the last major hospital building was constructed in 1942), the district contained the following major buildings in addition to those included in this nomination. The properties in this list no longer remain:

- (1) Main Hospital Building (1911,1924): two story with basement brick complex with Neo-Classical detailing.
- (2) Recreation building (1920): two story vernacular wood frame structure with basement; to the west was a yard cemetery which was relocated to the Presidio in San Francisco, California.
- (3) Navy Female Nurse Corps Quarters (1921): two story wood frame vernacular structure.
- (4) Three Isolation Buildings (1915): their design is unknown. They were located to the east of the main hospital building. Other smaller buildings were constructed in this area and all (except for one isolation building) were eventually connected to the main hospital building.

The six buildings located within this district were historically the quarters for the Commanding Officer of the Naval Hospital Reservation, the dormitory for the hospital corpsmen, the sick officers quarters, quarters for the medical corps and two separate quarters for pharmacists. The dormitory for hospital corpsmen and the sick officers quarters are the two surviving buildings of the main hospital complex and are sited in a suburban setting of lawn and shrubs with adjacent parking lots. The remaining four quarters are sited with yard space of lawn, native trees and shrubs.

With the exception of Quarters W (Facility No. 646), which is a wood frame building with Neo-Classical influences, the buildings located in this district are of brick construction with distinctive Georgian Revival composition and detail. The feeling and association related to the Hospital Reservation Historic District has been compromised in part by major alterations to the original utility building for the hospital (Facility No. 437, 1936), also located within the district area, and two newer (post World War II) quarters buildings (Nos. 885 and 942).

**8 SIGNIFICANCE**

PERIOD	AREAS OF SIGNIFICANCE -- CHECK AND JUSTIFY BELOW			
<input type="checkbox"/> PREHISTORIC	<input type="checkbox"/> ARCHEOLOGY-PREHISTORIC	<input type="checkbox"/> COMMUNITY PLANNING	<input type="checkbox"/> LANDSCAPE ARCHITECTURE	<input type="checkbox"/> RELIGION
<input type="checkbox"/> 1400-1499	<input type="checkbox"/> ARCHEOLOGY-HISTORIC	<input type="checkbox"/> CONSERVATION	<input type="checkbox"/> LAW	<input type="checkbox"/> SCIENCE
<input type="checkbox"/> 1500-1599	<input type="checkbox"/> AGRICULTURE	<input type="checkbox"/> ECONOMICS	<input type="checkbox"/> LITERATURE	<input type="checkbox"/> SCULPTURE
<input type="checkbox"/> 1600-1699	<input type="checkbox"/> ARCHITECTURE	<input type="checkbox"/> EDUCATION	<input checked="" type="checkbox"/> MILITARY	<input type="checkbox"/> SOCIAL/HUMANITARIAN
<input type="checkbox"/> 1700-1799	<input type="checkbox"/> ART	<input type="checkbox"/> ENGINEERING	<input type="checkbox"/> MUSIC	<input type="checkbox"/> THEATER
<input type="checkbox"/> 1800-1899	<input type="checkbox"/> COMMERCE	<input type="checkbox"/> EXPLORATION/SETTLEMENT	<input type="checkbox"/> PHILOSOPHY	<input type="checkbox"/> TRANSPORTATION
<input checked="" type="checkbox"/> 1900-	<input type="checkbox"/> COMMUNICATIONS	<input type="checkbox"/> INDUSTRY	<input type="checkbox"/> POLITICS/GOVERNMENT	<input type="checkbox"/> OTHER (SPECIFY)
		<input type="checkbox"/> INVENTION		

SPECIFIC DATES 1923 - 1942

BUILDER/ARCHITECT See individual forms

## STATEMENT OF SIGNIFICANCE

The Hospital Reservation Historic District is significant because it contains the only pre-World War II buildings representative of this function within the Puget Sound Naval Shipyard Shore Facility. Constructed between 1923 and 1942, the buildings in this district symbolize the United States traditional commitment to adequate medical care and to the Navy Department's need to provide adequate housing for those who perform that function.

Medical service was first established at the Puget Sound Naval Shipyard in 1895, when Past Assistant Surgeon General James Stoughton set up Sick Quarters aboard the U.S.S. Nipsic. This ship was used as offices and quarters while permanent buildings were being constructed on land. In 1901, the Surgeon General recommended that a hospital building be built at the yard as the closest one was located in Seattle. Construction began the following year and by 1903, the shipyard had a two-story sixteen bed hospital. It was located west of Drydock No. 1 and south of the original location of the Marine Reservation. By 1907, the Surgeon General was requesting the removal of this hospital from its location so close to the industrial yard because of the outbreak of contagious diseases among yard personnel and workers. "A site was chosen atop the western ridge for a new hospital, but ambitious plans had to be modified before work finally began in 1909. The brick hospital, consisting of three buildings connected by solarium, was completed in January 1911, but was not opened until the following January when funds became available to equip it." (Reh. Vol.I,p.27) The older building was moved into Bremerton.

This hospital building became the focal point for the Hospital Reservation. Between World War I and World War II, an array of buildings reflecting the needs of medical service were constructed. These included a recreation hall constructed by the American Red Cross for the Naval Hospital (1920), nurses quarters (1921), quarters for the Commanding Officer of the Hospital Reservation (1923), the medical officers (1923), pharmacists (1926) and hospital corpsmen (1936) and sick officers quarters (1942). The hospital building itself was also enlarged during this period of time. The construction of personnel and officers quarters was considered essential to the navy's ability to provide good medical care. Prior to 1921, the nurses were living a mile outside the yard in a building which contained a motion picture theater and billiard hall. Medical officers were refusing commissions in the navy because of the lack of suitable housing. At Puget Sound, they were living in basement rooms in Bremerton or were commuting from Seattle,

The expansion of the Hospital Reservation paralleled the expansion of needed medical services at the shipyard. When the first hospital building was constructed in 1903, there had been only one death at the yard due to the unwise consumption of wood alcohol. Medical service only applied to shipyard workers, personnel on the receiving ship and

# 9 MAJOR BIBLIOGRAPHICAL REFERENCES

See thematic group nomination form.

## 10 GEOGRAPHICAL DATA

Bremerton West quadrangle Scale is 1:24000

ACREAGE OF NOMINATED PROPERTY 12.0

UTM REFERENCES

A	[1,0]	[5 2,6 7,0,0]	[5,2 6,7 6,8,0]	B	[1,0]	[5 2,6 8,8,2]	[5,2 6,7 6,8,0]
	ZONE	EASTING	NORTHING		ZONE	EASTING	NORTHING
C	[1,0]	[5 2,6 8,4,0]	[5,2 6,7 2,8,0]	D	[1,0]	[5 2,6 7,2,2]	[5,2 6,7 2,8,0]
	ZONE	EASTING	NORTHING		ZONE	EASTING	NORTHING

### VERBAL BOUNDARY DESCRIPTION

The Hospital Reservation Historic District is located to the east of the Marine Reservation Historic District with road access along Dewey Street. The northern boundary is approximately Mahan Avenue, the northern boundary of the yard. The properties are located within the following Puget Sound Naval Shipyard grid references: E 36, E 38, F 36, I 36 and J 37.

### LIST ALL STATES AND COUNTIES FOR PROPERTIES OVERLAPPING STATE OR COUNTY BOUNDARIES

STATE	CODE	COUNTY	CODE
N/A			

## 11 FORM PREPARED BY

NAME / TITLE

Caroline Gallacci and August Gene Grulich

ORGANIZATION

Grulich Architecture and Planning

DATE

September, 1986

STREET & NUMBER

707 Court A

TELEPHONE

(206) 272-0007

CITY OR TOWN

Tacoma

STATE

Washington 98402

## 12 CERTIFICATION OF NOMINATION

STATE HISTORIC PRESERVATION OFFICER RECOMMENDATION

YES

NO

NONE

STATE HISTORIC PRESERVATION OFFICER SIGNATURE

In compliance with Executive Order 11593, I hereby nominate this property to the National Register, certifying that the State Historic Preservation Officer has been allowed 90 days in which to present the nomination to the State Review Board and to evaluate its significance. The evaluated level of significance is  National  State  Local.

FEDERAL REPRESENTATIVE SIGNATURE F.S. STERNS, DIR., INSTALLATIONS & FACILITIES, OASN (S&L)

TITLE

*F. S. Sterns*

DATE

11-15-88

FOR NPS USE ONLY

I HEREBY CERTIFY THAT THIS PROPERTY IS INCLUDED IN THE NATIONAL REGISTER

*Antoinette A. Lee*

DATE

7/16/90

DIRECTOR, OFFICE OF ARCHEOLOGY AND HISTORIC PRESERVATION

ATTEST:

DATE

*for* KEEPER OF THE NATIONAL REGISTER

UNITED STATES DEPARTMENT OF THE INTERIOR  
NATIONAL PARK SERVICE

**NATIONAL REGISTER OF HISTORIC PLACES  
INVENTORY -- NOMINATION FORM**

<b>FOR NPS USE ONLY</b>	NOV 22 1988
RECEIVED	
DATE ENTERED	

Hospital Reservation Historic District: Puget Sound Naval Shipyard Shore Facility

**CONTINUATION SHEET**

ITEM NUMBER 8 PAGE 8.1

on the Marine Reservation. In 1907, only 225 patients were treated. By 1920, the number had increased to 1,515. By World War II, medical treatment had expanded to navy personnel and their dependents stationed throughout the Puget Sound region. The Hospital Reservation continued to perform this function as a part of the naval shore facility until 1980. At that time a new hospital was established outside the boundaries of the Puget Sound Naval Shipyard at Jackson Park. Over time, the brick hospital building, as well as other hospital-related buildings constructed prior to World War II, have been demolished.

# PSNS INVENTORY

# HISTORIC SURVEY PUGET SOUND NAVAL SHIPYARD

Historic Name

HOSPITAL CORPSMEN  
DORMITORY

NOV 22 1998

Facility No.

443

NAME OF STRUCTURE SECURITY OFFICE & TRAINING FACILITY

Construction Date 1936

Alterations/Additions

Uses: Original Dormitory for Hospital Corpsmen

(Remod-52, EM Barracks; 54, toilet; 69, repairs; 83, repairs)

WWII

Present Security Office & Training Fac.

DESIGNED BY PUGET SOUND NAVY YARD

DATE 1936

DESCRIPTION:

Condition Good

Altered No

Original Site Yes



Building 443 is a two story brick veneer building with basement. The building measures 115 feet by 56 feet in a rectangular shape with two projecting bays on either side of the central entry. The building is clad in a redish brown brick with a running bond pattern. Between the upper and lower windows a decorative brick pattern in the form of a square surrounds a small cast stone inset. The brick walls rest on a concrete base which forms the basement. Windows are double-hung wood units with 8 over 8 lights. The main entry doors have been replaced with an aluminum storefront entry. Above the entry is a wood double "french door" with semi-circular fanlight and with a wrought iron balcony railing. The gable walls meet the roof in a classical form of broken pediment.

The interior is plaster walls and partitions, carpet over concrete floors and acoustical tile ceilings. The entry has ceramic tile floor and wainscot. The second floor has carpeted halls with VAT in offices, gypsum wallboard and plaster partitions and acoustical tile ceilings.

The building was designed and constructed as a dormitory for hospital corpsmen and later converted to an enlisted mens barracks and finally into a security office and training facility.

N

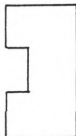

SIGNIFICANCE:

1. 2. x 3. 4.

Period 1900-

Area of Significance Military

Building 443 is one of two surviving buildings of the Naval Hospital Reservation at the Puget Sound Naval Shipyard. It is the oldest of the two structures constructed in 1936. Building 443 is similar in design to the other surviving building, Building 491, and is consistent with the design of the Hospital Complex. The design of Building 443 and the major buildings of the Hospital Complex is one in which "Federal" design elements are employed. Building 443 exhibits these "Federal" design elements within a stately and conservative composition which emphasizes symmetry and balance.

Building 443 was designed as the dormitory for the Hospital Corpsmen located at the northwest corner of the Naval Hospital Reservation. Its design reflects the "Federal" influence of the major buildings of the Hospital Complex. It was designed in 1936 by the Puget Sound Navy Yard under the direction of Public Works Officers, Captain R.M. Warfield, U.S.N. and Captain E.R. Gayler, U.S.N.

(cont'd on back)



Negative No.  
SP 85-00992-443

Acreage:  
less than 1  
Verbal Boundary  
Description:  
Between Mahan  
Ave. & Ambler  
Dr. & between  
Dewey St. & Bldg  
437.

Facility  
No.

443

LOCATION :

PSNS  
GRID  
E 36

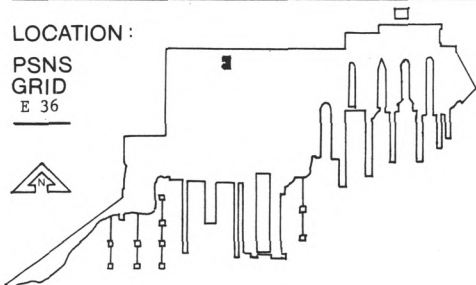

UTM Zone	Easting	Northing
10	526713	5267616
Quadrangle Bremerton West		
scale 1:24,000		

## CONTINUATION of SIGNIFICANCE

Building 443 began as a dormitory for Hospital Corpsmen which it was during World War II. It remained a Corpsmen dormitory until the Naval Hospital Reservation was relocated. At that time it was converted to office space for use by the Security Office. The exterior has remained unaltered. The interior has experienced extensive alterations for its current use. The building is well maintained.

# PSNS INVENTORY

# HISTORIC SURVEY PUGET SOUND NAVAL SHIPYARD

Historic Name

SICK OFFICER'S QUARTERS

NW 22 1996

Facility No.

491

NAME OF STRUCTURE SAFETY AND ENVIRONMENTAL HEALTH OFFICE

Construction Date 1942

Alterations/Additions

Uses: Original Sick Officers Quarters

(Remod-50, galley; 56; 68, roof; 74, data process; 80, equip; 84, ADP area)

WWII

Present Safety & Environment Health Offices

DESIGNED BY PUGET SOUND NAVY YARD, BREMERTON WASHINGTON

DATE 1942

DESCRIPTION :

Condition Good

Altered No

Original Site Yes



Building 491 is a three story brick veneered building over structural steel frame with concrete slab floors. The building measures 169 feet by 40 feet with two projecting bays on the southeast elevation. The main entry on the southeast elevation is cast stone with a classical pediment with arched cornice. The brick veneer is running bond with projecting clinker brick forming a decorative pattern. Early windows appear to be wood double-hung sash with 24 over 24 lights and most have been replaced with 4 lights awning units with center units operable. Windows on the ground floor have cast stone lintels and sills with 2nd floor windows with flat brick arches with stone keystones. On the 3rd floor window heads are lintels with a brick soldier course. A porte cochere is at the west end of the building.

The interior of building 491 has been remodeled from quarters to offices and laboratories. Walls are plaster or gypsum wall board, carpet on hallway floors with sheet vinyl in offices over concrete slabs. Acoustic tiles have been applied to the ceiling.

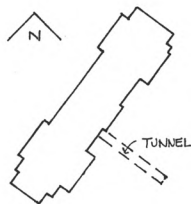

SIGNIFICANCE :

Period 1900-

Area of Significance Military

1. 2. x 3. 4.

Building 491 is one of two surviving buildings of the Naval Hospital Reservation at the Shipyard. Constructed in 1942, it is the newest of the two buildings. Building 491 was originally the Sick Officers Quarters of the Hospital, located adjacent to and connected, via a tunnel, to the Hospital Complex of wards. Building 491 reflects the design of various Hospital Buildings with its "Federal" design elements.

The building was constructed in 1942 employing the same style as the main buildings of the Hospital Complex. The design was the product of the Puget Sound Navy Yard under the direction of Public Works Officers, Captain R.E. Thomas, U.S.N. and Captain C. Phillips, U.S.N. The design included "Federal" details of classical pediments, brick exterior and classical symmetry. The unique design of wood sided 'dayrooms' over a porte-cochere at the southern end of the building maintains the classical details of the "Federal" influenced design.

(cont'd on back)





Negative No.  
SP 85-00992-491

Acreage:  
less than 1  
Verbal Boundary  
Description:  
Bounded by Dewey  
St., Ambler Dr.  
& Gatewood Ave.



Facility  
No.  
491

LOCATION :

PSNS  
GRID  
F 36

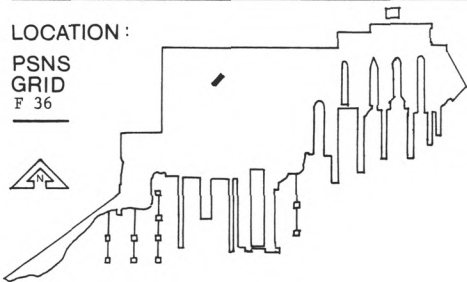

UTM Zone	Easting	Northing
110	526718	5267575

Quadrangle Bremerton West  
scale 1:24,000

## CONTINUATION of SIGNIFICANCE

Building 491 remained as the Sick Officers Quarters or Sick Officers Ward until after the end of World War II. It was converted into its present use as the Safety and Environmental Health Office when the Hospital was relocated to its present site outside the shipyard property. The conversion resulted in significant alterations to the interior. However, the exterior has remained unchanged with the exception of a majority of replacement windows. The building has been well maintained.

# PSNS INVENTORY

# HISTORIC SURVEY PUGET SOUND NAVAL SHIPYARD

Historic Name

QUARTERS V

NOV 22 1960

 Facility  
No.

644

 NAME OF STRUCTURE OFFICER'S QUARTERS (V) & GARAGE 645

 Construction Date 1923

Alterations/Additions

 Uses: Original Officers Quarters

 (Remod-47,bath;48,kit,elect;50,rear stair;  
68,roof;79,repair)

 WWII Officers Quarters

 Present Officers Quarters

 DESIGNED BY NAVY YARD PUGET SOUND WASHINGTON

 DATE 1923

DESCRIPTION:

 Condition Excellent Altered No Original Site Yes

Officer's Quarters(V) is a two story brick structure, measuring 89 feet by 56 feet, and including an attic and basement. The building contains four residences. The building has a Jerkinhead Style roof with hip roof dormers and covered in composition shingles. The building exhibits "Georgian" detailing with windows having brick flat arches with limestone keystones and limestone sills. The windows are double-hung wood sash within wood frames with 6 over 1 lights. The main entry door is white painted wood and glass set within a semi-circular arched opening. The arch contains limestone keystone and limestone imposts. The doorway follows the "Palladian" motif of a central door with side lights on each side.

The interior of Building (V) 644 is divided into four units (2 over 2) , two stairways provide access to two units each with a common back stair to all units. The main entries floors are marble with terrazzo insets. The floors are fir, walls are plaster on wood lath. The foyer door trims are decorated. Decorated trim also is in living room and dining room. Door trim elsewhere is plain. Glass french doors separate living room from dining room. Ceilings are 9 feet. The living room has a fireplace surround of brick, quarry tile hearth and simple wood mantle. Baths have hexagonal tiled floors and tile wainscot. Pedestal sinks are in Units A,B,C&D. Kitchens and pantries have painted cabinets with glass doors above and wood panels below.

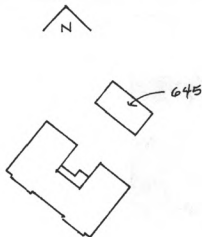

SIGNIFICANCE:

 1.  2.  3.  4. 

 Period 1900- Area of Significance Military

Building 644 was constructed in 1923 as an Apartment House for the Medical Corps. Providing quarters for four Medical Officers. The building was the first Officers Quarter for medical personnel with the exception of the Doctor in-Charge of the Hospital. The design reflects the "Federal" influences exhibited in the other Hospital buildings.

The design of Building 644 is similar to the design of the earlier four-plex designed for the Marine Reservation in 1914. Designed by the Puget Sound Navy Yard under the direction of Public Works Officer, E.R. Gayler, U.S.N., this building reflects "Federal" influences in its design with "Georgian" details. The building exhibits asymmetrical entries on its side and a symmetrical design front and rear. (cont'd on back)



Negative No.  
 SP 85-00992-644  
 SP86-01720-644-9

Acreage:  
 Less than 1  
 Verbal Boundary  
 Description:

Between Long-  
 shaw Dr. and  
 Dewey St. N.W.  
 of Bldg. 646  
 central area of  
 the Yard.

Facility  
 No.

644/645

LOCATION :

PSNS  
 GRID

I 36

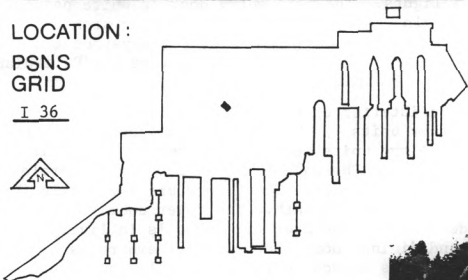

UTM Zone	Easting				Northing		
10	5	2	6	7	8	2	5
	2	6	7	3	5	2	

Quadrangle Bremerton West  
 scale 1:24,000



**CONTINUATION of SIGNIFICANCE**

The interior maintains the details associated with the "Federal" influences.

The building remained Medical Officers Quarters until the Hospital was relocated, at which time the quarters were assigned to Officers of the shipyard. The building experienced several modernizations which included electrical wiring and plumbing. It also received repair of the roof and the rear wooden stairs which serves each unit of the four-plex. The building has been well maintained and is in good repair.

Historic Name	Facility No.
QUARTERS W	646

NAME OF STRUCTURE OFFICER'S QUARTERS (W) & GARAGE 647  
 Construction Date 1923 Alterations/Additions \_\_\_\_\_  
 Uses: Original Quarters W for Com Off Naval Hosp (Remod-47, kit & bath; 50 porte  
 WWII Officers Quarters cohère; 50, elect; 61, roof;  
 Present Officers Quarters 79, whole house)

DESIGNED BY NAVAL YARD PUGET SOUND WASHINGTON DATE 1923

DESCRIPTION: Condition Good Altered No Original Site Yes



Officer's Quarters (W) is a two story wood frame residence with attic and basement. A gable roof is clad in composition shingles. The siding is 6 inch bevel siding painted white. The building has an irregular shape and measures 76 feet by 36 feet. On the south elevation, there is a wood frame porte cohère supported by 8 inch square columns resting on brick plinths incorporated in a garden wall.

Windows are rectangular, wood sash and frame, double-hung units with 6 over 1 lights. A semi-circular window is located within the gable end wall. Semi-circular arched openings at an entry porch respond to the semi-circular window above. A sun room on the west elevation is composed of large wood windows of 8 and 12 lights. Shallow pilasters are doubled at the outside corners. The roof contains intersecting gables and gable dormers. Brick chimneys are located at each gable end.

The interior contains oak floors and plaster on wood lath walls and ceilings. The entry with central stairs is flanked by the living room through a cased opening and a dining room through glass bi-fold doors. The stairway has oak treads, painted risers and turned spindles which terminate in a spiral. The living room has a large cove molding at the ceiling of 9 feet height. The fireplace has a wood surround and mantle. The hearth is six inch square ceramic tiles. The kitchen and pantry have vinyl floors, wood cabinets with glass doors above. Back porch has vinyl floor. A library has a 1/2 bath with vinyl floor. The second floor

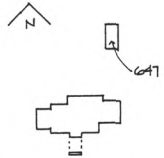

(cont'd)

contains bedroom and baths. The floors are fir in the hall at the stair landing with oak floors in all rooms except baths which have hexagonal tile floors. Baths have pedestal sinks. The attic has a bath with a VAT floor. The basement has concrete slab, plaster walls with a 1/2 bath (continued on back)

SIGNIFICANCE: Period 1900- Area of Significance Military  
1. X 2. 3. 4.

Building 646 was constructed in 1923 as the quarters for the Commanding Officer of the Naval Hospital Reservation. It remains the quarters for the Hospital Commander. The building exhibits a formal "Federal" design influence. One of two major quarters within the shipyard property. The size and amenities of Building 646 can be compared to Building 624, the Shipyard Commander's Quarters. Sited within the original Hospital Reservation, it sits in an area of open grassy lawn with ample distance from neighboring structures.

Building 646 is a two story, wood frame, clapboard sided quarters with gable roofs containing gabled dormers. The design exhibits a classical "Federal" influence with (cont'd on back)



Negative No.  
 SP 85-00992-646  
 SP86-01720-646-5

Acreage:  
 less than 1  
 Verbal Boundary  
 Description:  
 Between Dewey  
 St. & Tank 317  
 at the southern  
 end of Longshaw  
 Drive.



Facility  
 No.  
 646/647

LOCATION :

PSNS  
 GRID  
 J 37

UTM Zone	Easting					Northing							
10	5	2	6	8	2	2	5	2	6	7	3	2	4

Quadrangle Bremerton West  
 scale 1:24,000

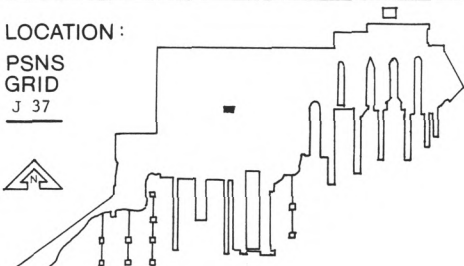

(cont'd) and a room with wood floor and a fire-place rendered inoperative.

The garage 647 is a two car gabled roof building with composition shingles. The windows are 6 light and the siding is beveled. The floor is concrete slab.

CONTINUATION of SIGNIFICANCE

an asymmetrical composition. The building was designed in 1923 by the Puget Sound Navy Yard under the direction of Public Works Officer Captain E.R. Gayler, U.S.N. The building has a formal entry on its southern elevation with a porte cochere and a less formal entry on the north elevation. The arrangement of areas are public rooms, living room, dining room, sun room and kitchen on the main floor with bedrooms and baths on the second floor and in the attic. The second floor is accessed from a central open stairway at the center of the building adjacent to the formal entry. The public rooms are large with high ceilings.

The building was constructed as quarters for the Commanding Officer of the Naval Hospital prior to 1923, the Commanding Officer was quartered in Building 621. The building has maintained its exterior and interior intact. The building has experienced modernization and repair to its plumbing and electrical wiring as well as repair of various elements. The building is well maintained and in good repair.

# PSNS INVENTORY

# HISTORIC SURVEY PUGET SOUND NAVAL SHIPYARD

Historic Name

NOV 22 1926

 Facility  
No.

QUARTERS X

648

 NAME OF STRUCTURE OFFICER'S QUARTERS (X)

 Construction Date 1926

Alterations/Additions

 Uses: Original Naval Hospital Pharmacists Quarters (Remod- 49, toilet rm; 51, wiring; 61, roof)

 WWII Naval Hospital Quarters

79, whole house)

 Present Officer's Quarters

 DESIGNED BY NAVY YARD PUGET SOUND, WASHINGTON

 DATE 1925

DESCRIPTION:

 Condition Good Altered No Original Site Yes

Building 648 is a rectangular brick two story residence with a basement. The building measures 35 feet by 25 feet. The building has a gable roof with composition shingles and a small rear porch of wood and glass has a hip roof.

The entry door on the northwest elevation is formed by a semi-circular arch with wood fanlight over doorway. A small semi-circular window is set in the gable. Windows are flat arched brick lintels; sills are limestone. Windows are double-hung wood sash in wood frames with 6 over 6 lights.

Exterior brick is red common laid in a "Flemish" bond pattern. The base of the building is concrete forming the basement walls and joins the brick walls with a brick water-table laid with alternating soldier and double row lock courses.

The interior of Quarters (X) contains oak floors and plaster on wood lath walls and ceilings. The entry contains a stairway to the upper floor and is composed of painted treads and risers, open balustrade of square spindles and square newel posts. The living room consists of a fireplace with wood mantle and is flanked by wood bookcases with plain trim. Ceilings are 8 ft. high. The kitchen has VAT floor, painted wood cabinets and plastic laminate countertop. The second floor has fir floors. Upper bath has VAT flooring. The basement has 7 ft. ceiling height. Walls and floors are concrete and partitions are plywood.

SIGNIFICANCE:

 Period 1900-

 Area of Significance Military

 1.  2.  3.  4. 

Building 648 is one of two remaining buildings of the Naval Hospital Complex assigned as quarters for Warrant Officers. Building 648 and 649 were the only quarters constructed for Warrant Pharmacists. Constructed in 1926 by the Navy Yard, Puget Sound, under the direction of Captain W.H. Allen, U.S.N., Public Works Officer. Building 648 is a small brick building which displays "Georgian" influences.

Building 648 was constructed as a residence for Warrant Pharmacists in 1926 at its present location on Gatewood Avenue. The building is a small two story, gable-roofed residence with a brick exterior having "Georgian" design influences. "Georgian" design was a very popular form of architectural expression during the 1924-29 period. Built in tandem with Building 649, Building 648 exhibits the "Georgian" motifs of a

(cont'd on back)



Negative No.  
SP 85-00992-648

Acreage:  
less than 1  
Verbal Boundary  
Description:  
Between Gate-  
wood Ave., &  
Hoogewerff Rd.,  
between Mahan  
Ave. and Bldg.  
649.

Facility  
No.  
648

LOCATION :

PSNS  
GRID

E 38

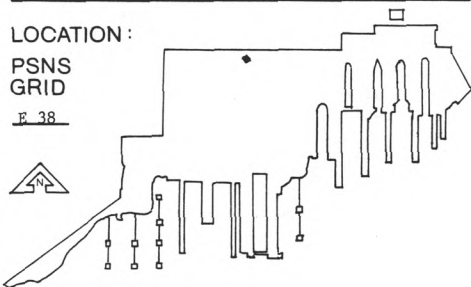

UTM Zone	Easting	Northing
10	526878	5267652

Quadrangle Bremerton West

scale 1:24,000

## CONTINUATION of SIGNIFICANCE

fanlight over the entry door, simple rectangular window openings and a round window within the gable. At the rear of the building an enclosed sun porch demonstrates "Georgian" influence.

Building 648 remained Warrant Pharmacists' quarters until after World War II. In 1946 it was converted to Corps Officer's Quarters for the Naval Hospital. In 1948 it became the Naval Hospital's Personnel Officer's quarters. It was converted to Naval Base Officer's quarters when the Naval Hospital was relocated.

Building 648 has experienced few changes since its original construction. Changes have been limited to upgrading of plumbing and electrical wiring.

# PSNS INVENTORY

# HISTORIC SURVEY PUGET SOUND NAVAL SHIPYARD

Historic Name NOV 22 1968 Facility No. 649  
QUARTERS Y

NAME OF STRUCTURE OFFICER'S QUARTERS (Y) & GARAGE 650

Construction Date 1926

Alterations/Additions

Uses: Original Navy Hospital Pharmacists Quarters

(Alt-51)

WWII

(Remod-57, wiring; 61, roof, 79, whole house)

Present Officer's Quarters

DESIGNED BY NAVY YARD PUGET SOUND, WASHINGTON

DATE 1925

DESCRIPTION: Condition Good Altered No Original Site Yes



Building 649 is a rectangular brick two story residence with a basement. The building measures 35 feet by 25 feet. The building has a gable roof with composition shingles and a small rear porch of wood and glass has a hip roof.

The entry door on the northwest elevation is formed by a semi-circular arch with wood fanlight over doorway. A small semi-circular window is set in the gable. Windows are flat arched brick lintels; sills are limestone. Windows are double-hung wood sash in wood frames with 6 over 6 lights.

Exterior brick is red common laid in a "Flemish" bond pattern. The base of the building is concrete forming the basement walls and joins the brick walls with a brick water-table laid with alternating soldier and double row lock courses.

The interior of Quarters (Y) contains oak floors and plaster on wood lath walls and ceilings. The entry contains a stairway to the upper floor and is composed of painted treads and risers, open balustrade of square spindles and square newel posts. The living room consists of a fireplace with wood mantle and is flanked by wood bookcases with plain trim. Ceilings are 8 ft high. The kitchen has 6 inch VAT, steel sink unit and painted cabinets with plastic laminate countertop. The second floor has fir floors. Upper bath has vinyl floor. The basement has 7 ft ceiling height, walls and floors are concrete and partitions are plywood.

Garage 650 serves Quarters X and Y. It is a two car garage of wood frame with gable roof of composition shingles. Its floor is a concrete slab.

SIGNIFICANCE:

1.  2.  3.  4.

Period 1900-

Area of Significance Military

Building 649 is one of two remaining buildings of the Naval Hospital Complex assigned as quarters for Warrant Officers. Building 649 and 648 were the only quarters constructed for Warrant Pharmacists. Constructed in 1926 by the Navy Yard, Puget Sound, under the direction of Captain W.H. Allen, U.S.N., Public Works Officer. Building 649 is a small brick building which displays "Georgian" influences.

Building 649 was constructed as a residence for Warrant Pharmacists in 1926 at its present location on Gatewood Avenue. The building is a small two story, gable-roofed residence with a brick exterior having "Georgian" design influences. "Georgian" design was a very popular form of architectural expression during the 1924-29 period. Built in tandem with Building 648, Building 649 exhibits the "Georgian" motifs of a  
(cont'd on back)



Negative No. SP 85-00992-649

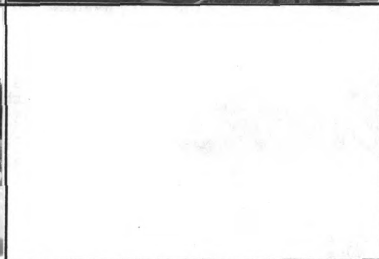

Acreage: less than 1  
Verbal Boundary Description: Between Gatewood Ave. and Hoogewerff Rd. adjacent to Bldg. 648.

Facility No.

649/650

LOCATION :

PSNS GRID

E 38

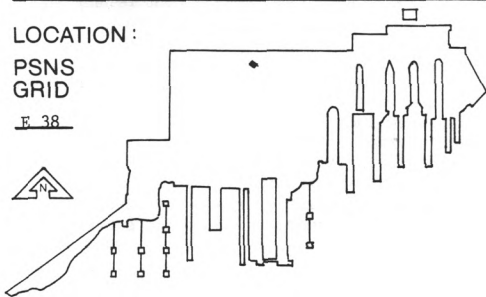

UTM Zone	Easting	Northing
10	5 2 6 8 4 2	5 2 6 7 6 3 8

Quadrangle Bremerton West  
scale 1:24,000

### CONTINUATION of SIGNIFICANCE

fanlite over the entry door, simple rectangular window openings and a round window within the gable. At the rear of the building an enclosed sun porch demonstrates "Georgian" influence.

Building 649 remained Warrant Pharmacists' quarters until After World War II. In 1946 it was converted to Corps Officer's Quarters for the Naval Hospital. In 1948 it became the quarters for the Staff Officer of the Pacific Reserve Fleet.

Building 649 has experienced few changes since its original construction. Changes have been limited to upgrading of plumbing and electrical wiring.