

UNITED STATES DEPARTMENT OF THE INTERIOR  
NATIONAL PARK SERVICE

**NATIONAL REGISTER OF HISTORIC PLACES  
INVENTORY -- NOMINATION FORM**

FOR FEDERAL PROPERTIES

<b>FOR NPS USE ONLY</b>	
RECEIVED	DEC 19 1985
DATE ENTERED	1/24/86

SEE INSTRUCTIONS IN *HOW TO COMPLETE NATIONAL REGISTER FORMS*  
TYPE ALL ENTRIES -- COMPLETE APPLICABLE SECTIONS

**1 NAME**

HISTORIC  
Rifle Post Office  
AND/OR COMMON  
Rifle Main Post Office

**2 LOCATION**

STREET & NUMBER  
Railroad Avenue and Fourth Street  
CITY, TOWN  
Rifle  
STATE  
Colorado  
VICINITY OF  
NA  
COUNTY  
Garfield  
CONGRESSIONAL DISTRICT  
3  
CODE  
08  
CODE  
045

**3 CLASSIFICATION**

CATEGORY	OWNERSHIP	STATUS	PRESENT USE
<input type="checkbox"/> DISTRICT	<input checked="" type="checkbox"/> PUBLIC	<input checked="" type="checkbox"/> OCCUPIED	<input type="checkbox"/> AGRICULTURE
<input type="checkbox"/> BUILDING(S)	<input type="checkbox"/> PRIVATE	<input type="checkbox"/> UNOCCUPIED	<input type="checkbox"/> MUSEUM
<input type="checkbox"/> STRUCTURE	<input type="checkbox"/> BOTH	<input type="checkbox"/> WORK IN PROGRESS	<input type="checkbox"/> COMMERCIAL
<input type="checkbox"/> SITE	<b>PUBLIC ACQUISITION</b>	<b>ACCESSIBLE</b>	<input type="checkbox"/> EDUCATIONAL
<input type="checkbox"/> OBJECT	<input checked="" type="checkbox"/> IN PROCESS	<input type="checkbox"/> YES: RESTRICTED	<input type="checkbox"/> ENTERTAINMENT
<input checked="" type="checkbox"/> Thematic Group	<input type="checkbox"/> BEING CONSIDERED	<input checked="" type="checkbox"/> YES: UNRESTRICTED	<input checked="" type="checkbox"/> GOVERNMENT
		<input type="checkbox"/> NO	<input type="checkbox"/> RELIGIOUS
			<input type="checkbox"/> PRIVATE RESIDENCE
			<input type="checkbox"/> SCIENTIFIC
			<input type="checkbox"/> INDUSTRIAL
			<input type="checkbox"/> TRANSPORTATION
			<input type="checkbox"/> MILITARY
			<input type="checkbox"/> OTHER:

**4 AGENCY**

REGIONAL HEADQUARTERS: *(If applicable)*  
United States Postal Service, Western Regional Office  
STREET & NUMBER  
850 Cherry Ave.  
CITY, TOWN  
San Bruno  
VICINITY OF  
NA  
STATE  
CA  
94099

**5 LOCATION OF LEGAL DESCRIPTION**

COURTHOUSE,  
REGISTRY OF DEEDS, ETC.  
Garfield County Assessor  
STREET & NUMBER  
109 8th Street Suite 207  
CITY, TOWN  
Glenwood Springs  
STATE  
CO  
81601

**6 REPRESENTATION IN EXISTING SURVEYS**

TITLE  
None Known.  
DATE  
\_\_\_\_ FEDERAL \_\_\_\_ STATE \_\_\_\_ COUNTY \_\_\_\_ LOCAL

DEPOSITORY FOR  
SURVEY RECORDS  
CITY, TOWN  
STATE

## 7 DESCRIPTION

CONDITION		CHECK ONE	CHECK ONE
<input checked="" type="checkbox"/> EXCELLENT	<input type="checkbox"/> DETERIORATED	<input checked="" type="checkbox"/> UNALTERED	<input checked="" type="checkbox"/> ORIGINAL SITE
<input type="checkbox"/> GOOD	<input type="checkbox"/> RUINS	<input type="checkbox"/> ALTERED	<input type="checkbox"/> MOVED    DATE <u>NA</u>
<input type="checkbox"/> FAIR	<input type="checkbox"/> UNEXPOSED		

---

### DESCRIBE THE PRESENT AND ORIGINAL (IF KNOWN) PHYSICAL APPEARANCE

The Rifle Main Post Office is a square brick building with classically inspired Colonial Revival detailing. It has a hipped slate roof, and retains much of its original interior detailing in the public lobby.

### LOCAL CONTEXT

Rifle was founded as a trading center in 1882, and grew substantially with the discovery of coal, vanadium, and uranium. A large experimental oil shale plant is located west of the town. Rifle contains a number of late-19th and early-20th century red brick sandstone structures. There are no designated historic districts in the community.

The Main Post Office is centrally located one block north of the principal commercial street in Rifle.

A topographic survey dated 3/22/39 showed the following structures on the site: two one-story frame houses; one two-story frame house; and miscellaneous frame sheds, garages, and coal houses. There are no known archaeological or paleontologic sites within or adjacent to the site. Basement construction has probably eliminated any trace of previous structures.

### PHYSICAL APPEARANCE

The building appears to be in excellent condition and both it and the grounds are being well maintained. All of the original fixtures excepting the interior lights are in the building.

The building and foundation are of red brick. There is a slate roof. The lobby floor is terrazzo with travertine wainscoting and wooden paneling. The workroom floor is linoleum.

The building is roughly square, with the main entrance facing west. It is one story with a full basement. Both the public

**United States Department of the Interior  
National Park Service**

**National Register of Historic Places  
Inventory—Nomination Form**

For NPS use only

received

date entered

Continuation sheet

Rifle PO

Item number

7

Page 1

lobby and the exterior of the building have a number of features associated with the American Colonial Revival. These include: interior molding brick dentils along the entrance vestibule and the cornice; and entrance with leaded glass adjacent to the door, wooden fluted columns, a band above the front door with thirteen stars, a large cast eagle fronting the transom, and brass and copper lanterns flanking the front steps.

There is also a mural painted on canvas and mounted over the Postmaster's office door. It is entitled "Colorado Landscape" and was painted in 1942, by George Vander Sluis. No information on Mr. Vander Sluis was available in the standard artist reference works consulted.

# 8 SIGNIFICANCE

PERIOD	AREAS OF SIGNIFICANCE -- CHECK AND JUSTIFY BELOW			
<input type="checkbox"/> PREHISTORIC	<input type="checkbox"/> ARCHEOLOGY-PREHISTORIC	<input type="checkbox"/> COMMUNITY PLANNING	<input type="checkbox"/> LANDSCAPE ARCHITECTURE	<input type="checkbox"/> RELIGION
<input type="checkbox"/> 1400-1499	<input type="checkbox"/> ARCHEOLOGY-HISTORIC	<input type="checkbox"/> CONSERVATION	<input type="checkbox"/> LAW	<input type="checkbox"/> SCIENCE
<input type="checkbox"/> 1500-1599	<input type="checkbox"/> AGRICULTURE	<input type="checkbox"/> ECONOMICS	<input type="checkbox"/> LITERATURE	<input type="checkbox"/> SCULPTURE
<input type="checkbox"/> 1600-1699	<input checked="" type="checkbox"/> ARCHITECTURE	<input type="checkbox"/> EDUCATION	<input type="checkbox"/> MILITARY	<input type="checkbox"/> SOCIAL/HUMANITARIAN
<input type="checkbox"/> 1700-1799	<input type="checkbox"/> ART	<input type="checkbox"/> ENGINEERING	<input type="checkbox"/> MUSIC	<input type="checkbox"/> THEATER
<input type="checkbox"/> 1800-1899	<input type="checkbox"/> COMMERCE	<input type="checkbox"/> EXPLORATION/SETTLEMENT	<input type="checkbox"/> PHILOSOPHY	<input type="checkbox"/> TRANSPORTATION
<input checked="" type="checkbox"/> 1900-	<input type="checkbox"/> COMMUNICATIONS	<input type="checkbox"/> INDUSTRY	<input type="checkbox"/> POLITICS/GOVERNMENT	<input type="checkbox"/> OTHER (SPECIFY)
		<input type="checkbox"/> INVENTION		

---

SPECIFIC DATES	1940	BUILDER/ARCHITECT	OSA/Louis A. Simon, Sup. Architect
----------------	------	-------------------	---------------------------------------

---

STATEMENT OF SIGNIFICANCE

The Rifle Main Post Office is the most detailed and complete of any of the five known small Colonial Revival influenced post offices in Colorado.

### ARCHITECTURE

American Colonial style detailing continues to be popular, especially in residential architecture, throughout the East and Mid-West. It is much less common in the western and southwestern states. The Rifle Post Office is the finest example of the use of Colonial Revival detailing on any post office in Colorado. The quality of the workmanship and the complexity of the architectural detailing is exceptional for a post office constructed as late as 1940. The building is also in essentially its original condition.

The original plans indicate that the structure was constructed by Joseph Sebacher Construction Company of Abilene, Kansas.



UNITED STATES DEPARTMENT OF THE INTERIOR  
NATIONAL PARK SERVICE

**NATIONAL REGISTER OF HISTORIC PLACES  
INVENTORY -- NOMINATION FORM**

FOR NPS USE ONLY	
RECEIVED	MAR 7 1968
DATE ENTERED	

CONTINUATION SHEET Rifle MPO      ITEM NUMBER 10      PAGE 1

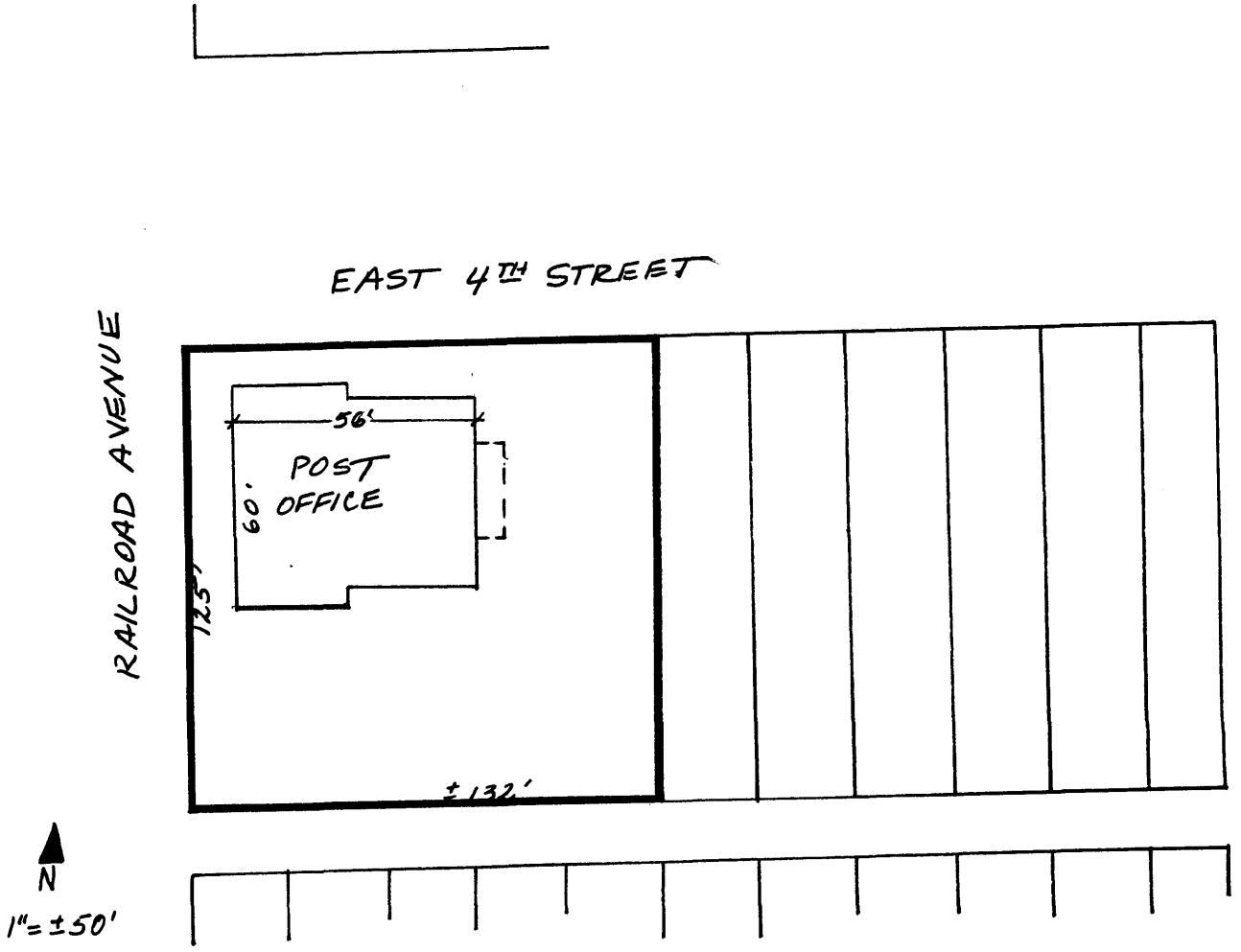

Source: Sanborn Map, Rifle Colorado,  
May 1939, 1943 revision, page 2.