

PH0663271

DATA SHEET

UNITED STATES DEPARTMENT OF THE INTERIOR
NATIONAL PARK SERVICE

FOR NPS USE ONLY	
RECEIVED	FEB 15 1978
DATE ENTERED	JUN 9 1978

NATIONAL REGISTER OF HISTORIC PLACES INVENTORY -- NOMINATION FORM

SEE INSTRUCTIONS IN *HOW TO COMPLETE NATIONAL REGISTER FORMS*
TYPE ALL ENTRIES -- COMPLETE APPLICABLE SECTIONS

1 NAME

HISTORIC

Findley, William, House

AND/OR COMMON

Davis County Historical Society Museum

LOCATION

STREET & NUMBER

302 East Franklin Street

NOT FOR PUBLICATION

CITY, TOWN

Bloomfield

CONGRESSIONAL DISTRICT

STATE

Iowa

VICINITY OF
CODE

COUNTY

Davis

CODE

51

CLASSIFICATION

CATEGORY

- DISTRICT
- BUILDING(S)
- STRUCTURE
- SITE
- OBJECT

OWNERSHIP

- PUBLIC
- PRIVATE
- BOTH
- PUBLIC ACQUISITION**
- IN PROCESS
- BEING CONSIDERED

STATUS

- OCCUPIED
- UNOCCUPIED
- WORK IN PROGRESS
- ACCESSIBLE**
- YES: RESTRICTED
- YES: UNRESTRICTED
- NO

PRESENT USE

- AGRICULTURE
- COMMERCIAL
- EDUCATIONAL
- ENTERTAINMENT
- GOVERNMENT
- INDUSTRIAL
- MILITARY
- MUSEUM
- PARK
- PRIVATE RESIDENCE
- RELIGIOUS
- SCIENTIFIC
- TRANSPORTATION
- OTHER:

OWNER OF PROPERTY

NAME

Davis County Historical Society

STREET & NUMBER

302 East Franklin Street

CITY, TOWN

Bloomfield

STATE

Iowa

VICINITY OF

LOCATION OF LEGAL DESCRIPTION

COURTHOUSE,
REGISTRY OF DEEDS, ETC.

Davis County Courthouse

STREET & NUMBER

City Square

CITY, TOWN

Bloomfield

STATE

Iowa

6 REPRESENTATION IN EXISTING SURVEYS

TITLE

DATE

FEDERAL STATE COUNTY LOCAL

DEPOSITORY FOR
SURVEY RECORDS

CITY, TOWN

STATE

7 DESCRIPTION

CONDITION		CHECK ONE	CHECK ONE
<input type="checkbox"/> EXCELLENT	<input type="checkbox"/> DETERIORATED	<input type="checkbox"/> UNALTERED	<input checked="" type="checkbox"/> ORIGINAL SITE
<input checked="" type="checkbox"/> GOOD	<input type="checkbox"/> RUINS	<input checked="" type="checkbox"/> ALTERED	<input type="checkbox"/> MOVED DATE _____
<input type="checkbox"/> FAIR	<input type="checkbox"/> UNEXPOSED		

DESCRIBE THE PRESENT AND ORIGINAL (IF KNOWN) PHYSICAL APPEARANCE

The T-plan Findley house is constructed of brick laid in common bond on a stone foundation. The main block is two bays deep and three wide, the rear wing three bays long. There is a chimney, brick covered with cement, toward each gable end. Windows are round-arched, 2/2 sash with keystone hoods; those of the basement are segmentally arched. The central entrance is also round-arched, sheltered by a small wooden porch which repeats the arch shape, and features a narrow, denticular cornice and small pendant brackets. The gable roof of the main block has a wide, denticular cornice, paired brackets, and partial returns. The rear wing conforms in mass, roof- and window-shape, but the cornice here is plain.

Original features, now gone: tall shutters, shaped to fit the window arches; a small balustrade around the front porch roof; a two-story porch along the north side of the rear wing -- its arches were similar to those of the front porch, but wider.

Until 1917, there was a small frame summer kitchen, with a shed extension, located at the rear of the house. It was replaced that year with the one-story frame structure attached to the south end of the main block. It served as a kitchen while the dwelling was used as a boarding house. It is now an office for the historical society.

The house is set on a small corner lot near the town square, and is operated as a county museum. Also on the lot is a small log cabin, attributed to Mormons who crossed Iowa during the 1840's and 1850's to Utah, and a 19th-century frame schoolhouse. These structures have been moved from their original locations, and do not appear to qualify for the National Register. They are part of the historical museum complex.

8 SIGNIFICANCE

PERIOD	AREAS OF SIGNIFICANCE -- CHECK AND JUSTIFY BELOW			
<input type="checkbox"/> PREHISTORIC	<input type="checkbox"/> ARCHEOLOGY-PREHISTORIC	<input type="checkbox"/> COMMUNITY PLANNING	<input type="checkbox"/> LANDSCAPE ARCHITECTURE	<input type="checkbox"/> RELIGION
<input type="checkbox"/> 1400-1499	<input type="checkbox"/> ARCHEOLOGY-HISTORIC	<input type="checkbox"/> CONSERVATION	<input type="checkbox"/> LAW	<input type="checkbox"/> SCIENCE
<input type="checkbox"/> 1500-1599	<input type="checkbox"/> AGRICULTURE	<input type="checkbox"/> ECONOMICS	<input type="checkbox"/> LITERATURE	<input type="checkbox"/> SCULPTURE
<input type="checkbox"/> 1600-1699	<input checked="" type="checkbox"/> ARCHITECTURE	<input type="checkbox"/> EDUCATION	<input type="checkbox"/> MILITARY	<input type="checkbox"/> SOCIAL/HUMANITARIAN
<input type="checkbox"/> 1700-1799	<input type="checkbox"/> ART	<input type="checkbox"/> ENGINEERING	<input type="checkbox"/> MUSIC	<input type="checkbox"/> THEATER
<input checked="" type="checkbox"/> 1800-1899	<input type="checkbox"/> COMMERCE	<input type="checkbox"/> EXPLORATION/SETTLEMENT	<input type="checkbox"/> PHILOSOPHY	<input type="checkbox"/> TRANSPORTATION
<input type="checkbox"/> 1900-	<input type="checkbox"/> COMMUNICATIONS	<input type="checkbox"/> INDUSTRY	<input type="checkbox"/> POLITICS/GOVERNMENT	<input type="checkbox"/> OTHER (SPECIFY)
		<input type="checkbox"/> INVENTION		

SPECIFIC DATES ca. 1860

BUILDER/ARCHITECT

STATEMENT OF SIGNIFICANCE

Although no firm date has been established for this house, it is believed to have been built about 1860, making it one of the oldest dwellings left in Bloomfield. It does not conform to any specific style, but the wide, bracketted cornice, in particular, suggests Italianate influences. Overall, it is a well-executed example of vernacular house architecture. The Findley house is also one of only five brick houses remaining in the town. Brick was not a common building material in Bloomfield, and most of the housing stock was of frame construction.

The first owner of the house was William M. Findley. Findley was born in Dayton, Ohio in 1816, and studied medicine at the University of Pennsylvania. He came to Bloomfield in 1843, after practicing in Indiana and New London, Iowa. During the Civil War, Findley acted as surgeon for the 4th Iowa Cavalry.

9 MAJOR BIBLIOGRAPHICAL REFERENCES

History of Davis County, Iowa. Des Moines: State Historical Company, 1882, pp. 616-7.

10 GEOGRAPHICAL DATA

ACREAGE OF NOMINATED PROPERTY less than one

UTM REFERENCES

A	1 5	5 4 9 0 6 5	4 5 1 1 0 1 0 0	B			
	ZONE	EASTING	NORTHING		ZONE	EASTING	NORTHING
C				D			

VERBAL BOUNDARY DESCRIPTION

Lot Four (4) in Block Thirty (30) of the Original Town, now City, of Bloomfield, Iowa.

LIST ALL STATES AND COUNTIES FOR PROPERTIES OVERLAPPING STATE OR COUNTY BOUNDARIES

STATE	CODE	COUNTY	CODE
STATE	CODE	COUNTY	CODE

11 FORM PREPARED BY

NAME / TITLE

Lillian Haufe

ORGANIZATION

Davis County Historical Society

DATE

STREET & NUMBER

413 N. Columbia St.

TELEPHONE

CITY OR TOWN

Bloomfield,

STATE

Iowa 52537

12 STATE HISTORIC PRESERVATION OFFICER CERTIFICATION

THE EVALUATED SIGNIFICANCE OF THIS PROPERTY WITHIN THE STATE IS:

NATIONAL

STATE

LOCAL

As the designated State Historic Preservation Officer for the National Historic Preservation Act of 1966 (Public Law 89-665), I hereby nominate this property for inclusion in the National Register and certify that it has been evaluated according to the criteria and procedures set forth by the National Park Service.

STATE HISTORIC PRESERVATION OFFICER SIGNATURE

[Signature] (HFS)

TITLE Director, Division of Historic Preservation

DATE 2-10-79

FOR NPS USE ONLY

I HEREBY CERTIFY THAT THIS PROPERTY IS INCLUDED IN THE NATIONAL REGISTER

DIRECTOR, OFFICE OF ARCHAEOLOGY AND HISTORIC PRESERVATION ATTEST: <i>[Signature]</i> KEEPER OF THE NATIONAL REGISTER	DATE <i>6/9/78</i> DATE <i>6/7/78</i>
--	--

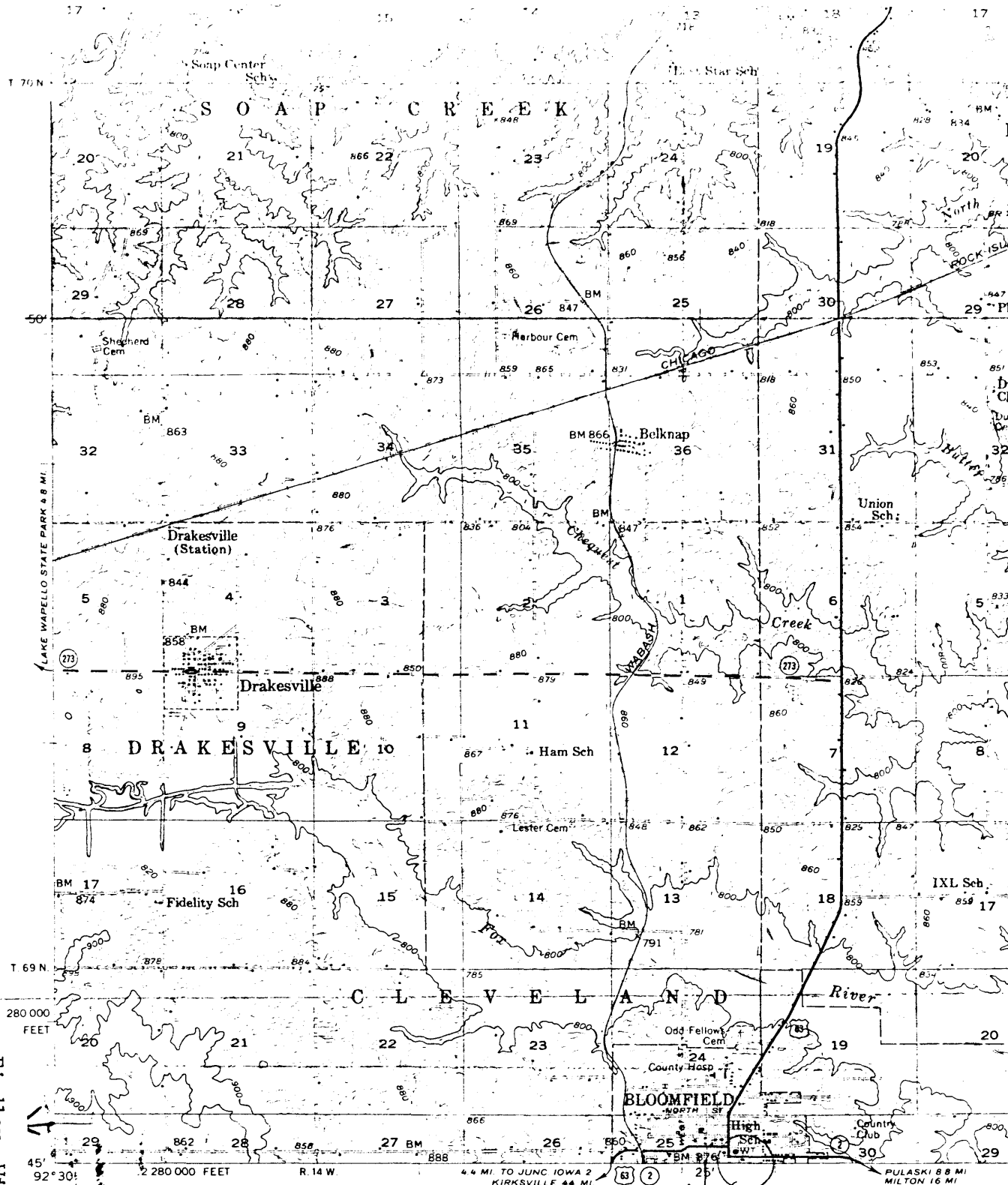

Findley, William, House
 Bloomfield, Davis Co., Iowa
 UTM: 15/549065 4511000

Mappe... edited, and published by the Geological Survey
 Control by USGS and USC&GS
 Topography from aerial photographs by photogrammetric methods
 and in part by City of Ottumwa. Aerial photographs taken 1955
 Field check 1956
 Polyconic projection. 1927 North American datum
 10,000-foot grid based on Iowa coordinate system, south zone
 1000-meter Universal Transverse Mercator grid ticks,
 zone 15, shown in blue
 Red tint indicates areas in which only
 landmark buildings are shown

6 1/2°
 TRUE NORTH
 MAGNETIC NORTH
 APPROXIMATE MEAN
 DECLINATION, 1956

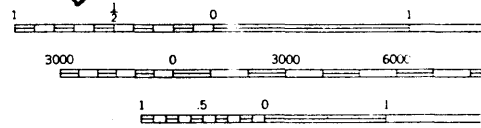

CONTOUR 11
 DATUM 15
 THIS MAP COMPLIES WITH THE
 FOR SALE BY U. S. GEOLOGICAL SURVEY, I
 AND BY THE IOWA GEOLO
 A FOLDER DESCRIBING TOPOGRAPHIC M