

FORM B - BUILDING

MASSACHUSETTS HISTORICAL COMMISSION
Office of the Secretary, State House, Boston

In Area no.	Form no.
	1/18/1 221

2. Photo (3x3" or 3x5")
Staple to left side of form
Photo number Sncl - 8-19A

4. Map. Draw sketch of building location in relation to nearest cross streets and other buildings. Indicate north.

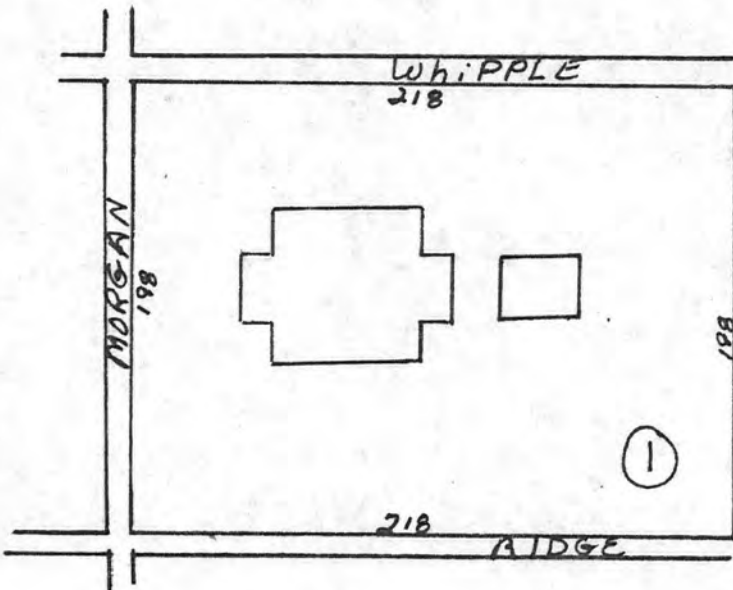

1. Town Fall River, Ma.
Address 43 Morgan St.
Name N.B. Borden School
Present use school

Present owner City of Fall River

3. Description:
Date 1867-8
Source Atlas/City Documents
Style Second Empire
Architect _____
Exterior wall fabric pressed brick w/ brownstone trim
Outbuildings (describe) _____
Other features Center bay blocked forwa w/ brownstone entrance motif. Brownstone beltcourses, incised lintels, shed-roofed dormers w/ paired arch-topped lintels.

Altered _____ Date _____
Moved _____ Date _____

5. Lot size: 43,170 sq. ft.
One acre or less Over one acre _____
Approximate frontage _____
Approximate distance of building from street _____

6. Recorded by Patricia Giza
Organization F.R.O.H.P.
Date November 1980

7. Original owner (if known) City of Fall River

Original use School

Subsequent uses (if any) and dates _____

8. Themes (check as many as applicable)

Aboriginal	_____	Conservation	_____	Recreation	_____
Agricultural	_____	Education	<u> x </u>	Religion	_____
Architectural	<u> x </u>	Exploration/ settlement	_____	Science/ invention	_____
The Arts	_____	Industry	_____	Social/ humanitarian	_____
Commerce	_____	Military	_____	Transportation	_____
Communication	_____	Political	_____		_____
Community development	<u> x </u>				

9. Historical significance (include explanation of themes checked above)

The building is a handsome Second Empire School building with mansard roof and walls of red pressed brick. It is the key structure for the "Ridge Street subsection" of the Corky Row neighborhood, which stretches several blocks to the south of it.

Built as the N.B. Borden School, this was one of a group of schools built in Fall River during the 1868-79 peak prosperity, and those schools followed the 1863 abolition of the earlier system of district schools. The school had great influence in training the early civic and industrial leaders of Fall River. The first principal was George W. Bronson, 1869. There were a series of four single-story frame cottages, used as class rooms and heated by stoves, across the rear of this lot behind (south of) the school.

The school was later the location of the girls' division of the Diman Vocational School, a part-time system of practical education which offered courses in manual training to men and boys; and in home management and nursing to girls. (In 1919 a statute passed requiring 14 yr. old applicant for employment to demonstrate 6th grade-level skills instead of 4th grade level. Cities then were required to provide 4 hours of school a week for 14-16 year olds who were employed 6 or more hours a day. Since so many of Fall River's children were employed, these requirements augmented attendance at the Vocational Schools.) (See continuation sheet)

10. Bibliography and/or references (such as local histories, deeds, assessor's records, early maps, etc.)

City Documents 1860-1869 : Morgan St. Schoolhouse, cost to build \$17,008.21. No mention of architect. Built in 1867, occupied in 1868.

Phillips History of Fall River p. 76

INVENTORY FORM CONTINUATION SHEET

MASSACHUSETTS HISTORICAL COMMISSION
Office of the Secretary, Boston

Community: Fall River, Mass.	Form No: 221 1/8/71
Property Name: N.B. Borden School	

Indicate each item on inventory form which is being continued below.

Continuation of Historical Significance (#9)

The N.B. School is the oldest school in Fall River still in continuous use; it is also the only surviving example of a brick mansard. Architecturally distinguished, this school played a significant role in the education of the city's early civic & industrial leaders; it meets Criteria A & C of the National Register.

Staple to Inventory form at bottom

United States Department of the Interior
National Park Service

National Register of Historic Places
Inventory—Nomination Form

For NPS use only

received

1/5/83

date entered

Continuation sheet

Item number

Page 2 of 10

Multiple Resource Area
Thematic Group

Name Fall River Multiple Resource Area
State MA

Nomination/Type of Review

Date/Signature

11. Borden, Ariadne J. & Mary A., House
Substantive Review

Keeper 2/16/83 Patricia Douglas

Attest

12. Border City Mills
Substantive Review

Keeper 12/11/83 Patricia Douglas R

DOE/OWNER OBJECTION

Attest

13. Borden, N. B., School
Entered in the National Register

Keeper 2/16/83 Delores Byers

Attest

14. Borden-Winslow House
Entered in the National Register

Keeper 2/16/83 Delores Byers

Attest

15. Brayton Methodist Episcopal Church
Entered in the National Register

Keeper 2/16/83 Delores Byers

Attest

16. Brightman, Hathaway, House
Entered in the National Register

Keeper 2/16/83 Delores Byers

Attest

17. Bristol County Superior Court
Entered in the National Register

Keeper 2/16/83 Delores Byers

Attest

18. Cadedy, Squire William B., House
Entered in the National Register

Keeper 2/16/83 Delores Byers

Attest

19. Cataract Engine Company No. 3
Entered in the National Register

Keeper 2/16/83 Delores Byers

Attest

20. Central Congregational Church
Entered in the National Register

Keeper 2/16/83 Delores Byers

Attest

States Department of the Interior
National Park Service

Borden, N. B., School (Fall River MRA)
Bristol County
MASSACHUSETTS

Working No. 115/83-15
Fed. Reg. Date: 2.7.84
Date Due: 2/3/83 - 2/9/83
Action: ACCEPT 2/16/83
 RETURN
 REJECT
Entered in the National Register
Federal Agency: _____

- resubmission
- nomination by person or local government
- owner objection
- appeal

Substantive Review: sample request appeal NR decision

Reviewer's comments:

Recom./Criteria _____
Reviewer _____
Discipline _____
Date _____
see continuation sheet

Nomination returned for: technical corrections cited below
 substantive reasons discussed below

1. Name

2. Location

3. Classification

Category	Ownership	Status	Present Use
	Public Acquisition	Accessible	

4. Owner of Property

5. Location of Legal Description

6. Representation in Existing Surveys

has this property been determined eligible? yes no

7. Description

Condition		Check one	Check one
<input type="checkbox"/> excellent	<input type="checkbox"/> deteriorated	<input type="checkbox"/> unaltered	<input type="checkbox"/> original site
<input type="checkbox"/> good	<input type="checkbox"/> ruins	<input type="checkbox"/> altered	<input type="checkbox"/> moved date _____
<input type="checkbox"/> fair	<input type="checkbox"/> unexposed		

Describe the present and original (if known) physical appearance

- summary paragraph
- completeness
- clarity
- alterations/integrity
- dates
- boundary selection

8. Significance

Period _____ Areas of Significance—Check and justify below

Specific dates _____ Builder/Architect _____

Statement of Significance (in one paragraph)

- _____ summary paragraph
- _____ completeness
- _____ clarity
- _____ applicable criteria
- _____ justification of areas checked
- _____ relating significance to the resource
- _____ context
- _____ relationship of integrity to significance
- _____ justification of exception
- _____ other

9. Major Bibliographical References

10. Geographical Data

Acres of nominated property _____

Quadrangle name _____

UMT References _____

Verbal boundary description and justification _____

11. Form Prepared By

12. State Historic Preservation Officer Certification

The evaluated significance of this property within the state is:

_____ national _____ state _____ local

State Historic Preservation Officer signature _____

title _____ date _____

13. Other

- _____ Maps
- _____ Photographs
- _____ Other

Questions concerning this nomination may be directed to _____

Signed _____ Date _____ Phone: 202 272 - 3504

Comments for any item may be continued on an attached sheet



INST. V 111
N.B. BORDEN SCHOOL
45 MORGAN ST.

Inst. - 8-19A

Fall River MRA, Ma

Borden, N. B., School

Please refer to the map in the
Multiple Property Cover Sheet
for this property

Multiple Property Cover Sheet Reference Number: 64000279