

96-1554

United States Department of the Interior
National Park Service

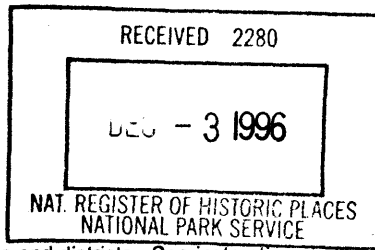

National Register of Historic Places
Registration Form

This form is for use in nominating or requesting determinations for individual properties and districts. See instructions in How to Complete the National Register of Historic Places Registration Form (National Register Bulletin 16A). Complete each item by marking "x" in the appropriate box or by entering the information requested. If an item does not apply to the property being documented, enter "N/A" for "not applicable." For functions, architectural classification, materials, and areas of significance, enter only categories and subcategories from the instructions. Place additional entries and narrative items on continuation sheets (NPS Form 10-900a). Use a typewriter, word processor, or computer, to complete all items.

1. Name of Property

historic name Picnic Area, Jackson State Forest
other names/site number Knob Lake Upper Picnic Area

2. Location

street & number Jackson-Washington State Forest N/A not for publication
city or town Brownstown vicinity
state Indiana code IN county Jackson code 071 zip code 47220

3. State/Federal Agency Certification

As the designated authority under the National Historic Preservation Act, as amended, I hereby certify that this nomination request for determination of eligibility meets the documentation standards for registering properties in the National Register of Historic Places and meets the procedural and professional requirements set forth in 36CFR Part 60. In my opinion, the property meets does not meet the National Register criteria. I recommend that this property be considered significant nationally statewide locally. (See continuation sheet for additional comments.)

Pat R. Rohl 10-31-96
Signature of certifying official/Title Date

Indiana Department of Natural Resources
State or Federal agency and bureau

In my opinion, the property meets does not meet the National Register criteria. (See continuation sheet for additional comments.)

Signature of certifying official/Title Date

State or Federal agency and bureau

4. National Park Service Certification

- I hereby certify that the property is:
 entered in the National Register.
 See continuation sheet.
- determined eligible for the National Register
 See continuation sheet.
- determined not eligible for the National Register
- removed from the National Register
- other, (explain:)

Edson H. Beall Signature of the Keeper
Date of Action 1-2-97

Name of Property

County and State

5. Classification

Ownership of Property

(Check as many boxes as apply)

- private
- public-local
- public-State
- public-Federal

Category of Property

(Check only one box)

- building
- district
- site
- structure
- object

Number of Resources within Property

(Do not include previously listed resources in the count)

Contributing	Noncontributing	
1	1	buildings
1	0	sites
4	0	structures
0	0	objects
6	1	Total

Name of related multiple property listing

(Enter "N/A" if property is not part of a multiple property listing.)

Number of contributing resources previously listed in the National Register

New Deal Resources on Indiana State Lands

0

6. Function or Use

Historic Functions

(Enter categories from instructions)

RECREATION/CULTURE: Outdoor Recreation

Current Functions

(Enter categories from instructions)

RECREATION/CULTURE: Outdoor Recreation

7. Description

Architectural Classification

(Enter categories from instructions)

OTHER: Park Rustic

Materials

(Enter categories from instructions)

foundation CONCRETE

walls WOOD: Log

roof WOOD: Shingle

other STONE

Narrative Description

(Describe the historic and current condition of the property on one or more continuation sheets.)

8. Statement of Significance

Applicable National Register Criteria

(Mark "x" in one or more boxes for the criteria qualifying the property for National Register listing.)

- A** Property is associated with events that have made a significant contribution to the broad patterns of our history.
- B** Property is associated with the lives of persons significant in our past.
- C** Property embodies the distinctive characteristics of a type, period, or method of construction or represents the work of a master, or possesses high artistic values, or represents a significant and distinguishable entity whose components lack individual distinction.
- D** Property has yielded, or is likely to yield, information important in prehistory or history.

Criteria Considerations

(Mark "x" in all the boxes that apply.)

Property is:

- A** owned by a religious institution or used for religious purposes.
- B** removed from its original location.
- C** a birthplace or grave.
- D** a cemetery.
- E** a reconstructed building, object, or structure.
- F** a commemorative property.
- G** less than 50 years of age or achieved significance within the past 50 years.

Areas of Significance

(Enter categories from instructions)

ENTERTAINMENT/RECREATION

SOCIAL HISTORY

LANDSCAPE ARCHITECTURE

Period of Significance

1934-42

Significant Dates

1934

Significant Person

(Complete if Criterion B is marked above)

N/A

Cultural Affiliation

N/A

Architect/Builder

Civilian Conservation Corps

Narrative Statement of Significance

(Explain the significance of the property on one or more continuation sheets.)

9. Major Bibliographic References

Bibliography

(Cite the books, articles, and other sources used in preparing this form on one or more continuation sheets.)

Previous documentation on file (NPS):

- preliminary determination of individual listing (36 CFR 67) has been requested
- previously listed in the National Register
- previously determined eligible by the National Register
- designated a National Historic Landmark
- recorded by Historic American Buildings Survey # _____
- recorded by Historic American Engineering Record # _____

Primary location of additional data:

- State Historic Preservation Office
- Other State agency
- Federal agency
- Local government
- University
- Other

Name of repository:

Picnic Area, Jackson State Forest
Name of Property

Jackson IN
County and State

10. Geographical Data

Acreage of Property 2.8

UTM References

(Place additional UTM references on a continuation sheet.)

1 16 586800 4302260
Zone Easting Northing

3 16
Zone Easting Northing

2 16
Zone Easting Northing

4 16
Zone Easting Northing

See continuation sheet

Verbal Boundary Description

(Describe the boundaries of the property on a continuation sheet.)

Boundary Justification

(Explain why the boundaries were selected on a continuation sheet.)

11. Form Prepared By

name/title Glory-June Greiff, Consulting Historian
organization _____ date 6-15-96
street & number 1753 South Talbott telephone 317/637-6163
city or town Indianapolis state IN zip code 46225

Additional Documentation

Submit the following items with the completed form:

Continuation Sheets

Maps

A **USGS map** (7.5 or 15 minute series) indicating the property's location.

A **Sketch map** for historic districts and properties having large acreage or numerous resources.

Photographs

Representative **black and white** photographs of the property.

Additional items

(Check with the SHPO or FPO for any additional items)

Property Owner

(Complete this item at the request of SHPO or FPO.)

name Indiana Department of Natural Resources, Division of Forestry
street & number 402 W. Washington St., Room W-296 telephone 317/232-4105
city or town Indianapolis state IN zip code 46204

Paperwork Reduction Act Statement: This information is being collected for applications to the National Register of Historic Places to nominate properties for listing or determine eligibility for listing, to list properties and to amend existing listings. Response to this request is required to obtain a benefit in accordance with the National Historic Preservation Act, as amended (16 U.S.C. 470 *et seq.*).

Estimated Burden Statement: Public reporting burden for this form is estimated to average 18.1 hours per response including time for reviewing instructions, gathering and maintaining data, and completing and reviewing the form. Direct comments regarding this burden estimate or any aspect of this form to the Chief, Administrative Services Division, National Park Service, P.O. Box 37127, Washington, DC 20013-7127; and the Office of Management and Budget, Paperwork Reductions Projects (1024-0018), Washington, DC 20503.

United States Department of the Interior
National Park Service

National Register of Historic Places
Continuation Sheet

Section number 7 Page 1

Picnic Area, Jackson State Forest

Jackson County, Indiana

NARRATIVE DESCRIPTION

The historic main picnic area (photos 1 and 2) lies at the end of the forest road that runs northeast off SR250, southeast of Brownstown in Jackson-Washington (formerly Jackson) State Forest. Also called the Knob Lake Upper Picnic Area, it nestles in a grove of oaks on a hillside to the north of Knob Lake (formerly Sawmill Lake). Bordered by a parking area on the west, the grove is accessible by way of two sets of stone steps set into the hillside. At the bottom of the northernmost steps is a water fountain beneath a timber shelter (photo 1). The grove features an oven shelter (photo 2), a typical New Deal-era recreational feature, which is comprised of a two-sided stone fireplace centered within an open shelter topped with a hipped roof. The only other substantial construction is a circular stone platform--or campfire ring--with a fireplace oven built into the wall that partially surrounds it (photo 3). Within the circle is a stone-and-timber picnic table. (The table and bench supports are constructed of stone; the table top and seats are 2x10s, which presumably have been replaced in many cases.) In addition, there are eighteen more of these picnic tables scattered about the grove, along with five individual fireplace ovens of stone (photos 4,5). In every case, each oven is grouped with two of the picnic tables. On the east side of the grove is a modern vault toilet that presumably replaced an earlier facility of similar type. A service road that enters the grove at its southeast corner becomes an unobtrusive cinder lane within the picnic area.

The site contains six contributing resources: the oven shelter, the stone platform (with table), the drinking fountain shelter, two sets of stone steps, and the site itself, which includes eighteen stone-and-timber picnic tables and five stone fireplace ovens. The vault toilet is a non-contributing resource.

**United States Department of the Interior
National Park Service**

**National Register of Historic Places
Continuation Sheet**

Section number 8 Page 2

Picnic Area, Jackson State Forest

Jackson County, Indiana

NARRATIVE STATEMENT OF SIGNIFICANCE

Nestled amidst an oak grove on a hillside to the northwest above the former Sawmill Lake in the midst of Jackson-Washington State Forest, the property's main picnic grove is a marvelously intact example of state forest recreational development by the Civilian Conservation Corps in Indiana. As such, it offers a splendid material record of an important area of New Deal public works and recreational development on Indiana state lands during the 1930s. Although there was less emphasis on recreational development in the state forests, shelters and picnic areas were typical of the projects on these properties.

As described in the associated property type "New Deal work projects related to recreational activities," the picnic area is eligible for the National Register under Criterion A in the areas of recreation and social history because it is associated with the New Deal's work programs and recreational development in the 1930s. It is also eligible under Criterion C because the site as a whole, and its individual resources: the oven shelter, the campfire ring, the picnic tables, and the fountain shelter, all are representative of the work and style of architecture and site development typical of the CCC. The picnic area meets the standards of integrity as set forth in the multiple property nomination "New Deal Resources on Indiana State Lands." The site remains in its original location and original setting--or more accurately, its original setting come to fruition. The design and materials remain intact, and the resources are representative of and associated with typical CCC workmanship--timber construction and stone masonry.

The state had only recently acquired (1930) Jackson State Forest near Brownstown, when CCC Company 1556 established a forestry camp there in 1933. They immediately set to work planting trees and building access roads. Within two years they had constructed a service building, a large barn, sawmill and lumber shed, a dam to impound a small lake that provided a source of water, a museum out of a reassembled pioneer cabin, two shelter houses, and the picnic area under discussion.

**United States Department of the Interior
National Park Service**

**National Register of Historic Places
Continuation Sheet**

Section number 8 Page 3

Picnic Area, Jackson State Forest

Jackson County, Indiana

While a number of CCC-constructed picnic areas survive in various state forests, this one is unusually intact. Unlike most picnic areas of this size, it features no large shelter house (although there is one nearby across the parking lot and up a hill), only an oven shelter, a popular recreational structure during the New Deal years (none were built before or since in Indiana). The stone platform, which Division of Forestry personnel call a fire ring, also appears to have been built only during the New Deal years. Most large picnic areas in Indiana's state forests had one--but only one. (Interestingly, no example of this type of resource has materialized in any state park.) Those extant today are too frequently in a very deteriorated state. The oaks that define the picnic area appear to have been planted about the same time as the site's construction. Although documentation is lacking for this site, the CCC is known to have planted some hardwoods as well as the ubiquitous white pines, and similar sites in other state forests are also marked by oak trees of 1930s vintage.

United States Department of the Interior
National Park Service

National Register of Historic Places
Continuation Sheet

Section number 9,10 Page 4

Picnic Area, Jackson State Forest

Jackson County, Indiana

MAJOR BIBLIOGRAPHICAL REFERENCES

Archival Collections

National Archives, Washington, D.C.

Records of the National Park Service: Civilian Conservation Corps
(RG 79)

Records of the Civilian Conservation Corps (RG 35)

Indiana Division, Indiana State Library, Indianapolis

Clipping Files, CCC

Outdoor Indiana, 1934-1942

Government Publications

"Annual Report of Department of Conservation," Yearbook of Indiana,
1930-1945.

United States Department of Interior, National Park Service. Park and
Recreation Structures. 3 Vol. Washington, D.C.: U.S. Government
Printing Office, 1938.

Other

Greiff, Glory-June. "New Deal Resources on Present Indiana State
Lands." June 1990-May 1991/August 1995-June 1996. Sponsored by
Indiana University, Indianapolis, and on file with the Indiana Division
of Historic Preservation and Archaeology (DHPA), 402 West Washington
Street, Indianapolis IN 46204. Field survey and inventory of existing
CCC- and WPA-constructed buildings, structures, and sites.

GEOGRAPHICAL DATA

Verbal Boundary Description

Starting at a point on the east edge of the paved road at the south end
of the parking lot north of Knob Lake, thence North 41 degrees East 350
feet, thence East 41 degrees South 350 feet, thence South 41 degrees
West 350 feet, thence West 41 degrees North 350 feet to point of
origin.

Boundary Justification

The boundaries encompass the historic picnic area and include all its
historic resources.

PICNIC AREA, JACKSON STATE FOREST
(Knob Lake Upper Picnic Area, Jackson-Washington State Forest)

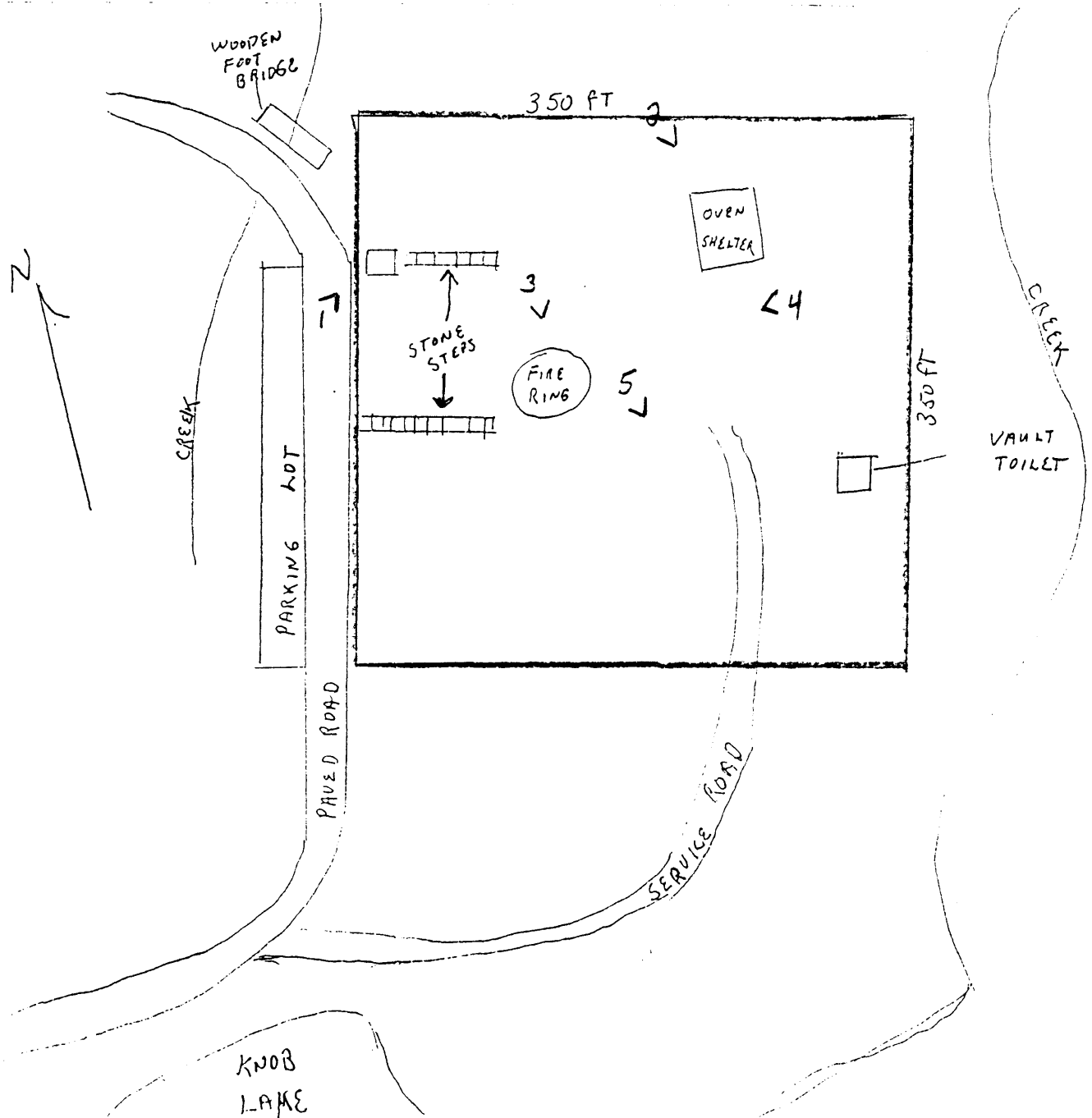

sketch map by Ben Hubbard, IDNR Division of Forestry, 29 May 1996