

United States Department of the Interior
National Park Service

National Register of Historic Places
Registration Form

1354

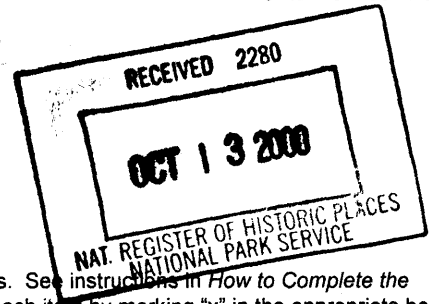

This form is for use in nominating or requesting determinations for individual properties and districts. See instructions in *How to Complete the National Register of Historic Places registration Form* (National Register Bulletin 16A). Complete each item by marking "x" in the appropriate box or by entering the information requested. If an item does not apply to the property being documented, enter "N/A" for "not applicable." For functions, architectural classification, materials, and areas of significance, enter only categories and subcategories from the instructions. Place additional entries and narrative items on continuation sheets (NPS Form 10-900a). Use a typewriter, word processor, or computer, to complete all items.

1. Name of Property

historic name Gibbs Drive Historic District

other names/site number N/A

2. Location

street & number Gibbs Drive

NA not for publication

city or town Knoxville

NA vicinity

state Tennessee

code TN

county Knox

code 093

zip code 37918

3. State/Federal Agency Certification

As the designated authority under the National Historic Preservation Act, as amended, I hereby certify that this nomination request for determination of eligibility meets the documentation standards for registering properties in the National Register of Historic Places and meets the procedural and professional requirements set for in 36 CFR Part 60. In my opinion, the property meets does not meet the National Register criteria. I recommend that this property be considered significant nationally statewide locally. (See continuation sheet for additional comments.)

Herbert L. Harper
Signature of certifying official/Title

10/9/00
Date

Deputy State Historic Preservation Officer, Tennessee Historical Commission

State or Federal agency and bureau

In my opinion, the property meets does not meet the National Register criteria. (See Continuation sheet for additional comments.)

Signature of certifying official/Title

Date

State or Federal agency and bureau

4. National Park Service Certification

I hereby certify that the property is:

entered in the National Register.

See continuation sheet

determined eligible for the National Register.

See continuation sheet

determined not eligible for the National Register

removed from the National Register.

other,

(explain:)

Signature of the Keeper

Date of Action

Edson H. Beall

11-8-00

5. Classification

Ownership of Property
(Check as many boxes as apply)

Category of Property
(Check only one box)

Number of Resources within Property
(Do not include previously listed resources in count)

- private
- public-local
- public-State
- public-Federal
- building(s)
- district
- site
- structure
- object

Contributing	Noncontributing	
72	7	buildings
		sites
		structures
		objects
72	7	Total

Name of related multiple property listing
(Enter "N/A" if property is not part of a multiple property listing.)

Number of Contributing resources previously listed in the National Register

Knoxville and Knox County MPS

N/A

6. Function or Use

Historic Functions
(Enter categories from instructions)

Current Functions
(Enter categories from instructions)

DOMESTIC: Single dwelling

DOMESTIC: secondary structure

DOMESTIC: Single dwelling

DOMESTIC: secondary structure

7. Description

Architectural Classification
(Enter categories from instructions)

Materials
(Enter categories from instructions)

Bungalow/Craftsman

OTHER: Minimal Traditional

OTHER: Four square

foundation BRICK, STONE

walls Weatherboard, BRICK, synthetic

roof ASPHALT, CLAY

other WOOD,STONE

Narrative Description

(Describe the historic and current condition of the property on one or more continuation sheets.)
See Continuation Sheets

8. Statement of Significance

Applicable National Register Criteria

(Mark "x" in one or more boxes for the criteria qualifying the property for National Register listing.)

- A** Property is associated with events that have made a significant contribution to the broad patterns of our history.
- B** Property is associated with the lives of persons significant in our past.
- C** Property embodies the distinctive characteristics of a type, period, or method of construction or represents the work of a master, or possesses high artistic values, or represents a significant and distinguishable entity whose components lack individual distinction.
- D** Property has yielded, or is likely to yield, information important in prehistory or history.

Criteria Considerations N/A

(Mark "x" in all boxes that apply.)

Property is:

- A** owned by a religious institution or used for religious purposes.
- B** removed from its original location.
- C** moved from its original location.
- D** a cemetery.
- E** a reconstructed building, object, or structure.
- F** a commemorative property
- G** less than 50 year of age or achieved significance within the past 50 years.

Areas of Significance

(Enter categories from instructions)

Architecture
 Community planning and development

Period of Significance

1910-1950

Significant Dates

N/A

Significant Person

(complete if Criterion B is marked)

N/A

Cultural Affiliation

N/A

Architect/Builder

Various, unknown

Narrative Statement of Significance

(Explain the significance of the property on one or more continuation sheets.)

9. Major Bibliographical References

Bibliography

(Cite the books, articles, and other sources used in preparing this form on one or more continuation sheets.)

Previous documentation on file (NPS): N/A

- preliminary determination of individual listing (36 CFR 67) has been requested
- previously listed in the National Register
- Previously determined eligible by the National Register
- designated a National Historic Landmark
- recorded by Historic American Buildings Survey # _____
- recorded by Historic American Engineering Record # _____

Primary location of additional data:

- State Historic Preservation Office
- Other State Agency
- Federal Agency
- Local Government
- University
- Other

Name of repository:
 McClung Historical Collection, Metropolitan Planning
 Commission

Gibbs Drive Historic District
Name of Property

Knox County, Tennessee
County and State

10. Geographical Data

Acreage of Property Approximately 42 acres Fountain City

UTM References

(place additional UTM references on a continuation sheet.)

1	<u>17</u>	<u>236740</u>	<u>3991970</u>	3	<u>17</u>	<u>235980</u>	<u>3991310</u>
	Zone	Easting	Northing		Zone	Easting	Northing
2	<u>17</u>	<u>236720</u>	<u>3991760</u>	4	<u>17</u>	<u>235870</u>	<u>3991480</u>

See continuation sheet

Verbal Boundary Description

(Describe the boundaries of the property on a continuation sheet.)

See Continuation Sheet

Boundary Justification

(Explain why the boundaries were selected on a continuation sheet.)

See continuation sheet

11. Form Prepared By

name/title Cathryn Irwin, Program Director
organization Knox Heritage, Inc. date August, 1999
street & number 803 S. Gay Street telephone (423) 523-8008
city or town Knoxville state TN zip code 37902

Additional Documentation

submit the following items with the completed form:

Continuation Sheets

Maps

A **USGS map** (7.5 Or 15 minute series) indicating the property's location

A **Sketch map** for historic districts and properties having large acreage or numerous resources.

Photographs

Representative **black and white photographs** of the property.

Additional items

(Check with the SHPO) or FPO for any additional items

Property Owner

(Complete this item at the request of SHPO or FPO.)

name See continuation sheets
street & number Gibbs Drive telephone _____
city or town Knoxville state TN zip code 37918

Paperwork Reduction Act Statement: This information is being collected for applications to the National Register of Historic Places to nominate properties for listing or determine eligibility for listing, to list properties, and to amend existing listing. Response to this request is required to obtain a benefit in accordance with the National Historic Preservation Act, as amended (16 U.S.C. 470 *et seq.*)

Estimated Burden Statement: Public reporting burden for this form is estimated to average 18.1 hours per response including time for reviewing instructions, gathering and maintaining data, and completing and reviewing the form. Direct comments regarding this burden estimate or any aspect of this form to the Chief, Administrative Services Division, National Park Service, P. O. Box 37127, Washington, DC 20013-7127; and the Office of Management and Budget, Paperwork Reductions Projects (1024-0018), Washington, DC 20303.

United States Department of the Interior
National Park Service

National Register of Historic Places Continuation Sheet

Section number 7 Page 1

Gibbs Drive Historic District
Knox County, Tennessee

DESCRIPTION

The Gibbs Drive Historic District is a neighborhood of fifty-two residences and associated outbuildings that reflect the characteristics of the streetcar and automobile suburb in Knoxville. The district has a linear street pattern, broad sidewalks, spacious facade lawns and sidewalks. Beginning in the era of streetcar suburbs, the neighborhood development continued throughout the period when automobile usage and ownership became prolific in Knoxville. The predominant building styles and forms are the bungalow, Craftsman, Minimal Traditional and four squares. Overall, the district is an outstanding example of the early twentieth century trend away from the elaborate Victorian era styles, to a more simplified floor plan and appearance

Buildings in the district are mainly one and one-half to two and one-half stories in height. Construction is brick or frame, with predominant building materials being brick, weatherboard siding or brick veneer. Lots are larger than those of other early twentieth century suburbs in Knoxville. Many garages and outbuildings survive in original form. The Gibbs Drive Historic District retains a high degree of architectural integrity. Only six of the fifty-two primary buildings are noncontributing. Most of the noncontributing houses have had visible additions or new siding; only one is post-1950.

INVENTORY

1. 2805 Gibbs Drive. (c. 1924). Dempster House. Neoclassical. Two and one-half story frame with brick veneer wall covering. Hip roof with one-story extension on west elevation, hip roof facade dormer, sawn wood balustrade at top of roof and barrel-shaped concrete tile roof covering. One-over-one, double-hung and nine-light casement windows. Two-story, half-round central porch covers half of facade, has fluted wood columns topped with Ionic capitals. Sawn wood balustrade at roofline of porch. Two brick chimneys. Rock-face fieldstone foundation. Sidelights and fanlight at facade entry comprised of leaded and beveled glass. Irregular plan. Stone wall at facade sidewalk with piers set with electric lanterns that mark steps. Dempster, the inventor of the Dempster dumpster and mayor of Knoxville, lived here from 1928-1933. (C)

(c. 1924). One-story frame garage with brick veneer wall covering. Hip roof with barrel shaped concrete tile roof covering. (C)

2. 2810 Gibbs Drive. (c. 1950). Colonial Revival. Two-story frame with brick veneer wall covering on first story and aluminum siding on second story. One story side extensions. Side gable roof with asphalt shingle covering. Three-over-three and four-over-four, double-hung windows. Façade stoop porch. Fluted pilasters beneath rectangular entablature with dentil trim at top of facade entry door. One-story screened sun porch on west elevation. Exterior side brick chimney. Brick foundation. Irregular plan. Attached one-story garage on east elevation, with connecting breezeway from house. (C)
3. 2811 Gibbs Drive. (c. 1915). American Four Square. Two story frame with brick veneer wall covering on the first story, weatherboard on the second story, and flared beltcourse separating first and second stories. Hip roof with hip roof facade dormer, gable one story extensions on side

United States Department of the Interior
National Park Service

National Register of Historic Places Continuation Sheet

Section number 7 Page 2

Gibbs Drive Historic District
Knox County, Tennessee

elevations, and asphalt shingle roof covering. One-over-one, double-hung windows with limestone lintels. One-story full width façade porch with sawn wood balustrade, tripled square wood columns with Doric capitals on brick piers. Porch extends to porte cochere on east elevation with square wood post and Doric capitals on brick piers. Exterior offset side brick chimney. Brick foundation with water table. Irregular plan. From 1937-1958 J.W. Carter, the owner of Carter Motor Company, lived here. (C)

(c. 1950). One-story concrete block, two-bay garage. Facade gable roof with asphalt shingle roof covering. (C)

4. 2812 Gibbs Drive. (c. 1916). Harris House. Bungalow with Craftsman influence. One story, frame with weatherboard wall covering. Asphalt shingles on attic dormer. Side gable roof with rafter tails, knee braces and gable roof facade shed roof dormer. One-over-one, double-hung windows, one facade window altered to picture window. One-over-one window in dormer. One story, three-quarter width façade porch with brick columns and brick piers with limestone caps. Brick balustrade with limestone cap. Two brick chimneys: one exterior side, one interior rear. Rectangular plan. R.L. Harris, the owner of a local Caterpillar dealership, lived here from 1916-1947. (C)

(c. 1916). One story frame garage with board and batten wall covering. Facade gable roof with tin roof covering. (C).

5. 2815 Gibbs Drive. (c. 1921). Tindell House. Bungalow with Craftsman influence. One and one-half story frame with brick veneer wall covering. Side gable roof with facade gable roof porch and shed roof dormers. Asphalt shingle covering roof; rafter tails and knee braces. Five-over-one, double-hung windows. One story, full width façade porch and porte cochere on west elevation. Brick balustrade, with tripled square wood columns, and Doric capitals on brick piers. Interior offset central brick chimney. Projecting bay on east elevation. One light sidelights at facade entry. Brick foundation. Irregular plan. J.A. Tindell, the president of Fountain City Bank and executive with Burwell Coal Company, lived here from 1921-1983. (C)

6. 2816 Gibbs Drive. (c. 1941). Minimal Traditional with Tudor Revival influence. One and one-half story frame with brick veneer wall covering. Side gable roof with lower cross gable on facade, cresting and wood shingle roof covering, rectangular wood louvered attic vents. Six-over-six and eight-over-eight, double-hung windows. One story gable roof façade porch over entry. Wood pilasters with knee braces under porch roof and aluminum balustrade on patio. Exterior facade brick chimney. Brick foundation. Irregular plan. (C)

(c. 1930). One story frame garage with brick veneer wall covering. Facade gable roof with wood shingle roof covering. (C)

7. 2820 Gibbs Drive. (c. 1920). Bungalow with Craftsman influence. Two story frame with weatherboard wall covering, asphalt shingle roof and on walls of attic dormer. Side gable roof with shed roof dormers on facade, knee braces, rafter tails. Six-over-one, double-hung windows. One

United States Department of the Interior
National Park Service

National Register of Historic Places Continuation Sheet

Section number 7 Page 3

Gibbs Drive Historic District
Knox County, Tennessee

story, three-quarter width facade porch with open gable end with bracing, battered wood columns on brick piers and sawn wood balustrade. Exterior side brick chimney. Projecting bays on east and west elevation. Large window at facade. Brick foundation. Irregular plan. (C)

(c. 1920). One story frame garage with board and batten wall covering. Facade gable roof with crimped metal roof covering. (C)

8. 2821 Gibbs Drive. (c. 1913). Orndorff House. Bungalow. One and one-half story frame with weatherboard wall covering. Side gable roof with facade shed roof dormer, asphalt shingle roof covering, and wood shingles on dormer walls. One-over-over, double-hung windows with added picture window on facade. One story, full width facade porch with solid brick balustrade, brick columns, and aluminum columns on brick piers at entry. Exterior side brick chimney. Projecting bay on east elevation. Brick foundation. Irregular plan. Daniel Orndorff, owner of Knoxville Music Company and a founder of Fountain City Bank, lived here from 1913-1979. (C)

9. 2824 Gibbs Drive. (c. 1926). Bungalow with Craftsman influence. One story frame with brick veneer wall covering. Aluminum siding in gable end of porch. Side gable roof with projecting gable for facade porch, cement tile roof covering, ridge cap and knee braces. Cottage window with divided light transom on facade. Two-over-one, double-hung windows. One story, three-quarter width facade porch with brick columns, brick piers and pierced brick balustrade with concrete coping. Two brick chimneys: one exterior offset and one interior offset side. Brick foundation. Irregular plan. (C)

(c. 1926). One story frame garage with vertical board wall on facade, vertical on sides. Hip roof with asphalt shingle roof covering. (C)

10. 2825 Gibbs Drive. (c. 1927). American Four Square. Two story frame, raised basement with brick veneer wall covering. Hip roof with barrel shaped concrete tile roof covering with ridge cap and finials. Eight-over-eight, double-hung windows. Fifteen-over-fifteen, double-hung windows on first floor, with shutters. One story, three-quarter width facade porch with brick balustrade and columns, gable at facade entry. Exterior side brick chimney. Brick foundation. Rectangular plan. (C)

11. 2828 Gibbs Drive. (c. 1923). Bungalow. One story frame with weatherboard wall covering and wood shingle on upper half of wall. Facade gable roof with asphalt shingle roof covering, attic vent and knee braces. Three-over-one, double-hung windows. One story, three-quarter width facade porch with porte cochere, with battered wood columns on tall brick piers. Exterior offset side brick chimney. Brick foundation. Irregular plan. From 1931-1941 W.S. Semones, owner of Semones Beauty Supply, lived here. (C)

(c. 1923). One story frame garage with vertical board wall covering. Side gable roof, with asphalt shingle roof covering. (C)

United States Department of the Interior
National Park Service

National Register of Historic Places Continuation Sheet

Section number 7 Page 4

Gibbs Drive Historic District
Knox County, Tennessee

-
12. 2829 Gibbs Drive. (c. 1927). American Four Square with Colonial Revival influence. Two story frame with raised basement and weatherboard wall covering. Hip roof with barrel shaped, concrete tile roof covering. Paired, double-hung, six-over-one windows. One story, one bay hip roof façade porch with square wood columns topped by Doric capitals. Two story projecting bay and one story projecting bay, with sawn wood balustrade at roof line, both on east elevation. Interior central brick chimney. Brick foundation. Irregular plan. A.B. Hammer, founder of Hammer's Stores lived here. (C)
13. 2832 Gibbs Drive. (c. 1922). Luttrell House. Bungalow with Craftsman influence. One story frame with asbestos shingle wall covering. Three-over-one, and two-over-one, double-hung windows. Three-over-one window on facade. One story, three-quarter width gable roof porch at façade. Asbestos shingle, battered wood columns on brick piers and sawn wood balustrade. Projecting gable bays on west elevation. Exterior offset side brick chimney. Brick foundation. Irregular plan. W.M. Luttrell, president of Knoxville Business College, lived here from 1924 –1959. (C)
- (c. 1922). One story frame garage with Masonite wall covering. Side gable roof with asphalt shingle roof covering. (C)
14. 2833 Gibbs Drive. (c. 1917). Wood House. Bungalow. One story frame, raised basement with weatherboard wall covering. Facade gable roof with asphalt shingle roof covering. Arched, sawn wood attic vent. Eight-over-one, double-hung windows. One story, one-half width facade porch with brick columns and balustrade. Six light sidelights at facade entry. Brick foundation. Rectangular plan. (C)
15. 2836 Gibbs Drive. (c. 1913). Bungalow with Craftsman influence. One story frame with asbestos shingle wall covering. Side gable roof with shed roof extensions and asphalt shingle roof covering. Gable roof dormer, knee braces and rafter tails. Six-over-one, double-hung windows. Large window on facade. One story, full width facade porch with square brick columns, capitals, and brick balustrade with concrete cap. Projecting bays on east and west elevations. Exterior offset side brick chimney. Brick foundation. Irregular plan. (C)
16. 2837 Gibbs Drive. (c. 1916). Bungalow with Craftsman influence. One story frame, with weatherboard wall covering and raised basement. Cross gable roof with telescoping facade gable, knee braces, sawn wood attic vents, and asphalt shingle roof covering. Three-over-one double-hung windows. One story, one-half width facade porch with sawn wood balustrade, battered wood columns, Doric capitals on brick piers. Oriel window on east elevation. Interior offset central brick chimney. Brick foundation. Irregular plan. From 1923-1989 Carolos Campbell, author of *Birth of a National Park* and *Wildflowers of the Smokies*, lived here. (C)
17. 2840 Gibbs Drive. (c. 1948). Minimal Traditional. One story formed concrete, scored to appear as block. Side gable roof with asphalt shingle roof covering. Aluminum siding at gable ends. Eight-over-eight and six-over-six, double-hung windows with brick lintels. One story, one bay façade

United States Department of the Interior
National Park Service

National Register of Historic Places Continuation Sheet

Section number 7 Page 5

Gibbs Drive Historic District
Knox County, Tennessee

porch with shed roof, square wood columns, and wrought iron balustrade. Exterior offset side concrete chimney. Concrete foundation. Irregular plan. (C)

(c. 1948) One story concrete garage with shop addition. Facade gable roof with asphalt shingle roof covering. (C)

18. 2841 Gibbs Drive. (c. 1917). Weckler House. Bungalow with Craftsman influence. One story frame with raised basement and weatherboard wall covering. Side gable roof with facade gable roof dormer, curved knee braces, rafter tails and asphalt shingle roof covering. Six-over-one, paired, double-hung windows. One story, wrap around porch with tripled, square wood columns, Doric capitals, brick piers and sawn wood balustrade. Ten light transom and four light sidelights at facade entry. Two brick chimneys; one exterior side, one interior offset. Brick foundation. Irregular plan. Judge W.L. Weckler lived here from 1917-1981. (C)

(c. 1930). One story frame garage with sheet plywood wall covering. Facade gable roof with asphalt shingle roof covering. (C)

19. 2844 Gibbs Drive. (c. 1920). Bungalow with Craftsman influence. One and one-half story frame, with asbestos shingle wall covering on second story and weatherboard covering on first story. Side gable roof with telescoping facade gable, asphalt shingle roof covering, paired rectangular wood louvered attic vents, rafter tails and knee braces. Six-over one and four-over-four, double-hung windows. One story, three-quarter width facade porch with square columns with corbelled capitals, brick piers, and brick balustrade with concrete cap. Projecting bays on east and west elevation. Exterior offset side brick chimney. Brick foundation. Irregular plan. (C)

20. 2845 Gibbs Drive. (c. 1928). Bungalow. One story frame with weatherboard wall covering. Hip roof with lower cross gables, rafter tails, knee braces and barrel-shaped concrete tile roof covering with ridge cap and finials. Sawn wood attic vent in floral pattern. One-over-one, double-hung windows. One story, three-quarter width facade porch with battered wood columns on stuccoed paneled piers and pierced concrete block balustrade. Projecting one story bay on east elevation. Interior offset brick chimney. Brick foundation. Irregular plan. (C)

21. 2848 Gibbs Drive. (c. 1941). Hensley House. Minimal Traditional. One and one-half story frame with asphalt shingle wall covering. Side gable roof with facade gable roof dormers, asphalt shingle roof covering. Six-over-six, double-hung windows. Facade porch with stone enclosed entry and aluminum balustrade. Carport added on west elevation and addition on east elevation. Exterior side stone chimney. Brick foundation. Irregular plan. B.H. Hensley, owner of Hensley Motor Company, lived here from 1941-1972. (NC)

22. 2849 Gibbs Drive. (c. 1925). Bungalow with Craftsman influence. One and one-half story frame with raised basement and weatherboard wall covering. Side gable roof with facade shed roof dormer, rafter tails, knee braces and asphalt shingle roof covering. Tripled, one-over-one, double-hung windows. One story full width facade porch with square wood columns and Doric capitals on

**United States Department of the Interior
National Park Service**

National Register of Historic Places Continuation Sheet

Section number 7 Page 6

Gibbs Drive Historic District
Knox County, Tennessee

wood piers, sawn wood balustrade. Interior end brick chimney. Brick foundation. Rectangular plan. From 1937-1963, W.E. Lack, a partner in Lack and Blackely Civil Engineering, lived here. (C)

(c. 1925). One story frame garage with weatherboard wall covering. Facade gable roof with asphalt shingle roof covering. (C)

(c. 1925). One story frame workshop and storage building with weatherboard wall covering. Side gable roof with asphalt shingle roof covering. Two light casement window. (C)

23. 2852 Gibbs Drive. (c. 1928). Pavlis House. Minimal Traditional with Colonial Revival influence. One and one-half story frame with brick veneer wall covering on first story, and wood shingles on second story. Side gable roof with telescoping facade gables, window in gable, and asphalt shingle roof covering. Six-over-six, double-hung windows. Facade stoop with arched entry and aluminum balustrade. One story board and batten addition on east elevation. One story projecting bay on west elevation. Interior offset brick chimney. Brick foundation. Irregular plan. From 1946-1961 G.P. Pavlis, owner of the Bijou Restaurant, lived here. (C)

(c. 1928). One story frame garage with weatherboard wall covering. Facade gable roof with asphalt shingle roof covering. (C)

24. 2855 Gibbs Drive. (c. 1929). Dutch Colonial Revival. Two story frame with raised basement and weatherboard wall covering. Gambrel roof with facade and rear shed roof dormers and asphalt shingle roof covering. Six-over-one, double-hung windows. One story, offset one bay porch with replacement aluminum columns, gable roof with arched cornice. One story side extension. Interior offset brick chimney. Brick foundation. Irregular plan. (C)

(c. 1929). One story frame garage with weatherboard wall covering. Shed roof with asphalt roll roof covering. (C)

25. 3000 Gibbs Drive. (c. 1924). Craftsman influence. One story frame with modern brick veneer and board and batten aluminum siding. Gable roof with asphalt shingle covering and telescoping facade gables. Three-over-one, four-over-four, and one-over four, double-hung, four light pivoting and twenty light fixed pane windows. Shed roof porch with tripled square wood columns. Divided four light transom and sidelight. Exterior side brick chimney. Brick veneer foundation. Irregular plan. Attached garage. (NC)

26. 3001 Gibbs Drive. (c. 1923). Queener House. Craftsman. One story frame with raised basement with brick veneer wall covering. Hip roof with lower cross gables, asphalt shingle roof covering and rectangular wood louvered attic vents. Six-over-six, double-hung and eight light casement windows. One story, one bay projecting facade porch with square wood columns and lattice inserts. Projecting bay on facade. Interior central brick chimney. Brick foundation. S.L. Queener, owner of the Queener Coal Company, lived here from 1923-1945. Irregular plan. (C)

United States Department of the Interior
National Park Service

National Register of Historic Places Continuation Sheet

Section number 7 Page 7

Gibbs Drive Historic District
Knox County, Tennessee

-
27. 3002 Gibbs Drive. (c. 1924). Bungalow with Craftsman influence. One and on-half story frame with brick veneer wall covering. Side gable roof with gable roof dormer and asphalt shingles on side walls. Asphalt shingle roof covering, knee braces and rafter tails. Five-over-one, three-over-one, six-over-one, and one-over-one, double-hung windows. One story, full width facade porch with battered wood columns on brick piers, arcaded pierced brick balustrade with concrete coping. Projecting bay on west elevation. Two brick chimneys: one exterior offset side, and one interior offset. Brick foundation. Irregular plan. (C)
- (c. 1924). One story frame garage with aluminum siding wall covering. Facade gable roof with asphalt shingle roof covering and rafters. (C)
28. 3005 Gibbs Drive. (c. 1925). Bungalow with Craftsman influence. One story frame with raised basement and weatherboard wall covering. Side gable roof with asphalt shingle roof covering, knee braces, rafters and kingpost truss in porch gable. One light casement windows. One story, one bay central facade porch with battered wood columns and brick piers. Projecting bay on south elevation. Exterior end brick chimney. Brick foundation. Irregular plan. (C)
- (c. 1925). One story frame garage with weatherboard wall covering. Facade gable roof with asphalt shingle roof covering. (C)
29. 3008 Gibbs Drive. (c. 1921). Craftsman. One and one-half story frame with brick veneer wall covering, and weatherboard in gable ends. Cross gable roof with telescoping facade gables, asphalt shingle roof covering, decorative sawn trim, wood louvered attic vent and knee braces. Eighteen-over-one, double-hung windows. One story full width facade porch with square tripled wood columns on brick piers, cast concrete coping. Ten light sidelights. Porte cochere west elevation. Unroofed porch on west end of facade. Exterior side brick chimney. Brick foundation. Irregular plan. (C)
- (c. 1921). One story frame garage with vertical board wall covering, gable roof with asphalt shingle roof covering. (C)
30. 3009 Gibbs Drive. (c. 1915). Bungalow influence. One and two story frame with raised basement and weatherboard wall covering. Side gable roof with lower hip roof extension, facade hip roof dormer, and asphalt shingle roof covering. Rafters and knee braces. One-over-one, and five-over-one, double-hung windows. One story full width facade porch with rusticated ashlar stone columns, sawn wood balustrade. Two-over-one entry sidelights. Interior offset brick chimney. Brick foundation. Irregular plan. Garage addition at side. (NC)
31. 3013 Gibbs Drive. (c. 1925). Minimal Traditional with Craftsman influence. One story frame with aluminum siding wall covering. Side gable roof with asphalt shingle roof covering, knee braces. Eight-over-eight, double-hung windows. One story, one bay facade porch with tripled wood columns with Doric capitals on brick piers, sawn wood balustrade. Two brick chimneys: one exterior

United States Department of the Interior
National Park Service

National Register of Historic Places Continuation Sheet

Section number 7 Page 8

Gibbs Drive Historic District
Knox County, Tennessee

end and one interior offset. Garage added to west elevation. Room added to east elevation. Brick foundation. Irregular plan. (NC)

32. 3016 Gibbs Drive. (c. 1930). Dutch Colonial Revival. Two story frame with aluminum siding and brick veneer wall covering. Gable roof with shed roof dormers and asphalt shingle roof covering. Four-over-four and six-over-six, double-hung windows. Gable roof façade porch with aluminum columns. Four light transom at facade entry. Exterior end brick chimney. Brick foundation. Irregular plan. (C)

(c. 1930). One story frame garage with aluminum siding wall covering. Gable roof with asphalt shingle roof covering. (C)

33. 3017 Gibbs Drive. (c. 1926). Colonial Revival. Two story frame with shiplap wood siding wall covering. Side gable roof with asphalt shingle roof covering. Six-over-six, double-hung windows. Facade stoop with broken pediment above facade entry. Eight light sidelights at facade entry. One story projecting bay on east elevation. Two interior offset brick chimneys. Brick foundation. Irregular plan. (C)

(c. 1926). One story rusticated ashlar stone garage. Side gable roof with asphalt shingle roof covering. (C)

34. 3020 Gibbs Drive. (c. 1926). Bungalow with Craftsman influence. One story frame with weatherboard wall covering. Facade gable roof with telescoping gables, knee braces, rafters and asphalt shingle roof covering. Asphalt wall covering in gable ends. Twelve-over-one and six-over-six, double-hung windows. One story, three-quarter width offset porch with brick columns with inset brick motif. Porte cochere on west elevation. Exterior offset side brick chimney. Brick foundation. Irregular plan. (C)

35. 3021 Gibbs Drive. (c. 1923). Bungalow with Craftsman influence. One and one-half story frame with asbestos shingle wall covering. Side gable roof with facade shed roof dormer, rafters and asphalt shingle roof covering. Four-over-one, double-hung windows. One story full width facade porch with battered wood columns with Doric capitals on brick piers. Replacement aluminum balustrade. Exterior end brick chimney. Brick foundation. Rectangular plan. (C)

(c. 1923). One story concrete block garage with facade gable roof. Asphalt shingle roof covering. (C)

36. 3022 Gibbs Drive. (c. 1925). Bungalow with Craftsman influence. One story frame with asbestos shingle wall covering. Gable roof with asphalt shingle wall covering on gable ends. Telescoping facade gable, louvered wood attic vent, asphalt shingle roof covering, knee braces and rafters. Nine-over-one, double-hung windows. One story, three-quarter width facade porch with battered brick columns on piers. Projecting bays on west and east elevations. Porte cochere on east elevation. Exterior offset side brick chimney. Irregular plan. (C)

United States Department of the Interior
National Park Service

National Register of Historic Places

Continuation Sheet

Section number 7 Page 9

Gibbs Drive Historic District
Knox County, Tennessee

(c. 1925). One story concrete block garage with facade gable roof covered with asphalt shingle roof covering. (C)

37. 3025 Gibbs Drive. (c. 1926). Minimal Traditional. One story frame with raised basement, newer brick and stone veneer wall covering. Cross gable roof with asphalt shingle roof covering. Four-over-one and three-over-one, double-hung windows. One story, one-half facade porch with aluminum columns and added stone parapet wall. Two light sidelights at facade entrance. Exterior end brick chimney. Brick foundation. Irregular plan. (NC)

38. 3026 Gibbs Drive. (c. 1939). Sandman House. Minimal Traditional. One story frame with aluminum siding wall covering. Side gable roof with extension on east elevation and asphalt shingle roof covering. Six-over-six, double-hung windows. Projecting, gable facade porch with Doric columns and wood balustrade. Porch addition on west elevation with Doric columns, wood balustrade, lattice inserts, dentil cornice at (flat) roof line. Interior central brick chimney. Brick chimney. Irregular plan. C.R. Sandman, owner of Sandman and Company (service station equipment) lived here from 1939-1948 and Fred Tallent, owner of Tallent Drug Store, lived here from 1948-1991. (C)

3029 Gibbs Drive. Vacant lot owned by 3025 Gibbs Drive.

39. 3030 Gibbs Drive. (c. 1938). Minimal Traditional. One story frame with raised basement and aluminum siding wall covering. Side gable roof with asphalt shingle roof covering. Six-over-six windows. Gable roof over facade stoop entry. Enclosed sun porch on east elevation with one-over-one, double-hung windows. Projecting bay on west elevation. Interior offset brick chimney. Brick foundation. Irregular plan. (C)

40. 3033 Gibbs Drive. (c. 1948). Minimal Traditional. One story frame with aluminum siding wall covering. Side gable roof with asphalt shingle roof covering. Two-over-two, double-hung replacement windows. One story facade porch with replacement aluminum columns. Brick interior offset chimney. Brick foundation. Irregular plan. (C)

(c. 1925). One story concrete block garage with flat roof attached to rear of house. (NC)

41. 3034 Gibbs Drive. (c. 1926). Bungalow with Craftsman influence. One story frame with aluminum siding wall covering. Facade gable roof with telescoping gable, asphalt shingle roof covering and knee braces. Three-over-one, double-hung windows. One story, half width facade porch with battered columns. Brick chimney and brick foundation. Irregular plan. From 1932-1990 C.M. Ramsey, owner of Ramsey Florist, lived here. (C)

(c. 1926). One story frame garage with aluminum siding wall covering. Gable roof with asphalt shingle roof covering. (C)

United States Department of the Interior
National Park Service

National Register of Historic Places Continuation Sheet

Section number 7 Page 10

Gibbs Drive Historic District
Knox County, Tennessee

-
42. 3035 Gibbs Drive. (c. 1926). Minimal Traditional with Colonial Revival influence. One story frame with raised basement and asbestos shingle wall covering. Side gable roof with asphalt shingle roof covering. Six-over-six, double-hung windows on facade. Façade stoop entry with pilasters. Exterior end brick chimney. Brick foundation. Rectangular plan. (C)
43. 3036 Gibbs Drive. (c. 1926). Minimal Traditional with Tudor Revival influence. One story frame with aluminum siding wall covering. Side gable roof with steep centered facade gable bay, two gable roof dormers on facade, and asphalt shingle roof covering. Nine-over-six, vinyl replacement windows. Facade stoop. Interior offset brick chimney. Brick foundation. Rectangular plan. (C)
44. 3037 Gibbs Drive. (c. 1948). Minimal Traditional. One story frame with raised basement and brick veneer wall covering. Side gable roof with asphalt shingle roof covering. Eight-over-eight, double-hung windows. Tripartite window on façade contains fixed, sixteen light center with flanking two-over-two panels. One bay, one story facade porch with square wood columns with Doric capitals. Projecting screened porch on east elevation. Interior end brick chimney. Brick foundation. Irregular plan. (C)
45. 3038 Gibbs Drive. (c. 1926). Bungalow with Craftsman influence. One story frame with aluminum siding wall covering. Facade gable roof with small extended side gables and asphalt shingle roof covering. Three-over-one, double-hung windows. One story full width facade porch with paired square wood columns and Doric capitals on brick piers. Interior offset brick chimney. Brick foundation. Irregular plan. (C)
- (c. 1926). One story frame garage with vertical board and brick veneer wall covering. Gable roof with asphalt shingle roof covering. (C)
46. 3039 Gibbs Drive. (c. 1985). Ranch. One story frame with brick veneer wall covering. Side gable roof with asphalt shingle roof covering. Six-over-six, double-hung aluminum windows. One story facade porch with brick columns. Screened porch on east elevation. Brick foundation. Irregular plan. (NC)
47. 3040 Gibbs Drive. (c. 1926). Bungalow. One and one-half story frame with rusticated, ashlar cast stone and weatherboard wall covering. Side gable roof with asphalt shingle roof covering. Three-over-one, double-hung windows, with flat lintels. Gable roof porch with replacement aluminum columns and balustrade. Interior offset brick chimney. Cast block foundation. Rectangular plan. (C)
48. 3041 Gibbs Drive. (c. 1920). Queen Anne cottage with Colonial Revival influence. One and one-half story frame with weatherboard wall covering. Pyramidal roof with hip roof dormers. Roof covered with oversize diamond asphalt shingles. One-over-one, double-hung windows. One story, three-quarter width facade porch with round wood, doubled and tripled columns with Doric capitals on stuccoed piers. Projecting bays on west and east elevations. Single light transom and sidelights at facade entry. Two interior offset brick chimneys. Stuccoed foundation. Irregular plan. (C)

United States Department of the Interior
National Park Service

National Register of Historic Places

Continuation Sheet

Section number 7 Page 11

Gibbs Drive Historic District
Knox County, Tennessee

(c. 1990) Two story frame garage with weatherboard wall covering, facade gable roof with asphalt shingle roof covering. Six-over-six, double-hung windows, brick foundation, and decorative wood attic vent. (NC)

49. 3044 Gibbs Drive. (c. 1921). Bungalow with Craftsman influence. One story frame with aluminum wall covering. Front gable roof with asphalt shingle roof covering. One-over-one, double-hung windows. One story, full width recessed facade porch with battered wood columns on brick piers. Single light transoms and sidelights. Exterior end brick chimney. Stuccoed foundation. Rectangular plan. (C)

(c. 1921). One story frame garage with aluminum siding wall covering. Mansard roof with asphalt shingle roof covering. (C)

50. 3045 Gibbs Drive. (c. 1947). Minimal Traditional with Tudor Revival influence. One and one-half story frame with brick veneer wall covering. Cross gable asphalt shingle roof. Eight-over-eight, double-hung windows. Diamond pane casement window at facade entry. Recessed facade entry with replacement aluminum balustrade. One story side porch on east elevation with square wood columns and sawn wood balustrade. Exterior facade brick chimney. Brick foundation. Irregular plan. (C)

(c. 1947). One story frame garage with brick veneer wall covering. Facade gable roof with asphalt shingle roof covering. (C)

51. 3046 Gibbs Drive. (c. 1941). Minimal Traditional. One story frame with asbestos shingle wall covering. Side gable roof with asphalt shingle roof covering. Eight-over-eight and six-over-six, double-hung windows. One story facade porch with knee braces supporting gable roof. End brick chimney. Brick foundation. Rectangular plan. (C)

52. 3047 Gibbs Drive. (c. 1910). Colonial Revival with Craftsman influence. Two story frame with asbestos shingle wall covering. Side gable roof with metal shingle roof covering, facade gable roof dormers with bargeboard. Three-over-one, double-hung windows. One story wrap around porch. Multi-diamond paned transom and sidelights at facade entry. Facade door has segmental arch light. Interior offset brick chimney. Brick foundation. Irregular plan. (C)

(c. 1910). One story frame garage with asbestos shingle wall covering. Facade gable roof with asphalt shingle roof covering. (C)

United States Department of the Interior
National Park Service

National Register of Historic Places Continuation Sheet

Section number 8 Page 12

Gibbs Drive Historic District
Knox County, Tennessee

STATEMENT OF SIGNIFICANCE

The Gibbs Drive Historic District is being nominated to the National Register of Historic Places under criterion A and C for its local significance in community planning and development and architecture. According to the Multiple Property Documentation Form (MPDF) context, *Suburban Growth and Development in Knoxville*, the district is representative of early twentieth century Knoxville residential development. The pattern of growth in the Gibbs Drive Historic District depicts the transition from streetcar suburb to automobile suburb. The district's wide sidewalks and long, straight grid street pattern are indicative of these developments. It is also a unique Knoxville example of the transition into the automobile era, which became prevalent in the city by the late 1920s. This is evident in the number of original garages, frame and brick, that prove the growing importance automobiles had during this period. The Gibbs Drive Historic District is a good example of the post-Victorian era, suburban development in Knoxville. It is a good representation of the building trends of the early to mid-twentieth century, when there was a return to simplified architecture and, often, smaller houses. This is most evident to the vast number of bungalow forms and Craftsman style influenced houses that dominate the block. In addition, the later Minimal Traditional style represent the building trends into the 1930s, 40s, and 50s. The district meets the registration requirements set forth in the MPDF.

Gibbs Drive is located in Fountain City, an area now included within the city limits of Knoxville. It is located in North Knoxville, approximately six miles from downtown, off of Broadway (U.S. 441) in Fountain City. However, Fountain City was, as late as the 1880s, a largely rural area dominated by farms. Originally called Fountain Head, it was far enough removed from the soot and grime of the industrial city to become a popular resort area. A large hotel with natural springs and a large lake became a popular spot for Knoxvilleans and others to get away from the ever-increasing noise and pollution of the city.

Fountain Head also became a popular area in which to build "country homes." The development in 1890 of the Fountain Head Railway, a mechanized streetcar system, allowed a simple means of transportation from the city to the country. The first cars were steam-driven, and the route was tagged "The Dummy Line." It ran north on Broadway from Emory Place to the Fountain Head Resort, with a number of stop along the way. Due to its popularity, Fountain Head's population began to grow, and it incorporated as Fountain City in 1891. Because of increased ease in access, combined with its bucolic setting, Fountain City began to experience a growing trend in subdivision. The "Dummy Line" was electrified in 1905 and offered even more efficient transportation through the Broadway area. A number of residential developments sprang up along the route of the Dummy Line.

Once known as Jackson Boulevard, the first house to have been constructed on Gibbs Drive predates the subdivision of the land. The circa 1910 Colonial Revival house at 3047 Gibbs Drive was built on the corner of Jackson (Gibbs) and Jacksboro Pike. That same year, on September 15, Charles Gibbs, Frank Maloney and G.W. Maloney, real estate and mortgage company partners, had the land surveyed and subdivided. The Gibbs and Maloney Addition to Fountain City was recorded on September 26, 1911. The subdivision required that only single family houses be built. The next building occurred with the construction of two houses in 1913. The bungalows at 2821 and 2836 Gibbs Drive were built that year.

United States Department of the Interior
National Park Service

National Register of Historic Places Continuation Sheet

Section number 8 Page 13

Gibbs Drive Historic District
Knox County, Tennessee

Throughout the rest of the second decade of the twentieth century, bungalows sprang up along this new development.

The popularity of the automobile in Knoxville became apparent and widespread during the 1920s. An increase in improved roads, the annexation of large land areas by the City of Knoxville in 1917 and general population growth spurred a second wave of suburbanization. Unlike the post-Civil War suburbanization, the newer suburbs were located far from downtown, in mostly remote rural areas. Growth in industry and manufacturing were no longer limited to the downtown region, and commercial areas sprang up to meet the need of the increasing suburban population.

The Gibbs Drive area continued to flourish throughout the 1920s. It is obvious that the automobile played an important role in its development, as is evident in the number of garages that were constructed along side or behind the homes. Approximately half of the houses in the district have extant historic garages. A number of local businessmen and business owners built houses or later moved into the district. One of the more notable is former Mayor George Dempster. Dempster's Neoclassical home at 2805 Gibbs Drive is the largest, and most visible structure in the neighborhood. It is located at the northwest corner of Gibbs Drive and Broadway. Dempster was considered a philanthropist and efficient politician in the Knoxville history books. However, his claim to fame is the invention, along with his brother, of the Dempster Dumpster, used today throughout the world.

The change in the architecture along Gibbs Drive mimics the changes from streetcar suburb to automobile suburb. The 1920s, 1930s and 1940s saw a shift from the bungalow and Craftsman influenced houses to the Colonial, Dutch and Tudor revival styles. Post World War II brought a proliferation of Minimalist Traditional styles, which were popularized in American magazines such as *Better Homes and Gardens* and *The Ladies' Home Journal*.

Of the fifty-two residences in the Gibbs Drive Historic District forty were built prior to 1930 and eleven were built between 1930 and 1950. The importance of Gibbs Drive as an extant example of early to mid-twentieth century architecture in Knoxville is undeniable. It retains integrity unlike few Knoxville neighborhoods. No demolition has occurred and only one house was constructed during the 1980s. The houses are in good to excellent condition, perhaps a tribute to the long term occupancy of many residents.

United States Department of the Interior
National Park Service

National Register of Historic Places Continuation Sheet

Section number 9 Page 14

Gibbs Drive Historic District
Knox County, Tennessee

MAJOR BIBLIOGRAPHICAL RESOURCES

Ames, David. *National Register Bulletin: A Context and Guidelines for Evaluating America's Historic Suburbs*. (draft) Washington, D.C.: The National Park Service, 1998.

Bennett, Ann. *Historic and Architectural Resources in Knoxville and Knox County, Tennessee*, (A Multiple Property Listing for the National Register of Historic Places.) Knoxville: Metropolitan Planning Commission, 1994.

"Dogwood Festival on Gibbs Drive." Volume 1, Issue 1. April 1997.

"Historic Gibbs Drive, Knoxville, Tennessee, 1997 Directory."

Winter, Robert and Alexander Vertikoff. *American Bungalow Style*. New York: Simon and Schuster, 1996.

United States Department of the Interior
National Park Service

National Register of Historic Places Continuation Sheet

Section number 10 Page 15

Gibbs Drive Historic District
Knox County, Tennessee

GEOGRAPHICAL DATA

VERBAL BOUNDARY DESCRIPTION

The Gibbs Drive Neighborhood includes all structures and outbuildings within the following boundaries: on the southwest by Broadway, on the northeast by Jacksboro Pike, on the northwest by Essary Drive and property boundaries and southeast by property boundaries.

BOUNDARY JUSTIFICATION

The boundaries include a collection of buildings and outbuildings with the confines of Gibbs Drive that retain historic integrity. The majority of the buildings were constructed over fifty years ago and there are few modern intrusions. The nominated district is surrounded by commercial development or later or scattered historic properties.

**United States Department of the Interior
National Park Service**

**National Register of Historic Places
Continuation Sheet**

Section number photos Page 16

Gibbs Drive Historic District
Knox County, Tennessee

PHOTOGRAPHS

Gibbs Drive Neighborhood
Knox County, Tennessee
Photographer: Cathryn Irwin, Knox Heritage, Inc.
Date of photographs and slides: July 1, 1999
Location of original negative: Tennessee Historical Commission

2805 Gibbs Drive, Facing Northwest
#1 of 52

2810 Gibbs Drive, Facing Southeast
#2 of 52

2811 Gibbs Drive, Facing Northwest
#3 of 52

2812 Gibbs Drive, Facing Southeast
#4 of 52

2815 Gibbs Drive, Facing Northwest
#5 of 52

2816 Gibbs Drive, Facing Southeast
#6 of 52

2820 Gibbs Drive, Facing Southeast
#7 of 52

2821 Gibbs Drive, Facing Northwest
#8 of 52

2824 Gibbs Drive, Facing Southeast
#9 of 52

2825 Gibbs Drive, Facing Northwest
#10 of 52

2828 Gibbs Drive, Facing Southeast
#11 of 52

2829 Gibbs Drive, Facing Northwest
#12 of 52

**United States Department of the Interior
National Park Service**

**National Register of Historic Places
Continuation Sheet**

Section number photos Page 17

Gibbs Drive Historic District
Knox County, Tennessee

2832 Gibbs Drive, Facing Southeast
#13 of 52

2833 Gibbs Drive, Facing Northwest
#14 of 52

2836 Gibbs Drive, Facing Southeast
#15 of 52

2837 Gibbs Drive, Facing Northwest
#16 of 52

2840 Gibbs Drive, Facing Southeast
#17 of 52

2841 Gibbs Drive, Facing Northwest
#18 of 52

2844 Gibbs Drive, Facing Southeast
#19 of 52

2845 Gibbs Drive, Facing Northwest
#20 of 52

2848 Gibbs Drive, Facing Southeast
#21 of 52

2849 Gibbs Drive, Facing Northwest
#22 of 52

2852 Gibbs Drive, Facing Southeast
#23 of 52

2855 Gibbs Drive, Facing Northwest
#24 of 52

3000 Gibbs Drive, Facing Southeast
#25 of 52

3001 Gibbs Drive, Facing Northwest
#26 of 52

**United States Department of the Interior
National Park Service**

**National Register of Historic Places
Continuation Sheet**

Section number photos Page 18

Gibbs Drive Historic District
Knox County, Tennessee

3002 Gibbs Drive, Facing Southeast
#27 of 52

3005 Gibbs Drive, Facing Northwest
#28 of 52

3008 Gibbs Drive, Facing Southeast
#29 of 52

3009 Gibbs Drive, Facing Northwest
#30 of 52

3013 Gibbs Drive, Facing Northwest
#31 of 52

3016 Gibbs Drive, Facing Southeast
#32 of 52

3017 Gibbs Drive, Facing Northwest
#33 of 52

3020 Gibbs Drive, Facing Southeast
#34 of 52

3021 Gibbs Drive, Facing Northwest
#35 of 52

3022 Gibbs Drive, Facing Southeast
#36 of 52

3025 Gibbs Drive, Facing Northwest
#37 of 52

3026 Gibbs Drive, Facing Southeast
#38 of 52

3030 Gibbs Drive, Facing Southeast
#39 of 52

3033 Gibbs Drive, Facing Northwest
#40 of 52

**United States Department of the Interior
National Park Service**

**National Register of Historic Places
Continuation Sheet**

Section number photos Page 19

Gibbs Drive Historic District
Knox County, Tennessee

3034 Gibbs Drive, Facing Southeast
#41 of 52

3035 Gibbs Drive, Facing Northwest
#42 of 52

3036 Gibbs Drive, Facing Southeast
#43 of 52

3037 Gibbs Drive, Facing Northwest
#44 of 52

3038 Gibbs Drive, Facing Southeast
#45 of 52

3039 Gibbs Drive, Facing Northwest
#46 of 52

3040 Gibbs Drive, Facing Southeast
#47 of 52

3041 Gibbs Drive, Facing Northwest
#48 of 52

3044 Gibbs Drive, Facing Southeast
#49 of 52

3045 Gibbs Drive, Facing Northwest
#50 of 52

3046 Gibbs Drive, Facing Southeast
#51 of 52

3047 Gibbs Drive, Facing Northwest
#52 of 52

United States Department of the Interior
National Park Service

National Register of Historic Places Continuation Sheet

Section number owners Page 20

Gibbs Drive Historic District
Knox County, Tennessee

2805 Gibbs Drive

Lena Duke Francis
2805 Gibbs Drive
Knoxville, TN 37918

2810 Gibbs Drive

Dennis C. Black
2810 Gibbs Drive
Knoxville, TN 37918

2811 Gibbs Drive

Barry R. Fernandez and Donna L. Cragle
2811 Gibbs Drive
Knoxville, TN 37918

2812 Gibbs Drive

Denny R. Koontz and Barry W. Robertson
2812 Gibbs Drive
Knoxville, TN 37918

2815 Gibbs Drive

Sonya J. and David J. Weber
2815 Gibbs Drive
Knoxville, TN 37918

2816 Gibbs Drive

Stephen R. Bales
2816 Gibbs Drive
Knoxville, TN 37918

2820 Gibbs Drive

James H. and Clara H. Barton
2820 Gibbs Drive
Knoxville, TN 37918

2821 Gibbs Drive

Kenneth and Kathy D. Clonninger
2821 Gibbs Drive
Knoxville, TN 37918

2824 Gibbs Drive

Mary Elizabeth and Gregory McDonald
2824 Gibbs Drive
Knoxville, TN 37918

2825 Gibbs Drive

Sarah Bommelje
2825 Gibbs Drive
Knoxville, TN 37918

2828 Gibbs Drive

Mamie T. Robinson
2828 Gibbs Drive
Knoxville, TN 37918

2829 Gibbs Drive

Opal Butler Hammer
2829 Gibbs Drive
Knoxville, TN 37918

2832 Gibbs Drive

Manus E. Henegar, Jr., and Ruth Henegar
2832 Gibbs Drive
Knoxville, TN 37918

2833 Gibbs Drive

M. R. and Ida Wood
2833 Gibbs Drive
Knoxville, TN 37918

2836 Gibbs Drive

Anna M. Thompson
2836 Gibbs Drive
Knoxville, TN 37918

2837 Gibbs Drive

Nelda A. Hill
2837 Gibbs Drive
Knoxville, TN 37918

United States Department of the Interior
National Park Service

National Register of Historic Places Continuation Sheet

Section number owners Page 21

Gibbs Drive Historic District
Knox County, Tennessee

2840 Gibbs Drive

Paul E. and Mary J. Galyan
2840 Gibbs Drive
Knoxville, TN 37918

2841 Gibbs Drive

Jeffrey and Marilew Bartling
2841 Gibbs Drive
Knoxville, TN 37918

2844 Gibbs Drive

Stephen and Franstine Weaver
2844 Gibbs Drive
Knoxville, TN 37918

2845 Gibbs Drive

David A. and Frances Nichols
2845 Gibbs Drive
Knoxville, TN 37918

2848 Gibbs Drive

Paul J. and Ellen K. F. Wolf
2848 Gibbs Drive
Knoxville, TN 37918

2849 Gibbs Drive

James A. Brennan
2849 Gibbs Drive
Knoxville, TN 37918

2852 Gibbs Drive

Amanda B. and Thomas E. Aldmon
5121 Stanton Road
Knoxville, TN 37918

2855 Gibbs Drive

Glenn and Sarah Biggs
2855 Gibbs Drive
Knoxville, TN 37918

3000 Gibbs Drive

Audrey L. and A. C. Rochat
5412 Gaineswood
Drive Knoxville, TN 37918

3001 Gibbs Drive

Betty Korter Horner
3001 Gibbs Drive
Knoxville, TN 37918

3002 Gibbs Drive

Timothy Helton
2523 Adair Drive
Knoxville, TN 37917

3005 Gibbs Drive

Bart Monroe
3005 Gibbs Drive
Knoxville, TN 37918

3008 Gibbs Drive

Anthony John Smith
3008 Gibbs Drive
Knoxville, TN 37918

3009 Gibbs Drive

James H. Huffinan
3009 Gibbs Drive
Knoxville, TN 37918

3013 Gibbs Drive

Paul A. and Nancy S. Dickinson
3013 Gibbs Drive
Knoxville, TN 37918

3016 Gibbs Drive

James M. Welch
3016 Gibbs Drive
Knoxville, TN 37918

United States Department of the Interior
National Park Service

National Register of Historic Places Continuation Sheet

Section number owners Page 22

Gibbs Drive Historic District
Knox County, Tennessee

3017 Gibbs Drive

Steven and Mary Muffer
3017 Gibbs Drive
Knoxville, TN 37918

3020 Gibbs Drive

Kelly W. Frye
3020 Gibbs Drive
Knoxville, TN 37918

3021 Gibbs Drive

Jimmy L. Lowell
3021 Gibbs Drive
Knoxville, TN 37918

3022 Gibbs Drive

Brian Christian and Gina Kincaid
3022 Gibbs Drive
Knoxville, TN 37918

3025 Gibbs Drive:

Albert L. Ogg
c/o Carolyn F. Riggs
3002 Sanders Lane
Knoxville, TN 37918

3026 Gibbs Drive

Wayne Prosser
3026 Gibbs Drive
Knoxville, TN 37918

3029 Gibbs Drive (lot)

Albert L. Ogg
c/o Carolyn F. Riggs
3002 Sanders Lane
Knoxville, TN 37918

3030 Gibbs Drive:

Darrell Waldrop and Rosemarie Waldrop
3030 Gibbs Drive
Knoxville, TN 37918

3033 Gibbs Drive:

Harry Hornbecker
c/o William S. Hornbecker
5204 Penelope Lane
Knoxville, TN 37918-3033

3034 Gibbs Drive

John B. Limek
3034 Gibbs
Drive Knoxville, TN 37918

3035 Gibbs Drive

Jerry Trivette and Judith Needham
3035 Gibbs Drive
Knoxville, TN 37918

3036 Gibbs Drive

Monty L. Walton
3036 Gibbs Drive
Knoxville, TN 37918

3037 Gibbs Drive

Bertha T. Hicks
3037 Gibbs Drive
Knoxville, TN 37918

3038 Gibbs Drive

Marilyn Hammond, James M. Bird and Julia Conyer
4210 Willowbrook Lane
Rockford, TN 37835

3039 Gibbs Drive

Herbert A. and Wanda H. Buel
3039 Gibbs Drive
Knoxville, TN 37918

3040 Gibbs Drive

John H. Ellis, Jr.
512 Roth Road
Sevierville, TN 37876-9131

United States Department of the Interior
National Park Service

National Register of Historic Places

Continuation Sheet

Section number owners Page 23

Gibbs Drive Historic District
Knox County, Tennessee

3041 Gibbs Drive

Stephen and Vicky Ferguson
3041 Gibbs Drive
Knoxville, TN 37918

3044 Gibbs Drive

William H. and Mary Sue Hill
3044 Gibbs Drive
Knoxville, TN 37918

3045 Gibbs Drive

George W. Scott and Mary Beth Leidig
3045 Gibbs Drive
Knoxville, TN 37918

3046 Gibbs Drive

Ernest N. and Zane B. Conner
3046 Gibbs Drive
Knoxville, TN 37918

3047 Gibbs Drive

Stuart A. Currie
3047 Gibbs Drive
Knoxville, TN 37918

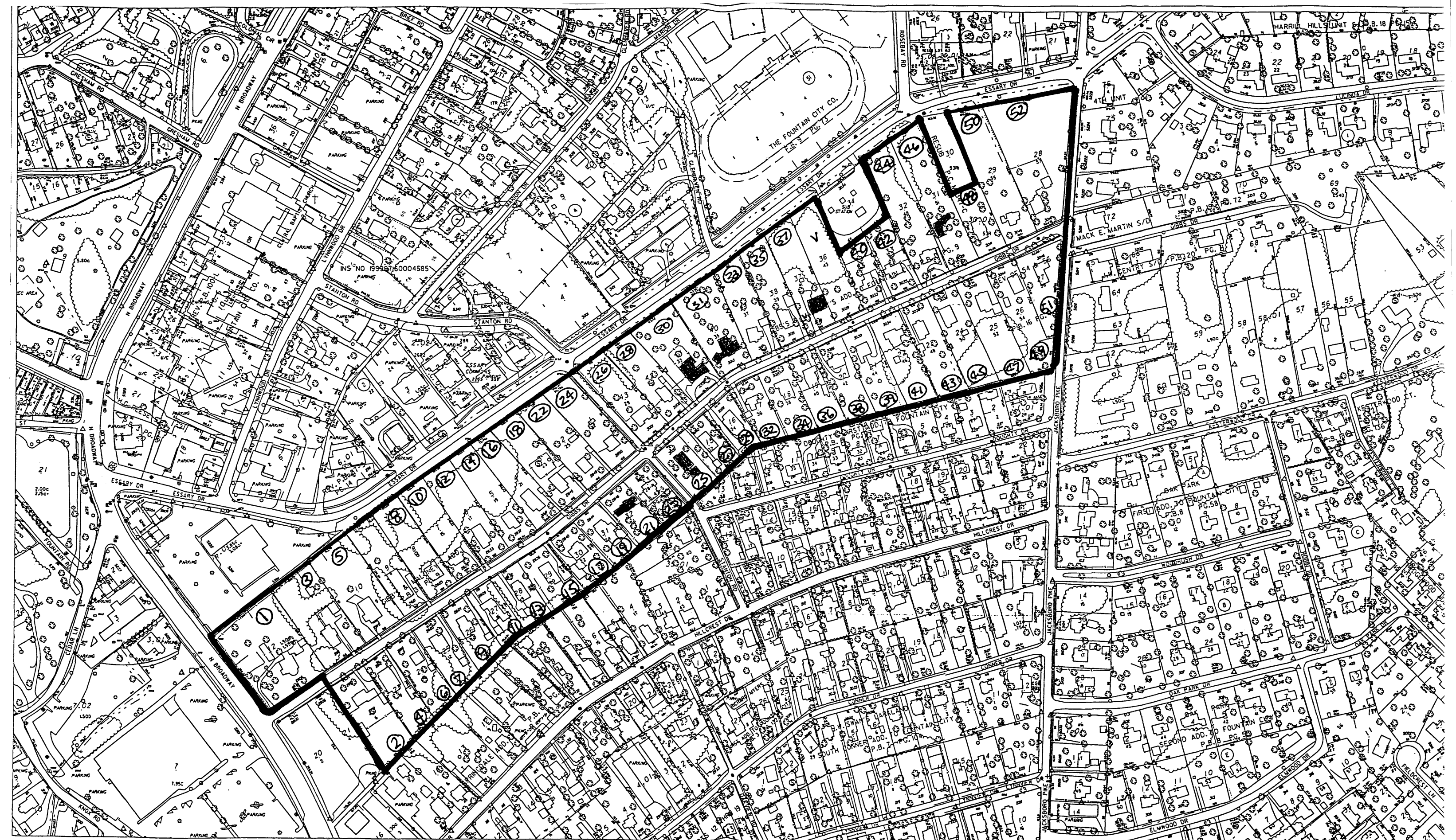

Parcel Number : 058EB016
 Scale : 1 in = 275 ft
 3-Aug-2000

Gibbs Drive Historic District
 Knox County TN
 ■ noncontributing
 □ contributing

Geographic Information System
 Services Division
 © COPYRIGHT 1996



Metropolitan Planning Commission
 400 Main Street
 Suite 403 City County Building
 Knoxville, Tennessee 37902