

KENTUCKY HISTORIC RESOURCES INVENTORY

Js-136

1. Historic Name (s) <p style="text-align: center;">Keene Springs Hotel</p>		22. ADD/County <p style="text-align: center;">Bluegrass/Jessamine</p>																												
Original Owner <p style="text-align: center;">Mason Singleton, Jr.</p>		23. Zoning Classification <p style="text-align: center;">Magisterial District</p>																												
Present Name <p style="text-align: center;">Keene Springs Hotel</p>		24. U.S.G. S. Quadrant (15'/75') <p style="text-align: center;">Keene</p>																												
3. Owner's Name <p style="text-align: center;">J. R. Wilson, Jr.</p>		25. UTM Reference <table style="width:100%; border-collapse: collapse;"> <tr> <td style="border: 1px solid black; padding: 2px;">1</td> <td style="border: 1px solid black; padding: 2px;">6</td> <td style="border: 1px solid black; padding: 2px;">7</td> <td style="border: 1px solid black; padding: 2px;">0</td> <td style="border: 1px solid black; padding: 2px;">8</td> <td style="border: 1px solid black; padding: 2px;">5</td> <td style="border: 1px solid black; padding: 2px;">0</td> <td style="border: 1px solid black; padding: 2px;">0</td> <td style="border: 1px solid black; padding: 2px;">4</td> <td style="border: 1px solid black; padding: 2px;">2</td> <td style="border: 1px solid black; padding: 2px;">0</td> <td style="border: 1px solid black; padding: 2px;">2</td> <td style="border: 1px solid black; padding: 2px;">0</td> <td style="border: 1px solid black; padding: 2px;">2</td> <td style="border: 1px solid black; padding: 2px;">0</td> </tr> <tr> <td colspan="4" style="text-align: center; font-size: small;">Zone</td> <td colspan="4" style="text-align: center; font-size: small;">Easting</td> <td colspan="4" style="text-align: center; font-size: small;">Northing</td> </tr> </table>		1	6	7	0	8	5	0	0	4	2	0	2	0	2	0	Zone				Easting				Northing			
1	6	7	0	8	5	0	0	4	2	0	2	0	2	0																
Zone				Easting				Northing																						
4. Owner's Address <p style="text-align: center;">Keene, 40339</p>		26. Prehistoric Site <p style="text-align: center;">Historic Site</p>																												
5. Location <p style="text-align: center;">Keene, Kentucky</p>		Object <p style="text-align: center;">Building</p>																												
6. Open to Public Yes <input type="checkbox"/> No <input checked="" type="checkbox"/>	7. Visible from road Yes <input checked="" type="checkbox"/> No <input type="checkbox"/>	8. Ownership Private <input checked="" type="checkbox"/> Local <input type="checkbox"/> State <input type="checkbox"/> Federal <input type="checkbox"/>																												
9. Local Contact/Organization		27. District Yes <input type="checkbox"/> No <input checked="" type="checkbox"/>																												
10. Site Plan with North Arrow Attached Boundary contains the hotel, dairy, smoke house, wood house, outhouse, and Delco shed (ca.1900). See Attached Sheet		28. Significance Evaluation <p style="text-align: center;">National Register</p>																												
11. Architect		29. Status <table style="width:100%; border-collapse: collapse;"> <tr> <td style="width:70%;">National Landmark</td> <td style="width:5%;"><input type="checkbox"/></td> <td style="width:25%;">Date</td> </tr> <tr> <td>National Register</td> <td><input type="checkbox"/></td> <td></td> </tr> <tr> <td>Landmark Certificate</td> <td><input type="checkbox"/></td> <td></td> </tr> <tr> <td>Kentucky Survey</td> <td><input checked="" type="checkbox"/></td> <td>11/18/71</td> </tr> <tr> <td>Local Landmark</td> <td><input type="checkbox"/></td> <td></td> </tr> <tr> <td>HABS/HAER</td> <td><input type="checkbox"/></td> <td></td> </tr> </table>		National Landmark	<input type="checkbox"/>	Date	National Register	<input type="checkbox"/>		Landmark Certificate	<input type="checkbox"/>		Kentucky Survey	<input checked="" type="checkbox"/>	11/18/71	Local Landmark	<input type="checkbox"/>		HABS/HAER	<input type="checkbox"/>										
National Landmark	<input type="checkbox"/>	Date																												
National Register	<input type="checkbox"/>																													
Landmark Certificate	<input type="checkbox"/>																													
Kentucky Survey	<input checked="" type="checkbox"/>	11/18/71																												
Local Landmark	<input type="checkbox"/>																													
HABS/HAER	<input type="checkbox"/>																													
12. Builder		30. Theme Primary <u>health spas/hotel</u> Secondary <u>architecture</u> Other <u>log houses</u>																												
13. Date <p style="text-align: center;">1843*/ mid-19th c.</p>		31. Endangered Yes <input type="checkbox"/> No <input checked="" type="checkbox"/>																												
14. Style <p style="text-align: center;">Greek Revival</p>		32.																												
15. Original Use <p style="text-align: center;">hotel</p>		ATTACH PHOTO																												
16. Present Use <p style="text-align: center;">none</p>		Roll No. <u>55</u> Picture No. _____ Direction _____																												
17. Condition Interior <u>good</u> Exterior <u>good</u>		33. Tape No. _____ Negative No. _____																												
18. Description 2-story, 5-bay house on E. end moved to site in 1843 — hotel built to link this block with log houses on W. end of site; ballroom on 2nd floor (gone) of central block and dining hall on 1st floor; decorative iron balcony spans central block on front and rear.		34. Prepared by: <p style="text-align: center;">NCP-KTG-ACW</p>																												
19. History Cholera epidemics of 1833 and 1849 brought Lexington residents to Keene's white sulphur spring through the 1860s. 1877 atlas - Sandusky and Hughes - hotel and store		35. Organization <p style="text-align: center;">KHC</p>																												
20. Significance Social/Health: this resort hotel is the only spa in the county and one of very few health spas from the mid-19th century in the state; it is a significant reminder of the American spa-resort movement of the early and mid-19th century.		36. Date <p style="text-align: center;">summer 1977</p>																												
21. Source of Information 1971 survey form; J. Winston Coleman, <u>Historic Ky</u> , p. 192; 1967 survey form; National Register files.		37. Revision Dates _____ 38. Staff Review _____																												

KENTUCKY HISTORIC RESOURCE INVENTORY SUPPLEMENT
BOUNDARY AND LOCATION INFORMATION

Historic Property Name Kenn Springs Hotel Site # JA 136
Multiple Resource/Thematic Nomination Title M.R. of Jess. Co.

U.T.M. Coordinates - List multiple UTM's if property is ten or more acres.

A. 16 708500 4202020 D. _____
B. _____ E. _____
C. _____ F. _____

Verbal Boundary Description Acreage 1.12 acres

Beginning at A, at the corner of the lane beside the hotel and the road, thence W 270 ft, N 180 ft to the fence behind the hotel, E 270 ft to the lane, and S 180 ft to the beginning, containing the hotel, dairy, smoke house, wood house, ~~see~~ out house, and Delco plant.

Sketch of Site Plan (Showing outbuildings, structures, landscape features and the site boundary as described above.)

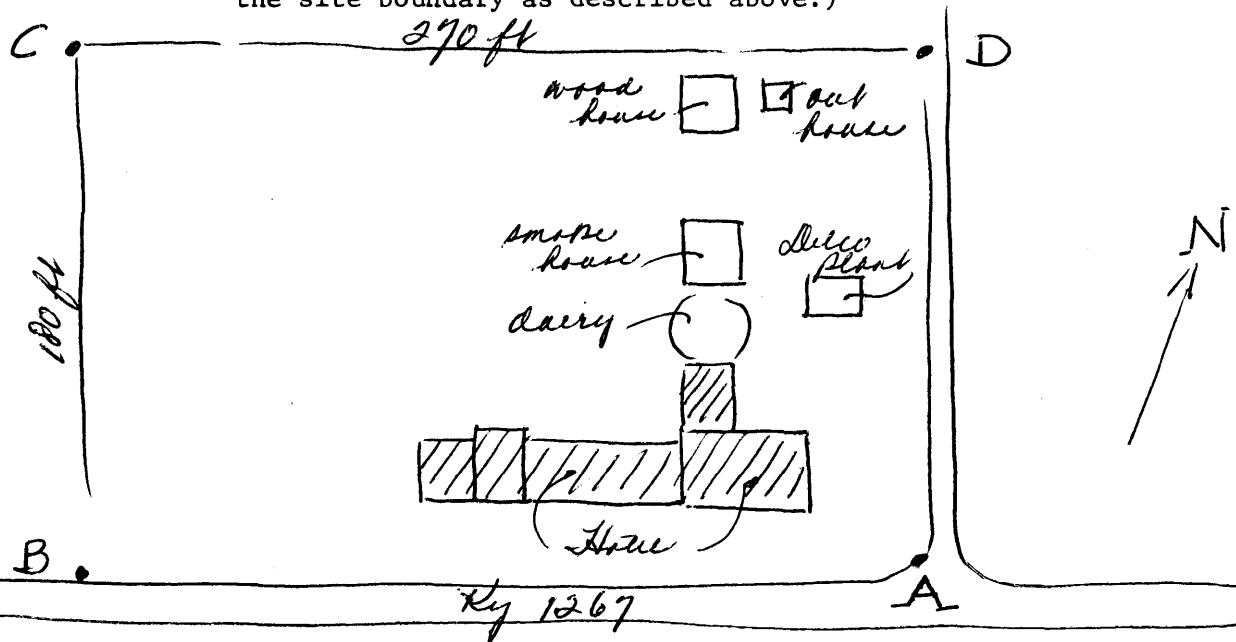

Official Courthouse Property Reference: