

**United States Department of the Interior  
National Park Service**

For NPS use only

**National Register of Historic Places  
Inventory—Nomination Form**

received NOV 7 1985  
date entered

See instructions in *How to Complete National Register Forms*  
Type all entries—complete applicable sections

DEC 19 1985

**1. Name**

historic West Virginia University Neo-Classical Revival Buildings, Thematic Grouping  
and/or common Oglebay Hall

**2. Location**

street & number University Avenue \_\_\_\_\_ not for publication  
city, town Morgantown \_\_\_\_\_ vicinity of  
state West Virginia code 54 county Monongalia code 061

**3. Classification**

Category	Ownership	Status	Present Use
<input type="checkbox"/> district	<input checked="" type="checkbox"/> public	<input checked="" type="checkbox"/> occupied	<input type="checkbox"/> agriculture
<input checked="" type="checkbox"/> building(s)	<input type="checkbox"/> private	<input type="checkbox"/> unoccupied	<input type="checkbox"/> commercial
<input type="checkbox"/> structure	<input type="checkbox"/> both	<input type="checkbox"/> work in progress	<input checked="" type="checkbox"/> educational
<input type="checkbox"/> site	<b>Public Acquisition</b>	<b>Accessible</b>	<input type="checkbox"/> entertainment
<input type="checkbox"/> object	<u>N/A</u> in process	<input checked="" type="checkbox"/> yes: restricted	<input type="checkbox"/> government
	<input type="checkbox"/> being considered	<input type="checkbox"/> yes: unrestricted	<input type="checkbox"/> industrial
<u>Thematic Group</u>		<input type="checkbox"/> no	<input type="checkbox"/> military
			<input type="checkbox"/> museum
			<input type="checkbox"/> park
			<input type="checkbox"/> private residence
			<input type="checkbox"/> religious
			<input type="checkbox"/> scientific
			<input type="checkbox"/> transportation
			<input type="checkbox"/> other:

**4. Owner of Property**

name West Virginia Board of Regents  
street & number P. O. Box 3368  
city, town Charleston \_\_\_\_\_ vicinity of \_\_\_\_\_ state WV 25333

**5. Location of Legal Description**

courthouse, registry of deeds, etc. Monongalia County Courthouse  
street & number High Street at Courthouse Square  
city, town Morgantown \_\_\_\_\_ state WV

**6. Representation in Existing Surveys**

title Historic Properties Inventory (HPU) has this property been determined eligible?  yes  no  
date May 1983 \_\_\_\_\_ federal \_\_\_\_\_ state \_\_\_\_\_ county \_\_\_\_\_ local  
depository for survey records History Department, West Virginia University  
city, town Morgantown \_\_\_\_\_ state WV

---

## 7. Description

---

<b>Condition</b>		<b>Check one</b>	<b>Check one</b>
<input type="checkbox"/> excellent	<input type="checkbox"/> deteriorated	<input checked="" type="checkbox"/> unaltered	<input checked="" type="checkbox"/> original site
<input checked="" type="checkbox"/> good	<input type="checkbox"/> ruins	<input type="checkbox"/> altered	<input type="checkbox"/> moved date <u>          N/A          </u>
<input type="checkbox"/> fair	<input type="checkbox"/> unexposed		

---

### Describe the present and original (if known) physical appearance

Oglebay Hall was completed in 1918 and presents an imposing sight in the center of West Virginia University's downtown campus as an example of Neo-Classical Revival architecture, combining brick and concrete to give the building a look of solidity.

Large air vents top the almost flat hip roof. An unadorned concrete roofline tops the third story. Four massive Roman Doric columns support the front pediment with a false, concrete railing at the third story and the building name engraved in the entablature. A concrete cornice separates the second and third story windows. Concrete architraves top the double brick pilasters at the corners of the building. There is a concrete water table over the high basement, and high concrete stairs with brick railings lead to the front of the building. A unique feature of the building is the book-like designs in the concrete between the first and second story windows. Windows have 6/1 lights and are framed by concrete.

The building's interior features plaster walls, wood doors and frames, and tiled concrete floors. There are enclosed stairways at each end of the building, and interior hallways run lengthwise down the center of the rows of classrooms and offices.

Oglebay Hall's Neo-Classical Revival style is based to a large extent on Roman architectural designs. The pediment and columns follow Roman designs. Massive pilasters at regular intervals on the facade and the symmetrical arrangement of the building follow the Neo-Classical Revival style. The common bond brick exterior and 6/1 light windows vary from usual Neo-Classical Revival features of smooth stone finishes and single-light windows.

## 8. Significance

Period	Areas of Significance—Check and justify below			
___ prehistoric	___ archeology-prehistoric	___ community planning	___ landscape architecture	___ religion
___ 1400-1499	___ archeology-historic	___ conservation	___ law	___ science
___ 1500-1599	<input checked="" type="checkbox"/> agriculture	___ economics	___ literature	___ sculpture
___ 1600-1699	<input checked="" type="checkbox"/> architecture	<input checked="" type="checkbox"/> education	___ military	___ social/
___ 1700-1799	___ art	___ engineering	___ music	___ humanitarian
___ 1800-1899	___ commerce	___ exploration/settlement	___ philosophy	___ theater
<input checked="" type="checkbox"/> 1900-	___ communications	___ industry	___ politics/government	___ transportation
		___ invention		___ other (specify)

**Specific dates** 1918 **Builder/Architect** Unknown

### Statement of Significance (in one paragraph)

Oglebay Hall, originally West Virginia University's agricultural building, represents the university's heritage as a land-grant institution established for the study of agricultural sciences; it stands at the center of the downtown campus and is one of the most imposing buildings on the university campus. Its plaza has become a center for ceremonies as well as a memorial to the USS West Virginia which sank during the Pearl Harbor attack.

The building was completed in 1918 and named for Board of Regents member E. W. Oglebay in order to induce a donation from Oglebay on behalf of the university. That ploy failed.

E. W. Oglebay was an influential West Virginia Republican who maintained his political base in Cleveland, Ohio, and allied himself with railroad magnate Sen. Stephen B. Elkins. He had a great interest in agriculture and owned a large farm near Wheeling which was eventually bestowed to the City of Wheeling for use as a park, while his mansion is now administered by Oglebay Institute as a museum, Oglebay was an alumnus and trustee Bethany College near Wheeling. Thus, he preferred to bestow gifts upon his alma mater. He donated a farm to the college and built Oglebay Hall of Agriculture on the Bethany campus. However, West Virginia University attempted to use its advantage as the state's leading agriculture research center to play upon Oglebay's interests in agriculture and generosity. As part of its effort to win his favor, WVU conferred an honorary doctorate on him in 1919.

The College of Agriculture vacated Oglebay Hall in 1961 and moved to a new building on the Evansdale campus. Since 1962, Oglebay has been used for offices and classrooms and currently houses the psychology department. The mast and ship's bell from the USS West Virginia stand in front of the building and make that plaza a West Virginia memorial to its war dead.

Oglebay Hall sits imposingly at the center of the downtown West Virginia University campus visibly from just about every vista. The Neo-Classical Revival style is evident in the four Roman Doric columns that support the front pediment and the balustrade at the top. Its mass and setting make it the focal point of campus.

# 9. Major Bibliographical References

See continuation sheet.

# 10. Geographical Data

Acreeage of nominated property 1 1/2 acre

Quadrangle name Morgantown North, WV

Quadrangle scale 1:24000

UTM References

A 

1	7	5	8	9	7	2	0	4	3	8	7	8	2	0
Zone				Easting				Northing						

B 

Zone				Easting				Northing						

C 

Zone				Easting				Northing						

D 

Zone				Easting				Northing						

E 

Zone				Easting				Northing						

F 

Zone				Easting				Northing						

G 

Zone				Easting				Northing						

H 

Zone				Easting				Northing						

Verbal boundary description and justification

See continuation sheet.

List all states and counties for properties overlapping state or county boundaries

state N/A code county code

state code county code

# 11. Form Prepared By

name/title Randall Gooden and Mortar Board senior honorary (Elizabeth Moore Hall)

organization WVU Public History Option date July 19, 1985

street & number Dept. of History, West Virginia Univ. telephone 304-293-2421

city or town Morgantown state WV

# 12. State Historic Preservation Officer Certification

The evaluated significance of this property within the state is:

national  state  local

As the designated State Historic Preservation Officer for the National Historic Preservation Act of 1966 (Public Law 89-665), I hereby nominate this property for inclusion in the National Register and certify that it has been evaluated according to the criteria and procedures set forth by the National Park Service.

State Historic Preservation Officer signature *Ann M. J...*  
title Deputy State Historic Preservation Office date 10/28/85

For NPS use only  
I hereby certify that this property is included in the National Register  
*Patrick Andrews* date 12/19/85  
Keeper of the National Register  
Attest: \_\_\_\_\_ date \_\_\_\_\_  
Chief of Registration

**United States Department of the Interior  
National Park Service**

**National Register of Historic Places  
Inventory—Nomination Form**

For NPS use only

received

date entered

Continuation sheet WVU Neo-Classical Revival Item number 9 Page 2  
Oglebay Hall

Boundary descriptions and floor plans from files of WVU Facilities Planning and Management Office

Amber, Charles Henry. A History of Education in West Virginia from Early Colonial Times to 1949. Huntington, WV: Standard Printing & Publishing Co., Inc., 1951.

Doherty, William T. and Summers, Festus P. West Virginia University: Symbol of Unity in a Sectionalized State. Morgantown, WV: West Virginia University Press, 1982.

Core, Earl L. The Monongalia Story: A Bicentennial History. Vol. 3. Discord. Parsons, WV: McClain Printing Co., 1979.

Core, Earl L. The Monongalia Story: A Bicentennial History. Vol. 4. Industrialization. Parsons, WV: McClain Printing Co., 1982.

**United States Department of the Interior  
National Park Service**

**National Register of Historic Places  
Inventory—Nomination Form**

For NPS use only

received

date entered

Continuation sheet WVU Neo-Classical Revival Item number 10

Page 2

Verbal Boundary Description and Justification

Oglebay Hall

From point of beginning follow College Avenue 438 feet southwest to juncture of College Avenue and University Avenue, thence following University Avenue 288 feet to point, thence 54 feet southeast to Point, thence following driveway 215 feet northeast to point, thence 129 feet southeast to Point of Beginning. (See attached maps)

**United States Department of the Interior  
National Park Service**

**National Register of Historic Places  
Inventory—Nomination Form**



**Continuation sheet** Verbal Boundary Description **Item number** **Page** 1

---

Oglebay Hall  
Boundary

Beginning at the south east common corner of deed book 585 page 221 and deed book 23 page 332 then S 39° 30' W 30' to a point on edge of curb of College Avenue then along the same curb S 34° 00' W 438 to the beginning of curve on edge of curb then 57' around curve then N 11° 30' E 288' along edge of curb then S 66° 00' E 54' then N 24° 00' E 215' then s 54° 00' E 129' to the point of beginning containing 1.15 acres and being a part of those lands described in deed book 23 page 332 and deed book 24 page 18 as recorded in the office of the County Clerk Monongalia County Court House.

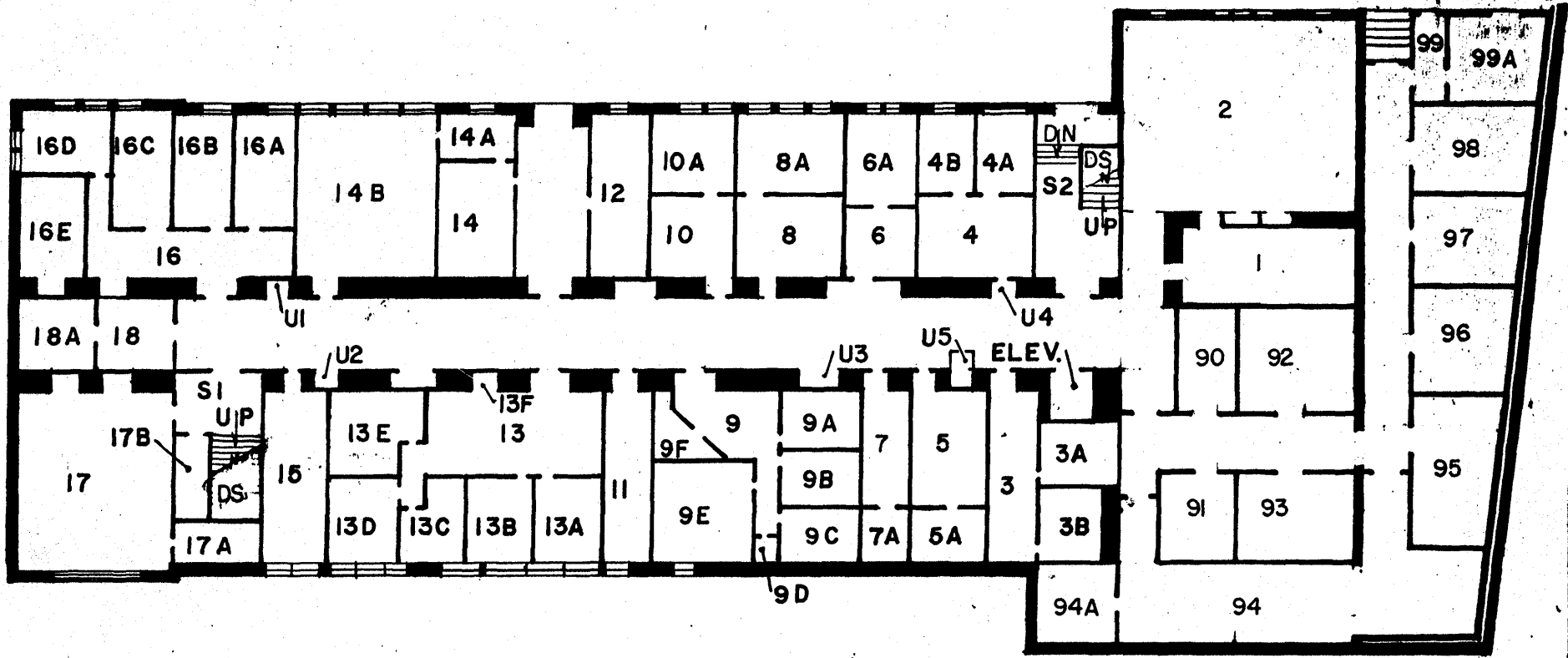

**GROUND FLOOR PLAN**

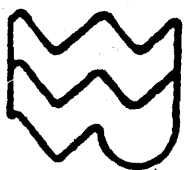
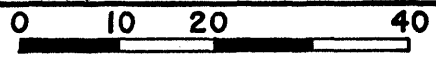

**WEST VIRGINIA UNIVERSITY**

**OGLEBAY HALL  
DOWNTOWN CAMPUS**

**BLDG. NO.  
01036**

OFFICE OF THE UNIVERSITY ARCHITECT

J. RIGGS J.E.  
8-14-1978 8-82



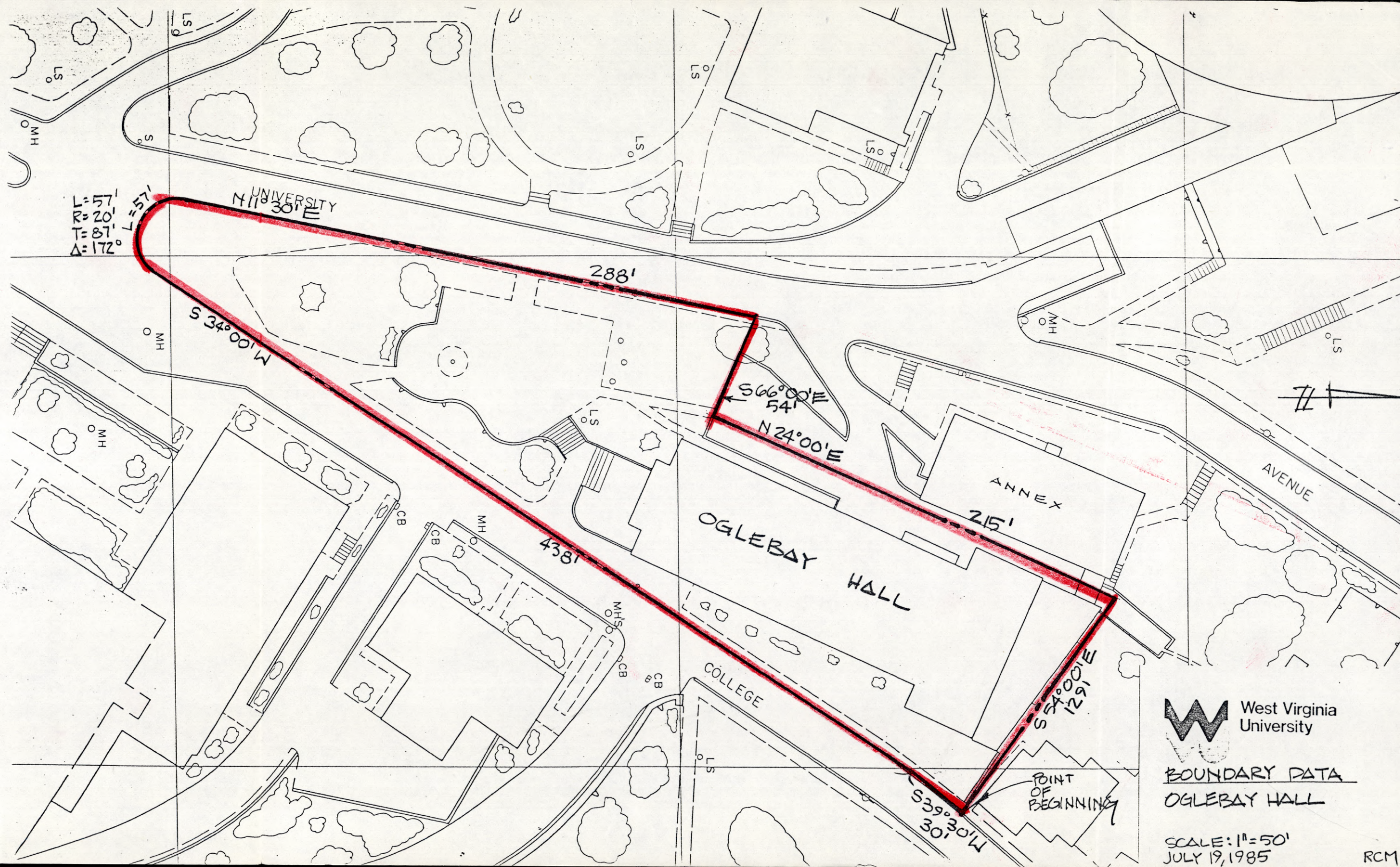

$L=57'$   
 $R=20'$   
 $T=87'$   
 $\Delta=172^\circ$

UNIVERSITY  
 $N 11^\circ 30' E$

288'

$S 34^\circ 00' W$   
 M 100° 00' W

$S 66^\circ 00' E$   
 54'

$N 24^\circ 00' E$

438'

OGLEBAY HALL

ANNEX

215'

$S 54^\circ 00' E$   
 129'

$S 39^\circ 30' W$   
 30'

POINT OF BEGINNING

AVENUE

COLLEGE

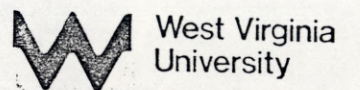

BOUNDARY DATA  
 OGLEBAY HALL

SCALE: 1"=50'  
 JULY 19, 1985

RCM