

United States Department of the Interior
National Park Service

National Register of Historic Places
Continuation Sheet

Section number 7 Page 14

Building: Railroad Cottage Historic District

Location: 601-629 South Casino Center
Las Vegas, Clark County, Nevada

Township/Range/Section: T20S, R61E, 34

Current Owner(s):

601 South Casino Center
David H. Miller, et al.
934 Redway
Houston, Texas 77062

Lots 1, 2, Block 24, Clark's Las Vegas
Townsite

605 South Casino Center
Lloyd L. Leettig
605 South Casino Center
Las Vegas, Nevada 89101

Lots 3, 4, Block 24, Clark's Las Vegas
Townsite

609 South Casino Center
Vito & Gilberte Lombardo
2100 East Oakey
Las Vegas, Nevada 89104

Lots 5, 6, Block 24, Clark's Las Vegas
Townsite

613 South Casino Center
Pacheco Family Trust
613½ South Casino Center
Las Vegas, Nevada 89101

Lots 7, 8, Block 24, Clark's Las Vegas
Townsite

617 South Casino Center
Muriel E. Smith
617 South Casino Center
Las Vegas, Nevada 89101

Lots 9, 10, Block 24, Clark's Las Vegas
Townsite

621 South Casino Center
Paul M. Sprague
3217 Burnham
Las Vegas, Nevada 89109

Lots 11, 12, Block 24, Clark's Las Vegas
Townsite

8/18/87

United States Department of the Interior
National Park Service

National Register of Historic Places
Continuation Sheet

Section number 7 Page 15

Railroad Cottage Historic District
601-629 South Casino Center
Las Vegas, Nevada

625 S. Casino Center

Ramonia Bell and Dennis Ellestad Lots 13,14, Block 24 Clark's
2501 E. Cheyenne Las Vegas Townsite
North Las Vegas, Nevada 89030

629 South Casino Center

Madelyne B. Schmidt & Lloyd A. Jones Lots 15, 16, Block 24, Clark's
2120 Bonniebrook Drive Las Vegas Townsite
Stockton, California 95207

Property Information:

Original Use: Residential
Present Use: Residential/Commercial
Architect/Builder: San Pedro, Los Angeles and Salt Lake Railroad
Construction/Modifications: 1909-11
Building Type: Residential

Physical Description:

In 1909 expansion of the Las Vegas railroad facilities to include the main machine shops for the SP, LA and SL Railroad precipitated the need for immediate expansion of workmen housing in the area. Between 1909 and 1912, the company constructed 64 of a possible 120 dwellings planned. In that latter year, company policy changed so that the railroad no longer built, but sold lots and gave loans for construction of employee homes. The railroad cottages were nearly identical in original form and details. Each was of concrete block construction in rectangular plan with a two-bay entrance porch set into the main block at the right hand corner. Roofs are hipped with flared, boxed eaves supported by square brackets. Original porch details include railings with closely spaced square balusters and small c brackets framing the posts.

8/18/87

United States Department of the Interior
National Park Service

National Register of Historic Places
Continuation Sheet

Section number 7 Page 16

Railroad Cottage Historic District
601-629 South Casino Center
Las Vegas, Nevada

Three design "types" were employed within this general format. The simplest has a full hipped roof with a small hipped venting dormer. The second type has a truncated hipped roof with upper, perpendicular gable containing a vent. The third, and most ornate type, employed a hipped roof with a major porch gable containing a vent. This gable has flared eaves and is faced with half-timbering or shingles. These various design details relate the otherwise simple dwellings to the California Bungalow movement and to aspects of the craftsman tradition. Careful attention was given in construction to good attic ventilation, shade from both the porch and eaves, and insulation against the desert heat through the choice of concrete building materials. (Above taken from Charles Hall Page & Associates, Inc., Historic Preservation Inventory & Planning Guidelines (1978).

The eight cottages included in the proposed district represent the most architecturally intact group of surviving cottages. With the exception of 624 South Casino Center, which has been converted to office space, all remain in use as single family dwellings. Examples of all three cottage types are represented.

The following is a short description of each of the eight contributing buildings included in the district.

601 South Casino Center

The dwelling located at 601 South Casino Center is representative of the third and most elaborate type of railroad cottage. The three bay, single story building is constructed of concrete block parged in stucco and rises to a bell cast, hipped roof incorporating a cross gable. The building includes one-light-over-one-light wooden sash windows enframed by simple board surrounds. Alterations to the building include the addition of a rear, cross gable wing. The dwelling's original, off-set front porch has been enclosed.

8/18/87

United States Department of the Interior
National Park Service

National Register of Historic Places
Continuation Sheet

Section number 7 Page 17

Railroad Cottage Historic District
601-629 South Casino Center
Las Vegas, Nevada

605 South Casino Center

The dwelling at 605 South Casino Center is an example of the first and simplest railroad cottage type. As indicative of this category, the rectangular, single story structure rises to a bellcast hipped roof accented by a small hipped venting dormer. The building's concrete walls are parged in stucco. Windows are one-light-over-one-light, wooden sash enframed by simple board surrounds. Modifications to the building include a sympathetic single-story, wood frame addition located to the rear of the building. This addition is parged in stucco. The off-set porch located on the principal elevation has been enclosed.

609 South Casino Center

The dwelling at 609 South Casino Center can be categorized as a Type three railroad cottage. The building is a simple, single story dwelling constructed in stucco parged, concrete block terminating in a bell cast, hipped roof. Building windows are one-light-over-one-light, wooden sash enframed by a simple board surround. Modifications to the building include replacement of original porch posts with tapered wooden supports sheathed in stucco. These supports retain the buildings original, modified c-scroll capitals.

613 South Casino Center

The dwelling at 613 South Casino Center is representative of the second type of railroad cottage constructed by the San Pedro, Los Angeles and Salt Lake Railroad. The single story, concrete block building rises to a hipped roof incorporating a gablet. Building windows are one-light-over-one-light, wooden sash enframed by simple board surrounds. The building retains its original off-set, open porch supported by simple wooden supports.

617 South Casino Center

The building at 617 South Casino Center is a single story, concrete block dwelling representative of a type three railroad cottage. The building terminates in a bell cast, hipped roof. Building windows are one-light-over-one-light, wooden sash enframed by simple wood surrounds. The building's original, off-set porch has been enclosed but retains its ventilated gable-end roof.

8/18/87

United States Department of the Interior
National Park Service

National Register of Historic Places
Continuation Sheet

Section number 7 Page 18

Railroad Cottage Historic District
601-629 South Casino Center
Las Vegas, Nevada

621 South Casino Center

The building at 621 South Casino Center is a single story, type one railroad cottage. Constructed in concrete block, the building includes a bell cast, hipped roof featuring a central, hipped roof ventilator dormer. Windows are one-light-over-one-light, wooden sash enframed by simple wooden surrounds. Window bays are supported by slightly extended concrete sills and terminate in slightly projecting lintels. The building retains its original, recessed, two-bay porch which is supported by simple wooden posts terminating in stylized capitals incorporating c scrolls.

625 South Casino Center

The dwelling at 625 South Casino Center is a single story, cement block building classified as a type two railroad cottage. As characteristic of this cottage type, the dwelling's bell cast, hipped roof includes a central gablet with ventilator panel. Original windows are one-light-over-one-light wooden sash enframed by simple wooden surrounds. Modifications to the original design include stucco parging and enclosure of the original, recessed porch.

Statement of Significance:
Criteria A and C

The eight dwellings included in the historic district are locally significant for their association with the San Pedro, Los Angeles and Salt Lake Railroad and the early development of Las Vegas, Nevada. The district is architecturally significant as the most intact area representative of the 1909-1911 SP, LA and SL housing development. The district includes examples of the three dwelling types constructed by the railroad to house workers employed in the company's machine shops and rail yards. Please refer to the nomination cover form for a discussion of the SP, LA and SL role in the development of Las Vegas.

Considering the date of probable construction of these homes in what essentially amounts to an early housing "project", they are innovative and progressive in terms of construction, design and planning. Concrete block construction was still a new technology at the time. The stylish modern detailing employed must have made such homes highly desirable when contrasted with the average vernacular wood frame house in the Las Vegas area. Though not as apparent today, the Railroad cottages were many steps above the wood shacks of Las Vegas' pioneer phase. Alterations generally have amounted to filling in the porch in one way or another for more interior space. Fenestration, porch woodwork, and even whole buildings, have been subject to alterations for changing tastes or functions. Examples cited above should be viewed as nearly pure examples of the original constructed designs.

8/18/87

United States Department of the Interior
National Park Service

National Register of Historic Places
Continuation Sheet

Section number 7 Page 19

Railroad Cottage Historic District
601-629 South Casino Center
Las Vegas, Nevada

Bibliography:

Clark County Assessor's Records
Las Vegas Age, 1909-1910

Charles Hall Page & Associates, Historic Preservation Inventory & Planning Guidelines
pp. 36-37

Florence Lee Jones Cahlan, Water: A History of Las Vegas, Las Vegas Water District, 1975.

Legal Descriptions:

See Current Ownership

Location of Legal Description:

Clark County Courthouse
309 South Third Street
Las Vegas, Nevada 89101

Representation in Existing Surveys

Historic Resources of Central Las Vegas, 1984.
Local survey deposited at the Nevada State Museum and Historical Society
700 Twin Lakes Drive, Las Vegas, Nevada 89158

UTM References:

D.	Zone 11	Easting	666665	Northing	4003600
E.	Zone 11	Easting	666723	Northing	4003580
F.	Zone 11	Easting	666660	Northing	4003460
G.	Zone 11	Easting	666600	Northing	4003480

8/28/87

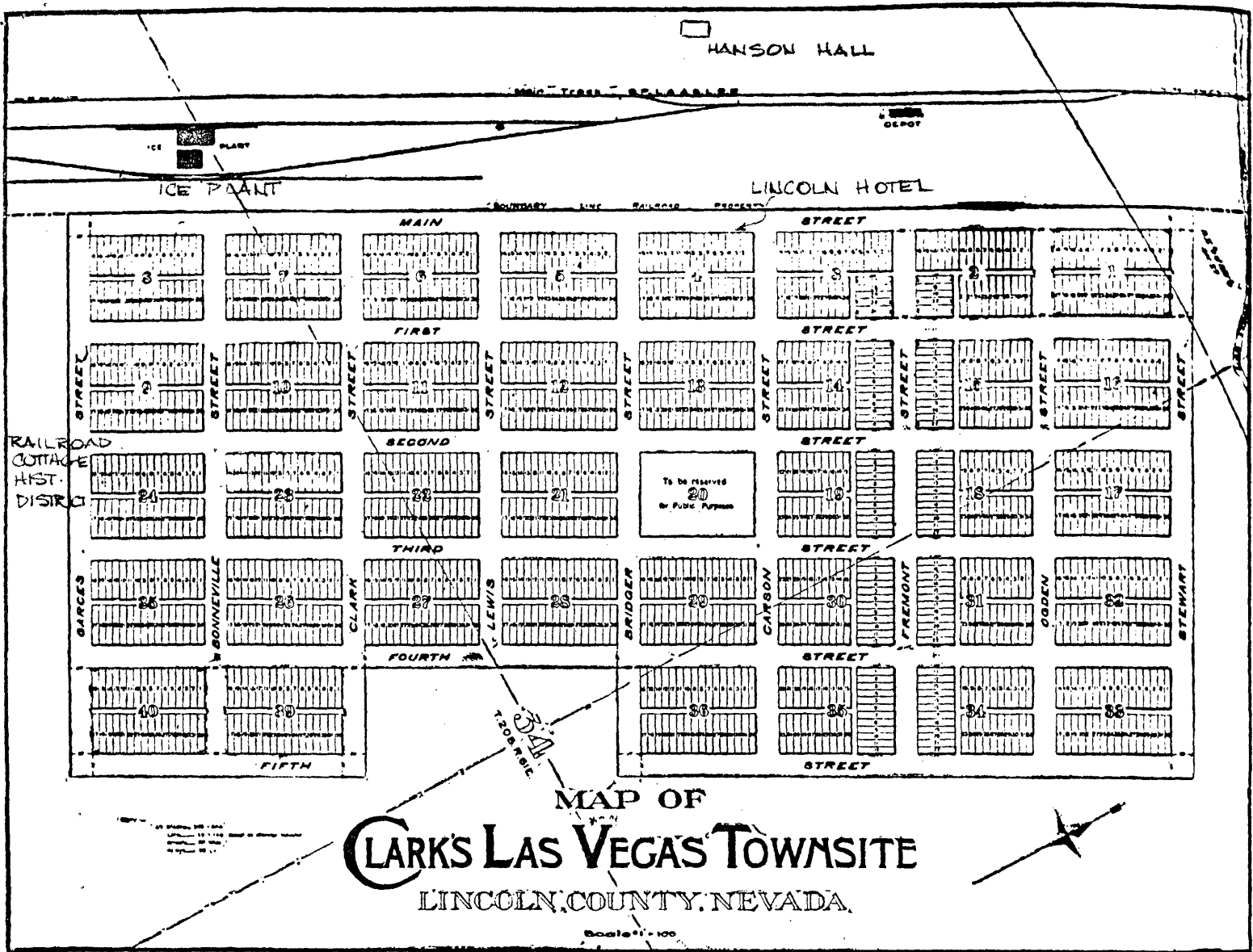

MAP OF
CLARK'S LAS VEGAS TOWNSITE
 LINCOLN COUNTY, NEVADA.

Information as to Sale of Lots in

Clark's Las Vegas Townsite

Las Vegas, Nevada

Owing to the great number of applications that have been received for the various lots in this townsite, and the impracticability of deciding as between applicants for the same lots, it has been decided, in fairness to all, to conduct an auction sale of these lots at Las Vegas, commencing at noon on **May 15, 1905.**

A special rate of \$16.00 from Los Angeles and \$20.00 from Salt Lake City for the round trip, will be made along the line of the San Pedro, Los Angeles & Salt Lake Railroad, to Las Vegas. Tickets will be sold on the 13th and the 14th and return portion must be used before the 18th. **Purchasers of lots will receive as a rebate the amount paid for railroad fare to Las Vegas.**

A map showing the lots with scale of prices can be seen at room 507 Pacific Electric Building, Los Angeles, California, at Houston Real Estate and Investment Co.'s office in Salt Lake City, and at the office of the Las Vegas Land and Water Company at Las Vegas. The bidding will be as to choice of lots at the following scale of prices: **From \$150.00 to \$750.00 for corner lots, and from \$100.00 to \$500.00 for inside lots.**

All streets are 80 feet wide with alleys 20 feet wide running through the center of each block. **Terms of sale: Twenty-five per cent down and balance on execution and delivery of deed by the company within sixty days thereafter. The sale of intoxicating liquors will be prohibited, excepting on blocks 16 and 17.**

Further information and particulars can be obtained from Mr. F. A. Waters, room 507 Pacific Electric Building, Los Angeles, or at the office of the company at Las Vegas, or from W. E. Vigus at the office of the Houston Real Estate & Investment Co., at Salt Lake City.

Las Vegas Land & Water Company By C. O. WHITTEMORE, President
 Los Angeles, California, May 10, 1905

11/9/87

United States Department of the Interior
National Park Service

National Register of Historic Places
Continuation Sheet

Section number 10 Page 2

Railroad Cottage Historic District
(Properties Associated with the
San Pedro, Los Angeles and Salt Lake Railroad TR)
Clark County, Nevada

10. Geographical Data

Acreage of nominated property:

601 South Casino Center.

Lots 1,2, Block 24, Clark's Las Vegas Townsite

Acreage: 0.32 A

605 South Casino Center

Lots 3,4, Block 24, Clark's Las Vegas Townsite

Acreage: 0.32 A

609 South Casino Center

Lots 5,6, Block 24, Clark's Las Vegas Townsite

Acreage: 0.32 A

613 South Casino Center

Lots 7,8, Block 24, Clark's Las Vegas Townsite

Acreage: 0.32 A

617 South Casino Center

Lots 9, 10, Block 24, Clark's Las Vegas Townsite

Acreage: 0.32 A

621 South Casino Center

Lots 11, 12, Block 24, Clark's Las Vegas Townsite

Acreage: 0.32 A

625 South Casino Center

Lots 13, 14, Block 24, Clark's Las Vegas Townsite

Acreage: 0.32

629 South Casino Center

Lots 15, 16, Block 24, Clark's Las Vegas Townsite

Acreage: 0.32

Total District Acreage: 2.56 A