

IOWA SITE INVENTORY

Division of Historic Preservation
Iowa State Historical Department
26 E. Market St., Iowa City, Iowa 52240

Site Number 3-010-002
District Name _____
Map Reference # _____
Topo Map La Crosse NK 1:250,000

IDENTIFICATION

- ✓ 1. Site Name old Former Allamakee County Courthouse *(County Courthouses in Iowa (Iowa Courthouse TR) TR)*
- ✓ 2. Village/Town/City Lansing Township _____ County Allamakee
- ✓ 3. Street Address Second Street
4. Legal Location S. Lansing 5 1
Urban: subdivision block parcel
Rural: township range section
subparcel 1/4 section-1/4 section
5. UTM Location: zone 15 easting 644400 northing 4802100; Acreage less than 1 acre
6. Owner(s) Name W.W. Wilkins
7. Owner(s) Address S. First Street Lansing Iowa 52151
(Street address) (City) (State) (Zip)
8. Use: present apartments original courthouse

DESCRIPTION

9. Date of Construction 1861 Architect/Builder _____
10. Building Type: single family dwelling multiple family dwelling commercial
 industrial educational other institutional public religious agricultural
11. Exterior Walls: clapboard stone brick board & batten shingles stucco
 other _____
12. Structural System: wood frame with interlocking joints
 wood frame with light members (balloon frame) masonry load-bearing walls
 iron frame steel frame with curtain walls reinforced concrete
 other _____
13. Condition: excellent good fair deteriorated
14. Integrity: original site moved—if so, when? _____
Notes on alterations, additions (with dates and architect, if known) and any other notable features of building and site:
Additions: porch railing and steps, little roof over rear entrance, interior modifications for apartment use
15. Related Outbuildings and Property: barn other farm structures
 carriage house garage privy other _____
16. Is the building endangered? no yes—if so, why? _____
17. Surroundings of the building: open land woodland scattered outbuildings
 densely built-up commercial industrial residential other _____

18. Map

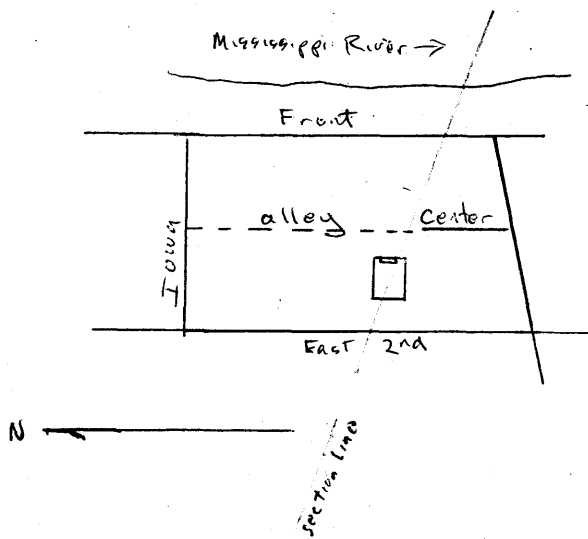

19. Photo

Roll 121 Frame 1 View _____

SIGNIFICANCE (Indicate sources of information for all statements)

20. Architectural Significance

- a. Key structure/individually may qualify for the National Register
- b. Contributing structure c. Not eligible/intrusion

This is among the most significant of Iowa's county courthouses, and is notable as one of the few remaining in the Greek Revival style. The recessed portico, with curved staircases hidden behind the front corners of the building, is perhaps unique in the state. Note the emphasis on the main facade, in terms of detail and masonry treatment: side and rear walls are simply quarry faced stone.

21. Historical Significance

Theme(s) Politics/Government

- a. Key structure/individually may qualify for the National Register
- b. Contributing structure c. Not eligible/intrusion

This courthouse was a victim of county seat rivalry, serving its original function only from 1861 to 1867. The county courthouse is locally significant as the historical focus of county seat government, and of the political power and prestige derived from the community's status as the county seat. As center of county government, an Iowa town was reasonably assured of economic and population growth, and a prominent role in local social and political life. The county courthouse represents a significant public investment in a structure built not simply for utilitarian purposes, but also as a monument associated with the historical importance of county organization and development.

22. Sources (for primary and secondary sources, give complete facts of publication: author, title, place of publication, date, etc.):

Andreas, A.T. Illustrated Historical Atlas of Iowa. Chicago: Andreas Atlas Co., 1875.
 Pratt, LeRoy G. The Counties and Courthouses of Iowa. Mason City: Klipto Printing and Office Supply Co., 1977.
 Stanek, Edward and Jacqueline. Iowa's Magnificent County Courthouses. Des Moines: Wallace-Homestead Book Co., 1976.

Prepared by Division of Historic Preservation Date January 1980
 Address 26 East Market St. Iowa City Telephone _____
 Organization _____

FOR DIVISION OF HISTORIC PRESERVATION USE ONLY	
1. OFFICE INFORMATION SOURCES ON THIS PROPERTY <input type="checkbox"/> COUNTY RESOURCE FILE <input type="checkbox"/> WINDSHIELD SURVEY <input type="checkbox"/> NATIONAL REGISTER <input type="checkbox"/> GRANTS-IN-AID: _____ <input type="checkbox"/> DETERMINATION OF ELIGIBILITY	<input type="checkbox"/> REVIEW AND COMPLIANCE PROJECT: _____ <input type="checkbox"/> OTHER _____ <input type="checkbox"/> OTHER _____ <input type="checkbox"/> OTHER _____
2. SUBJECT TRACES a. _____ b. _____ c. _____ d. _____ e. _____	3. PHOTO IMAGES _____ _____ _____ _____