



ARCHITECTURAL/HISTORICAL COMPONENT FORM

IMPORTANT: USE IN CONJUNCTION WITH THE GREEN INVENTORY RECORD FORM FOR RECORDING HISTORIC STRUCTURES AND DISTRICTS. USE SEPARATELY FOR RECORDING STRUCTURES LOCATED WITHIN DISTRICT BOUNDARIES.

- 1) Resource No. _____ 2) Temp No. 2 3) Name Congregational Church
 Theme _____
- 4) Address 300 East Simpson, Lafayette, Colo. 5) District Name Lafayette Coal Mining Era
Buildings TR
- I. INTEGRITY: 6) Condition: Good Fair _____ Deteriorated _____
- 7) Original Use Church 8) Present Use Library
- 9) Original Site Moved _____ Date(s) of Move: _____
- 10) Unaltered _____ Altered Explain: 1901, Steeple removed; 1964, door placed between
main and north rooms; early 1970s, door placed in south exterior wall

- II. DESCRIPTION: 11) Building Materials frame
- 12) Construction Date 1892 13) Architect/Builder unknown
- 14) Architectural Style(s) vernacular
- 15) Special Features/Surroundings: The church is a single story building with a steeply
pitched roof which adds substantially to its overall height. The foundation is of Lyons
sandstone, the exterior material is narrow clapboard siding, and the roof is wood shake
shingles. The front facade of the building exhibits three gables, Decorative elements
include brackets under the eaves, turned spindles accenting the shallow porch. The
windows have cornice heads with simple architrave surrounds and are hood framed, double hung.
There is a round, wood-trimmed vent in the gable facade of the meeting room, and a
rectangular vent with simple cornice molding in the gable of the south facade.

- 16) Archaeological Potential: Yes _____ No _____ Unknown Explain: _____

III. CULTURAL ACTIVITIES: Key the resource type (ie: house, barn, shed, school, church, etc) to the cultural activity theme and sub-theme category associated with it.

AREA OF SIGNIFICANCE			
17) THEME	industry	social/humanitarian	
18) SUB-THEME	coal		
19) TYPES			

(Attach Photographs)

Frame Number _____
 Roll Number _____
 Facade Orientation _____

IV. SIGNIFICANCE: Assess whether or not the resource has any historical or architectural merit by checking appropriate categories and justifying below. Include any relevant historical data.

20) Architectural Significance:

- Represents work of a master
- Possesses high artistic values
- Represents a type, period, or method of construction

21) Historical Significance:

- Associated with significant persons
- Associated with significant events or patterns
- Contributes to the significance of an historic district

The Lafayette Congregational Church has occupied a central role in the town's history, particularly during the coal mining era. It was a community meeting place for the miners and their families and throughout its existence has functioned in many service related capacities.

The church was organized in 1890. During the early years of operation, members met in various homes for services, but as the population grew, it became evident that a permanent house of worship was needed. During these lucrative years of coal development, the town's founder, Mary Miller, provided the majority of funds for the church and arranged for the construction of the building. Miller also paid the minister's salary for several years until the congregation could assume the obligation.

The church served as a focal building for the miners and their families throughout its existence. In 1918, the structure was converted to an emergency hospital during the influenza epidemic. A small library was started at the church in 1923. Due to lack of membership in the early 1920s, the church was sold to the Christian Science Society in 1928. At that time the library was moved to the Rocky Mountain Fuel Company Store, but returned to the site in 1964.

22) List Any Associated Cultural Group: n/a

V. REFERENCES:

Beshoar, Barron B. Out of the Depths. Denver: World Press Inc., 1942, p. 27
 Records of the Congregational Church.
 Cramer, Anne. "Historic Congregational Church is Today's Library." Lafayette News, 31 December 1980, Vol. 7, #41, p. 8
Lafayette Leader, 11 October 1918.
Lafayette Leader, 1 November 1918.
Lafayette Leader, 10 February 1923.

Congregational Church
Lafayette Coal Mining Era Buildings

(References)

Boulder County Courthouse Records.

IV. Significance (continued)

The structure represents many aspects of the community. It has served as a church, meeting hall, hospital, and library.



INVENTORY RECORD

IMPORTANT: COMPLETE THIS SHEET FOR EACH RESOURCE PLUS EITHER AN ARCHAEOLOGICAL OR HISTORICAL/ARCHITECTURAL COMPONENT FORM.

NOT FOR FIELD USE	
<input type="checkbox"/>	DET. ELIG.
<input type="checkbox"/>	DET. NOT ELIG.
<input type="checkbox"/>	NOMINATED
<input type="checkbox"/>	LISTED, DATE _____

I. IDENTIFICATION: 1)Resource No. _____ 2)Temp. No. 2

3)Resource Name Congregational Church 4)Project Name Lafayette Thematic District

5)Category: Arch. Site , Hist./Archit. Structure , Hist./~~Archit.~~ District .
Thematic

6)(For Arch. site)In a District:yes no ;Name N/A

II. LOCATION: 7)Township 15; Range 69W; SW $\frac{1}{4}$ of SE $\frac{1}{4}$ of NW $\frac{1}{4}$ of NW $\frac{1}{4}$ of Section 2; P.M. 6TH. 8)County Boulder

9)USGS QUAD Lafayette, Colorado; 7.5 X 15; Date 1965 (71) Attach photocopy portion of Quad. Clearly show site. 10)Other maps N/A

11)Dimensions ---- mX ----- m 12)Area ----- sq.m(+4047=)less than 1 acre

13)UTM Reference: (One UTM centered on resource may be given for resource under 10 acres.)

A. | 1 | 3 | ; | 4 | 9 | 2 | 5 | 4 | 0 | mE; | 4 | 4 | 2 | 7 | 3 | 4 | 0 | mN. B. | | | ; | | | | | | | | | | | | | | | | | | mE; | | | | | | | | | | | | | | | | | | mN.
C. | | | ; | | | | | | | | | | | | | | | | | | mE; | | | | | | | | | | | | | | | | | | mN. D. | | | ; | | | | | | | | | | | | | | | | | | mE; | | | | | | | | | | | | | | | | | | mN.

14)Address 300 East Simpson, Lafayette, Colorado Lot 6 Block 4 Addition -----

III. MANAGEMENT DATA: 15)Field Assessment: Eligible Not Eligible Need Data

16)Owner/Address City of Lafayette, 201 East Simpson, Lafayette, Colorado

17)Gov't Involvement: County State Federal Private : Agency N/A

18)Disturbance:none light moderate heavy total ; Explain Structure has been converted on the interior to house a library.

19)Threats to Resource:Water Erosion Wind Erosion Animal Activity Neglect Vandalism
Recreation Construction ; Comments N/A

20)Management Recommendations Follow the Secretary's Standards for Rehabilitation

V. REFERENCE: 21)State/Fed. Permit Nos. N/A

22)Photo Nos. L-1, 10, 11, 12, on file at Colorado Historical Society

23)Report Title N/A

24)Recorder Manuel Weiss 25)Recording Date January 23, 1982

26)Recorder Affiliation Community Services Collaborative 27)Phone No. 442-3601

V. SKETCH MAP: Map all features and show the boundaries of the resources. Show all major topographic features, permanent modern features, and vegetation zones as appropriate. Give names of features, streets and addresses if known. Provide scale, key and direction.

scale:
□ =
3 meters

key:

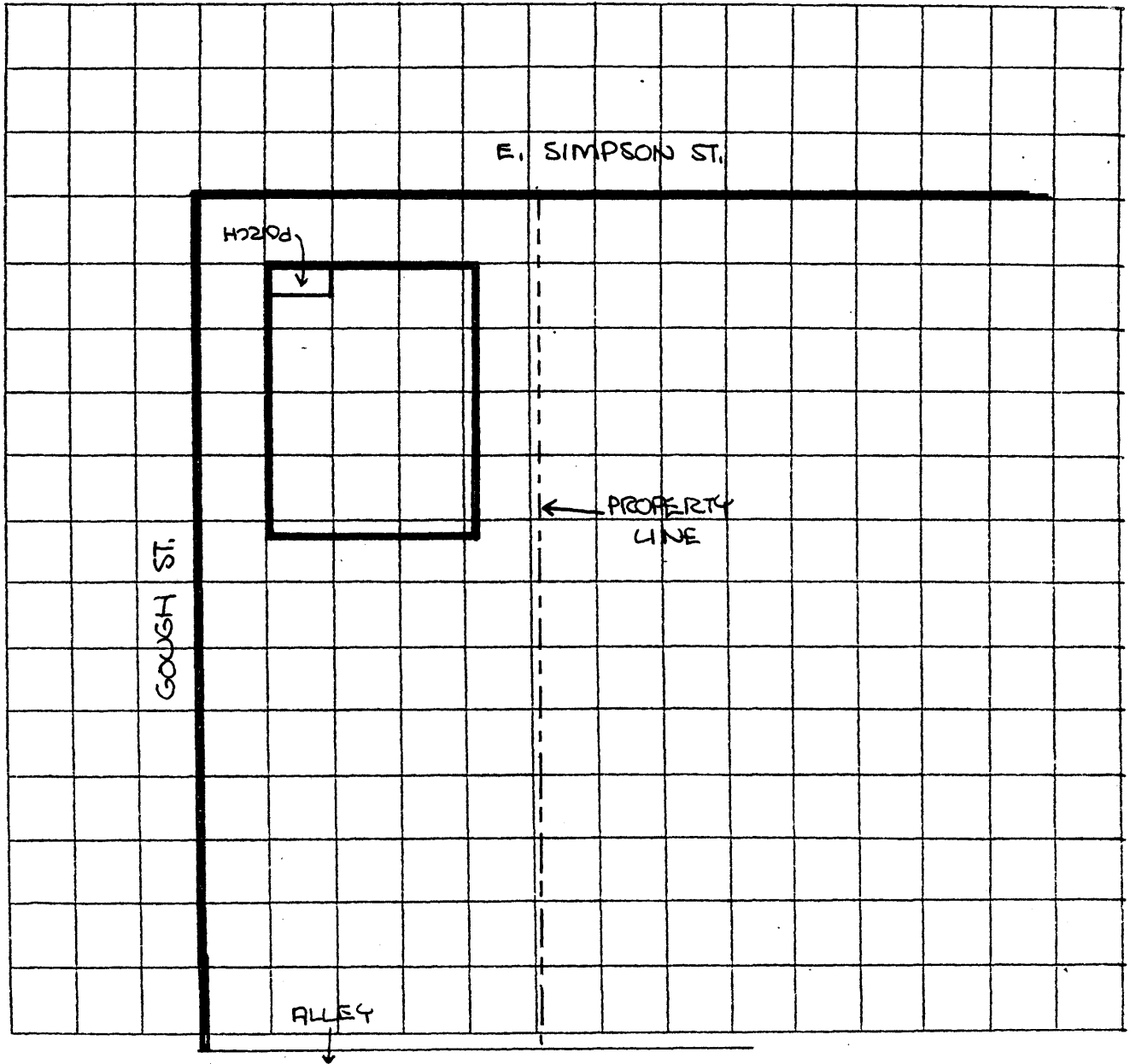

28) Location/Access: From the intersection of Hwy. 287 and East Simpson, drive east two blocks. The church is located on the southeast corner.

29) Boundary Description: Lot 6, block L, Lafayette, Colorado.

30) Boundary Justification: Limited to the extent of the lots occupied by the structure.

UNITED STATES
DEPARTMENT OF THE INTERIOR
GEOLOGICAL SURVEY

CONGREGATIONAL CHURCH

