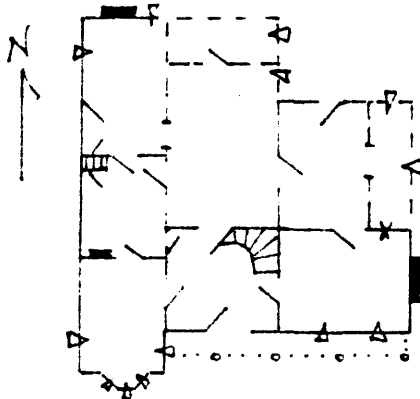

KENTUCKY HISTORIC RESOURCES INVENTORY

Site No. **WS-97**

1988 3421

1. Historic Name(s) Kendrick/Tucker/Barber House Original Owner _____		22. ADD. County Lincoln Trail/Wash. 115	
2. Present Name As above		23. U.S.G.S. Quadrant (15/75') Maud G.I.S. Mod. 	
3. Location 1 m. NE of Hwy 150, 10 m. W. of Springfield		24. UTM Reference 1,6 64,8,860 4,1,8,0,9,3,0 Zone Easting Northing	
4. Owner's Name Jimmy Hatchett		25. Coordinate Accuracy 	
5. Owner's Address Rt. 2, Springfield, Ky. 40069		26. Prehistoric Site _____ Object _____ Historic Site _____ Structure _____ Building <input checked="" type="checkbox"/> Other _____	
6. Open to Public Yes _____ No <input checked="" type="checkbox"/>	7. Visible from road Yes <input checked="" type="checkbox"/> No _____	8. Ownership XX Private _____ Local _____ State _____ Federal _____	
9. Local Contact/Organization Owner		27. National Register District Name: N/A 	
10. Site Plan with North Arrow 		28. Significance Evaluation NR N	
		11. Architect unknown	
		12. Builder unknown	
		13. Date A. c.1801; B. c.1885 A 2 B 5	
		14. Style A Federal B Italianate B E 	
15. Original Use Sing. fam. res. A		29. Status _____ Date _____ National Landmark _____ National Register _____ Landmark Certificate _____ Kentucky Survey _____ Local Landmark _____ HABS/HAER _____	
16. Present use Sing. fam. res.		30. Historic Theme Architecture C	
17. Condition Fair C		31. Endangered Yes <input checked="" type="checkbox"/> No _____	
18. Description 7 bay, 2 story, part brick, part frame; bay window on W. facade; decorative Vic. porch added to front; cornice window heads w/brackets; Flemish bond brick to top of porch then changes to Eng. bond; rear 2nd fl. windows are segmental arched; (Continue on Back) (over)		32. Preservation Project Status N/A Actual Cost in \$1,000s 	
No. Stories Two C Single Pile <input checked="" type="checkbox"/> NA _____ Double Pile _____ Floor Plan T-plan N Structural Fabric Brick/frame C B D Decorative Fabric Flemish bond A G Weatherbd. B J Roof Form Gable end		33. ATTACH PHOTO Roll No 15;19 Picture No. 11-20; 30-38A/39 Direction _____	
19. History Wm. Kendrick (WS-91) gave 210 a. of land on Cartwright's Creek to his son, Gabriel, according to Wm.'s will probated 11Oct1824. This house appears to be located on the same property as John A. Tucker (over)		34. Prepared by: Joe DeSpain	
20. Significance Significant under criterion C. Important early brick hall/parlor ho. with brick 2nd floor added and frame w wing added in later 19th c. to form T-plan		35. Organization Green Co. Hist. Soc., Inc. 36. Date 15 Mar. 1983	
21. Source of Information Shows methods for expansion of houses. county records		37. Revision Dates _____ 38. Staff Review _____ 1/87	

DESCRIPTION: (cont.) external brick stepped shouldered chimney to E.; internal chimney in frame section; stone external slope shouldered chimney to N. of frame; brackets under eaves; louvered openings for cellar. INTERIOR: open string spiral stair w/decorative brackets and walnut newel post similar to Simmstown; pronounced architrave; windows go to floor in E. rm.; pic. rails; mantel has 5 panel frieze w/double fluted pilasters 3/4 round as in Grundy home(WS-7)-paneled pilasters on mantel in N. rm. on ell; simple mantels in upstairs rms.

The frame section has a faced limestone foundation, and bricks fill the interspaces between the studdings. Brick herringbone walks go to the front porch and are found in other sections around the house. To the W. of the frame are the remains of a limestone foundation.

SIGNIFICANCE: (cont.) construction with its brick interspacing between the studs suggesting a half-timbered bldg. suggests an interesting architectural history.

HISTORY: (cont.) acquired the land from the heirs of Gabriel Kendrick in 1882. The house is presently associated with John A. Tucker, J. W. Tucker, and P. S. Barber.

While the house is presently T-form with Italianate characteristics, close observation of the brickwork seems to indicate an early construction date with the first floor brick, an alteration later to a second story brick, then the frame addition. The rear windows, 2nd floor, of the brick are segmental arched as opposed to the flat arch of the first floor.

SOURCE OF INFORMATION: WC Will D/63
WC Deeds 28/17; 59/158; 100/331; 120/17;
120/24; 124/520; 137/3
WC Comm. Deeds 1/68; 4/403

KENTUCKY HISTORIC RESOURCE INVENTORY SUPPLEMENT
BOUNDARY AND LOCATION INFORMATION

Historic Property Name Kendrick/Tucker/Barber House Site # WS-97

Multiple Resource/Thematic Nomination Title Washington County Multiple Resource Area

U.T.M. Coordinates - List multiple UTM's if property is ten or more acres.

A. 16 648860 4180930 D. _____

B. _____ E. _____

C. _____ F. _____

Verbal Boundary Description Acreage 0.3 acre

Point A is 35 feet southeast of the southeast corner of the house. Beginning at Point A, proceeding west 100 feet along a fence to Point B, thence north 125 feet along a fence to Point C, thence 100 feet east along a fence to Point D, thence south along a drive 125 feet to the point of origin. The boundaries were drawn to include the house and domestic-related space as enclosed by fences and drive. There are no outbuildings. The nomination area contains one contributing building.

Sketch of Site Plan (Showing outbuildings, structures, landscape features and the site boundary as described above.)

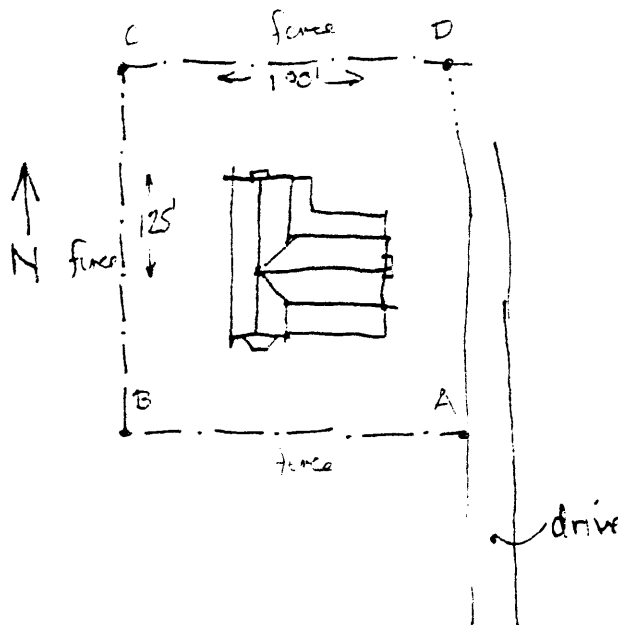

Official Courthouse Property Reference:

Washington County Courthouse, Springfield, Kentucky

ATTACHMENT :

KENDRICK/TUCKER/BARBER HOME

WS-97

