

United States Department of the Interior
National Park Service

National Register of Historic Places
Inventory—Nomination Form

For NPS use only

received DEC 12 1983
date entered

See instructions in *How to Complete National Register Forms*
Type all entries—complete applicable sections

1. Name

historic First Presbyterian Church, Ruston

and/or common Same

2. Location

street & number 212 North Bonner St. N/A not for publication

city, town Ruston N/A vicinity of

state LA code 22 parish Lincoln code 061

3. Classification

Category	Ownership	Status	Present Use
<input type="checkbox"/> district	<input type="checkbox"/> public	<input checked="" type="checkbox"/> occupied	<input type="checkbox"/> agriculture
<input checked="" type="checkbox"/> building(s)	<input checked="" type="checkbox"/> private	<input type="checkbox"/> unoccupied	<input type="checkbox"/> commercial
<input type="checkbox"/> structure	<input type="checkbox"/> both	<input type="checkbox"/> work in progress	<input type="checkbox"/> educational
<input type="checkbox"/> site	Public Acquisition	Accessible	<input type="checkbox"/> entertainment
<input type="checkbox"/> object	<input type="checkbox"/> N/A in process	<input checked="" type="checkbox"/> yes: restricted	<input type="checkbox"/> government
	<input type="checkbox"/> N/A being considered	<input type="checkbox"/> yes: unrestricted	<input type="checkbox"/> industrial
		<input type="checkbox"/> no	<input type="checkbox"/> military
			<input type="checkbox"/> museum
			<input type="checkbox"/> park
			<input type="checkbox"/> private residence
			<input checked="" type="checkbox"/> religious
			<input type="checkbox"/> scientific
			<input type="checkbox"/> transportation
			<input type="checkbox"/> other:

4. Owner of Property

name First Presbyterian Church (318) 255-2542

street & number 212 North Bonner

city, town Ruston N/A vicinity of state LA 71270

5. Location of Legal Description

courthouse, registry of deeds, etc. Lincoln Parish Courthouse

street & number Trenton St. (no specific address) P. O. Box 924

city, town Ruston state LA 71270

6. Representation in Existing Surveys

title LA Historic Sites Survey has this property been determined eligible? yes no

date 1983 federal state county local

depository for survey records Louisiana State Historic Preservation Office

city, town Baton Rouge state LA

7. Description

Condition		Check one	Check one	
<input type="checkbox"/> excellent	<input type="checkbox"/> deteriorated	<input type="checkbox"/> unaltered	<input checked="" type="checkbox"/> original site	
<input checked="" type="checkbox"/> good	<input type="checkbox"/> ruins	<input checked="" type="checkbox"/> altered	<input type="checkbox"/> moved	date <u> N/A </u>
<input type="checkbox"/> fair	<input type="checkbox"/> unexposed			

Describe the present and original (if known) physical appearance

The First Presbyterian Church of Ruston (1923-24) is a six bay, brick, Gothic style, basilican plan building with a contemporaneous service wing. The church is located in the Ruston central business district near the eastern edge. Despite a few alterations, the building retains its National Register eligibility.

The Flemish bond brick structure is trimmed with limestone. The gable parapeted nave is entered by means of a crenelated single bay porch which is surmounted by a large lancet window. The single side tower also has a crenelated top and an ornamental needle spire formed of sheet metal. All lancet windows on the church are of the two center type. The two story service wing features a gabled pavilion which is visually connected to the church by a two bay arcade formed of Tudor arches. Perhaps the intent here was to suggest a cloister.

The nave features a complex exposed truss roof with ornamental brackets accenting each bay. The original pews and cabinetwork remain.

Integrity:

Since construction the following changes have been made in the church;

1. Air conditioning and a new organ have been installed.
2. An unobtrusive rear wing has been added.

In our opinion, these changes should not be regarded as detrimental to the church's architectural integrity. Its Gothic style features remain plainly visible both inside and out.

8. Significance

Period	Areas of Significance—Check and justify below			
<input type="checkbox"/> prehistoric	<input type="checkbox"/> archeology-prehistoric	<input type="checkbox"/> community planning	<input type="checkbox"/> landscape architecture	<input type="checkbox"/> religion
<input type="checkbox"/> 1400-1499	<input type="checkbox"/> archeology-historic	<input type="checkbox"/> conservation	<input type="checkbox"/> law	<input type="checkbox"/> science
<input type="checkbox"/> 1500-1599	<input type="checkbox"/> agriculture	<input type="checkbox"/> economics	<input type="checkbox"/> literature	<input type="checkbox"/> sculpture
<input type="checkbox"/> 1600-1699	<input checked="" type="checkbox"/> architecture	<input type="checkbox"/> education	<input type="checkbox"/> military	<input type="checkbox"/> social/ humanitarian
<input type="checkbox"/> 1700-1799	<input type="checkbox"/> art	<input type="checkbox"/> engineering	<input type="checkbox"/> music	<input type="checkbox"/> theater
<input type="checkbox"/> 1800-1899	<input type="checkbox"/> commerce	<input type="checkbox"/> exploration/settlement	<input type="checkbox"/> philosophy	<input type="checkbox"/> transportation
<input checked="" type="checkbox"/> 1900-	<input type="checkbox"/> communications	<input type="checkbox"/> industry	<input type="checkbox"/> politics/government	<input type="checkbox"/> other (specify)
		<input type="checkbox"/> invention		

Specific dates 1923-24 **Builder/Architect** Architect: C. E. Olscher
 Builder: C. C. Davis

Statement of Significance (in one paragraph) Criterion C

The First Presbyterian Church of Ruston is locally significant in the area of architecture because it is one of Ruston's most sophisticated early-twentieth century buildings.

The Louisiana Comprehensive Historic Structures Survey reveals the extent of Ruston's post-Victorian architectural heritage. There are approximately 450 bungalows (some of which are two story structures in the bungalow style). There are also approximately 100 one and two story commercial style structures. Finally, there are about fifteen Colonial style structures. In addition to these, there are a few higher style structures which are articulated in a well developed, more or less consistent historic style. Of these, the First Presbyterian Church is the only Gothic structure. It stands therefore as a landmark within the context of Ruston's early-twentieth century architectural patrimony.

9. Major Bibliographical References

- Graham, John P. Historical Sketch of the Presbyterian Church, Ruston, Louisiana, 50th Anniversary, 1934.
Graham, John P. An Historical Sketch of the Presbyterian Church of Ruston, Seventy-Fifth Anniversary, 1959. Lincoln Parish Survey, LA State Historic Preservation Office.

10. Geographical Data

Acreeage of nominated property @ 1 acre

Quadrangle name Ruston, LA

Quadrangle scale 1:62,500

UTM References

A

1	5	5	3	4	1	0	0	3	5	9	9	0	0	0	0
Zone				Easting				Northing							

B

Zone				Easting				Northing							

C

Zone				Easting				Northing							

D

Zone				Easting				Northing							

E

Zone				Easting				Northing							

F

Zone				Easting				Northing							

G

Zone				Easting				Northing							

H

Zone				Easting				Northing							

Verbal boundary description and justification

Please refer to enclosed sketch map.

List all states and counties for properties overlapping state or county boundaries

state	code	county	code
N/A			

state	code	county	code
-------	------	--------	------

11. Form Prepared By

name/title	National Register Staff Division of Historic Preservation	ASSISTED BY:	Curry Patton 126 Llanfair Dr. Ruston, LA 71270 (318) 255-1980
organization	State of Louisiana	date	September 1983
street & number	P. O. Box 44247	telephone	(504) 342-6682
city or town	Baton Rouge	state	LA 70804

12. State Historic Preservation Officer Certification

The evaluated significance of this property within the state is:

national state local

As the designated State Historic Preservation Officer for the National Historic Preservation Act of 1966 (Public Law 89-665), I hereby nominate this property for inclusion in the National Register and certify that it has been evaluated according to the criteria and procedures set forth by the National Park Service.

State Historic Preservation Officer signature

Robert B. DeBlieux

date December 5, 1983

title State Historic Preservation Officer

For NPS use only

I hereby certify that this property is included in the National Register

Entered in the
National Register

date

1/12/84

for Keeper of the National Register

Attest:

date

Chief of Registration

FIRST PRESBYTERIAN CHURCH, LINCOLN PARISH, RUSTON, LA

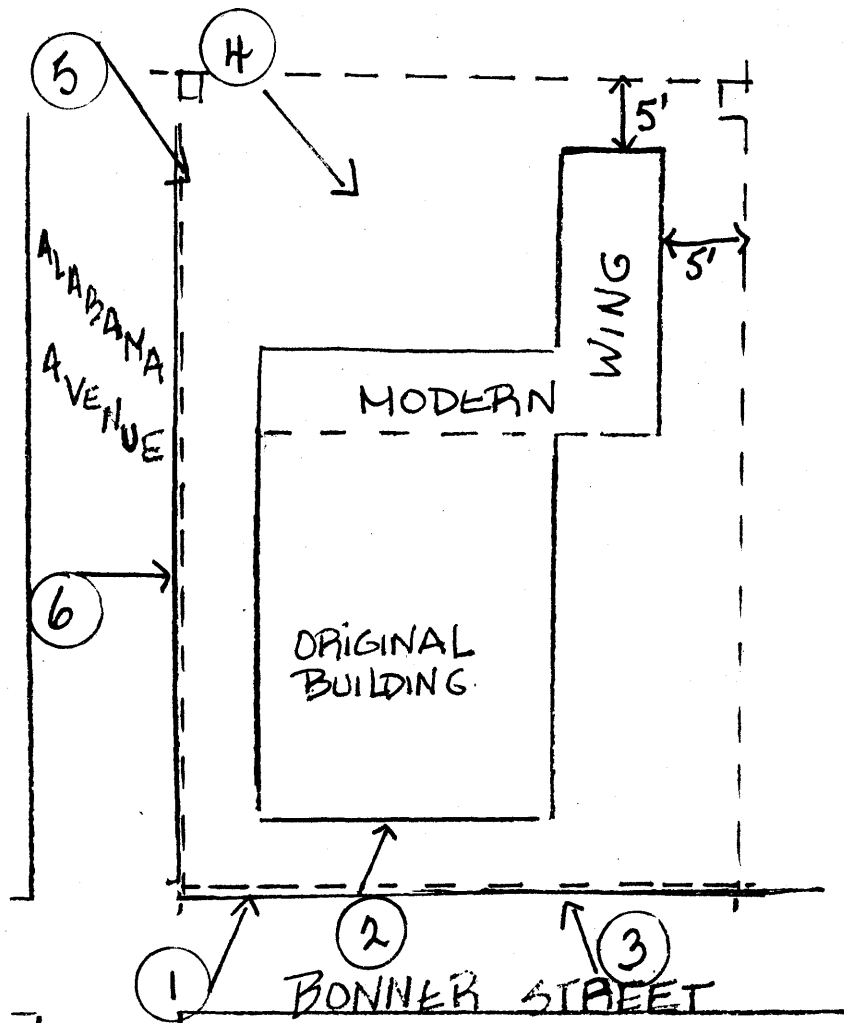

NOT TO SCALE

NORTHERN AND WESTERN BOUNDARIES FOLLOW CURBLINES, AS SHOWN. SOUTHERN AND EASTERN BOUNDARIES PARALLEL BUILDING ELEVATIONS, EACH AT A DISTANCE OF 5', AS SHOWN.

