

MAY 22 1989

FORM B - BUILDING

638

AREA FORM NO.

462

MASSACHUSETTS HISTORICAL COMMISSION
80 BOYLSTON STREET
BOSTON, MA 02116

Winchester, Mass., MRA

Town WINCHESTER

Address 219 Washington St.

Historic Name George Brine House

Photo (3"x3" or 3"x5", black and white) Indicate address of property on back of photo. Staple to left side of form.

Use: Present dwelling

Original dwelling

DESCRIPTION

Date c1865

Source historic maps

Style Mansard

Architect Joseph S. Shattuck, builder

Exterior Wall Fabric clapboard

Outbuildings barn with cupola: C

Major Alterations (with dates) none

with possible exception of wings

Condition good

Moved no Date n/a

Acreage .47A / 20,860 sq. ft. / 03-0023

Setting busy thoroughfare of mixed use:

primarily residential in this

area

Sketch Map: Draw map showing property's location in relation to nearest cross streets and/or geographical features. Indicate all buildings between inventoried property and nearest intersection(s). Indicate north

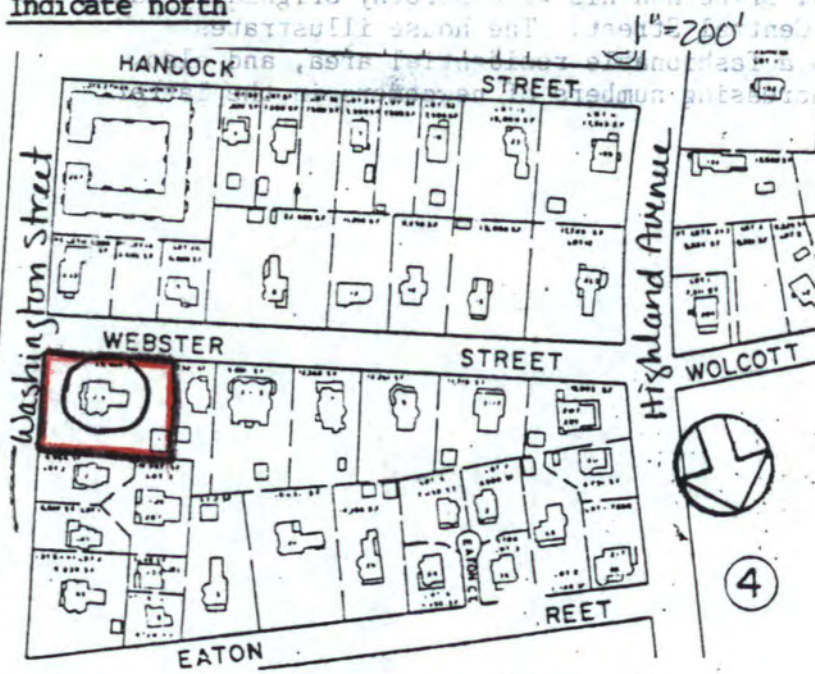

UTM REFERENCE 19 324780 14702410

USGS QUADRANGLE LEXINGTON, MASS.

SCALE 1:25,000

Recorded by Marcia Wood

Organization Winchester Historical Comm.

Date 12/78; 10/87 revised by C. Jenkins

NATIONAL REGISTER CRITERIA STATEMENT (if applicable)

The George R. Brine House possesses integrity of location, design, materials, workmanship, feeling and associations. It is significant as a fine example of the Mansard style featuring paired scrolled brackets beneath the slate mansard roof, bracketed window sills, segmental dormers with scroll bases and a full width verandah with paired posts and turned balusters. It also illustrates Washington Street's 19th century character as a fashionable residential area. It meets criteria A and C of the National Register of Historic Places.

ARCHITECTURAL SIGNIFICANCE Describe important architectural features and evaluate in terms of other buildings within the community.

The Brine House is a two story, wood-frame structure enclosed by a slate mansard roof of straight sided profile that rests on paired scroll brackets. It displays a symmetrical three bay facade with center entry. A full length verandah with paired posts, brackets and balusters extends across the facade, emphasizing the location of the entry with a projecting central section. At the second story, paired windows occupy the central bay while standard windows occupy the outer bays; all have bracketed sills. Two dormers with segmental heads and scrolled bases light the attic story. Extending laterally from the rear of the house are two, two-story wings. The entire house is sheathed with clapboards. A barn with cupola sits at the rear of the lot.

HISTORICAL SIGNIFICANCE Explain the role owners played in local or state history and how the building relates to the development of the community.

Little is known about the origin of this house built between 1854 and 1870 (c.1865) by Joseph S. Shattuck, a carpenter and builder who appears to have rented until it was acquired by the Brine family in 1893. George R. Brine and his wife Dorothy originally came to Winchester in 1888 as summer residents on Central Street. The house illustrates Washington Street's 19th century character as a fashionable residential area, and also Winchester's growth as a suburb attracting increasing numbers of newcomers in the latter part of the century.

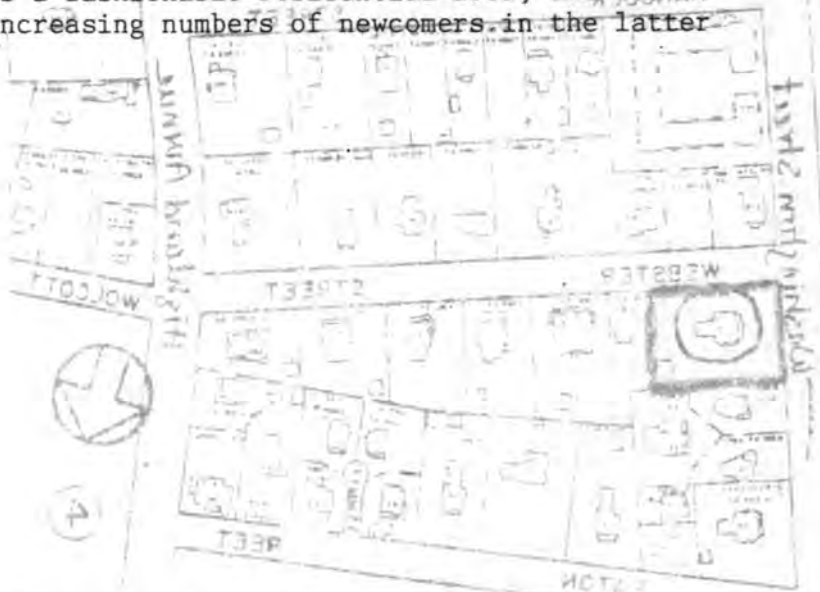

BIBLIOGRAPHY and/or REFERENCES

Winchester Archival Center resources, historic maps and town directories.

MAY 22 1989

United States Department of the Interior
National Park Service

National Register of Historic Places
Continuation Sheet

Section number _____ Page _____

Multiple Resource Area
Thematic Group

Name Winchester MRA
State Middlesex County, MASSACHUSETTS

Nomination/Type of Review	Date/Signature
Cover Substantive Review	for Keeper <u>Betty Sarge 7-5-89</u>
1. Ayer, Albert, House Entered in the National Register	for Keeper <u>Delores Byen 7/5/89</u> Attest _____
2. Ayer, Thomas, House Entered in the National Register	for Keeper <u>Delores Byen 7/5/89</u> Attest _____
3. Bacon, Robert, House Entered in the National Register	for Keeper <u>Delores Byen 7/5/89</u> Attest _____
4. Baker, Kenelum, House Entered in the National Register	for Keeper <u>Delores Byen 7/5/89</u> Attest _____
5. Brackett, Edward A., House Entered in the National Register	for Keeper <u>Delores Byen 7/5/89</u> Attest _____
6. Braddock, Edward, House Entered in the National Register	for Keeper <u>Delores Byen 7/5/89</u> Attest _____
7. Brine, George, House Entered in the National Register	for Keeper <u>Delores Byen 7/5/89</u> Attest _____
8. Carr--Jeeves House Entered in the National Register	for Keeper <u>Delores Byen 8/2/89</u> Attest _____
9. Central Street Historic District Substantive Review	for Keeper _____ Attest _____
10. Childs, Webster, House Entered in the National Register	for Keeper <u>Delores Byen 7/5/89</u> Attest _____

UNITED STATES DEPARTMENT OF THE INTERIOR
NATIONAL PARK SERVICE

NATIONAL REGISTER OF HISTORIC PLACES
EVALUATION/RETURN SHEET

REQUESTED ACTION: NOMINATION

PROPERTY NAME: Brine, George, House

MULTIPLE NAME: Winchester MRA

STATE & COUNTY: MASSACHUSETTS, Middlesex

DATE RECEIVED: 5/22/89 DATE OF PENDING LIST: 6/06/89
DATE OF 16TH DAY: 6/22/89 DATE OF 45TH DAY: 7/06/89
DATE OF WEEKLY LIST:

REFERENCE NUMBER: 89000638

NOMINATOR: STATE

REASONS FOR REVIEW:

APPEAL: N DATA PROBLEM: N LANDSCAPE: N LESS THAN 50 YEARS: N
OTHER: N PDIL: N PERIOD: N PROGRAM UNAPPROVED: N
REQUEST: N SAMPLE: N SLR DRAFT: N NATIONAL: N

COMMENT WAIVER: N

ACCEPT RETURN REJECT 7/5/89 DATE

Entered in the
National Register

ABSTRACT/SUMMARY COMMENTS:

RECOM./CRITERIA _____
REVIEWER _____
DISCIPLINE _____
DATE _____

DOCUMENTATION see attached comments Y/N see attached SLR Y/N

CLASSIFICATION

count resource type

STATE/FEDERAL AGENCY CERTIFICATION

FUNCTION

historic current

DESCRIPTION

architectural classification
 materials
 descriptive text

SIGNIFICANCE

Period Areas of Significance--Check and justify below

Specific dates Builder/Architect
Statement of Significance (in one paragraph)

summary paragraph
 completeness
 clarity
 applicable criteria
 justification of areas checked
 relating significance to the resource
 context
 relationship of integrity to significance
 justification of exception
 other

BIBLIOGRAPHY

GEOGRAPHICAL DATA

acreage verbal boundary description
 UTMs boundary justification

ACCOMPANYING DOCUMENTATION/PRESENTATION

sketch maps USGS maps photographs presentation

OTHER COMMENTS

Questions concerning this nomination may be directed to

_____ Phone _____

Signed _____ Date _____



George

Brine House

7/88

219 Washington St

Winchester, MA MIRA

MHC Inv # 462

Please refer to the map in the
Multiple Property Cover Sheet
for this property

Multiple Property Cover Sheet Reference Number: 64000303