

UNITED STATES DEPARTMENT OF THE INTERIOR
NATIONAL PARK SERVICE

PH0142760 DATA SHEET 1

FOR NPS USE ONLY
RECEIVED APR 28 1975
DATE ENTERED JUN 20 1975

NATIONAL REGISTER OF HISTORIC PLACES
INVENTORY -- NOMINATION FORM

SEE INSTRUCTIONS IN HOW TO COMPLETE NATIONAL REGISTER FORMS
TYPE ALL ENTRIES -- COMPLETE APPLICABLE SECTIONS

1 NAME

HISTORIC

Gatewood House

AND/OR COMMON

2 LOCATION

STREET & NUMBER

6 mi NE of Eatonton off GA 44

NOT FOR PUBLICATION

CITY, TOWN

Eatonton

X VICINITY OF

CONGRESSIONAL DISTRICT

10th - Robert G. Stephens

STATE

Georgia

CODE

13

COUNTY

Putnam

CODE

237

3 CLASSIFICATION

CATEGORY

- DISTRICT
- BUILDING(S)
- STRUCTURE
- SITE
- OBJECT

OWNERSHIP

- PUBLIC
- PRIVATE
- BOTH
- PUBLIC ACQUISITION**
- IN PROCESS
- BEING CONSIDERED

STATUS

- OCCUPIED
- UNOCCUPIED
- WORK IN PROGRESS
- ACCESSIBLE**
- YES: RESTRICTED
- YES: UNRESTRICTED
- NO

PRESENT USE

- AGRICULTURE
- MUSEUM
- COMMERCIAL
- PARK
- EDUCATIONAL
- PRIVATE RESIDENCE
- ENTERTAINMENT
- RELIGIOUS
- GOVERNMENT
- SCIENTIFIC
- INDUSTRIAL
- TRANSPORTATION
- MILITARY
- OTHER:

4 OWNER OF PROPERTY

NAME

Mr. and Mrs. John Copeland

STREET & NUMBER

CITY, TOWN

Eatonton

VICINITY OF

STATE

Georgia

5 LOCATION OF LEGAL DESCRIPTION

COURTHOUSE,
REGISTRY OF DEEDS, ETC.

Putnam County Courthouse

STREET & NUMBER

Marion Street

CITY, TOWN

Eatonton

STATE

Georgia

6 REPRESENTATION IN EXISTING SURVEYS

TITLE

None

DATE

FEDERAL STATE COUNTY LOCAL

DEPOSITORY FOR
SURVEY RECORDS

CITY, TOWN

STATE

7 DESCRIPTION

CONDITION		CHECK ONE	CHECK ONE
<input type="checkbox"/> EXCELLENT	<input type="checkbox"/> DETERIORATED	<input checked="" type="checkbox"/> UNALTERED	<input checked="" type="checkbox"/> ORIGINAL SITE
<input type="checkbox"/> GOOD	<input type="checkbox"/> RUINS	<input type="checkbox"/> ALTERED	<input type="checkbox"/> MOVED DATE _____
<input checked="" type="checkbox"/> FAIR	<input type="checkbox"/> UNEXPOSED		

DESCRIBE THE PRESENT AND ORIGINAL (IF KNOWN) PHYSICAL APPEARANCE

Located in Putnam County approximately seven and one fourth miles northeast of Eatonton, Georgia, following Georgia Highway 44, Gatewood House can be described as a plain style house built c. 1805-1812. It is surrounded by acres of pasture and forest land and is situated near Lick Creek. Basically it is a two story, beaded weatherboarded structure with an attic and pitched roof. The house supports three chimneys and two raised shed porches.

The main section of the house having a three bayed front, off-centered shed porch, attic and on its north and south elevations, two brick chimneys, seems to have been the original plan. However, the eastern end of the house is composed of a smaller, square-framed structure only two floors high which supports a smaller chimney on its eastern side. A shed porch on the southern elevation spans these larger and smaller sections, tying them together. Both distinct components were built probably at the same time, with the eastern section being an apparent after-thought perhaps as a result of the need for more space.

The western elevation of the house shows the apparent main entrance. Three windows are set asymmetrically across the stark, clapboard facade of the second floor. Below them a small raised porch standing to the far left side, supported with posts, serves as the only interruption in the unornamented entrance. Here two separate doors lead into the kitchen and a drawing room respectively.

On the southern facade two smaller windows, located above the second floor and flanking the upper portion of the chimney, denote the attic space. On this south side a small shed porch (as mentioned above) bridges the two sections of the house where an entrance with a single, sidelighted door leads into a hallway. The northern facade is built exactly the same with windows of the second floor placed symmetrically over the windows or doors of the first floor creating balanced proportions.

Though simple in style, Gatewood's exterior supports two chimneys of extremely unique design, with a delicate diamond patterned bonding used in the brickwork for the chimneys. This bonding has been found to appear in very few houses in Georgia, one other house being only a few miles from Gatewood.

The interior of the house is composed of a first floor with four large rooms (a parlor, drawing room, kitchen, and sitting room) and a hall, a second floor containing four bedrooms and hall, and a small attic. Two stairways, one in the first floor entrance hall, and another in the drawing room, lead to the second floor. The floors are of wide pine boards and most of the rooms have wainscoting. In the first floor kitchen and living room, corner cabinets built into the wall are solid mahogany. Perhaps the most outstanding interior features of house are its mantels. There are six altogether, four of which are shown in the photographs. Photographs enclosed show the delicate reeding and molding in the Adam style found in the mantel of the drawing room. This elegant style is carried over with some modifications in the kitchen mantel. Upstairs the mantels are much simpler and heavier, but like the others, have a refinement of unusual quality not often found

UNITED STATES DEPARTMENT OF THE INTERIOR
NATIONAL PARK SERVICE

**NATIONAL REGISTER OF HISTORIC PLACES
INVENTORY -- NOMINATION FORM**

FOR NPS USE ONLY	
RECEIVED	APR 28 1975
DATE ENTERED	JUN 20 1975

CONTINUATION SHEET Description ITEM NUMBER 7 PAGE 2

in early pioneer homes in Georgia. This simple elegance of Gatewood is carried not only in its mantels, walls, and floors, but also in its heavy oak-grained doors. One bedroom door still retains their large, ornate character. The Gatewood house remains in its original state with no alterations since its building over 150 years ago. It has in the past ten years fallen into a bad state of repair, but its recent purchase is the beginning of its restoration process.

8 SIGNIFICANCE

PERIOD	AREAS OF SIGNIFICANCE -- CHECK AND JUSTIFY BELOW			
<input type="checkbox"/> PREHISTORIC	<input type="checkbox"/> ARCHEOLOGY-PREHISTORIC	<input type="checkbox"/> COMMUNITY PLANNING	<input type="checkbox"/> LANDSCAPE ARCHITECTURE	<input type="checkbox"/> RELIGION
<input type="checkbox"/> 1400-1499	<input type="checkbox"/> ARCHEOLOGY-HISTORIC	<input type="checkbox"/> CONSERVATION	<input type="checkbox"/> LAW	<input type="checkbox"/> SCIENCE
<input type="checkbox"/> 1500-1599	<input type="checkbox"/> AGRICULTURE	<input type="checkbox"/> ECONOMICS	<input type="checkbox"/> LITERATURE	<input type="checkbox"/> SCULPTURE
<input type="checkbox"/> 1600-1699	<input checked="" type="checkbox"/> ARCHITECTURE	<input type="checkbox"/> EDUCATION	<input type="checkbox"/> MILITARY	<input type="checkbox"/> SOCIAL/HUMANITARIAN
<input type="checkbox"/> 1700-1799	<input type="checkbox"/> ART	<input type="checkbox"/> ENGINEERING	<input type="checkbox"/> MUSIC	<input type="checkbox"/> THEATER
<input checked="" type="checkbox"/> 1800-1899	<input type="checkbox"/> COMMERCE	<input type="checkbox"/> EXPLORATION/SETTLEMENT	<input type="checkbox"/> PHILOSOPHY	<input type="checkbox"/> TRANSPORTATION
<input type="checkbox"/> 1900-	<input type="checkbox"/> COMMUNICATIONS	<input type="checkbox"/> INDUSTRY	<input type="checkbox"/> POLITICS/GOVERNMENT	<input checked="" type="checkbox"/> OTHER (SPECIFY) History
		<input type="checkbox"/> INVENTION		

SPECIFIC DATES

BUILDER/ARCHITECT

STATEMENT OF SIGNIFICANCE

Set in a woodland area of Putnam County, Gatewood House is a dwelling of unusual architectural qualities. Its significance lies in its refined, yet simple construction and because it was built c. 1805-1812, its elegance makes it all the more important. Its history is a colorful and romantic one. Many men have owned the house, and yet it remains original in every aspect; unaltered since its erection over 150 years ago.

In the land lottery of 1805, a man named John Keating of Warren County drew land lot number 300. The lot consisted of 202-1/2 acres "more or less" and lay in the very fertile land of Middle Georgia. It also contained part of Lick Creek and was therefore well-suited for a plantation home. Mr. Keating built Gatewood House and lived there until 1812. Nothing more is known about him, but it can be inferred that Mr. Keating must have been very prosperous to have built such finery in an area miles away from any town, in a wilderness known, up until 1805, only by traders and the Creek Indians. In 1812 Mr. Keating sold his 202-1/2 acres to Mr. James O'Neal for \$1200.00. Mr. O'Neal evidently succeeded in making the land and house a thriving cotton plantation for in 1818 he sold the lot and house to Mr. Z. Weddington for \$1900.00. Mr. Weddington sold the land in 1820 to Mr. William Walker at a loss for \$1400.00. At this point deed records are obscure. Mr. Walker sold the land, but it is not clear to whom he sold it. But by 1839 a Mr. James Jackson had owned it and had sold the 202-1/2 acres and house to Mrs. Francis M. Gatewood, for \$1200.00. It is for the Gatewood family that the house was named. The land, house, and their family cemetery remained in the Gatewood family until the 1920's when the United States government bought it along with many other acres in that area. In the 1930's Mr. H. Grady West bought 163 acres of this land lot number 300 (including the house) from the government. He has owned it since that time until recently when he sold the house to Mr. and Mrs. John Copeland of Eatonton, Georgia.

The Gatewoods, however, were the best known family that ever lived in the large house. They were a very wealthy people and owned town lots in Eatonton as well as hundreds of acres of land all over the northeast section of Putnam County. Richard Gatewood, born in 1773 at Caswell County, North Carolina, and his wife, Francis Markham Gatewood, born in 1781 at Dinwiddie County, Virginia, moved to Putnam County in 1809. They first lived somewhere in the far north-eastern part of Putnam County; most likely on the Oconee River (according to deed records). There were many Gatewood children, but perhaps the most well-

9 MAJOR BIBLIOGRAPHICAL REFERENCES

Dudley, Dr. and Mrs. Gatewood-Interview by Maria King, February, 1975
 Gatewood, Hal - Interview by Maria King, February, 1975
 King, Maria, Personal Inspection, February, 1975
 Macgregor, Elizabeth Z., Personal Inspection, August, 1974

NO UTM / HM

10 GEOGRAPHICAL DATA

ACREAGE OF NOMINATED PROPERTY approximately 127 acres
 UTM REFERENCES NO USGS AVAILABLE

	LATITUDE	LONGITUDE
NW	33° 23' 41"	83° 18' 02"
NE	33° 23' 41"	83° 17' 30"
SE	33° 23' 17"	83° 17' 30"
SW	33° 23' 17"	83° 18' 02"

A

ZONE	EASTING	NORTHING

C

ZONE	EASTING	NORTHING

B

ZONE	EASTING	NORTHING

D

ZONE	EASTING	NORTHING

VERBAL BOUNDARY DESCRIPTION

Beginning at a point 660 feet from Highway 44 on the dead end road leading to Gatewood House; boundaries are as follows: continue in a northeast direction parallel to Highway 44 for 1980 feet; turn due east 990 feet; due south 2,640 feet; due west 2,640 feet; and terminating at a point 1,320 feet due north. These boundaries are set to include immediate area of original plantation and family cemetery plots.

LIST ALL STATES AND COUNTIES FOR PROPERTIES OVERLAPPING STATE OR COUNTY BOUNDARIES

STATE	CODE	COUNTY	CODE

11 FORM PREPARED BY

NAME / TITLE

Architectural Historian)

Maria King, Historic Preservation Section (Elizabeth Z. Macgregor consulting/

ORGANIZATION

DATE

Department of Natural Resources

March 20, 1975

STREET & NUMBER

TELEPHONE

270 Washington Street, S.W.

404-656-2840

CITY OR TOWN

STATE

Atlanta

Fulton County

Georgia

12 STATE HISTORIC PRESERVATION OFFICER CERTIFICATION

THE EVALUATED SIGNIFICANCE OF THIS PROPERTY WITHIN THE STATE IS:

NATIONAL

STATE

LOCAL

As the designated State Historic Preservation Officer for the National Historic Preservation Act of 1966 (Public Law 89-665), I hereby nominate this property for inclusion in the National Register and certify that it has been evaluated according to the criteria and procedures set forth by the National Park Service.

FEDERAL REPRESENTATIVE SIGNATURE

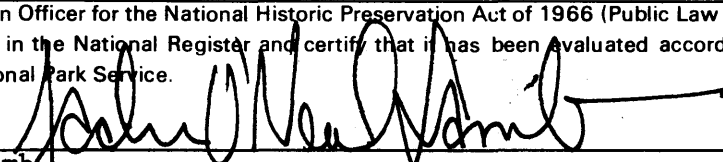

TITLE

Jackson O'Neal Lamb
 STATE HISTORIC PRESERVATION OFFICER

DATE

April 7, 1975

FOR NPS USE ONLY

I HEREBY CERTIFY THAT THIS PROPERTY IS INCLUDED IN THE NATIONAL REGISTER

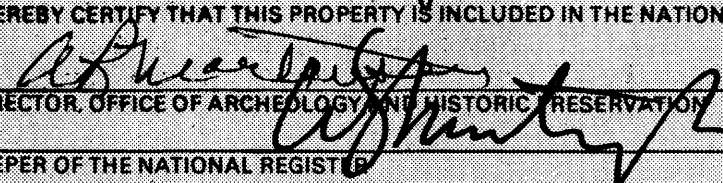

DATE

6/29/75

ATTEST:

DATE

JUN 20 1975

KEEPER OF THE NATIONAL REGISTER

UNITED STATES DEPARTMENT OF THE INTERIOR
NATIONAL PARK SERVICE

**NATIONAL REGISTER OF HISTORIC PLACES
INVENTORY -- NOMINATION FORM**

FOR NPS USE ONLY	
RECEIVED	APR 28 1975
DATE ENTERED	JUN 20 1975

CONTINUATION SHEET Significance ITEM NUMBER 8 PAGE 2

known was Mary Ann E. Gatewood. According to oral tradition, William H. Seward fell in love with Mary Gatewood and courted her during the time he stayed at the nearby home of Colonel Rowan Ward and taught at Union Academy. Seward ran away from Union College in New York at the age of seventeen and came to Putnam County, Georgia. Here he was hired to teach at the Union Academy which was located near Turnwold Plantation (home of Joel Chandler Harris). Mary's family did not approve of William Seward because he was a school teacher and a "Yankee", so he returned to New York without her; later becoming secretary of state under President Lincoln. Years later an unsent love letter was found by Joel Chandler Harris (creator of the Uncle Remus stories) when he was playing with some friends in the attic of the Ward House. The letter was addressed to Mary Gatewood from William Seward and was written long before the War Between the States. Unfortunately Mrs. Sarah Holt Ward gave the letter to Joel Chandler Harris years afterwards when he became a famous author, and it was lost among his many papers.

Today Gatewood House, standing strongly through war, and remaining stately in appearance, is an extremely important monument to Georgia and the nation. It not only is representative of the history of the early southern plantation owner, but is situated near the historical Turnwold Plantation where Joel Chandler Harris lived and wrote his famous stories. Architecturally Gatewood House is one of refined yet simple propriety, chaste in its appearance, and cultured in embellishments.

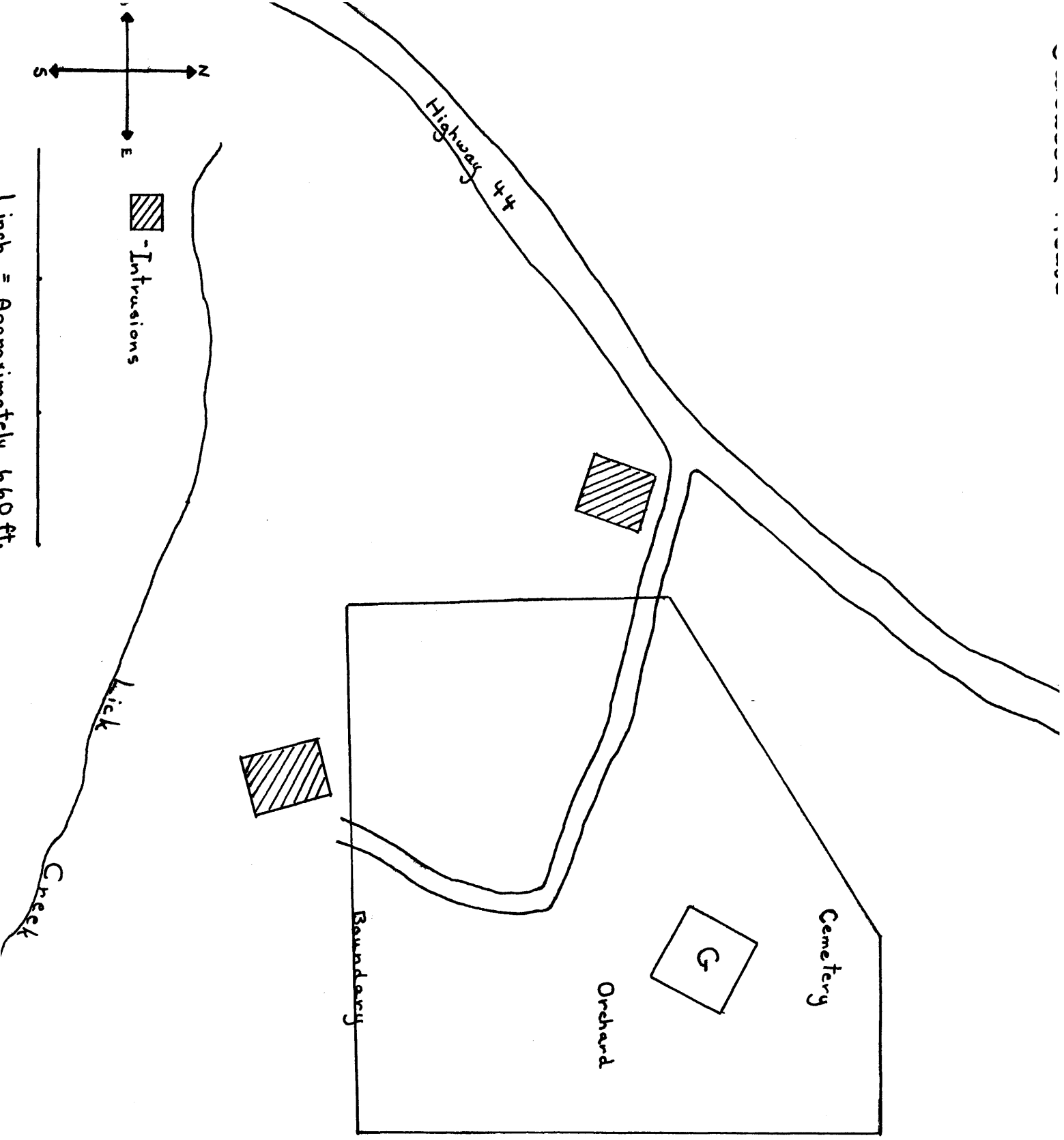
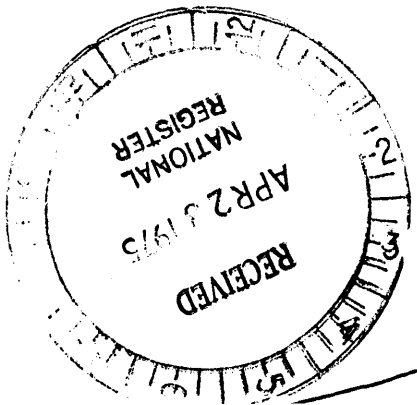

 - Intrusions

1 inch = Approximately 660 Ft.

