

KENTUCKY HISTORIC RESOURCES INVENTORY

Site No. Tm-42

1. Historic Name(s) Bates House		22. ADD/County No.Ky./Trimble 1 1 2	
Original Owner		23. U.S.G.S. Quadrant (15'/75') Madison East G.I.S. Mod. [] [] []	
2. Present Name		24. UTM Reference 1 6 6 4 3 6 6 0 4 2 7 8 4 4 0 Zone Easting Northing	
3. Location New Hope Road, Vedford Vicinity		25. Coordinate Accuracy []	
4. Owner's Name Gene Wingham		26. Prehistoric Site Object Historic Site Structure (Building) Other	
5. Owner's Address Box 131, Route 2, Bedford, Ky		27. National Register District Name: Historic Resources of Trimble County [] [] []	
6. Open to Public Yes <input type="checkbox"/> No <input checked="" type="checkbox"/>	7. Visible from road Yes <input checked="" type="checkbox"/> No <input type="checkbox"/>	8. Ownership [X] Private <input checked="" type="checkbox"/> Local <input type="checkbox"/> State <input type="checkbox"/> Federal <input type="checkbox"/>	
9. Local Contact/Organization		28. Significance Evaluation National Register [D]	
10. Site Plan with North Arrow		29. Status Date National Landmark <input type="checkbox"/> National Register <input type="checkbox"/> Landmark Certificate <input type="checkbox"/> Kentucky Survey <input type="checkbox"/> Local Landmark <input type="checkbox"/> HABS/HAER <input type="checkbox"/>	
		30. Historic Theme Primary Architecture [C] [] Secondary <input type="checkbox"/> Other <input type="checkbox"/>	
		31. Endangered Yes <input checked="" type="checkbox"/> No <input type="checkbox"/>	
		32. Preservation Project Status [] Actual Cost in \$1,000s [] [] [] [] []	
11. Architect		33. ATTACH PHOTO	
12. Builder			
13. Date ca.1830 A. <input checked="" type="checkbox"/> B. <input type="checkbox"/>			
14. Style A. Federal [B] B. <input type="checkbox"/>			
15. Original Use Dwelling [A]			
16. Present use Vacant			
17. Condition Fair [C]			
18. Description The Bates House is a one and one-half story rectangular building of brick construction with a one-story brick ell. Fenestration consists of four bays with two off-center entrances. All exterior facade bays are embellished with delicate reeding with corner block. The facade is enhanced by Flemish bond brick work, while the remainder is executed in common bond with a row of headers every five rows. <small>(Continue on Back)</small>		No. Stories 1 1/2 [B] Single Pile <input checked="" type="checkbox"/> NA <input type="checkbox"/> Double Pile <input type="checkbox"/> Floor Plan Hall Parlor [E] Structural Fabric Brick A. <input checked="" type="checkbox"/> B. <input type="checkbox"/> Decorative Fabric Flemish Bond A. <input checked="" type="checkbox"/> Common Bond B. <input checked="" type="checkbox"/> Roof Form Gable	
19. History Once owned by Bates family and later the Wingham family.		Roll No. 24 Picture No. 1 - 15 Direction _____	
20. Significance Architecture: The Bates House is one of the outstanding examples of the Federal style in Trimble County. As one of three Federal style hall-parlor		34. Prepared by William Gus Johnson Sr.Historian & Photographer	
21. Source of Information		35. Organization Kentucky Heritage Council	
		36. Date Fall 1982	
		37. Revision Dates 38. Staff Review	

18. 6/6 pane windows with jackarches pierce the facade. Both entranceways have three-pane transoms which have been enclosed. Interior gable end chimneys with two 2/2/2 pane gable windows at each end arise from the gabled tin roof, and the ell also has an interior gable-end chimney. The dwelling has a full basement of limestone construction. The poplar rafters are 4' X 4', and floor joists are poplar logs. The high quality Federal woodwork is executed in symmetrical trim. Federal style mantels and floor to ceiling four-panel wallpresses are intact. A one and one-half story frame meathouse is the only dependency associated with the dwelling.

20. dwellings included in the Historic Resources of Trimble County, the Bates House, the Bird House and Tm-55 represent the best illustrations of this particular style in Trimble County. The dwelling is historically significant in the early development of the county, and a significant cultural resource. Although in a neglected state today, the Bates House displays excellent craftsmanship and design, and reflects admirable architectural qualities of the Federal style as is evident by the Flemish bond facade, period embellishments of the exterior facade bays and outstanding interior detailing.

KENTUCKY HISTORIC RESOURCE INVENTORY SUPPLEMENT
BOUNDARY AND LOCATION INFORMATION

Historic Property Name Bates House Site # Tm-42

Multiple Resource/Thematic Nomination Title Historic Resources of Trimble County

U.T.M. Coordinates - List multiple UTM's if property is ten or more acres.

A. 16 643660 4278440 D. _____

B. _____ E. _____

C. _____ F. _____

Verbal Boundary Description Acreage 1.5

Beginning at the intersection of the farm lane and New Hope Road proceed 300' in a northward direction; thence 200' in an eastward direction; thence 300' in a southward direction; thence 200' in a westward direction to the point of origin. The boundary is drawn to include the house and outbuilding.

Sketch of Site Plan (Showing outbuildings, structures, landscape features and the site boundary as described above.)

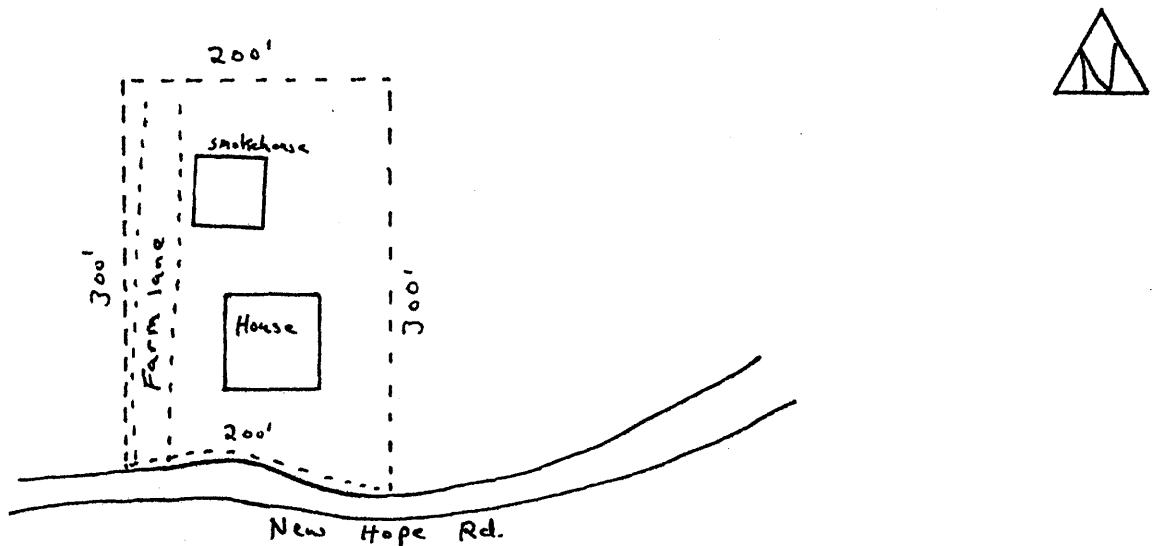

Not to scale

Official Courthouse Property Reference: