

1. Historic Name (s) A.C. Davidson House

Original Owner \_\_\_\_\_

Present Name \_\_\_\_\_

3. Owner's Name Carley Dickerson

4. Owner's Address Cemetery Rd - Bowling Green, Ky  
at elevation

5. Location 1 m. W. of Leayou Rd.; beginning of lane is 2 m S.

6. Open to Public Yes  No

7. Visible from road Yes  No

8. Ownership Private  Local  State  Federal

9. Local Contact/Organization \_\_\_\_\_

22. ADD/County BARTON

23. Zoning Classification Magisterial District

24. U.S.G. S. Quadrant (15'/75') Allen Springs

25. UTM Reference Zone 116 Easting 5517026 Northing 410718240

26. Prehistoric Site  Historic Site  Object Building Structure

27. District Yes  No

28. Significance Evaluation NR

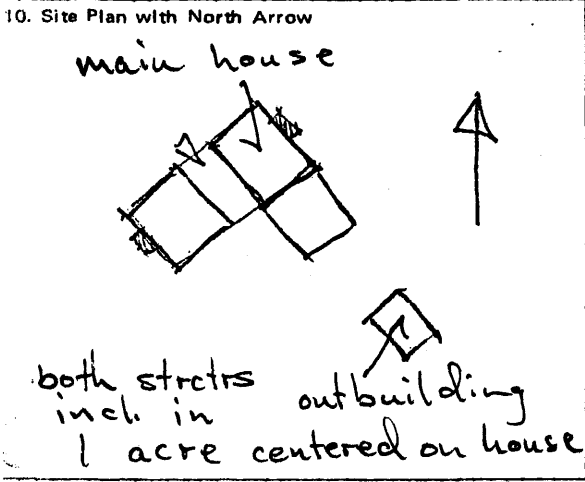

11. Architect \_\_\_\_\_

12. Builder \_\_\_\_\_

13. Date from 1st 1/3 19thc

14. Style dogtrot log

15. Original Use house

16. Present Use house

17. Condition Interior  Exterior good

29. Status National Landmark  National Register  Landmark Certificate  Kentucky Survey  Local Landmark  HABS/HAER

30. Theme Primary log houses Secondary architecture Other

31. Endangered Yes  No

18. Description 2 story dogtrot form - log - two exterior end stone chimneys - step shouldered (right) regular coursed - dog trot enclosed - slope shouldered (left) - slope shouldered (ell) - square notched outbuilding - porch (later) in angle of ell left pen probably first - rear pen and right pen later - half dovetail notching on outbuilding - rear and right chimneys have foundation ledges

19. History right pen - half dovetail - sited on rise in bend of Drake's Creek

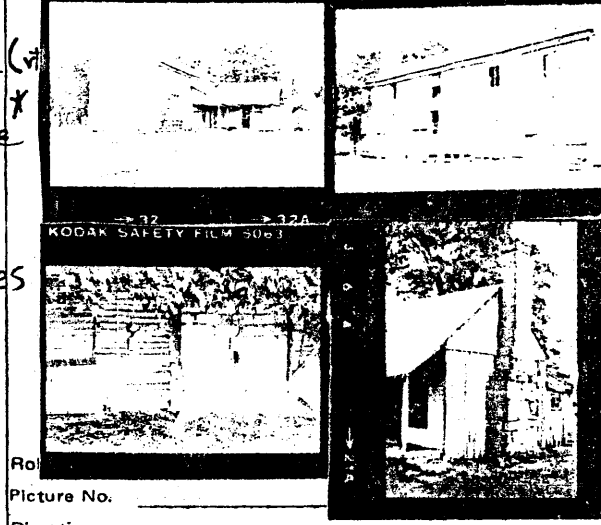

20. Significance 1877 Beers Atlas - A.C. Davidson, Hill particularly clear illustration of a historic attitude toward the relationship between structure and landscape; clear illustration of a common type and structural technique.

33. Tape No. \_\_\_\_\_ Negative No. \_\_\_\_\_

34. Prepared by: KTG - JCH

35. Organization KHC

36. Date Spring 78

37. Revision Dates \_\_\_\_\_ 38. Staff Review \_\_\_\_\_

21. Source of Information \_\_\_\_\_



NOV 26 1983

## Architecture

91. This complex of log buildings is one of the clearest illustrations in the county of the use of log construction in the accretive increase of domestic space. Several building stages produced the two-storied main block in dogtrot form with a one-storied, single pen ell and a nearby single pen outbuilding. The significance of the group of log buildings is enhanced by the sensitive siting on a low rise above the bottom land in a bend of Drakes Creek in a manner representative of early nineteenth century attitudes of domestic siting. The house is the most distinguished of fifteen log structures along Drakes Creek.

UNITED STATES DEPARTMENT OF THE INTERIOR  
NATIONAL PARK SERVICE

**NATIONAL REGISTER OF HISTORIC PLACES  
INVENTORY -- NOMINATION FORM**

FOR NPS USE ONLY	
RECEIVED	NOV 13 1980
DATE ENTERED	NOV 26 1980

Warren County Multiple Resource Area  
Warren County, Kentucky

CONTINUATION SHEET

ITEM NUMBER

PAGE

ADDENDUM

Wa-91

The A. C. Davidson house is unoccupied and has been neglected, but it is in sound structural condition. Despite lack of recent maintenance, the roof is intact; despite the removal of weatherboarding in several places, the fabric of the log house is well-preserved; the stone chimneys show no signs of structural weakness.