

United States Department of the Interior  
National Park Service

National Register of Historic Places  
Continuation Sheet

Section number \_\_\_\_\_ Page \_\_\_\_\_

SUPPLEMENTARY LISTING RECORD

NRIS Reference Number: 97000244

Date Listed: 3/18/97

Seven Islands Methodist Church  
Property Name

Knox  
County

TENNESSEE  
State

Knoxville and Knox County MPS  
Multiple Name

-----  
This property is listed in the National Register of Historic Places in accordance with the attached nomination documentation subject to the following exceptions, exclusions, or amendments, notwithstanding the National Park Service certification included in the nomination documentation.

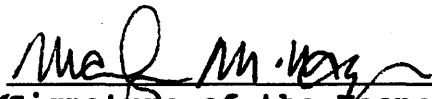
  
Signature of the Keeper

3/24/97  
Date of Action

=====  
Amended Items in Nomination:

Section No. 8

This nomination is amended to limit the period of significance to 1865, the year the church was constructed. Significance is being claimed only for architecture.

The property meets the conditions of Criteria Consideration A, for religious properties.

These changes have been confirmed by the Tennessee SHPO.

-----  
DISTRIBUTION:

- National Register property file
- Nominating Authority (without nomination attachment)

United States Department of the Interior  
National Park Service

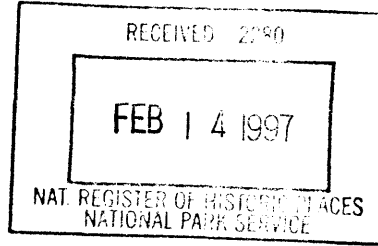

National Register of Historic Places  
Registration Form

This form is for use in nominating or requesting determinations for individual properties and districts. See instructions in *How to Complete the National Register of Historic Places registration Form* (National Register Bulletin 16A). Complete each item by marking "x" in the appropriate box or by entering the information requested. If an item does not apply to the property being documented, enter "N/A" for "not applicable." For functions, architectural classification, materials, and areas of significance, enter only categories and subcategories from the instructions. Place additional entries and narrative items on continuation sheets (NPS Form 10-900a). Use a typewriter, word processor, or computer, to complete all items.

1. Name of Property

historic name Seven Islands Methodist Church  
other names/site number Seven Islands Community Church, Historic Sites Survey No. 2822

2. Location

street & number 8100 Seven Islands Road  not for publication N/A  
city or town Knoxville  vicinity  
state Tennessee code TN county Knox code 093 zip code 37920

3. State/Federal Agency Certification

As the designated authority under the National Historic Preservation Act, as amended, I hereby certify that this  nomination  request for determination of eligibility meets the documentation standards for registering properties in the National Register of Historic Places and meets the procedural and professional requirements set for in 36 CFR Part 60. In my opinion, the property  meets  does not meet the National Register criteria. I recommend that this property be considered significant  nationally  statewide  locally. (See continuation sheet for additional comments.)

Herbert L. Hays 1/31/97  
Signature of certifying official/Title Date  
Deputy State Historic Preservation Officer, Tennessee Historical Commission  
State or Federal agency and bureau

In my opinion, the property  meets  does not meet the National Register criteria. ( See Continuation sheet for additional comments.)

\_\_\_\_\_  
Signature of certifying official/Title Date  
\_\_\_\_\_  
State or Federal agency and bureau

4. National Park Service Certification

I hereby certify that the property is:  
 entered in the National Register.  
 See continuation sheet  
 determined eligible for the National Register.  
 See continuation sheet  
 determined not eligible for the National Register  
 removed from the National Register.  
 other, (explain:) \_\_\_\_\_

\_\_\_\_\_  
Signature of the Keeper Date of Action  
Ma J M. Dy 3/18/97  
\_\_\_\_\_  
\_\_\_\_\_  
\_\_\_\_\_

Seven Islands Methodist Church  
Name of Property

Knox County, TN  
County and State

**5. Classification**

**Ownership of Property**  
(Check as many boxes as apply)

**Category of Property**  
(Check only one box)

**Number of Resources within Property**  
(Do not include previously listed resources in count)

- private
- public-local
- public-State
- public-Federal

- building(s)
- district
- site
- structure
- object

Contributing

Noncontributing

1		buildings
		sites
		structures
		objects
1	0	Total

**Name of related multiple property listing**  
(Enter "N/A" if property is not part of a multiple property listing.)

Hist & Arch Resources of Knoxville & Knox Co.,  
TN

**Number of Contributing resources previously listed  
in the National Register**

0

**6. Function or Use**

**Historic Functions**

(Enter categories from instructions)

RELIGION: religious facility

**Current Functions**

(Enter categories from instructions)

RELIGION: religious facility

**7. Description**

**Architectural Classification**

(Enter categories from instructions)

Other: Vernacular Church

**Materials**

(Enter categories from instructions)

foundation stone

walls weatherboard

roof metal standing seam

other wood

**Narrative Description**

(Describe the historic and current condition of the property on one or more continuation sheets.)

**8. Statement of Significance**

**Applicable National Register Criteria**

(Mark "x" in one or more boxes for the criteria qualifying the property for National Register listing.)

- A** Property is associated with events that have made a significant contribution to the broad patterns of our history.
- B** Property is associated with the lives of persons significant in our past.
- C** Property embodies the distinctive characteristics of a type, period, or method of construction or represents the work of a master, or possesses high artistic values, or represents a significant and distinguishable entity whose components lack individual distinction.
- D** Property has yielded, or is likely to yield, information important in prehistory or history.

**Criteria Considerations**

N/A

(Mark "x" in all boxes that apply.)

Property is:

- A** owned by a religious institution or used for religious purposes.
- B** removed from its original location.
- C** moved from its original location.
- D** a cemetery.
- E** a reconstructed building, object, or structure.
- F** a commemorative property
- G** less than 50 year of age or achieved significance within the past 50 years.

**Areas of Significance**

(Enter categories from instructions)

ARCHITECTURE

**Period of Significance**

c.1865 - 1945

**Significant Dates**

c.1865

**Significant Person**

(complete if Criterion B is marked)

N/A

**Cultural Affiliation**

N/A

**Architect/Builder**

UNKNOWN

**Narrative Statement of Significance**

(Explain the significance of the property on one or more continuation sheets.)

**9. Major Bibliographical References**

**Bibliography**

(Cite the books, articles, and other sources used in preparing this form on one or more continuation sheets.)

**Previous documentation on file (NPS):** N/A

- preliminary determination of individual listing (36 CFR 67) has been requested
- previously listed in the National Register
- Previously determined eligible by the National Register
- designated a National Historic Landmark
- recorded by Historic American Buildings Survey # \_\_\_\_\_
- recorded by Historic American Engineering Record # \_\_\_\_\_

**Primary location of additional data:**

- State Historic Preservation Office
- Other State Agency
- Federal Agency
- Local Government
- University
- Other

Name of repository:

Knoxville-Knox County Metro Planning Commission

Seven Islands Methodist Church  
Name of Property

Knox County, TN  
County and State

### 10. Geographical Data

Acreage of Property approximately .75 acres Boyd's Creek, TN

#### UTM References

(place additional UTM references on a continuation sheet.)

1 17 25600 3981760  
Zone Easting Northing  
2 \_\_\_\_\_

3 \_\_\_\_\_  
Zone Easting Northing  
4 \_\_\_\_\_

See continuation sheet

#### Verbal Boundary Description

(Describe the boundaries of the property on a continuation sheet.)

#### Boundary Justification

(Explain why the boundaries were selected on a continuation sheet.)

### 11. Form Prepared By

name/title Ann K. Bennett, Senior Planner  
organization Knoxville-Knox County Metropolitan Planning Commission date September 1996  
street & number 403 City County Building, 400 Main Avenue telephone 423-521-2500  
city or town Knoxville state TN zip code 37902

#### Additional Documentation

submit the following items with the completed form:

#### Continuation Sheets

#### Maps

A USGS map (7.5 or 15 minute series) indicating the property's location.

A Sketch map for historic districts and properties having large acreage or numerous resources.

#### Photographs

Representative **black and white photographs** of the property.

#### Additional items

(Check with the SHPO) or FPO for any additional items

### Property Owner

(Complete this item at the request of SHPO or FPO.)

name Seven Islands Church and Cemetery Association c/o Patsy Aytes  
street & number 3712 Woodland School Road telephone \_\_\_\_\_  
city or town Knoxville state TN zip code 37920

**Paperwork Reduction Act Statement:** This information is being collected for applications to the National Register of Historic Places to nominate properties for listing or determine eligibility for listing, to list properties, and to amend existing listing. Response to this request is required to obtain a benefit in accordance with the National Historic Preservation Act, as amended (16 U.S.C. 470 *et seq.*)

**Estimated Burden Statement:** Public reporting burden for this form is estimated to average 18.1 hours per response including time for reviewing instructions, gathering and maintaining data, and completing and reviewing the form. Direct comments regarding this burden estimate or any aspect of this form to the Chief, Administrative Services Division, National Park Service, P. O. Box 37127, Washington, DC 20013-7127; and the Office of Management and Budget, Paperwork Reductions Projects (1024-0018), Washington, DC 20303.

#### Narrative Description

**United States Department of the Interior**  
National Park Service

# National Register of Historic Places

## Continuation Sheet

Section number 7 Page 2

Seven Islands Methodist Church  
Knox County, TN

---

The Seven Islands Methodist Church, now known as Seven Islands Community Church, is located on the northeast side of Seven Islands Road, at a bend in the road that follows the banks of the French Broad River some two hundred feet to the north and east. The church sits at the highest elevation on the tract of land. To the east of the church building is a cemetery that was established in the late eighteenth or early nineteenth century. Interments continue at the present time. To the north of the building is a stand of mature trees. A gravel drive circles the church building, approaching from the south and Seven Islands Road, and circling to the north around the rear of the church.

Seven Islands Church is a one story frame building with a gable roof. The walls are covered with weatherboard, and marked by corner boards. The building is supported by a stone foundation. The south facade contains the main entrance to the building. Three stone steps lead to the entrance of the building. The entrance is comprised of double entry doors with recessed panels in a Cross and Bible design. A short recessed two light transom is located above the entry doors.

The gable end of the roof is marked by a circular sawn wood attic vent. Above the gable peak is a square cupola, or bell tower, also with a gable roof. On each side of the cupola are sawn wood louvered vents.

Three two-over-two double hung wood windows appear on the east and west elevations of the church building. The windows are arched and have wood sills. The rear of the church is unadorned, with a single rear entry door in a Cross and Bible paneled design.

The interior of the building consist of a pine floor with interior walls covered in horizontal boards. The ceiling, which is also covered in boards, is a tall, tray ceiling designed to capture some of the room contained under the gable roof. At the rear of the church, above the double entry doors, a ladder is mounted on the wall providing access to the cupola.

A noteworthy feature of the interior are the pews, which were moved to this church from the old Lebanon in the Forks Presbyterian Church when it was constructed. The pews are pine, with plank seats and backs.

**United States Department of the Interior**  
National Park Service

# National Register of Historic Places Continuation Sheet

Section number 8 Page 3

Seven Islands Methodist Church  
Knox County, TN

---

## Statement of Significance

The significance of the Seven Islands Methodist Church lies in its unadorned, unchanged architectural design. The building is unique among churches in Knox County. No major changes have occurred since its construction circa 1865. The Seven Islands Church is being nominated to the National Register of Historic Places under criterion C.

The land for the Seven Islands Church and its adjoining cemetery was donated by John Huffaker in 1835. However, the Methodist congregation in the Seven Islands Community predated the 1835 date by about thirty-two years. In 1802, Bishop Francis Asbury, sent to America by John Wesley in 1784, became a prominent representative of the pioneer Protestants church movement in America. Asbury first traveled across the Alleghenies in 1788. He first came to Knoxville in November 1800, on his sixth trip across the Alleghenies. He preached in Nashville, and on his return trip visited Francis Alexander Ramsey of Knox County. Asbury's next visit to Knox County occurred in 1802. He spent several days at the home of Justus Huffaker on the French Broad River in the Seven Islands Community. On that trip, Justus Huffaker was ordained as a deacon.

When the Seven Islands Church was built in 1835, it was a log building located in the present day cemetery. A school was also located on the site. The log house was torn down in 1855, with the construction of the present church. At the time of construction of the Seven Islands Church, the old pews from the Lebanon in the Forks Presbyterian Church were placed in the building.

The Civil War had an affect on Seven Islands Church. The church split into two congregations as part of the congregation found its sympathies aligned with the Confederate cause and the others aligned with the Union. The Union faction in the congregation established Ridgeway Methodist Church as a result of the division in the church, building their current building in the 1880s. The two congregations were parties in a lawsuit filed after 1887.

The Seven Islands Church became a Baptist Church, and the Baptist congregation built a new building across the road and to the south of the present church about twenty years ago. The Seven Islands Community Church's influence is therefore not as great as it was in 1855, when after a two week revival to celebrate the new church building, the Seven Islands area was known for a time as "Pious Bend," a recognition of the influence of the Seven Islands Church. However, the Seven Islands Church, with its straightforward design and significant geographical location, continues to hold a strong position in the affections of residents of the Seven Islands community. Unique in the lack of physical changes made to the building, and in the representation it makes of an early frontier church, the Seven Islands Methodist Church remains significant in understanding the ecclesiastical development in frontier Knox County.

**United States Department of the Interior**  
National Park Service

# **National Register of Historic Places**

## **Continuation Sheet**

Section number   9   Page   4  

Seven Islands Methodist Church  
Knox County, TN

---

### **Bibliography**

Herzog, Pat. Personal Interview, September, 1992.



**United States Department of the Interior**  
National Park Service

# National Register of Historic Places Continuation Sheet

Section number 10 Page 5

Seven Islands Methodist Church  
Knox County, TN

---

## Verbal Boundary Description

Part of Parcel 20, CLT Map 113, Knox County, Tennessee. Beginning at a point on the northern side of Seven Islands Road where a gravel drive intersects the roadway and running north 300 feet to a point; thence west 100 feet to a point; thence south 300 feet to a point on the right of way of Seven Islands Road; thence east 100 feet to the point of beginning.

## Boundary Justification

This nomination encompasses the land on which is located the Seven Islands Community Church.

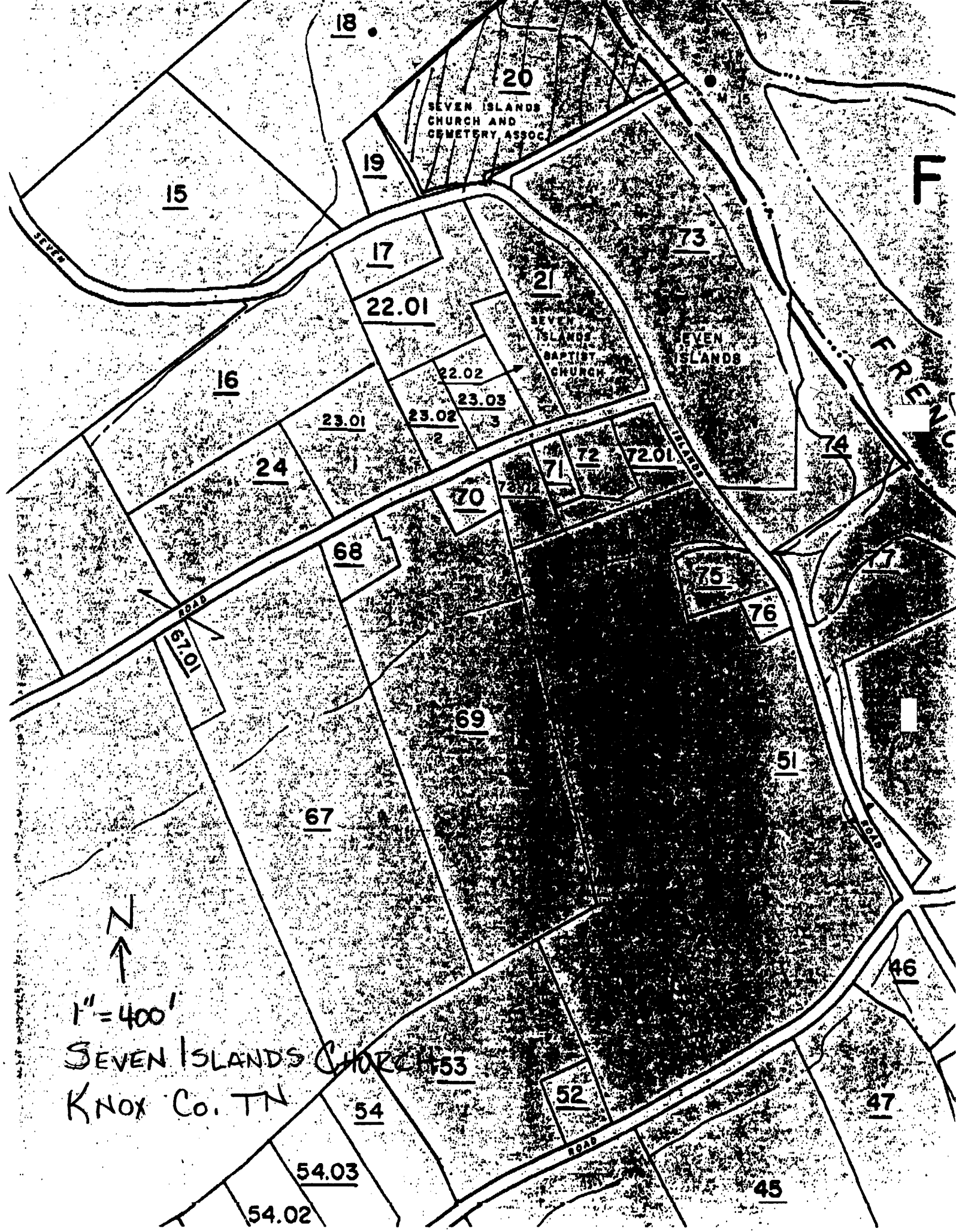

SEVEN ISLANDS  
CHURCH AND  
CEMETERY ASSOC.

SEVEN  
ISLANDS  
BAPTIST  
CHURCH

SEVEN  
ISLANDS



1" = 400'

SEVEN ISLANDS CHURCH 53

KNOX Co. TN

F

FRENCH

46

47

45

54

52

54.03

54.02

51

69

67

68

70

24

23.01

23.02

23.03

22.02

22.01

21

17

73

19

15

18

20

SEVEN

ISLANDS

ROAD

67.01

ROAD

ROAD

**United States Department of the Interior**  
National Park Service

# National Register of Historic Places Continuation Sheet

Section number photos Page 7

Seven Islands Methodist Church  
Knox County, TN

---

Seven Islands Methodist Church  
8100 Seven Islands Road  
Knox County, Tennessee  
Tennessee Historical Commission  
Pamela Dishongh  
September, 1993

South facade, facing north  
#1 of 10

West elevation, facing east  
#2 of 10

North elevation, facing south  
#3 of 10

East elevation, facing west  
#4 of 10

Interior detail, ceiling structural members, facing south  
#5 of 10

Interior detail, pews and window, facing east  
#6 of 10

Interior, facing north  
#7 of 10

Interior, facing northeast  
#8 of 10

Cemetery, facing northeast  
#9 of 10

Cemetery, facing southeast  
#10 of 10