

United States Department of the Interior
Heritage Conservation and Recreation Service

National Register of Historic Places
Inventory—Nomination Form

See instructions in *How to Complete National Register Forms*
Type all entries—complete applicable sections



1. Name

historic Benjamin Holt House Residence
and/or common Boy Scout Headquarters--Forty Niner Council

2. Location

street & number 548 Park Street not for publication
city, town Stockton vicinity of _____ congressional district 14th
state California code 06 county San Joaquin code 077

3. Classification

Category	Ownership	Status	Present Use
<input type="checkbox"/> district	<input type="checkbox"/> public	<input checked="" type="checkbox"/> occupied	<input type="checkbox"/> agriculture
<input checked="" type="checkbox"/> building(s)	<input checked="" type="checkbox"/> private	<input type="checkbox"/> unoccupied	<input type="checkbox"/> commercial
<input type="checkbox"/> structure	<input type="checkbox"/> both	<input type="checkbox"/> work in progress	<input type="checkbox"/> educational
<input type="checkbox"/> site	Public Acquisition	Accessible	<input type="checkbox"/> entertainment
<input type="checkbox"/> object	<input type="checkbox"/> in process	<input checked="" type="checkbox"/> yes: restricted	<input type="checkbox"/> government
	<input type="checkbox"/> being considered	<input type="checkbox"/> yes: unrestricted	<input type="checkbox"/> industrial
		<input type="checkbox"/> no	<input type="checkbox"/> military
			<input type="checkbox"/> museum
			<input type="checkbox"/> park
			<input type="checkbox"/> private residence
			<input type="checkbox"/> religious
			<input type="checkbox"/> scientific
			<input checked="" type="checkbox"/> transportation
			<input type="checkbox"/> other: <u>Office Space</u>

4. Owner of Property

name Mr. Don Compton
street & number P.O. Box 7765
city, town Stockton vicinity of _____ state CA 95207

5. Location of Legal Description

courthouse, registry of deeds, etc. San Joaquin County Recorder's Office
street & number 222 Weber Street
city, town Stockton state CA 95202

6. Representation in Existing Surveys

title Stockton Historic Building Survey has this property been determined eligible? yes no
date 1977 federal state county local
depository for survey records Office of Historic Preservation
city, town Sacramento state California

7. Description

Condition		Check one	Check one	
<input checked="" type="checkbox"/> excellent	<input type="checkbox"/> deteriorated	<input type="checkbox"/> unaltered	<input checked="" type="checkbox"/> original site	
<input type="checkbox"/> good	<input type="checkbox"/> ruins	<input checked="" type="checkbox"/> altered	<input type="checkbox"/> moved	date _____
<input type="checkbox"/> fair	<input type="checkbox"/> unexposed			

Describe the present and original (if known) physical appearance

The Benjamin Holt residence is a two-story, detached home, the basic structure of which dates to 1869. Numerous subsequent additions, however, have altered its original appearance and given it a highly irregular plan. These alterations do not detract from the structure's integrity; they were undertaken by the Holt family, whose residency here forms the basis of this structure's historical significance.

The Park Street (north), or front, elevation, is dominated by a Colonial Revival entry, which was commissioned by Mrs. Benjamin Holt in 1929. It replaced an earlier front porch. A broken pediment supported by fluted pilasters surmounts the panelled door and fanlight transom of the entry (photo # 1). This elevation is lighted by four 6/6 light double hung windows with wooden shutters.

The east elevation, which fronts on American Street, is visually and structurally divisible into four parts (Photo # 3). At the northeast is a plain wall broken only by two 6/6 light windows with wooden shutters. Moving south, one encounters a two-story square bay window topped by a pediment at its gable end. The first-story of this bay window is abundantly lighted by twelve large multipaned fixed windows, which serve as a solarium. The fenestration on the second story of this bay is somewhat irregular, with 4/4 double-hung windows on the sides and paired 6/6 double hung windows facing the street. The dominant feature of the east elevation is a large, flat-roofed porch, supported by six evenly spaced Doric columns and enclosed by a simple balustrade. Fenestration above the porch is 6/6 double-hung sash. Sheltered by the porch are paired 6/6 double hung windows, as well as paired 4/4 double-hung windows flanked by two fixed four-light windows. The southern end of the east elevation consists of a two-story addition. This addition is sheathed in flush horizontal siding, while the remainder of the house is covered by clapboard siding. Fenestration in this addition deviates notably from that of the primary structure, with two pair of 6 light casement windows on the first story and three single-light hinged windows on the second story.

The rear, or southern, elevation, is comprised entirely of the two-story addition (photo # 2). There are eight single-light windows on the second story. On the first story, double hung windows flank the doorway while three pair of casement windows are to the right (east) of the doorway. The doorway itself has been severely damaged and must be replaced.

The west elevation, like the east, is highly irregular and visually divisible into four parts--a simple wall to the north, followed by a two-story bay-like extension, followed by a porch, followed by the two-story addition to the south. (Photo # 2) The northwest section is identical to its counterpart on the east elevation. Moving south, one encounters a two-story gabled extension. This extension has 6/6 double hung windows on the sides, and ten 6/6 double hung windows on its west face. There is a round attic vent at the gable end. Further south is a one-story sleeping porch, added circa 1917. Above the porch are two 6/6 double hung windows and a 4/4 double hung window. At the far southern end of the west elevation is the two-story rear addition, with fenestration similar to that on the east side of this addition.

To the south of the residence is a one-story, hipped-roofed garage. This garage was built circa 1904 when the Holt's obtained their first automobile. The three

8. Significance

Period	Areas of Significance—Check and justify below			
<input type="checkbox"/> prehistoric	<input type="checkbox"/> archeology-prehistoric	<input type="checkbox"/> community planning	<input type="checkbox"/> landscape architecture	<input type="checkbox"/> religion
<input type="checkbox"/> 1400-1499	<input type="checkbox"/> archeology-historic	<input type="checkbox"/> conservation	<input type="checkbox"/> law	<input type="checkbox"/> science
<input type="checkbox"/> 1500-1599	<input checked="" type="checkbox"/> agriculture	<input type="checkbox"/> economics	<input type="checkbox"/> literature	<input type="checkbox"/> sculpture
<input type="checkbox"/> 1600-1699	<input type="checkbox"/> architecture	<input type="checkbox"/> education	<input type="checkbox"/> military	<input type="checkbox"/> social/humanitarian
<input type="checkbox"/> 1700-1799	<input type="checkbox"/> art	<input type="checkbox"/> engineering	<input type="checkbox"/> music	<input type="checkbox"/> theater
<input checked="" type="checkbox"/> 1800-1899	<input type="checkbox"/> commerce	<input type="checkbox"/> exploration/settlement	<input type="checkbox"/> philosophy	<input type="checkbox"/> transportation
<input type="checkbox"/> 1900-	<input type="checkbox"/> communications	<input checked="" type="checkbox"/> industry	<input type="checkbox"/> politics/government	<input type="checkbox"/> other (specify)
		<input checked="" type="checkbox"/> invention		

Specific dates 1869; with numerous alterations
Builder/Architect

Statement of Significance (In one paragraph)

This structure is significant chiefly for its association with Benjamin Holt (1849-1920), inventor of the "Caterpillar" tractor and one of California's most important industrialists. Although not architecturally significant, the present appearance of this structure dates to the period in which Holt lived here and reflects the tastes and increasing affluence of his family.

While he lived here (1899-1920), Holt made major contributions to the mechanization of agriculture. Holt held more than one hundred patents that collectively helped revolutionize the manner in which the crops of the world were cultivated and harvested. These patents involved major breakthroughs in steam traction engines as well as the internationally-significant Caterpillar track-type tractor.

Holt's original 1904 test of the first track-type tractor was followed by extensive work leading to mass production and widespread public acceptance of this type of vehicle. Much of the testing and early production of the tractor was accomplished at the big Holt Manufacturing Company plant a few blocks from this house. In 1908, the first gasoline-powered model was sold for use in construction of the Los Angeles Aqueduct leading from the Owens Valley to the Los Angeles Basin. In 1913, the term, "Caterpillar," was adopted as the trademark for these products. During World War I, the company concentrated upon construction of slightly-modified agricultural tractors for use in hauling artillery and supplies in the battlegrounds of Western Europe, a great improvement over previous horse-drawn transport vehicles. The United States, British, French, and Russian armies utilized some 9000 Caterpillars during the war, giving the product a worldwide exposure. The wartime success of these track-type tractors led other firms to experiment with an armored version, or "tank," for battlefield use. Production of Caterpillars during World War I was accomplished at the main plant in Stockton as well as in branch operations in Peoria, Illinois and elsewhere.

Even though Holt served as president of the company for several decades, he adopted an informal stance toward his employees and the operations of the firm. Seldom seen in his executive office, Holt preferred to spend his time in the experimental shop and elsewhere in the plant. He enjoyed socializing with his employees and often joined them at local saloons after hours. His influence resulted in many employee benefits, including a company hospital, club house, ball team, band, and annual picnic. The Holt Manufacturing Company remained a major employer in Stockton until 1925, five years after Holt's death. At that time, the company merged with the Best Tractor Company, to form the Caterpillar Tractor Company of today.

ACREAGE NOT VERIFIED
UTM NOT VERIFIED

9. Major Bibliographical References

"Fifty Years on Tracks", Caterpillar Tractor Company, 1954.
Articles in: Agricultural History, January, 1975; Americana Magazine, July, 1936.
"Cats and Combines," unpublished ms., by Reynold Wik, Mills College, 1978. (Deposited in Pioneer Museum and Haggin Galleries, Stockton, California)

10. Geographical Data

Acreeage of nominated property .57
Quadrangle name Stockton, West Quadrangle scale 1:24000

UMT References

A	<u>10</u>	<u>650710</u>	<u>429269d</u>	B			
	Zone	Easting	Northing		Zone	Easting	Northing
C				D			
E				F			
G				H			

Verbal boundary description and justification See assessor's base map attached. Parcel 4, block 108, East of Center Street, , Assessors Map 139-16.

List all states and counties for properties overlapping state or county boundaries

state	code	county	code
state	code	county	code

11. Form Prepared By

name/title Raymond W. Hillman, Regional V.P. # 8

organization Conference of California Historical Societies date May 27, 1980

street & number 1021 N. Argonaut Street telephone (209) 462-4116

city or town Stockton state California 95203

12. State Historic Preservation Officer Certification

The evaluated significance of this property within the state is:

national state local

As the designated State Historic Preservation Officer for the National Historic Preservation Act of 1966 (Public Law 89-665), I hereby nominate this property for inclusion in the National Register and certify that it has been evaluated according to the criteria and procedures set forth by the Heritage Conservation and Recreation Service.

State Historic Preservation Officer signature R Hillman

title State Historic Preservation Officer date 12/1/80

For HCERS use only
I hereby certify that the property is included in the National Register.

William H. Robinson 3-2-82
Keeper of the National Register

Attest:
Chief of _____

FHR-8-300A
(11/78)

UNITED STATES DEPARTMENT OF THE INTERIOR
HERITAGE CONSERVATION AND RECREATION SERVICE

**NATIONAL REGISTER OF HISTORIC PLACES
INVENTORY -- NOMINATION FORM**

FOR HCRS USE ONLY

RECEIVED JAN 20 1982

DATE ENTERED

CONTINUATION SHEET

1

ITEM NUMBER 7

PAGE 2

sliding doors are original. (photo #5)

The house is surrounded by lawn area, brick retaining walls, a large brick patio area, and many old trees, including several palms dating to the period of the Holt's residence at the site.

PARK STREET

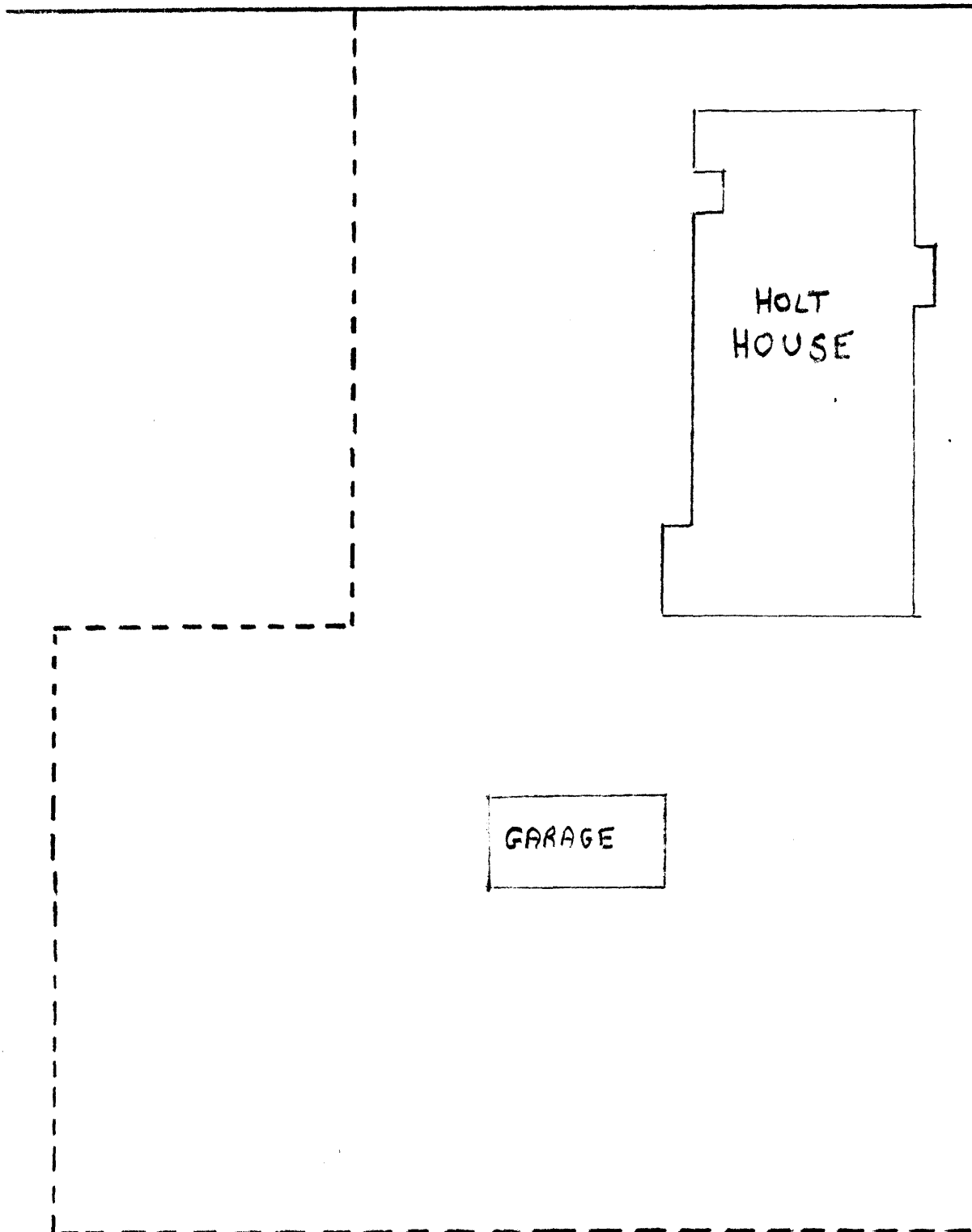

HOLT
HOUSE

GARAGE

AMERICAN STREET