

1 City, Village or Town: <input checked="" type="checkbox"/> Waukesha	County: <input checked="" type="checkbox"/> Waukesha	Surveyor: HNTB	Date: 2/10/82	Riverview Avenue 500
Street Address: 500 Riverview Avenue <input checked="" type="checkbox"/>		Legal Description: Addendum	Acreeage: 77.2	
Current Name & Use: Waukesha County Office Building		Current Owner: Waukesha County		
Film Roll No. WK 43		Current Owner's Address: 515 Moreland Blvd.		
Negative No. 9		Special Features Not Visible In Photographs: (see over)		
Facade Orient. S		Interior visited? <input type="radio"/> Yes <input checked="" type="radio"/> No		

2 Original Name & Use: (preferred) <input checked="" type="checkbox"/> Grand View Health Resort / Moor Mud Baths	Source	A	Previous Owners	Dates	Uses	Source
Dates of Construction / Alteration C. 1911	Source	A				
Architect and/or Builder: Not known	Source					

3 Architectural Significance	4 Historical Significance
<input type="radio"/> Represents work of a master <input type="radio"/> Possesses high artistic values <input type="radio"/> Represents a type, period, or method of construction <input type="radio"/> Is a visual landmark in the area <input checked="" type="radio"/> Other: <u>None</u>	<input type="radio"/> Assoc. with lives of significant persons <input type="radio"/> Assoc. with significant historical events <input type="radio"/> Assoc. with development of a locality <input checked="" type="radio"/> Other: <u>Assoc. w. Commercial Development of Waukesha</u> <input type="radio"/> None

<p>Architectural Statement:</p> <p>This large health resort building consists of an H shaped block with a large wing extending to the rear. The majority of the building is two stories, however, one arm of the H block has been increased to three stories. A one story frame porch consisting of fluted columns supporting a denticulated cornice, joins the end pavilions. A similar cornice appears on the brick building, and contributes to the Classical Revival flavor of the design.</p>	<p>Historical Statement:</p> <p>Period of significance: 1911-1961</p> <p>The Grand View Health Resort or Moor Mud Baths is significant as a rare remaining example of the resorts developed during the Springs Era as well as significant in its own right for its use of mud for theraputic treatment.</p>
--	---

5 Sources of Information (Reference to Above)	6 Representation in Previous Surveys
A Waukesha Daily Freeman, Section K, pg. _____	<input type="radio"/> HABS <input type="radio"/> NAER <input checked="" type="radio"/> WIHP <input type="radio"/> NRHP <input type="radio"/> landmark
B Waukesha Freeman, June 30, 1970	<input type="radio"/> other: _____
C Waukesha Freeman, May 13, 1972	7 Condition
D	<input type="radio"/> excellent <input checked="" type="radio"/> good <input type="radio"/> fair <input type="radio"/> poor <input type="radio"/> ruins
E	8 District: _____
F	<input type="radio"/> pivotal <input type="radio"/> contributing <input type="radio"/> non-contributing
	initials: _____ date: _____
	9 Opinion of National Register Eligibility
	<input checked="" type="radio"/> eligible <input type="radio"/> not eligible <input type="radio"/> unknown
	<input type="radio"/> national <input type="radio"/> state <input checked="" type="radio"/> local initials: <u>DS/CC</u>

Architectural Statement: continued

The building has been converted to county offices and entirely remodeled on the interior. Modifications to the exterior include enclosure of the porch with glass.
~~Historical Statement~~

Its period of significance is from 1911 to 1961, the years in which it operated as a hotel.

Although the resort is a reminder of the Springs Era, its founding in 1911 almost postdates that period. In 1902, real estate agent John Weber came into possession of 200 acres of land on top of the Prospect Avenue Hill. He had the land on the market from that time until 1907 but was unable to sell it for development due to the large area of black mud on the property. In that year a visitor familiar with the mud baths of Europe suggested that use for the land. In February, 1911, Weber opened a thirty-room health resort specializing in the application of mud baths. The hotel prospered and eventually grew to 200 rooms. John Weber invented a couch for giving mud baths which became an industry standard. In 1915 a golf course was added which is still operated by the County as Moor-Downs Golf Course. From 1925 to 1947 over 130,000 people received Weber's mud treatment and Waukesha became known for its unorthodox medical center. Weber sold the hotel in 1946 and after several other owners, the mud baths finally closed in 1961, victim to more sophisticated medical practices. The Moor Mud Baths was the first and largest of several such spas in the City and remained as an example of the health resort industry spawned by the Springs Era. (B, C)

In 1962, the hotel became Mt. St. Paul College and in 1972, a County Office Building.

While part of the college, a three story brick structure was added to the east side of the original hotel. A modern, metal-sided garage and a single-story frame clubhouse are also on the grounds; however, none of these modern buildings contribute to the significance of the nominated property.
Addendum: Legal Description

Sec SE34 T7N R19E & Kimball's Sub Blk Z North West Ad: Bg S1/4
cor N1576.44' SW 1.22' N1022'E 425.65' SE913.78' S1882.1' SW41.82 &
659.3' W10.23' SW 246.08' NW 131.92' SW 119' NW 122.9' SW75' NW100'
SW150'SW150' NW 346.8' E55' bg R 22/663

USGS Quadrangle: Waukesha, WI (7.5) 1:24000
UTM References:

- A. 16/399690/4763440
- B. 16/399690/4764060
- C. 16/399300/4764080
- D. 16/399300/4763320
- E. 16/399370/4763280
- F. 16/399430/4763360
- G. 16/399520/4763260

GRAND VIEW HEALTH RESORT/ MOOR MUD BATH

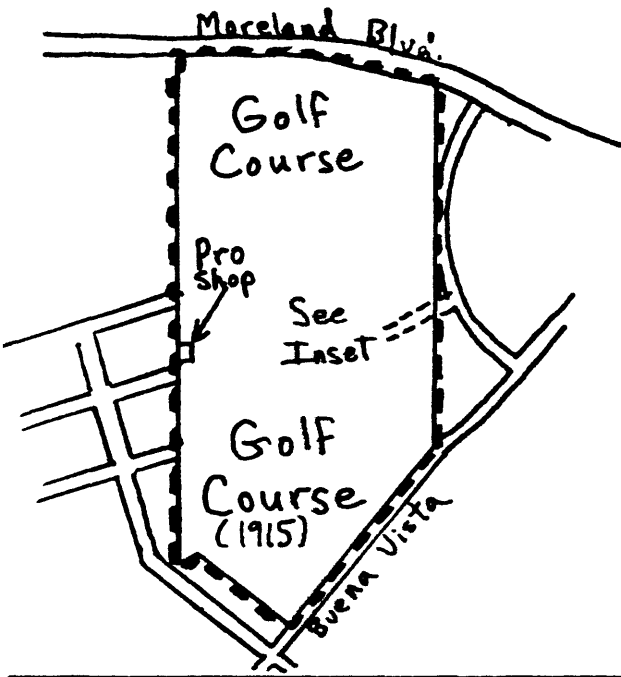

--- Nominated Property



Scale: 1" = 1000'

INSET

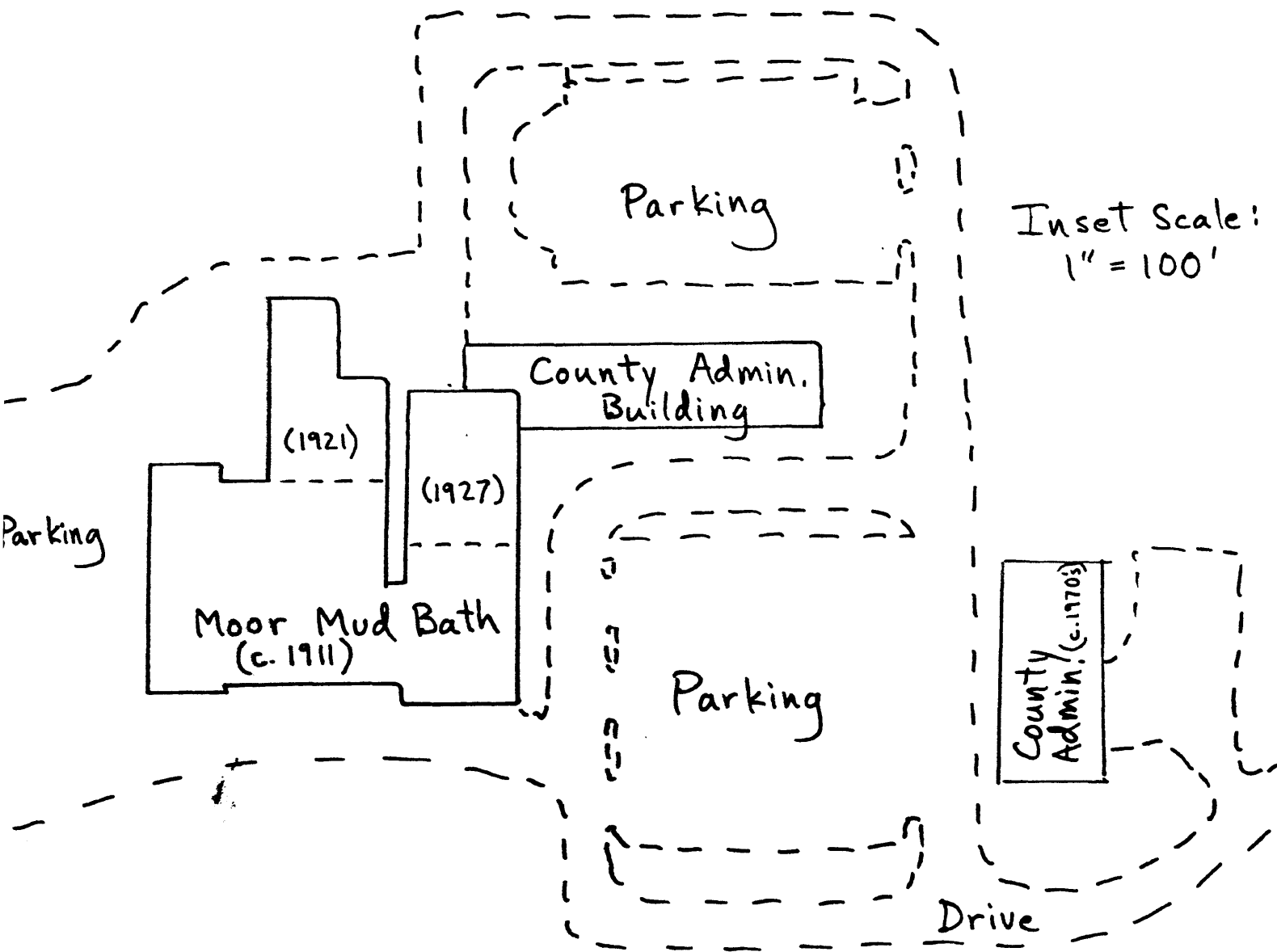

Inset Scale: 1" = 100'