

PH0076 066

Form 10-300
(July 1969)UNITED STATES DEPARTMENT OF THE INTERIOR
NATIONAL PARK SERVICENATIONAL REGISTER OF HISTORIC PLACES
INVENTORY - NOMINATION FORM

(Type all entries - complete applicable sections)

STATE: Arkansas	
COUNTY: Lawrence	
FOR NPS USE ONLY	
ENTRY NUMBER 70-2-03-0004	DATE 2/16/70

1. NAME

COMMON:

Powhatan Courthouse

AND/OR HISTORIC:

2. LOCATION

STREET AND NUMBER:

Location as shown on annexed map

CITY OR TOWN:

Powhatan

STATE

Arkansas

CODE

03

COUNTY:

Lawrence

CODE

075

3. CLASSIFICATION

CATEGORY (Check One)	OWNERSHIP	STATUS	ACCESSIBLE TO THE PUBLIC
<input type="checkbox"/> District <input checked="" type="checkbox"/> Building	<input checked="" type="checkbox"/> Public	<input type="checkbox"/> Occupied	Yes:
<input type="checkbox"/> Site <input type="checkbox"/> Structure	<input type="checkbox"/> Private	<input checked="" type="checkbox"/> Unoccupied	<input type="checkbox"/> Restricted
<input type="checkbox"/> Object	<input type="checkbox"/> Both	<input type="checkbox"/> Preservation work in progress	<input checked="" type="checkbox"/> Unrestricted
			<input type="checkbox"/> No

PRESENT USE (Check One or More as Appropriate)

<input type="checkbox"/> Agricultural	<input checked="" type="checkbox"/> Government	<input type="checkbox"/> Park	<input type="checkbox"/> Transportation	<input type="checkbox"/> Comments
<input type="checkbox"/> Commercial	<input type="checkbox"/> Industrial	<input type="checkbox"/> Private Residence	<input type="checkbox"/> Other (Specify)	
<input type="checkbox"/> Educational	<input type="checkbox"/> Military	<input type="checkbox"/> Religious		
<input type="checkbox"/> Entertainment	<input type="checkbox"/> Museum	<input type="checkbox"/> Scientific		

4. OWNER OF PROPERTY

OWNER'S NAME:

Lawrence County

STREET AND NUMBER:

CITY OR TOWN:

Walnut Ridge

STATE:

Arkansas

CODE

03

5. LOCATION OF LEGAL DESCRIPTION

COURTHOUSE, REGISTRY OF DEEDS, ETC.:

Lawrence County Courthouse

STREET AND NUMBER:

CITY OR TOWN:

Walnut Ridge

STATE:

Arkansas

CODE

03

6. REPRESENTATION IN EXISTING SURVEYS

TITLE OF SURVEY: Some Historic Buildings of Arkansas, A. Edwin Kendrew,
James R. Short, Henry A. Judd, John L. FergusonDATE OF SURVEY: October 1968☐ Federal☒ State☐ County☐ Local

DEPOSITORY FOR SURVEY RECORDS:

Arkansas History Commission

STREET AND NUMBER:

300 West Markham Street

CITY OR TOWN:

Little Rock

STATE:

Arkansas

CODE

03

STATE:

COUNTY:

FOR NPS USE ONLY

DATE

SEE INSTRUCTIONS



70-2-03-0004 2/16/70

7. DESCRIPTION

CONDITION	(Check One)					
	<input type="checkbox"/> Excellent	<input type="checkbox"/> Good	<input checked="" type="checkbox"/> Fair	<input type="checkbox"/> Deteriorated	<input type="checkbox"/> Ruins	<input type="checkbox"/> Unexposed
	(Check One)			(Check One)		
	<input checked="" type="checkbox"/> Altered	<input type="checkbox"/> Unaltered	<input type="checkbox"/> Moved	<input checked="" type="checkbox"/> Original Site		

DESCRIBE THE PRESENT AND ORIGINAL (if known) PHYSICAL APPEARANCE

The site of the courthouse is a commanding one overlooking the Black River. It was apparently designed with great care and with consideration of its aesthetic relationship to the site selected. It was built in the same location as a prior courthouse which had been constructed in 1873 and burned in 1885. The present courthouse has the date 1888 inscribed in the pediment. The building is designed in the Victorian style common to this country in the 1880's.

The foundation is of natural stone, quarried locally, and apparently goes down to solid rock. The building itself is a two-story brick. The brick was manufactured locally and the ruins of the old kiln in which it was fired are still in existence. The brickwork has a fine color and texture and was well done in a common bond. Two-story brick pilasters emphasize the corners and bays of the building, giving it a monumental appearance. The segmental arches of the windows and the fine tower are impressive elements. The roof is of a modified mansard style and is covered with metal shingles. Yellow cypress was used in the roof structure and in the exterior trim.

Alterations were evidently made on the building during WPA days. Modern fireproof and burglarproof vaults were installed in certain sections of the building. The chimneys do not match the original drawings.

It is very doubtful if the building or grounds have altered much from the time they were plotted and constructed. Comparison of a 1936 photo with photos taken in 1969 show virtually no change during that period other than that of minor deterioration.

SEE INSTRUCTIONS

B. SIGNIFICANCE

PERIOD (Check One or More as Appropriate)

- | | | | |
|--|---------------------------------------|--|---------------------------------------|
| <input type="checkbox"/> Pre-Columbian | <input type="checkbox"/> 16th Century | <input type="checkbox"/> 18th Century | <input type="checkbox"/> 20th Century |
| <input type="checkbox"/> 15th Century | <input type="checkbox"/> 17th Century | <input checked="" type="checkbox"/> 19th Century | |

SPECIFIC DATE(S) (If Applicable and Known) Built in 1888

AREAS OF SIGNIFICANCE (Check One or More as Appropriate)

- | | | | |
|--|---------------------------------------|---|--|
| <input type="checkbox"/> Aboriginal | <input type="checkbox"/> Education | <input checked="" type="checkbox"/> Political | <input type="checkbox"/> Urban Planning |
| <input type="checkbox"/> Prehistoric | <input type="checkbox"/> Engineering | <input type="checkbox"/> Religion/Philosophy | <input type="checkbox"/> Other (Specify) |
| <input checked="" type="checkbox"/> Historic | <input type="checkbox"/> Industry | | |
| <input type="checkbox"/> Agriculture | <input type="checkbox"/> Invention | <input type="checkbox"/> Science | |
| <input checked="" type="checkbox"/> Architecture | <input type="checkbox"/> Landscape | <input type="checkbox"/> Sculpture | |
| <input type="checkbox"/> Art | <input type="checkbox"/> Architecture | <input type="checkbox"/> Social/Humanitarian | |
| <input type="checkbox"/> Commerce | <input type="checkbox"/> Literature | <input type="checkbox"/> Theater | |
| <input type="checkbox"/> Communications | <input type="checkbox"/> Military | <input type="checkbox"/> Transportation | |
| <input type="checkbox"/> Conservation | <input type="checkbox"/> Music | | |

STATEMENT OF SIGNIFICANCE

The design and construction of the Powhatan Courthouse reflects the search for styles by the architects of the period. The building displays an Italian influence in the brackets, dormers and modified mansard roof. It combines also, other architectural features which were popular in this country during the Victorian period. The most illustrative examples would be the elaborate decoration of the wood details of the building.

Although the building has suffered considerable wear and tear, and a good many architectural features have been damaged, there is ample evidence of the original fabric to make an authentic restoration possible. The main stairway, which lies to the right on the river side of the building, is intact. The stair newel and handrails are impressive in their substantial construction. Although some balusters are missing, there is a sufficient number available to serve as examples for restoration of the original balustrade. The story heights are extremely great, creating an impressive example of a commodious county structure. The courtroom is unusually large and also has an extremely high ceiling. The courtroom is on the second floor level.

In a report titled "Some Historic Buildings of Arkansas," prepared for Governor Winthrop Rockefeller in October of 1968, by A. Edwin Kendrew, John L. Ferguson, et al, the following Statement was made,

"It would be highly desirable to preserve and eventually restore and exhibit this building as a landmark of the history and development of the area and its former importance as a port town and county seat."

The building is architecturally significant due to the fact that it is one of the few remaining buildings of that period left in that portion of the State. Original design and construction remain virtually intact, and restoration is economically feasible due to the soundness of the basic structure.

SEE INSTRUCTIONS

9. MAJOR BIBLIOGRAPHICAL REFERENCES

American Guide Series. Arkansas, A Guide to the State. New York: Hastings House, 1941.

Hempstead, Fay. Historical Review of Arkansas. Chicago: Lewis Publishing Co., 1911.

McLeod, Walter E. Centennial Memorial History of Lawrence County. Russellville, Arkansas: Russellville Printing Co., 1936.

10. GEOGRAPHICAL DATA

LATITUDE AND LONGITUDE COORDINATES DEFINING A RECTANGLE LOCATING THE PROPERTY			OR	LATITUDE AND LONGITUDE COORDINATES DEFINING THE CENTER POINT OF A PROPERTY OF LESS THAN TEN ACRES		
CORNER	LATITUDE	LONGITUDE		LATITUDE	LONGITUDE	
	Degrees Minutes Seconds	Degrees Minutes Seconds		Degrees	Minutes	Seconds
NW	° ' "	° ' "		36°	04'	54"
NE	° ' "	° ' "		91°	07'	12"
SE	° ' "	° ' "				
SW	° ' "	° ' "				

APPROXIMATE ACREAGE OF NOMINATED PROPERTY: LESS THAN 1 ACRE

LIST ALL STATES AND COUNTIES FOR PROPERTIES OVERLAPPING STATE OR COUNTY BOUNDARIES

STATE:	CODE	COUNTY	CODE
STATE:	CODE	COUNTY:	CODE
STATE:	CODE	COUNTY:	CODE
STATE:	CODE	COUNTY:	CODE

11. FORM PREPARED BY

NAME AND TITLE:	
Jack E. Porter, Administrator, Historic Preservation Program	
ORGANIZATION	DATE
Arkansas Planning Commission	10/20/69
STREET AND NUMBER:	
Game and Fish Building	
CITY OR TOWN:	STATE
Little Rock	Arkansas
	CODE
	03

12. STATE LIAISON OFFICER CERTIFICATION

NATIONAL REGISTER VERIFICATION

As the designated State Liaison Officer for the National Historic Preservation Act of 1966 (Public Law 89-665), I hereby nominate this property for inclusion in the National Register and certify that it has been evaluated according to the criteria and procedures set forth by the National Park Service. The recommended level of significance of this nomination is:

National ☐ State ☐ Local ☒

Name John M. Peterson
John M. Peterson
Title Executive Director
Arkansas Planning Commission
Date 10/27/69

I hereby certify that this property is included in the National Register.

Ernest Allen Connally
Chief, Office of Archeology and Historic Preservation

FEB 16 1970

Date _____

ATTEST:

William J. Montague
Keeper of The National Register

Date FEB 11 1970

SEE INSTRUCTIONS

HB 20 573

CONTROL SHEET
National Register
Inventory-Nomination Forms

LAURENCE CO. 70000122 ARK

Powhatan Courthouse

NPS Number

20 2-03-0704

RECEIPT

SIGN OFF

3/25/70

Date of Receipt 11/17/69
Data Page
Photo(s)
Photo Description(s)
Map(s)
Map Description(s)
Logged
Acknowledged 11/17/69

Yes No Number

☒ ☐ 12 {one for all}
☒ ☐
☒ ☐ 2
☒ ☐
☒ ☐
☒ ☐

Acresage in way

Photos could present problem

OK

REVIEW

Historian Comments

OK

Architect Comments

OK

B.L. 1/19/70

Chambers 11/19/69

If checked
ret. to
Herk

☐ / Chief Architect ☐ / Chief Archeologist ☐ / Chief Historian

Keeper Comments

OK

Kentley 2/11/70

ENTRY

Chief, OAHF Comments

OK

OK 2-16-70

Date of Entry

Registry Clerk Yes No Date
Assign NPS No. ☐ ☐
Acknowledgement Sent ☐ ☐

4096

EDITORIAL PROCESSING

Editor

Federal Register Entry

Annual Edition Entry

Date

4/7/70

OK

FILE

FILE

FILE

WORKING NO.

11.17.69.6



NATIONAL REGISTER OF HISTORIC PLACES
PROPERTY PHOTOGRAPH FORM

(Type all entries - attach to or enclose with photograph)

STATE Arkansas	
COUNTY Lawrence	
FOR NPS USE ONLY	
ENTRY NUMBER 70-2-03-0004	DATE 2/16/70

SEE INSTRUCTIONS

1. NAME			
COMMON: Powhatan Courthouse			
AND/OR HISTORIC:			
2. LOCATION			
STREET AND NUMBER: Location as shown on annexed map			
CITY OR TOWN: Powhatan			
STATE: Arkansas	CODE 05	COUNTY: Lawrence	CODE 075
3. PHOTO REFERENCE			
PHOTO CREDIT: Mr. Harvey Little			
DATE OF PHOTO: Oct., 8, 1970			
NEGATIVE FILED AT:			
4. IDENTIFICATION			
DESCRIBE VIEW, DIRECTION, ETC. Photo taken from West			

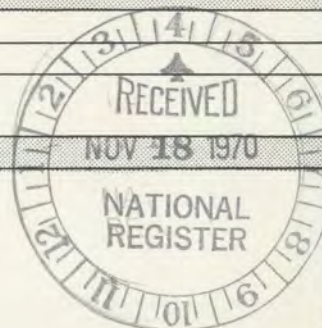



UNITED STATES DEPARTMENT OF THE INTERIOR
NATIONAL PARK SERVICE

NATIONAL REGISTER OF HISTORIC PLACES
PROPERTY PHOTOGRAPH FORM

(Type all entries - attach to or enclose with photograph)

STATE Arkansas	
COUNTY Lawrence	
FOR NPS USE ONLY	
ENTRY NUMBER 70-2-13-0004	DATE 2/16/70

SEE INSTRUCTIONS

1. NAME			
COMMON: Powhatan Courthouse			
AND/OR HISTORIC:			
2. LOCATION			
STREET AND NUMBER: Location as shown on annexed map			
CITY OR TOWN: Powhatan			
STATE: Arkansas	CODE 05	COUNTY: Lawrence	CODE 075
3. PHOTO REFERENCE			
PHOTO CREDIT: Mr. Harry Little			
DATE OF PHOTO: Oct. 8, 1970			
NEGATIVE FILED AT: Arkansas History Commission			
4. IDENTIFICATION			
DESCRIBE VIEW, DIRECTION, ETC. Photo taken from Northwest			





NATIONAL REGISTER OF HISTORIC PLACES

PROPERTY PHOTOGRAPH FORM

(Type all entries - attach to or enclose with photograph)

STATE Arkansas	
COUNTY Lawrence	
FOR NPS USE ONLY	
ENTRY NUMBER 70-2-03-0004	DATE 2/16/70

SEE INSTRUCTIONS

1. NAME			
COMMON: Powhatan Courthouse			
AND/OR HISTORIC:			
2. LOCATION			
STREET AND NUMBER:			
Location as shown on annexed map			
CITY OR TOWN:			
Powhatan			
STATE:	CODE	COUNTY:	CODE
Arkansas	05	Lawrence	075
3. PHOTO REFERENCE			
PHOTO CREDIT: Mr. Harvey Little			
DATE OF PHOTO: Oct. 8, 1969			
NEGATIVE FILED AT:			
ARKANSAS HISTORY COMMISSION			
4. IDENTIFICATION			
DESCRIBE VIEW, DIRECTION, ETC.			
Photo taken from northeast			



NATIONAL REGISTER OF HISTORIC PLACES

PROPERTY MAP FORM

(Type all entries - attach to or enclose with map)

STATE Arkansas	
COUNTY Lawrence	
FOR NPS USE ONLY	
ENTRY NUMBER 70-2-03-000	DATE 2/16/70

SEE INSTRUCTIONS

1. NAME			
COMMON: Powhatan Courthouse			
AND/OR HISTORIC:			
2. LOCATION			
STREET AND NUMBER:			
Location as shown on annexed map			
CITY OR TOWN:			
Powhatan			
STATE:	CODE	COUNTY:	CODE
Arkansas	03	Lawrence	075
3. MAP REFERENCE			
SOURCE:			
Arkansas State Highway Commission, Lawrence County A 200-38			
SCALE: 1:125,000			
DATE: 1959			
4. REQUIREMENTS			
TO BE INCLUDED ON ALL MAPS			
1. Property boundaries where required.			
2. North arrow.			
3. Latitude and longitude reference.			

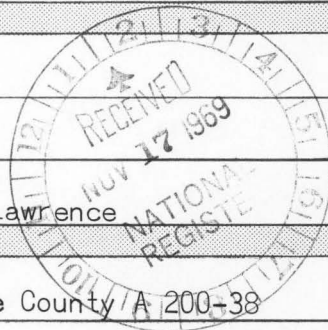

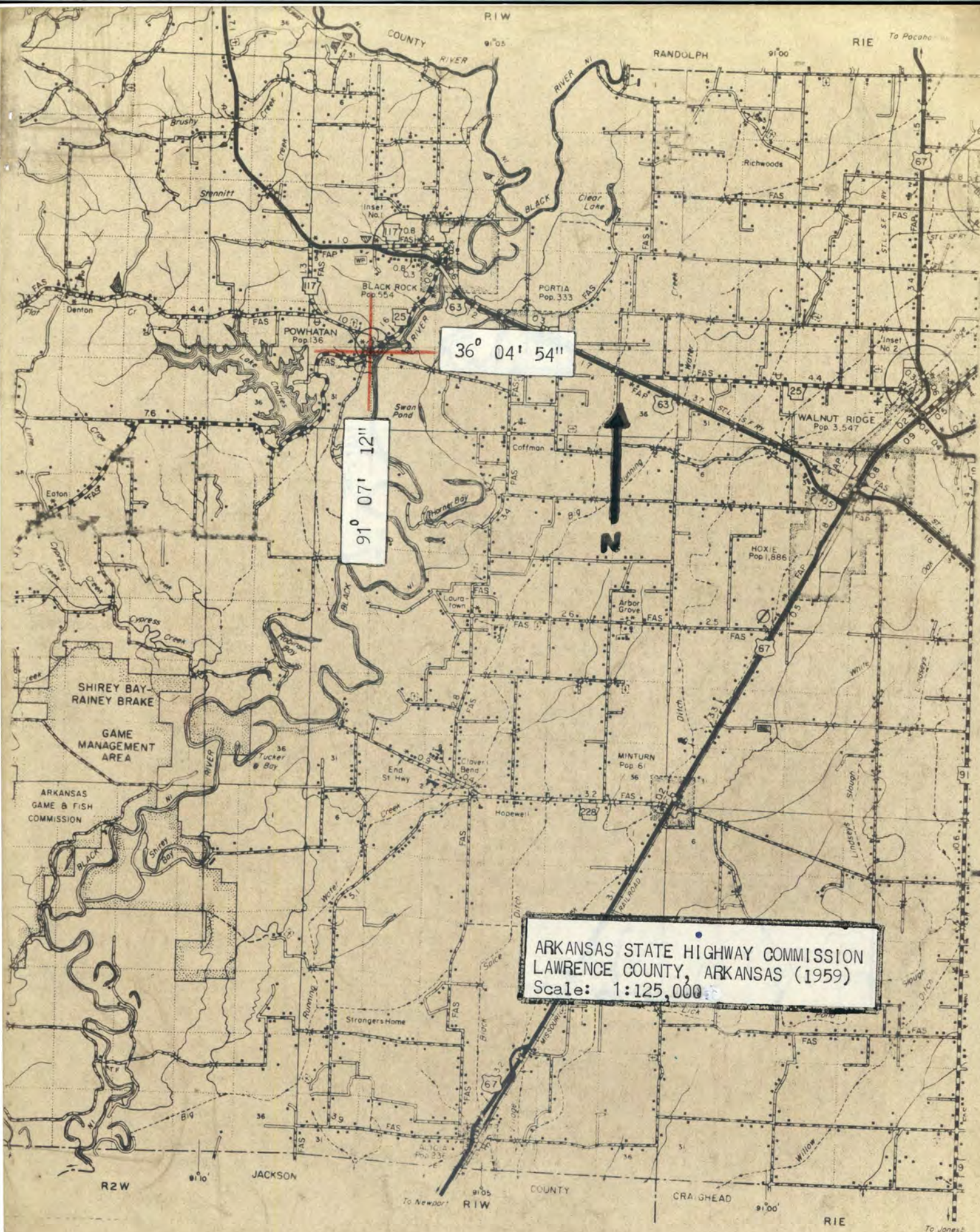

UNITED STATES DEPARTMENT OF THE INTERIOR
NATIONAL PARK SERVICE

NATIONAL REGISTER OF HISTORIC PLACES

PROPERTY MAP FORM

(Type all entries - attach to or enclose with map)

STATE

Arkansas

COUNTY

Lawrence

FOR NPS USE ONLY

ENTRY NUMBER

DATE

70-2-03-000

2/16/70

1. NAME

COMMON: Powhatan Courthouse

AND/OR HISTORIC:

2. LOCATION

STREET AND NUMBER:

Location as shown on annexed map

CITY OR TOWN:

Powhatan

STATE:

Arkansas

CODE

03

COUNTY:

Lawrence

CODE

075

3. MAP REFERENCE

SOURCE:

Arkansas State Highway Commission, Lawrence County A 200-38 (inset)

SCALE: 1:24,000

DATE: 1959

4. REQUIREMENTS

TO BE INCLUDED ON ALL MAPS

1. Property boundaries where required.
2. North arrow.
3. Latitude and longitude reference.

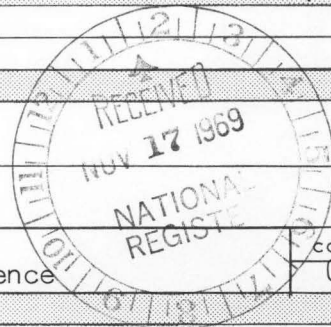

SEE INSTRUCTIONS

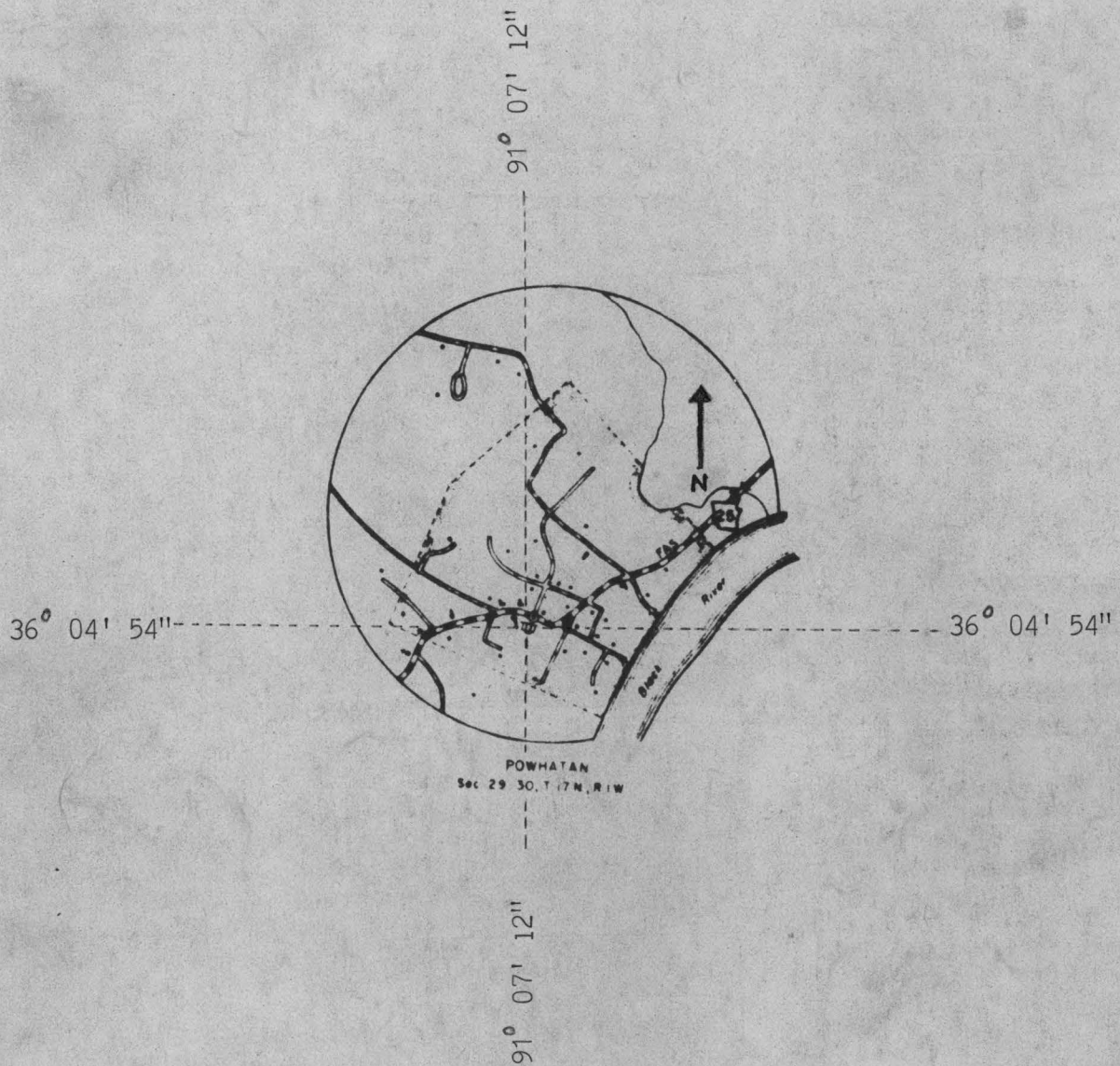

ARKANSAS STATE HIGHWAY COMMISSION
LAWRENCE COUNTY, ARKANSAS (1959)
Scale: 1:24,000 (inset)

Missing Core Documentation

Property Name

Powhatan Courthouse

County, State

Lawrence,
Arkansas

Reference Number

70000122

The following Core Documentation is missing from this entry:

☐ Nomination Form

☐ Photographs

☒ USGS Map

H34-HR

Lawrence Co, Ark.
FEB 16 1970

BASIC FILE RETAINED IN HR

2/13/70

RGamble:mm

LL-Mr. Melvin
T-Mr. Butterfield
HR

Hon. John L. McClellan
United States Senate
Washington, D. C.

Dear Senator McClellan:

We are pleased to inform you that the Powhatan Courthouse in Powhatan, Arkansas, has been nominated by the officer appointed by the Governor for the implementation of the National Historic Preservation Program in Arkansas and has been entered into the "National Register of Historic Places." Senator J. W. Fulbright and Representative William Vollie (Bill) Alexander, Jr., have also been provided with this information. A leaflet explaining the National Register is enclosed.

Sincerely yours,

/S/ Ernest Allen Connally

Ernest Allen Connally
Chief, Office of Archeology
and Historic Preservation

FEB 16 1970

Enclosure

Entered in the National Register

cc:

Dr. John M. Peterson, Executive Director, Arkansas Planning Commission,
Little Rock, Arkansas 72201

Duplicate letters sent to:
Hon. J. W. Fulbright

Hon. William Vollie (Bill)
Alexander, Jr.

J. W. FULBRIGHT
ARKANSAS

COMMITTEES:
FOREIGN RELATIONS (CHAIRMAN)
FINANCE
JOINT ECONOMIC
DEMOCRATIC POLICY

United States Senate

WASHINGTON, D.C. 20510

January 20, 1971

LEE WILLIAMS
ADMINISTRATIVE ASSISTANT

DAVID P. LAMBERT
LEGISLATIVE ASSISTANT

PARKER WESTBROOK
SPECIAL ASSISTANT

F.W.

The Honorable
Rogers C. B. Morton
Secretary-Designate of the Interior
Washington, D. C.

Dear Mr. Secretary:

I have been contacted by a group of my constituents who are interested in restoration and preservation of the old Courthouse building in Powhatan, Arkansas.

It is my understanding that local people hope to find federal funds to match the money they raise, estimated at about \$50,000.

I would appreciate any information you might have about funds which might be available for this project. There is considerable interest in Arkansas and I believe some of those working on this project may have previously contacted your Department about their plans.

The courthouse is one of the more interesting and significant historical sites in the area, and I understand that it has been designated as a national historic site. I feel that this is a worthwhile undertaking, and I am hopeful that some assistance can be found for this project.

With best wishes, I am

Sincerely yours,

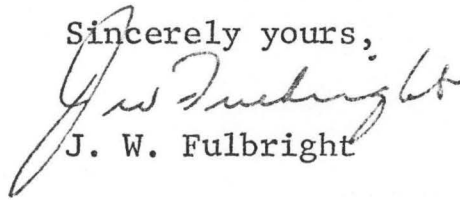
J. W. Fulbright

JWF:pt

CL-13570

CONGRESSIONAL INQUIRY *

TO: H - Mrs. Henley

DATE: January 25, 1971

FROM: Chief, Office of Congressional Services (LL)

SUBJECT: Pres., SE

CONTROL NUMBER: CL 13570

SUSPENSE DATE: February 1, 1971

The attached Congressional correspondence is forwarded for the preparation of a draft reply. In the event the above suspense date cannot be met, please furnish me an interim draft reply on or before that suspense date, and include reasons for the delay and an estimate as to the date a final reply may be expected.

All draft replies must be surnamed by the Chief of the Division preparing the draft. It will be optional with that Division Chief as to whether his Assistant Director should also surname the draft.

For NPS signature _____ XX
For Secretarial signature _____

Frank S. Melvin

PLEASE LEAVE THIS MEMO ATTACHED TO THE CORRESPONDENCE

JAN 26 1971

Hon. J. W. Fulbright
United States Senate
Washington, D.C.

Dear Senator Fulbright:

We are pleased to acknowledge your inquiry in behalf of a group of your constituents concerning the old Courthouse building in Powhatan, Arkansas.

We appreciate your interest in this matter and will provide you a reply at our earliest opportunity.

Sincerely yours,

GEORGE B. HARTMAN, JR.

Director

FNP:FSMelvin:maj:1/26/71

CL-13570

H34-HR

FEB 22 1971

Hon. J. W. Fulbright
United States Senate
Washington, D.C.

Dear Senator Fulbright:

Thank you for your recent inquiry concerning the Courthouse in
Ponchatoula, Arkansas.

The State of Arkansas has submitted an application for \$54,050 in
Federal matching funds for the restoration of the Ponchatoula Courthouse.
The application is under review; if any clarification is needed, we
will consult Arkansas's State Liaison Officer, who is Dr. George M.
Reynolds, Chairman, State Review Committee, Arkansas History Commission,
Old State House, Little Rock, Arkansas 72201.

States submitting adequate State historic preservation plans are
eligible to participate in the apportionment of funds for acquisition
and development projects, which will be announced by the Secretary
of the Interior in the near future. Arkansas has submitted a plan,
which has been approved. Also, the courthouse has been entered in
the National Register of Historic Places, which is a further require-
ment for eligibility for financial assistance.

Arkansas is a leading State in the National Historic Preservation
Program, and we value the cooperation of Dr. Reynolds. Your interest
in the National Park Service is greatly appreciated.

Sincerely yours,

(Sgd) Marthon L. Bill
Acting Director

cc:

Dr. George M. Reynolds, Chairman, State Review Committee, Arkansas
History Commission, Old State House, Little Rock, Arkansas 72201)/w/c of inc/

CL)
Director, Southeast Region)

LL - Mr. Melvin)

T)
HR)

FNP:SBradford:EACConnally:ljp:2-11-71

J. V. FULBRIGHT
ARKANSAS

COMMITTEES:
FOREIGN RELATIONS (CHAIRMAN)
FINANCE
JOINT ECONOMIC
DEMOCRATIC POLICY

United States Senate

WASHINGTON, D.C. 20510

LEE WILLIAMS
ADMINISTRATIVE ASSISTANT

DAVID P. LAMBERT
LEGISLATIVE ASSISTANT

PARKER WESTBROOK
SPECIAL ASSISTANT

February 24, 1971

Mr. Hardy Little III
Little & Maddox, Architects
Jonesboro, Arkansas

Dear Hardy:

Senator Fulbright has now received a further reply from the National Park Service concerning his inquiry about restoration of the Courthouse at Powhatan. I enclose a copy of the letter from the Park Service and hope this will be helpful to you.

With best wishes, I am

Sincerely yours,



Hoyt Purvis

HP:at



February 25, 1971

Mr. Hardy Little III
Little and Maddox
519 West Washington
Jonesboro, Arkansas 72401

RE: Powhatan Courthouse Restoration

Dear Mr. Little:

Please allow me to introduce myself, my name is Bill Hibbard and I am an architect, Arkansas registration. I am presently with the Historic Preservation Program.

As you know, a Grant application was made in October, 1970 for the Courthouse restoration but funds were not available at that time. We plan to re-submit the Grant Request in April provided that the project status is essentially the same. Could you fill me in on the local situation? Is the State Parks Department still planning to take over the property after restoration?

I would like very much to visit the site with you in the near future. Could we arrange this some time after Tuesday of next week?

I am looking forward to meeting and working with you in your preservation effort.

Sincerely,

Bill Hibbard

William H. Hibbard
Historic Preservation Program

WHH/ hp

LITTLE & MADDOX ARCHITECTS

519 W. WASHINGTON, SUITE 5
JONESBORO, ARKANSAS 72401
TELEPHONE 501-935-3813



February 26, 1971

Arkansas Historic Preservation Program
1023 West Third Street
Little Rock, Arkansas 72201

Attn: Mr. William H. Hibbard

Re: Powhatan Courthouse Restoration

Dear Bill:

Please find enclosed a letter from Senator Fulbright's office concerning the restoration project. We requested the inquiry earlier. The project status is the same as it was at the time of the previous submission. The local people are still working on the project even though activity has not been at as high a level as before. They have something over \$30,000.00 in their account now and have purchased the land surrounding the building.

The Parks Department still plans to take over the property upon completion. For information on this please contact Buddy Searles. They are including this project in the overall parks planning program.

We have an application prepared for the HUD preservation program. Mr. Searles has recommended we submit this in addition to the Department of Interior application. It would be very helpful if you would check this out for us with the HUD people in Little Rock.

Tentatively, set up Friday March 5 for the site visit. We will check it out on our end. Please contact us concerning this date, where to meet, etc.

We are looking forward to meeting and working with you on this project.

Yours very truly,

Little & Maddox, Architects, Inc.

Hardy Little III

HLIII/pap

cc: Jim Snapp



March 3, 1971

Mr. Hardy Little III
Little and Maddox
519 West Washington Street
Jonesboro, Arkansas 72401

Dear Mr. Little:

I would like to call your attention to the attached newspaper article which appeared in the Arkansas Gazette on January 10, 1971. Lieutenant Governor Bob Riley offers to serve as a rallying point for groups and individuals attempting to preserve Arkansas' Historic Heritage. Lieutenant Governor Riley also states that he wants to,

"Lend the office (Lieutenant Governor's) and whatever prestige is involved in it, and the time I have to serve in it, to being of service in this way."

This is not merely rhetoric. Lieutenant Governor Riley's record as a member of the Arkansas General Assembly shows numerous instances where he has been both sponsor and supporter of measures designed to preserve and promote Arkansas History. In 1947, as a young member of the House of Representatives, he introduced and secured the passage of the legislation which saved the Old State House at Little Rock, and the Confederate Capitol at Washington, Arkansas from deterioration. The same Act created the Arkansas Commemorative Commission, a State Agency specifically charged with preserving our Arkansas Heritage for "present and succeeding generations."

Lieutenant Governor Riley has recently reaffirmed his newspaper statement of January 10, and stands ready to support efforts to preserve and promote Arkansas History. His interest and involvement may well be the most significant step toward preserving Arkansas Heritage in almost a quarter of a century.

Due to federal interest and financial assistance toward preserving state and local history, both the machinery

Mr. Hardy Little III

-2-

March 3, 1971

and funding potential exists for implementing such a program. The State of Arkansas has also come to realize that the preservation and promotion of our historical resources can contribute to the State's economy in much the same manner as conservation of our natural resources.

Your organization has been working toward achieving the same objectives in which Lieutenant Governor Riley has shown an interest. Would it be possible for your organization, and individual members, to write to the Lieutenant Governor and let him know of your interest and support? Your State Senators and Representatives should also be made aware of your wishes in this matter.

Sincerely,

A handwritten signature in dark ink, appearing to read "Jack E. Porter". The signature is fluid and cursive, with the first letters of the first and last names being capitalized and prominent.

Jack E. Porter, Administrator
Historic Preservation Program

JEP:bp
Enclosure

Riley Wants to Make State (and Tourists With Dollars) Aware of the Historical Assets of Arkansas

By BILL LEWIS
Of the Gazette Staff

As a child, Lieutenant Governor-elect Bob Riley, whose great-great-grandfather is buried somewhere in Ashley County, played games on the lawn of what then was known as the War Memorial Building, now the Old State House.

"I saw it in such a state of deterioration that I thought, 'If I ever have a chance to do anything about it, I'd do it.'"

Riley had his chance in 1947, when he returned from World War II with some sympathy-generating wounds, got himself elected to the House of Representatives at the tender age of 21, and introduced a bill for a major appropriation to save the crumbling old building.

Riley has survived another generation and achieved a higher office, and he thinks it is time now to turn the attention of the state's people toward other historical, natural and other interest-generating assets of the state as he, with some prestigious help from other interested Arkansians, did for the Old State House a quarter-century ago.

What Riley seeks to do is to create an attitude. "The thing I have been trying to suggest for a good many years is that we develop an attitude of trying to 'sell' our attractions that are very unique and very different. People who are out touring and who have vague objectives would be encouraged with very little effort to come to see a certain thing."

There are, Riley said, "a great many historical sites in Arkansas that lack only attention to be brought to public notice to give them the kind of place, and make them the kind of attraction, that they should be."

For example, there is an obscure spot in Phillips County little known even to residents of the area or to anyone else except those with a keen interest in such things.

"When the Louisiana Purchase was made," Riley said, "they sent two surveying parties. One went in at the mouth of the St. Francis River and probably went due west; and one started at the mouth of the Arkansas River and went due north. Where they met, they put down a marker — and every piece of land in the Louisiana Purchase is measured from that point."

"The interesting thing about this is that it has gone almost unnoticed. A number of individuals through the years have tried to bring it to the attention of the public without any success."

The spot is on private land and the state Highway Department has been unsuccessful in gaining access for a road to it. A crude marker still marks the spot, so the attraction of it would be more intellectual than physical — but that is precisely what Riley seeks to promote, "that we develop an attitude of trying to 'sell' our attractions."

Ouachita Mountains Have Selling Point

"We could sell the Ouachita Mountains on the fact that they are the only range in the hemisphere that runs east and west; all the other ranges run north and south. There is bound to be some curious factor we could create about that and make a big issue about it. And of course they are very beautiful and very primitive; these are additional things. But this unique quality is enough to attract people from St. Louis and a number of other places..."

Crowley's Ridge is a unique geological wonder that is little known as such. It is unique, Riley said, in that it was deposited wholly by the wind. Its alluvial soil has properties almost identical to those of North China, and one can dig down into it as far as one wishes without finding a stone. He suspects that, eons ago, in some major cataclysm, the earth's winds brought part of North China and deposited it in a ridge in Northeast Arkansas — a merchandiseable oddity.

And there is Mammoth Spring, a vast outpouring of water that is the entire source for the Spring River, yet, said Riley, "almost nothing has been done to try to bring attention to it. There are probably hundreds of things like that around that we, in our casual way, have taken for granted and are not very impressed with."

Says State Behind In Tourist Dollar

"To have them inventoried and catalogued would create quite a tourist attraction and would be a tremendous impetus for us economically. And the last time I looked, we were about \$15 million below the lowest tourist dollar rate in the surrounding states."

Riley is pleased that Blanchard Springs, a cavern larger than Carlsbad and still "alive" in contrast to its "dead" New Mexico counterpart, is now being developed by the National Park Service, albeit a hundred years too late, and that Texans seeking trees have discovered such spots as Daisy State Park, the "most camped-in" park in the region.

But he thinks the state eventually is going to have to play a role in such privately owned attractions as the diamond mine near Murfreesboro. "This is a tremendous potential thing," he said, "but it is still on private land and it's got to be somehow adjusted because people come a long distance to see it and can't even get to it."

Other potential attractions are the natural dam south of Prairie Grove, an upthrust of earth that dammed a creek where people now swim in the summertime; the geological curiosities created by the New Madrid Earthquake in the early 1800s; James Black's blacksmithy at Washington, where the Bowie knife was invented; the community of Fulton, laid out by Stephen Austin; a house at Arkadelphia that served as headquarters for both federal and Confederate troops during the War Between the States, and from which the War's longest raid, led by Gen. Sterling Price, originated.

"And one of the things in that area that has been completely allowed to deteriorate," Riley said, "was the salt works established by the Confederacy, about eight or nine miles northwest of Arkadelphia. The old salt pans are still there, and you can still see the apparatus used to make salt. They used the water from an old salt well that was part of an old animal rack. Mud Creek that runs through Arkadelphia is saline, and it comes from that source."

Little Rock's architectural diversity is "fantastic," Riley said, and deserving of preservation. "Little Rock is most curious," he said. "It was really a collecting point for all this civilization that was moving in this direction. They came down the Ohio and Mississippi Rivers, and brought along all of the architectural types they had known before, so you've got one of every kind there is."

Mount Olive Church Special to Riley

Another gem worthy of preservation, Riley said, is the Mount Olive Church near Hamburg, his own family's church. In its cemetery are buried his grandfather and great-grandfather, and the great-great-grandfather is buried nearby. The church itself is well over a century old, and it is "one of those perfect examples of that crossroads church. We've kept the cemetery up and the original furniture is still in there. The church could be marked and people could come from all over the country to see a church like that—a perfect relic of that type of civilization at that particular time before the Civil War. We take these things so much for granted."

Riley thinks a legislative resolution might be proposed that would create a series of regional conferences where persons interested in historical preservation could begin to identify areas of

interest, plan for their development and perhaps eventual inclusion in an agency such as the Arkansas Commemorative Commission, which manages the Old

State House and the old Capitol at Washington. Several legislators of counties where these areas exist have expressed an interest, and Riley said that as

Lieutenant governor he would be pleased to serve as a rallying point for such an effort.

"I certainly want to lend the office and whatever prestige is

involved in it, and the time I have to serve in it, to being of service in this way," Riley said, "because there are many things a Lieutenant governor may do

that are not prescribed by law, and as a teacher and a leading Arkansawyer of present stock, I am very much interested in this."

LITTLE & MADDOX ARCHITECTS

519 W WASHINGTON, SUITE 5
JONESBORO, ARKANSAS 72401
TELEPHONE 501-935-3813



March 5, 1971

The Hon. Bob Riley
Lieutenant Governor of Arkansas
Little Rock, Arkansas

Sir:

We would like to acknowledge your endorsement for preservation of points of historical interest within the state. We also appreciate your own involvement in generating interest in implementation of programs for restoration.

At the present time, our office is concerned with successful restoration of Powhatan Court House at Powhatan, Arkansas. Application has been submitted to the US Department of the Interior for matching funds for the building's restoration. A HUD application for Grant for Historic Preservation has been prepared but not yet submitted. In addition, the people of Powhatan have raised over \$30,000 in order to see the completion of this project.

This project has been assigned first priority for restoration by the State Review Committee. The State Parks, Recreation and Travel Commission voted to include the Courthouse in our park system upon completion of the restoration.

Several gentlemen in the state have shown a genuine interest in the preservation of Powhatan Court House and may be contacted along with us for further details on the project. They are: Mr. Jack Porter, Administrator, Historic Preservation Program; Mr. Jim Snapp, Chairman, Lawrence County Development Council and member of the AIDC; Mr. L. E. Surles, Director of Parks & Recreation; and Mr. William D. Hibbard, Historic Preservation Program.

Enclosed you will find a copy of a letter written to Mr. Surles concerning the condition of the building and its architectural significance. Also enclosed is a copy of a letter to Senator Fulbright from the acting director of the National Park Service, Department of the Interior, concerning the status of the application for federal matching funds.

March 5, 1971

Those of us who are interested in this project would greatly appreciate any support and assistance you might be able to offer that would enable the Courthouse at Powhatan to be restored.

Sincerely,

Little & Maddox Architects, Inc.

A handwritten signature in dark ink, appearing to read "Hardy Little III". The signature is fluid and cursive, with the last name "Little" being more prominent.

Hardy Little III A.I.A.

HLIII/pan

Enc.

ARKANSAS HISTORIC PRESERVATION PROGRAM

1023 WEST THIRD STREET

LITTLE ROCK, ARKANSAS 72201

501 374-0375



March 8, 1971

Mr. Jim Snap
Snap Ford Company
Walnut Ridge, Arkansas 72476

Dear Mr. Snap:

I want to thank you for taking your time to show me through the Powhatan Courthouse Friday. It is a magnificent structure, well deserving the interest, time and money that the people of Lawrence County have devoted to it.

I enjoyed meeting you and am looking forward to working with you in the future.

Best regards,

Bill Hibbard

Wm. H. Hibbard
Historic Preservation Program

WHH:bp

Snapp MOTOR COMPANY, INC.

113-117 EAST MAIN ST. • PHONE 886 - 2414

WALNUT RIDGE, ARKANSAS 72476

-RUSSELL SNAPP
-JIMMY SNAPP
-C. R. SNAPP
-CHARLES SNAPP

March 9, 1971 RECEIVED

MAR 11 1971

BILL ALEXANDER, M.C.

Congressman Bill Alexander
1110 House Building
Washington, D. C. 20515

Dear Congressman:

Enclosed you will find copies of recent correspondence on the Powhatan Courthouse Restoration. You will notice on the letter of February 25, 1970 from the Arkansas Historic Preservation Program to Mr. Hardy Little that plans are to resubmit the grant request next month. In talking to Mr. Hibbard it seems that he has received some unofficial word that funds might be available next month and that the Powhatan Courthouse is in line to receive some of these funds. Would you please let me know what information you can gather from the Department of Interior on this project and may I suggest that you express an interest in this project to Lt. Governor Wiley.

Thanking you in advance for your assistance,

Sincerely,

Jimmy Snapp

Jimmy Snapp

YOUR



DEALER

ARK

Congress of the United States
House of Representatives
Washington, D.C. 20515

March 18th, 1971

The Honorable Rogers C. Morton
Secretary
Department of the Interior
Washington, D. C.

Re: Powhatan Courthouse
Lawrence County
Walnut Ridge, Arkansas

Dear Rogers:

For some time I have joined with the efforts of my constituents in an attempt to preserve the Powhatan Courthouse, which has important meaning to the citizens of Arkansas and historical value to the people of this great Nation.

✓ To this date I have been unable to discover the exact position of your Department with reference to our efforts. Would you please ask one of your colleagues in the Department to provide me with the current status of our application?

With kindest regards and best wishes for a successful administration, I am

Sincerely yours,



Bill Alexander
Congressman from Arkansas
(1st District)

BA/pa
Enclosures

CL-15862

F.W.
MAR 22 11 10 AM '71
CONGRESSIONAL LIBRARY

Draft
S. Bradford:dyw

March 30, 1971

H34-HR

Hon. William V. Alexander
House of Representatives
Washington, D. C.

Dear Mr. Alexander:

We are pleased to acknowledge your inquiry on behalf of several constituents concerning the Powhatan Courthouse, Lawrance County, Walnut, Ridge, Arkansas.

Arkansas submitted eight project applications totaling \$247,958.00 in October 1970. An application for the Powhatan Courthouse was included, requesting a matching grant of \$54,050.00. The State subsequently rated each project in accordance with the grants program priority schedule (copy enclosed) using the four criteria under the third priority. Three projects received higher ratings than the Powhatan Courthouse, which was rated 3-d with three other projects. One project was eliminated from the State's fiscal year 1971 development program.

The Secretary's apportionment of \$2,185,631.75 to 40 States for the acquisition and development of historic properties on March 11, 1971 allocated \$47,458.72 to Arkansas. The State's apportionment is sufficient to fund the three top rated projects only, excepting funding for another

CL 15862

TO EAC
Apr 1

project from a small sum left over from the allocation. Arkansas has not determined how that money will be used.

Since the Powhatan Courthouse will not be funded in the fiscal year under the grants-in-aid program its sponsors could consult Arkansas' State Liaison Officer, Dr. George M. Reynolds, Chairman, State Review Committee, Arkansas History Commission, Old State House, Little Rock, Arkansas 72201, about including the courthouse in the State's annual work program for fiscal year 1972. The work program is due May 1.

Your interest in the National Park Service and its programs is most deeply appreciated. With warmest personal regards and every good wish,

Sincerely yours,

Director

Enclosure

cc:

Dr. George M. Reynolds, Chariman, State Review Committee, Arkansas
History Commission, Old State House, Little Rock, Arkansas 72201 w/cy inc.
Director, Southeast Region w/cy inc.
LL-Mr. Melvin w/cy inc.
T-w/cy inc.
HR-w/cy inc.

BASIC FILE RETAINED IN HR

HR CONGRESSIONAL INQUIRY *

TO: *H*-Mrs. Henley

DATE: 3/24/71

FROM: Chief, Office of Congressional Services (LL)

SUBJECT: Preservation - SE

CONTROL NUMBER: CL 15862

SUSPENSE DATE: 4/1

The attached Congressional correspondence is forwarded for the preparation of a draft reply. In the event the above suspense date cannot be met, please furnish me an interim draft reply on or before that suspense date, and include reasons for the delay and an estimate as to the date a final reply may be expected.

All draft replies must be surnamed by the Chief of the Division preparing the draft. It will be optional with that Division Chief as to whether his Assistant Director should also surname the draft.

For NPS signature XX
For Secretarial signature _____

Frank S. Melvin
Frank S. Melvin

PLEASE LEAVE THIS MEMO ATTACHED TO THE CORRESPONDENCE

Hon. William V. Alexander
House of Representatives
Washington, D.C.

Dear Mr. Alexander:

We are pleased to acknowledge your inquiry on behalf of several constituents concerning the Powhatan Courthouse, Lawrence County, Walnut Ridge, Arkansas.

We appreciate your interest in this matter and will provide you a reply at our earliest opportunity.

Sincerely yours,

Director

FNP:AJones:ljp:3-24-71

CL-15862

Draft
S. Bradford:dyw:March 30, 1971

Rewritten:S. Bradford:EAC:dyw
April 8, 1971

H34-HR

Hon. William V. Alexander
House of Representatives
Washington, D. C.

Dear Mr. Alexander:

We are pleased to acknowledge your inquiry in behalf of several constituents concerning the Powhatan Courthouse, Lawrence County, Walnut Ridge, Arkansas.

Arkansas submitted eight project applications totaling \$257,958 in Federal matching funds in October 1970. Included was an application for the restoration of the Powhatan Courthouse, requesting a matching grant of \$54,050. The total project acquisition and development request from the States is \$17 million. Fiscal year 1971's appropriation for the grants-in-aid program is \$5,980,000, of which \$2,185,631.75 has been apportioned to 41 States for survey and planning, \$1,042,023 to the National Trust for Historic Preservation and \$2,323,762.22 to 40 States for acquisition and development projects. Regrettably, there is not enough money to fund all of Arkansas' valuable requests, the State selecting the projects to be funded in accordance with the attached grants program priority schedule.

To EAC
2nd time
4-12-71

CL15862

The Powhatan Courthouse, according to the project ratings submitted by Arkanasa, will not be funded in fiscal year 1971.

Since the Powhatan Courthouse will be not funded in this fiscal year under the grants-in-aid program, its sponsors could consult Arkansas' State Liaison Officer, Dr. George M. Reynolds, Chairman, State Review Committee, Arkansas History Commission, Old State House, Little Rock, Arkansas 72201, about including the courthouse in the State's annual work program for fiscal year 1972. The work program is due May 1.

Your interest in the National Park Service and its program is most deeply appreciated. With warmest personal regards and every good wish.

Sincerely yours,

Enclosure (Priority Schedule) Director

cc:

Dr. George M. Reynolds, Chairman, State Review Committee, Arkansas History Commission, Old State House, Little Rock, Arkansas 72201 w/cy inc.

Director, Southeast Region w/cy inc.

LL-Mr. Melvin w/cy inc.

T-w/cy inc.

HR-w/cy inc.

BASIC FILE RETAINED IN HR

Lawrence
AK ✓

S. Bradford 4/19
W. Mortagh 4/19
~~F. Wood 4/16~~
T. Wood 4/28

H34-HR

MAY 3 1971

Hon. William V. Alexander
House of Representatives
Washington, D.C.

Dear Mr. Alexander:

We are pleased to acknowledge your inquiry in behalf of several constituents concerning the Powhatan Courthouse, Lawrence County, Walnut Ridge, Arkansas.

Arkansas submitted eight project applications totaling \$257,958 in Federal matching funds in October 1970. Included was an application for the restoration of the Powhatan Courthouse, requesting a matching grant of \$54,050. The total project acquisition and development request from the States exceeds \$17 million. The fiscal year 1971 appropriation for the grants-in-aid program is \$5,980,000, of which \$2,185,631.75 has been apportioned to 41 States for survey and planning, \$1,042,023 to the National Trust for Historic Preservation and \$2,323,762.22 to 40 States for acquisition and development projects. Arkansas' apportionment for development projects is \$47,498.72. Regrettably, there is not enough money to fund all of Arkansas' valuable requests. Therefore, the State has selected the projects to be funded in accordance with the criteria under Priority 3 in the enclosed Grants Program Priority Schedule. It is unfortunate that the restrictive funding of the grants program will not allow inclusion of the Powhatan Courthouse among the projects scheduled for Federal assistance in fiscal year 1971.

Since the Powhatan Courthouse project will not be funded in fiscal 1971, it is suggested that its sponsors consult Arkansas' State Liaison Officer about including the courthouse in the State's annual work program for fiscal year 1972. The work program is due

(BASIC FILE RETAINED IN HR)

(CL-15862)

May 1. The State Liaison Officer is Dr. George M. Reynolds,
Chairman, State Review Committee, Arkansas History Commission,
Old State House, Little Rock, Arkansas 72201.

Your interest in the National Park Service and its programs is
most deeply appreciated.

Sincerely yours,

(Sgd.) Raymond L. Freeman

Acting **Director**

Enclosure

cc:

Dr. George M. Reynolds
Chairman, State Review Committee
Arkansas History Commission
Old State House
Little Rock, Arkansas 72201) w/c of inc.

CL)

Director-SE Region)

LL-Mr. Melvin)

T)

HR)

FNP:SBradford:EAC:crb:4-26-71

J. W. FULBRIGHT
ARKANSAS

COMMITTEES:
FOREIGN RELATIONS (CHAIRMAN)
FINANCE
JOINT ECONOMIC
DEMOCRATIC POLICY

JUN 9 1971

United States Senate
WASHINGTON, D.C. 20510

LEE WILLIAMS
ADMINISTRATIVE ASSISTANT

DAVID P. LAMBERT
LEGISLATIVE ASSISTANT

PARKER WESTBROOK
SPECIAL ASSISTANT

June 8, 1971

Mr. George B. Hartzog, Jr.
Director, National Park Service
Department of Interior
Washington, D. C. 20240

Dear Mr. Hartzog:

I understand that the Arkansas Historic Preservation Program has resubmitted an application for assistance for historic preservation of the Powhatan Courthouse in Lawrence County, Arkansas.

You may recall that I have had previous correspondence with you on this matter. I know it to be a meritorious project and hope that you will give it every consideration.

With best wishes, I am

Sincerely yours,

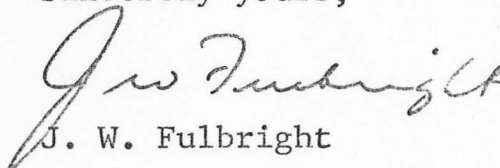
J. W. Fulbright

JWF:psp

JUN 11 1971

Hon. J. W. Fulbright
United States Senate
Washington, D.C.

Dear Senator Fulbright:

We are pleased to acknowledge your inquiry in behalf
of the Arkansas Historic Preservation Program concerning
the Powhatan Courthouse in Lawrence County, Arkansas.

We appreciate your interest in this matter and will
provide you a reply at our earliest opportunity.

Sincerely yours,

GEORGE B. HARTZOG, JR.

Director

FNP:TGWood:ljp:6-10-71

state file
CL - Arch

H34-HR

JUL 6 - 1971

Hon. J. W. Fulbright
United States Senate
Washington, D.C.

Dear Senator Fulbright:

We are pleased to respond to your inquiry concerning the Powhatan Courthouse in Lawrence County, Arkansas.

Arkansas' fiscal 1972 annual work program includes a development project application for the Powhatan Courthouse. The total project cost is \$108,100; the Federal matching share is \$54,050. Our staff is reviewing the State's annual work program; if any questions arise, we will consult Arkansas' State Liaison Officer, Dr. George Reynolds, Chairman, State Review Committee, Arkansas History Commission, Old State House, Little Rock, Arkansas 72201. The application will be carefully considered according to its priority in the State's annual work program and the availability of funding for grants-in-aid in fiscal 1972.

We recall your previous correspondence about the Powhatan Courthouse and greatly appreciate your interest. We believe that you will be pleased to know of Arkansas' vigorous participation in the national historic preservation program. The State's annual work program is a model of its kind.

Your interest in the National Park Service and its programs is most deeply appreciated.

Sincerely yours,

(Sgd) Harthon L. Bill

Acting Director

cc:

Dr. George Reynolds
Chairman, State Review Committee
Arkansas History Commission
Old State House
Little Rock, Arkansas 72201) w/c of inc.

Director, Southeast Region)
LS - Mr. Melvin)

FNP:SBradford:ljp:6-25-71

HR (2) Bradford & SLO

(BASIC FILE RETAINED IN HR

state file
CL - Arch

H34-HR

JUL 6 - 1971

Hon. J. W. Fulbright
United States Senate
Washington, D.C.

Dear Senator Fulbright:

We are pleased to respond to your inquiry concerning the Powhatan Courthouse in Lawrence County, Arkansas.

Arkansas' fiscal 1972 annual work program includes a development project application for the Powhatan Courthouse. The total project cost is \$108,100; the Federal matching share is \$54,050. Our staff is reviewing the State's annual work program; if any questions arise, we will consult Arkansas' State Liaison Officer, Dr. George Reynolds, Chairman, State Review Committee, Arkansas History Commission, Old State House, Little Rock, Arkansas 72201. The application will be carefully considered according to its priority in the State's annual work program and the availability of funding for grants-in-aid in fiscal 1972.

We recall your previous correspondence about the Powhatan Courthouse and greatly appreciate your interest. We believe that you will be pleased to know of Arkansas' vigorous participation in the national historic preservation program. The State's annual work program is a model of its kind.

Your interest in the National Park Service and its programs is most deeply appreciated.

Sincerely yours,

(Sgd) Harthon L. Bill

Acting Director

cc:
Dr. George Reynolds
Chairman, State Review Committee
Arkansas History Commission
Old State House
Little Rock, Arkansas 72201) w/c of inc.

Director, Southeast Region) FNP:SBradford:ljp:6-25-71
LS - Mr. Melvin)

HR (2) Bradford & SLO

(BASIC FILE RETAINED IN HR