

UNITED STATES DEPARTMENT OF THE INTERIOR  
NATIONAL PARK SERVICE

**NATIONAL REGISTER OF HISTORIC PLACES  
INVENTORY -- NOMINATION FORM**

FOR FEDERAL PROPERTIES

FOR NPS USE ONLY

RECEIVED DEC 11 1985

DATE ENTERED JAN 21 1986

SEE INSTRUCTIONS IN *HOW TO COMPLETE NATIONAL REGISTER FORMS*  
TYPE ALL ENTRIES -- COMPLETE APPLICABLE SECTIONS

**1 NAME**

HISTORIC

United States Post Office

AND/OR COMMON

Manchester Main Post Office

**2 LOCATION**

STREET & NUMBER

479 Main/Center Street

N/A NOT FOR PUBLICATION

CITY, TOWN

Manchester

N/A VICINITY OF

CONGRESSIONAL DISTRICT

First Congressional District

STATE

Connecticut 06040

CODE

0365

COUNTY

Hartford

CODE

003

**2 CLASSIFICATION**

**CATEGORY**

DISTRICT  
 BUILDING(S)  
 STRUCTURE  
 SITE  
 OBJECT

**OWNERSHIP**

PUBLIC  
 PRIVATE  
 BOTH

**PUBLIC ACQUISITION**

N/A IN PROCESS  
 BEING CONSIDERED

**STATUS**

OCCUPIED  
 UNOCCUPIED  
 WORK IN PROGRESS  
**ACCESSIBLE**  
 YES, RESTRICTED  
 YES, UNRESTRICTED  
 NO

**PRESENT USE**

AGRICULTURE  MUSEUM  
 COMMERCIAL  PARK  
 EDUCATIONAL  PRIVATE RESIDENCE  
 ENTERTAINMENT  RELIGIOUS  
 GOVERNMENT  SCIENTIFIC  
 INDUSTRIAL  TRANSPORTATION  
 MILITARY  OTHER

**4 AGENCY**

REGIONAL HEADQUARTERS: *(If applicable)*

New England Field Real Estate and Buildings Office

STREET & NUMBER

1050 Waltham Street

CITY, TOWN

Lexington

N/A VICINITY OF

STATE

Massachusetts 02173

**5 LOCATION OF LEGAL DESCRIPTION**

COURTHOUSE,  
REGISTRY OF DEEDS, ETC.

Town of Manchester Land Records

STREET & NUMBER

Town Hall, Town Clerk's Office, 41 Center Street

CITY, TOWN

Manchester, Connecticut 06040

STATE

**6 REPRESENTATION IN EXISTING SURVEYS**

TITLE

None

DATE

FEDERAL  STATE  COUNTY  LOCAL

DEPOSITORY FOR  
SURVEY RECORDS

CITY, TOWN

STATE

## 7 DESCRIPTION

CONDITION		CHECK ONE	CHECK ONE
<input checked="" type="checkbox"/> EXCELLENT	<input type="checkbox"/> DETERIORATED	<input checked="" type="checkbox"/> UNALTERED	<input checked="" type="checkbox"/> ORIGINAL SITE
<input type="checkbox"/> GOOD	<input type="checkbox"/> RUINS	<input type="checkbox"/> ALTERED	<input type="checkbox"/> MOVED      DATE _____
<input type="checkbox"/> FAIR	<input type="checkbox"/> UNEXPOSED		

---

### DESCRIBE THE PRESENT AND ORIGINAL (IF KNOWN) PHYSICAL APPEARANCE

The United States Post Office at Manchester, Connecticut is essentially a one-story structure, however, due to the substantial slope of the site, the basement level opens on grade at the loading zone in the rear. The property is situated at the intersection of Routes 6, 44, and 83 at the northern end of Manchester's commercial district. It harmonizes well with several other neighboring buildings including the imposing white clapboard Congregational Church to the West and the Neo-Classical Masonic Temple to the East. Directly across from the main entrance is a major city park.

The southwest portion of the building consists of pedimented central entrance. It is framed by five bays of bold large scale arched windows on the western side and five bays with a recessed sixth bay of the same on the south. The northern face of the building is composed of five rectangular bays that have double 3 x 4 lites casement window for the mezzanine above and the double 4 x 4 casements for the the workroom below. The original copper canopy projects over the loading platform. The remaining east side carries two of the arched window bays on the south along with three recessed rectangular bays and adjoining stair and elevator tower.

The building is faced in red brick in English bond coursing trimmed with buff limestone sills and string coursing. A hipped roof capped with the original slate and finely detailed glass and wood cupola covers the main portion of the building. A flat roof protects the mezzanine and stair at the rear of the building.

The central entrance is graced with four limestone columns of the Ionic order. These in turn support a denticulated frieze which becomes a deep cornice around the perimeter of the building. Centered in the pediment is a recessed leaded glass lite in the shape of a shield, framed with richly detailed plaster moldings.

Served by wide granite steps, the main door frame carries a limestone ediface with an arched pediment and lantern. A leaded glass eagle forms the rectangular lite above the doorway.

The original lobby, upon entering, once extended to the north and east. The eastern portion is now part of the workroom. An elevator in the northeast corner serves the mailing platform in the basement. Storage and the mechanical rooms are also located there. Originally, these storage rooms once served as federal offices.

The lobby materials include the original random sized brown ceramic tiles. Floors with white marble borders and wainscotting; black marble base; painted plaster walls and ceilings; and ornate metal grilles above the service windows in the screen line while marble window sills and molded wooden frames mark the window areas. An original parquet wood flooring in the workroom has been resurfaced with hardwood strips. (more)

**United States Department of the Interior  
National Park Service**

**National Register of Historic Places  
Inventory—Nomination Form**

For NPS use only

received

date entered

Continuation sheet

Item number seven (7)

Page 2

There are no other buildings on the site. An English Bond red brick retaining wall with granite capping creates a level visual plane for the central building face to rest on. The Japanese yews border plantings are very well maintained and new maples have been planted along the intersection.

# 8 SIGNIFICANCE

PERIOD		AREAS OF SIGNIFICANCE -- CHECK AND JUSTIFY BELOW			
<input type="checkbox"/> PREHISTORIC	<input type="checkbox"/> ARCHEOLOGY-PREHISTORIC	<input type="checkbox"/> COMMUNITY PLANNING	<input type="checkbox"/> LANDSCAPE ARCHITECTURE	<input type="checkbox"/> RELIGION	
<input type="checkbox"/> 1400-1499	<input type="checkbox"/> ARCHEOLOGY-HISTORIC	<input type="checkbox"/> CONSERVATION	<input type="checkbox"/> LAW	<input type="checkbox"/> SCIENCE	
<input type="checkbox"/> 1500-1599	<input type="checkbox"/> AGRICULTURE	<input type="checkbox"/> ECONOMICS	<input type="checkbox"/> LITERATURE	<input type="checkbox"/> SCULPTURE	
<input type="checkbox"/> 1600-1699	<input checked="" type="checkbox"/> ARCHITECTURE	<input type="checkbox"/> EDUCATION	<input type="checkbox"/> MILITARY	<input type="checkbox"/> SOCIAL/HUMANITARIAN	
<input type="checkbox"/> 1700-1799	<input type="checkbox"/> ART	<input type="checkbox"/> ENGINEERING	<input type="checkbox"/> MUSIC	<input type="checkbox"/> THEATER	
<input type="checkbox"/> 1800-1899	<input type="checkbox"/> COMMERCE	<input type="checkbox"/> EXPLORATION/SETTLEMENT	<input type="checkbox"/> PHILOSOPHY	<input type="checkbox"/> TRANSPORTATION	
<input checked="" type="checkbox"/> 1900-	<input type="checkbox"/> COMMUNICATIONS	<input type="checkbox"/> INDUSTRY	<input type="checkbox"/> POLITICS/GOVERNMENT	<input type="checkbox"/> OTHER (SPECIFY)	
		<input type="checkbox"/> INVENTION			

SPECIFIC DATES    Designed: 1931  
                           Constructed: 1931-1932    BUILDER/ARCHITECT    James D. Wetmore, Acting Supervising Architect

STATEMENT OF SIGNIFICANCE

Contractor: Pieretti Brothers  
 Centerbrook, CT

The United States Post Office at Manchester, Connecticut is significant as an example of architectural eclecticism incorporating Classical and Georgian revival detailing. Shaped to effectively maximize its prominent corner site, the building is unique in its use of a pentagonal floor plan.

The Manchester Post Office was designed in 1931 under James A. Wetmore, Acting Supervising Architect for the U.S. Treasury Department. It was constructed in 1931-1932 by the Pieretti Brothers of Centerbrooke, Connecticut.

It is a unique design that illustrates the abilities of the U.S. Treasury Department's Architectural Division to work with a difficult site and not impose a preconceived floor plan or design. Instead they maximized its prominent corner location and created a structure of timeless quality with durable materials and simple yet monumental scale.

Built during the depression it is, indeed, tangible evidence of the Federal Governments sincerity of working at the community level to inspire a positive image.

The building has become a local landmark with its rich details and handsome Classical entrance which are traditional in New England towns. It is a fine example of a Class B building as defined by McAdoo's 1915 Classification for Federal Buildings. The adjacent properties, being on the work edge of town, were at the time somewhat below the higher valuation of metropolitan real estate. Typical with Class B structures, it utilized the brick exterior with limestone trimmings. While the interior finishes may have excluded the finer marble and expensive woods, the ornamental iron grillework and leaded window lites are exceptional. Its nomination to the National Register of Historic Places will protect this architecturally significant and important local landmark.

# 9 MAJOR BIBLIOGRAPHICAL REFERENCES

History of Post Office Construction 1900-1940, July, 1982

Craig, Lois, ed., The Federal Presence: Architecture, Politics and Symbols in the United States Government Building, Cambridge, Massachusetts: The MIT Press, 1979.

# 10 GEOGRAPHICAL DATA

ACREAGE OF NOMINATED PROPERTY .5

UTM REFERENCES

A	1, 8	7 0, 5 9, 0, 0	4, 6 2 7 7 2 0	B			
	ZONE	EASTING	NORTHING		ZONE	EASTING	NORTHING
C				D			

VERBAL BOUNDARY DESCRIPTION

The rectangular site is 170' x 120' at the intersection of Center and Main Streets. The main floor of the building is approximately 8,100 square feet.

LIST ALL STATES AND COUNTIES FOR PROPERTIES OVERLAPPING STATE OR COUNTY BOUNDARIES

STATE	CODE	COUNTY	CODE
STATE	CODE	COUNTY	CODE

# 11 FORM PREPARED BY

NAME / TITLE

Robert W. St. John, Architect

ORGANIZATION

SULLIVAN DESIGN GROUP, INC.

DATE

July 15, 1985

STREET & NUMBER

44 ADAMS STREET

TELEPHONE

(617) 848-1545

CITY OR TOWN

Braintree

STATE

Massachusetts 02184

# 12 CERTIFICATION OF NOMINATION

STATE HISTORIC PRESERVATION OFFICER RECOMMENDATION

YES

NO

NONE

*[Signature]*  
STATE HISTORIC PRESERVATION OFFICER SIGNATURE

In compliance with Executive Order 11593, I hereby nominate this property to the National Register, certifying that the State Historic Preservation Officer has been allowed 90 days in which to present the nomination to the State Review Board and to evaluate its significance. The evaluated level of significance is \_\_\_ National \_\_\_ State  Local.

FEDERAL REPRESENTATIVE SIGNATURE

TITLE

*[Signature]*

Director, Office of Real Estate

DATE

12/5/85

FOR NPS USE ONLY

I HEREBY CERTIFY THAT THIS PROPERTY IS INCLUDED IN THE NATIONAL REGISTER

*[Signature]*

DATE

1/21/86

DIRECTOR, OFFICE OF ARCHAEOLOGY AND HISTORIC PRESERVATION

ATTEST:

*[Signature]*

DATE

1-16-86

~~KEEPER OF THE NATIONAL REGISTER~~

1. Public Lobby
2. Originally part of Lobby
3. Postmaster
4. Work Room
5. Carrier's Area
6. Elevator

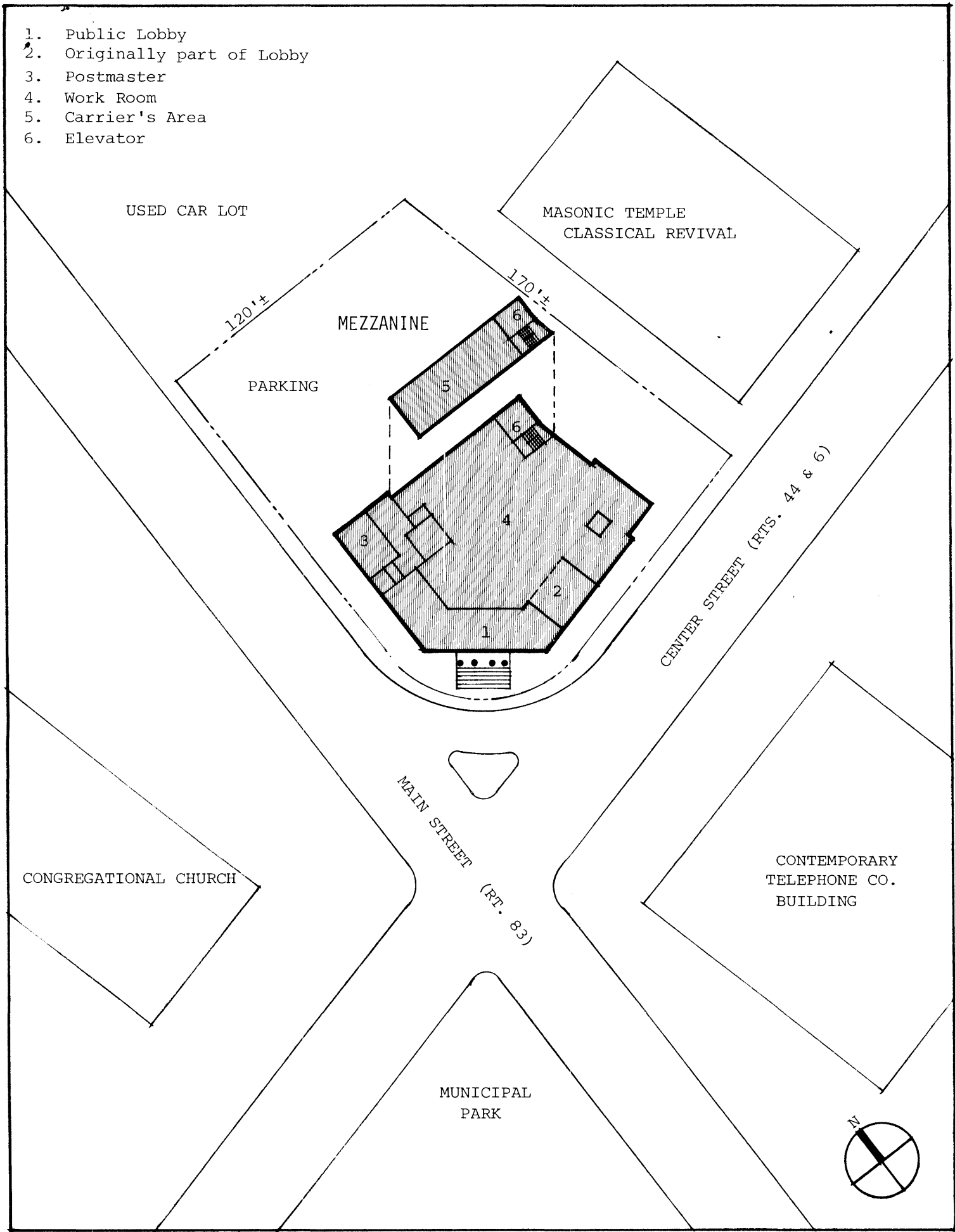

UNITED STATES POST OFFICE - MANCHESTER, CONNECTICUT