

NATIONAL REGISTER OF HISTORIC PLACES
INVENTORY - NOMINATION FORM

(Type all entries - complete applicable sections)

1/17/73 PH0002437

STATE: Florida	
COUNTY: Pinellas	
FOR NPS USE ONLY	
ENTRY NUMBER	DATE
JUL 31 1972	

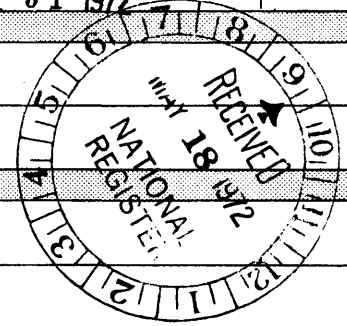

1. NAME

COMMON:
Andrews Memorial Chapel

AND/OR HISTORIC:

2. LOCATION

STREET AND NUMBER:
Corner of Buena Vista and San Mateo

CITY OR TOWN:
Dunedin

STATE Florida	CODE 12	COUNTY: Pinellas	CODE 103
------------------	------------	---------------------	-------------

3. CLASSIFICATION

CATEGORY (Check One)	OWNERSHIP	STATUS	ACCESSIBLE TO THE PUBLIC
<input type="checkbox"/> District <input type="checkbox"/> Site <input type="checkbox"/> Object	<input checked="" type="checkbox"/> Building <input type="checkbox"/> Structure <input type="checkbox"/> Public Acquisition: <input type="checkbox"/> In Process <input type="checkbox"/> Being Considered	<input type="checkbox"/> Occupied <input checked="" type="checkbox"/> Unoccupied <input checked="" type="checkbox"/> Preservation work in progress	Yes: <input checked="" type="checkbox"/> Restricted <input type="checkbox"/> Unrestricted <input type="checkbox"/> No

PRESENT USE (Check One or More as Appropriate)

<input type="checkbox"/> Agricultural <input type="checkbox"/> Commercial <input type="checkbox"/> Educational <input type="checkbox"/> Entertainment	<input type="checkbox"/> Government <input type="checkbox"/> Industrial <input type="checkbox"/> Military <input type="checkbox"/> Museum	<input type="checkbox"/> Park <input type="checkbox"/> Private Residence <input type="checkbox"/> Religious <input type="checkbox"/> Scientific	<input type="checkbox"/> Transportation <input checked="" type="checkbox"/> Other (Specify) <u>in process of restoration</u>	<input type="checkbox"/> Comments
--	--	--	--	-----------------------------------

4. OWNER OF PROPERTY

OWNER'S NAME:
City of Dunedin for Dunedin Historical Society

STREET AND NUMBER:
750 Milwaukee Avenue

CITY OR TOWN:
Dunedin

STATE:
Florida

CODE:
12

5. LOCATION OF LEGAL DESCRIPTION

COURTHOUSE, REGISTRY OF DEEDS, ETC.:
Pinellas County Courthouse

STREET AND NUMBER:
315 Haven Street

CITY OR TOWN:
Clearwater

STATE:
Florida

CODE:
12

6. REPRESENTATION IN EXISTING SURVEYS

TITLE OF SURVEY:
None

DATE OF SURVEY:
 Federal State County Local

DEPOSITORY FOR SURVEY RECORDS:

STREET AND NUMBER:

CITY OR TOWN:

STATE:

CODE:

SEE INSTRUCTIONS

STATE: Florida

COUNTY: Pinellas

ENTRY NUMBER: JUL 31 1972

FOR NPS USE ONLY

DATE:

7 DESCRIPTION

CONDITION

(Check One)

Excellent Good Fair Deteriorated Ruins Unexposed

(Check One)

Altered Unaltered

(Check One)

Moved Original Site

DESCRIBE THE PRESENT AND ORIGINAL (if known) PHYSICAL APPEARANCE

Andrews Memorial Chapel is located in a rural setting in the city-owned Highland Park. It was moved to this site in 1971 and it now stands on block piers. The structure is wood framed throughout and from all evidence it is heart pine. All concealed framing lumber is rough sawn, full dimension. Wood flooring is tongue and groove, apparently of pine and painted. The exterior of the building is wood siding, in horizontal coursing, shiplap "novelty" siding with curved top rabbet. The most unique feature of the structure is the roof framing. Wood trusses frame across the main room and carry two purlins on each side which in turn carry vertical rafters. The roof decking is tongue and groove beaded siding, stained and varnished. The trusses are basically modified scissors trusses. The roofing material is cement-asbestos shingles (red), but these are certainly not the original. No evidence of the original roofing remains, but it is likely that it was wood shingle. Doorways are both arches and half-arches with scroll sawn casings and carefully kerfed and bent moldings. Decorative brass hinge plates indicate considerable age and are very likely the original hardware. Windows are single-hung with right-angle straight arch heads.

Interior wall finishes are a painted wainscot of vertically applied double beaded siding. There is then a layer of plaster on wood strip lath to the eave level with double beaded siding from there up, stained and varnished. The main room is approximately 30 by 50 feet. The rose windows in both of the end gables are thought to be original to the building.

The main alteration of the building was the removal of the steeple. The general condition of the building is fair. There is no apparent damage to the roof structure, and the interior surfaces are in very good condition. The exterior siding, however, shows much damage. This is from the recent move and the effects of weather. The siding also shows nail damage from a previous stucco application. The gable shingles are in good condition.

This building is most interesting and a valuable example of early indigenous Florida architecture. The designer-builder showed imagination, coupled with admirable restraint, in his treatment of the fenestration, finished wall surfaces and particularly in the roof framing system.

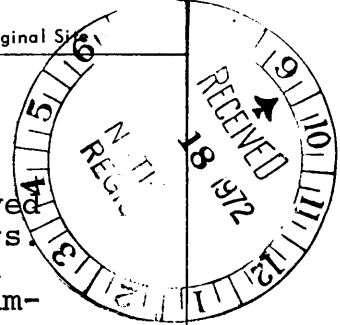

SEE INSTRUCTIONS

8. SIGNIFICANCE

PERIOD (Check One or More as Appropriate)

- Pre-Columbian 16th Century 18th Century 20th Century
 15th Century 17th Century 19th Century

SPECIFIC DATE(S) (If Applicable and Known) **1888**

AREAS OF SIGNIFICANCE (Check One or More as Appropriate)

- | | | |
|--|---|--|
| <input type="checkbox"/> Aboriginal | <input type="checkbox"/> Education | <input type="checkbox"/> Political |
| <input type="checkbox"/> Prehistoric | <input type="checkbox"/> Engineering | <input type="checkbox"/> Religion/Philosophy |
| <input type="checkbox"/> Historic | <input type="checkbox"/> Industry | <input type="checkbox"/> Science |
| <input type="checkbox"/> Agriculture | <input type="checkbox"/> Invention | <input type="checkbox"/> Sculpture |
| <input checked="" type="checkbox"/> Architecture | <input type="checkbox"/> Landscape Architecture | <input type="checkbox"/> Social/Humanitarian |
| <input type="checkbox"/> Art | <input type="checkbox"/> Literature | <input type="checkbox"/> Theater |
| <input type="checkbox"/> Commerce | <input type="checkbox"/> Military | <input type="checkbox"/> Transportation |
| <input type="checkbox"/> Communications | <input type="checkbox"/> Music | |
| <input type="checkbox"/> Conservation | | |

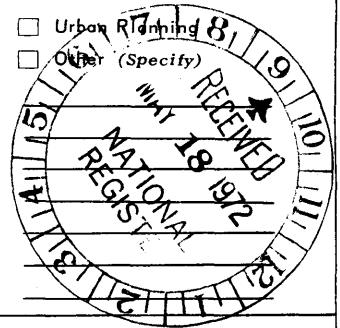

STATEMENT OF SIGNIFICANCE

SEE INSTRUCTIONS

"In the spring of 1871, according to public notice, a meeting was held at the schoolhouse, the usual place of worship, for the purpose of organizing a church." Since the arrival of the Rev. Mr. Brown from Virginia in 1868, the tiny congregation had been meeting in the log schoolhouse. In 1876, however, construction was begun on a new church building. The land for the church was given by Mr. B. W. Brown, at which time the name of the church was changed to Andrews Memorial. The naming was in honor of William Andrews, recently deceased, whose father pledged \$200 to the building fund if the church bore his name.

The tiny congregation continued to grow and many members wanted to build a new and larger church in the center of population. Before an agreement could be reached between the members, a parcel of land was given by Mr. William Tate at the southwest corner of Scotland Street and Highland Avenue. The new church was completed in 1888. There was never a formal dedication, but the name, Andrews Memorial Church, was transferred to the new location.

In 1926 Andrews Memorial Church became the Andrews Memorial Chapel and was moved down Highland Avenue to the rear of the church property to make room for the present sanctuary. The church changed its name to the First Presbyterian Church of Dunedin at that time.

Because of the architectural significance of this indigenous structure and since it is one of the few remaining nineteenth century structures in this rapidly expanding region of Florida, it is judged to be of adequate regional importance for placement on the National Register. There is a great deal of local interest in the preservation of this structure as evidenced by its recent move by the Dunedin Historical Society. The building is currently in the process of restoration to be used by this group as its headquarters.

9 MAJOR BIBLIOGRAPHICAL REFERENCES

See Attached Sheet

10 GEOGRAPHICAL DATA

LATITUDE AND LONGITUDE COORDINATES DEFINING A RECTANGLE LOCATING THE PROPERTY			OR	LATITUDE AND LONGITUDE COORDINATES DEFINING THE CENTER POINT OF A PROPERTY OF LESS THAN TEN ACRES		
CORNER	LATITUDE	LONGITUDE		LATITUDE	LONGITUDE	
	Degrees Minutes Seconds	Degrees Minutes Seconds		Degrees Minutes Seconds	Degrees Minutes Seconds	
NW	° ' "	° ' "		N 28° 01 ' 52"	W 82° 47 ' 09"	
NE	° ' "	° ' "				
SE	° ' "	° ' "				
SW	° ' "	° ' "				

APPROXIMATE ACREAGE OF NOMINATED PROPERTY: **Less than an acre**

LIST ALL STATES AND COUNTIES RECEIVING INTERESTS OVERLAPPING STATE OR COUNTY BOUNDARIES

STATE:	CODE	COUNTY:	CODE

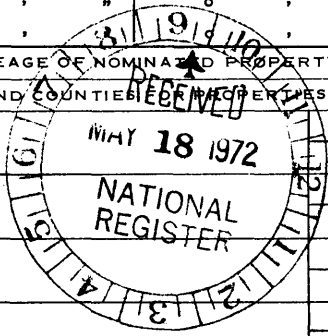

SEE INSTRUCTIONS

11 FORM PREPARED BY

NAME AND TITLE:
Diane D. Greer, Historic Sites Specialist

ORGANIZATION: **Division of Archives, History, Records Mgmt.** DATE: **3/72**

STREET AND NUMBER:
Department of State - The Capitol

CITY OR TOWN: **Tallahassee** STATE: **Florida** CODE: **12**

12. STATE LIAISON OFFICER CERTIFICATION NATIONAL REGISTER VERIFICATION

<p>As the designated State Liaison Officer for the National Historic Preservation Act of 1966 (Public Law 89-665), I hereby nominate this property for inclusion in the National Register and certify that it has been evaluated according to the criteria and procedures set forth by the National Park Service. The recommended level of significance of this nomination is:</p> <p>National <input type="checkbox"/> State <input type="checkbox"/> Local <input checked="" type="checkbox"/></p> <p>Name: <u><i>Robert William</i></u></p> <p>Title: <u>State Liaison Officer</u></p> <p>Date: <u>May 10, 1972</u></p>	<p>I hereby certify that this property is included in the National Register.</p> <p><u><i>Robert Van Utley</i></u> Chief, Office of Archeology and Historic Preservation</p> <p>Date: <u>7/31/72</u></p> <p>ATTEST:</p> <p><u><i>W. Bradford</i></u> Keeper of The National Register</p> <p>Date: <u>7/24/72</u></p>
--	--

**NATIONAL REGISTER OF HISTORIC PLACES
INVENTORY - NOMINATION FORM**

(Continuation Sheet)

STATE	
Florida	
COUNTY	
Pinellas	
FOR NPS USE ONLY	
ENTRY NUMBER	DATE
	JUL 31 1972

(Number all entries)

9. MAJOR BIBLIOGRAPHICAL REFERENCES.

Dunedin Past and Present, A History of Dunedin, Florida. Dunedin, Florida: n.p., 1956.

Pinellas County Courthouse. Pinellas County Records. Office of the Clerk of the Circuit Court, Clearwater, Florida (Subgroup: Deeds).

Presbyterian Church. Minutes of the Session, Vol. I. 1871-1884. (Reprinted in A Century of Christian Life and Service.)

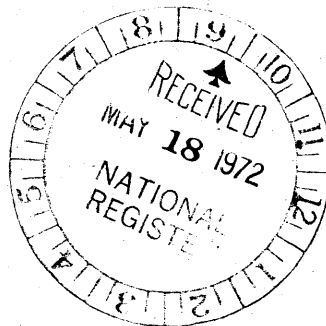

**NATIONAL REGISTER OF HISTORIC PLACES
PROPERTY MAP FORM**

(Type all entries - attach to or enclose with map)

STATE Florida	
COUNTY Pinellas	
FOR NPS USE ONLY	
ENTRY NUMBER JUL 31 1972	DATE

SEE INSTRUCTIONS

1. NAME

COMMON: Andrews Memorial Chapel
AND/OR HISTORIC:

2. LOCATION

STREET AND NUMBER:
Corner of Buena Vista and San Mateo

CITY OR TOWN:
Dunedin

STATE: Florida	CODE 12	COUNTY: Pinellas	CODE 103
-------------------	------------	---------------------	-------------

3. MAP REFERENCE

SOURCE:
U.S.G.S. Dunedin Quadrangle

SCALE: 1:24,000; 7.5 minute

DATE: 1943

4. REQUIREMENTS

TO BE INCLUDED ON ALL MAPS

1. Property boundaries where required.
2. North arrow.
3. Latitude and longitude reference.

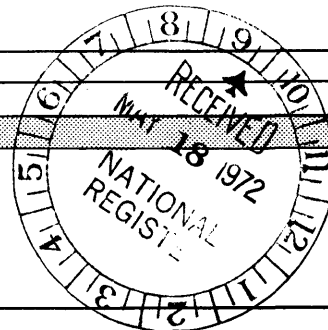

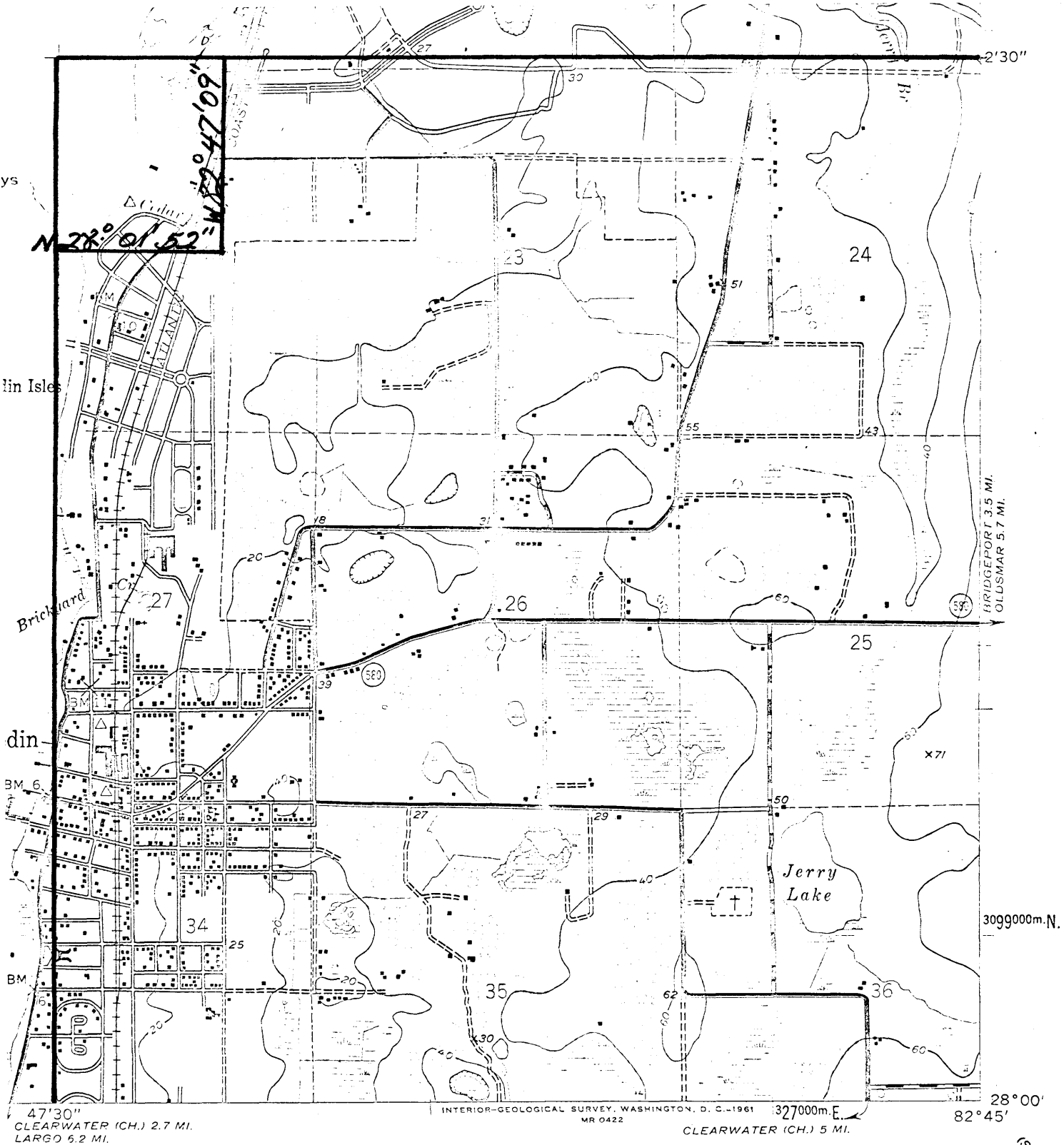

47'30"
CLEARWATER (CH.) 2.7 MI.
LARGO 6.2 MI.

INTERIOR-GEOLOGICAL SURVEY, WASHINGTON, D. C.-1961
MR 0422
327000m. E.
CLEARWATER (CH.) 5 MI.

28° 00'
82° 45'

ROAD CLASSIFICATION

- Heavy-duty —————
- Medium-duty —————
- Light-duty —————
- Unimproved dirt - - - - -
- U. S. Route
- State Route

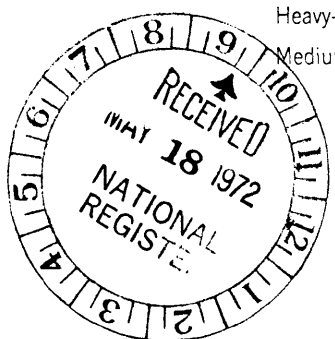

DUNEDIN, FLA.
N2800—WS245/7.5

1943

