

**NATIONAL REGISTER OF HISTORIC PLACES  
INVENTORY -- NOMINATION FORM**

79001413  
FOR HCRS USE ONLY  
RECEIVED JUL 9 1979  
DATE ENTERED SEP 5 1979

CONTINUATION SHEET	Individual Property	ITEM NUMBER	PAGE 65
Name:	Harvat Ranch		Photos #61 & #62
Map number:	Map B #14, Map M		
Location:	Southeast of Livingston, off of U.S. 89		
Owner and address:	George Myers Box 954 Livingston, Montana 59047		
Construction date:	1914-1917		
Style:	Craftsman bungalow, Vernacular		
Verbal boundary description:	T 2S, R 10, NE 1/4 of Section 18		
Acreage:	<del>less than 1 acre</del>		
U.T.M. reference:	12 1513,613,7,0 15,015,7,0,6,0		
Bibliography:	Tom Stout, ed., <u>Montana</u> , Vol. II, p. 328. Bill and Doris Whithorn, <u>Photo History of the Harvats and their Woolies</u> (Livingston, Private printing, 1976).		

**Description:**  
The house and outbuildings sit near the Yellowstone River against a low ridge, on a wooded site through which runs a small stream, the overflow from the spring supplying water to the property. The house is a large, 1 1/2-story bungalow, approximately square in plan. Sandstone foundations with red mortar joints support the brick walls of the first floor. Shingles cover gables under the low roof and those of large front and rear dormers. Solid carved brackets support the rake of the main roof and dormer eaves. The full front porch is supported by heavy piers, altered in 1959 after an earthquake. Two bays, one angled, one square, project to the sides. Six-over-one windows are used throughout most of the house. Original interiors are well preserved. Notable features include oak and maple flooring, woodwork, and built-in cabinetry; a cast bronze coal fireplace; original ceiling light fixtures, bathtub, and Hoosier cabinets in the kitchen. Behind the house is a newer garage, replacing the former carriage house and stable (see sketch plan). To the south is a small, 1-story, wood-frame, white stuccoed house (c. 1930s), and next to it, a lattice-work summer house (c. 1900), now in poor condition. To the north is a red barn (1917) with white trim, which has a gambrel roof and two square, louvered ventilators. Behind it are a wood frame bunkhouse and three sheds. The site adjoins a sandstone quarry on the river, which has provided much of the stone for Livingston structures. Behind the property is a disused road, once the main road from the east to Livingston, across the Yellowstone River bridge, now gone. The road was buttressed by dry-laid sandstone retaining walls, fragments of which remain.

**NATIONAL REGISTER OF HISTORIC PLACES  
INVENTORY -- NOMINATION FORM**

FOR HCRS USE ONLY
RECEIVED JUL 9 1979
DATE ENTERED SEP 5 1979

CONTINUATION SHEET      Individual Property      ITEM NUMBER      PAGE 66

**Significance:**

Like many other prominent Livingston men, John H. Harvat was drawn to the early-day settlement by the opportunities the Northern Pacific Railroad offered. Harvat was reared in Iowa, and as a young man, followed his fortunes to Virginia City and Bozeman, Montana territory. He came to Clark City in 1880, two years before the platting of Livingston. He first found employment in a business that supplied meat to railway construction crews and then to soldiers at Fort Yellowstone. He ran cattle and a meat market until 1900, when he embarked upon a lucrative career in sheep ranching. In 1919, the year he died, he claimed more than 20,000 acres of land and 25,000 sheep. About 1900, he had also built the Harvat Block and a large home on South Yellowstone Street in Livingston. After his death, his three sons organized the Harvat Brothers Sheep Company from his holdings. The large barn had been built in 1917, and the shearing sheds (some since destroyed) and corrals about the same time. At one point, the Harvat Brothers had under lease, deed, or forest service permit, more than 100,000 acres in Park County. In 1953, they sold some of these holdings to the present owner.

This structure meets the following National Register criteria:

- B. Harvat was an early settler and important rancher. His former property reflects the extensive agricultural interests in the area.
- C. The main house is a fine and well preserved craftsman bungalow, all the more impressive for its site.

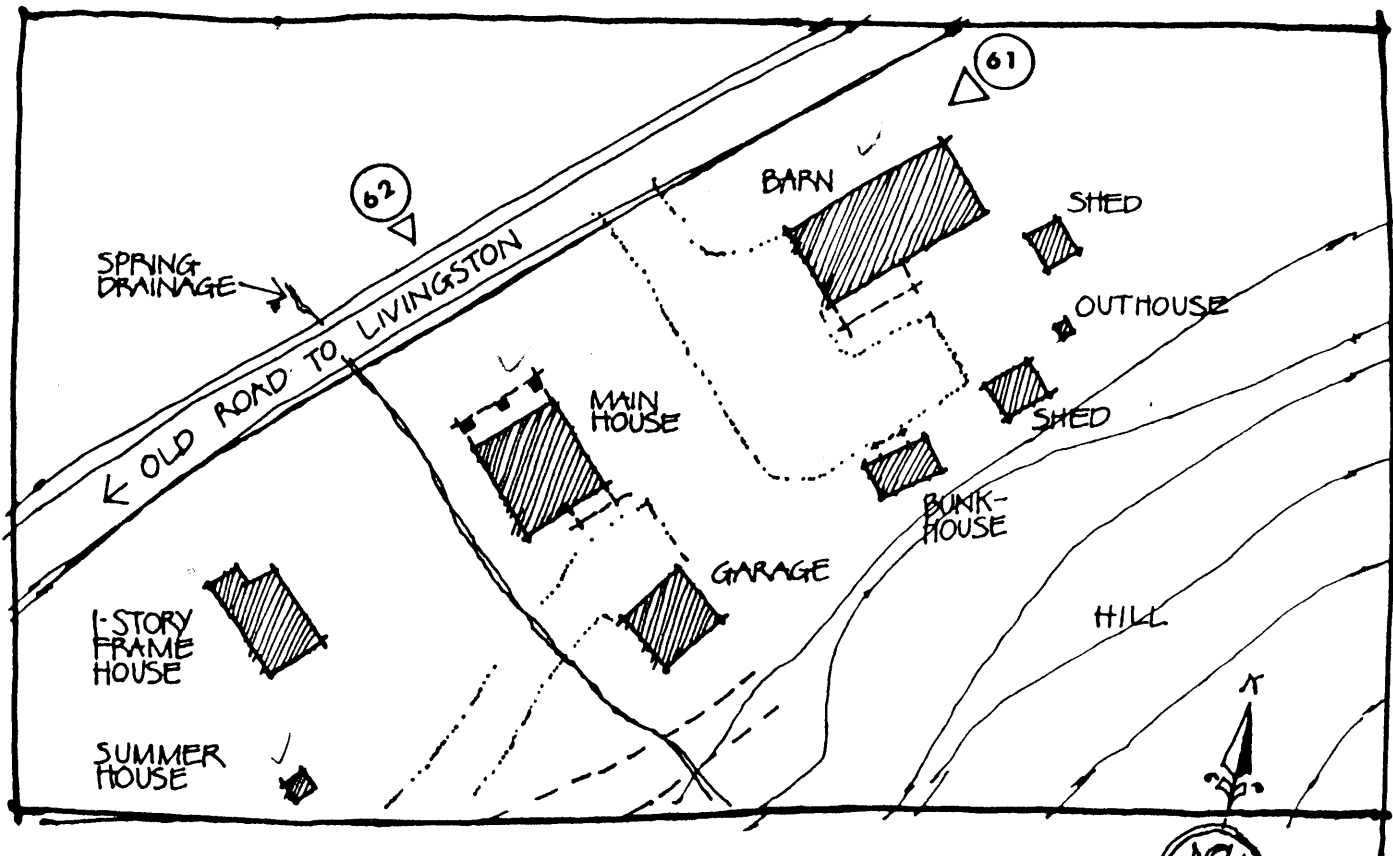

# HARVAT RANCH

Approx. scale 1" = 100'-0"

\*THE SITE AROUND THE TWO HOUSES IS WOODED, TREES ARE NOT SHOWN FOR CLARITY.

