

United States Department of the Interior
National Park Service

**National Register of Historic Places
Continuation Sheet**

Section number CZ 10-b Page 2 Herman Barn

The Herman Barn is also significant in the history of Czech Settlement in the state. Joseph Herman was born in Teletin, Bohemia in 1833. He brought his family to Dakota in 1870 and started a brewery in Tabor. His sons Joseph, Frank, Anton, and Charles all moved to Hutchinson County and established farms there.

Major biographical source: Dvorak (1980), 116.

10. Acreage: less than one acre. Scale: 1:24,000.
 Quad.: Tabor. UTM: 14/ 604420/ 4757800.

The Joseph Herman Barn is oriented on an axis that is canted approximately 20 degrees Northwest from Geographic North. The boundaries of the property are formed by imaginary lines that connect to form a rectangle that is centered on the rectangular barn. Each line lies 10 feet from the exterior walls of the barn. The site is located in the Southwest Quarter of the Southeast Quarter of Section 8, Township 94 North, Range 58 West, in Bon Homme County.

United States Department of the Interior
National Park Service

National Register of Historic Places

Continuation Sheet

Section number CZ 10-b Page 3

Herman Barn

SITE PLAN OF FARMSTEAD CONTAINING CZ 10-b ON REVERSE SIDE

SITE PLAN (Complete inventory of all structures, their function, dates & details of construction, and surrounding vegetation) WITH NORTH ARROW

SITE NAME: John Herman
CZ SURVEY #: 10a, b, & c

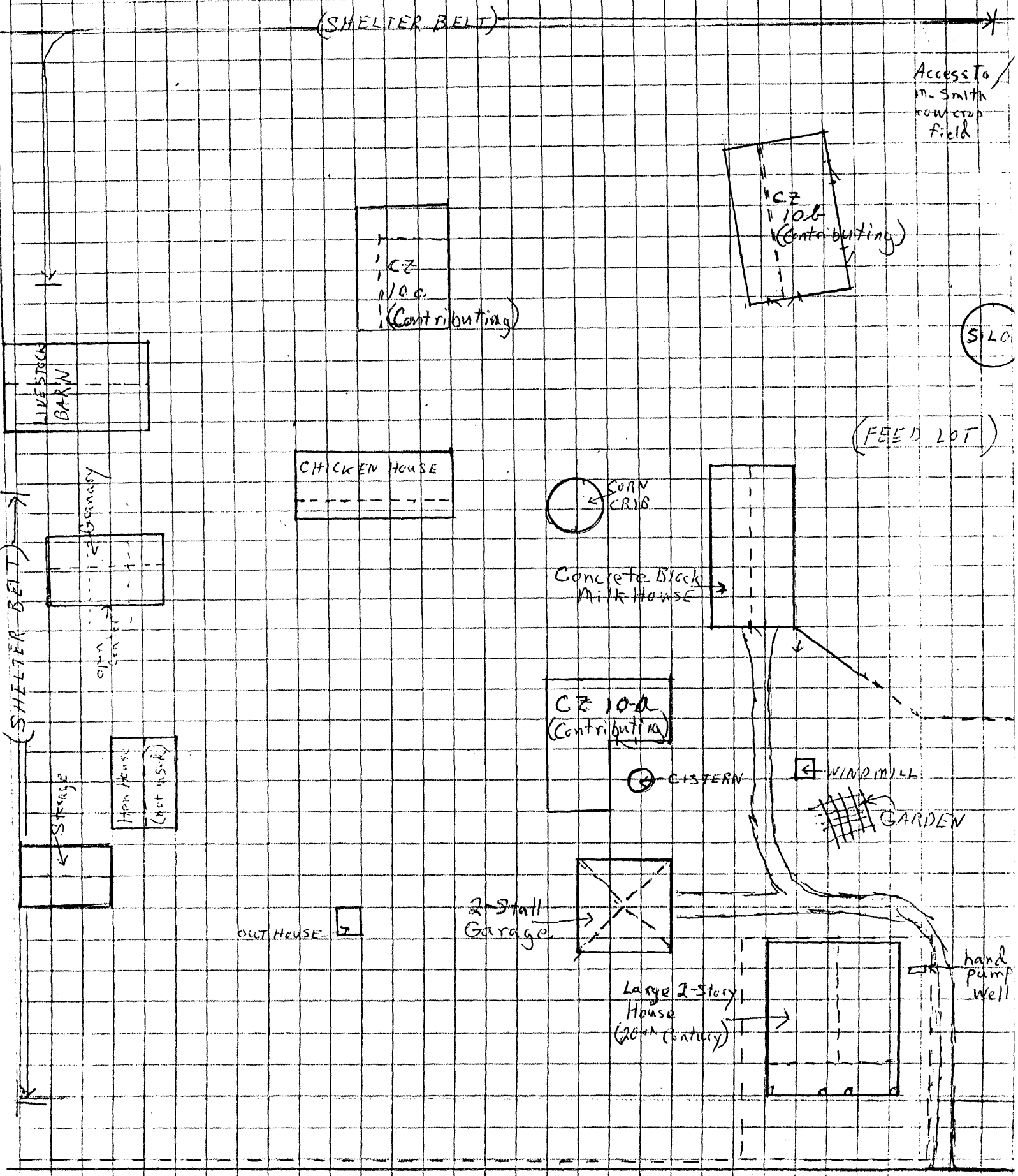

(SHELTER BELT)

Access to
m. Smith
row crop
field

CZ
10c
(Contributing)

CZ
10b
(Contributing)

SILO

LIVE STOCK
BARN

(FEED LOT)

CHICKEN HOUSE

CORN
CRIB

Concrete Block
Milk House

CZ 10a
(Contributing)

CISTERN

WINDMILL

GARDEN

(SHELTER BELT)

Man House
(not used)

Storage

OUT HOUSE

2 Stall
Garage

Large 2-Story
House
(20th Century)

hand
pump
Well