

278

United States Department of the Interior
National Park Service

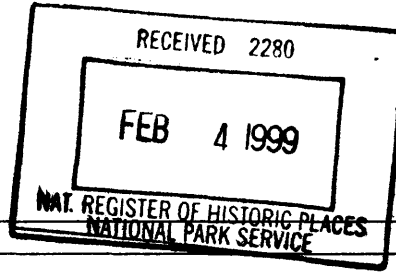

National Register of Historic Places
Registration Form

1. Name of Property

historic name: Idlewild Historic District

other name/site number: N/A

2. Location

street & number: Roughly bounded by South Cooper Street. Linden Avenue, N/A not for publication
Rembert Street and Central Avenue

city or town: Memphis N/A vicinity

state Tennessee code TN county Shelby code 157 zip code 38104

3. State/Federal Agency Certification

As the designated authority under the National Historic Preservation Act of 1986, as amended, I hereby certify that this nomination ___ request for determination of eligibility meets the documentation standards for registering properties in the National Register of Historic Places and meets the procedural and professional requirements set forth in 36 CFR Part 60. In my opinion, the property meets ___ does not meet the National Register Criteria. I recommend that this property be considered significant ___ nationally ___ statewide locally. (___ See continuation sheet for additional comments.)

Herbert L. Hays 1/26/98
Signature of certifying official Deputy SHPO, Tenn. Historical Commission Date

State or Federal agency and bureau

In my opinion, the property ___ meets ___ does not meet the National Register criteria. (___ See continuation sheet for additional comments.)

Signature of commenting or other official Date

State or Federal agency and bureau

4. National Park Service Certification

- I, hereby certify that this property is:
- ___ entered in the National Register
___ See continuation sheet.
- ___ determined eligible for the National Register
___ See continuation sheet.
- ___ determined not eligible for the National Register
- ___ removed from the National Register
- ___ other (explain): _____

for
Signature of the Keeper Date of Action
Edson H. Beall 3/5/99

Idlewild Historic District
Name of Property

Memphis, Shelby County, TN
County and State

5. Classification

Ownership of Property:	Private	Number of Resources within Property:		
		(Do not include previously listed resources in the count)		
Category of Property:	District	Contributing	Noncontributing	
		348	152	buildings
		2	0	sites
		0	0	structures
		0	0	objects
		350	152	Total

Name of related multiple property listing: Historic Residential Resources of Memphis, ca. 1865 to 1950
Number of contributing resources previously listed in the National Register: N/A

6. Function or Use

Historic Functions:	DOMESTIC DOMESTIC DOMESTIC COMMERCE/TRADE	Sub:	single dwelling multiple dwelling secondary structure specialty store
Current Functions:	DOMESTIC DOMESTIC DOMESTIC COMMERCE/TRADE	Sub:	single dwelling multiple dwelling secondary structure specialty store

7. Description

Architectural Classification:

Minimal Traditional
Craftsman
Colonial Revival
Queen Anne
Tudor Revival

Other Description:

shotgun bungalow
modified shotgun four-square
double shotgun
English cottage
composite cottage

Materials

foundation	BRICK
roof	ASPHALT SHINGLES
walls	BRICK
	WOOD/weatherboard
	STUCCO
other	CONCRETE/cast stone

Narrative Description

See continuation sheets.

5. Classification

Ownership of Property: Private

Number of Resources within Property:

(Do not include previously listed resources in the count)

Category of Property:	District	Number of Resources		
		Contributing	Noncontributing	
		347	153	buildings
		2	0	sites
		0	0	structures
		0	0	objects
		349	153	Total

Name of related multiple property listing:

Number of contributing resources previously listed in the National Register: N/A

Historic Residential Resources of Memphis, ca. 1865 to 1950

6. Function or Use

Historic Functions:	DOMESTIC	Sub:	single dwelling
	DOMESTIC		multiple dwelling
	DOMESTIC		secondary structure
	COMMERCE/TRADE		specialty store
Current Functions:	DOMESTIC	Sub:	single dwelling
	DOMESTIC		multiple dwelling
	DOMESTIC		secondary structure
	COMMERCE/TRADE		specialty store

7. Description

Architectural Classification:

Queen Anne Revival
Colonial Revival
Craftsman
Tudor Revival
Minimal Traditional

Other Description:

shotgun	bungalow
modified shotgun	four-square
double shotgun	
English cottage	
composite cottage	

Materials

foundation	BRICK
roof	ASPHALT SHINGLES
walls	BRICK
	WOOD/weatherboard
	STUCCO
other	CONCRETE/cast stone

Narrative Description

See continuation sheets.

8. Statement of Significance

Applicable National Register Criteria

Areas of Significance

- A** Property is associated with events that have made a significant contribution to the broad patterns of our history.
- B** Property is associated with the lives of persons significant in our past.
- C** Property embodies the distinctive characteristics of a type, period, or method of construction or represents the work of a master, or possesses high artistic values, or represents a significant and distinguishable entity whose components lack individual distinction.
- D** Property has yielded, or is likely to yield, information important in prehistory or history.

ARCHITECTURE

Period of Significance

ca. 1890 to ca. 1945

Significant Dates

N/A

Criteria Considerations

Property is N/A

- A** owned by a religious institution or used for religious purposes
- B** removed from its original location.
- C** a birthplace or grave
- D** a cemetery
- E** a reconstructed building, object, or structure
- F** a commemorative property
- G** less than 50 years of age or achieved significance within the past 50 years.

Significant Persons

N/A

Cultural Affiliation

N/A

Architect/Builder

Various, unknown

Narrative Statement of Significance

See continuation sheets.

9. MAJOR BIBLIOGRAPHICAL REFERENCES

Bibliography

See continuation sheet.

Previous Documentation on File (NPS): N/A

Primary Location of Additional Data:

- preliminary determination of individual listing (36 CFR 67) has been requested.
- previously listed in the National Register
- previously determined eligible by the National Register
- designated a National Historic Landmark
- recorded by Historic American Buildings Survey
- # _____

- State Historic Preservation Office
- Other State agency
- Federal agency
- Local government
- University
- Other
- Tennessee Historical Commission

Idlewild Historic District
Name of Property

Memphis, Shelby County, TN
County and State

10. Geographical Data

Acreage of Property: approximately 75 acres

USGS Quad Map Name: Northeast Memphis

UTM References:	Zone	Easting	Northing	Zone	Easting	Northing
	1 16	227550	3891770	3 16	772780	3890810
	2 16	227500	3891000	4 16	772840	3891800

___ See continuation sheet.

Verbal Boundary Description: See continuation sheet.

Boundary Justification: See continuation sheet.

11. Form Prepared By

name/title: John Linn Hopkins & Marsha R. Oates

organization: Hopkins & Associates date: October, 1998

street & number: 974 Philadelphia Street telephone: (901) 278-5186

city or town: Memphis state: TN zip code: 38104

Property Owner

name: Multiple

street & number: telephone:

city or town: state: zip code:

United States Department of the Interior
National Park Service

National Register of Historic Places Continuation Sheet

Idlewild Historic District
Memphis, Shelby County, TN

Section number 7 Page 1

NARRATIVE DESCRIPTION

The Idlewild Historic District is a significant, mixed residential and commercial area of approximately 401 principal structures built between ca. 1890 and ca. 1945 in various subdivisions along the principal axis of Peabody Avenue in the area generally referred to as Midtown in Memphis, Shelby County, Tennessee. A large majority of the principal buildings are contributing resources in the district.

The district is composed of eighteen city blocks in an area generally bounded by Rembert Street on the west, Central Avenue on the south, South Cooper Street on the east, and Linden Avenue on the north. The irregular street pattern created a pattern of mixed block shapes and sizes, ranging from simple square blocks to long, rectangular blocks only one lot deep.

The topography of the district is gently rolling, generally rising from its low point along Rembert Street to its highest elevation at Summit Street. The topographic character of the district was shaped, in part, by the swale of Lick Creek, located generally along the Rembert Street corridor. The creek was channeled into a culvert and covered ca. 1905 -10 to permit additional residential development in the district.

Subdivision development overlaid on the topography required many streets to be cut into the slopes of the area. As a result, many of the blocks in the district have low terraces for the setting of residences. Some of these terraces are retained by low masonry walls while others slope gently to the street.

The landscape character of the district is notable for its plantings of mature trees along streets and in yards; there are notable areas of the district where the tree canopy spans the street. Varieties of street and yard trees found in the district include red and white oak, red gum, magnolia, tulip poplar, sycamore, and red maple. Individual yards vary in their landscape character, but many are planted with ornamental shrubs and trees including holly, crepe myrtle, mahonia, red bud, dogwood, and box wood.

The pattern of individual lots within the district varies widely, in part due to the irregular street pattern and in part due to factors of natural topography and other development patterns. In general terms, lots within the district are rectangular in shape with frontages that range from 35' to 150'; lot depths also range widely from 75' to more than 240'. There are exceptions to this pattern, including the block bounded by Rembert, Vinton, Diana and Peabody, where an irregular lot pattern was created by the alignment of Lick Creek through this part of the district.

United States Department of the Interior
National Park Service

National Register of Historic Places Continuation Sheet

Idlewild Historic District
Memphis, Shelby County, TN

Section number 7 Page 2

The development of the district over its period of significance has produced architectural diversity in its residential and commercial character, as might be expected for an area developed over such a long period of time. Like other "edge" developments at the turn of the twentieth century in Memphis, residential house types developed in the district included the shotgun, the double-shotgun, the modified shotgun, the cubical cottage, the L-plan cottage, the composite cottage, and variations of these forms. Architectural styles applied to these structures includes the Italianate and the Queen Anne styles. The setting of these earlier structures often lacks driveway cuts, since the some area's development occurred as a streetcar suburb, prior to the era of the individual automobile.

Following the turn of the century, the area grew with more homogeneity, continuing many of the same house types for the next decade but also adding the diversity of the bungalow, the four-square, the Cape, the English cottage, the double-pile cottage and variations of these forms. Architectural styles applied to these structures included the Queen Anne, the Colonial Revival, the Craftsman, the Tudor Revival and the Minimal Traditional styles. There are reflections of commercial types and styles appropriate to the times reflected in the commercial buildings of the district constructed during this same period.

The structures to be found in the district are described in the following inventory. Structures built during the period of significance which retain their architectural integrity contribute to the district's historical character and are labeled (C). Structures built after the period of significance, or those which have been so altered as to have lost their architectural integrity, do not contribute to the district's character and are labeled (NC).

INVENTORY OF STRUCTURES

CARR AVENUE

01 2035 CARR C One-story, two-bay, frame composite cottage with Colonial Revival influence, built ca. 1905. Gable and hip roof with box cornice, covered with asphalt shingles. Exterior walls covered with weatherboard siding. Windows are 1/1 double-hung sashes. L-plan, hip roof porch, supported by turned posts. Entrance has a replacement slab door, with a single-light transom.

Garage/quarters, ca. 1980. One and one-half story, four-bay, frame, shed and gable roofs, exterior plywood siding, 1/1 double hung metal sashes. (NC)

02 2038 CARR C One-story, three-bay, frame modified shotgun with Queen Anne influences, built ca. 1890. Gable roof with box cornice, covered with asphalt shingles. Exterior walls covered with weatherboard siding. Windows are 2/2 double-hung sashes. Full-width, hip roof porch, supported by turned posts, with a turned spindle balustrade. Entrance has a Queen Anne cottage door, with a single-light transom.

United States Department of the Interior
National Park Service

National Register of Historic Places
Continuation Sheet

Idlewild Historic District
Memphis, Shelby County, TN

Section number 7 Page 3

03 2039 CARR NC One-story, two-bay, frame shotgun with Craftsman influence, built ca. 1910 and significantly altered ca. 1990 with a side addition. Gable and hip roof with box cornice, covered with asphalt shingles. Exterior walls covered with weatherboard siding. Windows are single-light fixed sash replacements. L-plan, shed roof porch, supported by columns. Entrance has a Queen Anne cottage door, with a single-light transom.

04 2040 CARR C One-story, two-bay, frame shotgun with Colonial Revival influence, built ca. 1910. Gable roof with box cornice, covered with asphalt shingles. Exterior walls covered with weatherboard siding. Windows are 1/1 double-hung sashes. Full-width, hip roof porch, supported by turned posts. Entrance has a Colonial Revival cottage door.

05 2042 CARR C One-story, two-bay, frame shotgun with Colonial Revival influence, built ca. 1910. Gable roof with box cornice, covered with asphalt shingles. Exterior walls covered with weatherboard siding. Windows are 1/1 double-hung sashes replacements. Full-width, hip roof porch, supported by turned posts. Entrance has a replacement two-panel, single-light door, with a single-light transom.

06 2044 CARR NC One and one-half story, two-bay, frame shotgun with Colonial Revival influence, built ca. 1905 and significantly altered ca. 1985. Gable roof with box cornice, covered with asphalt shingles; a rear airplane added ca. 1985. Exterior walls covered with diagonal tongue and groove siding. Windows are single-light fixed sashes and 1/1 double-hung sashes. Full-width, hip roof porch, supported by boxed columns. Entrance has a replacement four-panel, four-light door, with a single-light transom.

07 2046 CARR NC One and one-half story, two-bay, frame shotgun with Colonial Revival influence, built ca. 1905 and significantly altered ca. 1990. Gable roof with box cornice, covered with asphalt shingles; rear second story additions built ca. 1990. Exterior walls covered with weatherboard siding and an added brick skirt. Windows are 1/1 double-hung sashes. Full-width, hip roof porch, supported by chamfered piers. Entrance has a replacement two-light, four-panel door, with ghost transom.

08 2047 CARR C One-story, three-bay, frame bungalow with Craftsman influence, built ca. 1905. Hip roof with hip-roofed dormers and exposed rafter tails, covered with asphalt shingles. Exterior walls covered with weatherboard siding. Windows are 9/1 double-hung sashes, some in pairs. Partial-width, undercut porch, supported by boxed columns. Entrance has a six-panel door.

09 2049 CARR C One-story, three-bay, frame bungalow with Craftsman influence, built ca. 1905. Side gable with exposed rafter tails, covered with asphalt shingles. Exterior walls covered with weatherboard siding. Windows are 9/1 double-hung sashes, some in pairs. Full-width, shed roof porch, supported by paired box columns, with a closed weatherboard balustrade. Entrance has a Craftsman cottage door.

10 2052 CARR C One-story, two-bay, frame shotgun with Colonial Revival influence, built ca. 1905. Gable roof with box cornice, covered with asphalt shingles. Exterior walls covered with weatherboard siding. Windows are 6/6 double hung replacements. Full-width, hip roof porch, supported by turned posts, with replacements turned spindle balustrade. Entrance has a single-light, single-panel replacement door, with a single-light transom.

11 2053 CARR C One-story, three-bay, frame cottage with Craftsman influence, built ca. 1915. Hip roof with exposed rafter tails, covered with asphalt shingles. Exterior walls covered with weatherboard siding. Windows are 12/1 double-hung sashes. Partial-width, gable roof porch, supported by turned posts. Entrance has a Colonial Revival cottage door.

United States Department of the Interior
National Park Service

National Register of Historic Places
Continuation Sheet

Idlewild Historic District
Memphis, Shelby County, TN

Section number 7 Page 4

12 2054 CARR **C** One-story, two-bay, frame shotgun with Colonial Revival influence, built ca. 1905. Gable roof with box cornice, covered with asphalt shingles. Exterior walls covered with shiplap siding. Windows are 1/1 double-hung sashes. Full-width, hip roof porch, supported by box columns. Entrance has a single-light replacement door, with a single-light transom.

13 2060 CARR **NC** One-story, two-bay, frame shotgun with Colonial Revival influence, built ca. 1905 and significantly altered ca. 1975. Gable roof with box cornice, covered with asphalt shingles. Exterior walls covered with aluminum siding. Windows are 2/2 metal-frame double-hung sashes in reduced openings. Full-width, hip roof porch, supported by boxed columns. Entrance has a multi-light, multi-panel replacement door.

14 2061 CARR **C** One-story, three-bay, frame composite cottage with Colonial Revival influence, built ca. 1905. Hip and gable roof with box cornice and enclosed gable end, covered with asphalt shingles. Exterior walls covered with weatherboard siding. Windows are 1/1 double-hung sashes. Partial-width, hip roof porch, supported by replacement turned posts, with a block spindle balustrade. Entrance has an oval light replacement door, with a single-light transom.

Garage, ca. 1990. One and one-half story, two-bay, frame, gable roof, weatherboard siding. **(NC)**

15 2063 CARR **C** One-story, three-bay, frame composite cottage with Colonial Revival influence, built ca. 1905. Gable roof with and box cornice, covered with asphalt shingles. Exterior walls covered with weatherboard siding. Windows are 1/1 double-hung sashes. Partial-width, hip roof porch, supported by replacement turned posts. Entrance has a replacement four-light, four-panel door.

Garage/quarters, ca. 1990. One-story, two-bay, frame, hip roof, novelty siding. **(NC)**

16 2064 CARR **C** One-story, two-bay, frame modified shotgun with Colonial Revival influence, built ca. 1905. Gable and hip roof with box cornice, covered with asphalt shingles. Exterior walls covered with weatherboard siding. Windows are 2/2 double-hung sashes. Partial-width, hip roof porch, supported by turned posts. Entrance has an oval light replacement door, with a single-light transom.

17 2065 CARR **C** One-story, two-bay, frame shotgun with Colonial Revival influence, built ca. 1905. Gable roof with box cornice, covered with asphalt shingles. Exterior walls covered with weatherboard siding. Windows are 1/1 double-hung sashes. Full-width, hip roof porch, supported by turned posts, with turned spindle balustrade. Entrance has a multi-light replacement door.

18 2066 CARR **C** One and one-half story, two-bay, frame modified shotgun with Colonial Revival influence, built ca. 1905. Gable and hip roof with box cornice, covered with asphalt shingles. Exterior walls covered with weatherboard siding. Windows are 1/1 double-hung sashes. Partial-width, hip roofed porch, supported by replacement turned posts. Entrance has an oval light replacement door, with a single-light transom.

Garage, ca. 1970. One-story, one-bay, frame, gable roof, weatherboard siding. **(NC)**

19 2067 CARR **C** One-story, two-bay, frame shotgun with Colonial Revival influence, built ca. 1905. Gable roof with box cornice and exposed rafter tails, covered with asphalt shingles. Exterior walls covered with weatherboard siding. Windows are 1/1 double-hung sashes. Full-width, hip roof porch, supported by replacement turned posts. Entrance has a Queen Anne cottage door, with a single-light transom.

United States Department of the Interior
National Park Service

National Register of Historic Places
Continuation Sheet

Idlewild Historic District
Memphis, Shelby County, TN

Section number 7 Page 5

20 2068 CARR C One-story, two-bay, frame shotgun with Colonial Revival influence, built ca. 1910. Gable roof with box cornice, covered with asphalt shingles. Exterior walls covered with weatherboard siding. Windows are 1/1 double-hung sashes. Full-width, hip roof porch, supported by boxed columns, with turned spindle balustrade. Entrance has a two-panel, single-light door, with ghost transom.

21 2069 CARR C One-story, two-bay, frame shotgun with Colonial Revival influence, built ca. 1905. Gable roof with box cornice, covered with asphalt shingles. Exterior walls covered with weatherboard siding. Windows are 1/1 double hung replacements. Full-width, hip roof porch, supported by replacement turned posts. Entrance has a replacement multi-light, multi-panel door and a single-light transom.

22 2070 CARR C One-story, two-bay, frame shotgun with Colonial Revival influence, built ca. 1910. Gable roof with box cornice, covered with asphalt shingles. Exterior walls covered with weatherboard siding. Windows are 1/1 double-hung sashes. Full-width, hip roof porch, supported by boxed columns, with turned spindle balustrade. Entrance has a Queen Anne cottage door, with a covered transom.

23 2071 CARR NC One-story, two-bay, frame shotgun with Colonial Revival influence, built ca. 1905 and significantly altered ca. 1997. Gable roof with box cornice, covered with asphalt shingles. Exterior walls covered with weatherboard siding. Windows are 1/1 double-hung sashes. Full-width, open gable roof porch, supported by turned posts. Entrance has a single-light door, with a single-light transom.

24 2072 CARR C One-story, two-bay, frame shotgun with Colonial Revival influence, built ca. 1905. Gable roof with box cornice, covered with asphalt shingles. Exterior walls covered with weatherboard siding. Windows are 1/1 double-hung sashes. Full-width, undercut porch, supported by replacement columns. Entrance has a replacement eight-panel door, with a single-light transom.

25 2073 CARR C One-story, two-bay, frame shotgun with Colonial Revival influence, built ca. 1905. Gable roof with box cornice, covered with asphalt shingles. Exterior walls covered with weatherboard siding. Windows are 1/1 double-hung sashes. Full-width, undercut porch, supported by turned posts, with turned spindle balustrade. Entrance has a Colonial Revival cottage door, with a single-light transom.

26 2074 CARR C One-story, two-bay, frame shotgun with Craftsman influence, built ca. 1915. Gable roof with exposed rafter tails, covered with asphalt shingles. Exterior walls covered with weatherboard siding. Windows are 1/1 double-hung sashes. Full-width, undercut porch, supported by columns with Doric capitals raised on bases. Entrance has a Colonial Revival cottage door.

27 2075 CARR C One-story, two-bay, frame shotgun with Colonial Revival influence, built ca. 1905. Gable roof with box cornice with enclosed gable end, covered with asphalt shingles. Exterior walls covered with weatherboard siding. Windows are 1/1 double-hung sashes. Full-width, undercut porch, supported by columns with Doric capitals. Entrance has a Colonial Revival cottage door, with a single-light transom.

28 2076 CARR C One-story, two-bay, shotgun with Colonial Revival influence, built ca. 1905. Gable roof with box cornice, covered with asphalt shingles. Exterior walls covered with weatherboard siding. Windows are 1/1 double-hung sashes. Full-width, undercut porch, supported by columns with Doric capitals raised on bases; a side shed porch added ca. 1975. Entrance has a Craftsman cottage door, with a single-light transom.

29 2079 CARR C One-story, three-bay, frame composite cottage with Colonial Revival influence, built ca. 1905. Hip and gable roof with box cornice, covered with asphalt shingles. Exterior walls covered by weatherboard siding. Windows

United States Department of the Interior
National Park Service

National Register of Historic Places
Continuation Sheet

Idlewild Historic District
Memphis, Shelby County, TN

Section number 7 Page 6

are 12/12 double-hung sashes. Partial-width, shed roof porch, supported by columns with Doric capitals. Entrance has a Queen Anne cottage door, with a single-light transom.

30 2080 CARR **NC** One-story, three-bay, frame cottage with Minimal Traditional influence, built ca. 1950. Side gable with box cornice, covered with asphalt shingles. Exterior walls covered by weatherboard siding. Windows are 6/6 double-hung sashes. One-bay wide, gable roof porch, supported by boxed columns. Entrance has a two-light, four-panel door.

31 2085 CARR **C** One-story, three-bay, frame composite cottage with Colonial Revival influence, built ca. 1905. Hip roof with box cornice and enclosed gable end, covered with asphalt shingles. Exterior walls covered by asbestos siding. Windows are 1/1 double-hung sashes. One-bay, undercut porch, supported by wrought iron posts. Entrance has a Colonial Revival cottage door, with a single-light transom.

Garage, ca. 1960. One-story, two-bay, frame, gable roof, novelty siding. **(NC)**

32 2090 CARR **C** One-story, three-bay, frame composite cottage with Colonial Revival influence, built ca. 1905. Hip and gable roof with box cornice, covered with asphalt shingles. Exterior walls covered by aluminum siding. Windows are 1/1 double-hung sashes. Partial-width, hip roof porch, supported by turned posts. Entrance has a multi-panel, multi-light replacement door, with a single-light transom.

33 2093 CARR **NC** One-story, three-bay, frame bungalow with Craftsman influence, built ca. 1910 and significantly altered ca. 1980. Hip roof with box cornice, covered with asphalt shingles. Exterior walls covered by aluminum siding. Windows are 1/1 double-hung sashes. Full-width, hip-roofed porch, supported by wrought iron posts, partially enclosed. Entrance has a multi-light replacement door.

Garage, ca. 1930. One-story, three-bay, frame, hip roof, board and batten siding. **(C)**

34 2094 CARR **NC** One-story, two-bay, frame shotgun with Colonial Revival influence, built ca. 1910 and significantly altered ca. 1985 with side addition. Gable roof with box cornice, covered with asphalt shingles. Exterior walls covered by weatherboard siding. Windows are 1/1 double-hung sashes. Full-width, shed roof porch, supported by turned posts with block spindle valance. Entrance has a relocated single-light door, with a single-light transom.

35 2095 CARR **NC** One-story, two-bay, frame modified shotgun with Colonial Revival influence, built ca. 1905. Gable and hip roof with box cornice and enclosed gable end, covered with asphalt shingles. Exterior walls covered by asbestos siding. Windows are 1/1 double-hung sashes. L-plan, hip roof porch, supported by simple posts. Entrance has a Colonial Revival cottage door, with a single-light transom.

Garage, ca. 1920. One-story, one-bay, frame, gable roof, asbestos siding. **(C)**

36 2096 CARR **NC** One-story, two-bay, frame modified shotgun with Colonial Revival influence, built ca. 1905 and significantly altered in 1970 with side addition. Gable roof with box cornice, covered with asphalt shingles. Exterior walls covered by weatherboard siding. Windows are 1/1 double-hung sashes. L-plan, flat and hip roof porch, supported by box columns raised on bases. Entrance has a Colonial Revival cottage door, with a single-light transom.

37 2102 CARR **C** One-story, three-bay, frame composite cottage with Colonial Revival influence, built ca. 1905. Hip and gable roof with box cornice, covered with asphalt shingles. Exterior walls covered by asbestos shingles. Windows are

United States Department of the Interior
National Park Service

National Register of Historic Places
Continuation Sheet

Idlewild Historic District
Memphis, Shelby County, TN

Section number 7 Page 7

1/1 double-hung sashes, some in pairs. Partial-width, hip roof porch, supported by brick piers. Entrance has a Colonial Revival cottage door, with a ghost transom.

Garage, ca. 1920. One-story, one-bay, frame, gable roof, weatherboard siding. (C)

38 2103 CARR C One-story, three-bay, frame cottage with Colonial Revival influence, built ca. 1905. Hip and gable roof with box cornice, covered with asphalt shingles. Exterior walls covered by vinyl siding. Windows are 1/1 double-hung sashes. Partial-width, shed roof porch, supported by boxed columns raised on bases. Entrance has a replacement slab door.

Garage, ca. 1930. One-story, two-bay, frame, gable roof, asphalt roll siding. (C)

39 2105 CARR C One-story, three-bay, frame composite cottage with Colonial Revival influence, built ca. 1905. Hip and gable roof with box cornice, covered with asphalt shingles. Exterior walls covered by weatherboard siding. Windows are 1/1 double-hung sashes. Partial-width, hip roof porch, supported by columns with Doric capitals. Entrance has a Colonial Revival cottage door, with single-light transom.

40 2107 CARR NC One and one-half story, two-bay, frame bungalow with Craftsman influence, built ca. 1905 and significantly altered ca. 1960 with additions. Gable roof with jerkinhead and box cornice, covered with asphalt shingles. Windows are 1/1 double hung replacements. Partial-width, flat and hip roof porch, supported by stuccoed piers. Entrance has a replacement slab door.

41 2119 CARR NC One-story, three-bay, frame L-plan cottage with Colonial Revival influence, built ca. 1905 and significantly altered ca. 1960. Cross-gable roof with box cornice and enclosed gable end, covered with asphalt shingles. Exterior walls covered by permastone siding. Windows are 1/1 double-hung sashes. Partial-width, shed roof porch, supported by wrought iron posts. Entrance has a replacement slab door, with a single-light transom.

42 2121 CARR C One-story, two-bay, shotgun with Craftsman influence, built ca. 1905. Gable and hip roof with exposed rafter tails, covered with asphalt shingles. Exterior walls covered by asbestos shingles. Windows are 12/1 double-hung sashes. Full-width, undercut porch, supported by wrought iron posts. Entrance has a Colonial Revival cottage door, with a single-light transom.

CENTRAL AVENUE

43 1983 CENTRAL C Two-story, two-bay, brick veneer four-square with Craftsman influence, built ca. 1920. Hip roof with hip-roofed dormers and box cornice, covered with asphalt shingles. Windows are 1/1 double-hung sashes. Partial-width porch and porte cochère covered with a flat and hip roof, supported by brick piers. Entrance has a multi-light door.

Garage, ca. 1970. One-story, two-bay, frame, gable roof, aluminum siding. (NC)

44 1989 CENTRAL C Two-story, two-bay, brick veneer four-square with Craftsman influence, built ca. 1920. Hip roof with hip-roofed dormers and box cornice, covered with asphalt shingles. Windows are 1/1 double-hung sashes. Partial-width porch and porte cochère covered with a flat and hip roof, supported by brick piers, with an open brick balustrade. Entrance has a single-light double door, with a single-light transom.

Garage, ca. 1960. One-story, two-bay, frame, shed roof, weatherboard siding. (NC)

United States Department of the Interior
National Park Service

National Register of Historic Places
Continuation Sheet

Idlewild Historic District
Memphis, Shelby County, TN

Section number 7 Page 8

45 1992 CENTRAL **C** One-story, two-bay, frame bungalow with Craftsman influence, built ca. 1920. Side gable with gable-roofed dormers and exposed rafter tails, covered with asphalt shingles. Exterior walls covered with wood shingles. Windows are Craftsman multi-light/1 double-hung sashes, some in pairs. Partial-width, gable roof porch, supported by stone piers. Entrance has a Craftsman multi-light double door, with 3/4-length, single-light sidelights.

Garage, ca. 1920. One-story, two-bay, frame, hip roof, weatherboard siding. **(C)**

46 1993 CENTRAL **C** Two-story, three-bay, frame four square with Craftsman influence, built ca. 1915. Hip roof with box cornice, covered with asphalt shingles. Exterior walls covered with vinyl siding. Windows are 12/1 double-hung sashes, some in pairs. Partial-width porch and porte cochère covered with a flat and hip roof, supported by boxed columns raised on a weatherboard balustrade. Entrance has a replacement slab door.

47 1997 CENTRAL **C** Two-story, three-bay, stucco veneer four-square with Craftsman influence, built ca. 1920. Hip roof with hip-roofed dormers and box cornice, covered with asphalt shingles. Windows are Craftsman multi-light/1 double-hung sashes, some in pairs. Partial-width, flat roof porch, supported by stuccoed piers with an enclosed stucco balustrade. Entrance has a Craftsman cottage door.

Garage, ca. 1950. One-story, one-bay, frame, hip roof, weatherboard siding. **(NC)**

48 1998 CENTRAL **C** One-story, two-bay, frame bungalow with Craftsman influence, built ca. 1920. Side gable with gable-roofed dormers and exposed rafter tails, covered with asphalt shingles. Exterior walls covered with weatherboard siding. Windows are 1/1 double-hung sashes, some in threes. Partial-width, undercut porch, supported by brick piers. Entrance has a multi-light double door.

49 2001-03 CENTRAL **C** Two-story, five-bay, brick veneer four square with Craftsman influence, built ca. 1920. Hip roof with gable-roofed dormers and box cornice, covered with asphalt shingles. Windows are 9/1 double-hung sashes, some in threes. Two-story, partial-width, hip roof porch, supported by brick piers. Entrances have multi-light doors, with multi-light transoms.

50 2002 CENTRAL **C** One-story, three-bay, brick veneer bungalow with Craftsman influence, built ca. 1915. Gable roof with jerkinhead and box cornice, covered with asphalt shingles. Windows are 1/1 double-hung sashes. Full-width, flat and hip roof porch, supported by brick columns, with an open brick balustrade. Entrance has a six-panel door.

Garage, ca. 1930. One-story, two-bay, frame, gable roof, novelty siding. **(C)**

51 2006 CENTRAL **C** One-story, three-bay, brick veneer bungalow with Craftsman influence, built ca. 1915. Gable roofs with boxed cornice, covered with asphalt shingles. Windows are 1/1 double-hung sashes. Full-width, flat and hip roof porch, supported by cast stone columns with Doric capitals raised on bases, with an open brick balustrade. Entrance has a Craftsman cottage door, with blind sidelights.

Garage, ca. 1920. Two-story, two-bay, frame, gable roof, weatherboard siding, 2/2 double-hung sashes. **(C)**

52 2007 CENTRAL **C** Two-story, three-bay, frame, four-square with Colonial Revival influence, built ca. 1910. Gable and hip roof with hip-roofed dormers and box cornice, covered with asphalt shingles. Exterior walls covered with asbestos siding. Windows are 1/1 double-hung sashes, some in pairs. L-plan, hip roof porch, supported by columns with Scamozzi capitals raised on bases. Entrance has a single-light door, with a single-light transom and 1/2-length, single-light sidelights.

United States Department of the Interior
National Park Service

National Register of Historic Places
Continuation Sheet

Idlewild Historic District
Memphis, Shelby County, TN

Section number 7 Page 9

53 2011 CENTRAL C Two-story, three-bay, frame center hall plan house with Craftsman and Colonial Revival influence, built ca. 1920. Side gable with exposed rafter tails, covered with asphalt shingles. Exterior walls covered with weatherboard siding. Windows are 6/1 double-hung sashes, in pairs and threes. One-bay wide, flat and hip roof porch, supported by paired box columns. Entrance has a single-light door, with 3/4-length, single-light sidelights.

54 2012 CENTRAL C One-story, three-bay, brick veneer bungalow with Craftsman influence, built ca. 1915. Side gable with shed-roofed dormers and exposed rafter tails, covered with asphalt shingles. Windows are 1/1 double-hung sashes, some in pairs. Full-width, undercut porch, supported by brick piers. Entrance has a Craftsman cottage door.

55 2020 CENTRAL C Two-story, three-bay, frame modified four square with Colonial Revival influence, built ca. 1910. Gable and hip roof with hip-roofed dormers and box cornice, covered with asphalt shingles. Exterior walls covered with vinyl siding. Windows are 1/1 double-hung sashes, some in pairs. Full-width, shed roof porch, supported by wrought iron posts. Entrance has a Colonial Revival cottage door, with multi-light transom and 3/4-length, single-light sidelights.

56 2022 CENTRAL NC Two-story, two-bay, brick veneer house with Colonial Revival influence, built ca. 1960. Hip roof with box cornice, covered with asphalt shingles. Windows are multi-light fixed sashes. Two-story, partial-width, shed roof porch, supported by boxed columns and wrought iron posts. Entrance has a multi-light door.

57 2025 CENTRAL C Two and one-half story, three-bay, frame modified four-square with Craftsman and Colonial Revival influences, built ca. 1915. Cross gable roof with jerkinhead and box cornice, covered with asphalt shingles. Exterior walls covered with weatherboard siding. Windows are 1/1 double-hung sashes. Partial-width, hip roof porch, supported by columns with Doric capitals. Entrance has a single-light door, with multi-light transom and 3/4-length, single-light sidelights.

58 2026 CENTRAL C Two-story, two-bay, brick veneer four-square with Colonial Revival influence, built ca. 1915. Hip roof with hip-roofed dormers and box cornice, covered with asphalt shingles. Windows are 1/1 double-hung sashes. Full-width, hip roof porch, supported by brick piers, partially enclosed. Entrance has a Colonial Revival cottage door.

59 2031 CENTRAL C Two-story, two-bay, frame modified four square with Colonial Revival influence, built ca. 1910. Gable roof with plain projecting Entrance, covered with asphalt shingles. Exterior walls covered with weatherboard siding on the first floor, wood shingles on the second. Windows are 1/1 double-hung sashes, some in pairs. Partial-width, hip roof porch, supported by replacement turned posts. Entrance has a multi-light door, with a multi-light transom and full-length, multi-light sidelights.

60 2035-37 CENTRAL NC Two-story, four-bay, frame, four-square with Colonial Revival influence, built ca. 1915 and significantly altered ca. 1970. Hip roof with box cornice, covered with asphalt shingles. Exterior walls covered with added Cherry Valley stone veneer. Windows are 1/1 double-hung sashes. One-bay wide, shed roof porch, enclosed with an arcade of Gothic windows. Entrance has a six-panel door set in a Gothic arched vestibule.

61 2038 CENTRAL C One-story, three-bay, frame composite cottage with Colonial Revival influence, built ca. 1905. Hip and gable roof with shed-roofed dormers and box cornice, covered with asphalt shingles. Exterior walls covered with weatherboard siding. Windows are 1/1 double-hung sashes. L-plan, gable roof porch, supported by paired box columns. Entrance has a six-panel replacement door, with a two-light transom and 3/4-length, single-light sidelights.

62 2041 CENTRAL NC One-story, three-bay, frame bungalow with Craftsman influence, built ca. 1920 and significantly altered ca. 1960. Hip roof with box cornice, covered with asphalt shingles. Exterior walls covered with added brick

United States Department of the Interior
National Park Service

National Register of Historic Places
Continuation Sheet

Idlewild Historic District
Memphis, Shelby County, TN

Section number 7 Page 10

vener. Windows are single-light fixed sashes. Partial-width, gable roof porch, supported by wrought iron posts. Entrance has a replacement slab door.

Garage, ca. 1950. One-story, two-bay, frame, shed roof, weatherboard siding. **(NC)**

63 2042 CENTRAL **C** One-story, three-bay, frame bungalow with Craftsman influence, built ca. 1925. Gable roof with exposed rafter tails, covered with asphalt shingles. Exterior walls covered with weatherboard siding. Windows are 1/1 double-hung sashes. Full-width, flat and hip roof porch, supported by wrought iron posts, with an open brick balustrade. Entrance has a single-light door.

64 2047 CENTRAL **NC** One-story, two-bay, frame bungalow with Craftsman influence, built ca. 1920 and significantly altered ca. 1985. Hip roof with hip-roofed dormers and exposed rafter tails, covered with asphalt shingles. Exterior walls covered with weatherboard siding. Windows are 1/1 double-hung sashes. Porch enclosed. Relocated entrance has a Colonial Revival cottage door.

Garage, ca. 1950. One-story, one-bay, frame, gable roof, novelty siding. **(NC)**

65 2048 CENTRAL **C** One-story, three-bay, frame bungalow with Craftsman influence, built ca. 1925. Hip roof with hip-roofed dormers and exposed rafter tails, covered with asphalt shingles. Exterior walls covered with weatherboard siding. Windows are 1/1 double-hung sashes. Full-width, undercut porch, supported by paired box columns raised on bases, with an open brick balustrade. Entrance has a single-light door.

66 2052 CENTRAL **C** One-story, three-bay, frame bungalow with Craftsman influence, built ca. 1925. Side gable with gable-roofed dormers and exposed rafter tails, covered with asphalt shingles. Exterior walls covered with weatherboard siding. Windows are 1/1 double-hung sashes. Full-width, undercut porch, supported by paired box columns, raised on an open brick balustrade. Entrance has a single-light door.

Garage, ca. 1960. One-story, two-bay, frame, hip roof, exterior plywood siding. **(NC)**

67 2053 CENTRAL **C** One-story, three-bay, frame bungalow with Craftsman influence, built ca. 1920. Hip roof with hip-roofed dormers and exposed rafter tails, covered with asphalt shingles. Exterior walls covered with wood shingle siding. Windows are 1/1 double-hung sashes, some in pairs. Full-width, undercut porch, supported by boxed piers. Entrance has a single-light door, with a single-light transom and 3/4-length, single-light sidelights.

68 2058 CENTRAL **C** One-story, three-bay, frame bungalow with Craftsman influence, built ca. 1920. Gable roof with exposed rafter tails, covered with asphalt shingles. Exterior walls covered with weatherboard siding. Windows are 1/1 double-hung sashes. Full-width, hip roof porch, supported by box columns raised on bases, with an open brick balustrade. Entrance has a single-light door.

Garage, ca. 1950. One-story, two-bay, frame, gable roof, sheet metal siding. **(NC)**

SOUTH COOPER STREET

69 237-39 S. COOPER **C** One-story, six-bay, brick veneer commercial building with Craftsman influence, built ca. 1915. Flat roof behind parapet with stone coping, covered with built-up asphalt roofing. Storefront has single-light display windows with transoms, some covered. Entrances have single-light, metal frame doors with single-light transoms, some covered.

United States Department of the Interior
National Park Service

National Register of Historic Places Continuation Sheet

Idlewild Historic District
Memphis, Shelby County, TN

Section number 7 Page 11

70 243-47 S. COOPER **C** One-story, three-bay, stone veneer commercial building with Colonial Revival influence, built 1912. Flat roof behind parapet with stone coping, covered with built-up asphalt roofing. A shed-roofed metal canopy spans the storefront. Storefront has single-light display windows with paneled bulkheads and single-light transoms, some covered. Entrances have wood-frame single-light doors, with single-light transoms.

71 539 S. COOPER **C** Two-story, six-bay, brick veneer Masonic hall, with Classical Revival influence, built 1941. Flat roof behind parapet with stone coping, covered with built-up asphalt roofing. Exterior walls have engaged monumental Corinthian pilasters that support a flat entablature. Windows are 1/1 double-hung sashes. Entrance beneath a flat suspended metal canopy. Entrance has a single-light double-door.

72 549 S. COOPER **C** One-story, four-bay, brick veneer commercial building with Craftsman influence, built ca. 1915. Flat roof behind parapet with stone coping, covered with built-up asphalt roofing. Storefront has single-light display windows with two-light transom above. Entrance has a metal-frame single-light door, with a covered transom.

73 551-53 S. COOPER **C** One-story, six-bay, brick veneer commercial building with Craftsman influence, built ca. 1920. Flat roof behind parapet with stone coping, covered with built-up asphalt roofing. A pent roof spans the storefronts, supported by console brackets. Storefronts have single-light display windows with ghost transoms. Entrances have single-light metal frame doors, with single-light transoms.

74 567 S. COOPER **NC** One-story, two-bay, porcelain panel veneer former gas station building with Modernist influence, built ca. 1940, and altered significantly ca. 1995. Flat roof behind parapet with metal coping, covered with built-up asphalt roofing. Windows are multi-light display windows. Entrance has a metal-frame single-light double door, with a single-light transom.

75 585 S. COOPER **C** One-story, three-bay, frame L-plan cottage with Colonial Revival influence, built ca. 1905. Gable roof with box cornice, covered with asphalt shingles. Exterior walls covered with weatherboard siding. Windows are 1/1 double-hung sashes. Partial-width, hip roof porch, supported by chamfered wood posts. Entrance has a single-light door, with a single-light transom.

COURTLAND AVENUE

76 1992 COURTLAND **C** Two-story, two-bay, frame four-square with Colonial Revival influence, built ca. 1915. Hip roof with shed-roofed dormers and box cornice, covered with asphalt shingles. Exterior walls covered with weatherboard siding. Windows are 1/1 and 12/1 double-hung sashes. L-plan, hip roof porch, supported by columns with Doric capitals raised on bases. Entrance has a Colonial Revival cottage door, with a multi-light transom and 1/2-length, single-light sidelights.

77 1993 COURTLAND **NC** One and one-half story, three-bay, frame cottage with Colonial Revival influence, built ca. 1990. Side gable with gable-roofed dormers and flush eaves, covered with asphalt shingles. Exterior walls covered with weatherboard siding. Windows are 9/9 double-hung sashes. Full-width, undercut porch, supported by wrought iron posts. Entrance has a Colonial Revival multi-light door, with a multi-light transom.

78 1997 COURTLAND **C** One-story, three-bay, frame composite cottage with Colonial Revival influence, built ca. 1905. Hip and gable roof with box cornice and cornice returns, covered with asphalt shingles. Exterior walls covered with weatherboard siding. Windows are 6/2 double-hung sashes. Partial-width, hip roof porch, supported by turned posts with spindle valance and brackets. Entrance has a Colonial Revival cottage door, with a single-light transom.

United States Department of the Interior
National Park Service

National Register of Historic Places
Continuation Sheet

Idlewild Historic District
Memphis, Shelby County, TN

Section number 7 Page 12

79 1998 COURTLAND **C** Two-story, three-bay, frame four square with Colonial Revival influence, built ca. 1910. Cross-gable roof with box cornice, covered with asphalt shingles. Exterior walls have brick veneer on first floor, stucco veneer on the second. Windows are 1/1 double-hung sashes, some in pairs. L-plan, hip roof porch, supported by columns with Doric capitals raised on bases. Entrance has a single-light door, with multi-light transom and 3/4-length, single-light sidelights.

Garage, ca. 1950. One-story, two-bay, frame, gable roof, asphalt roll siding. **(NC)**

80 2000 COURTLAND **C** Two-story, two-bay, brick veneer four-square with Colonial Revival influence, built ca. 1915. Hip roof with hip-roofed dormers and box cornice, covered with asphalt shingles. Windows are 6/6 double-hung sashes, some in pairs. Full-width, hip roof porch, supported by boxed columns. Entrance has a single-light door, with multi-light transom and 3/4-length, multi-light sidelights.

81 2001 COURTLAND **C** One-story, three-bay, frame composite cottage with Colonial Revival influence, built ca. 1905. Hip and gable roof with gable-roofed dormers and box cornice with enclosed gable end, covered with asphalt shingles. Exterior walls covered with weatherboard siding. Windows are 1/1 double-hung sashes. L-plan, hip roof porch, supported by replacement turned posts with spindle valance. Entrance has a Queen Anne cottage door, with multi-light transom.

82 2005 COURTLAND **C** One-story, three-bay, stucco veneer bungalow with Craftsman influence, built ca. 1915. Gable roof with jerkinhead with shed-roofed dormers and box cornice, covered with asphalt shingles. Windows are 1/1 double-hung sashes. Partial-width, gable and jerkinhead roof porch, supported by stucco piers. Entrance has a Craftsman cottage door.

Shed, ca. 1925. One-story, two-bay, frame, gable roof, weatherboard siding. **(C)**

83 2008 COURTLAND **NC** One-story, four-bay, frame double shotgun with Craftsman influence, built ca. 1905 and altered significantly ca. 1970. Gable roof with box cornice, covered with asphalt shingles. Exterior walls covered with board and batten siding. Windows are 3/2 double-hung sashes, some replaced with single-light fixed sashes. Full-width, flat and hip roof porch, supported by wrought iron posts. Entrances have replacement slab doors.

84 2012 COURTLAND **C** One-story, three-bay, frame modified shotgun with Colonial Revival influence, built ca. 1905. Hip and gable roof with box cornice, covered with asphalt shingles. Exterior walls covered with weatherboard siding. Windows are 2/2 double-hung sashes. L-plan, hip roof porch, supported by turned posts. Entrances have Queen Anne cottage doors, with a single-light transoms.

85 2013 COURTLAND **C** One-story, two-bay, brick veneer bungalow with Craftsman influence, built ca. 1915. Gable roof with shed-roofed dormers and exposed rafter tails, covered with asphalt shingles. Windows are Craftsman multi-light 3/1 double-hung sashes. Partial-width porch and porte cochère covered with a gable roof porch, supported by brick piers, with a closed brick balustrade. Entrance has a Craftsman cottage door, with multi-light transom and 3/4-length, single-light sidelights.

Garage, ca. 1920. One-story, one-bay, frame, gable roof, weatherboard siding. **(C)**

86 2018 COURTLAND **NC** One-story, three-bay, brick veneer cottage with Colonial Revival influence, built ca. 1990. Gable roof with box cornice, covered with asphalt shingles. Windows are 6/6 double-hung sashes. Partial-width porch and porte cochère covered with a porch, supported by boxed columns. Entrance has a Colonial Revival cottage door.

United States Department of the Interior
National Park Service

National Register of Historic Places
Continuation Sheet

Idlewild Historic District
Memphis, Shelby County, TN

Section number 7 Page 13

87 2019 COURTLAND **NC** One-story, two-bay, frame shotgun with Colonial Revival with shotgun influence, built ca. 1910 and altered significantly ca. 1990 with side additions. Gable roof with box cornice, covered with asphalt shingles. Exterior walls covered with weatherboard siding. Windows are 1/1 double-hung sashes. Full-width, hip roof porch, supported by turned posts. Entrance has a Queen Anne cottage door, with a multi-light transom.

88 2020-22 COURTLAND **NC** One-story, three-bay, brick veneer cottage with Minimal Traditional influence, built ca. 1950. Gable roofs with flush eaves, covered with asphalt shingles. Windows are 8/8 double-hung sashes. One-bay wide, projecting shed roof hood. Entrance has a Colonial Revival four-panel, four-light door.

89 2021 COURTLAND **C** One and one-half story, four-bay, frame cottage with Colonial Revival influence, built ca. 1910. Side gable with gable-roofed dormers and box cornice, covered with asphalt shingles. Exterior walls covered with weatherboard siding. Windows are 1/1 double-hung sashes. Full-width, undercut porch, supported by boxed columns, with a block spindle balustrade. Entrances have Queen Anne cottage doors.

90 2027 COURTLAND **C** One-story, two-bay, frame modified composite cottage with Colonial Revival influence, built ca. 1905. Gable roof with box cornice and cornice returns, covered with asphalt shingles. Exterior walls covered with asbestos siding. Windows are 1/1 double-hung sashes. Partial-width, undercut porch, supported by boxed columns. Entrance has a Queen Anne cottage door, with multi-light transom.

91 2028 COURTLAND **NC** One-story, two-bay, brick veneer bungalow with Craftsman influence, built ca. 1920 and altered significantly ca. 1960. Gable roof with exposed rafter tails, covered with asphalt shingles. Exterior walls covered with permastone. Windows are 9/1 double-hung sashes. Full-width, gable, flat and hip roof porch, supported by brick piers, with a closed brick balustrade. Entrance has a six-panel replacement door, with multi-light transom and 3/4-length, multi-light sidelights.

92 2034-36 COURTLAND **NC** One-story, four-bay, frame double shotgun with Colonial Revival influence, built ca. 1925 and significantly altered ca. 1965. Gable roof with box cornice, covered with asphalt shingles. Exterior walls covered with added brick veneer. Windows are 1/1 double-hung sashes. Full-width, undercut porch, supported by columns with Doric capitals. Entrances have slab doors.

Shed, ca. 1925. One-story, one-bay, frame, gable roof, novelty siding. **(NC)**

93 2040 COURTLAND **C** One-story, three-bay, frame bungalow with Craftsman influence, built ca. 1920. Gable roof with exposed rafter tails, covered with asphalt shingles. Exterior walls covered with vinyl siding. Windows are 6/1 double-hung sashes. Partial-width porch and porte cochère covered with a flat and hip roof porch, supported by battered brick piers, with an open brick balustrade. Entrance has a replacement slab door.

94 2044 COURTLAND **C** One-story, two-bay, stucco veneer bungalow with Craftsman influence, built ca. 1915. Hip roof with hip-roofed dormers and exposed rafter tails, covered with asphalt shingles. Windows are 1/1 double-hung sashes. Partial-width, hip roof porch, supported by stone piers, with closed weatherboard balustrade. Entrance has a replacement slab door.

95 2050 COURTLAND **C** One-story, three-bay, frame composite cottage with Colonial Revival influence, built ca. 1910. Gable and hip roof with box cornice, covered with asphalt shingles. Exterior walls covered with weatherboard siding.

United States Department of the Interior
National Park Service

National Register of Historic Places
Continuation Sheet

Idlewild Historic District
Memphis, Shelby County, TN

Section number 7 Page 14

Windows are 1/1 double-hung sashes. L-plan, hip roof porch, supported by iron posts. Entrance has a Queen Anne cottage door, with ghost transom.

96 2060-62 COURTLAND **C** One-story, two-bay, frame composite cottage with Colonial Revival influence, built ca. 1910. Hip and gable roof with box cornice, covered with asphalt shingles. Exterior walls covered with weatherboard siding. Windows are 1/1 double-hung sashes. Full-width, hip roof porch, supported by wrought iron posts. Entrances have replacement slab doors, with multi-light transoms and 3/4-length, single-light sidelights.

97 2064 COURTLAND **C** One-story, two-bay, frame composite cottage with Colonial Revival influence, built ca. 1910. Hip and gable roof with box cornice, covered with asphalt shingles. Exterior walls covered with weatherboard siding. Windows are 1/1 double-hung sashes. Partial width, hip roof porch, supported by wrought iron posts. Entrances have replacement slab doors, with multi-light transoms and 3/4-length, single-light sidelights.

98 2066 COURTLAND **C** One-story, three-bay, frame composite cottage with Colonial Revival influence, built ca. 1910. Hip and gable roof with hip-roofed dormers and box cornice, covered with asphalt shingles. Exterior walls covered with weatherboard siding. Windows are 1/1 double-hung sashes. Partial-width, shed roof porch, supported by columns with Doric capitals. Entrance has a Colonial Revival cottage door, with a single-light transom.

99 2070 COURTLAND **C** One-story, three-bay, frame L-plan cottage with Colonial Revival with influence, built ca. 1905. Gable roofs with box cornice with enclosed gable ends, covered with asphalt shingles. Exterior walls covered with asbestos siding. Windows are 1/1 double-hung sashes. Partial-width, hip roof porch, supported by simple posts. Entrance has a Colonial Revival cottage door, with a single-light transom.

100 2082 COURTLAND **C** One-story, two-bay, frame composite cottage with Colonial Revival influence, built ca. 1900. Hip and gable roof with box cornice with enclosed gable ends, covered with asphalt shingles. Exterior walls covered with weatherboard siding. Windows are 1/1 double-hung sashes. L-plan, hip roof porch, supported by columns with Doric capitals. Entrance has a Queen Anne cottage door, with single-light transom.

Garage, ca. 1920. One-story, one-bay, frame, hip roof, weatherboard siding. **(C)**

101 2087 COURTLAND **NC** One-story, two-bay, frame composite cottage with Colonial Revival influence, built ca. 1905 and substantially altered ca. 1975. Hip and gable roof with box cornice, covered with asphalt shingles. Exterior walls covered with added brick veneer. Windows are 1/1 metal frame replacements. One-bay wide, shed roof porch, supported by wrought iron posts. Entrance has a replacement slab door.

102 2088 COURTLAND **C** One-story, three-bay, frame composite cottage with Colonial Revival influence, built ca. 1905. Hip and gable roof with shed-roofed dormers and box cornice with enclosed gable end, covered with asphalt shingles. Exterior walls covered with weatherboard siding. Windows are 1/1 double-hung sashes. Full-width, porch, supported by columns. Entrance has a Colonial Revival cottage door, with a single-light transom.

103 2090 COURTLAND **NC** One-story, three-bay, stucco veneer bungalow with Craftsman influence, built ca. 1920, and altered significantly ca. 1990. Gable roof with exposed rafter tails, covered with asphalt shingles. Windows are 1-1 fixed metal sashes. Partial-width, gable roof porch, supported by replacement battered brick piers, with a replacement closed brick balustrade. Entrance has a multi-light replacement door.

United States Department of the Interior
National Park Service

National Register of Historic Places
Continuation Sheet

Idlewild Historic District
Memphis, Shelby County, TN

Section number 7 Page 15

Garage, ca. 1990. Two-story, two-bay, frame, gable roof, novelty siding, 4/4 metal sashes. (NC)

104 2091 COURTLAND NC One-story, five-bay, frame cottage with Colonial Revival influence, built ca. 1985. Gable roof with box cornice, covered with asphalt shingles. Exterior walls covered with weatherboard siding. Windows are ten-light fixed sashes. Partial-width, undercut porch, supported by boxed columns. Entrance has a Colonial Revival cottage door.

105 2095 COURTLAND C One-story, three-bay, frame T-plan cottage with Colonial Revival influence, built 1904. Gable roof with box cornice and enclosed gable end, covered with asphalt shingles. Exterior walls covered with vinyl siding. Windows are 1/1 double-hung sashes. Partial-width, shed roof porch, supported by simple posts, raised on bases. Entrance has a six-panel replacement door, with a single-light transom.

106 2096 COURTLAND C One-story, three-bay, frame composite cottage with Colonial Revival influence, built ca. 1895. Gable roof with gable-roofed dormers and plain projecting eaves, covered with asphalt shingles. Exterior walls covered with vinyl siding. Windows are 1/1 double-hung sashes. Partial-width, shed roof porch, supported by box columns. Entrance has a single-light door.

107 2100 COURTLAND C One-story, three-bay, frame L-plan cottage with Colonial Revival influence, built ca. 1900. Gable roof with box cornice with enclosed gable ends, covered with asphalt shingles. Exterior walls covered with vinyl siding. Windows are 1/1 double-hung sashes. Partial-width, shed roof porch, supported by wrought iron posts. Entrance has a single-light door, with a single-light transom.

Garage, ca. 1990. One-story, one-bay, frame, gable roof, vinyl siding. (NC)

108 2101 COURTLAND C three-bay-story, three-bay, frame bungalow with Craftsman influence, built ca. 1905. Gable roof with jerkinhead and exposed rafter tails, covered with asphalt shingles. Exterior walls covered with weatherboard siding. Windows are 1/1 double-hung sashes. Partial-width, undercut porch, supported by boxed columns, partially enclosed. Entrance has a Craftsman cottage door, with a single-light transom.

109 2104 COURTLAND C One-story, three-bay, frame L-plan cottage with Colonial Revival influence, built ca. 1905. Gable roof with box cornice and enclosed gable ends, covered with asphalt shingles. Exterior walls covered with asbestos siding. Windows are 1/1 double-hung sashes. Partial-width, shed roof porch, supported by columns with Doric capitals. Entrance has a replacement multi-light door, with single-light transom.

110 2105 COURTLAND C One-story, two-bay, frame modified composite cottage with Colonial Revival influence, built ca. 1905. Gable and hip roof with box cornice, covered with asphalt shingles. Exterior walls covered with weatherboard siding. Windows are 1/1 double-hung sashes, some in threes. Partial-width, undercut porch, supported by battered boxed columns. Entrance has a replacement six-panel door, with a single-light transom.

111 2110 COURTLAND NC One-story, four-bay, frame double-pile cottage with Colonial Revival influence, built ca. 1905, and substantially altered ca. 1980. Gable roof with box cornice, covered with asphalt shingles. Exterior walls covered with added brick veneer and exterior plywood siding. Windows are 1/1 and 6/6 double-hung sashes. Full-width, hip roof porch, supported by boxed columns, with a spindle balustrade. Entrance has a multi-light replacement door.

United States Department of the Interior
National Park Service

National Register of Historic Places
Continuation Sheet

Idlewild Historic District
Memphis, Shelby County, TN

Section number 7 Page 16

112 2111-13 COURTLAND **NC** One-story, four-bay, brick veneer cottage with Minimal Traditional influence, built ca. 1965. Gable and hip roof with box cornice, covered with asphalt shingles. Windows are 2/2 double-hung sashes. Full-width, porch, supported by wrought iron posts. Entrances have Colonial Revival cottage doors.

COWDEN AVENUE

113 1992 COWDEN **C** Two-story, two-bay, frame four-square with Colonial Revival influence, built ca. 1910. Hip roof with hip-roofed dormers and box cornice, covered with asphalt shingles. Exterior walls covered with weatherboard siding. Windows are 1/1 double-hung sashes, some in pairs. Partial-width, hip roof porch, supported by boxed columns. Entrance contains a Colonial Revival cottage door, with single-light transom and 3/4-length, multi-light sidelights.

Garage/quarters, ca. 1960. One-story, three-bay, frame, hip roof, vinyl siding **(NC)**

114 1993 COWDEN **C** One-story, four-bay, frame bungalow with Craftsman influence, built ca. 1915. Gable roof with plain projecting eaves, covered with asphalt shingles. Exterior walls covered with aluminum siding. Windows are 1/1 double-hung sashes. Partial-width, shed roof porch, supported by stone piers. Entrance contains a multi-light door.

Garage/carport, ca. 1915; altered ca. 1960. One-story, one-bay, frame, gable roof, weatherboard siding. **(NC)**

115 1998 COWDEN **NC** One-story, five-bay, brick veneer cottage with Minimal Traditional influence, built ca. 1950. Gable with flush eaves, covered with asphalt shingles. Windows are 6/6 double-hung sashes. One-bay, undercut porch, supported by boxed columns. Entrance contains a four-panel, two-light door.

Garage, ca. 1950. One-story, one-bay, frame, gable roof, weatherboard siding. **(NC)**

116 2002 COWDEN **C** Two-story, two-bay, frame four-square with Colonial Revival influence, built ca. 1910. Hip roof with hip-roofed dormers and box cornice, covered with asphalt shingles. Exterior walls covered with aluminum siding. Windows are 1/1 double-hung sashes. L-plan, hip roof porch, supported by boxed columns. Entrance contains a Colonial Revival cottage door, with multi-light transom and 3/4-length, multi-light sidelights.

Garage, ca. 1950. One-story, two-bay, frame, shed roof, exterior plywood siding. **(NC)**

117 2003 COWDEN **C** One-story, three-bay, brick veneer bungalow with Craftsman influence, built ca. 1925. Gable roof with exposed rafter tails, covered with asphalt shingles. Windows are 9/1 double-hung sashes, some in pairs. L-plan, gable and hip roof porch, supported by brick piers, with a closed brick balustrade. Entrance contains a Craftsman cottage door, with 1/2-length, single-light sidelights.

Garage, ca. 1960. One-story, two-bay, frame, gable roof, exterior plywood siding. **(NC)**

118 2006 COWDEN **C** One-story, three-bay, frame bungalow with Craftsman influence, built ca. 1910. Hip roof with hip-roofed dormers and exposed rafter tails, covered with asphalt shingles. Exterior walls covered with weatherboard siding. Windows are Craftsman multi-light/1 double-hung sashes. Full-width, undercut porch, supported by boxed columns. Entrance contains a Craftsman cottage door, with a single-light transom and 1/4-length, multi-light sidelights.

United States Department of the Interior
National Park Service

National Register of Historic Places
Continuation Sheet

Idlewild Historic District
Memphis, Shelby County, TN

Section number 7 Page 17

119 2007 COWDEN **C** Two-story, two-bay, frame four-square with Craftsman influence, built ca. 1915. Hip roof with hip-roofed dormers and box cornice, covered with asphalt shingles. Exterior walls covered with weatherboard siding on first floor, wood shingles on the second. Windows are 1/1 double-hung sashes. Full-width, hip roof porch, supported by brick piers. Entrance contains a Colonial Revival cottage door, with multi-light transom and 3/4-length, multi-light sidelights.

Garage, ca. 1960. One-story, one-bay, frame, gable roof, exterior plywood siding. **(NC)**

120 2012 COWDEN **C** One-story, two-bay, stucco veneer bungalow with Craftsman influence, built ca. 1920. Gable roof with exposed rafter tails, covered with asphalt shingles. Windows are Craftsman multi-light casements, some in groups of four. Partial-width, gable roof porch, supported by brick piers, with an open brick balustrade. Entrance contains a Craftsman cottage door, with multi-light transom and 3/4-length, multi-light sidelights.

121 2013 COWDEN **C** One-story, three-bay, brick veneer bungalow with Craftsman influence, built ca. 1925. Gable roofs with exposed rafter tails, covered with asphalt shingles. Windows are 1/1 double-hung sashes. Full-width porch and porte cochère covered with a gable roof, supported by brick piers, with a closed brick balustrade. Entrance contains a four-panel, two-light door.

122 2016 COWDEN **C** One-story, two-bay, frame bungalow with Craftsman influence, built ca. 1915. Hip roof with hip-roofed dormers and exposed rafter tails, covered with asphalt shingles. Exterior walls covered with weatherboard siding. Windows are Craftsman multi-light/1 double-hung sashes. Full-width, undercut porch, supported by paired columns with Doric capitals. Entrance contains a Craftsman cottage door, with 1/4-length, multi-light sidelights.

Garage, ca. 1930. One-story, two-bay, frame, hip roof, shiplap siding. **(C)**

123 2017 COWDEN **C** One-story, two-bay, stucco veneer bungalow with Craftsman influence, built ca. 1915. Gable roof with exposed rafter tails, covered with asphalt shingles. Windows are Craftsman multi-light/1 double-hung sashes, some in fours. Full-width, gable roof porch, supported by stone piers, with a stone balustrade. Entrance contains a single-light door, with multi-light transom and full-length, multi-light sidelights.

Garage, ca. 1950. One-story, one-bay, frame, gable roof, exterior plywood siding. **(NC)**

124 2024 COWDEN **C** One-story, three-bay, frame bungalow with Craftsman influence, built ca. 1915. Hip roof with exposed rafter tails, covered with asphalt shingles. Exterior walls covered with bevel siding. Windows are Craftsman multi-light/1 double-hung sashes, some in pairs. Partial-width, gable roof porch, supported by box columns raised on bases, with a block spindle balustrade. Entrance contains a Craftsman cottage door.

125 2025 COWDEN **C** One and one-half story, three-bay, brick veneer bungalow with Craftsman influence, built ca. 1920. Gable roof with box cornice, covered with asphalt shingles. Windows are 1/1 double-hung sashes. Full-width, undercut porch, supported by boxed columns. Entrance contains a six-panel door.

Garage, ca. 1960. One-story, two-bay, frame, gable roof, aluminum siding. **(NC)**

126 2026 COWDEN **NC** One-story, two-bay, frame bungalow with Craftsman influence, built ca. 1920. Side gable with exposed rafter tails, covered with asphalt shingles. Exterior walls covered with aluminum siding. Windows are 1/1 double-hung sashes. Partial-width, gable roof porch, supported by box piers, partially enclosed. Entrance contains a jalousie door.

United States Department of the Interior
National Park Service

National Register of Historic Places
Continuation Sheet

Idlewild Historic District
Memphis, Shelby County, TN

Section number 7 Page 18

127 029 COWDEN **C** Two-story, two-bay, frame four-square with Colonial Revival influence, built ca. 1915. Hip roof with hip-roofed dormers and box cornice, covered with asphalt shingles. Exterior walls covered with weatherboard siding on the first floor, wood shingles on the second. Windows are 1/1 double-hung sashes. Full-width, hip roof porch, supported by box columns raised on bases. Entrance contains a single-light door, with a multi-light transom and 3/4-length, multi-light sidelights.

128 2032 COWDEN **C** One-story, two-bay, stucco veneer bungalow with Craftsman influence, built ca. 1915. Gable roof with jerkinhead with exposed rafter tails, covered with asphalt shingles. Windows are Craftsman multi-light/1 double-hung sashes. Full-width, flat and hip roof porch, supported by stone piers. Entrance contains a Craftsman cottage door, with a single-light transom and 3/4-length, multi-light sidelights.

129 2033 COWDEN **C** One-story, two-bay, stucco veneer bungalow with Craftsman influence, built ca. 1925. Gable roof with jerkinhead and exposed rafter tails, covered with asphalt shingles. Windows are Craftsman multi-light/1 double-hung sashes. Full-width, gable and jerkinhead roof porch, supported by battered brick piers. Entrance contains a Craftsman cottage door, with multi-light transom and full-length, multi-light sidelights.

Garage, ca. 1925. One-story, one-bay, frame, gable roof, stucco veneer. **(C)**

130 2038 COWDEN **C** One-story, three-bay, stucco veneer bungalow with Craftsman influence, built ca. 1910. Hip roof with hip-roofed dormers and exposed rafter tails, covered with asphalt shingles. Windows are 1/1 double-hung sashes. Partial-width, hip roof porch, supported by paired brick piers. Entrance contains a Craftsman cottage door, with a ghost transom.

131 2039 COWDEN **C** Two-story, two-bay, frame four-square with Colonial Revival influence, built ca. 1915. Hip roof with gable-roofed dormers and box cornice, covered with asphalt shingles. Exterior walls covered with bevel siding on the first floor, weatherboard on the second. Windows are 1/1 double-hung sashes. L-plan, hip roof porch, supported by wrought iron posts. Entrance contains a single-light door, with a single-light transom and 3/4-length, ghost sidelights.

Garage/quarters, ca. 1915. Two-story, three-bay, frame, hip roof, weatherboard siding, 1/1 double-hung sashes. **(C)**

132 2042 COWDEN **C** One-story, two-bay, stucco veneer bungalow with Craftsman influence, built ca. 1910. Side gable with hip-roofed dormers and exposed rafter tails, covered with asphalt shingles. Windows are Craftsman multi-light/1 double-hung sashes, some in threes. Full-width, shed roof porch, supported by stone piers. Entrance contains a single-light door, with multi-light transom and 3/4-length, single-light sidelights.

Garage, ca. 1930. One-story, two-bay, frame, gable roof, board and batten siding. **(C)**

133 2043 COWDEN **C** One-story, two-bay, brick veneer bungalow with Craftsman influence, built ca. 1925. Gable roof with exposed rafter tails, covered with asphalt shingles. Windows are 1/1 double-hung sashes. Full-width porch and porte cochère covered with a flat and hip roof porch, supported by battered brick piers, with a closed brick balustrade. Entrance contains a Craftsman cottage door, with multi-light transom and 1/4-length, multi-light sidelights.

Garage/quarters, ca. 1925. Two-story, one-bay, frame, gable roof, weatherboard siding, 6/6 double-hung sashes. **(C)**

134 2048 COWDEN **C** One-story, two-bay, stucco veneer bungalow with Craftsman influence, built ca. 1910. Hip roof with gable-roofed dormers and exposed rafter tails, covered with asphalt shingles. Windows are Craftsman 9/1 double-hung sashes. Full-width, hip roofed porch, supported by stucco piers. Entrance contains a Craftsman cottage door, with multi-light transom and 3/4-length, multi-light sidelights.

United States Department of the Interior
National Park Service

National Register of Historic Places
Continuation Sheet

Idlewild Historic District
Memphis, Shelby County, TN

Section number 7 Page 19

135 2049 COWDEN **C** Two-story, two-bay, frame four-square with Colonial Revival influence, built ca. 1915. Hip roof with hip-roofed dormers and box cornice, covered with asphalt shingles. Exterior walls covered with weatherboard siding on the first floor, wood shingles on the second. Windows are 1/1 double-hung sashes. Partial-width, hip roof porch, supported by boxed columns. Entrance contains a single light door, with multi-light transom and 3/4-length, single-light sidelights.

Garage/quarters, ca. 1915. Two-story, two-bay, frame, hip roof, weatherboard siding, 1/1 double-hung sashes. **(C)**

136 2052 COWDEN **C** One and one-half story, two-bay, stucco veneer bungalow with Craftsman influence, built ca. 1915. Side gable with gable-roofed dormers and exposed rafter tails, covered with asphalt shingles. Windows are 9/1 double-hung sashes. Full-width, shed roof porch, supported by stuccoed piers, with a closed stucco balustrade. Entrance contains a Craftsman cottage door, with multi-light transom and 3/4-length, single-light sidelights.

137 2055 COWDEN **C** One-story, two-bay, frame bungalow with Craftsman influence, built ca. 1920. Gable roof with box cornice, covered with asphalt shingles. Exterior walls covered with weatherboard siding. Windows are Craftsman 3/1 double-hung sashes. Partial-width, hip roof porch, supported by boxed columns. Entrance contains a Craftsman cottage door, with 1/4-length, multi-light sidelights.

Garage, ca. 1950. One-story, two-bay, frame, gable roof, Masonite siding. **(NC)**

138 2058 COWDEN **C** Two-story, two-bay, frame four-square with Colonial Revival influence, built ca. 1915. Hip roof with hip-roofed dormers and box cornice, covered with asphalt shingles. Exterior walls covered with aluminum siding. Windows are 1/1 double-hung sashes. Partial-width, hip roof porch, supported by columns with Doric capitals. Entrance contains a replacement slab door, with 3/4-length, single-light sidelights.

Garage, ca. 1920. One-story, two-bay, frame, hip roof, weatherboard siding. **(C)**

139 2059 COWDEN **C** One-story, two-bay, frame bungalow with Craftsman influence, built ca. 1915. Hip roof with hip-roofed dormers and box cornice, covered with asphalt shingles. Exterior walls covered with weatherboard siding. Windows are 9/1 double-hung sashes, some in pairs. L-plan, hip roof porch, supported by boxed columns. Entrance contains a single-light door.

140 2065 COWDEN **C** One-story, two-bay, frame composite cottage with Colonial Revival influence, built ca. 1915. Hip and gable roof with hip-roofed dormers and box cornice, covered with asphalt shingles. Exterior walls covered with weatherboard siding. Windows are 1/1 double-hung sashes. Partial-width, gable and undercut porch, supported by paired columns with Doric capitals, raised on bases. Entrance contains a single-light door.

141 2066 COWDEN **C** One-story, four-bay, frame modified composite cottage with Colonial Revival influence, built ca. 1905. Gable and hip roof with box cornice, covered with asphalt shingles. Exterior walls covered with weatherboard siding. Windows are 1/1 double-hung sashes. L-plan, hip roof porch, supported by boxed columns. Entrance contains a multi-light door, with a multi-light transom.

142 2071 COWDEN **C** One and one-half story, three-bay, frame composite cottage with Colonial Revival influence, built ca. 1905. Hip and gable roof with box cornice with enclosed gable ends, covered with asphalt shingles. Exterior walls covered with weatherboard siding. Windows are 1/1 double-hung sashes. L-plan, hip roof porch, supported by box columns raised on bases. Entrance contains a Colonial Revival cottage door, with a single-light transom.

143 2072 COWDEN **C** One-story, three-bay, frame composite cottage with Colonial Revival influence, built ca. 1910. Gable and hip roof with box cornice, covered with asphalt shingles. Exterior walls covered with vinyl siding. Windows are

United States Department of the Interior
National Park Service

National Register of Historic Places
Continuation Sheet

Idlewild Historic District
Memphis, Shelby County, TN

Section number 7 Page 20

1/1 double-hung sashes. L-plan, hip roof porch, supported by replacement columns. Entrance contains a Colonial Revival cottage door.

144 2075 COWDEN C One-story, four-bay, frame composite cottage with Colonial Revival influence, built ca. 1905. Gable and hip roof with box cornice, covered with asphalt shingles. Exterior walls covered with weatherboard siding. Windows are 1/1 double-hung sashes. Full-width, undercut porch, supported by boxed columns. Entrance contains a Colonial Revival cottage door, with multi-light transom and 1/2-length, single-light sidelights.

145 2076 COWDEN C One-story, three-bay, frame composite cottage with Colonial Revival influence, built ca. 1910. Hip and gable roof with box cornice, covered with asphalt shingles. Exterior walls covered with weatherboard siding. Windows are 1/1 double-hung sashes. Partial-width, hip roof porch, supported by boxed columns. Entrance contains a Colonial Revival cottage door, with a single-light transom.

146 2083 COWDEN C One-story, three-bay, frame composite cottage with Colonial Revival influence, built ca. 1915. Hip and gable roof with box cornice, covered with asphalt shingles. Exterior walls covered with weatherboard siding. Windows are 1/1 double-hung sashes. L-plan, gable roof porch, supported by columns with Doric capitals. Entrances contain replacement slab doors.

147 2084 COWDEN C One-story, two-bay, frame composite cottage with Colonial Revival influence, built ca. 1910. Hip and gable roof with box cornice, covered with asphalt shingles. Exterior walls covered with weatherboard siding. Windows are 1/1 double-hung sashes. Partial-width, hip roof porch, supported by replacement turned posts, with turned spindle balustrade. Entrance contains a Colonial Revival cottage door, with a single-light transom and 1/2-length, single-light sidelights.

Garage, ca. 1960. One-story, one-bay, frame, gable roof, weatherboard siding. (NC)

148 2086 COWDEN C One-story, four-bay, frame composite cottage with Colonial Revival influence, built ca. 1900. Gable and hip roof with box cornice, covered with asphalt shingles. Exterior walls covered with weatherboard siding. Windows are 1/1 double-hung sashes. Full-width, undercut porch, supported by boxed columns. Entrance contains a single-light door, with a single-light transom.

149 2087 COWDEN C One-story, two-bay, frame bungalow with Craftsman influence, built ca. 1915. Hip roof with exposed rafter tails, covered with asphalt shingles. Exterior walls covered with weatherboard siding. Windows are Craftsman multi-light 12/01 double-hung sashes, some in threes. Full-width, gable roof porch, supported by weatherboard piers, with closed weatherboard balustrade. Entrance contains a Craftsman cottage door, with 1/2-length, multi-light sidelights.

150 2090 COWDEN C One and one-half story, three-bay, frame bungalow with Craftsman and Colonial Revival influence, built ca. 1915. Gable roof with jerkinhead, shed-roofed dormers and box cornice, covered with asphalt shingles. Exterior walls covered with weatherboard siding. Windows are 1/1 double-hung sashes, some in threes. Full-width, hip roof porch, supported by cast stone columns with Scamozzi capitals. Entrance contains a replacement slab door, with a single-light transom and 3/4-length, single-light sidelights.

151 2091 COWDEN C One and one-half story, two-bay, frame composite cottage with Colonial Revival influence, built ca. 1905. Hip and gable roof with box cornice, covered with asphalt shingles. Exterior walls covered with weatherboard siding. Windows are 1/1 double-hung sashes. L-plan, hip roof porch, supported by boxed columns. Entrance contains a Colonial Revival cottage door, with a single-light transom.

United States Department of the Interior
National Park Service

National Register of Historic Places
Continuation Sheet

Idlewild Historic District
Memphis, Shelby County, TN

Section number 7 Page 21

152 2093-95 COWDEN NC One-story, two-bay, brick veneer ranch house with Minimal Traditional influence, built ca. 1965. Gable and hip roof with box cornice, covered with asphalt shingles. Windows are 2/2 double-hung sashes. Two, one-bay wide, undercut porches, supported by wrought iron posts. Entrances contain six-panel doors.

153 2096 COWDEN C One-story, four-bay, frame composite cottage with Colonial Revival influence, built ca. 1900. Hip and gable roof with box cornice, covered with asphalt shingles. Exterior walls covered with weatherboard siding. Windows are 1/1 double-hung sashes. L-plan, hip roof porch, supported by wrought iron posts. Entrances contain Colonial Revival cottage doors, with single-light transoms.

154 2097 COWDEN C One-story, three-bay, frame composite cottage with Colonial Revival with composite cottage influence, built ca. 1915. Hip and gable roof with box cornice, covered with asphalt shingles. Exterior walls covered with weatherboard siding. Windows are 1/1 double-hung sashes. L-plan, hip roof porch, supported by cast stone columns with Doric capitals raised on bases. Entrance contains a single-light door, with a single-light transom.

155 2098 COWDEN C One and one-half story, three-bay, frame composite cottage with Colonial Revival influence, built ca. 1910. Hip and gable roof with gable-roofed dormers and box cornice with enclosed gable end, covered with asphalt shingles. Exterior walls covered with weatherboard siding. Windows are 1/1 double-hung sashes, some in pairs. L-plan, hip roof porch, supported by cast stone columns with Doric capitals. Entrance contains a Colonial Revival cottage door, with a multi-light transom and 3/4-length, single-light sidelights.

156 2101 COWDEN C One-story, four-bay, frame composite cottage with Colonial Revival influence, built ca. 1915. Hip and gable roof with box cornice, covered with asphalt shingles. Exterior walls covered with weatherboard siding. Windows are 1/1 double-hung sashes. Partial-width, hip roof porch, supported by brick piers, with an open brick balustrade. Entrance contains a single-light door, with a single-light transom.

157 2104 COWDEN C One-story, four-bay, frame composite cottage with Colonial Revival influence, built ca. 1910, and altered with brick veneer ca. 1935. Hip and gable roof with and box cornice, covered with asphalt shingles. Windows are 1/1 double-hung sashes. Partial-width, shed roof porch, supported by cast stone columns with Doric capitals raised on bases. Entrance contains a replacement six-panel door, with a single-light transom.

158 2110 COWDEN C One-story, three-bay, frame composite cottage with Colonial Revival influence, built ca. 1900. Hip and gable roof with shed-roofed dormers with added bay window and box cornice, covered with asphalt shingles. Exterior walls covered with vinyl siding. Windows are 1/1 double-hung sashes. Partial-width, shed roof porch, supported by cast stone columns with Doric capitals. Entrance contains a Colonial Revival cottage door, with a single-light transom.

159 2116 COWDEN C One-story, three-bay, frame double-pile cottage with Colonial Revival influence, built ca. 1910. Gable roof with shed-roofed dormers, box cornice with enclosed gable ends, covered with asphalt shingles. Exterior walls covered with vinyl siding. Windows are 1/1 double-hung sashes. L-plan, hip roof porch, supported by boxed columns. Entrance contains a single-light door, with a single-light transom.

DIANA STREET

160 523 DIANA C One-story, two-bay, frame shotgun with Colonial Revival influence, built ca. 1915. Hip and gable roof with box cornice, covered with asphalt shingles. Exterior walls covered with vinyl siding. Windows are 2/2 double hung metal frame sashes. Full-width, undercut porch, supported by wrought iron posts. Entrance contains a replacement slab door.

United States Department of the Interior
National Park Service

National Register of Historic Places
Continuation Sheet

Idlewild Historic District
Memphis, Shelby County, TN

Section number 7 Page 22

161 527 DIANA **NC** One-story, two-bay, frame shotgun with Colonial Revival influence, built ca. 1905 and significantly altered ca. 1960. Gable roof with box cornice with enclosed gable ends, covered with asphalt shingles. Exterior walls covered with permastone. Windows are 1/1 double-hung sashes. Full-width, hip roof porch, supported by wrought iron posts. Entrance contains a replacement slab door.

162 529 DIANA **C** One-story, two-bay, frame shotgun with Colonial Revival influence, built ca. 1905. Gable roof with box cornice, covered with asphalt shingles. Exterior walls covered with asbestos siding. Windows are 1/1 double-hung sashes. Partial-width, hip roof porch, supported by wrought iron posts. Entrance contains a replacement six-panel door.

163 533 DIANA **NC** One-story, three-bay frame shotgun with Colonial Revival influence, built ca. 1995. Hip roof with box cornice, covered with asphalt shingles. Exterior walls covered with weatherboard siding. Windows are 9/9 double-hung sashes. Full-width, undercut porch supported by box columns. Entrance contains a multi-light door.

Garage, ca. 1995. One-story, one-bay, frame, gable roof, weatherboard siding. **(NC)**

164 537 DIANA **C** One-story, two-bay, frame modified shotgun with Colonial Revival influence, built ca. 1915, and modified with added airplane wing ca. 1930. Gable roof with box cornice and enclosed gable ends, covered with asphalt shingles. Exterior walls covered with vinyl siding. Windows are 1/1 double-hung sashes. Partial-width, undercut porch, supported by replacement columns. Entrance contains a four-light, four-panel door, with single-light transom.

Garage, ca. 1950. One-story, two-bay, frame, hip roof, weatherboard siding. **(NC)**

165 543-47 DIANA **NC** Two-story, two-bay, frame duplex cottage with Victorian Revival influence, built ca. 1985. Gable roof with box cornice, covered with asphalt shingles. Exterior walls covered with weatherboard siding. Windows are 1/1 double-hung sashes. Full-width, hip roof porch, supported by turned posts with brackets. Entrance contains a single-light door, with a single-light transom.

166 559 DIANA **C** One-story, two-bay, frame modified shotgun with Colonial Revival influence, built ca. 1910. Gable roof with box cornice, covered with asphalt shingles. Exterior walls covered with weatherboard siding. Windows are 1/1 double-hung sashes. Full-width, gable roof porch, supported by columns with Doric capitals. Entrance contains a single-light door, with a single-light transom.

FLORENCE STREET

167 212 FLORENCE **C** One and one-half story, two-bay, frame camelback shotgun with Craftsman influence, built ca. 1920, and modified with added airplane ca. 1930. Side gambrel roof with exposed rafter tails, covered with asphalt shingles. Exterior walls covered with weatherboard siding. Windows are Craftsman multi-light/1 double-hung sashes, in pairs and threes. Full-width, hip roof porch, supported by columns with Doric capitals. Entrance contains a single-light door, with 1/2-length, single-light sidelights.

HARBERT AVENUE

168 1992 HARBERT **C** Two-story, three-bay, brick veneer modified four-square with Minimal Traditional influence, built ca. 1930. Hip roof with gable-roofed dormers and box cornice, covered with asphalt shingles. Windows are 6/1 double-hung sashes. Entrance covered with a gabled hood with knee brace brackets, and contains a six-panel door.

United States Department of the Interior
National Park Service

National Register of Historic Places
Continuation Sheet

Idlewild Historic District
Memphis, Shelby County, TN

Section number 7 Page 23

169 1993 HARBERT **C** Two-story, two-bay, frame four-square with Colonial Revival influence, built ca. 1910. Hip roof with hip-roofed dormers and box cornice, covered with asphalt shingles. Exterior walls covered with weatherboard siding. Windows are 1/1 double-hung sashes. Two-story, partial-width, hip roof porch, supported by boxed columns. Entrance contains an oval light replacement doors, one with full-length, single-light sidelights.

170 1996 HARBERT **C** One and one-half story, three-bay, brick veneer cottage with Minimal Traditional influence, built ca. 1935. Side gable with shed-roofed dormers and exposed rafter tails, covered with asphalt shingles. Windows are 6/6 double-hung sashes. Entrance covered by gable hood with knee brace brackets, and contains a six-panel replacement door.

171 1997 HARBERT **C** One-story, two-bay, stucco veneer bungalow with Craftsman influence, built ca. 1915. Hip roof with exposed rafter tails, covered with asphalt shingles. Windows are eight-light casements. Partial-width, gable roof porch, supported by stone piers. Entrance contains a single-light door, with 3/4-length, multi-light sidelights.

Garage, ca. 1920. One-story, one-bay, frame, gable roof, board and batten siding. **(C)**

172 2002 HARBERT **C** One-story, two-bay, frame modified shotgun with Colonial Revival influence, built ca. 1915. Gable roofs with box cornice, covered with asphalt shingles. Exterior walls covered with weatherboard siding. Windows are 1/1 double-hung sashes. L-plan, hip roof porch, supported by columns with Doric capitals. Entrance contains a Colonial Revival cottage door, with a single-light transom.

173 2003 HARBERT **C** One-story, three-bay, frame bungalow with Craftsman influence, built ca. 1915. Side gable with box cornice, covered with asphalt shingles. Exterior walls covered with aluminum siding. Windows are 12/1 double-hung sashes. Full-width, undercut porch, supported by boxed columns. Entrance contains a multi-light door, with 3/4-length, multi-light sidelights.

174 2007 HARBERT **C** One-story, two-bay, brick veneer bungalow with Craftsman influence, built ca. 1925. Gable roof with jerkinhead and exposed rafter tails, covered with asphalt shingles. Windows are 1/1 double-hung sashes. Full-width, flat and hip roof porch, supported by brick piers, with an open brick balustrade. Entrance contains a Craftsman cottage door.

Garage, ca. 1925. One-story, one-bay, frame, gable roof, weatherboard siding. **(C)**

175 2008 HARBERT **NC** One-story, three-bay, frame cottage with Colonial Revival influence, built ca. 1905, altered significantly with Minimal Traditional influence ca. 1970. Side gable with gable-roofed dormers and box cornice, covered with asphalt shingles. Exterior walls covered with Masonite siding. Windows are 1/1 double-hung sashes. Partial-width, shed roof porch, supported by box columns. Entrance contains a multi-light replacement door.

176 2012 HARBERT **C** One-story, three-bay, frame bungalow with Craftsman influence, built ca. 1915. Hip roof with shed-roofed dormers and box cornice, covered with asphalt shingles. Exterior walls covered with aluminum siding. Windows are 9/1 double-hung sashes. Partial-width, hip roof porch, supported by boxed columns. Entrances contain six-panel doors.

177 2015 HARBERT **C** One-story, three-bay, stucco veneer bungalow with Craftsman influence, built ca. 1920. Side gable with gable-roofed dormers and exposed rafter tails, covered with asphalt shingles. Windows are 1/1 double-hung sashes. Partial-width, shed roof porch, supported by brick piers. Entrance contains a Craftsman cottage door.

United States Department of the Interior
National Park Service

National Register of Historic Places
Continuation Sheet

Idlewild Historic District
Memphis, Shelby County, TN

Section number 7 Page 24

Garage, ca. 1920. one-story, two-bay, frame, gable roof, bevel siding. (C)

178 2017 HARBERT C One-story, three-bay, frame composite cottage with Colonial Revival and Craftsman influence, built ca. 1910. Hip and gable roof with box cornice and enclosed gable end, covered with asphalt shingles. Exterior walls covered with asbestos shingles. Windows are 1/1 double-hung sashes. Partial-width, hip roof porch, supported by stone piers. Entrance contains a multi-light door, with a single-light transom.

Garage, ca. 1930. One-story, two-bay, frame, gable roof, bevel siding. (C)

179 2022 HARBERT C One-story, three-bay, brick veneer bungalow with Craftsman influence, built ca. 1925. Gable roof with box cornice, covered with asphalt shingles. Windows are 1/1 double-hung sashes. Full-width, gable, flat and hip roof porch, supported by cast stone columns with Doric capitals raised on bases, with an open brick balustrade. Entrance contains a Craftsman cottage door.

180 2023 HARBERT C One-story, two-bay, stucco veneer bungalow with Craftsman influence, built ca. 1925. Gable and hip roof with box cornice, covered with asphalt shingles. Windows are 1/1 double-hung sashes. Full-width, undercut porch, supported by stone piers, with an open stone balustrade. Entrance contains a Craftsman cottage door, with single-light transom.

Garage, ca. 1930. One-story, two-bay, frame, gable roof, weatherboard siding. (NC)

181 2027 HARBERT C One-story, two-bay, stucco veneer bungalow with Craftsman influence, built ca. 1925. Gable roof with box cornice, covered with asphalt shingles. Windows are 1/1 double-hung sashes. Full-width, undercut porch, supported by stone piers with an open stone balustrade. Entrance contains a Craftsman cottage door, with a single-light transom.

182 2028 HARBERT C One-story, two-bay, frame bungalow with Craftsman influence, built ca. 1915. Side gable with exposed rafter tails, covered with asphalt shingles. Exterior walls covered with vinyl siding. Windows are 1/1 double-hung sashes. Partial-width, gable roof porch, supported by box columns raised on bases with an open stone balustrade. Entrance contains a Craftsman cottage door, with 3/4-length, multi-light sidelights.

183 2032 HARBERT NC One-story, two-bay, frame modified shotgun with Colonial Revival influence, built ca. 1910 and altered significantly in 1985 with a side stucco veneer addition. Hip and gable roof with and box cornice, covered with asphalt shingles. Exterior walls covered with weatherboard siding. Windows are 1/1 double-hung sashes. One-bay, gable roof replacement porch, supported by boxed columns. Entrance contains a six-panel door.

184 2034 HARBERT C One-story, three-bay, brick veneer bungalow with Craftsman influence, built ca. 1925. Gable roof with exposed rafter tails, covered with asphalt shingles. Windows are 1/1 double-hung sashes. Partial-width, gable roof porch, supported by brick piers. Entrance contains a replacement slab door.

Garage, ca. 1950. One-story, two-bay, frame, gable roof, bevel siding. (NC)

185 2035 HARBERT NC One and one-half story, two-bay, frame cottage with Colonial Revival influence, built ca. 1990. Gable roof with box cornice, covered with asphalt shingles.

United States Department of the Interior
National Park ServiceNational Register of Historic Places
Continuation SheetIdlewild Historic District
Memphis, Shelby County, TNSection number 7 Page 25

186 2038 HARBERT **NC** One-story, three-bay, frame composite cottage with Colonial Revival influence, built ca. 1905 and altered in 1975. Gable roof with box cornice, covered with asphalt shingles. Exterior walls covered with vinyl siding. Windows are 2/2 metal sash replacements, set in reduced openings. Partial-width, hip roof porch, supported by columns with Doric capitals. Entrance contains a Craftsman cottage door.

Garage, ca. 1950. One-story, two-bay, frame, gable roof, Masonite siding. **(NC)**

187 2039 HARBERT **C** One-story, two-bay, stucco veneer bungalow with Craftsman influence, built ca. 1925. Side gable with shed-roofed dormers and exposed rafter tails, covered with metal roofing. Windows are Craftsman multi-light/1 double-hung sashes. Partial-width porch and porte cochère covered with a gable roof, supported by stucco piers. Entrance contains a Craftsman cottage door, with multi-light transom and 1/4-length, multi-light sidelights.

188 2042 HARBERT **C** One-story, two-bay, frame composite cottage with Colonial Revival influence, built ca. 1910. Hip roof with box cornice, covered with asphalt shingles. Exterior walls covered with weatherboard siding. Windows are 1/1 double-hung sashes. L-plan, hip roof porch, supported by boxed columns. Entrance contains a replacement slab door, with single-light transom.

189 2045 HARBERT **C** One and one-half story, two-bay, frame, bungalow with Craftsman influence, built ca. 1915. Side gable with shed-roofed dormers and box cornice, covered with asphalt shingles. Exterior walls covered with aluminum siding. Windows are 1/1 double-hung sashes. Full-width, undercut porch, supported by boxed columns. Entrance contains a single-light door, with 3/4-length, single-light sidelights.

190 2048 HARBERT **C** One-story, three-bay, frame bungalow with Craftsman influence, built ca. 1915. Hip roof with hip-roofed dormers and exposed rafter tails, covered with asphalt shingles. Exterior walls covered with bevel siding. Windows are 12/1 and 9/1 double-hung sashes. Full-width, undercut porch, supported by paired box columns. Entrance contains a Craftsman cottage door.

191 2049 HARBERT **C** Two-story, two-bay, frame four-square with Colonial Revival influence, built ca. 1910. Hip roof with hip-roofed dormers and box cornice, covered with asphalt shingles. Exterior walls covered with weatherboard siding. Windows are 1/1 double-hung sashes. Full-width, hip roof porch, supported by columns with Doric capitals. Entrance contains a single-light door, with full-length, single-light sidelights.

Garage, ca. 1915. On-story, one-bay, frame, gable roof, weatherboard siding. **(C)**

192 2050-52 HARBERT **NC** Two-story, four-bay, brick veneer duplex side hall townhouse with Colonial Revival influence, built ca. 1975. Side gable with box cornice, covered with asphalt shingles. Windows are 4/4 double-hung sashes, some in pairs. Partial-width, shed roof porch, supported by columns with Doric capitals. Entrances contain slab doors.

193 2053 HARBERT **C** One-story, three-bay, stucco veneer bungalow with Craftsman influence, built ca. 1915. Hip roof with box cornice, covered with asphalt shingles. Windows are Craftsman 4/1 double-hung sashes. Partial-width, gable roof porch, supported by boxed columns. Entrance contains a craftsman cottage door, with a single-light transom.

194 2054 HARBERT **C** One and one-half story, three-bay, stone and tile veneer English cottage with Craftsman influence, built ca. 1925. Side gable with gable-roofed dormers and exposed rafter tails, covered with asphalt shingles. Windows are Craftsman 3/1 and 4/1 double-hung sashes. Partial-width, undercut porch, supported by stone piers. Entrance contains a semi-circular arched board and batten door.

United States Department of the Interior
National Park Service

National Register of Historic Places
Continuation Sheet

Idlewild Historic District
Memphis, Shelby County, TN

Section number 7 Page 26

195 2056 HARBERT C One-story, three-bay, frame modified shotgun with Colonial Revival cottage influence, built ca. 1910. Gable and hip roof with box cornice, covered with asphalt shingles. Exterior walls covered with weatherboard siding. Windows are 1/1 double-hung sashes. Full-width, undercut porch, supported by wrought iron posts. Entrance contains a two-panel, four-light door.

196 2059 HARBERT C One-story, two-bay, frame bungalow with Craftsman influence, built ca. 1915. Hip roof with shed-roofed dormers and exposed rafter tails, covered with asphalt shingles. Exterior walls covered with weatherboard siding. Windows are Craftsman 3/1 double-hung sashes. Full-width, undercut porch, supported by weatherboard piers, with closed weatherboard balustrade. Entrance contains a Craftsman cottage door, with single-light transom and 1/2-length, multi-light sidelights.

197 2060 HARBERT C One-story, three-bay, brick veneer bungalow with Craftsman influence, built ca. 1925. Gable roof with exposed rafter tails, covered with asphalt shingles. Windows are Craftsman 3/1 double-hung sashes. Partial-width porch and porte cochère covered with gable roofs, supported by battered brick piers raised on bases. Entrance contains a multi-light door, with 3/4-length, multi-light sidelights.

198 2069 HARBERT C Two-story, two-bay, frame four-square with Colonial Revival influence, built ca. 1915. Hip roof with gable-roofed dormers and box cornice, covered with asphalt shingles. Exterior walls covered with weatherboard siding. Windows are 1/1 double-hung sashes. Full-width, gable and hip roof porch, supported by wrought iron posts. Entrance contains a single-light door, with a single-light transom and 3/4-length, single-light sidelights.

199 2070 HARBERT C One-story, four-bay, frame cottage with Colonial Revival influence, built ca. 1915. Side gable with shed-roofed dormers and box cornice, covered with asphalt shingles. Exterior walls covered with weatherboard siding. Windows are 1/1 double-hung sashes. Full-width, shed roof porch, supported by columns with Doric capitals. Entrance contains a Colonial Revival cottage door.

Garage/quarters, ca. 1950, altered ca. 1980. Two-story, three-bay, frame, gable roofs, weatherboard siding, 6/6 double-hung sashes. (NC)

200 2075 HARBERT C Two-story, two-bay, frame four-square with Colonial Revival influence, built ca. 1915. Hip roof with hip-roofed dormers and box cornice, covered with asphalt shingles. Exterior walls covered with vinyl siding. Windows are 1/1 double-hung sashes. Full-width, hip roof porch, supported by columns with Doric capitals. Entrance contains a single-light door, with a single-light transom and full-length, single-light sidelights.

201 2077-79 HARBERT NC One-story, three-bay, brick veneer double-pile cottage with Minimal Traditional influence, built ca. 1965. Side gable with flush eaves, covered with asphalt shingles. Windows are 6/6 double-hung sashes. Partial-width, shed roof porch, supported by wrought iron posts. Entrance contains a two-light, four-panel door.

202 2078 HARBERT C One-story, two-bay, stucco veneer bungalow with Craftsman influence, built ca. 1925. Gable roof with exposed rafter tails, covered with asphalt shingles. Exterior walls covered with weatherboard siding. Windows are Craftsman multi-light/1 double-hung sashes. Full-width porch and porte cochère covered with a gable, flat and hip roof porch, supported by brick piers, with a closed brick balustrade. Entrance contains a Craftsman cottage door, with multi-light transom and 3/4-length, single-light sidelights.

203 2081 HARBERT C One-story, three-bay, frame composite cottage with Colonial Revival influence, built ca. 1905 and altered ca. 1930. Hip and gable roof with box cornice with enclosed gable ends, covered with asphalt shingles.

United States Department of the Interior
National Park Service

National Register of Historic Places
Continuation Sheet

Idlewild Historic District
Memphis, Shelby County, TN

Section number 7 Page 27

Exterior walls covered with weatherboard siding. Windows are 1/1 double-hung sashes. Original porch enclosed; entrance relocated in vestibule with gable hood supported by Doric pilasters, containing a Colonial Revival cottage door.

204 2086-88 HARBERT **NC** One-story, two-bay, brick veneer duplex cottage with Minimal Traditional influence, built ca. 1975. Gable and hip roof with box cornice, covered with asphalt shingles. Windows are 6/6 double-hung sashes. Two, one-bay, undercut porches, supported by wrought iron posts. Entrances contain slab doors.

205 2089 HARBERT **C** One-story, three-bay, frame composite cottage with Colonial Revival influence, built ca. 1905 and altered ca. 1920. Hip and gable roof with box cornice and enclosed gable ends covered with asphalt shingles. Exterior walls covered with weatherboard siding. Windows are 9/1 double-hung sashes, some in pairs. Partial-width, hip roof porch, supported by columns raised on bases. Entrances contain Craftsman cottage doors.

206 2092-94 HARBERT **NC** One-story, two-bay, brick veneer duplex cottage with Minimal Traditional influence, built ca. 1975. Gable and hip roof with box cornice, covered with asphalt shingles. Windows are 6/6 double-hung sashes. Two, one-bay, undercut porches, supported by wrought iron posts. Entrances contain slab doors.

207 2093 HARBERT **C** One and one-half story, two-bay, frame composite cottage with Colonial Revival influence, built ca. 1910. Hip and gable roof with box cornice and enclosed gable ends, covered with asphalt shingles. Exterior walls covered with weatherboard siding. Windows are 1/1 double-hung sashes. L-plan, hip roof porch supported by box columns. Entrance contains a single-light door with a single-light transom.

208 2095 HARBERT **NC** One-story, three-bay, frame modified composite cottage with Colonial Revival influence, built ca. 1905 and altered significantly ca. 1985. Hip and gable roof with box cornice and enclosed gable ends, covered with asphalt shingles. Exterior walls covered with Masonite siding. Windows are 6/6 double hung replacement sashes. Partial-width, hip roof porch, supported by wrought iron posts. Entrance contains a six-panel replacement door, with a single-light transom.

Garage, ca. 1960. One-story, two-bay, frame, gable roof, Masonite siding. **(NC)**

209 2100 HARBERT **C** One and one-half story, two-bay, frame composite cottage with Colonial Revival influence, built ca. 1910. Hip and gable roof with box cornice, covered with asphalt shingles. Exterior walls covered with vinyl siding. Windows are 1/1 double-hung sashes. Partial-width, hip roof porch, supported by box columns raised on bases, with a closed stucco balustrade. Entrance contains a six-panel replacement door, with a single-light transom.

210 2104-06 HARBERT **NC** Two-story, five-bay, brick veneer side hall duplex townhouse with Minimal Traditional influence, built ca. 1970. Side gable with box cornice, covered with asphalt shingles. Windows are 6/6 double-hung sashes. Entrance contains a four-panel, four-light door.

211 2105 HARBERT **NC** One-story, four-bay, brick veneer cottage with Minimal Traditional influence, built ca. 1965. Side gable with flush eaves, covered with asphalt shingles. Windows are 6/6 double-hung sashes. One-bay, undercut porch, supported by wrought iron posts. Entrance contains a six-panel door.

212 2109 HARBERT **NC** One-story, five-bay, frame cottage with Colonial Revival influence, built ca. 1950. Side gable with box cornice, covered with asphalt shingles. Exterior walls covered with aluminum siding. Windows are 1/1 double-hung sashes. Entrance contains a six-panel door.

United States Department of the Interior
National Park Service

National Register of Historic Places
Continuation Sheet

Idlewild Historic District
Memphis, Shelby County, TN

Section number 7 Page 28

213 2110 HARBERT **C** One-story, four-bay, frame composite cottage with Colonial Revival influence, built ca. 1910. Hip and gable roof with box cornice, covered with asphalt shingles. Exterior walls covered with Masonite siding. Windows are 1/1 double-hung sashes. L-plan, hip roof porch, supported by boxed columns. Entrances contain single-light doors.

214 2115 HARBERT **C** One-story, three-bay, frame composite cottage with Colonial Revival influence, built ca. 1905. Gable and hip roof with box cornice, covered with asphalt shingles. Exterior walls covered with Masonite siding. Windows are 1/1 double-hung sashes. L-plan, hip roof porch, supported by columns with Doric capitals. Entrance contains a Craftsman cottage door, with a single-light transom.

Garage, ca. 1960. One-story, one-bay, frame, gable roof, shiplap siding. **(NC)**

HIGBEE AVENUE

215 1992 HIGBEE **C** One-story, three-bay, brick veneer bungalow with Craftsman influence, built ca. 1925. Gable roof with jerkinhead and exposed rafter tails, covered with asphalt shingles. Windows are 1/1 double-hung sashes. Full-width, gable roof porch, supported by battered brick piers, with an open brick balustrade. Entrance contains a multi-light door.

Garage, ca. 1950. One-story, two-bay, frame, gable roof, shiplap siding. **(NC)**

216 1993 HIGBEE **NC** One-story, two-bay, frame cottage with Minimal Traditional influence, built ca. 1970. Hip roof with box cornice, covered with asphalt shingles. Windows are 8/8 double-hung sashes. One-bay, undercut porch, supported by boxed columns. Entrance contains a six-panel door.

217 1996 HIGBEE **C** One-story, two-bay, frame bungalow with Craftsman influence, built ca. 1925. Gable roof with exposed rafter tails, covered with asphalt shingles. Exterior walls covered with weatherboard siding. Windows are Craftsman multi-light/1 double-hung sashes. L-plan, gable roof porch, supported by cast stone columns with Doric capitals. Entrance contains a Craftsman cottage door, with full-length, glass block sidelights.

Garage, ca. 1925. One-story, two-bay, frame, gable roof, shiplap siding. **(C)**

218 1997 HIGBEE **C** Two-story, four-bay, frame four-square with Colonial Revival influence, built ca. 1915. Hip roof with hip-roofed dormers and box cornice, covered with asphalt shingles. Exterior walls covered with weatherboard siding. Windows are 1/1 double-hung sashes. Full-width, hip roof porch, supported by wrought iron posts. Entrance contains a Colonial Revival cottage door.

Garage, ca. 1925. One-story, one-bay, frame, gable roof, shiplap siding. **(C)**

219 2002 HIGBEE **C** One-story, two-bay, stucco veneer bungalow with Craftsman influence, built ca. 1925. Side gable roof with shed-roofed dormers and exposed rafter tails, covered with asphalt shingles. Windows are 9/1 double-hung sashes. One-bay, undercut porch, supported by brick piers. Entrance contains a Craftsman cottage door, with a multi-light transom.

Garage, ca. 1925. One-story, one-bay, frame, gable roof, shiplap siding. **(C)**

220 2006 HIGBEE **C** One-story, four-bay, stucco veneer bungalow with Craftsman influence, built ca. 1925. Gable roof with jerkinhead and exposed rafter tails, covered with asphalt shingles. Exterior walls covered with weatherboard siding. Windows are 1/1 double-hung sashes. Full-width, gable and jerkinhead roof porch, supported by stucco piers, with a

United States Department of the Interior
National Park Service

National Register of Historic Places
Continuation Sheet

Idlewild Historic District
Memphis, Shelby County, TN

Section number 7 Page 29

closed stucco balustrade. Entrance contains Craftsman cottage door, with a single-light transom and 1/1 double-hung sashes sidelights.

221 2007 HIGBEE **C** Two-story, two-bay, frame four-square with Colonial Revival influence, built ca. 1915. Hip roof with hip-roofed dormers and box cornice, covered with asphalt shingles. Exterior walls covered with weatherboard siding on first floor, wood shingles on second. Windows are 1/1 double-hung sashes. Partial-width, hip roof porch, supported by box columns raised on bases. Entrance contains a six-panel replacement door.

222 2008 HIGBEE **C** One-story, two-bay, stucco veneer bungalow with Craftsman influence, built ca. 1920. Gable and hip roof with hip-roofed dormers and exposed rafter tails, covered with asphalt shingles. Windows are 6/1 double-hung sashes. Partial-width, gable roof porch, supported by paired columns with Doric capitals, raised on bases. Entrance contains a Craftsman cottage door, with a multi-light transom and full-length, multi-light sidelights.

Garage, ca. 1960. One-story, two-bay, frame, gable roof, weatherboard siding. **(NC)**

223 2012 HIGBEE **C** One-story, three-bay, brick veneer bungalow with Craftsman influence, built ca. 1920. Side gable roof with exposed rafter tails, covered with asphalt shingles. Windows are Craftsman multi-light/1 double-hung sashes. Partial-width, gable roof porch, supported by battered brick piers, with a closed brick balustrade. Entrance contains a Craftsman cottage door, with single-light transom.

224 2013 HIGBEE **C** One-story, three-bay, brick veneer bungalow with Craftsman influence, built ca. 1925. Hip roof with exposed rafter tails, covered with asphalt shingles. Windows are Craftsman 4/1 double-hung sashes, some in pairs. Partial-width, hip roof porch, supported by brick piers, with a closed brick balustrade. Entrance contains a multi-light door.

225 2014 HIGBEE **NC** One-story, three-bay, stone veneer double-pile cottage with influence, built ca. 1950. Side gable roof with box cornice, covered with asphalt shingles. Windows are 6/6 double-hung sashes. Projecting gable roof hood covers entrance. Entrance contains a Colonial Revival cottage door.

226 2016 HIGBEE **C** One-story, two-bay, brick veneer bungalow with Craftsman influence, built ca. 1920. Gable roof with jerkinhead and exposed rafter tails, covered with asphalt shingles. Windows are Craftsman multi-light/1 double-hung sashes, some in pairs. Full-width, flat and hip roof porch, supported by brick piers, with an open brick balustrade. Entrance contains a Craftsman cottage door, with a multi-light transom and 1/4-length, multi-light sidelights.

Garage, ca. 1950. One-story, two-bay, frame gable roof, bevel siding. **(NC)**

227 2017 HIGBEE **C** One and one-half story, three-bay, stucco veneer bungalow with Craftsman influence, built ca. 1925. Hip roof with exposed rafter tails, covered with asphalt shingles. Windows are Craftsman 4/1 double-hung sashes, some in threes. Partial-width, gable roof porch, supported by battered brick piers, with a closed brick balustrade. Entrance contains a Craftsman cottage door.

228 2022 HIGBEE **C** One-story, three-bay, brick veneer bungalow with Craftsman influence, built ca. 1920. Hip roof with hip dormer and exposed rafter tails, covered with asphalt shingles. Windows are Craftsman multi-light/1 double-hung sashes, some in pairs. Full-width, gable roof porch, supported by battered stone piers, with an open brick balustrade. Entrance contains a Craftsman cottage door, with single-light transom.

Garage, ca. 1970. One-story, two-bay, frame, gable roof, exterior plywood siding. **(NC)**

United States Department of the Interior
National Park Service

National Register of Historic Places
Continuation Sheet

Idlewild Historic District
Memphis, Shelby County, TN

Section number 7 Page 30

229 2023 HIGBEE **C** One-story, three-bay, stucco veneer bungalow with Craftsman and Colonial Revival influences, built ca. 1925. Hip roof with exposed rafter tails, covered with asphalt shingles. Windows are 1/1 double-hung sashes. Partial-width, gable roof porch, supported by cast stone columns with Scamozzi capitals, raised on bases. Entrance contains a Craftsman cottage door, with single-light transom.

230 2027 HIGBEE **C** One-story, three-bay, stucco veneer bungalow with Craftsman influence, built ca. 1925. Side gable roof with shed-roofed dormers and exposed rafter tails, covered with asphalt shingles. Windows are 1/1 double-hung sashes. Full-width, shed roof porch, supported by battered piers raised on bases, with an open brick balustrade. Entrance contains a single-light door.

231 2036-38 HIGBEE **C** One-story, two-bay, brick veneer bungalow with Craftsman influence, built ca. 1925. Gable roof with exposed rafter tails, covered with asphalt shingles. Windows are 6/1 double-hung sashes. Partial-width, shed roof porches, supported by brick piers. Entrances contain Colonial Revival cottage doors.

Garage, ca. 1950. One-story, one-bay, frame, gable roof, weatherboard siding. **(NC)**

232 2037 HIGBEE **C** Two-story, two-bay, frame four-square with Colonial Revival influence, built ca. 1915. Hip roof with gable-roofed dormers and box cornice, covered with asphalt shingles. Exterior walls covered with weatherboard siding. Windows are 1/1 double-hung sashes. L-plan, hip roof porch, supported by boxed columns, with a block spindle balustrade. Entrance contains a four-panel, two-light door, with single-light transom and 3/4-length, single-light sidelights.

Garage, ca. 1960. One-story, two-bay, frame, gable roof, weatherboard siding. **(NC)**

233 2040 HIGBEE **C** One and one-half story, two-bay, brick veneer duplex airplane bungalow with Craftsman influence, built ca. 1925. Gable roof with jerkinhead and exposed rafter tails, covered with asphalt shingles. Windows are 1/1 double-hung sashes. Full-width, gable with jerkinhead, flat and hip roof porch, supported by brick piers, with a closed brick balustrade. Entrances contain replacement slab doors, with full-length, blind sidelights.

Garage, ca. 1950. One-story, two-bay, frame, gable roof, aluminum siding. **(NC)**

234 2043 HIGBEE **C** Two-story, two-bay, frame four-square with Colonial Revival influence, built ca. 1915. Hip roof with hip-roofed dormers and box cornice, covered with asphalt shingles. Exterior walls covered with vinyl siding. Windows are 1/1 double-hung sashes. Partial-width, hip roof porch, supported by boxed columns. Entrance contains a single-light door, with single-light transom and 3/4-length, single-light sidelights.

Garage, ca. 1920. One-story, two-bay, frame, hip roof, weatherboard siding. **(C)**

235 2047 HIGBEE **C** One-story, three-bay, frame bungalow with Craftsman influence, built ca. 1915. Hip roof with hip-roofed dormers and box cornice, covered with asphalt shingles. Exterior walls covered with vinyl siding. Windows are 1/1 double-hung sashes. Full-width, undercut porch, supported by boxed columns on battered brick bases, with a closed brick balustrade. Entrance contains a single-light door.

236 2048 HIGBEE **C** One and one-half story, two-bay, brick veneer bungalow with Craftsman influence, built ca. 1925. Gable and hip roof with exposed rafter tails, covered with asphalt shingles. Windows are 1/1 double-hung sashes. Full-width, gable and hip roof porch, supported by brick piers, with a closed brick balustrade. Entrances contain replacement slab doors, with full-length, single-light sidelights.

United States Department of the Interior
National Park Service

National Register of Historic Places
Continuation Sheet

Idlewild Historic District
Memphis, Shelby County, TN

Section number 7 Page 31

Garage/quarters, ca. 1950. Two-story, two-bay, frame, gable roof, shiplap siding. **(NC)**

237 2054 HIGBEE **C** One-story, three-bay, frame bungalow with Craftsman influence, built ca. 1920. Hip roof with hip-roofed dormers and exposed rafter tails, covered with asphalt shingles. Exterior walls covered with weatherboard siding. Windows are 1/1 double-hung sashes. Partial-width, hip roof porch, supported by cast stone columns with Ionic capitals. Entrance contains a replacement six-panel door.

238 2058 HIGBEE **C** One-story, two-bay, frame bungalow with Craftsman influence, built ca. 1915. Hip roof with gable-roofed dormers and exposed rafter tails, covered with asphalt shingles. Exterior walls covered with weatherboard siding. Windows are Craftsman multi-light/1 double-hung sashes. Full-width, undercut porch, supported by paired box columns. Entrance contains a single-light door, with multi-light transom and 3/4-length, single-light sidelights.

Garage, ca. 1990. One-story, two-bay, frame, gable roof, exterior plywood siding. **(NC)**

239 2068 HIGBEE **C** One-story, two-bay, frame composite cottage with Colonial Revival influence, built ca. 1910. Hip and gable roof with gable-roofed dormers and box cornice, covered with asphalt shingles. Exterior walls covered with weatherboard siding. Windows are 1/1 double-hung sashes. Partial-width, gable roof porch, supported by battered brick piers. Entrance contains a single-light door, with single-light transom and 3/4-length, single-light sidelights.

240 2076 HIGBEE **C** One and one-half story, three-bay, frame modified four-square with Colonial Revival influence, built ca. 1915. Hip roof with exposed rafter tails, covered with asphalt shingles. Exterior walls covered with vinyl siding. Windows are 1/1 double-hung sashes. Full-width, hip roof porch, supported by wrought iron posts. Entrance contains a replacement slab door, with ghost transom.

Shed, ca. 1950. One-story, two-bay, frame, hip roof, shiplap siding. **(NC)**

241 2078 HIGBEE **C** One-story, three-bay, stucco veneer bungalow with Craftsman influence, built ca. 1915. Hip roof with plain projecting eaves, covered with asphalt shingles. Exterior walls have a weatherboard wainscot. Windows are 1/1 double-hung sashes. Partial-width, gable roof porch, supported by stucco piers. Entrance contains a Craftsman cottage door.

242 2084 HIGBEE **NC** One-story, four-bay, frame modified shotgun with Colonial Revival influence, built ca. 1900 and significantly altered ca. 1980. Gable and hip roof with box cornice, covered with asphalt shingles. Exterior walls covered with vinyl siding. Windows are 1/1 double-hung sashes. Full-width, gable roof porch, enclosed with 1-1 metal frame sliding sashes. Entrance contains a replacement single-light door.

243 2090 HIGBEE **NC** One-story, four-bay, frame modified shotgun with Colonial Revival influence, built ca. 1915 and significantly altered ca. 1980. Hip roof with hip-roofed dormers and box cornice, covered with asphalt shingles. Exterior walls covered with weatherboard siding. Windows are replacement six-light fixed sashes. Porch removed. Entrance contains a replacement four-panel door.

244 2094 HIGBEE **NC** One-story, two-bay, frame double-pile cottage with Victorian Revival influence, built ca. 1905 and significantly altered ca. 1990. Gable roof with box cornice with enclosed gable end, covered with asphalt shingles. Exterior walls covered with vinyl siding. Windows are 1/1 double-hung sashes. Partial-width, gable roof porch, supported

United States Department of the Interior
National Park Service

National Register of Historic Places
Continuation Sheet

Idlewild Historic District
Memphis, Shelby County, TN

Section number 7 Page 32

by replacement turned posts with spindle valance and brackets, and with turned spindle balustrade. Entrance contains a Queen Anne cottage door, with single-light transom.

Garage, ca. 1930. One-story, one-bay, frame, gable roof, weatherboard siding. (C)

245 2098 HIGBEE C One-story, three-bay, frame bungalow with Craftsman influence, built ca. 1915. Side gable roof with exposed rafter tails, covered with asphalt shingles. Exterior walls covered with asbestos shingles. Windows are Craftsman multi-light/01 double-hung sashes, some in threes. Full-width, shed and gable roof porch, supported by brick piers raised on an open brick balustrade. Entrance contains a Craftsman cottage door.

Shed, ca. 1950. One-story, one-bay, frame, gable roof, bevel siding. (NC)

246 2100 HIGBEE C One-story, three-bay, frame composite cottage with Colonial Revival influence, built ca. 1905. Gable and hip roof with box cornice with enclosed gable end, covered with asphalt shingles. Exterior walls covered with vinyl siding. Windows are 1/1 double-hung sashes. Partial-width, hip roof porch, supported by wrought iron posts. Entrance contains a Craftsman cottage door.

247 2106 HIGBEE C One-story, three-bay, frame L-plan cottage with Craftsman influence, built ca. 1910. Gable roof with box cornice, covered with asphalt shingles. Exterior walls covered with weatherboard siding. Windows are 1/1 double-hung sashes. Partial-width, hip roof porch, supported by battered brick piers, with an open brick balustrade. Entrance contains a Craftsman cottage door.

248 2110 HIGBEE C One and one-half story, three-bay, frame bungalow with Craftsman influence, built ca. 1905. Gable and hip roof with jerkinhead, shed-roofed dormers and box cornice, covered with asphalt shingles. Exterior walls covered with weatherboard siding. Windows are 1/1 double-hung sashes. Full-width, undercut porch, supported by battered piers raised on bases, with an open brick balustrade. Entrance contains a Craftsman cottage door, with single-light transom.

249 2118-20 HIGBEE NC One and one-half story, five-bay, brick veneer bungalow with Craftsman influence, built ca. 1925 and significantly altered ca. 1990. Side gable roof with exposed rafter tails, covered with asphalt shingles. Windows are 1/1 double-hung sashes. Partial-width, undercut porch, supported by brick piers, with a closed brick balustrade, enclosed with 1/1 double hung metal frame sashes, in pairs. Entrance contains a replacement slab door, with 1/4-length, multi-light sidelights.

LINDEN AVENUE

250 1992 LINDEN C One-story, three-bay, brick veneer airplane bungalow with Craftsman influence, built ca. 1920. Gable roof with exposed rafter tails, covered with asphalt shingles. Windows are 1/1 double-hung sashes. Full-width, undercut porch, supported by brick piers, with a closed brick balustrade. Entrance contains a single-light door, with a single-light transom.

251 1993 LINDEN NC One-story, five-bay, frame cottage with Colonial Revival influence, built ca. 1990. Hip roof with box cornice, covered with asphalt shingles. Exterior walls covered with weatherboard siding. Windows are 6/6 double-hung sashes with three-light transoms. Full-width, undercut porch, supported by box columns. Entrance contains a multi-panel door.

United States Department of the Interior
National Park Service

National Register of Historic Places
Continuation Sheet

Idlewild Historic District
Memphis, Shelby County, TN

Section number 7 Page 33

252 1996 LINDEN C One-story, two-bay, brick veneer airplane bungalow with Craftsman influence, built ca. 1920. Gable roof with jerkinhead and box cornice, covered with asphalt shingles. Windows are 1/1 double-hung sashes. Full-width, flat and hip roof porch, supported by battered piers raised on bases, with a closed brick balustrade, partially enclosed. Entrance contains a Craftsman cottage door.

Garage, ca. 1920. One and one-half story, two-bay, frame, gable roof vinyl siding. (NC)

253 1999 LINDEN C Two-story, two-bay, frame modified four-square with Colonial Revival influence, built ca. 1910. Cross gable roof with box cornice, covered with asphalt shingles. Exterior walls covered with vinyl siding. Windows are 1/1 double-hung sashes. Full-width, undercut porch, supported by cast stone piers. Entrance contains a single-light door.

254 2001 LINDEN C Two-story, two-bay, frame modified four-square with Colonial Revival influence, built ca. 1910. Gable roof with shed dormers and box cornice, covered with asphalt shingles. Exterior walls covered with weatherboard siding. Windows are 1/1 double-hung sashes, some in pairs. Partial-width, hip roof porch, supported by columns with Doric capitals. Entrance contains single-light, with single-light transom.

255 2002 LINDEN C One and one-half story, two-bay, frame modified composite cottage with Colonial Revival influence, built ca. 1910. Cross-gable roof with box cornice, covered with asphalt shingles. Exterior walls covered with weatherboard siding. Windows are 1/1 double-hung sashes. L-plan, hip roof porch, supported by columns with Doric capitals, with a turned spindle balustrade. Entrance contains multi-light door, with single-light transom and a side, multi-light double door.

256 2008 LINDEN C One-story, two-bay, frame composite cottage type with Queen Anne Revival influence, built ca. 1890. Gable and hip roof with plain projecting eaves, covered with standing seam metal roof. Exterior walls covered with weatherboard siding. Windows are 1/1 double-hung sashes. Full-width, hip roof porch, supported by turned posts with spindle valance and brackets. Entrance contains a Queen Anne cottage door, with single-light transom and 3/4-length, single-light sidelights.

257 2009 LINDEN C One-story, two-bay, frame composite cottage with Colonial Revival influence, built ca. 1905. Hip and gable roof with box cornice, covered with asphalt shingles. Exterior walls covered with aluminum siding. Windows are 6/6 and 4/4 double-hung sashes. Partial-width, hip roof porch, supported by boxed columns with added spindle valance and brackets. Entrance contains a Colonial Revival cottage door, with single-light transom.

Garage, ca. 1980. One-story, two-bay, frame, hip roof, aluminum siding. (NC)

258 2010 LINDEN C One-story, three-bay, frame composite cottage with Colonial Revival influence, built ca. 1910. Hip and gable roof with box cornice, covered with asphalt shingles. Exterior walls covered with weatherboard siding. Windows are 1/1 double-hung sashes. L-plan, hip roof porch, supported by columns with Doric capitals. Entrance contains a replacement slab door, with multi-light transom and 3/4-length, single-light sidelights.

259 2015 LINDEN C One-story, four-bay, frame composite cottage with Colonial Revival influence, built ca. 1910. Hip and gable roof with box cornice, covered with asphalt shingles. Exterior walls covered with weatherboard siding. Windows are 1/1 double-hung sashes. L-plan, hip roof porch, supported by columns with Doric capitals. Entrance contains a single-light door, with a single-light transom.

Garage, ca. 1930. One-story, one-bay, frame, hip roof, weatherboard siding. (C)

United States Department of the Interior
National Park Service

National Register of Historic Places
Continuation Sheet

Idlewild Historic District
Memphis, Shelby County, TN

Section number 7 Page 34

260 2017 LINDEN NC One-story, three-bay, frame double-shotgun with Colonial Revival influence, built ca. 1905 and significantly altered ca. 1975. Hip roof with box cornice, covered with asphalt shingles. Exterior walls covered with aluminum siding. Windows are 2/2 double hung metal frame replacement sashes. Partial-width, undercut porch, supported by replacement turned posts, partially enclosed. Entrance contains a replacement six-panel door.

261 2018 LINDEN NC One-story, three-bay, frame composite cottage with Colonial Revival influence, built ca. 1905 and significantly altered ca. 1955. Gable and hip roof with box cornice, covered with asphalt shingles. Exterior walls covered with asbestos shingles. Windows are 6/1 double-hung sashes. Original porch removed and replaced with one-bay, gable roof porch, supported by wrought iron posts. Entrance contains a multi-light door.

262 2022 LINDEN NC Two-story, three-bay, frame modified four square with Craftsman influence, built ca. 1915 and significantly altered ca. 1960. Gable roof with exposed rafter tails, covered with asphalt shingles. Exterior walls covered with added brick veneer. Windows are 1/1 double-hung sashes. L-plan, hip roof porch, supported by brick piers, with a closed brick balustrade. Entrance contains a Craftsman cottage door, with single-light transom and full-length, single-light sidelights.

263 2023 LINDEN C One-story, two-bay, frame composite cottage with Colonial Revival influence, built ca. 1905. Hip and gable roof with box cornice, covered with asphalt shingles. Exterior walls covered with weatherboard siding. Windows are 1/1 double-hung sashes. L-plan, hip roof porch, supported by boxed columns. Entrance contains a Craftsman multi-light door.

Garage, ca. 1990. One-story, two-bay, frame, gable roof, bevel siding. (NC)

264 2026 LINDEN C One-story, two-bay, frame composite cottage with Colonial Revival influence, built ca. 1910. Hip and gable roof with box cornice, covered with asphalt shingles. Exterior walls covered with weatherboard siding. Windows are 1/1 double-hung sashes. L-plan, hip roof porch, supported by columns with Doric capitals. Entrance contains a replacement six-panel door, with a multi-light transom and 3/4-length, two-light sidelights.

265 2027 LINDEN C One-story, three-bay, frame (L-plan cottage with Colonial Revival influence, built ca. 1905. Gable roof with box cornice, covered with asphalt shingles. Exterior walls covered with weatherboard siding. Windows are 2/2 double-hung sashes. Partial-width, hip roof porch, supported by cast stone columns with Doric capitals, raised on bases. Entrance contains a four-panel door, with single-light transom.

Garage/carport, ca. 1980. One-story, two-bay, frame, undercut gable roof, weatherboard siding, box columns. (NC)

266 2030 LINDEN C One-story, three-bay, frame composite cottage with Colonial Revival influence, built ca. 1910. Hip and gable roof with box cornice and enclosed gable end, covered with asphalt shingles. Exterior walls covered with weatherboard siding. Windows are 1/1 double-hung sashes. L-plan, hip roof porch, supported by columns with Doric capitals raised on bases, with a closed brick balustrade. Entrance contains a Colonial revival cottage door, with a multi-light transom and 3/4-length, two-light sidelights.

267 2033 LINDEN C Two-story, two-bay, cast stone veneer modified four square with Dutch Colonial Revival influence, built ca. 1915. Cross gambrel roof with box cornice, covered with asphalt shingles. Windows are 1/1 double-hung sashes.

United States Department of the Interior
National Park Service

National Register of Historic Places
Continuation Sheet

Idlewild Historic District
Memphis, Shelby County, TN

Section number 7 Page 35

Full-width, undercut porch, supported by cast stone piers. Entrance contains a single-light door, with single-light transom and 3/4-length, single-light sidelights.

268 2034 LINDEN **C** One-story, three-bay, frame composite cottage with Colonial Revival influence, built ca. 1910. Hip and gable roof with box cornice and enclosed gable end, covered with asphalt shingles. Exterior walls covered with weatherboard siding. Windows are 9/6 double hung replacement sashes. L-plan, hip roof porch, supported by cast stone columns with Doric capitals raised on bases. Entrance contains a Colonial Revival cottage door, with a multi-light transom and 3/4-length, two-light sidelights.

269 2035 LINDEN **C** Two-story, two-bay, stucco veneer two-story shotgun with Craftsman influence, built ca. 1915. Hip roof with exposed rafter tails, covered with asphalt shingles. Windows are 1/1 double-hung sashes. Full-width, hip roof porch, supported by battered brick piers. Entrance contains a Colonial Revival cottage door.

270 2036-38 LINDEN **C** One-story, four-bay, brick veneer duplex bungalow with Craftsman influence, built ca. 1925. Gable roof with exposed rafter tails, covered with asphalt shingles. Windows are 1/1 double-hung sashes. Full-width, flat and hip roof porch, supported by brick piers, with a closed brick balustrade. Entrance contains a Colonial Revival cottage door, with single-light transom.

271 2037 LINDEN **C** Two-story, two-bay, frame modified four square with Dutch Colonial Revival influence, built ca. 1915. Cross gambrel roof with box cornice, covered with asphalt shingles. Exterior walls have cast stone on the first floor, and stucco veneer on the second. Windows are 1/1 double-hung sashes and 9/6 metal frame replacement sashes. Full-width, undercut porch, supported by cast stone piers. Entrance contains a Colonial Revival cottage door, with a multi-light transom and 1/2-length, single-light sidelights.

272 2043 LINDEN **C** Two-story, two-bay, cast stone, modified four square with Dutch Colonial Revival influence, built ca. 1915. Cross gambrel roof with box cornice and enclosed gable ends, covered with asphalt shingles. Windows are 1/1 double-hung sashes. Full-width, undercut porch, supported by cast stone piers. Entrance contains an oval replacement door, with single-light transom and 3/4-length, single-light sidelights.

Garage, ca. 1950. One-story, two-bay, frame, cross gable roof, vertical tongue and groove siding. **(NC)**

273 2046 LINDEN **C** One-story, four-bay, frame L-plan cottage with Colonial Revival influence, built ca. 1905. Gable roofs with box cornice, covered with asphalt shingles. Exterior walls covered with weatherboard siding. Windows are 2/2 double hung metal frame replacements. Partial-width, shed roof porch, supported by columns with Doric capitals. Entrance contains a Colonial Revival cottage door, with single-light transom.

274 2049 LINDEN **C** One-story, three-bay, frame bungalow with Craftsman influence, built ca. 1915. Hip roof with exposed rafter tails, covered with asphalt shingles. Exterior walls covered with Masonite siding. Windows are 1/1 double-hung sashes, some in bay windows. Partial-width, hip roof porch, supported by wrought iron posts. Entrance contains a Craftsman cottage door, with single-light transom.

275 2052 LINDEN **C** One and one-half story, two-bay, frame composite cottage with Colonial Revival influence, built ca. 1905. Hip and gable roof with hip-roofed dormers and box cornice, covered with asphalt shingles. Exterior walls covered with weatherboard siding. Windows are 1/1 double-hung sashes. Full-width, hip roof porch, supported by columns with Doric capitals. Entrance contains a Colonial Revival cottage door, with multi-light transom and 1/2-length, single-light sidelights.

United States Department of the Interior
National Park Service

National Register of Historic Places
Continuation Sheet

Idlewild Historic District
Memphis, Shelby County, TN

Section number 7 Page 36

276 2053 LINDEN **C** One-story, two-bay, frame composite cottage with Colonial Revival influence, built ca. 1910. Hip and gable roof with box cornice, covered with asphalt shingles. Exterior walls covered with asphalt roll siding. Windows are 1/1 double-hung sashes. L-plan, hip roof porch, supported by wrought iron posts. Entrance contains Colonial Revival cottage door, with single-light transom and 3/4-length, single-light sidelights.

277 2054 LINDEN **NC** One-story, three-bay, frame modified composite cottage with Colonial Revival influence, built ca. 1905 and significantly altered with stucco veneer ca. 1970. Hip and gable roof with box cornice and enclosed gable end, covered with asphalt shingles. Windows are replacement multi-light fixed sashes. Partial-width, flat and hip roof porch, supported by columns. Entrance contains a multi-light door.

Garage, ca. 1920. One-story, one-bay, frame, side gable, exterior plywood siding. **(C)**

278 2056 LINDEN **C** One-story, three-bay, frame composite cottage with Colonial Revival influence, built ca. 1915. Hip and gable roof with box cornice, covered with asphalt shingles. Exterior walls covered with asphalt roll siding. Windows are 1/1 double-hung sashes. Partial-width, shed roof porch, supported by wrought iron posts. Entrance contains a Colonial Revival cottage door, with single-light transom.

Shed, ca. 1920. One-story, one-bay, frame, gable roof, weatherboard siding. **(C)**

279 2057 LINDEN **C** One-story, three-bay, frame composite cottage with Colonial Revival influence, built ca. 1910. Complex hip and gable roof with box cornice and enclosed gable end, covered with asphalt shingles. Exterior walls covered with vinyl siding. Windows are 1/1 double-hung sashes. Partial-width, hip roof porch, supported by replacement columns. Entrance contains a single-light door, with a multi-light transom and 1/2-length, single-light sidelights.

Garage, ca. 1920. One-story, one-bay, frame, gable roof, weatherboard siding. **(C)**

280 2061 LINDEN **C** One-story, two-bay, frame composite cottage with Colonial Revival influence, built ca. 1910. Hip and gable roof with box cornice and enclosed gable end, covered with asphalt shingles. Exterior walls covered with weatherboard siding. Windows are 1/1 double-hung sashes and one multi-light fixed replacement sash. L-plan, hip roof porch, supported by boxed columns. Entrance contains a replacement six-panel door, with single-light transom.

281 2067-69 LINDEN **C** One-story, three-bay, frame composite cottage with Colonial Revival influence, built ca. 1910. Hip and gable roof with box cornice, covered with asphalt shingles. Exterior walls covered with weatherboard siding. Windows are 1/1 double-hung sashes. L-plan, hip roof porch, supported by wrought iron posts. Entrance contains a single-light door, with a multi-light transom and full-length, single-light sidelights, and, a side, single-light door with single-light sidelights.

282 2073 LINDEN **NC** One-story, three-bay, frame composite cottage with Colonial Revival influence, built ca. 1910. Hip and gable roof with box cornice and enclosed gable end, covered with asphalt shingles. Exterior walls covered with vinyl siding. Windows are 1/1 double-hung sashes. Partial-width, shed roof porch, supported by replacement boxed columns, partially enclosed. Entrance contains single-light door, with 3/4-length, single-light sidelights.

283 2081 LINDEN **C** One and one-half story, four-bay, frame composite cottage with Colonial Revival influence, built ca. 1910. Complex hip and gable roof with gable-roofed dormers and box cornice, covered with asphalt shingles. Exterior walls covered with weatherboard siding. Windows are 1/1 double-hung sashes. L-plan, hip roof porch, supported by columns with Doric capitals, with turned spindle balustrade. Entrance contains a replacement slab door, with a multi-light transom and 3/4-length, single-light sidelights.

Garage, ca. 1960. One-story, one-bay, frame, gable roof, Masonite siding. **(NC)**

United States Department of the Interior
National Park Service

National Register of Historic Places
Continuation Sheet

Idlewild Historic District
Memphis, Shelby County, TN

Section number 7 Page 37

284 2082 LINDEN **NC** One-story, three-bay, brick veneer cottage with Colonial Revival influence, built ca. 1965. Hip roof with hip-roofed dormers and box cornice, covered with asphalt shingles. Windows are 6/6 double-hung sashes. One-bay wide, hip roof porch, supported by wrought iron posts. Entrance contains a six-panel door.

285 2084 LINDEN **C** One-story, three-bay, frame composite cottage with Colonial Revival influence, built ca. 1905. Gable roof with box cornice, covered with asphalt shingles. Exterior walls covered with weatherboard siding. Windows are 1/1 double-hung sashes. Partial-width, shed roof porch, supported by boxed columns. Entrance contains a single-light door with a ghost transom.

286 2085 LINDEN **C** One-story, two-bay, frame composite cottage with Colonial Revival influence, built ca. 1910. Hip and gable roof with gable-roofed dormers and box cornice, covered with asphalt shingles. Exterior walls covered with weatherboard siding. Windows are 1/1 double-hung sashes. L-plan, hip roof porch, supported by replacement columns. Entrance contains a single-light door, with single-light transom and 3/4-length, single-light sidelights.

287 2088 LINDEN **NC** One-story, four-bay, frame composite cottage with Colonial Revival influence, built ca. 1905 and significantly altered ca. 1975. Gable and hip roof with box cornice, covered with asphalt shingles. Exterior walls covered with vinyl siding. Windows are 2/2 double hung metal frame replacement sashes in reduced openings. Partial-width, shed roof porch, supported by replacement columns raised on bases. Entrance contains a multi-panel, multi-light door.

288 2091 LINDEN **NC** Two-story, three-bay, stucco veneer four-square with Craftsman influence, built ca. 1915. Hip roof with hip-roofed dormers and box cornice, covered with asphalt shingles. Windows are 1/1 double-hung sashes. Partial-width, gable roof porch, supported by stucco piers. Entrance contains a single-light door, with a multi-light transom and 3/4-length, single-light sidelights.

289 2092 LINDEN **C** One-story, four-bay, frame modified composite cottage with Craftsman and Colonial Revival influence, built ca. 1910. Gable roof with jerkinhead, shed-roofed dormers and box cornice with enclosed gable end, covered with asphalt shingles. Exterior walls covered with asbestos shingles. Windows are 1/1 double-hung sashes. L-plan, hip roof porch, supported by metal poles, partially enclosed. Entrances contain Colonial Revival cottage doors, with single-light transoms.

290 2096 LINDEN **NC** One-story, three-bay, frame double-pile cottage with Colonial Revival influence, built ca. 1905 and significantly altered ca. 1980. Gable roof with box cornice, covered with asphalt shingles. Exterior walls covered with exterior plywood siding. Windows are 1/1 double-hung sashes. Full-width, hip roof porch, supported by turned posts, partially enclosed. Entrance contains a replacement slab door.

291 2097 LINDEN **C** One and one-half story, three-bay, frame composite cottage with Colonial Revival influence, built ca. 1905. Gable and hip roof with box cornice, covered with asphalt shingles. Exterior walls covered with aluminum siding. Windows are 1/1 double-hung sashes. L-plan, undercut porch supported by columns with Doric capitals. Entrance contains a replacement slab door.

292 2103 LINDEN **C** One-story, three-bay, frame composite cottage with Colonial Revival influence, built ca. 1905. Complex hip and gable roof with box cornice, covered with asphalt shingles. Exterior walls covered with asbestos shingles. Windows are 1/1 double-hung sashes. L-plan, hip roof porch, supported by brick piers. Entrances contain replacement slab doors.

United States Department of the Interior
National Park Service

National Register of Historic Places
Continuation Sheet

Idlewild Historic District
Memphis, Shelby County, TN

Section number 7 Page 38

293 2108 LINDEN **C** One-story, three-bay, frame composite cottage with Colonial Revival influence, built ca. 1905. Gable roof with box cornice, covered with asphalt shingles. Exterior walls covered with weatherboard siding. Windows are 1/1 double-hung sashes. L-plan, undercut porch, supported by columns with Doric capitals, raised on bases. Entrance contains a Queen Anne two-panel, two-light door, with a single-light transom and added, single-light sidelight.

294 2109 LINDEN **C** One-story, four-bay, frame composite cottage with Colonial Revival influence, built ca. 1905. Hip and gable roof with box cornice, covered with asphalt shingles. Exterior walls covered with weatherboard siding. Windows are 1/1 double-hung sashes. L-plan, hip roof porch, supported by boxed columns. Entrance contains a single-light door, with single-light transom.

295 2113 LINDEN **C** One-story, four-bay, frame composite cottage with Colonial Revival influence, built ca. 1910. Hip roof with gable-roofed dormers and box cornice, covered with asphalt shingles. Exterior walls covered with weatherboard siding. Windows are 9/9 double-hung sashes. L-plan, undercut porch, supported by columns with Doric capitals raised on bases. Entrance contains a replacement six-panel door.

296 2117 LINDEN **C** One-story, four-bay, frame composite cottage with Colonial Revival influence, built ca. 1905. Complex hip and gable roof with box cornice, covered with asphalt shingles. Exterior walls covered with weatherboard siding. Windows are 1/1 double-hung sashes. L-plan, hip roof porch, supported by battered stone piers raised on bases. Entrances contain single-light doors, with single-light transoms.

297 2123 LINDEN **C** One-story, three-bay, frame composite cottage with Colonial Revival influence, built ca. 1910. Hip and gable roof with box cornice, covered with asphalt shingles. Exterior walls covered with weatherboard siding. Windows are 1/1 double-hung sashes. Partial-width, hip roof porch, supported by boxed columns. Entrance contains a Queen Anne cottage door, with single-light transom.

LINDSEY STREET

298 700 LINDSEY **NC** One-story, five-bay, frame cottage with Colonial Revival influence, built ca. 1990. Side gable roof with flush eaves, covered with asphalt shingles. Exterior walls covered with weatherboard siding. Windows are 9/9 double-hung sashes. Entrance contains a six-panel door.

PEABODY AVENUE

299 1993 PEABODY **C** Two-story, three-bay, stone veneer four-square with Colonial Revival influence, built ca. 1915. Hip roof with hip-roofed dormers and box cornice, covered with asphalt shingles. Windows are 12/1 double-hung sashes. L-plan, hip roof porch, supported by stone piers with an open stone balustrade. Entrance has a single-light door, with a segmental-arched single-light transom and 3/4-length, single-light sidelights.

Garage, ca. 1915. One-story, five-bay, frame, hip roof, weatherboard siding, four-light casements, five panel door. **(C)**

300 1999 PEABODY **C** One-story, three-bay, frame bungalow with Craftsman influence, built ca. 1930. Hip roof with exposed rafter tails, covered with asphalt shingles. Exterior walls covered with weatherboard siding. Windows are 6/1 double-hung sashes. Partial-width, gable and shed roof porch, supported by brick piers, with an open brick balustrade. Entrance has a replacement slab door.

United States Department of the Interior
National Park Service

National Register of Historic Places
Continuation Sheet

Idlewild Historic District
Memphis, Shelby County, TN

Section number 7 Page 39

301 2003-05 PEABODY **C** One-story, three-bay, frame bungalow with Craftsman influence, built ca. 1930. Hip roof with exposed rafter tails, covered with asphalt shingles. Exterior walls covered with weatherboard siding. Windows are 6/1 double-hung sashes. Partial-width, gable roof porch, supported by brick piers, with an open brick balustrade. Entrance has a replacement slab door.

Garage, ca. 1925. One-story, one-bay, frame, gable roof, board and batten siding. **(C)**

302 2009-17 PEABODY **NC** Two-story, eight-bay, brick veneer apartment building with Minimal Traditional influence, built ca. 1960 and altered with Colonial Revival influence in 1995. Flat roof with metal coping, covered with built-up asphalt roofing. Windows are 2/2 double-hung sashes. Two-story, partial-width, hip roof galleries, supported by boxed columns, with a block spindle balustrade. Entrances contain multi-light doors.

303 2029 PEABODY **NC** Two-story, two-bay, brick veneer office building with Modernist influence, built ca. 1975. Hip roof with box cornice, covered with asphalt shingles. Windows are 1/1 fixed lights. Entrance has a slab double door, with single-light transoms.

304 2030-32 PEABODY **C** One-story, four-bay, frame double shotgun with Craftsman influence, built ca. 1925. Gable roof with exposed rafter tails, covered with asphalt shingles. Exterior walls covered with asbestos siding. Windows are 1/1 double-hung sashes. One-bay wide, gable roof porches, supported by brick piers, with closed brick balustrades. Entrances contain multi-light replacement doors.

305 2034-36 PEABODY **C** One-story, four-bay, frame double shotgun with Craftsman influence, built ca. 1925. Gable roof with box cornice, covered with asphalt shingles. Exterior walls covered with vinyl siding. Windows are 1/1 double-hung sashes. One-bay wide, gable roof porches, supported by brick piers. Entrances contain six-panel replacement doors.

306 2037-39 PEABODY **C** One-story, four-bay, brick veneer duplex cottage with Tudor Revival influence, built ca. 1935. Gable roof with box cornice, covered with asphalt shingles. Windows are 6/6 double-hung sashes, some in threes. Two, one-bay-wide, gable roof porches, supported by stone piers with closed brick balustrades. Entrances contain Colonial Revival cottage doors.

Garage, ca. 1935. One-story, one-bay, frame, gable roof, bevel siding. **(C)**

307 2041 PEABODY **C** One-story, two-bay, frame modified shotgun with Colonial Revival influence, built ca. 1910. Gable and hip roof with box cornice, covered with asphalt shingles. Exterior walls covered with shiplap siding. Windows are 1/1 double-hung sashes. One-bay, undercut porch, supported by columns with Doric capitals. Entrance has a Colonial Revival cottage door, with single-light transom.

308 2042 PEABODY **NC** One and one-half story, four-bay, frame bungalow with Craftsman influence, built ca. 1915 and significantly altered ca. 1975. Cross-gable roof with jerkinhead and box cornice, covered with asphalt shingles. Exterior walls covered with asbestos siding. Windows are 2/2 double hung metal frame replacement sashes. Full-width, undercut porch, supported by paired box columns, with closed asbestos-sided balustrade. Entrances contain replacement slab doors.

United States Department of the Interior
National Park Service

National Register of Historic Places
Continuation Sheet

Idlewild Historic District
Memphis, Shelby County, TN

Section number 7 Page 40

309 2043 PEABODY **C** One-story, two-bay, frame modified shotgun with Colonial Revival influence, built ca. 1910. Gable and hip roof with box cornice, covered with asphalt shingles. Exterior walls covered with weatherboard siding. Windows are 1/1 double-hung sashes. Partial-width, undercut porch, supported by columns with Doric pilasters. Entrance has a replacement slab door, with single-light transom.

310 2046 PEABODY **C** One-story, two-bay, stucco veneer bungalow with Craftsman and Colonial Revival influences, built ca. 1915. Side gable roof with gable-roofed dormers and exposed rafter tails, covered with asphalt shingles. Windows are 6/1 double-hung sashes, some in pairs. Full-width, shed roof porch, supported by cast stone columns with Doric capitals, with a closed stucco balustrade. Entrance has a Craftsman cottage door, with 1/2-length, single-light sidelights.

311 2050-52 PEABODY **NC** One-story, four-bay, brick veneer duplex cottage with Modernist influence, built ca. 1975. Gable roof with box cornice, covered with asphalt shingles. Windows are 2/2 double hung metal frame sashes. Full-width, undercut porch, supported by metal poles. Entrances have replacement slab doors.

312 2051-53 PEABODY **NC** One-story, four-bay, frame double shotgun with Minimal Traditional influence, built ca. 1950. Gable roof with box cornice, covered with asphalt shingles. Exterior walls covered with asbestos shingles. Windows are 6/6 double-hung sashes. Partial-width, hip roof porch, supported by wrought iron posts. Entrance has a four-panel, two-light door.

313 2056 PEABODY **C** One-story, two-bay, stucco veneer bungalow with Craftsman influence, built ca. 1915. Hip roof with gable-roofed dormers and exposed rafter tails, covered with asphalt shingles. Windows are 1/1 double-hung sashes and a three-light casement with multi-light transom. Full-width, undercut porch, supported by stucco piers. Entrance has a single-light door, with single-light transom.

Garage, ca. 1915. One-story, one-bay, frame, hip roof, weatherboard siding. **(C)**

314 2061 PEABODY **NC** One-story, three-bay, frame, modified composite cottage with Colonial Revival influence, built ca. 1910 and significantly altered ca. 1985. Gable roof with box cornice and cornice returns, covered with asphalt shingles. Exterior walls covered with exterior plywood siding. Windows are single-light fixed sashes. Partial-width, undercut porch, supported by boxed columns. Entrance has a Colonial Revival cottage door.

315 2062 PEABODY **NC** One-story, three-bay, frame Cape with Minimal Traditional influence, built ca. 1950. Side gable roof with box cornice, covered with asphalt shingles. Exterior walls covered with aluminum siding. Windows are 2/2 double-hung sashes and one multi-light "picture" window. Entrance has a six-panel door.

316 2063 PEABODY **NC** One-story, two-bay, frame shotgun with Colonial Revival influence, built ca. 1905 and significantly altered ca. 1993. Gable roof with box cornice, covered with asphalt shingles. Exterior walls covered with weatherboard siding. Windows are single-light fixed sashes. Full-width, hip roof porch, supported by simple posts. Entrance has a six-panel door.

317 2064 PEABODY **NC** One-story, two-bay, brick veneer bungalow with Craftsman influence, built ca. 1925 and significantly altered ca. 1985. Gable roof with jerkinhead and exposed rafter tails, covered with asphalt shingles. Windows are 1/1 double-hung sashes. Partial-width, flat and hip roof porch, supported by brick piers, enclosed with vinyl siding and added bay windows. Entrance has a replacement multi-light door.

United States Department of the Interior
National Park Service

National Register of Historic Places
Continuation Sheet

Idlewild Historic District
Memphis, Shelby County, TN

Section number 7 Page 41

318 2065 PEABODY **C** One and one-half story, two-bay, frame camelback shotgun with Craftsman influence, built ca. 1925. Side gambrel roof with gable-roofed dormers and exposed rafter tails, covered with asphalt shingles. Exterior walls covered with weatherboard siding. Windows are 1/1 double-hung sashes. Full-width, undercut porch, supported by boxed columns, with a block spindle balustrade. Entrance has a replacement slab door.

319 2069 PEABODY **C** One-story, three-bay, frame modified shotgun with Colonial Revival influence, built ca. 1905. Hip roof with exposed rafter tails, covered with asphalt shingles. Exterior walls covered with weatherboard siding. Windows are 1/1 double-hung sashes. Partial-width, undercut porch, supported by columns with Doric pilasters. Entrance has a Colonial Revival cottage door, with single-light transom.

320 2070 PEABODY **C** One-story, three-bay, frame modified shotgun with Colonial Revival influence, built ca. 1905. Gable roof with box cornice and cornice returns, covered with asphalt shingles. Exterior walls covered with Masonite siding. Windows are 9/9 double hung metal frame replacement sashes. Partial-width, hip roof porch, supported by columns with Doric capitals. Entrance has an oval-light door.

321 2071 PEABODY **C** One-story, two-bay, frame shotgun with Colonial Revival influence, built ca. 1905. Gable roof with box cornice and enclosed gable end, covered with asphalt shingles. Exterior walls covered with asbestos siding. Windows are 1/1 double-hung sashes. Full-width, undercut porch, supported by wrought iron posts. Entrance has a replacement slab door.

322 2073 PEABODY **C** One-story, two-bay, frame shotgun with Colonial Revival influence, built ca. 1905. Gable roof with box cornice and enclosed gable end, covered with asphalt shingles. Exterior walls covered with weatherboard siding. Windows are 1/1 double-hung sashes. Full-width, undercut porch, supported by columns with Doric capitals raised on bases. Entrance has a replacement multi-light door, with single-light transom.

323 2075 PEABODY **C** One-story, two-bay, frame shotgun with Colonial Revival influence, built ca. 1905. Gable roof with box cornice, covered with asphalt shingles. Exterior walls covered with asbestos shingles. Windows are 1/1 double-hung sashes. Full-width, undercut porch, supported by wrought iron posts. Entrance has a replacement slab door, with single-light transom.

Shed, ca. 1960. One-story, one-bay, frame, gable roof, exterior plywood siding. **(NC)**

324 2080 PEABODY **NC** One-story, thirteen-bay, brick veneer office building with Modernist influence, built ca. 1952. Flat roof with metal coping, covered with built-up asphalt roofing. Windows are multi-light metal casements. Entrance beneath deep overhang supported by metal poles, and has a slab door.

325 2085 PEABODY **C** One-story, three-bay, frame composite cottage with Colonial Revival influence, built ca. 1905. Hip and gable roof with box cornice and with enclosed gable end, covered with asphalt shingles. Exterior walls covered with weatherboard siding. Windows are 1/1 double-hung sashes and one 9/6 double hung metal frame replacement sash. L-plan, hip roof porch, supported by boxed columns. Entrances contain replacement slab doors, with single-light transoms.

326 2089 PEABODY **C** One-story, two-bay, frame shotgun with Colonial Revival influence, built ca. 1905. Gable roof with box cornice, covered with asphalt shingles. Exterior walls covered with weatherboard siding. Windows are 1/1 double-hung sashes. Full-width, hip roof porch, supported by boxed columns. Entrance has a replacement slab door, with a single-light transom.

United States Department of the Interior
National Park Service

National Register of Historic Places
Continuation Sheet

Idlewild Historic District
Memphis, Shelby County, TN

Section number 7 Page 42

327 2093 PEABODY **C** One-story, two-bay, frame L-plan cottage with Colonial Revival influence, built ca. 1910. Gable roof with box cornice and enclosed gable end, covered with asphalt shingles. Exterior walls covered with weatherboard siding. Windows are 1/1 double-hung sashes. Partial-width, hip roof porch, supported by boxed columns. Entrance has a replacement slab door, with single-light transom.

328 2095-97 PEABODY **NC** One-story, four-bay, frame duplex Cape with Minimal Traditional influence, built ca. 1950. Side gable roof with flush eaves, covered with asphalt shingles. Exterior walls covered with vinyl siding. Windows are 6/6 double-hung sashes. Entrance has a four-panel, four-light door.

Garage, ca. 1950. One-story, one-bay, frame, gable roof, shiplap siding. **(NC)**

329 2109 PEABODY **NC** One-story, three-bay, brick veneer commercial office building with Minimal Traditional influence, built ca. 1970. Flat roof behind parapet with corbeled cornice, covered with built-up asphalt roofing. Windows are sixteen-light fixed sashes. Entrance has a six-panel door, with ghost sidelights.

330 2117 PEABODY **NC** One-story, three-bay, brick veneer commercial building with no influence, built ca. 1970. Flat roof behind parapet with metal coping, covered with built-up asphalt roofing. Storefront has single-light display windows. A pent roof spans the storefront. Entrance has a slab door.

REMBERT STREET

331 172-74 S. REMBERT **C** Two-story, three-bay, brick veneer English cottage with Tudor Revival influence, built ca. 1925. Gable roof with box cornice, covered with asphalt shingles. Windows are sixteen-light casements, in pairs, and 1/1 double-hung sashes. Entrance set in shed roof vestibule and has a semi-circular arched three-light board door; a side entrance is covered with a hip-roofed hood supported by wrought iron brackets, and has a multi-light door.

332 182 S. REMBERT **C** One-story, three-bay, brick veneer bungalow with Craftsman influence, built ca. 1925. Gable roof with jerkinhead with exposed rafter tails, covered with asphalt shingles. Windows are 1/1 double-hung sashes. Full-width, flat and hip roof porch, supported by brick piers, with a closed brick balustrade. Entrance has a Craftsman cottage door.

333 186 S. REMBERT **C** One-story, three-bay, brick veneer bungalow with Craftsman influence, built ca. 1915. Gable roof with jerkinhead and exposed rafter tails, covered with asphalt shingles. Windows are 1/1 double-hung sashes. Full-width porch and porte cochère covered with a flat and hip roof, supported by brick piers. Entrance has a replacement six-panel door.

334 532 S. REMBERT **NC** One-story, five-bay, frame cottage with Colonial Revival influence, built ca. 1985. Gable and hip roof with gable-roofed dormers and box cornice, covered with asphalt shingles. Exterior walls covered with vinyl siding. Windows are 6/6 double-hung sashes. Partial-width, undercut porch, supported by boxed columns. Entrance has a six-panel door, with single-light transom.

335 538 S. REMBERT **C** One-story, three-bay, frame composite cottage with Colonial Revival influence, built ca. 1905. Gable and hip roof with box cornice and enclosed gable end, covered with asphalt shingles. Windows are 1/1 double-hung sashes. Partial-width, hip roof porch, supported by wrought iron posts. Entrance has a replacement slab door.

Garage, ca. 1960. One-story, one-bay, frame, gable roof, weatherboard siding. **(C)**

336 540 S. REMBERT **C** One-story, three-bay, frame shotgun with Colonial Revival influence, built ca. 1900. Gable roof with plain projecting eaves, covered with asphalt shingles. Exterior walls covered with weatherboard siding.

United States Department of the Interior
National Park Service

National Register of Historic Places
Continuation Sheet

Idlewild Historic District
Memphis, Shelby County, TN

Section number 7 Page 43

Windows are 2/2 double-hung sashes. Full-width, hip roof porch, supported by boxed columns. Entrance has a Queen Anne cottage door, with a single-light transom.

Garage, ca. 1980. One-story, two-bay, frame, gable roof, weatherboard siding. (NC)

337 546 S. REMBERT C One-story, three-bay, brick veneer bungalow with Craftsman influence, built ca. 1920. Gable roof with jerkinhead with gable-roofed dormers and box cornice, covered with asphalt shingles. Windows are 1/1 double-hung sashes. Full-width, gable roof with jerkinhead porch, supported by brick piers, with a closed brick balustrade. Entrance has a Craftsman cottage door.

338 550 S. REMBERT NC One and one-half story, one-bay, brick veneer cottage with Colonial Revival influence, built ca. 1975. Gambrel roof with gable-roofed dormers and box cornice, covered with asphalt shingles. Windows are 6/6 double-hung sashes. Entrance has a six-panel door.

339 578 S. REMBERT C One-story, three-bay, frame airplane bungalow with Craftsman influence, built ca. 1915. Hip roof with shed-roofed dormers and exposed rafter tails, covered with asphalt shingles. Exterior walls covered with weatherboard siding. Windows are Craftsman multi-light/1 double-hung sashes, some in pairs. Full-width, undercut porch, supported by battered stone piers. Entrance has a Craftsman cottage door.

340 582 S. REMBERT C One-story, three-bay, frame bungalow with Craftsman influence, built ca. 1915. Gable roof with jerkinhead and exposed rafter tails, covered with asphalt shingles. Exterior walls covered with weatherboard siding. Windows are Craftsman multi-light/1 double-hung sashes. Full-width, undercut porch, supported by battered brick piers. Entrance has a Craftsman cottage door.

Garage, ca. 1920. One-story, one-bay, frame, gable roof, weatherboard siding. (C)

341 586 S. REMBERT C One-story, four-bay, frame bungalow with Craftsman influence, built ca. 1920. Gable roof with jerkinhead and exposed rafter tails, covered with asphalt shingles. Exterior walls covered with weatherboard siding. Windows are 9/1 double-hung sashes. Full-width, undercut porch, supported by box columns raised on bases, with a closed brick balustrade. Entrance has a Craftsman cottage door.

342 590 S. REMBERT C One-story, four-bay, frame cottage with Craftsman influence, built ca. 1935. Side gable roof with box cornice and cornice returns, covered with asphalt shingles. Exterior walls covered with weatherboard siding. Windows are Craftsman multi-light 3/1 double-hung sashes. Entrance set in vestibule covered with a gable hood supported by knee brace brackets, and has six-panel door.

343 596 S. REMBERT C One and one-half story, two-bay, brick veneer cottage with Colonial Revival influence, built ca. 1935. Side gable roof with shed-roofed dormers and box cornice, covered with asphalt shingles. Windows are 6/1 double-hung sashes. Partial-width, shed roof porch, supported by columns with Doric capitals. Entrance has a multi-light door.

TANGLEWOOD STREET

344 689 TANGLEWOOD NC One-story, two-bay, frame, modified shotgun with no influence, built ca. 1910 and substantially altered ca. 1975. Gable roof with box cornice, covered with asphalt shingles. Exterior walls covered with board and batten siding. Windows are 2/2 double-hung sashes. Porch enclosed. Relocated entrance has a multi-light door.

United States Department of the Interior
National Park Service

National Register of Historic Places
Continuation Sheet

Idlewild Historic District
Memphis, Shelby County, TN

Section number 7 Page 44

345 691 TANGLEWOOD **NC** Two-story, three-bay, brick veneer duplex cottage with Mansard Revival influence, built ca. 1975. Mansard roof with box cornice, covered with asphalt shingles. Windows are 8/12 double-hung sashes. Front, exterior, two-run metal stairs to second floor. Entrances contain four-panel, two-light doors, with 1/2-length, single-light sidelights.

346 695 TANGLEWOOD **C** One-story, two-bay, frame modified composite cottage with Colonial Revival influence, built ca. 1905. Gable roof with box cornice, covered with asphalt shingles. Exterior walls covered with asbestos shingles. Windows are 1/1 double-hung sashes. Partial-width, undercut and shed roof porch, supported by boxed columns. Entrances contain Colonial Revival cottage doors.

347 703 TANGLEWOOD **C** One-story, three-bay, frame bungalow with Craftsman influence, built ca. 1920. Side gable roof with box cornice, covered with asphalt shingles. Exterior walls covered with asbestos siding. Windows are 1/1 double-hung sashes. Full-width, shed roof porch, supported by wrought iron posts. Entrance has a Colonial Revival cottage door, with a single-light transom.

TANGLEWOOD STREET AT HIGBEE AVENUE

348 PEABODY PARK **C**

Originally developed as the Tanglewood Artesian Well Field, 1906. Converted to a 3.4 acre public park in 1922. The park retains its original stucco gate piers, located at Higbee Avenue and South Cooper Street, and much of its original walkway pattern, along with mature oak and maple trees planted ca. 1922. Modern intrusions into the park space include a small play structure and parking areas. Structures located in the park include:

Bandstand, ca. 1922. One-story, frame, octagonal plan, raised platform, flared octagonal roof with modillion cornice covered with asphalt shingles, supported by steel columns with Doric capitals, tubular steel handrail. **(C)**

Skinner Center for the Disabled (712 Tanglewood) **NC**

One-story, thirteen-bay, brick and stone veneer community center with Modernist influence, built ca. 1970. Structure composed of two larger masses connected by low esophagus. Flat and gable roofs with stucco cornices and metal coping, covered with built-up asphalt roofing. Windows are two-light metal casements and multi-light fixed displays. Primary entrance has a single-light, metal-frame double door set in a multi-light curtain wall; other entrances contain multi-light metal frame, metal slab, and single-light wood frame doors.

VINTON AVENUE

349 1996 VINTON **C** One-story, two-bay, brick veneer bungalow with Craftsman influence, built ca. 1925. Gable roof with exposed rafter tails, covered with asphalt shingles. Windows are 2/2 double-hung sashes. Full-width, gable, flat and hip roof porch, supported by brick piers, with a closed brick balustrade. Entrance has a single-light door.

Garage, ca. 1950. One-story, one-bay, frame, gable roof, shiplap siding. **(NC)**

350 1998 VINTON **C** One-story, three-bay, frame bungalow with Craftsman and Colonial Revival influence, built ca. 1925. Gable roof with box cornice, covered with asphalt shingles. Exterior walls covered with Masonite siding. Windows are 2/2 double-hung sashes, some in pairs. Full-width, flat and hip roof porch, supported by cast stone columns with Doric capitals. Entrance has a single-light cottage door.

United States Department of the Interior
National Park Service

National Register of Historic Places
Continuation Sheet

Idlewild Historic District
Memphis, Shelby County, TN

Section number 7 Page 45

351 2002 VINTON NC One-story, three-bay, frame bungalow with Craftsman influence, built ca. 1915 and significantly altered ca. 1975. Gable roof with jerkinhead and exposed rafter tails, covered with asphalt shingles. Exterior walls covered with weatherboard siding. Windows are 1/1 double-hung sashes. Full-width, undercut porch, supported by replacement wood posts, partially enclosed. Entrance has a single-light door, with single-light transom.

352 2006 VINTON NC One-story, two-bay, frame shotgun with Craftsman influence, built ca. 1910 and significantly altered ca. 1975 with side, on-bay addition. Hip roof with exposed rafter tails, covered with asphalt shingles. Exterior walls covered with weatherboard siding. Windows are 1/1 double-hung sashes. Full-width, porch, supported by simple posts. Entrance has a Colonial Revival cottage door, with single-light transom.

353 2007 VINTON C One-story, three-bay, frame bungalow with Craftsman influence, built ca. 1915. Gable roof with jerkinhead and exposed rafter tails, covered with asphalt shingles. Exterior walls covered with aluminum siding. Windows are 1/1 double-hung sashes. Full-width, undercut porch, supported by wrought iron posts. Entrance has a Craftsman cottage door.

Garage, ca. 1960. One-story, two-bay, frame gable roof, asphalt roll siding. **(NC)**

354 2008 VINTON C One-story, two-bay, frame shotgun with Colonial Revival influence, built ca. 1905. Gable roof with box cornice, covered with asphalt shingles. Exterior walls covered with weatherboard siding. Windows are 1/1 double-hung sashes. Full-width, hip roof porch, supported by turned posts. Entrance has a Colonial Revival cottage door, with single-light transom.

355 2011 VINTON C One-story, three-bay, frame composite cottage with Colonial Revival influence, built ca. 1910. Hip and gable roof with box cornice, covered with asphalt shingles. Exterior walls covered with aluminum siding. Windows are 1/1 double-hung sashes. Partial-width, hip roof porch, supported by wrought iron posts. Entrance has a single-light door, with single-light transom.

Garage, ca. 1920. One-story, two-bay, frame, hip roof, board and batten siding. **(C)**

356 2014 VINTON NC One-story, three-bay, frame L-plan cottage with Colonial Revival influence, built ca. 1990. Side gable roof with box cornice, covered with asphalt shingles. Exterior walls covered with weatherboard siding. Windows are 6/6 double-hung sashes. Partial-width, undercut porch, supported by turned posts. Entrance has a single-light door.

357 2017 VINTON C One-story, three-bay, brick veneer bungalow with Craftsman influence, built ca. 1915. Hip and gable roof with exposed rafter tails, covered with asphalt shingles. Windows are 1/1 double-hung sashes. Partial-width, flat and hip roof porch, supported by brick piers, with an open brick balustrade. Entrance has a Craftsman cottage door.

358 2018 VINTON NC One-story, three-bay, brick veneer cottage with Colonial Revival influence, built ca. 1990. Gable roof with box cornice, covered with asphalt shingles. Windows are 6/6 double-hung sashes. Partial-width, gable roof carport, supported by boxed columns. Entrance has a single-light door.

359 2020-22 VINTON NC One-story, four-bay, brick veneer duplex cottage with Minimal Traditional influence, built ca. 1965. Gable and hip roof with box cornice, covered with asphalt shingles. Windows are 2/2 double-hung sashes. Full-width, undercut porch, supported by wrought iron posts. Entrances have slab doors.

United States Department of the Interior
National Park Service

National Register of Historic Places
Continuation Sheet

Idlewild Historic District
Memphis, Shelby County, TN

Section number 7 Page 46

360 2021 VINTON C One-story, three-bay, frame bungalow with Craftsman influence, built ca. 1915. Gable roof with exposed rafter tails, covered with asphalt shingles. Exterior walls covered with weatherboard siding above a wainscot of bevel siding. Windows are 1/1 double-hung sashes. Partial-width, hip roof porch, supported by boxed columns. Entrance has a Craftsman cottage door.

361 2024 VINTON C One-story, three-bay, frame modified shotgun with Colonial Revival influence, built ca. 1915. Gable roof with box cornice, covered with asphalt shingles. Exterior walls covered with asbestos shingles. Windows are 1/1 double-hung sashes. Full-width, hip roof porch, supported by boxed columns. Entrance has a multi-light, multi-panel replacement door.

362 2025 VINTON C One-story, two-bay, frame modified shotgun with Colonial Revival influence, built ca. 1910. Gable and hip roof with box cornice, covered with asphalt shingles. Exterior walls covered with weatherboard siding. Windows are 1/1 double-hung sashes. L-plan, hip roof porch, supported by columns with Doric capitals. Entrance has a Colonial Revival cottage door, with single-light transom.

363 2028 VINTON C One-story, five-bay, frame Cape with Craftsman and Minimal Traditional influence, built ca. 1935. Side gable roof with exposed rafter tails, covered with asphalt shingles. Exterior walls covered with weatherboard siding. Windows are 6/6 double-hung sashes. One-bay wide, gable roof porch, supported by boxed columns. Entrance has a six-panel door.

364 2029 VINTON C One-story, three-bay, stucco veneer bungalow with Craftsman influence, built ca. 1920. Gable roof with jerkinhead and exposed rafter tails, covered with asphalt shingles. Windows are 9/9 double-hung sashes. Full-width, undercut porch, supported by boxed columns. Entrance has a multi-light door.

365 2033 VINTON C One-story, four-bay, brick veneer bungalow with Craftsman influence, built ca. 1925. Gable roof with exposed rafter tails, covered with asphalt shingles. Windows are 1/1 double-hung sashes. Full-width, gable, flat and hip roof porch, supported by brick piers, with a closed brick balustrade. Entrances contain multi-light doors.

366 2035-37 VINTON C One-story, four-bay, brick veneer bungalow with Craftsman influence, built ca. 1925. Gable roof with exposed rafter tails, covered with asphalt shingles. Windows are Craftsman multi-light/1 double-hung sashes. Full-width, flat and hip roof porch, supported by brick piers. Entrances contain single-light door, with single-light transoms.

367 2036 VINTON NC One-story, three-bay, frame double-pile cottage with Minimal Traditional influence, built ca. 1950. Gable roof with flush eaves, covered with asphalt shingles. Exterior walls covered with asbestos shingles. Windows are 2/2 double hung metal frame sashes. One-bay wide, hip roof porch, supported by box columns. Entrance has a six-panel door.

368 2044 VINTON C One-story, three-bay, frame composite cottage with Colonial Revival influence, built ca. 1905. Gable roofs with hip-roofed dormers and box cornice, covered with asphalt shingles. Exterior walls covered with weatherboard siding. Windows are 4/1 and 1/1 double-hung sashes. Partial-width, shed roof porch, supported by wrought iron posts. Entrance has a Colonial Revival cottage door, with a single-light transom.

369 2045 VINTON NC One-story, three-bay, frame cottage type with Colonial Revival influence, built ca. 1992. Gable and hip roof with box cornice, covered with asphalt shingles. Exterior walls covered with weatherboard siding. Windows are 1/1 double-hung sashes. Partial-width, undercut porch, supported by boxed columns. Entrance has a six-panel door.

370 2046 VINTON C One-story, four-bay, frame airplane bungalow with Craftsman influence, built ca. 1920. Gable roof with jerkinhead and exposed rafter tails, covered with asphalt shingles. Exterior walls covered with weatherboard

United States Department of the Interior
National Park Service

National Register of Historic Places
Continuation Sheet

Idlewild Historic District
Memphis, Shelby County, TN

Section number 7 Page 47

siding. Windows are 1/1 double-hung sashes. Full-width, undercut porch, supported by turned posts. Entrances contain Craftsman cottage doors.

Carport, ca. 1970. One-story, three-bay, frame, gable roof. (NC)

371 2047 VINTON C One-story, three-bay, frame bungalow with Craftsman influence, built ca. 1905. Gable roof with exposed rafter tails, covered with asphalt shingles. Exterior walls covered with weatherboard siding. Windows are 1/1 double-hung sashes. Partial-width, undercut porch, supported by boxed columns. Entrance has a Colonial Revival cottage door, with single-light transom.

372 2050 VINTON C One-story, three-bay, frame bungalow with Craftsman influence, built ca. 1920 and significantly altered ca. 1985. Gable roof with box cornice, covered with asphalt shingles. Exterior walls covered with exterior plywood siding. Windows are 1/1 double-hung sashes. Replacement, full-width, shed roof porch, supported by boxed piers. Entrance has a Craftsman cottage door.

Garage, ca. 1950. One-story, two-bay, frame, shed roof, bevel siding. (NC)

373 2053 VINTON C One-story, two-bay, frame composite cottage with Colonial Revival influence, built ca. 1905. Hip and gable roof with gable-roofed dormers, covered with asphalt shingles. Exterior walls covered with weatherboard siding. Windows are 1/1 double-hung sashes. Partial-width, shed roof porch, supported by boxed columns, with a block spindle balustrade. Entrance has a Colonial Revival cottage door, with a single-light transom.

374 2057 VINTON C One-story, two-bay, frame composite cottage with Colonial Revival influence, built ca. 1905. Hip and gable roof with gable-roofed dormers and box cornice, covered with asphalt shingles. Exterior walls covered with weatherboard siding. Windows are 1/1 double-hung sashes. One-bay wide, shed roof porch, supported by box columns raised on bases. Entrance has a Colonial Revival cottage door, with single-light transom.

Garage, ca. 1950. One-story, two-bay, frame, gable roof, weatherboard siding. (NC)

375 2060 VINTON C One-story, three-bay, frame composite cottage with Colonial Revival influence, built ca. 1905. Gable and hip roof with box cornice, covered with asphalt shingles. Exterior walls covered with weatherboard siding. Windows are 1/1 double-hung sashes. Partial-width, undercut porch, supported by turned posts. Entrance has a Queen Anne cottage door, with single-light transom.

376 2061 VINTON NC One-story, three-bay, frame L-plan cottage with Colonial Revival influence, built ca. 1905 and significantly altered ca. 1950. Gable roof with box cornice, covered with asphalt shingles. Exterior walls covered with asbestos shingles. Windows are 4/4 double-hung sashes. Partial-width shed roof porch, supported by box columns, with a side one-bay enclosed garage addition. Entrance has a replacement three-panel door.

377 2062 VINTON C One-story, two-bay, frame modified shotgun with Colonial Revival influence, built ca. 1910. Gable and hip roof with box cornice, covered with asphalt shingles. Exterior walls covered with weatherboard siding. Windows are 1/1 double-hung sashes. Full-width, undercut porch, supported by turned posts. Entrance has a four-panel, four-light door, with a multi-light transom and 3/4-length, single-light sidelights.

378 2065 VINTON C One-story, three-bay, frame T-plan cottage with Colonial Revival influence, built ca. 1900. Sable roof with box cornice, covered with asphalt shingles. Exterior walls covered with vinyl siding. Windows are 1/1 double-hung sashes. Partial-width, shed roof porch, supported by cast stone columns with Scamozzi capitals raised on bases. Entrance has a four-panel, four-light door, with single-light transom.

United States Department of the Interior
National Park Service

National Register of Historic Places
Continuation Sheet

Idlewild Historic District
Memphis, Shelby County, TN

Section number 7 Page 48

379 2068 VINTON C One-story, two-bay, frame modified shotgun with Colonial Revival influence, built ca. 1910. Gable roof with box cornice, covered with asphalt shingles. Exterior walls covered with weatherboard siding. Windows are 1/1 double-hung sashes. Full-width, shed roof porch, supported by columns with Doric capitals. Entrance has a Craftsman cottage, with single-light transom.

380 2069 VINTON C One-story, three-bay, frame composite cottage with Colonial Revival influence, built ca. 1905. Gable and hip roof with box cornice, covered with asphalt shingles. Exterior walls covered with weatherboard siding. Windows are 1/1 double-hung sashes. Partial-width, hip roof porch, supported by cast stone columns with Doric capitals raised on bases. Entrance has a Colonial Revival cottage door, with single-light transom.

381 2070 VINTON C One-story, three-bay, frame modified shotgun with Colonial Revival influence, built ca. 1910. Gable roof with box cornice with enclosed gable end, covered with asphalt shingles. Exterior walls covered with weatherboard siding. Windows are 1/1 double-hung sashes. Full-width, hip roof porch, supported by replacement turned posts. Entrance has a single-light door, with single-light transom.

382 2073 VINTON C One-story, three-bay, frame composite cottage with Colonial Revival influence, built ca. 1905. Hip and gable roof, hip-roofed dormers and box cornice with enclosed gable end, covered with asphalt shingles. Exterior walls covered with weatherboard siding. Windows are 1/1 double-hung sashes. L-plan, hip roof porch, supported by cast stone columns with Doric capitals raised on bases. Entrance has a Colonial Revival cottage door, with single-light transom.

383 2074 VINTON C One-story, three-bay, frame modified composite cottage with Colonial Revival influence, built ca. 1910. Hip and gable roof with box cornice and enclosed gable end, covered with asphalt shingles. Exterior walls covered with weatherboard siding. Windows are 1/1 double-hung sashes. Partial-width, shed roof porch, supported by boxed columns. Entrance has a single-light door, with a single-light transom.

Garage, ca. 1960. One-story, one-bay, frame, hip roof weatherboard siding. (NC)

384 2076 VINTON C One-story, three-bay, frame modified shotgun with Colonial Revival influence, built ca. 1910. Gable roof with box cornice and enclosed gable end, covered with asphalt shingles. Exterior walls covered with weatherboard siding. Windows are 9/9 double hung metal frame replacement sashes. Partial-width, undercut porch, supported by boxed columns. Entrance has an eight-panel replacement door, with single-light transom.

385 2077 VINTON C One-story, two-bay, frame modified composite cottage with Colonial Revival influence, built ca. 1905. Side gable roof with hip-roofed dormers and box cornice, covered with asphalt shingles. Exterior walls covered with weatherboard siding. Windows are 12/12 double hung metal frame replacement sashes. L-plan, hip roof porch, supported by boxed columns. Entrance has an oval-light replacement door, with single-light transom.

386 2080 VINTON C One-story, four-bay, stucco veneer bungalow with Craftsman influence, built ca. 1920. Gable roof with jerkinhead and exposed rafter tails, covered with asphalt shingles. Windows are 8/1 double-hung sashes. Full-width, flat and hip roof porch, supported by battered brick piers raised on bases. Entrances contain Craftsman cottage doors.

Garage, ca. 1920. One-story, one-bay, frame, gable roof, bevel siding. (C)

387 2083 VINTON C One-story, two-bay, frame composite cottage with Colonial Revival influence, built ca. 1905. Hip and gable roof with hip-roofed dormers and box cornice, covered with asphalt shingles. Exterior walls covered with weatherboard siding. Windows are 1/1 double-hung sashes. L-plan, hip roof porch, supported by replacement turned posts. Entrance has a single-light door, with single-light transom.

United States Department of the Interior
National Park Service

National Register of Historic Places
Continuation Sheet

Idlewild Historic District
Memphis, Shelby County, TN

Section number 7 Page 49

388 2089 VINTON C One-story, three-bay, frame composite cottage with Colonial Revival influence, built ca. 1905. Side gable roofs with hip-roofed dormers and box cornice, covered with asphalt shingles. Exterior walls covered with weatherboard siding. Windows are 1/1 double-hung sashes. L-plan, hip roof porch, supported by boxed columns, partially enclosed. Entrance has a single-light door, with a ghost transom.

389 2091 VINTON C One-story, three-bay, frame T-plan cottage with Colonial Revival influence, built ca. 1900. Gable roof with box cornice, covered with asphalt shingles. Exterior walls covered with vinyl siding. Windows are 2/2 and 1/1 double-hung sashes. Partial-width, shed roof porch, supported by columns with Doric capitals raised on bases. Entrances contain Colonial Revival cottage doors, with single-light transoms.

390 2099 VINTON C One-story, three-bay, frame T-plan cottage with Colonial Revival influence, built ca. 1900. Gable roof with plain projecting eaves, covered with asphalt shingles. Exterior walls covered with weatherboard siding. Windows are 1/1 double-hung sashes. One-bay wide, shed roof porch, supported by paired box columns. Entrances contain Colonial Revival cottage doors, with single-light transoms.

391 2100 VINTON C One-story, three-bay, frame modified shotgun with Colonial Revival influence, built ca. 1905. Gable and hip roof with box cornice and enclosed gable end, covered with asphalt shingles. Exterior walls covered with weatherboard siding. Windows are 1/1 double-hung sashes and one multi-light fixed sash. Partial-width, undercut porch, supported by replacement turned posts. Entrance has a Colonial Revival cottage door, with a single-light transom.

392 2102 VINTON NC One-story, four-bay, frame modified composite cottage with Colonial Revival influence, built ca. 1910 and significantly altered ca. 1990 with various additions. Gable roof with box cornice and enclosed gable end, covered with asphalt shingles. Exterior walls covered with weatherboard siding. Windows are 1/1 double-hung sashes. Partial-width, shed roof porch, supported by boxed columns, partially enclosed and extended. Entrance has an oval-light replacement door.

393 2104 VINTON C One and one-half story, three-bay, frame modified shotgun with Colonial Revival influence, built ca. 1905. Gable roof with shed-roofed dormers and box cornice and enclosed gable end, covered with asphalt shingles. Exterior walls covered with vinyl siding. Windows are 1/1 double-hung sashes. L-plan, hip roof porch, supported by replacement columns. Entrance has a replacement multi-light, multi-panel door, with single-light transom.

394 2106 VINTON C One-story, three-bay, frame modified shotgun with Colonial Revival influence, built ca. 1905. Hip and gable roof with box cornice and enclosed gable end, covered with asphalt shingles. Exterior walls covered with weatherboard siding. Windows are 1/1 double-hung sashes. L-plan, hip roof porch, supported by boxed columns. Entrance has a replacement slab door, with single-light transom.

395 2108 VINTON C One-story, three-bay, frame composite cottage with Queen Anne Revival influence, built ca. 1905. Hip and gable roof with and box cornice, covered with asphalt shingles. Exterior walls covered with weatherboard siding. Windows are 1/1 double-hung sashes. L-plan, hip roof porch, supported by wrought iron posts. Entrance has a Colonial Revival cottage door, with single-light transom.

Garage, ca. 1920. One-story, two-bay, frame, gable roof, novelty siding. (C)

396 2109 VINTON C One-story, two-bay, frame shotgun with Colonial Revival influence, built ca. 1905. Gable roof with box cornice, covered with asphalt shingles. Exterior walls covered with weatherboard siding. Windows are 2/2 double-hung sashes. Partial-width, hip roof porch, supported by replacement columns. Entrance has a replacement fan light, four-panel door, with single-light transom.

United States Department of the Interior
National Park Service

National Register of Historic Places
Continuation Sheet

Idlewild Historic District
Memphis, Shelby County, TN

Section number 7 Page 50

397 2112 VINTON **NC** One-story, one-bay, frame cottage with Modernist influence, built ca. 1975. Gable roof with flush eaves, covered with sheet metal. Exterior walls covered with exterior plywood siding. Windows are single-light fixed sashes. Front facing, one-bay, undercut garage. Entrance has a single-light door.

398 2113 VINTON **C** One and one-half story, three-bay, frame bungalow with Colonial Revival influence, built ca. 1915. Hip roof with hip-roofed dormers and box cornice, covered with asphalt shingles. Exterior walls covered with aluminum siding. Windows are 1/1 double-hung sashes. Partial-width, hip roof porch, supported by columns with Doric capitals, with a block spindle balustrade. Entrance has multi-light door, with a single-light transom.

399 2116 VINTON **C** One-story, five-bay, frame composite cottage with Colonial Revival influence, built ca. 1905. Complex hip and gable roof with box cornice, covered with asphalt shingles. Exterior walls covered with weatherboard siding. Windows are 1/1 double-hung sashes. Partial-width, hip roof porch, supported by columns with Doric capitals raised on bases. Entrance has a four-panel door, with a single-light transom.

400 2117 VINTON **NC** One-story, three-bay, frame cottage with Colonial Revival influence, built 1998. Gable roof with box cornice, covered with asphalt shingles. Exterior walls covered with Masonite siding. Windows are 6/6 double-hung sashes. Partial-width, undercut porch supported by simple posts. Entrance has a multi-panel door.

401 2124 VINTON **C** One-story, three-bay, frame modified composite cottage with Colonial Revival influence, built ca. 1905. Gable and hip roof with box cornice, covered with asphalt shingles. Exterior walls covered with asbestos siding. Windows are 1/1 double-hung sashes. Full-width, hip roof porch, supported by simple posts, with a block spindle balustrade, partially enclosed. Entrance has a six-panel replacement door, with single-light transom.

402 General Streetscape Characteristics **C** The character of the streetscape elements in the district combine to provide it with significant qualities of setting. These characteristics include mature street and yard trees, concrete sidewalks and curbs, the street matrix of the district, its lot patterns, lawn terraces, varying patterns of front and side yard setbacks, and other elements of the built and natural landscape found in the district. For the purposes of the resource count in the nomination, these elements are combined as one contributing site element.

United States Department of the Interior
National Park Service

National Register of Historic Places Continuation Sheet

Idlewild Historic District
Memphis, Shelby County, TN

Section number 8 Page 51

NARRATIVE STATEMENT OF SIGNIFICANCE

The Idlewild Historic District is being nominated under criterion C in the area of architecture for its significant collection of late-nineteenth and early twentieth century residential and commercial architecture developed in the period between ca. 1890 and 1945. The wide variety of house types, architectural styles, and of the materials used in their construction reflect the evolutionary history of the district over its period of significance from a remote streetcar suburb to that of an urban automobile suburb. The commercial resources found at the district's edge were developed along the street car line in response to the growing market for neighborhood services, and thus, reflect the maturation of the area as a well-rounded community.

The period of significance begins with the establishment of the Idlewild Subdivision ca. 1890, and ends with the end of World War Two, at which time, building types, patterns and materials changed radically from those characteristics in evidence in the district.

During the 1880s, the area of Memphis between the current day Parkways and the then existing city limit at Walnut and East Streets near the so-called "Midtown Loop" of Interstate 240 was an area still largely composed of farm properties and rural estates, represented by the likes of the Rozelle plantation (1737 Harbert Avenue, ca. 1850, part Central Gardens Historic District, NR 9/9/1982), the Eli Rayner House (1020 Rayner Street, NR 5/09/1977) and other early properties. The farms and estates were tied together by a widely scattered grid of public roads developed on shared property lines, including Cooper Street, Central Avenue, Union Avenue and Madison Avenue, among others.

Commonly known as "East End" prior to ca. 1905, and today known as "Midtown," the rural character of this area began to change beginning in 1884-1887 with the creation of three major developments in the area-- Montgomery Park, the Citizen's East End Railroad, and East End Park. The establishment of Montgomery Park (1884) on the site of the current Mid-South Fairgrounds created a major new site for public amusements, the focus of which were the horse races held by the Memphis Jockey Club. The popularity of Montgomery Park caused real estate interests in the area to charter the Citizens Street Railway Company in 1887, operating its suburban "East End Dummy Line" as a connection between the old city with Montgomery Park. On the site of the former McLean Homestead at Tucker and Madison Avenue, the new trolley company also developed its own pleasure ground called East End Park, which opened to the public in 1887.

The effect of the East End Dummy Line through the area can not be understated in its importance to the residential development in the Midtown area before ca. 1900. The rail line not only connected the public with the attractions of East End Park and Montgomery Park, but it also enabled families of

United States Department of the Interior
National Park Service

National Register of Historic Places Continuation Sheet

Idlewild Historic District
Memphis, Shelby County, TN

Section number 8 Page 52

every income level to seek housing opportunities outside of the old Memphis urban core, and yet be connected with the workplace in the old city by a simple commute on the trolley line. The effect of the trolley line on suburbanization of the East End area in the 1890s was similar to the effect that interstate-quality highways cause in the suburbanization of major cities in America today. The difference, of course, was that in the era before the automobile, development tended to occur within an easy walking distance from the street car line. The other contrast, of course, is that pre-World War Two trolley lines operated in tandem with existing traffic over established streets, serving to knit together the developing urban fabric of cities, instead of separating neighborhoods as does the Interstate system.

The "Dummy Line" extended out of the old core of Memphis along Madison Avenue, turning south on Cooper Street, then east again on Young Avenue to reach Montgomery Park. Within the first five years of its operation, several major areas of subdivision development were begun, including the Mount Arlington subdivision (1890, part Cooper-Young Historic District, NR 6/22/1989), the Idlewild Subdivision (1889, part Central Gardens Historic District, NR 9/09/1982), and the Lenox Subdivision (1890).

Concurrent with the onset of suburban development in the East End area was a burgeoning progressive political movement, begun ca. 1895 by an association of businessmen, civic interests and real estate interests called "The Committee of One Hundred." Some of the figures involved were some of the same real estate developers responsible for the Citizens Street Railway Company and the various East End subdivisions. The Committee first formally proposed a progressive agenda for the city during the mayoral election of 1895, which included annexation of an extensive area east from the city limits to the East End and the extension of city sewers and water lines into the annexed area to spur residential development (*Memphis Evening Scimitar*, 1899:2-3). Though the progressive agenda was not adopted by any of the mayoral candidates in 1895, the effect of the attention it gained was immediate.

It is not clear whether the progressive's push for annexation of the East End was a reaction to earlier calls for the incorporation of some of the eastern subdivisions, or whether the incorporation efforts in these areas came as a reaction to the progressive's public efforts. Which ever the case, a wave of incorporation efforts was set in motion in the East End, resulting in the incorporation of the Town of Idlewild in September of 1895 (*The Commercial Appeal*, September 11, 1895), among others. The Town of Idlewild was incorporated with boundaries that included Mosby Street (now Belvedere) on the west, Poplar Avenue and Madison Avenue on the north, Tucker Street and Cooper Street on the east, and Harbert Street on the south.

United States Department of the Interior
National Park Service

National Register of Historic Places Continuation Sheet

Idlewild Historic District
Memphis, Shelby County, TN

Section number 8 Page 53

The progressive agenda for Memphis returned to the fore-front of public debate in the mayoral election of 1897. By this time, the agenda had been given the name of "The Greater Memphis Movement" and it was heartily endorsed by both candidates for election, J. J. Williams and W. L. Clapp. Williams captured the attention of the voters first in endorsing the Greater Memphis Movement, and following his election, moved to implement the agenda immediately. The first action taken was for the city to take formal action to annex the twelve square miles of suburban territory, stretching out to the East End as far as Cooper Street. The city's efforts were stalled in 1898 by a ruling of the Tennessee Supreme Court that struck down certain provisions of the state's annexation law; the state legislature enacted corrections to the annexation law later in that year which allowed the City to proceed (*Commercial Appeal* June 12, 1898). Annexation of Idlewild was made formal in 1899.

In the period between ca. 1890 and 1899, the portions of Idlewild that lie in the proposed district saw rather modest development of residential and commercial resources. Sanborn maps and city directories for this period show concentrations of development along the major streets of the district, particularly along Linden, Courtland, Cowden and Harbert avenues covering perhaps a third of its total developed area today.

Other resources were developed in Idlewild during the period immediately prior to annexation and in the period which followed that reflect the unique development circumstances of the area; some of these resources have now become separated from the district due to subsequent redevelopment of the town after annexation. By example, the Idlewild Elementary School was built just west of the district on Linden Avenue in 1903 to replace an earlier town-run school; the school was included in the Belvedere Subdivision redevelopment of the southwestern portion of Idlewild in 1906 (Central Gardens NR 9/9/1982). Later, as the automobile gained in popularity as an everyday convenience, the redevelopment of originally modest streets into major transportation corridors, like Union Avenue and Madison Avenue, further divided the original "town" character of Idlewild into disparate parts. The proposed district is the largest of the remaining parts of the town-development of Idlewild.

The extant residential resources developed during the pre-annexation period in the district share common characteristics of house types and styles that set a rather unique architectural tone for the district and reflect its origin as a streetcar suburb. The developed patterns of shotgun, modified shotguns, composite cottages, modified composite cottages, and L-plan cottages built here in the pre-annexations era are different from those of those developed in the other major "edge" communities of its time, like the Mount Arlington Subdivision (Cooper-Young Historic District, NR 6/22/1989), the Town of Lenox, and the Town of Madison Heights, among others.

United States Department of the Interior
National Park Service

National Register of Historic Places Continuation Sheet

Idlewild Historic District
Memphis, Shelby County, TN

Section number 8 Page 54

Survey data, city directories and Sanborn Fire Insurance maps combine to reveal that the pace of residential development quickened following the annexation of Idlewild, perhaps as the result of the extension of public water and sewer lines in the area. Subdivisions were created to overlay and extend development to the south of the original town limit at Harbert Avenue, creating the sense of a seamless neighborhood extending from Linden to and including Central Avenue. The vast majority of the existing residential development in the district occurred between 1905 and 1915. Variations on the bungalow house form were introduced to the neighborhood during this period, along with the Craftsman architectural style. Many of the earlier house types continued to be built; the shotgun, composite cottage forms were among them, but they were built as often with Craftsman styling as with the Colonial Revival. Other housing types emerged during the post-annexation era, including the four-square and the English cottage, among others. Housing development in the area was largely complete by ca. 1920, though scattered vacant lots remained to be developed or redeveloped through the 1930s.

The growth of a significant residential population in the area of the district caused the development of complementary resources to service the maturing community. The Union Avenue Methodist Episcopal Church, South (NR 3/06/1987) was developed at the corner of Union Avenue and South Cooper Street in 1913, and the Union Avenue Baptist Church (2181 Union Avenue) was developed ca. 1915 to serve the spiritual needs of the neighboring communities. (Both are outside the district.)

A key resource developed in the district was the Tanglewood Well Field and Pumphouse, built in 1906 and operated on the site of Peabody Park until 1922. During most of the period from 1912 to 1922, the Tanglewood Well Field supplied most of the city of Memphis with its public water supply. The park's distinctive bandstand, built with its formal redevelopment as a park ca. 1922, remains standing in the park today. The Skinner Center for the Disabled occupies the site of the original Tanglewood Pump Station.

The history of the neighborhood is also reflected in the development of its commercial resources. The original "downtown" area of the Town of Idlewild was located along Madison Avenue, well to the north of the district. However, as the market for neighborhood services grew, the development of commercial resources followed the trolley line to the eastern edge of the district. The commercial cluster at the intersections of South Cooper, Peabody Avenue and Linden Avenue retains excellent examples of both types of commercial structures that developed over the first three decades of this century, including the particularly fine stone-veneer store building 243-47 South Cooper, built in 1912. Other significant commercial resources developed nearby in the district include the commercial blocks at 549 and 551-553 South Cooper, built ca. 1915 and ca. 1929, respectively, and the Park Avenue F & AM Masonic Lodge at 539 South Cooper, built in 1941.

United States Department of the Interior
National Park Service

National Register of Historic Places Continuation Sheet

Idlewild Historic District
Memphis, Shelby County, TN

Section number 8 Page 55

By the onset of World War Two, commercial structures occupied many lots on the south side of South Cooper running north from Vinton Avenue to Union Avenue. The redevelopment of some properties with new structures along South Cooper began in the 1950s, replacing some earlier commercial uses and residences with larger stores and service-oriented businesses. Other former residences were converted to commercial use in the 1960s and 1970s.

In spite of the changes along South Cooper since World War Two, the commercial corridor still retains a strong sense of identity and pride of place as part of its immediate community. Though the housing stock in parts of the district was once run down, in general terms, a recent wave of revitalization activity has added renewed vigor to the district, in part due to the convenience and quality of the small, neighborhood businesses which remain on South Cooper.

The Idlewild Historic District is a unique area in the City of Memphis. It is a place which can historically and physically demonstrate the experience of a formerly independent town that grew within the expanding suburban development of Memphis at the turn of the twentieth century. The district retains its sense of identity today, a sense bolstered in part by the great diversity and quality of its architectural character.

United States Department of the Interior
National Park Service

National Register of Historic Places Continuation Sheet

Idlewild Historic District
Memphis, Shelby County, TN

Section number 9 Page 56

MAJOR BIBLIOGRAPHICAL REFERENCES

Harkins, John

Metropolis of the American Nile. Windsor Publications, Woodland Hills, CA. 1982

Johnson, Eugene J. and Robert D. Russell, Jr.

Memphis: An Architectural Guide. University of Tennessee Press, Knoxville. 1990.

The Commercial Appeal:

September 11, 1895; September 1, 1909. Memphis, TN.

The Evening Scimitar.

Art Supplement to the Housewarming Edition, Memphis, TN, 1899.

Polk, R. L & Co.

Memphis City Directories: 1900, 1905, 1907, 1910, 1915, 1920, 1925.

United States Department of the Interior
National Park Service

National Register of Historic Places Continuation Sheet

Idlewild Historic District
Memphis, Shelby County, TN

Section number 10 Page 57

GEOGRAPHICAL DATA

Verbal Boundary Description

The property in nomination is an irregularly-shaped district generally bounded by South Cooper Street in part on the east, by the back property lines of properties along the north side of Linden Avenue, by Rembert Street on the west, and by the Nashville, Cincinnati and St. Louis Railroad right of way on the south, as delineated on the enclosed Shelby County tax maps.

Boundary Justification

The district being nominated contains the largest contiguous group of historic resources associated with the development of the southeastern quadrant of the Town of Idlewild before and after the annexation by the City of Memphis, as developed in the historic period of ca. 1890 to ca. 1945. Properties adjacent to, but not included in the district, are less than fifty years old and/or are buildings that do not retain their architectural or historical integrity. Properties in the district generally retain the same scale, setback, and character whether they are marked as contributing or noncontributing. The nominated property includes a small commercial area that was an important part of the development of Idlewild.

**United States Department of the Interior
National Park Service**

**National Register of Historic Places
Continuation Sheet**

**Idlewild Historic District
Memphis, Shelby County, TN**

Section number Photographs Page 58

PHOTOGRAPHS

Photo List	Photographs by:	Hopkins & Associates
Idlewild-Lenox Station Historic District	Date:	June 1998
Memphis, Shelby County, TN	Negatives:	Tennessee Historical Commission

- Photo 1 of 23 View of the north side of Courtland Avenue, looking northeast from 1992 Courtland at left.
- Photo 2 of 23 View of 2021 Courtland Avenue, looking south.
- Photo 3 of 23 View of the south side of Peabody Avenue, looking southeast from 2071 Peabody at right.
- Photo 4 of 23 View of 2088 Courtland Avenue, looking north.
- Photo 5 of 23 View of 212 Florence Street, looking northeast.
- Photo 6 of 23 View of the south side of Linden Avenue, looking southeast from 2081 Linden at right.
- Photo 7 of 23 View of the south side of Linden Avenue, looking southeast from 2035 Linden at right.
- Photo 8 of 23 View of the west side of South Cooper Street, looking southwest from 539 South Cooper at right.
- Photo 9 of 23 View of the south side of Carr Avenue, looking southeast from 2067 Carr Avenue, at right.
- Photo 10 of 23 View of the west side of South Cooper Street, looking northwest from 551-553 South Cooper at left.
- Photo 11 of 23 View of the south side of Carr Avenue, looking southwest from 2075 Carr at left.
- Photo 12 of 23 View of the south side of Vinton Avenue, looking southwest from 2029 Vinton at left.
- Photo 13 of 23 View of 2053 Harbert (right) and 2059 Harbert (left), looking southeast.
- Photo 14 of 23 View of the north side of Harbert Avenue, looking northwest from 2028 Harbert at right.
- Photo 15 of 23 View of 2065 Cowden (right) and 2071 Cowden (left), looking southeast.
- Photo 16 of 23 View of 2087 Cowden Avenue, looking southeast.
- Photo 17 of 23 View of the north side of Cowden Avenue, looking northwest from 2026 Cowden at right.
- Photo 18 of 23 View of 2058 Higbee Avenue, looking northwest.
- Photo 19 of 23 View of the north side of Central Avenue, looking northwest from 2058 Central at right.
- Photo 20 of 23 View of the bandstand in Peabody Park, looking north.

United States Department of the Interior
National Park Service

National Register of Historic Places

Continuation Sheet

Idlewild Historic District
Memphis, Shelby County, TN

Section number Photographs Page 59

Photo 21 of 23 View of Peabody Park, looking southwest towards the Skinner Center for the Disabled (712 Tanglewood Street).

Photo 22 of 23 View of the north side of Higbee Avenue, looking northwest from 2110 Higbee at right.

Photo 23 of 23 View of the west side of South Cooper Street looking northwest across its intersection with Peabody Avenue, with 243-247 South Cooper at left, and 237-239 South Cooper at right.

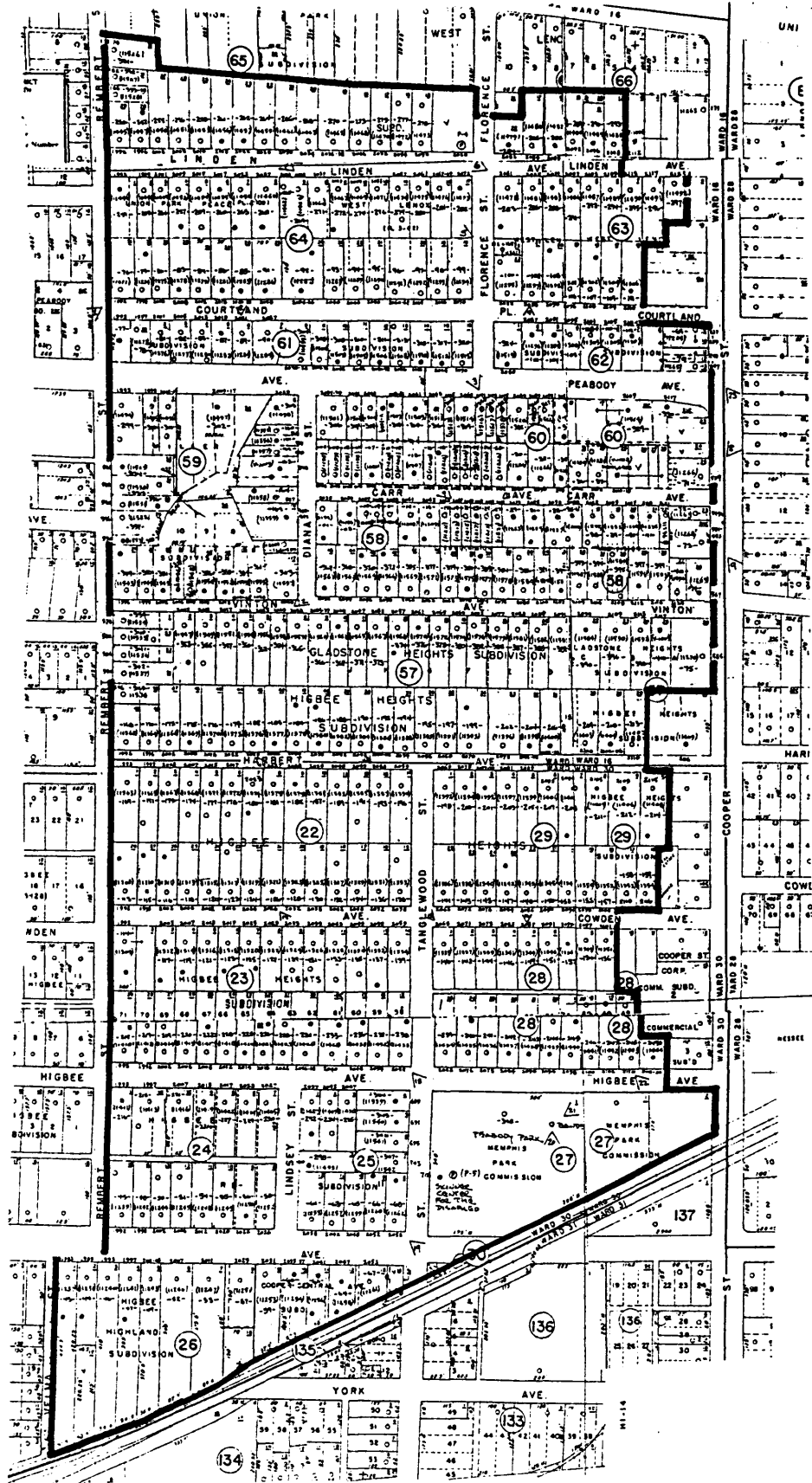

Idlewild Historic District
 Shelby Co. TN - reduced scale map