

United States Department of the Interior  
National Park Service

National Register of Historic Places  
Registration Form

This form is for use in nominating or requesting determinations for individual properties and districts. See instructions in *How to Complete the National Register of Historic Places Registration Form* (National Register Bulletin 16A). Complete each item by marking "x" in the appropriate box or by entering the information requested. If an item does not apply to the property being documented, enter "N/A" for "not applicable." For functions, architectural classification, materials, and areas of significance, enter only categories and subcategories from the instructions. Place additional entries and narrative items on continuation sheets (NPS Form 10-900a). Use a typewriter, word processor, or computer, to complete all items.

1. Name of Property

historic name Buzzard's Roost Historic District

other names/site number n/a

2. Location

street & number 301-400 College, 420-430 Ell, 129-186 Main, School House Rd. <sup>400-415</sup>  not for publication

city or town Ducktown 211 & 215 Highway 68  vicinity

state Tennessee code TN county Polk code 139 zip code 37326

3. State/Federal Agency Certification

As the designated authority under the National Historic Preservation Act, as amended, I hereby certify that this  nomination  request for determination of eligibility meets the documentation standards for registering properties in the National Register of Historic Places and meets the procedural and professional requirements set forth in 36 CFR Part 60. In my opinion, the property  meets  does not meet the National Register criteria. I recommend that this property be considered significant  nationally  statewide  locally. ( See continuation sheet for additional comments.)

Herbert L. Hays 3/16/92  
Signature of certifying official/Title Date  
Deputy State Historic Preservation Officer/ Tennessee Historical Commission  
State of Federal agency and bureau

In my opinion, the property  meets  does not meet the National Register criteria. ( See continuation sheet for additional comments.)

Signature of certifying official/Title Date  
State or Federal agency and bureau

4. National Park Service Certification

I hereby certify that the property is:

- entered in the National Register.  See continuation sheet.
- determined eligible for the National Register  See continuation sheet.
- determined not eligible for the National Register.
- removed from the National Register.
- other, (explain:)

Signature of the Keeper

entered in the

**National Register**

Date of Action

Delores Jones 5/15/92

5. Classification

Ownership of Property  
(Check as many boxes as apply)

Category of Property  
(Check only one box)

Number of Resources within Property  
(Do not include previously listed resources in the count.)

- private
- public-local
- public-State
- public-Federal

- building(s)
- district
- site
- structure
- object

Contributing	Noncontributing	
57	8	buildings
		sites
		structures
		objects
57	8	Total

Name of related multiple property listing  
(Enter "N/A" if property is not part of a multiple property listing.)

Number of contributing resources previously listed  
in the National Register

Historic Resources of the Tennessee Copper Basin 0

6. Function or Use

Historic Functions

(Enter categories from instructions)

DOMESTIC: single dwelling

RELIGION: religious structure

SOCIAL: meeting hall

Current Functions

(Enter categories from instructions)

DOMESTIC: single dwelling

RELIGION: religious structure

SOCIAL: meeting hall

7. Description

Architectural Classification

(Enter categories from instructions)

OTHER: Pyramid Cottage

OTHER: Catslide Cottage

OTHER: Hall and Parlor

Materials

(Enter categories from instructions)

foundation CONCRETE

walls vinyl

ASBESTOS

roof ASPHALT

other aluminum

weatherboard

Narrative Description

(Describe the historic and current condition of the property on one or more continuation sheets.)

Name of Property

County and State

8. Statement of Significance

Applicable National Register Criteria

(Mark "x" in one or more boxes for the criteria qualifying the property for National Register listing.)

- A Property is associated with events that have made a significant contribution to the broad patterns of our history.
B Property is associated with the lives of persons significant in our past.
C Property embodies the distinctive characteristics of a type, period, or method of construction or represents the work of a master, or possesses high artistic values, or represents a significant and distinguishable entity whose components lack individual distinction.
D Property has yielded, or is likely to yield, information important in prehistory or history.

Criteria Considerations n/a
(Mark "x" in all the boxes that apply.)

Property is:

- A owned by a religious institution or used for religious purposes.
B removed from its original location.
C a birthplace or grave.
D a cemetery.
E a reconstructed building, object, or structure.
F a commemorative property.
G less than 50 years of age or achieved significance within the past 50 years.

Areas of Significance

(Enter categories from instructions)

Community Planning & Development

Industry

Architecture

Period of Significance

1904-1941

Significant Dates

1904

Significant Person

(Complete if Criterion B is marked above)

n/a

Cultural Affiliation

n/a

Architect/Builder

Tennessee Copper Company

Narrative Statement of Significance

(Explain the significance of the property on one or more continuation sheets.)

9. Major Bibliographical References

Bibliography (See MPDF Bibliography)

(Cite the books, articles, and other sources used in preparing this form on one or more continuation sheets.)

Previous documentation on file (NPS): n/a

- preliminary determination of individual listing (36 CFR 67) has been requested
previously listed in the National Register
previously determined eligible by the National Register
designated a National Historic Landmark
recorded by Historic American Buildings Survey #
recorded by Historic American Engineering Record #

Primary location of additional data:

- State Historic Preservation Office
Other State agency
Federal agency
Local government
University
Other

Name of repository:

Southeast Tennessee Development District

Name of Property

County and State

10. Geographical Data

Acreage of Property approximately 26 acres

UTM References

(Place additional UTM references on a continuation sheet.)

Ducktown, TENN 133 SW

1 16 738940 3879740
Zone Easting Northing
2 16 738540 3879340

3 16 738290 3879520
Zone Easting Northing
4 16 738690 3879930

See continuation sheet

Verbal Boundary Description

(Describe the boundaries of the property on a continuation sheet.)

Boundary Justification

(Explain why the boundaries were selected on a continuation sheet.)

11. Form Prepared By

name/title Karen L. Daniels/ Historic Preservation Planner
organization Southeast Tennessee Development District date February 1992
street & number 25 Cherokee Boulevard telephone (615) 266-5781
city or town Chattanooga state Tennessee zip code 37405

Additional Documentation

Submit the following items with the completed form:

Continuation Sheets

Maps

- A USGS map (7.5 or 15 minute series) indicating the property's location.
A Sketch map for historic districts and properties having large acreage or numerous resources.

Photographs

Representative black and white photographs of the property.

Additional items

(Check with the SHPO or FPO for any additional items)

Property Owner

(Complete this item at the request of SHPO or FPO.) There are more than 50 property owners in the district.

The local newspaper is the :
name Polk County News
street & number P. O. Box 129 telephone
city or town Benton state Tennessee zip code 37307

Paperwork Reduction Act Statement: This information is being collected for applications to the National Register of Historic Places to nominate properties for listing or determine eligibility for listing, to list properties, and to amend existing listings. Response to this request is required to obtain a benefit in accordance with the National Historic Preservation Act, as amended (16 U.S.C. 470 et seq.).

Estimated Burden Statement: Public reporting burden for this form is estimated to average 18.1 hours per response including time for reviewing instructions, gathering and maintaining data, and completing and reviewing the form. Direct comments regarding this burden estimate or any aspect of this form to the Chief, Administrative Services Division, National Park Service, P.O. Box 37127, Washington, DC 20013-7127; and the Office of Management and Budget, Paperwork Reductions Projects (1024-0018), Washington, DC 20503.

United States Department of the Interior  
National Park ServiceNational Register of Historic Places  
Continuation SheetSection number 7 Page 1Buzzard's Roost Historic District  
Polk County, Tennessee

The Buzzard's Roost Historic District, in Ducktown, Polk County, Tennessee began as an industrial housing development for managers and workers at the Burra Burra Mine.

The area was developed in 1904 and resembles a backward "J" with two bars across the top (see 1923 map, Section 8 page 2). In this subdivision were built one story frame houses for the workers and two story frame houses for the managers.

The buildings are simple in plan and form, consisting mostly, of pyramid cottages and catslide cottages. There is some post 1904 development which occurred when houses burned or were demolished. Most of the houses maintain a uniform setback from the street.

## Inventory of Buildings:

College Street

1. 301 College St. c 1910, Bungalow. One story, concrete foundation, asbestos siding, gable roof, asphalt shingles, rectangular plan. (c)
2. 303 College St. c 1904, Pyramid Cottage. One story, concrete block foundation, asbestos siding, pyramid roof, asphalt shingles, square plan. (c)
3. 304 College St. c 1904, Pyramid Cottage. One story, concrete block foundation, vinyl siding, pyramid roof, asphalt shingles, square plan. (c)
4. 305 College St. c 1904, Pyramid Cottage. One story, concrete block foundation, vinyl siding, pyramid roof, asphalt shingles, square plan. (c)
5. 306 College St. c 1904, Pyramid Cottage. One story, concrete block foundation, vinyl siding, pyramid roof, asphalt shingles, square plan. (c)
6. 307 College St. c 1904, Pyramid Cottage. One story, concrete block foundation, weatherboard siding, pyramid roof, asphalt shingles, square plan. (c)

United States Department of the Interior  
National Park Service

## National Register of Historic Places Continuation Sheet

Section number 7 Page 2

Buzzard's Roost Historic District  
Polk County, Tennessee

---

7. 308 College St. c 1904, Pyramid Cottage. One story, concrete block, vinyl siding, pyramid roof, asphalt shingles, square plan. (c)

8. 309 College St. c 1904, Pyramid Cottage. One story, concrete block foundation, weatherboard siding, pyramid roof, asphalt shingles, square plan. (c)

9. 310 College St. c 1904, Pyramid Cottage. One story, concrete block foundation, vinyl siding, pyramid roof, asphalt shingles, square plan. (c)

10. 311 College St. c 1904, Pyramid Cottage. One story, concrete block foundation, asbestos siding, pyramid cottage, asphalt shingles, square plan. (c)

11. 312 College St. c 1904, Pyramid Cottage. One story, vinyl covered foundation, vinyl siding, pyramid roof, asphalt shingles, square plan. (c)

12. 315 College St. c 1904, Pyramid Cottage. One story, concrete block foundation, aluminum siding, pyramid roof, asphalt shingles, square plan. (c)

### Ell Street

13. 420 Ell St. c 1904, Catslide Cottage. One story, brick foundation, aluminum siding, catslide roof, asphalt shingles, rectangular plan. (c)

14. 421 Ell St. c 1904, Catslide Cottage. One story, concrete block foundation, vinyl siding, catslide roof, asphalt shingles, rectangular plan. (c)

15. 423 Ell St. c 1904, Catslide Cottage. One story, weatherboard sided foundation, asbestos siding, catslide roof, asphalt shingles, rectangular plan. (c)

16. 424 Ell St. c 1904, Catslide Cottage. One story, concrete block foundation, asbestos siding, catslide roof, asphalt shingles, rectangular plan. (c)

17. 425 Ell St. c 1904, Catslide Cottage. One story, stone

United States Department of the Interior  
National Park Service

National Register of Historic Places  
Continuation Sheet

Section number 7 Page 3

Buzzard's Roost Historic District  
Polk County, Tennessee

---

foundation, vinyl siding, catslide roof, asphalt shingles, rectangular plan. (c)

18. 426 Ell St. c 1904, Catslide Cottage. One story, concrete block foundation, asbestos siding, catslide roof, asphalt shingle, rectangular plan. (c)

19. 428 Ell St. c 1904, Catslide Cottage. One story, concrete block foundation, vinyl siding, catslide roof, asphalt shingles, rectangular plan. (c)

20. 430 Ell St. c 1904, Catslide Cottage. One story, concrete block foundation, aluminum siding, catslide roof, asphalt shingles, rectangular plan. (c)

Highway 68

21. 211 Highway 68. c 1904, Pyramid Cottage. One story, concrete block foundation, asbestos siding, pyramid roof, asphalt shingles, square plan. (c)

22. 215 Highway 68. c 1904, Pyramid Cottage. One story, metal sided foundation, asbestos siding, pyramid roof, asphalt shingles, square plan. (c)

Main Street

23. 129 Main St. c 1904 Pyramid Cottage. One story, concrete block foundation, aluminum siding, pyramid roof, asphalt shingles, square plan. (c)

24. 131 Main St. c 1904, Pyramid Cottage. One story, concrete block foundation, pyramid roof, asphalt shingles, square plan. (c)

25. 133 Main St. c 1904, Pyramid Cottage. One story, concrete block foundation, asbestos siding, pyramid roof, asphalt shingles, square plan. (c)

26. 135 Main St. Mine City Baptist Church. 1933, Colonial Revival. Two story, brick foundation, brick siding, gable roof, asphalt shingle, irregular plan. (c)

27. 137 Main St. c 1904, Hall and Parlor. One story, concrete

United States Department of the Interior  
National Park ServiceNational Register of Historic Places  
Continuation SheetSection number 7 Page 4 Buzzard's Roost Historic District  
Polk County, Tennessee

block foundation, aluminum siding, gable roof, asphalt shingles, rectangular plan. (c)

28. 139 Main St. c 1904, Hall and Parlor. One story, concrete block foundation, asbestos siding, gable roof, asphalt shingles, rectangular plan. (c)

29. 141 Main St. c 1904, Hall and Parlor. One story, concrete block foundation, asbestos siding, gable roof, asphalt shingles, rectangular plan. (c)

30. 143 Main St. c 1904, Catslide Cottage. One story, concrete block foundation, aluminum siding, catslide roof, asphalt shingles, rectangular plan. (c)

31. 145 Main St. c 1930, Hall and Parlor. One story, concrete block foundation, aluminum siding, gable roof, asphalt shingles, rectangular plan. (c)

32. 147 Main St. c 1904, Catslide Cottage. One story, concrete block foundation, vinyl siding, catslide roof, asphalt shingles, rectangular plan. (c)

33. 149 Main St. c 1904, Catslide Cottage. One story, concrete block foundation, board and batten siding, gable roof, asphalt shingles, rectangular plan. (c)

34. 150 Main St. c 1960, Ranch. One story, brick foundation, brick siding, gable roof, asphalt shingles, rectangular plan. (nc)

35. 152 Main St. c 1904, Pyramid Cottage. One story, metal sided foundation, aluminum siding, pyramid roof, asphalt shingles, square plan. (c)

36. 153 Main St. c 1904, Catslide Cottage. One story, brick foundation, aluminum siding, gable roof, asphalt shingles, rectangular plan. (c)

37. 154 Main St. c 1904, Pyramid Cottage. One story, concrete block foundation, vinyl siding, pyramid roof, asphalt shingles, square plan. (c)

38. 155 Main St. c 1904, Catslide Cottage. One story, concrete



United States Department of the Interior  
National Park ServiceNational Register of Historic Places  
Continuation SheetSection number 7 Page 5 Buzzard's Roost Historic District  
Polk County, Tennessee

block foundation, asbestos siding, gable roof, asphalt shingles, rectangular plan. (c)

39. 156 Main St. Masonic Lodge. c 1910, Commercial. Two story, brick foundation, brick siding, gable roof, asphalt shingles, rectangular plan. (c)

40. 157 Main St. c 1904, Catslide Cottage. One story, concrete block foundation, vinyl siding, gable roof, asphalt shingles, irregular plan. (c)

41. 158 Main St. c 1904, Pyramid Cottage. One story, concrete block foundation, asbestos siding, pyramid roof, asphalt shingles, square plan. (c)

42. 159 Main St. c 1980, Ranch. One story, brick foundation, vinyl siding, gable roof, asphalt shingles, rectangular plan. (nc)

43. 160 Main St. c 1904, Four Square. Two story, concrete block foundation, asbestos siding, gable roof, asphalt shingle, irregular plan. (c)

44. 162 Main St. c 1904, Four Square. Two story, concrete block foundation, vinyl siding, gable roof, asphalt shingles, irregular plan. (c)

45. 164 Main St. c 1980, Mobile Home. One story, concrete block foundation, metal siding, gable roof, asphalt shingles, rectangular plan. (nc)

46. 166 Main St. c 1980, Ranch. One story, concrete block foundation, vinyl siding, gable roof, asphalt shingles, rectangular plan. (nc)

47. 168 Main St. c 1904, Hall and Parlor. One story, concrete block foundation, weatherboard siding, gable roof, asphalt shingles, rectangular plan. (c)

48. 170 Main St. c 1904, Hall and Parlor. One story, concrete block foundation, vinyl siding, gable roof, asphalt shingles, rectangular plan. (c)

49. 172 Main St. c 1904, Hall and Parlor. One story, concrete

United States Department of the Interior  
National Park Service

National Register of Historic Places  
Continuation Sheet

Section number 7 Page 6 Buzzard's Roost Historic District  
Polk County, Tennessee

---

block foundation, asbestos siding, gable roof, asphalt shingles, rectangular plan. (c)

50. 174 Main St. c 1904, Catslide Cottage. One story, board and batten covered foundation, asbestos siding, gable roof, asphalt shingles, rectangular plan. (c)

51. 176 Main St. c 1904, Catslide Cottage. One story, concrete block foundation, asbestos siding, gable roof, asphalt shingles, rectangular plan. (c)

52. 180 Main St. c 1970, Mobile Home. One story, metal foundation, metal siding, flat roof, asphalt shingles, rectangular plan. (nc)

53. 182 Main St. c 1904, Catslide Cottage. One story, stucco foundation, asbestos siding, gable roof, asphalt shingles, rectangular plan. (c)

54. 184 Main St. c 1904, Catslide Cottage. One story, concrete block foundation, weatherboard siding, gable roof, asphalt shingles, rectangular plan. (c)

55. 186 Main St. c 1904, Catslide Cottage. One story, concrete block foundation, vinyl siding, gable roof, asphalt shingles, rectangular plan. (c)

56. 188 Main St. c 1904, Catslide Cottage. One story, concrete block foundation, vinyl siding, gable roof, asphalt shingles, rectangular plan. (c)

School House Road

57. 400 School House Rd. c 1904, Pyramid Cottage. One story, concrete block foundation, vinyl siding, pyramid roof, asphalt shingles, square plan. (c)

58. 401 School House Rd. c 1904, Catslide Cottage. One story, concrete block foundation, asbestos siding, gable roof, asphalt shingles, rectangular plan. (c)

59. 402 School House Rd. c 1970, Mobile Home. One story, metal foundation, metal siding, flat roof, metal roofing, rectangular

United States Department of the Interior  
National Park Service

National Register of Historic Places  
Continuation Sheet

Section number 7 Page 7 Buzzard's Roost Historic District  
Polk County, Tennessee

---

plan. (nc)

60. 405 School House Rd. c 1904, Catslide Cottage. One story, asbestos siding, gable roof, asphalt shingles, rectangular plan. (c)

61. 407 School House Rd. c 1904, Catslide Cottage. One story, concrete block foundation, vinyl siding, gable roof, asphalt shingles, rectangular plan. (c)

62. 409 School House Rd. c 1904, Catslide Cottage. One story, vinyl covered foundation, asbestos siding, gable roof, asphalt shingles, rectangular plan. (c)

63. 411 School House Rd. c 1970, Mobile Home. One story, metal foundation, metal siding, flat roof, metal roofing, rectangular plan, side addition. (nc)

64. 413 School House Rd. c 1904, Catslide Cottage. One story, weatherboard covered foundation, aluminum siding, gable roof, asphalt shingles, rectangular plan. (c)

65. 415 School House Rd. c 1980, Ranch. One story, concrete block foundation, concrete block siding, gable roof, asphalt shingles, rectangular plan. (nc)

United States Department of the Interior  
National Park Service

## National Register of Historic Places Continuation Sheet

Section number 8 Page 1 Buzzard's Roost Historic District  
Polk County, Tennessee

---

The Buzzard's Roost Historic District, in Ducktown, Polk County, Tennessee is eligible for the National Register under criterion A for its association with the mining industry and as an example of community planning in the Basin. It is also eligible under criterion C for its significance in the architectural development of the Basin.

Buzzard's Roost was developed in 1904 because there was a shortage of housing in Ducktown due to its rapid growth at the beginning of the second stage of mining development. The sub-division was planned to accommodate 85 houses, a church, and a meeting hall. Although the original plan for the community has not been found, a 1923 drawing of residential lots that TCC acquired adjacent to Buzzard's Roost shows the original plan, and the location and plan of houses in Buzzard's Roost. Buzzard's Roost was developed according to this plan, which is still evident, even though there are vacant lots along the edges of the plan.

Buzzard's Roost was the only company sponsored residential development in Ducktown to occur. TCC felt an obligation, in the face of public pressure, to develop some land it owned for residential use, and Buzzard's Roost was the result. The housing represents the company's attitude toward its workers housing. Unlike any other company owned residential development in the Basin, Buzzard's Roost mixed managers' and workers' houses.

Residents of Buzzard's Roost worked in the Burra Burra Mine, just northeast of the area. Burra Burra was one of the most important mines to operate in the Basin during the 20th century.

Buzzard's Roost contains an excellent example of well maintained early 20th century workers' housing. It is believed that the houses were purchased from a stock plan company, and erected on the site. The houses remain, relatively unaltered, excellent examples of stock plan housing which allowed industry to inexpensively construct housing for its workers.

United States Department of the Interior  
National Park Service

National Register of Historic Places  
Continuation Sheet

Section number 8 Page 2 Buzzard's Roost Historic District

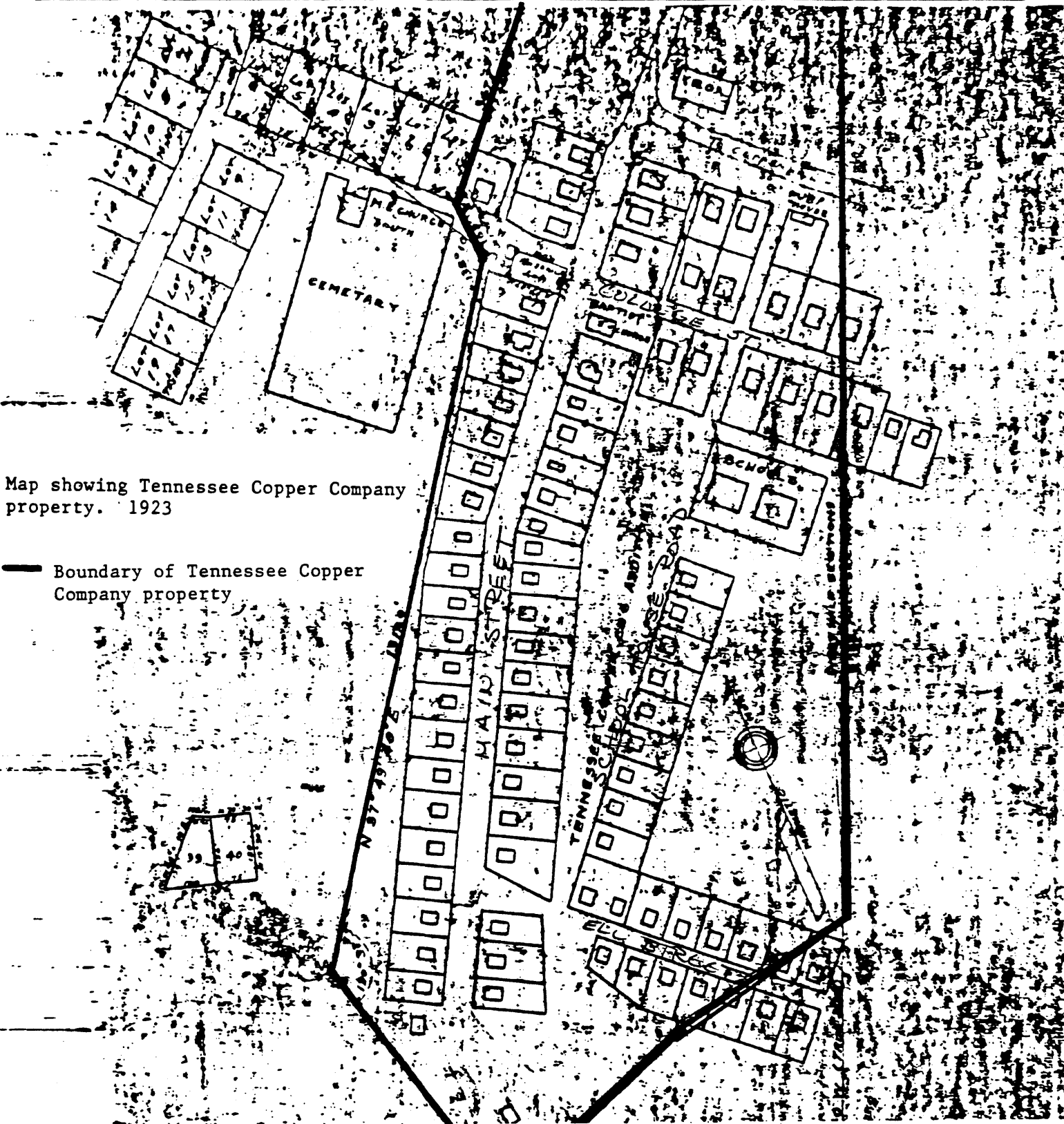

Map showing Tennessee Copper Company property. 1923

— Boundary of Tennessee Copper Company property

United States Department of the Interior  
National Park Service

## National Register of Historic Places Continuation Sheet

Section number 10 Page 1 Buzzard's Roost Historic District  
Polk County, Tennessee

---

### Verbal Boundary Description and Justification

The Buzzard's Roost Historic District is bounded by State Route 68 on the north, the corporate limits of Ducktown on the east, the rear property lines of the properties on the west side of main Street on the west and south. See Ducktown, Polk County, Tennessee tax maps 115-F and 115-C. The area nominated is the area planned as the Buzzard's Roost subdivision.

United States Department of the Interior  
National Park Service

National Register of Historic Places  
Continuation Sheet

Section number Photo Page 1 Buzzard's Roost Historic District  
Polk County, Tennessee

---

Buzzard's Roost Historic District  
Ducktown, Polk County, Tennessee  
Photos by: Karen L. Daniels  
Date: May 1991; August 1991  
Neg: Tennessee Historical Commission  
Nashville, Tennessee

# 1 of 11  
Looking south along Main Street and Highway 68.

#2 of 11  
Looking north along Main Street.

# 3 of 11  
Looking south along Main Street.

# 4 of 11  
Looking east toward School House Road from Main Street.

# 5 of 11  
Looking south along Main Street from College.

# 6 of 11  
Looking east along College from School House Rd.

# 7 of 11  
Overview of Buzzard's Roost from hill.

# 8 of 11  
Ell and School House Rd. from hill.

# 9 of 11  
Catslide Cottage.

# 10 of 11  
Looking north along Main Street from College.

# 11 of 11  
Pyramid Cottage.