

NPS Form 10-900
(Rev. 8-86)

OMB No. 1024-0018

United States Department of the Interior
National Park Service

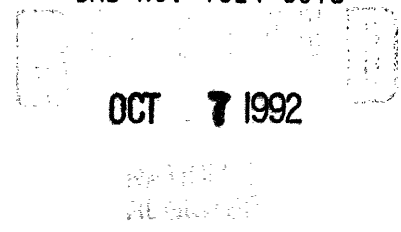

NATIONAL REGISTER OF HISTORIC PLACES
REGISTRATION FORM

=====

1. Name of Property

=====

historic name: Church of the Crossroads

other name/site number: _____

=====

2. Location

=====

street & number: 1212 University Avenue

not for publication: _____

city/town: Honolulu

vicinity: _____

state: HI county: Honolulu code: 003 zip code: 96822

=====

3. Classification

=====

Ownership of Property: private

Category of Property: building

Number of Resources within Property:

Contributing	Noncontributing	
<u>4</u>	<u>0</u>	buildings
_____	_____	sites
_____	_____	structures
_____	_____	objects
<u>4</u>	<u>0</u>	Total

Number of contributing resources previously listed in the National Register: 0

Name of related multiple property listing: NA

=====

4. State/Federal Agency Certification

=====

As the designated authority under the National Historic Preservation Act of 1986, as amended, I hereby certify that this X nomination _____ request for determination of eligibility meets the documentation standards for registering properties in the National Register of Historic Places and meets the procedural and professional requirements set forth in 36 CFR Part 60. In my opinion, the property X meets _____ does not meet the National Register Criteria. _____ See continuation sheet.

[Signature] _____ 9/29/92
Signature of certifying official Date

State Historic Preservation Officer
State or Federal agency and bureau

In my opinion, the property _____ meets _____ does not meet the National Register criteria. _____ See continuation sheet.

Signature of commenting or other official Date

State or Federal agency and bureau

=====

5. National Park Service Certification

=====

I, hereby certify that this property is:

- entered in the National Register _____ Antoinette Lee _____ 11/20/92
_____ See continuation sheet.
- determined eligible for the National Register _____
_____ See continuation sheet.
- determined not eligible for the National Register _____
- removed from the National Register _____
- other (explain): _____

for Signature of Keeper Date of Action

=====

6. Function or Use

=====

Historic: <u>Religion</u>	Sub: <u>religious structure</u>
<u>Social</u>	<u>meeting hall</u>
	<u>clubhouse</u>
Current : <u>Religion</u>	Sub: <u>religious structure</u>
<u>Social</u>	<u>meeting hall</u>
	<u>club house</u>

=====

7. Description

=====

Architectural Classification:

other

Other Description: Hawaiian, Art Deco, Asian

Materials: foundation concrete roof shingle

walls concrete other NA

Describe present and historic physical appearance. X See continuation sheet.

The Church of the Crossroads site has four interconnected buildings placed around an open grassy court. The connecting colonnade has red columns and a hipped roof. It was built to recall the Summer Palace outside of Beijing.

At the makai end of the courtyard is the sanctuary (or chapel) with an attached Music Tower on the east side. The colonnade connecting the buildings leads to a lanai, which provides access to the chapel through three doors of monkey pod wood. The building is constructed of concrete faced with plaster. Patterned concrete blocks, dyed a light green, are used in vertical panels at the corners of the chapel, between the chapel doors, and at the center of the concrete shaft of the Music Tower. The blocks have marble filings added to the concrete mix to give them additional texture.

The concrete blocks have reliefs of geometric forms and stylized tropical plants. Conventionalized leaf forms of the ape' (elephant ear) and the banana are cast into the exposed faces of the blocks. The cast panels between the doors have a pattern recalling the pandanus or hala tree.

All exposed wood in the complex is stained or treated with lye and lime. Most finish wood is given the latter treatment.

The chapel is cruciform in plan with movable seating in the nave. The transepts provide room for the choir and a small mortuary chapel. Originally, the transept to the left was a library; the one to the right was the music room. Sliding glass doors (no longer extant) closed them off from the nave. Interior lighting is provided by clerestory jalousie windows, which alternate with wooden panels. The wall below has three long jalousie windows on the left side and three such windows on the right side. The roof is supported by an exposed wood truss.

United States Department of the Interior
National Park Service

NATIONAL REGISTER OF HISTORIC PLACES
CONTINUATION SHEET

Section number 7

Church of the Crossroads

Page 1

The altar area is noted for its carvings by Honolulu artist Marguerite Blasingame. She created the lectern and pulpit of Philippine mahogany. There are four carved panels, each representing a great ethnic faith: Zoroastrianism, Judaism, Buddhism, and Hinduism. The human hand serves as a unifying motif for the work.

Two small buildings on the east and southwest ends of the colonnade are nearly identical and have a Japanese influence, with low roof lines and a wood and glass construction. These now house classrooms, a library, and meeting and craft rooms. Both were built around 1937. The building to the east was the original "Home Room." The more elaborate of the two, it has lauhala covered walls, ohia wood trim, and a fireplace. The court was closed with the 1957 addition of the Administration Building. It houses a kitchen, auditorium and offices. The auditorium has a vented gable roof facing the courtyard. The main roof is two intersecting hip roofs. All the buildings are roofed with wood shingles.

All the buildings on the site, with the exception of the Administration Building, were designed by Claude Stiehl. The administration block was designed by Honolulu architect Ernest Hara. The sanctuary was built by H.H. Philips. The Administration Building was built by K & M Sakamoto. There have been no additions or substantial alterations.

=====
8. Statement of Significance
=====

Certifying official has considered the significance of this property in relation to other properties: statewide.

Applicable National Register Criteria: A, C
Criteria Considerations (Exceptions) : A

Areas of Significance: architecture
social history

Period(s) of Significance: 1934-1937

Significant Dates : 1923 1935 1937

Significant Person(s): NA

Cultural Affiliation: NA

Architect/Builder: Claude A. Stiehl

State significance of property, and justify criteria, criteria considerations, and areas and periods of significance noted above.
X See continuation sheet.

The Church of the Crossroads is significant for its historical associations and as a building complex representative of the search for a regional architectural style in Hawaii in the 1930s.

The Church of the Crossroads was founded in 1923 by students of the Mid-Pacific Institute and of McKinley High School as Hawaii's first interracial congregation. The church developed as a result of a conference held at the Nuuanu Y.M.C.A. in February of 1922, whose purpose was to consider "the establishment of a service of worship for young people of all races in the English language." From its initial organization, the Church of the Crossroads has emphasized community interaction, been multi-racial and attempted to eliminate distinctions between members and non-members. It was also an early innovator in many forms of community interaction and forms of worship. The Church of the Crossroads has been very active in the community from its beginning. Besides its own functions it also provides space for other community programs.

The architecture of the complex draws from many sources in an allusion to the diverse ethnic, religious, and social backgrounds that make up Hawaii. The buildings integrate Eastern, Hawaiian, and Art Deco vocabularies to create architectural links between the present and the past. The sensitivity of scale, the detailing, and the integration of art and architecture within the group make

United States Department of the Interior
National Park Service

NATIONAL REGISTER OF HISTORIC PLACES
CONTINUATION SHEET

Section number 8

Church of the Crossroads

Page 1

=====
it a significant architectural complex within the State of Hawaii. Each building has been well maintained and the integrity of the original design has been preserved. The additions have strengthened the composition by creating a unified complex around a landscaped court. Therefore, the 1957 Administration Building is included within this nomination because it completed the sanctuary complex and thus significantly contributes to one's preception and experience of the enclosed courtyard and the continuous linking colonnade.

The Church complex is also significant as the master work of architect Claude Stiehl. Stiehl was one of a number of architects who came to work in Hawaii in the 1930s. Stiehl was graduated from the Art Institute of Chicago and Armour Institute of Technology with a degree in architecture. He furthered his studies in England, France and Germany. In 1929 Stiehl worked in the office of George Washington Smith in Santa Barbara, California, designing residences. In October 1929 Stiehl came to Honolulu and was employed in the offices of C. W. Dickey. He worked on the projects for the Kamehameha Schools and the Halekulani Hotel, as well as on residential designs. After a two year visit to the mainland, 1931-32, Stiehl returned to Honolulu to set up his own practice. In addition to the Church of the Crossroads, he designed Atherton Hall at Halekipa, the Kawaiahao Chapel, the Hawaii Performing Arts Theater in Manoa, Hemenway Hall at the University of Hawaii, and a number of residences. His designs are noted for their mixture of styles to create buildings which reflect the mixed ethnic heritage of the islands.

=====

9. Major Bibliographical References

=====

Church of the Crossroads commemorative booklet
Hemphill, Betty. The Crossroads Witness. Honolulu: Church of the
Crossroads, 1988.

Mason, Glenn. Church of the Crossroads NR eligibility nomination

Previous documentation on file (NPS):

- preliminary determination of individual listing (36 CFR 67) has been requested.
- previously listed in the National Register
- previously determined eligible by the National Register
- designated a National Historic Landmark
- recorded by Historic American Buildings Survey # _____
- recorded by Historic American Engineering Record # _____

Primary Location of Additional Data:

- State historic preservation office
- Other state agency
- Federal agency
- Local government
- University
- Other -- Specify Repository: _____

=====

10. Geographical Data

=====

Acreeage of Property: less than 1

UTM References: Zone Easting Northing Zone Easting Northing

A 04 621930 2355310 B _____
C _____ D _____

___ See continuation sheet.

Verbal Boundary Description: ___ See continuation sheet.

This nomination includes the portion of TMK 2-8-06:17 indicated in the attached sketch map.

Boundary Justification: ___ See continuation sheet.

This nomination includes the property immediately surrounding the buildings which frame the Church of the Corsroads chapel courtyard and that is historically associated with the property.

=====

11. Form Prepared By

=====

Name/Title: Rev. Neal MacPherson

Organization: Church of the Crossroads Date: May 1, 1991

Street & Number: 1212 University Avenue Telephone: 949-2220

City or Town: Honolulu State: HI ZIP: 96822

H-1 FREEWAY

STATE OF HAWAII

253.43

UNIVERSITY AVENUE

232.86

49.75

73.96

2459

299.82

49.41

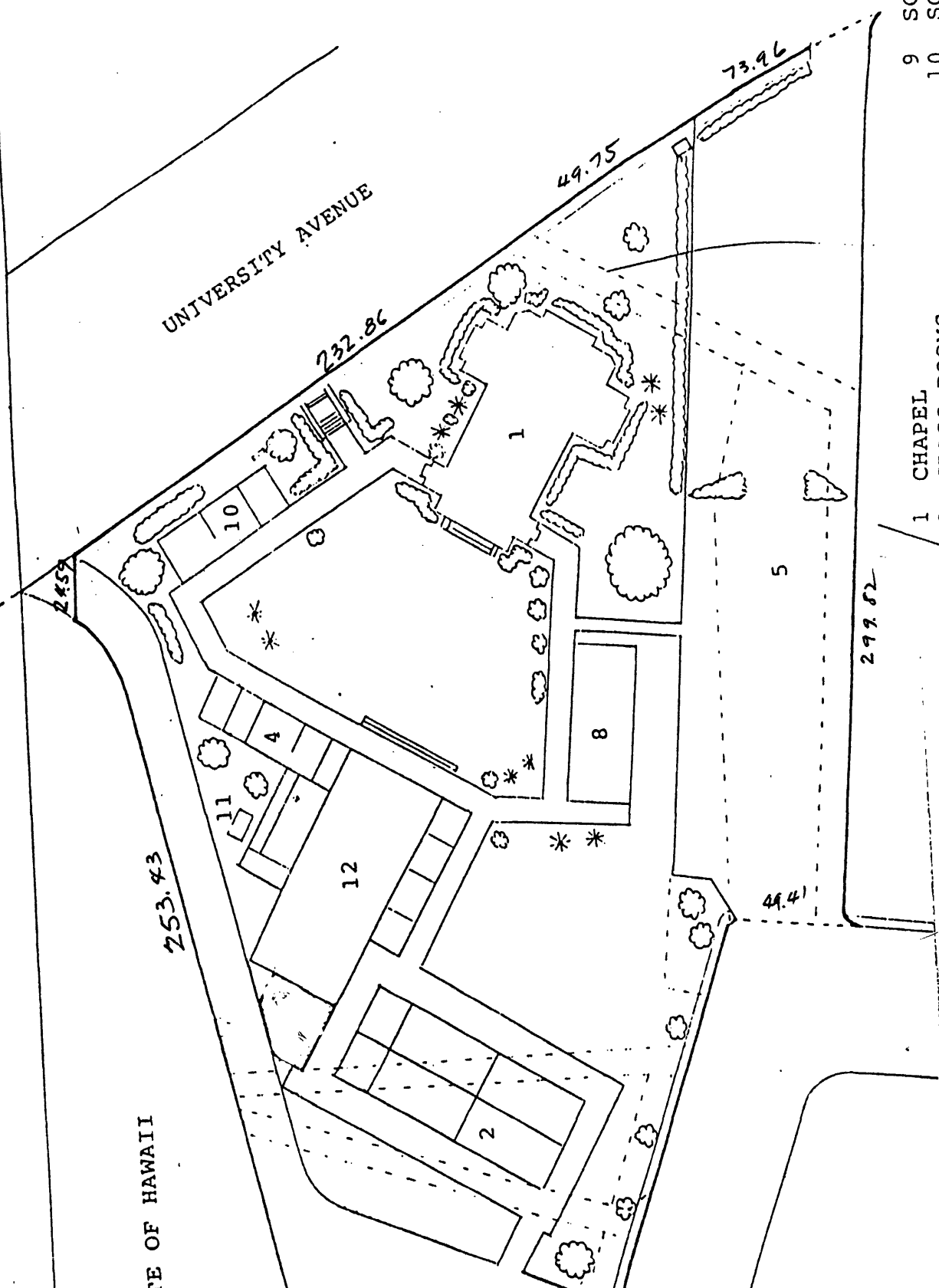

- 9 SCHENCK HALL
- 10 SCUDDER ROOM
- 11 TOOL SHED
- 12 WEAVER HALL
- * COCONUT TREES
- ☐ SHRUBS/BUSHES
- ☁ TREES

- 1 CHAPEL
- 2 CLASS ROOMS
- 3 COTTAGE - 2474 BINGHAM
- 4 OFFICE/ADMINISTRATION
- 5 PARKING LOT
- 6 PARSONAGE - 2468 BINGHAM
- 7 POTTERY
- 8 ROSS DAVIS ROOM

SITE PLAN
NOT TO SCALE

United States Department of the Interior
National Park Service

National Register of Historic Places
Continuation Sheet

Section number _____ Page _____

SUPPLEMENTARY LISTING RECORD

NRIS Reference Number: 92001551

Date Listed: 11/20/92

Church of the Crossroads
Property Name

Honolulu
County

HI
State

N/A
Multiple Name

This property is listed in the National Register of Historic Places in accordance with the attached nomination documentation subject to the following exceptions, exclusions, or amendments, notwithstanding the National Park Service certification included in the nomination documentation.

for *Robert A. Lee*
Signature of the Keeper

11/20/92
Date of Action

=====
Amended Items in Nomination:

Classification: The numer of resources within property should be amended to read 3 contributing buildings and 1 non-contributing building. (The 1957 Administration Building is classified as a non-contributing building, but within the boundary of the property.)

This information was confirmed with Carol Ogata of the Hawaii State Historic Preservation Division.

DISTRIBUTION:

- National Register property file
- Nominating Authority (without nomination attachment)