

ARCHITECTURAL/HISTORICAL SURVEY

DAVENPORT, IOWA

The Architects Office
 Wehner, Nowysz, Pottschiull and Pfiffner
 201 day building, Iowa city Iowa 50240

DAVENPORT COMMUNITY DEVELOPMENT DEPARTMENT
 IOWA DIVISION OF HISTORIC PRESERVATION

SITE #82-10- 3-W2108 MAP # 2

HIST. DIST. _____

NAME Samuel Hoffmann, Jr. House (H) C

ADDRESS 2108 W. ^{3rd} Third Street

LEGAL DES. J.M.F. Hall's Add. 1 2
SUB-DIVISION BLOCK PARCEL SUB-PARCEL

UTM 15 6991450 4599310 ACREAGE -1 ZONE C-2
EASTING NORTHING

OWNER R. Max Adams and wife
2108 W. Third St., Davenport, IA
52802

TITLE H. _____
 (IF DIFF)

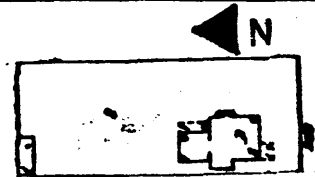

SITE SHEET

DESCRIPTION

FORM 2 story pinwheel type w/hipped roof & cornice veranda CONST. DATE 1888
 MATERIALS Frame w/brick foundation ARCH STYLE Stick/Eastlake
 FENESTRATION Rectangular
 DIST. FEATURES Patterned bargeboard and gables
 ALTERATIONS Veranda rebuilt in c. 1915
 SITE & RELATED STR. Nothing of significance

STATEMENT

Although bearing a later veranda, this house remains an excellent example of Stick Style/Eastlake influence on popular domestic architecture in Davenport. Ornament is of the flat, scroll-saw type, along with diagonal and short vertical stickwork elements at gable ends. The detail is continued on molded bargeboards and decorative strips applied to the projecting window bay on the east side. The veranda does not really detract from the house: Its details are simple and rather geometric, and thus complement those of the house itself.

SOURCES

ARCHITECTURE

ICANCE

HISTORY

DESCRIPTION

Samuel Hoffman, Jr. built this house in 1888 in the west end German-American neighborhood. Hoffman worked as a bookkeeper for the German Savings Bank, the predecessor of the American Commercial and Savings Bank (Davenport Bank and Trust Company).

SOURCES

City Directories, 1885-86, 1887, 1888-89, 1890-91.

ARCHITECTURAL HISTORIAN: Martha Bowers | HISTORIAN: MARLYS SVENDSEN-ROESLER | SURVEY COMP 1981

EVALUATION

ARCHITECTURAL

- I. ARCH. EVALUATION Good
- II. ENVIR. STATURE Tissue
- III. INT. OF CONTEXT Excellent
- IV. INT. OF FABRIC Excellent

LEVEL OF SIGNIFICANCE:

- NAT. STATE LOCAL N. ELIG.

HISTORICAL

I. THEME(S) OF SIGNIFICANCE:

- A. PRIMARY _____
- B. SECONDARY _____

II. LEVEL OF SIGNIFICANCE:

- NAT. STATE LOCAL

III. NRHP

- ELIGIBLE NOT ELIGIBLE

HISTORIC DISTRICT CLASSIFICATION

FOR DIVISION OF HISTORIC PRESERVATION USE ONLY

1 DATE RECEIVED _____

2 DATE OF STAFF EVALUATION _____

- | | | |
|---------------------------|--------------------------|--------------------------|
| | A. ARCHITECTURAL | B. HISTORICAL |
| ELIGIBLE FOR N.R.H.P. | <input type="checkbox"/> | <input type="checkbox"/> |
| NOT ELIGIBLE FOR N.R.H.P. | <input type="checkbox"/> | <input type="checkbox"/> |

3. NRHP ACTION

- A STATE REVIEW COMM. APP DISAPP TABLED DATE _____
- B FEDERAL REVIEW APP DISAPP TABLED DATE _____

4 D.H.P. SOURCES

- COUNTY RESOURCES
- WSHIELD SURVEY
- NRHP
- GRANT _____
- DET. OF ELIGIBILITY
- R. & C _____
- DAVENPORT A/H SURVEY
- _____
- _____

5 SUBJECT TRACES

6 PHOTO
1602-2

