

RECEIVED  
MAY 22 1990

**NATIONAL REGISTER**

NPS FORM 10-900 (Rev. 8-86) OMB No. 1024-0018 [SD-SHPO # ECA-OH-597-1/89]  
[use paper with at least 25% cotton rag content, use NLQ or LQ printer]

United States Department of the Interior -- National Park Service  
NATIONAL REGISTER OF HISTORIC PLACES -- REGISTRATION FORM

This form is for use in nominating or requesting determinations of eligibility for individual properties or districts. See instructions in Guidelines for Completing National Register Forms (National Register Bulletin 16). Complete each item by marking "x" in the appropriate box or by entering "NA" for "not applicable." For functions, styles, materials, and areas of significance, enter only the categories and subcategories listed in the instructions. For additional space use continuation sheets (Form 10-900a). Type all entries.

1. Name of Property

historic name: Young, Edna, and Ernest, Ranch  
other name/ site number: CU-DY-13

2. Location

street & number: approximately 3 miles south of Dewey /NA/ not for publication  
city, town: Custer /XX/ vicinity  
state: SOUTH DAKOTA code: SD county: Custer code: SD 033 zip code: 57730

3. Classification

| Ownership of Property: | Category of Property | Number of Resources within Property: |                 |            |
|------------------------|----------------------|--------------------------------------|-----------------|------------|
|                        |                      | Contributing                         | Noncontributing |            |
| /XX/ private           | / / building(s)      | 13                                   |                 | buildings  |
| / / public-local       | /XX/ district        |                                      |                 | sites      |
| / / public-state       | / / site             | 1                                    | 1               | structures |
| / / public-federal     | / / structure        |                                      |                 | objects    |
|                        | / / object           | 14                                   | 1               | Total      |

Name of related multiple property listing: Ranches of Southwestern Custer County, SD  
Number of contributing resources previously listed in the National Register: 0

11. Form Prepared by

name/title: Rebecca Sample Bernstein, Preservation Consultant  
organization: Custer County Board of Commissioner date: January 17, 1990  
street & number: 420 Mt. Rushmore Road telephone: 605-673-4815  
city or town: Custer state: SOUTH DAKOTA zip code: 57730

page 2: Edna & Ernest Young Ranch  
property name

, Custer County  
county

, SOUTH DAKOTA  
state

4. State/Federal Agency Certification

As the designated authority under the National Historic Preservation Act of 1966, as amended, I hereby certify that this /  nomination / / request for determination of eligibility meets the documentation standards for registering properties in the National Register of Historic Places and meets the procedural and professional requirements set forth in 36 CFR Part 60. In my opinion, the property /  meets / / does not meet the National Register criteria. / / See continuation sheet.

*Dr. J. M.* Signature of certifying official      5/18/90 Date

S. O. Holt SHPO  
State or Federal agency or bureau

In my opinion, the property / /meets / / does not meet the National Register Criteria.  
/ / See continuation sheet.

\_\_\_\_\_  
Signature of commenting or other official      Date

\_\_\_\_\_  
State or Federal agency or bureau

5. National Park Service Certification

I, hereby, certify that this property is:

- entered in the National Register
- \_\_\_\_ see continuation sheet
- \_\_\_\_ determined eligible for the National Register
- \_\_\_\_ see continuation sheet
- \_\_\_\_ determined not eligible for the National Register
- \_\_\_\_ removed from the National Register
- \_\_\_\_ other, (explain) \_\_\_\_\_

*Mark J. Baker* Entered in the National Register      5 July 1990

*for* Signature of the Keeper      Date

page 3: Edna & Ernest Young Ranch  
property name

, Custer  
county

, SOUTH DAKOTA  
state

**6. Function or Use** (enter categories from instructions)

Historic functions:

DOMESTIC/Single Dwelling  
AGRICULTURE/Animal Facility  
AGRICULTURE/Storage  
AGRICULTURE/Agricultural Outbuilding

Current Functions:

DOMESTIC/Single Dwelling  
AGRICULTURE/Animal Facility  
AGRICULTURE/Storage  
AGRICULTURE/Agricultural Outbuilding

---

**7. Description**

Architectural Classification:

(enter categories from instructions)  
No Style

Materials:

(enter categories from instructions)  
foundation Stone, Wood  
walls Stone, Wood,  
Metal  
roof Metal, Wood, Earth  
other NA

---

Describe present and historic physical appearance:      /XX/ see continuation sheet

---

**8. Significance**

Certifying official has considered the significance of this property in  
relation to other properties: / /      / /      /XX/  
   nationally      statewide      locally

Applicable National Register Criteria    /XX/ A    / /B / /C / /D

Criteria Considerations / /A / /B / /C / /D / /E / /F / /G

Areas of Significance (enter from instructions)

Exploration/Settlement

Period of Significance  
circa 1912-1940

Significant Dates  
NA

Significant Person  
NA

Cultural Affiliation  
NA

Architect/Builder  
Unknown

State significance of property, and justify criteria, criteria considerations,  
and periods of significance noted above      /XX/ see continuation sheet

United States Department of the Interior  
National Park ServiceNational Register of Historic Places  
Continuation SheetSection number 7 Page 1

Nestled in a small, remote depression, the Edna and Ernest Young Ranch is located about three miles south of Dewey and one-half mile east of the Wyoming border. The approach to the ranch is a six-mile-long, winding, hilly dirt driveway.

## List of Resources:

1. House: (Contributing), c. 1912; A most impressive component of the ranch is the red sandstone masonry house, the material for which was quarried from the nearby "racetrack" of the Black Hills formation. \* Oriented to the east, the rectangular stone dwelling is capped by a gambrel roof covered with tin panels. The gable ends are sheathed with white asphalt shingles. Two shed-roofed dormers project from the roof on the east and west facades. A wood frame summer kitchen is attached to the northwest corner of the main block of the house. The fenestration and floor plan are irregular. An open shed-roofed porch of recent construction shades the east (front) facade. This porch is a near replica of the original unit that was removed in the mid-1960s. It is the only rural building erected of red sandstone located during the summer 1988 historic sites survey of western Custer County.
2. Bunkhouse: (Contributing), c. 1912 - 1940; The bunkhouse is a stucco-covered wood frame building capped by tin-clad gable roof.
3. Small House: (Contributing), c. 1912 - 1940; The small house is one story, rectangular pen building resting on a simple wood sill. Its wood frame walls are covered with clapboard and tar paper. The gable roof is also covered with tar paper. Locally, this type of smaller dwelling is often called the "mother-in-law house," because it is generally where the grandparents and in-laws lived.
4. Privy: (Contributing), c. 1912 - 1940, The wood frame privy rises from a wood sill and is capped by a board-covered gable roof.

\*

---

The "racetrack" or Red Valley is an almost continuous band of redish sandy clay, shale, and sandstone that encircles the Black Hills formation just inside the foothills (known as the Hogback Ridge). Varying in width and elevation, these salty, dry soils date from the Triassic and Jurassic geologic periods and do not support complex vegetation. Therefore, unlike the rest of the Black Hills region, the red valley is generally treeless. [Sven G. Froiland, Natural History of the Black Hills, (Sioux Falls, SD: Augustana College, Center for Western Studies, 1982), p. 16.]

**United States Department of the Interior  
National Park Service**

**National Register of Historic Places  
Continuation Sheet**

Section number 7 Page 2

---

5. Granary: (Contributing), c. 1912 - 1940; The granary is a rectangular pen wood frame structure rising from stone piers. It is capped by a tin-covered shed roof.

6. Granary: (Noncontributing), n.d.; The second granary is a modern round metal bin with a conical metal roof.

7. Sheep Wagon: (Contributing), c. 1912 - 1940; The sheep wagon is a small frame building with a segmental arch roof all clad with tar paper. Once mounted on wheels, it was moved to pasture ranges to provide domestic shelter for persons who tended grazing sheep herds. Such facilities frequently are found on ranches in the survey area.

8. Garage: (Contributing), c. 1912 - 1940; Resting on a stone foundation, the garage is a large wood frame building clad with stucco and capped by a tar paper-covered gable roof.

9. Small Garage: (Contributing), c. 1912 - 1940; The small one-car garage is a wood frame building covered with stucco and capped by a tin-clad segmental-arch roof.

10. Livestock Building: (Contributing), c. 1912 - 1940; The livestock building is a wood frame building capped by a low gable roof.

11. Oil Storage Building: (Contributing), c. 1912 - 1940; The oil storage building is a wood frame building capped with a gable roof.

12. Log Outbuilding: (Contributing), c. 1912 - 1940; The log outbuilding is a small rectangular shed constructed of rough hewn logs with double vertical corner notches. Interstices are chinked with plaster and cement. The gable roof is covered with native sod.

13., 14., and 15. Sheds: (Contributing), c. 1912 - 1940; The sheds are all rectangular pen, wood frame buildings with shed roofs. All of them are used for working livestock.

**United States Department of the Interior  
National Park Service**

**National Register of Historic Places  
Continuation Sheet**

Section number   7   Page   3  

---

YOUNG RANCH SITE MAP ON REVERSE SIDE

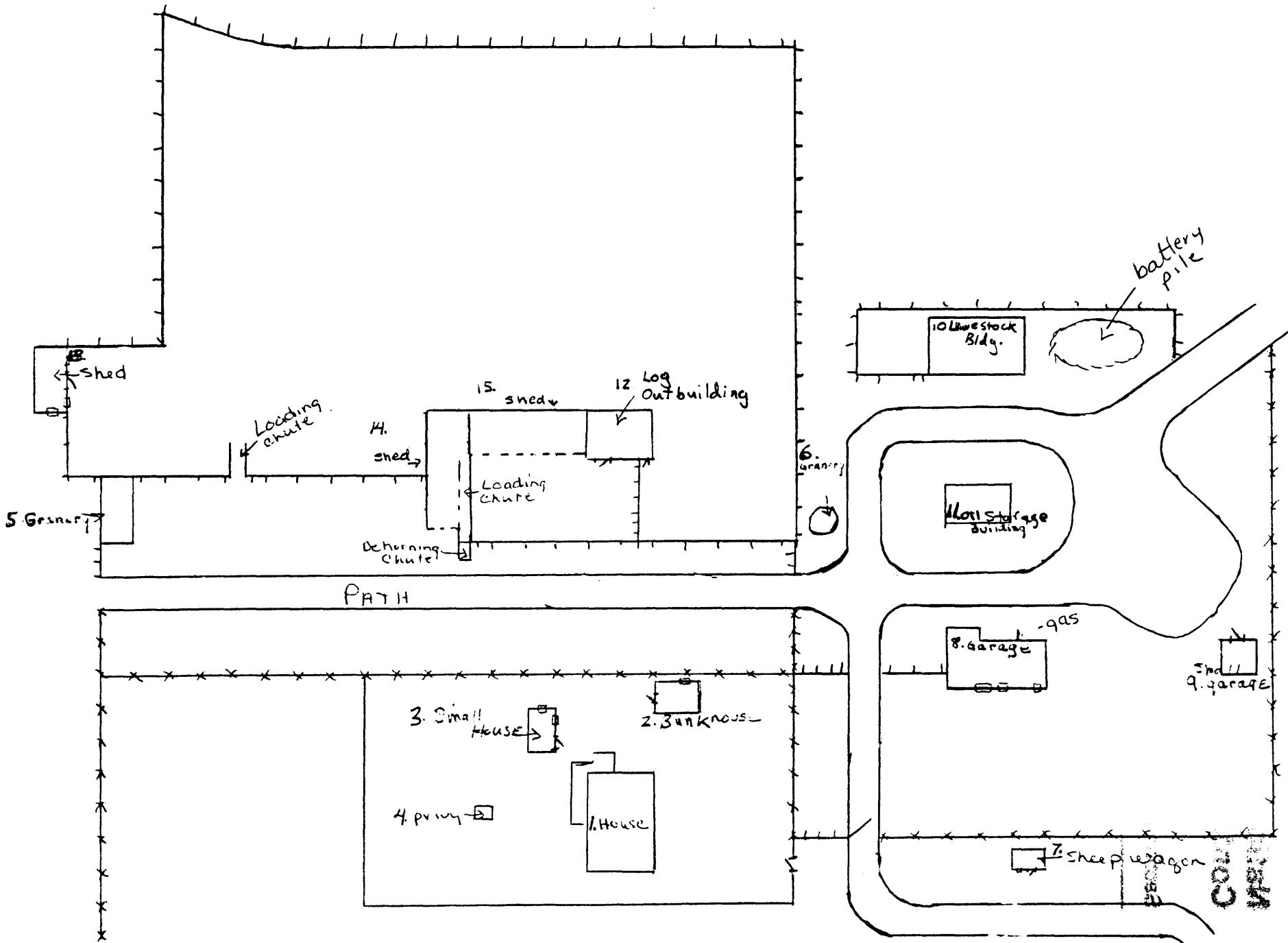

Site Plan (Complete Inventory of Structures and Features) with North Arrow

COPIES  
MAY 1954  
1954

**United States Department of the Interior  
National Park Service**

**National Register of Historic Places  
Continuation Sheet**

Section number 8 Page 1

---

Under Criterion A of the National Register Criteria, the Edna and Ernest Young ranch is significant in the area of Exploration/Settlement, because it represents the development of the legal homestead rancher in the southwestern corner of Custer County, South Dakota. In particular, this ranch represents homesteading on more than one claim. Homestead ranchers were the first generation of settlers to make good and to continue to live on a homestead claim in this semiarid part of Custer County. The homestead rancher who lived on his/her property, as did the Young family, represents a shift from the owners and workers of large cattle companies of the open range period who frequently lived in town.

Under the South Dakota State Historical Preservation Plan the nominated property relates to the historic contexts labeled: IV. Permanent Rural and Urban Settlement, A. Claim Era; and IV. C. Permanent Farm and Ranch Development. This property relates to the local historic context and property type labeled: "Ranches of Southwestern Custer County, South Dakota."

The Young Ranch illustrates the common western South Dakota practice of creating a larger, more economically productive ranch by various family members homesteading several adjacent parcels. In 1908, Edna Petty Young received a patent for a parcel in the southwest quarter of section 31 (T-6S, R-1E). Four years later, her husband Ernest Young received a patent to the adjoining northeast quarter. Throughout the 1920s, the two homesteaders continued to prove up contiguous and discontiguous claims in Custer County and in Niobrara County, Wyoming. As late as 1942, Ida Kirby Young (Ernest's mother) received a patent to land in Wyoming. However, all of the permanent domestic and agricultural operations of the ranch took place on the nominated ranch site in Section 31.

Originally from nearby Pringle, South Dakota, the Youngs were principally cattle and sheep ranchers. Although with generally little success, they attempted to irrigate some of their land with overflow from Beaver Creek. In later years, Ernest Young also raised Appaloosa horses.

Edna and Ernest Young's one daughter, Lena, earned a teaching certificate at the normal school in Spearfish, South Dakota. Upon graduation, she returned to her parent's ranch and taught in the local schools.

In 1965, the Young family sold the ranch to Robert and Lois Bakewell, who operated it on a nonresident basis for fifteen years. Between 1980 and 1985, John Holmes leased the property. In 1985, Clark Andis purchased the property from the Bakewells.



**United States Department of the Interior  
National Park Service**

# **National Register of Historic Places Continuation Sheet**

**Section number** 8 **Page** 2

---

The period of significance of the nominated property extends from circa 1912, the construction date of the oldest extant resource, to 1940, the established 50-year cut-off date for the National Register.

United States Department of the Interior  
National Park Service

National Register of Historic Places  
Continuation Sheet

Section number 10 Page 1

---

GEOGRAPHICAL DATA

ACREAGE OF NOMINATED PROPERTY: 12 acres.

UTM REFERENCES: Since the appropriate U.S.G.S. quad map does not have UTM marks for calculating the UTM references of the nominated property, those references have been calculated in longitude and latitude.

- References: a: 104 degrees 02 minutes 45 seconds longitude/  
43 degrees 29 minutes 15 seconds latitude.
- b: 104 degrees 02 minutes 35 seconds longitude/  
43 degrees 29 minutes 15 seconds latitude.
- c: 104 degrees 02 minutes 35 seconds longitude/  
43 degrees 29 minutes 07 seconds latitude.
- d: 104 degrees 02 minutes 45 seconds longitude/  
43 degrees 29 minutes 07 seconds latitude.

Twentyone Divide, Wyo.-S. Dak. Quad. (1951), scale: 1:24000.

VERBAL BOUNDARY DESCRIPTION: The nominated property is bounded by a set of imaginary lines that intersect to form a rectangle around the ranch district, the vertices of which are the longitude and latitude points a, b, c, and d as described above and as marked on the accompanying U.S.G.S. quad map. The ranch is located in the Southeast Quarter of the Southeast Quarter of the Northwest Quarter, and in the Southwest Quarter of the Southwest Quarter of the Northeast Quarter, of Section 31, Township 6 South, Range 1 East, (Black Hills Meridian) in Custer County, South Dakota.

BOUNDARY JUSTIFICATION: The boundary lines of the nominated property are set to include all features of the ranch complex, but to exclude pasture land and any public roadways.

**United States Department of the Interior  
National Park Service**

**National Register of Historic Places  
Continuation Sheet**

Section number photos Page 1

---

1.  
Edna and Ernest Young Ranch  
Custer Vicinity, Custer County, South Dakota  
by Rebecca Sample Bernstein  
June 1988  
Neg: State Historical Preservation Center  
House (resource no. 1), north and east elevations,  
camera facing southwest  
Photo No. 1
  
2.  
Edna and Ernest Young Ranch  
Custer Vicinity, Custer County, South Dakota  
by Rebecca Sample Bernstein  
June 1988  
Neg: State Historical Preservation Center  
House (resource no. 1), north elevation, camera facing south  
Photo No. 2
  
3.  
Edna and Ernest Young Ranch  
Custer Vicinity, Custer County, South Dakota  
by Rebecca Sample Bernstein  
June 1988  
Neg: State Historical Preservation Center  
House (resource no. 1), south and west elevations,  
camera facing northeast  
Photo No. 3
  
4.  
Edna and Ernest Young Ranch  
Custer Vicinity, Custer County, South Dakota  
by Rebecca Sample Bernstein  
June 1988  
Neg: State Historical Preservation Center  
Log outbuilding (resource no. 12), south and east elevations,  
camera facing northwest  
Photo No. 4

**United States Department of the Interior  
National Park Service**

**National Register of Historic Places  
Continuation Sheet**

Section number photos Page 2

---

5.

Edna and Ernest Young Ranch  
Custer Vicinity, Custer County, South Dakota  
by Rebecca Sample Bernstein  
June 1988  
Neg: State Historical Preservation Center  
Shed (resource no. 13), south and east elevations,  
camera facing northwest  
Photo No. 5

6.

Edna and Ernest Young Ranch  
Custer Vicinity, Custer County, South Dakota  
by Rebecca Sample Bernstein  
June 1988  
Neg: State Historical Preservation Center  
Small house (resource no. 3), north and east elevations,  
camera facing southwest  
Photo No. 6

7.

Edna and Ernest Young Ranch  
Custer Vicinity, Custer County, South Dakota  
by Rebecca Sample Bernstein  
June 1988  
Neg: State Historical Preservation Center  
Garage (resource no. 8), south and west elevations,  
camera facing northeast  
Photo No. 7

8.

Edna and Ernest Young Ranch  
Custer Vicinity, Custer County, South Dakota  
by Rebecca Sample Bernstein  
June 1988  
Neg: State Historical Preservation Center  
Sheep wagon (resource no. 7, south and east elevations,  
camera facing north  
Photo No. 8

page 4: Edna & Ernest Young Ranch  
property name

, Custer  
county

, SOUTH DAKOTA  
state

9. Major Bibliographical References

/XX/ see continuation sheet

Previous documentation by NPS:

/ / preliminary determination of individual listing (36 CFR 67) has been requested

/ / previously listed in the National Register

/ / previously determined eligible by the National Register

/ / designated a National Historic Landmark

/ / recorded by Historic American Buildings Survey # \_\_\_\_\_

/ / recorded by Historic American Engineering Record # \_\_\_\_\_

Primary location of additional data:

/XX/ State historic preservation office

/ / Other State agency

/ / Federal agency

/ / Local government

/ / University

/ / Other

Specify repository:

South Dakota Historical Preservation Center

---

10. Geographical Data

Acreage of property:

UTM References:

A = / / / / /

B = / / / / /

C = / / / / /

D = / / / / /

ZONE EASTING NORTHING

ZONE EASTING NORTHING

Quad:

Scale:

/XX/ see continuation sheet

Verbal Boundary Description:

/XX/ see continuation sheet

Boundary Justification:

/XX/ see continuation sheet

United States Department of the Interior  
National Park Service

National Register of Historic Places  
Continuation Sheet

Section number 9 Page 1

---

Brown, Mabel. "Not Much Doing at Dewey." Bits and Pieces, Your Own Western History Magazine. Vol 3, no.10., 1967.

Kraenzel, Carl Frederick. The Great Plains in Transition. Norman: University of Oklahoma Press, 1955.

Lee, Bob, and Dick Williams. The Last Grass Frontier, The South Dakota Stock Grower Heritage. Sturgis, South Dakota: Black Hills Publishers, Inc., 1964.

Schell, Herbert Samuel. History of South Dakota. 3rd. ed., rev.: Lincoln: University of Nebraska Press, 1975.

Sundstrom, Jessie Y., ed. Custer County History to 1976. Custer, South Dakota: Custer County Historical Society, (printed by Rapid City, South Dakota, Printing, Inc.), 1977.

Personal and Telephone Interviews by Rebecca Sample Bernstein, Summer/Fall, 1988:

Lois Bakewell, Palm Springs, California.

Hoyt Nicholas, Custer, South Dakota.

Jessie Sundstrom, Custer South Dakota.