

KENTUCKY HISTORIC RESOURCES INVENTORY

Site No. Ja 398

1. Historic Name(s) <u>John, Bell, house</u>		22. ADD/County <u>Bluegrass Fayette</u>	
Original Owner <u>John Bell</u>		23. U.S.G.S. Quadrant (15'/75') <u>Lexington West v.c.</u> G.I.S. Mod.	
2. Present Name <u>(Stoneleigh) John Webb house</u>		24. UTM Reference	
3. Location <u>E side 1978, 1/4 mi N of 1652</u>		<u>16 716640 4217700</u>	
4. Owner's Name <u>Richard S. Webb III</u>		Zone Easting Northing	
5. Owner's Address <u>Brendale Rd, Lex., Ky. 40505</u>		25. Coordinate Accuracy <input type="checkbox"/>	
6. Open to Public Yes <input type="checkbox"/> No <input checked="" type="checkbox"/>	7. Visible from road Yes <input checked="" type="checkbox"/> No <input type="checkbox"/>	26. Prehistoric Site Object Historic Site Structure Building <input checked="" type="checkbox"/> Other	
8. Ownership Private <input checked="" type="checkbox"/> Local <input type="checkbox"/> State <input type="checkbox"/> Federal <input type="checkbox"/>		27. National Register District Name: <input type="checkbox"/>	
9. Local Contact/Organization		28. Significance Evaluation <input type="checkbox"/>	
10. Site Plan with North Arrow <u># see attached boundary form</u>		29. Status Date National Landmark <input type="checkbox"/> National Register <input type="checkbox"/> Landmark Certificate <input type="checkbox"/> Kentucky Survey <input type="checkbox"/> Local Landmark <input type="checkbox"/> HABS/HAER <input type="checkbox"/>	
11. Architect		30. Historic Theme Primary <u>architecture</u> <input checked="" type="checkbox"/> Secondary <input type="checkbox"/> Other <input type="checkbox"/>	
12. Builder		31. Endangered Yes <input type="checkbox"/> No <input checked="" type="checkbox"/>	
13. Date <u>C. 1810 1804 A. <input checked="" type="checkbox"/> B. <input type="checkbox"/></u>		32. Preservation Project Status <input type="checkbox"/>	
14. Style A. <u>Federal</u> <input checked="" type="checkbox"/> B. <input type="checkbox"/>		Actual Cost in \$1,000s <input type="checkbox"/>	
15. Original Use <u>residence</u> <input checked="" type="checkbox"/>		33. ATTACH PHOTO	
16. Present use <u>residence</u>		Roll No. _____ Picture No. _____ Direction _____	
17. Condition <u>excellent</u> <input checked="" type="checkbox"/>		34. Prepared by: <u>C.M. Wooley</u>	
18. Description <u>4 bay 2 story double cell dry stone house with 1 story stone ell and 1 story brick ell beyond. Good masonry, w gable corners; ashlar voussiors, 9 on main windows, 11 on cellar; pointed mortar, mostly original, interior chimneys (Continue on Back) (over)</u>		35. Organization	
No. Stories <u>2</u> <input checked="" type="checkbox"/>		36. Date <u>1982</u>	
Single Pile <input checked="" type="checkbox"/> NA <input type="checkbox"/>		37. Revision Dates	
Double Pile <input type="checkbox"/>		38. Staff Review	
Floor Plan <u>double cell</u> <input checked="" type="checkbox"/>			
Structural Fabric <u>stone</u> A. <input checked="" type="checkbox"/> B. <input type="checkbox"/>			
Decorative Fabric <u>voussiors</u> A. <input checked="" type="checkbox"/> B. <input type="checkbox"/>			
Roof Form <u>gable</u>			
19. History <u>House built ca. 1810 by John Bell, son of Rev. War Capt. David Bell. Purchased in 1835 by former U.S. Senator and Governor of Mississippi, George Poindexter; then by (over)</u>			
20. Significance <u>Good early stone house in picturesque rural setting within the city of Lexington; in excellent condition. Home of several (over)</u>			
21. Source of Information <u>18: inspection 1979 inventory form 19: 1979 inventory form 13: descendants of the Bells</u>			

18. cont.:

each end; no attic windows  
House had beaded frames (not pegged)  
w ovolo trim, retained on front door,  
which has 4 pane transom. Stone  
ell built same time as house - masonry  
continuous - appears to have had large  
exterior chimney centered in gable, present (photo 3)  
chimney interior, off center to E; cooking  
fireplace in cellar. Common bond brick  
kitchen ell built ca 1840 behind stone (photo 3)  
ell. Frame addition on NE corner of  
house - pitch of stone ell gable roof  
changed & extended to cover it. G.R.  
porch on front. House had 2 front  
doors and enclosed corner stair adjacent  
to W door. Interior retains breakfast mantels,  
one w colonettes; gougework mantels upstairs;  
6 panel doors w original English Carpenter  
locks; ash flooring, board & batten door  
to ~~porch~~ ell stair.

Changes include: E front door changed  
into window; cornice rebuilt; stone window  
sills installed, probably when frames replaced;  
window added W end 1st floor; ell chimney  
moved(?); most chair rail and enclosed  
stair removed.

House located in extremely picturesque  
setting at end of winding drive from rock  
fenced roadway, through meadow, over  
spring branch, through wooded copse.  
Also on site are a brick smoke house, (photo 6)

18. Cont.: p. 3

a board & batten frame quarters, ruins (photo 7) of a barn, and a fine 2 story spring house (photo 4) and granary. Spring house has wooded lintels, pegged frames, beaded batten doors (boards ca. 6"); Spring room windows have horizontal iron bars and wooden mullions; low pitched hipped roof. Driveway bordered w. 20th C curved stone wall w. pierced entrance to the pastures. Wooded fence rows separate land from adjacent golf course and industrial park.

19. Cont.:

Winfield Bullcock, who had a deer park on the estate; then by John Webb in 1848, ancestor of present owner.

20. Cont.:

prominent citizens.

VERBAL BOUNDARY DESCRIPTION & JUSTIFICATION

Beginning at A, in the fence row 25 ft S of the ruins of the barn, thence N 414 ft to B, at the fence bordering the golf course, thence with fence 630 ft E to C at the fence corner, thence S with fence 414 ft to D, thence parallel to B-C W ~~414~~<sup>630</sup> ft to the beginning containing the stone house, brick smoke house, frame quarters, stone & spring house, spring branch and ruins of barn - about 6 acres. (Entire tract = 14 acres)

SKETCH MAP OF SITE SHOWING BOUNDARIES AND KEY BUILDINGS AND FEATURES WITH NORTH ARROW.

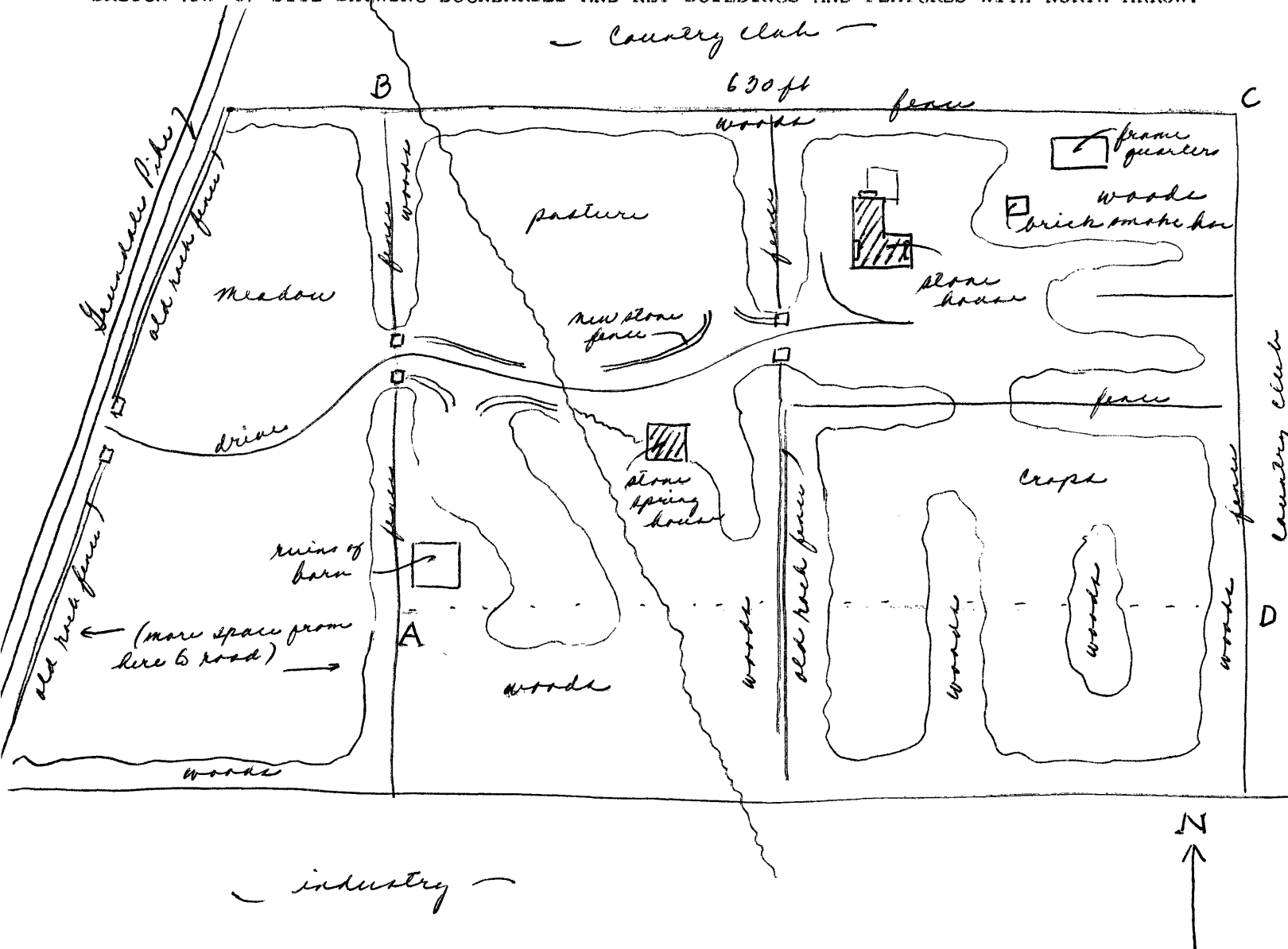

(Since this is beautiful land within Lexington, it would be nice to include the whole 14 acres owned by the Dibles.)  
C.W.