

KENTUCKY HISTORIC RESOURCES
Individual Inventory Form

Resource # MeH-39
Mercer County

1. Name of Resource: Benjamin Passmore Hotel

2. Original Owner: B. N. Passmore

3. Other Names: Mercer House, City Hotel

4. Prehistoric Site Building X Object
Historic Site Structure Other

5. Location: NW corner of N. Main Street and Broadway

6. Owner's Name: Jane Bird Hutton [P]

7. Owner's Address: 111 Broadway Harrodsburg, Kentucky 40330

8. Evaluation: National Register [N]

9. Recognition & Date:
Nat.Landmark _____ Local Landmark _____
Nat.Register _____ HABS/HAER _____
Highway Marker _____ KY Inventory 1970 _____
KY Landmark Certificate 1969 _____

10. N.R.Status & Date:

11. N.R.Group:
District Name: []
Mult.Resource Area: Mercer County []
Thematic Name: []

12. Historical Theme:
Primary: Architecture [030]
Secondary: Transportation [29H]
Other: []

13. Statement of Significance:
See Attached.

14. History:
See attached 1969 KHC form

15. Source of historical information and/or contact person: Jane Bird Hutton
KHC form: 1981, Clay Lancaster
KHC form: 1969, Frances Keightly

16. Date: Original Building 1843-49 [7]
Addition Facade modification [3]

17. Style: Greek Revival [31]
Windows on Corner ca. 1930 [5]

18. Architect/Builder: Unknown

19. No. of Stories: Two [2.0]

20. Original Floor Plan: NA []

21. Single Pile Double Pile N.A. X

22. Roof Form & Material: Original _____
Low hip and tin Not Original X

23. Structural Material: Brick [B]

24. Exterior Material: [B]
Brick/common []

25. Foundation Material: Stone [S]

26. Major Alterations: None
Moved/Rebuilt Other corner entry
Additions to the northwest

27. Special Features: None

28. Outbuildings: []

29. Original Function: Hotel/boarding house [01D]

30. Present Use: Newspaper publishing [10A]

31. Condition: Good [G]

32. Endangered: Yes _____
No X

33. Attach Photos:
Roll: Photo Nos: No. of Slides:
5 0



34. Prepared by: F. Keightly and H. Powell

35. Organization: Landmark Association

36. Date: 1986

37. New Survey _____ Resurvey X

MAY 10 1990

KENTUCKY HISTORIC RESOURCES
Individual Inventory Form

Resource # MeH-39

38. UTM Point of Primary Building:	Zone	Easting	Northing	39. G.I.S. Mod.	[]
Quadrant: Harrodsburg	16	689960	4181600	40. Coordi.Accuracy	[]

41. UTM Points of Boundary (for N. R. eligible sites only):

A. ---	D. ---
B. ---	E. ---
C. ---	F. ---

42. Total Acreage in Present Property: 43. Acreage included in proposed N.R. boundary:

44. Site Plan (and boundary description and justification for N.R. sites):

See attached

45. Description and House Plan:

The Passmore Hotel occupies a prominent Main Street corner on the north end of downtown Harrodsburg. The original brick structure was L-shaped with five bays on the south, or Broadway Street, facade and six bays on the North Main, or east, facade. The main entrance was located on the Broadway facade and consisted of a single door with transom and sidelights. The windows are nine over six. In the early twentieth century, the southeast corner of the first floor was modified by the creation of a recessed corner entrance. Two bays on the south facade and three bays on the east facade were either bricked up or removed during this renovation. During the same period, while the building was in use as a grocery and warehouse, additional storage space was added on the northwest side of the structure, thus enclosing the original two-tiered porch which had originally served as access to the first and second-story guest rooms in the ell. The building has a low hipped roof and a stone foundation. On the interior, neither the original staircase nor any of the original mantels remain. Despite these changes, which are confined to the present rear of the building, the Passmore Hotel retains strong associations to its mid-nineteenth century use as a hotel and stage coach stop.

10-445

<p>1. STATE Kentucky COUNTY Mercer TOWN Harrodsburg VICINITY STREET NO. 101 W. Broadway</p> <p>ORIGINAL OWNER Benjamin N. Passmore ORIGINAL USE Tavern PRESENT OWNER Miss Jane Bird Hutton PRESENT USE Printing office for the Harrodsburg Herald WALL CONSTRUCTION Brick NO. OF STORIES Two</p>	<p>HISTORIC AMERICAN BUILDINGS SURVEY INVENTORY</p> <p>2. NAME Mercer House</p> <p>DATE OR PERIOD 1843-1845 STYLE ARCHITECT BUILDER</p> <p>3. FOR LIBRARY OF CONGRESS USE</p>
<p>4. NOTABLE FEATURES, HISTORICAL SIGNIFICANCE AND DESCRIPTION OPEN TO PUBLIC Yes</p> <p>In 1843, B. N. Passmore bought from Philip Trapnall a quarter part of 2 half-acre in-lots 89 and 90 on which he, Passmore, had a blacksmith shop. (Mercer Co. Court Rec. Deed Bk. 25, p. 440) When Passmore sold the lot in 1849 it had a dwelling on it that was already referred to as the City Hotel. According to Collins History, Mr. Passmore was the oldest citizen that could be interviewed when getting their history of Harrodsburg in 1869.</p> <p>This property has passed through many hands and known many names -"Lyens House," "Mercer House," "Hansford House," "Williams Hotel," "City Hotel," and the "Chambers House." It was a stopping place for the stages coming in from Louisville. Its stable was over the creek.</p> <p>From "The Ploughboy" November 29, 1851: John A. Petty, late of Lancaster, Ky., is now the proprietor of the Mercer House in Harrodsburg, Ky., heretofore known as the "City Hotel." The house and all the outhouses are entirely new and recently erected in a favorable part of town, expressly as a "Tavern House." hitherto it has been kept as a boarding house only, but the stable being fully completed, it takes its position among the taverns of the place, according to the design of the builders. The proprietow will endeavor to make the Mercer House deserving of public patronage and as he knows from an experience of many years that his can only be done by meeting the wants and expectations of his guests, he pladges his undivided attention to the work. His table, bar and stable shall be well supplied, faihtfuldemestics employed and every attention given.</p> <p>Ref.: Mercer Co. Court Rec. Deed Bks. 25, p. 440; 36, p.302; 28 p. 372; 29, p. 48; 37, p. 393; 56 p. 164; 136, p. 489</p> <p>5. PHYSICAL CONDITION OF STRUCTURE Endangered Interior excellent Exterior excellent</p>	
<p>6. LOCATION MAP (Plan Optional)</p>	<p>7. PHOTOGRAPH</p>
<p>8. PUBLISHED SOURCES (Author, Title, Pages) INTERVIEWS, RECORDS, PHOTOS, ETC.</p> <p>Old Taverns by Grace S. L. Hutton p. 11.</p>	<p>9. NAME, ADDRESS AND TITLE OF RECORDER Mrs. James M. Keightley 744 Beaumont Ave. Harrodsburg, Ky. Mercer Co. rep. for the Ky. Hist. Com.</p> <p>DATE OF RECORD Oct. 27, 1969</p>



KENTUCKY HISTORIC RESOURCE INVENTORY SUPPLEMENT
BOUNDARY AND LOCATION INFORMATION

MAY 10 1990

Historic Property Name Benjamin Passmore Hotel Site # MeH-39

Multiple Resource/Thematic Nomination Title MERCER COUNTY MRA

U.T.M. Coordinates - List multiple UTM's if property is ten or more acres.

A. _____ D. _____

B. _____ E. _____

C. _____ F. _____

Verbal Boundary Description _____ Acreage .16

From a point of beginning 10 feet east and 10 feet south of the southeast corner of the building; then west 75 feet to a point; then north 92 feet to a point; then east 75 feet to a point; then south 92 feet to the point of beginning.

Sketch of Site Plan (Showing outbuildings, structures, landscape features and the site boundary as described above.)

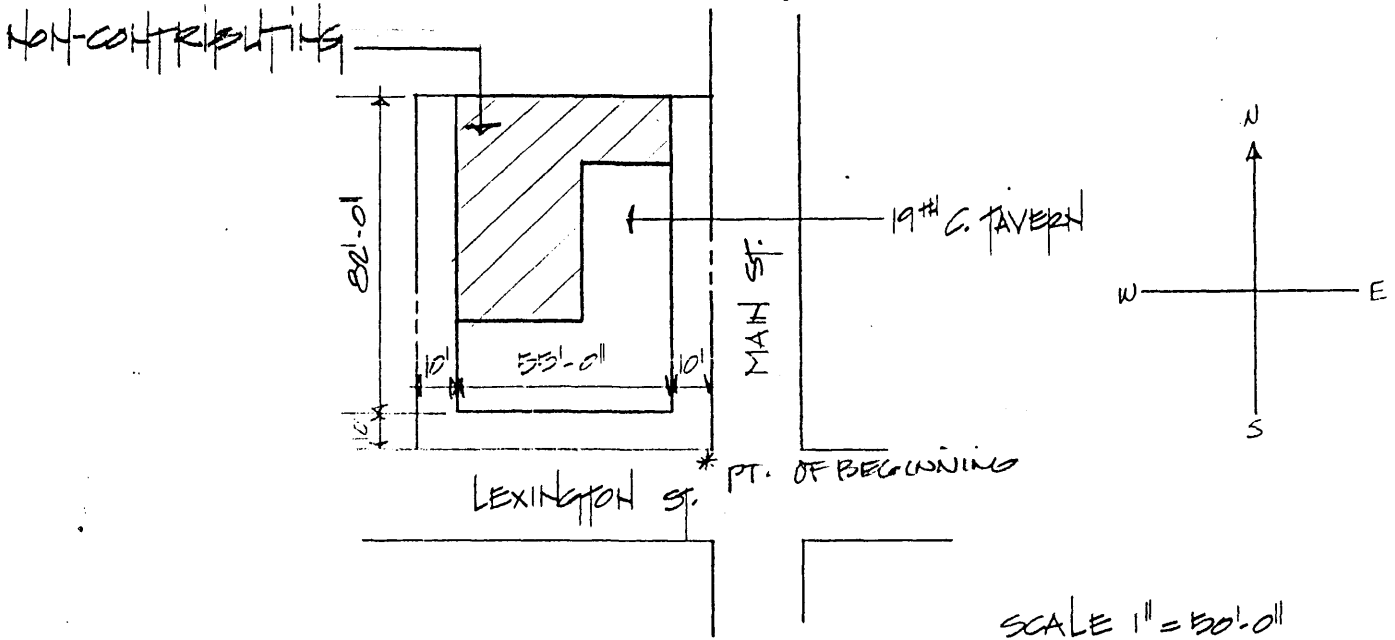

Official Courthouse Property Reference:

Page 5 of 5

Continuation sheet: Benjamin Passmore Hotel (ME-H-39)

Statement of Significance

The Benjamin Passmore Hotel is significant under Criterion A for its association with the stagecoach transportation along the Lexington to Nashville Road. Despite changes to both the interior floor plan and exterior facades as noted in the description, and the additions shown on the site plan, the Benjamin Passmore Hotel is important as the primary building in Harrodsburg associated with the theme of early nineteenth century transportation in Mercer County.

One history of historic inns, "Old Taverns," notes that 20-25 such places were available to travellers over time in Harrodsburg and Mercer County. Today, only Morgan Row and the Passmore Hotel retain an association as stopping places for travellers. Morgan Row was a more comprehensive commercial concern, having been constructed between 1807 and 1830 to serve varying functions. It housed travelling business persons in crowded accommodations.

The Passmore Hotel, on the other hand, was a much smaller operation, family run and on a scale in keeping with its restricted use. From its construction ca. 1843-49, it served a limited clientele, almost exclusively travellers on the toll road. The narrowness of its use as a stagecoach stop and tavern/hotel makes it a valuable representative of a property type, i.e., stagecoach stop, which is an important property type statewide. By contrast, Morgan Row, with its multiple functions, cannot be considered such a specific example of the property type.

Verbal Boundary Justification

The boundary was chosen to follow current property lines that include all resources historically associated with transportation events. Historically the site was larger, including a livery stable which spanned the local creek. The property on which that building sat was not included because of the loss of historic resources. Consequently, the nominated area has been reduced to include only the historic hotel.

The nominated area contains one contributing building.