

PH0066891

**NATIONAL REGISTER OF HISTORIC PLACES
INVENTORY - NOMINATION FORM**

(Type all entries - complete applicable sections)

STATE: Colorado	
COUNTY: Denver	
FOR NPS USE ONLY	
ENTRY NUMBER 69.12.05.0004	DATE

1. NAME

COMMON:
St. Elizabeth's Church

AND/OR HISTORIC:

2. LOCATION

STREET AND NUMBER:
1062 Eleventh Street

CITY OR TOWN:
Denver

STATE Colorado	CODE 05	COUNTY: Denver	CODE 031
-------------------	------------	-------------------	-------------

3. CLASSIFICATION

CATEGORY (Check One)	OWNERSHIP	STATUS	ACCESSIBLE TO THE PUBLIC
<input type="checkbox"/> District <input type="checkbox"/> Site <input type="checkbox"/> Object <input checked="" type="checkbox"/> Building <input type="checkbox"/> Structure	<input type="checkbox"/> Public <input type="checkbox"/> Private <input checked="" type="checkbox"/> Both	<input checked="" type="checkbox"/> Occupied <input type="checkbox"/> Unoccupied <input type="checkbox"/> Preservation work in progress <input type="checkbox"/> In Process <input type="checkbox"/> Being Considered	Yes: <input type="checkbox"/> Restricted <input checked="" type="checkbox"/> Unrestricted <input type="checkbox"/> No
PRESENT USE (Check One or More as Appropriate)			
<input type="checkbox"/> Agricultural <input type="checkbox"/> Commercial <input type="checkbox"/> Educational <input type="checkbox"/> Entertainment	<input type="checkbox"/> Government <input type="checkbox"/> Industrial <input type="checkbox"/> Military <input type="checkbox"/> Museum	<input type="checkbox"/> Park <input type="checkbox"/> Private Residence <input checked="" type="checkbox"/> Religious <input type="checkbox"/> Scientific	<input type="checkbox"/> Transportation <input type="checkbox"/> Other (Specify) <input type="checkbox"/> Comments

4. OWNER OF PROPERTY

OWNER'S NAME:
Order of Friars Minor of Province of Most Holy Name (Franciscan)

STREET AND NUMBER:
1062 Eleventh Street

CITY OR TOWN:
Denver

STATE:
Colorado

CODE:
05

5. LOCATION OF LEGAL DESCRIPTION

COURTHOUSE, REGISTRY OF DEEDS, ETC.:
Tax Assessor's office

STREET AND NUMBER:
City and County Building

CITY OR TOWN:
Denver

STATE:
Colorado

CODE:
05

6. REPRESENTATION IN EXISTING SURVEYS

TITLE OF SURVEY:
Junior League Survey of Historic Denver sites

DATE OF SURVEY: 1968
 Federal State County Local

DEPOSITORY FOR SURVEY RECORDS:
State Historical Society of Colorado

STREET AND NUMBER:
200 Fourteenth Avenue

CITY OR TOWN:
Denver

STATE:
Colorado

CODE:
05

SEE INSTRUCTIONS

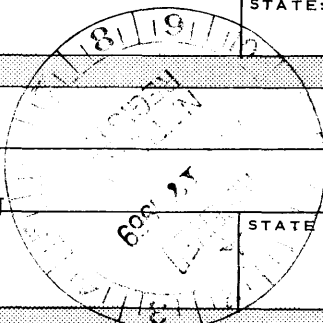

STATE: Colo.
COUNTY: Denver
ENTRY NUMBER
DATE

FOR NPS USE ONLY

7. DESCRIPTION

CONDITION

(Check One)
 Excellent Good Fair Deteriorated Ruins Unexposed

(Check One)
 Altered Unaltered

(Check One)
 Moved Original Site

DESCRIBE THE PRESENT AND ORIGINAL (if known) PHYSICAL APPEARANCE

The average height of the church is 43'. The architectural style is German-Gothic with a spire standing 162'. Building material is stone, quarried at Castle Rock, Colorado. The interior features statues and woodwork carved in Germany. The exterior and interior are in excellent condition.

In addition to the church, there also exists a school, built in 1890 and a monastery (1891). However, only the church is requested for nomination to the Register.

SEE INSTRUCTIONS

SIGNIFICANCE

PERIOD (Check One or More as Appropriate)

- | | | | |
|--|---------------------------------------|--|---------------------------------------|
| <input type="checkbox"/> Pre-Columbian | <input type="checkbox"/> 16th Century | <input type="checkbox"/> 18th Century | <input type="checkbox"/> 20th Century |
| <input type="checkbox"/> 15th Century | <input type="checkbox"/> 17th Century | <input checked="" type="checkbox"/> 19th Century | |

SPECIFIC DATE(S) (If Applicable and Known)

AREAS OF SIGNIFICANCE (Check One or More as Appropriate)

- | | | | |
|--|---|---|---|
| <input type="checkbox"/> Aboriginal | <input type="checkbox"/> Education | <input type="checkbox"/> Political | <input type="checkbox"/> Urban Planning |
| <input type="checkbox"/> Prehistoric | <input type="checkbox"/> Engineering | <input checked="" type="checkbox"/> Religion/Philosophy | <input checked="" type="checkbox"/> Other (Specify) |
| <input type="checkbox"/> Historic | <input type="checkbox"/> Industry | <input type="checkbox"/> Science | <u>Architecture</u> |
| <input type="checkbox"/> Agriculture | <input type="checkbox"/> Invention | <input type="checkbox"/> Sculpture | <u>Cultural</u> |
| <input checked="" type="checkbox"/> Architecture | <input type="checkbox"/> Landscape Architecture | <input type="checkbox"/> Social/Humanitarian | _____ |
| <input type="checkbox"/> Art | <input type="checkbox"/> Literature | <input type="checkbox"/> Theater | _____ |
| <input type="checkbox"/> Commerce | <input type="checkbox"/> Military | <input type="checkbox"/> Transportation | _____ |
| <input type="checkbox"/> Communications | <input type="checkbox"/> Music | | _____ |
| <input type="checkbox"/> Conservation | | | _____ |

STATEMENT OF SIGNIFICANCE

St. Elizabeth's parish was founded for and by German speaking Catholic families in the Denver area in 1878. St. Elizabeth's became the second Catholic parish in Denver. The original church on the site was torn down in 1890. In the meantime, St. Elizabeth's school was erected (1890) as well as a monastery (1891). The cornerstone of the present church was laid November 15, 1898.

The church represents a continuum of development from the German-speaking pioneers of Denver up to the present time. In addition to its cultural significance, St. Elizabeth's architectural style (Gothic) and its furnishings are noteworthy examples of the Old World influence upon the community. Urban Renewal plans are being made for the district in which St. Elizabeth lies. The Denver Landmarks Commission, a city preservation committee, is concerned about the future of St. Elizabeth's Church.

SEE INSTRUCTIONS

9 MAJOR BIBLIOGRAPHICAL REFERENCES

Various newspaper articles available at the Catholic Register office, Denver, Colorado.

History of the Diocese of Denver by Rev. William J. Howlett, available at the Denver Chancery office, 1536 Logan St., Denver
Parochial Beginnings in Colorado to 1889 by M. F. Hasting, S.J.

10 GEOGRAPHICAL DATA

LATITUDE AND LONGITUDE COORDINATES DEFINING A RECTANGLE LOCATING THE PROPERTY			O R	LATITUDE AND LONGITUDE COORDINATES DEFINING THE CENTER POINT OF A PROPERTY OF LESS THAN TEN ACRES		
CORNER	LATITUDE	LONGITUDE		LATITUDE	LONGITUDE	
	Degrees Minutes Seconds	Degrees Minutes Seconds		Degrees	Minutes	Seconds
NW	° ' "	° ' "		39°	44'	33"
NE	° ' "	° ' "		105°	00'	06"
SE	° ' "	° ' "				
SW	° ' "	° ' "				

APPROXIMATE ACREAGE OF NOMINATED PROPERTY: 3/4 acre

LIST ALL STATES AND COUNTIES FOR PROPERTIES OVERLAPPING STATE OR COUNTY BOUNDARIES

STATE:	CODE	COUNTY	CODE

11 FORM PREPARED BY

NAME AND TITLE:
Robert Fink

ORGANIZATION: **State Historical Society of Colorado** DATE: **10/23/69**

STREET AND NUMBER:
200 Fourteenth Street

CITY OR TOWN: **Denver** STATE: **Colorado** CODE: **05**

12 STATE LIAISON OFFICER CERTIFICATION

As the designated State Liaison Officer for the National Historic Preservation Act of 1966 (Public Law 89-665), I hereby nominate this property for inclusion in the National Register and certify that it has been evaluated according to the criteria and procedures set forth by the National Park Service. The recommended level of significance of this nomination is:

National State Local

Name: *Stephen H. Hunt*
 President, Board of Directors
 State Historical Society of Colorado
 Title: _____

Date: November 5, 1969

NATIONAL REGISTER VERIFICATION

I hereby certify that this property is included in the National Register.

Ernest Allen Connors
 Chief, Office of Archeology and Historic Preservation

DEC 1 1969

Date: _____

ATTEST:

William J. Huestay
 Keeper of The National Register

Date: NOV 26 1969

SEE INSTRUCTIONS

13/4999860/4299000

U.S.G.S. Map
1965

FORT LOGAN QUADRANGLE
COLORADO
7.5 MINUTE SERIES (TOPOGRAPHIC)

5063 IV
(COMMERCIAL)

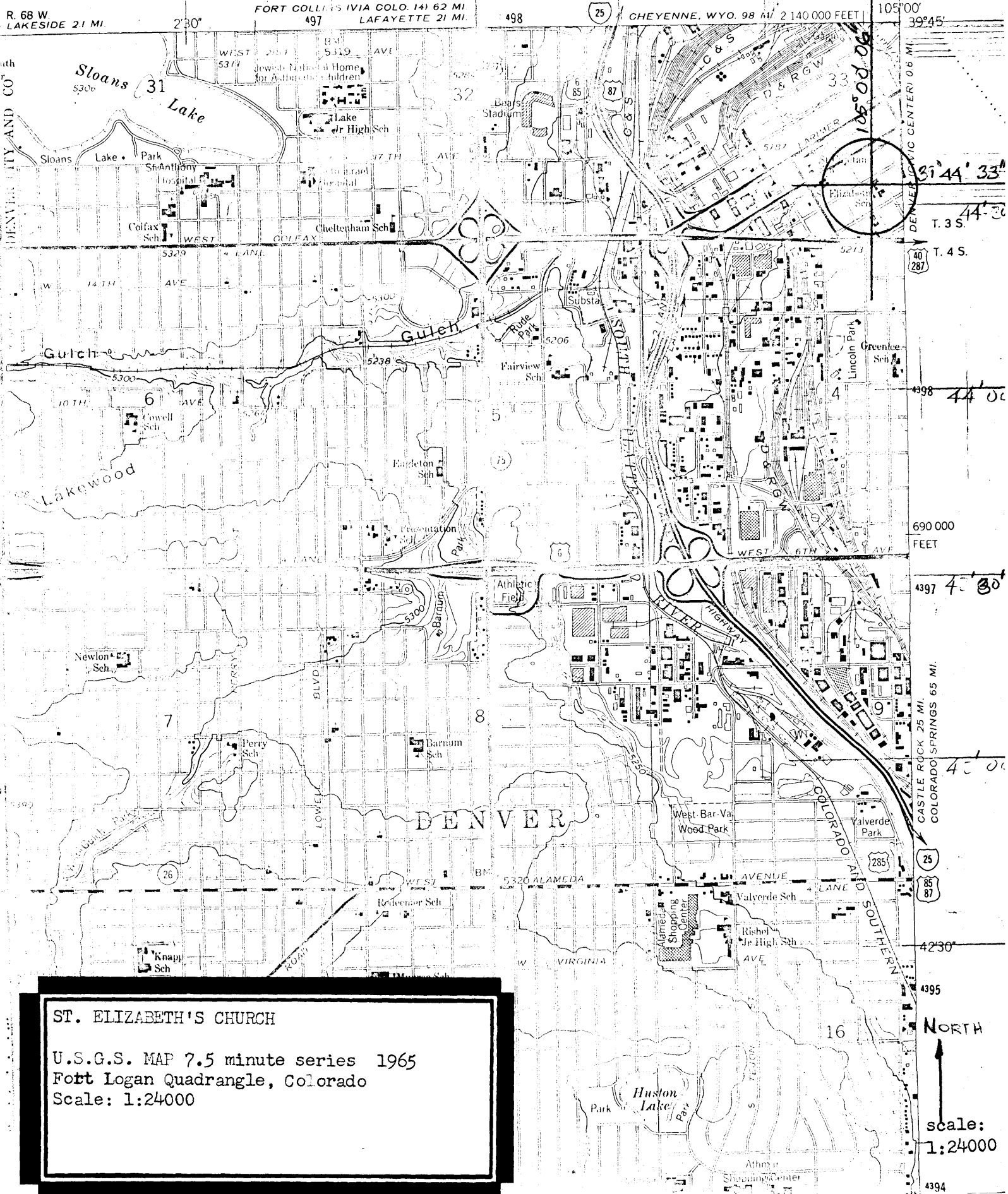

ST. ELIZABETH'S CHURCH

U.S.G.S. MAP 7.5 minute series 1965
Fort Logan Quadrangle, Colorado
Scale: 1:24000



scale:
1:24000

CURTIS STREET

130'±

10th STREET

11th STREET

#1062

75'±

alley

ST. ELIZABETH
CHURCH

NORTH

Scale: 1"=50'

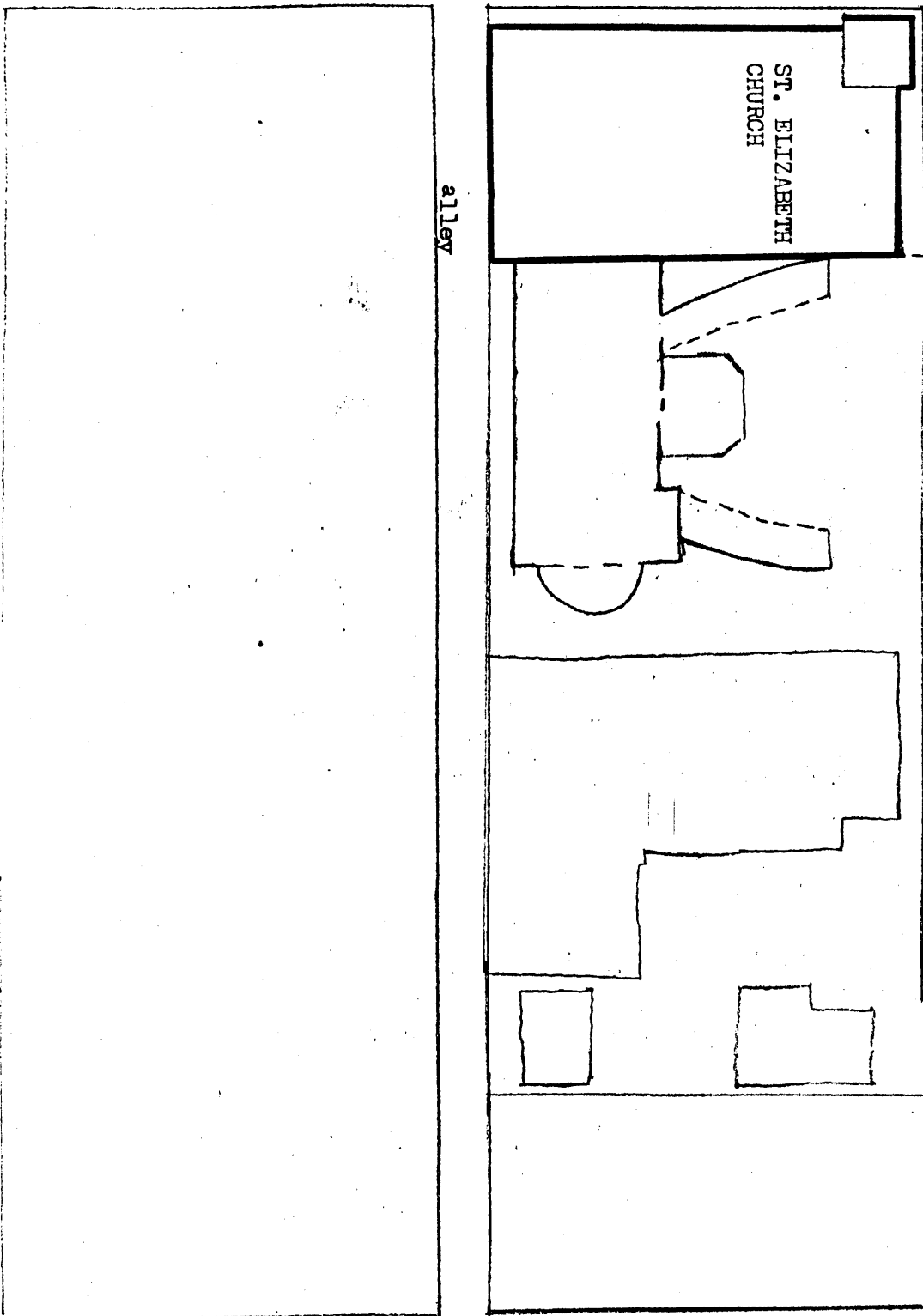

Scale: 1"=50'

**NATIONAL REGISTER OF HISTORIC PLACES
PROPERTY MAP FORM**

(Type all entries - attach to or enclose with map)

STATE	
Colorado	
COUNTY	
Denver	
FOR NPS USE ONLY	
ENTRY NUMBER	DATE

SEE INSTRUCTIONS

1. NAME

COMMON: St. Elizabeth's Church
AND/OR HISTORIC:

2. LOCATION

STREET AND NUMBER:
1062 Eleventh Street

CITY OR TOWN:
Denver

STATE:	CODE	COUNTY:	CODE
<u>Colorado</u>	<u>05</u>	<u>Denver</u>	<u>031</u>

3. MAP REFERENCE

SOURCE: U.S.G.S. Map 7.5 minute series Ft. Logan Quadrangle

SCALE: 1:24000

DATE: 1965

4. REQUIREMENTS

- TO BE INCLUDED ON ALL MAPS
1. Property boundaries where required.
 2. North arrow.
 3. Latitude and longitude reference.

