

972

RECEIVED

United States Department of the Interior
National Park Service

AUG 23 1993

National Register of Historic Places Registration Form

NATIONAL
REGISTER

This form is for use in nominating or requesting determinations for individual properties and districts. See instructions in *How to Complete the National Register of Historic Places Registration Form* (National Register Bulletin 16A). Complete each item by marking "x" in the appropriate box or by entering the information requested. If any item does not apply to the property being documented, enter "N/A" for "not applicable." For functions, architectural classification, materials, and areas of significance, enter only categories and subcategories from the instructions. Place additional entries and narrative items on continuation sheets (NPS Form 10-900a). Use a typewriter, word processor, or computer, to complete all items.

1. Name of Property

historic name Morse, Burton, House
other names/site number _____

2. Location

street & number 136 Tenth Ave. North n/a not for publication
city or town Twin Falls n/a vicinity
state Idaho code ID county Twin Falls code 083 zip code 83301

3. State/Federal Agency Certification

As the designated authority under the National Historic Preservation Act of 1986, as amended, I hereby certify that this nomination request for determination of eligibility meets the documentation standards for registering properties in the National Register of Historic Places and meets the procedural and professional requirements set forth in 36 CFR Part 60. In my opinion, the property meets does not meet the National Register criteria. I recommend that this property be considered significant nationally statewide locally. (See continuation sheet for additional comments.)

[Signature] 3 Aug 93
Signature of certifying official Date
John B. Hill, State Historic Preservation Officer
State or Federal agency and bureau

In my opinion, the property meets does not meet the National Register criteria. (See continuation sheet for additional comments.)

Signature of commenting or other official Date

State or Federal agency and bureau

4. National Park Service Certification

I, hereby, certify that this property is:

entered in the National Register. Antonieta Lee 9/23/93
 See continuation sheet
 determined eligible for the National Register. See continuation sheet
 determined not eligible for the National Register.
 removed from the National Register.
 other, (explain:) _____

[Signature] _____
Signature of Keeper Date of Action

Property Name Morse, Burton, House

County and State Twin Falls County

5. Classification

Ownership of Property	Category of Property	No. of Resources within Property	
		contributing	noncontributing
<input checked="" type="checkbox"/> private	<input checked="" type="checkbox"/> building(s)	<u>2</u>	<u> </u> buildings
<input type="checkbox"/> public-local	<input type="checkbox"/> district	<u> </u>	<u> </u> sites
<input type="checkbox"/> public-State	<input type="checkbox"/> site	<u> </u>	<u> </u> structures
<input type="checkbox"/> public-Federal	<input type="checkbox"/> structure	<u> </u>	<u> </u> objects
	<input type="checkbox"/> object	<u> </u>	<u> </u> Total
		<u>2</u>	

Name of related multiple property listing: n/a

No. of contributing resources previously listed in the National Register: 0

6. Functions or Use

Historic Functions (Enter categories from instructions.)

Cat: DOMESTIC

Sub: Single Dwelling/Residence

Current Functions (Enter categories from instructions.)

Cat: DOMESTIC

Sub: Single Dwelling/Residence

7. Description

Architectural Classification
(Enter categories from instructions.)

Colonial Revival

Materials
(Enter categories from instructions.)

foundation Stucco
walls Wood: Weatherboard

roof Asphalt
other Brick (Portico Base)

Narrative Description (Describe the historic and current condition of the property on one or more continuation sheets.)

Property Name Morse, Burton, House

County and State Twin Falls County, Idaho

8. Statement of Significance

Applicable National Register Criteria (Mark "x" in one or more boxes for the criteria qualifying the property for National Register listing.)

- A Property is associated with events that have made a significant contribution to the broad patterns of our history.
- B Property is associated with the lives of persons significant in our past.
- C Property embodies the distinctive characteristics of a type, period, or method of construction or represents the work of a master, or possesses high artistic values, or represents a significant and distinguishable entity whose components lack individual distinction.
- D Property has yielded, or is likely to yield, information important in prehistory or history.

Criteria Considerations (Mark "x" in all the boxes that apply.)

- A owned by a religious institution or used for religious purposes.
- B removed from its original location.
- C a birthplace or a grave.
- D a cemetery.
- E a reconstructed building, object, or structure.
- F a commemorative property.
- G less than 50 years of age or achieved significance within the past 50 years.

Areas of Significance

(Enter categories from instructions.)

Architecture

Period of Significance

1908

Significant Dates

1908

Cultural Affiliation

n/a

Significant Person

n/a

Architect/Builder

Morse, Burton

Narrative Statement of Significance (Explain the significance of the property on one or more continuation sheets.)

Property Name Morse, Burton, House

County and State Twin Falls County, Idaho

9. Major Bibliographical References

(Cite the books, articles, and other sources used in preparing this form on one or more continuation sheets.)

Previous documentation on file (NPS):

- preliminary determination of individual listing (36 CFR 67) has been requested
- previously listed in the National Register
- previously determined eligible by the National Register
- designated a National Historic Landmark
- recorded by Historic American Buildings Survey # _____
- recorded by Historic American Engineering Record # _____

- Primary location of additional data:
- State Historic Preservation Office
 - Other State agency
 - Federal agency
 - Local government
 - University
 - Other
- Specify repository: _____

10. Geographical Data

Acreage of property Less than 1 acre

UTM References

1	<u>1/1</u>	<u>7/0/8/4/0/0</u>	<u>4/7/1/5/1/6/0</u>	3	<u>/</u>	<u>/</u>	<u>/</u>	<u>/</u>	<u>/</u>	<u>/</u>	<u>/</u>
	Zone	Easting	Northing		Zone	Easting	Northing				

2	<u>/</u>	<u>/</u>	<u>/</u>	<u>/</u>	<u>/</u>	<u>/</u>	<u>/</u>	<u>/</u>	<u>/</u>	<u>/</u>	<u>/</u>
	Zone	Easting	Northing		Zone	Easting	Northing				

See continuation sheet

Verbal Boundary Description (Describe the boundaries of the property on a continuation sheet.)

Boundary Justification (Explain why the boundaries were selected on a continuation sheet.)

11. Form Prepared By

name/title Carolyn Burke/Ed Bourget, Architectural Interns

organization Twin Falls Historic Preservation Commission date June 30, 1992

street & number 168 Park Avenue telephone (208) 233-3616

city or town Pocatello state Idaho zip code 83201

Additional Documentation

Submit the following items with the completed form:
Continuation Sheets

Maps

- A USGS map (7.5 or 15 minute series) indicating the property's location.
- A sketch map for historic districts and properties having large acreage or numerous resources.

Photographs

Representative black and white photographs of the property.

Additional items (Check with the SHPO or FPO for any additional items.)

Property Owner

(Complete this item at the request of the SHPO or FPO.)

name _____

street & number _____ telephone _____

city or town _____ state _____ zip code _____

United States Department of the Interior
National Park Service

National Register of Historic Places Continuation Sheet

Section number 7 Page 1 Name of Property Morse, Burton, House
County and State Twin Falls County, Idaho

The Burton E. Morse house is a modestly sized, Colonial Revival-style, one-and-a-half story home clad with weatherboard. The principal, street facade is gabled front with flared cornice returns, weatherboard siding, and prominent, classical portico entry.

Apart from the side and rear elevations, which feature a slightly asymmetrical placement of windows, bay and chimney, the home has a strongly symmetrical character. The centrally-placed portico, which shelters three brick steps, is supported by paired, square columns resting on brick piers. Columns are surmounted by a plain entablature and a flat roof. The entry door is a four-paneled unit flanked by plain pilasters. Flanking the portico are two identical, three-sided bays containing four, four-over-four, double-hung sash. Bays have flat roofs. Located in the attic gable is a small, arched window with keystone containing four-over-one lights divided by a prominent mullion.

Located toward the front on the east elevation are five grouped, double-hung sash with four-over-four muntin configurations. Centrally located on the east facade is a square bay containing four grouped, double-hung sash of small dimensions. A slender chimney rises from the rear corner of this elevation.

The north facade contains a flared, exterior chimney located toward the front facade. Two, one-over-one sash are located to the rear. The rear elevation has a plain door situated toward the east side; paired, one-over-one sash at the east corner; and three grouped sash at the north corner.

The roof is sheathed with asphalt shingles. The concrete foundation is finished with stucco.

The Morse house stands relatively unchanged since its construction in 1908. A recent restoration left the house in excellent condition, with only a few fascia boards in need of replacing. A small, frame garage located in the backyard is original to the house. An extension of its roof creates a covered outdoor space with a brick fireplace as a focus. Although deteriorated, the garage is sufficiently intact and reflects the character of the house. It is, therefore, a contributing element of the Morse house nomination.

United States Department of the Interior
National Park Service

National Register of Historic Places Continuation Sheet

Section number 8 Page 1 Name of Property Morse, Burton, House
County and State Twin Falls County, Idaho

The Burton E. Morse house is significant under Criterion C as one of the best local examples of Colonial Revival residential design in Twin Falls. The symmetrical presentation of classical details allows this cottage to convey a stately yet unpretentious appearance. Frontal symmetry, combined with a free interpretation of classical Colonial features and the expression of interior functions on the side elevations make this house a true product of its era. The Colonial Revival style references the classicism that pervaded much of American residential design during this period, while the less formal and slightly asymmetrical treatment of side elevations reflects the "modern" movements coming into vogue at this time.

The 1908 design by Morse, a locally prominent architect, is a striking contrast to his grand public works and shows the range of his talents. Burton Morse is still remembered today, not only for his buildings, but also for his role as an early civic leader in Twin Falls.

In the early 1900s, the Burton Morse house was an anchor for a newly forming and very diverse neighborhood. While most houses in this area were built from plans in popular pattern books, the Morse house was a slightly eclectic composition blending new and old ideas of architectural design. Many of the home's features, such as low profile and integrated plan, would become very common in the emerging Bungalow style--a style which dominated Twin Falls' residential architecture well into the 1950s.

Morse was born in 1867 in Farmington, Illinois. In 1908 he and his wife Bertha came to Twin Falls from Chicago. Mr. Morse got his formal architectural education at the University of Illinois in both schools of architecture and engineering in 1891. Burton Morse brought with him many of the latest ideas of modern architecture and would leave his mark on commercial and residential structures in southern Idaho.

He often employed the Renaissance and Colonial Revival motifs, the latter being used mainly in residential design. Some of the more noteworthy Twin Falls buildings by Morse include: the High School (1920), Public Library, Rex Arms Apartments (1918), Maxwell and Sweeny houses (1909 and 1910), and his most ornate commission, the Title and Abstract building (1917). As an insight to the ability of Burton Morse, the following comment was found in a 1910 edition of Twin Falls Times: "His work shows a comprehensive knowledge of business requirements, and he has furnished plans for many of the best arranged and most attractive Twin Falls homes."

Burton Morse was also very civic-minded, having been a charter member of the Twin Falls Rotary club and an active member of both the Elks lodge and the Masonic lodge. In 1916 he helped form the Idaho Society of Architects; he was the first Vice-President of the organization and became President the following year. Morse also played a key role in securing funds for the Harmon Shoshone Falls parks for Twin Falls. Morse died on August 6, 1941, still residing in the house he built for himself.

United States Department of the Interior
National Park Service

National Register of Historic Places Continuation Sheet

Section number 8 Page 2 Name of Property Morse, Burton, House
County and State Twin Falls County, Idaho

The striking classicism of the Morse house is located in a context of Craftsman bungalows, Prairie style homes and Tudor cottages. Its somewhat anachronistic design marks the transition between the Classical Revival and modern movements which characterized the first two decades of the century.

United States Department of the Interior
National Park Service

National Register of Historic Places Continuation Sheet

Section number 9 Page 1 Name of Property Morse, Burton, House
County and State Twin Falls County, Idaho

Attebery, Jennifer. *Building Idaho; An Architectural History*. Moscow, Idaho: University of Idaho Press, 1991. Pp. 82,83.

Evening Times. Twin Falls, Idaho: June, 1910, August 7, 1941.

Polk's Twin Falls City and County Directory, 1908-09. Salt Lake City, Utah, 1909.

Reconnaissance Site Survey of Architectural Properties. Twin Falls Historic Preservation Commission, 1989.

Sanborn 1922 plot map of Twin Falls.

Scott, Donna. *Tribute to the Past; Legacy of the Future*. Caldwell, Idaho: Caxton, Press, 1990.

Wright, Patricia. *Twin Falls County; A Look at Idaho Architecture*. Boise, Idaho: Idaho State Historic Preservation Office, 1979.

United States Department of the Interior
National Park Service

National Register of Historic Places Continuation Sheet

Section number 10 Page 1 Name of Property Morse, Burton, House
County and State Twin Falls County, Idaho

VERBAL BOUNDARY DESCRIPTION

The nomination includes the Burton Morse House and the property on which it is located: Twin Falls Town Site Lot 12 block 1, which is 50' x 125' in size.

United States Department of the Interior
National Park Service

National Register of Historic Places Continuation Sheet

Section number 10 Page 2 Name of Property Morse, Burton, House

County and State Twin Falls County, Idaho

BOUNDARY JUSTIFICATION

Boundaries for the nomination include the entire city lot that has historically been associated with the property of the Burton Morse residence.

BURTON MORSE HOUSE • not to scale

ALLEYWAY

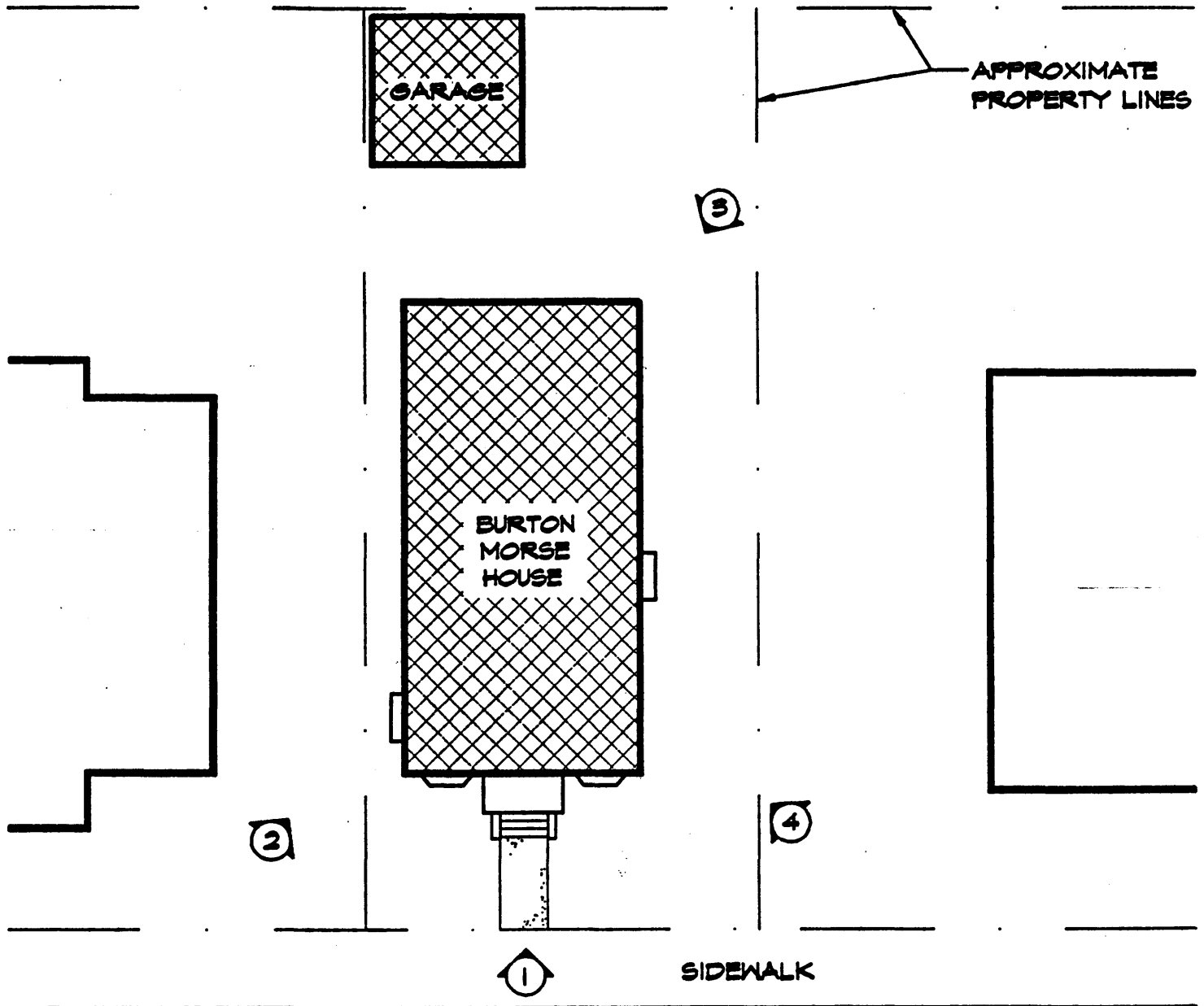

10 TH. AVE. N.

