





KENTUCKY HISTORIC RESOURCE INVENTORY SUPPLEMENT  
BOUNDARY AND LOCATION INFORMATION

Historic Property Name John Litsey Home Site # WS-18

Multiple Resource/Thematic Nomination Title Washington County Multiple Resource Area

U.T.M. Coordinates - List multiple UTM's if property is ten or more acres.

A. 16 657420 4181980 D. \_\_\_\_\_

B. \_\_\_\_\_ E. \_\_\_\_\_

C. \_\_\_\_\_ F. \_\_\_\_\_

Verbal Boundary Description Acreage 1 acre

Point A is located 40 ft. northeast of the northeast corner of the house.  
Beginning at point A, south 90' along a tree line 20' from the principal (east) facade to B, thence 80' west along a line marked by trees to C, thence north 90' along a line marked by trees to D, thence east 80' along a line marked by trees to the point of origin. The boundaries were chosen to encompass the house and its domestic-related space as defined by trees; there are no fences or other boundary markings. No contributing outbuildings.

The nominated area contains one contributing building.

Sketch of Site Plan (Showing outbuildings, structures, landscape features and the site boundary as described above.)

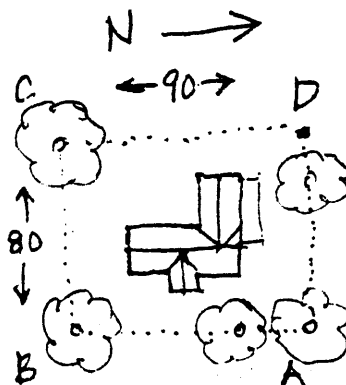

Official Courthouse Property Reference:

Washington County Courthouse, Springfield, Kentucky