

MASSACHUSETTS HISTORICAL COMMISSION
80 BOYLSTON STREET
BOSTON, MA 02116

Photos

2:7 exterior

2:9 first floor, left-hand room

2:11 second floor, right-hand room

Town North Andover 009Address 920 Turnpike StreetHistoric Name Samuel Frye (Frie) HouseUse: Present ResidenceOriginal Residence

DESCRIPTION

Date ca. 1711-1719Source typescript history by Charles Tucker;
visual analysisStyle Transitional First PeriodArchitect NoneExterior Wall Fabric ClapboardOutbuildings 20th c. garageMajor Alterations (with dates) Late 18th c. -
early 19th c.: central chimney stack removed
and replaced by twin stacks; east attached
shed converted to sun room after 1943.Condition GoodMoved No Date N/AAcreage part of 10.75 acre parcelSetting Surrounded by trees and open land.
set at angle to state highway on a slight
rise, developing industry oppositeRecorded by Nora Pat SmallOrganization Boston UniversityDate August 1985

Sketch Map:

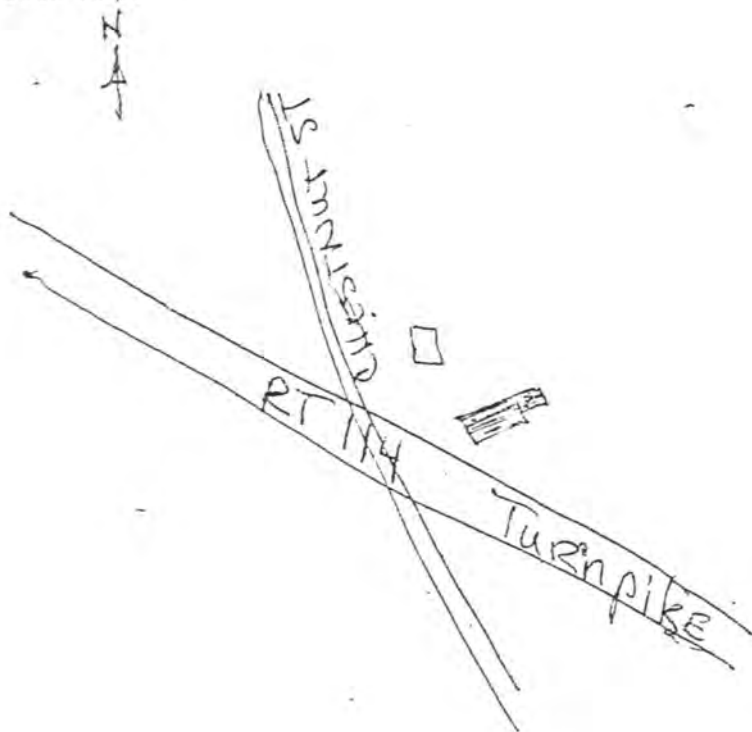

Z E N

UTM REFERENCE 19 / 327-560 / 4724-660USGS QUADRANGLE South Groveland (now Lawrence)SCALE 1:25,000

INVENTORY FORM CONTINUATION SHEET

MASSACHUSETTS HISTORICAL COMMISSION
Office of the Secretary, Boston

Community: NORTH ANDOVER	Form No: 69
Property Name: Samuel Frye House	

Indicate each item on inventory form which is being continued below.

SIGNIFICANCE

The Samuel Frye House retains integrity of materials, workmanship, and location in its surviving transitional First Period frame and floor plan, making it eligible under criterion C. It provides another example of transitional First Period frame embellishment, while the 18th century added lean-to represents a typical addition pattern in early Massachusetts houses. The retention of a First Period floor plan despite Federal remodeling, which replaced one central chimney stack with paired ones, represents a very late conservative survival of First Period planning concepts in a building superficially altered to conform to later standards.

EXTERIOR DESCRIPTION

The Samuel Frye House is a five-bay, 2 1/2 story clapboarded structure, one room deep with added rear lean-to and a 1 1/2 story 19th century ell projecting from the rear east corner. The central chimney stack has been removed and replaced with low, barely visible twin stacks of the Federal Period, but the house retains its original First Period two room plan inside.

MAJOR FIRST PERIOD FEATURES

Despite its Federal remodeling, the house still displays much of its transitional First Period frame on the second floor, characterized by quirk beading and beveled chamfers, and retains its two-room, lobby entrance, central chimney plan, with the original chimney space occupied by a large closet or small room. This is an unusual survival, as most First Period chimneys were removed in order to create a center stairhall, destroying the original plan.

The first floor southeast room has an exposed longitudinal summer beam with quirked beading. The rest of the frame is covered with plain boxes. The frame of the first floor southwest room is completely boxed. The east first floor room in the lean-to has exposed ceiling beams, some unfinished and some finished with very rough beveled chamfers, indicating that the lean-to may have been added fairly soon after the original building.

The southeast chamber has an exposed transverse summer beam with beveled chamfer and taper stops. The rear plate is quirk-beaded (visible in the closet); all other framing members are boxed. The southwest chamber has a transverse summer beam with quirk beading. The front and back plates are quirk-beaded. The east wall has two sections of square field panels with early deep feather edges which perhaps once flanked the original fireplace.

INVENTORY FORM CONTINUATION SHEET

MASSACHUSETTS HISTORICAL COMMISSION
Office of the Secretary, Boston

Community: NORTH ANDOVER	Form No: 69
Property Name: Samuel Frye House	

Indicate each item on inventory form which is being continued below.

The lean-to shows evidence of having been framed separately. The second floor hall has a flared interior post with beveled chamfer and taper stop; no similar posts are visible to the rear of the center room (the original chimney posts).

HISTORICAL INFORMATION

Samuel Frye deeded a house, barn, and land to his son, Ensign Samuel Frie, Jr., in 1719, shortly before his marriage in that year. Local tradition claiming that a previous house burned in 1711 fixes a date for the present structure between 1711 and 1719. The Fryes were an important local family; the area near the house was known as 'Frye's Village' after the saw and grist mill complex built there by Samuel Frye Sr. in 1718. Samuel Jr. built up an extensive farm, including land, sheep, cattle, and a cider mill, by his death in 1761. One of his sons, Peter, became Registrar of Deeds and Probate in Salem, and was forced to flee to Britain during the Revolution due to his Tory sympathies. The house remained in the Frye family until 1880.

REFERENCES

Partial title search by S.J. Roper & John McHugh, 1976.
Typescript history of the house by Charles Tucker, in possession of Helen Kellner, present owner.
Baily, Sarah Loring. Historical Sketches of Andover. Boston; Houghton Mifflin & Co, 1880.

BOUNDARY DESCRIPTION

The Samuel Frye House is situated near the intersection of Turnpike Road and Chestnut Street, an intersection that is reflective of early roads. The line of convenience is the property boundary along the two streets and includes an area of less than one acre including the house and one garage.

1/24/90

United States Department of the Interior
National Park Service

National Register of Historic Places
Continuation Sheet

Section number _____ Page _____

Multiple Resource Area
Thematic Group

Name First Period Buildings of Eastern Massachusetts TR
State _____

Nomination/Type of Review	Date/Signature
21. Foster, Stephen, House Entered in the National Register	<i>fu</i> Keeper <u>Delores Byrum 3/9/90</u> Attest _____
^{sub} 22. Foster, William, House Substantive Review	<i>JS</i> Keeper <u>Beth L. Savage 3/9/90</u> Attest _____
23. Fowler, Rea Putnam, House Entered in the National Register	<i>fu</i> Keeper <u>Delores Byrum 3/9/90</u> Attest _____
24. French--Andrews House Entered in the National Register	<i>fu</i> Keeper <u>Delores Byrum 3/9/90</u> Attest _____
^{sub} 25. Friend, James, House Substantive Review	<i>JS</i> Keeper <u>Beth L. Savage 3/9/90</u> Attest _____
26. Frye, Samuel, House Entered in the National Register	<i>fu</i> Keeper <u>Delores Byrum 3/9/90</u> Attest _____
^{sub} 27. Fuller, Joseph, House Substantive Review	<i>JS</i> Keeper <u>Beth L. Savage 3/9/90</u> Attest _____
28. Fuller, Lieut. Thomas, House Entered in the National Register	<i>fu</i> Keeper <u>Delores Byrum 3/9/90</u> Attest _____
29. Giddings, George, House and Barn Entered in the National Register	<i>fu</i> Keeper <u>Delores Byrum 3/9/90</u> Attest _____
30. Giddings--Burnham House Substantive Review	<i>JS</i> Keeper <u>Beth L. Savage 3/9/90</u> Attest _____

UNITED STATES DEPARTMENT OF THE INTERIOR
NATIONAL PARK SERVICE

NATIONAL REGISTER OF HISTORIC PLACES
EVALUATION/RETURN SHEET

REQUESTED ACTION: NOMINATION

PROPERTY NAME: Frye, Samuel, House

MULTIPLE NAME: First Period Buildings of Eastern Massachusetts TR

STATE & COUNTY: MASSACHUSETTS, Essex

DATE RECEIVED: 1/24/90 DATE OF PENDING LIST: 2/07/90
DATE OF 16TH DAY: 2/23/90 DATE OF 45TH DAY: 3/10/90
DATE OF WEEKLY LIST:

REFERENCE NUMBER: 90000252

NOMINATOR: STATE

REASONS FOR REVIEW:

APPEAL: N DATA PROBLEM: N LANDSCAPE: N LESS THAN 50 YEARS: N
OTHER: N PDIL: N PERIOD: N PROGRAM UNAPPROVED: N
REQUEST: N SAMPLE: N SLR DRAFT: N NATIONAL: N

COMMENT WAIVER: N

ACCEPT RETURN REJECT 3/9/90 DATE

Entered in the
National Register

ABSTRACT/SUMMARY COMMENTS:

RECOM./CRITERIA _____
REVIEWER _____
DISCIPLINE _____
DATE _____

DOCUMENTATION see attached comments Y/N see attached SLR Y/N

CLASSIFICATION

count resource type

STATE/FEDERAL AGENCY CERTIFICATION

FUNCTION

historic current

DESCRIPTION

architectural classification
 materials
 descriptive text

SIGNIFICANCE

Period Areas of Significance--Check and justify below

Specific dates Builder/Architect
Statement of Significance (in one paragraph)

summary paragraph
 completeness
 clarity
 applicable criteria
 justification of areas checked
 relating significance to the resource
 context
 relationship of integrity to significance
 justification of exception
 other

BIBLIOGRAPHY

GEOGRAPHICAL DATA

acreage verbal boundary description
 UTM's boundary justification

ACCOMPANYING DOCUMENTATION/PRESENTATION

sketch maps USGS maps photographs presentation

OTHER COMMENTS

Questions concerning this nomination may be directed to

_____ Phone _____

Signed _____

Date _____



920 Turnpike St.

2:7

No. Andover, MA

Samuel Frye House

Exterior

1st Period Buildings of E. Ma. NRA

1985



Samuel Frye House

2:9

920 Turnpike St.

No. Andover, MA.

1st period Buildings of E. Ma. MRA

1st floor left room

1985-



Samuel Frye House
920 Turnpike St,
No. Andover, MA.

2:11

1st Period Buildings of E. Me. MRA

2nd floor right room

1985

Please refer to the map in the
Multiple Property Cover Sheet
for this property

Multiple Property Cover Sheet Reference Number: 64000281