

United States Department of the Interior  
National Park Service

RECEIVED

AUG 22 1988

National Register of Historic Places  
Registration Form

NATIONAL  
REGISTER

This form is for use in nominating or requesting determinations of eligibility for individual properties or districts. See instructions in *Guidelines for Completing National Register Forms* (National Register Bulletin 16). Complete each item by marking "x" in the appropriate box or by entering the requested information. If an item does not apply to the property being documented, enter "N/A" for "not applicable." For functions, styles, materials, and areas of significance, enter only the categories and subcategories listed in the instructions. For additional space use continuation sheets (Form 10-900a). Type all entries.

1. Name of Property

historic name Clarkson Farm Complex  
other names/site number \_\_\_\_\_

2. Location

street & number U.S. Hwy. 52, 1 1/2 miles S of intersection w/ U.S. 521  not for publication  
city, town Greeleyville  vicinity  
state South Carolina code 045 county Williamsburg code 089 zip code 29056

3. Classification

| Ownership of Property                       | Category of Property                         | Number of Resources within Property |                    |
|---|--|-------------------------------------|--------------------|
|   |  | Contributing                        | Noncontributing    |
| <input checked="" type="checkbox"/> private | <input type="checkbox"/> building(s)         | <u>8</u>                            | <u>1</u> buildings |
| <input type="checkbox"/> public-local       | <input checked="" type="checkbox"/> district | <u>1</u>                            | _____ sites        |
| <input type="checkbox"/> public-State       | <input type="checkbox"/> site                | _____                               | _____ structures   |
| <input type="checkbox"/> public-Federal     | <input type="checkbox"/> structure           | _____                               | _____ objects      |
|   | <input type="checkbox"/> object              | <u>9</u>                            | <u>1</u> Total     |

Name of related multiple property listing: N/A

Number of contributing resources previously listed in the National Register 0

4. State/Federal Agency Certification

As the designated authority under the National Historic Preservation Act of 1966, as amended, I hereby certify that this  nomination  request for determination of eligibility meets the documentation standards for registering properties in the National Register of Historic Places and meets the procedural and professional requirements set forth in 36 CFR Part 60. In my opinion, the property  meets  does not meet the National Register criteria.  See continuation sheet.

Mary W. Edmonds 8/12/88  
Signature of certifying official Date  
Mary W. Edmonds, Deputy State Historic Preservation Officer, SC Dept of Archives/History  
State or Federal agency and bureau

In my opinion, the property  meets  does not meet the National Register criteria.  See continuation sheet.

\_\_\_\_\_  
Signature of commenting or other official Date  
\_\_\_\_\_  
State or Federal agency and bureau

5. National Park Service Certification

I, hereby, certify that this property is:

- entered in the National Register.  See continuation sheet.
- determined eligible for the National Register.  See continuation sheet.
- determined not eligible for the National Register.
- removed from the National Register.
- other, (explain:)

Amy Schlager 10/6/88  
\_\_\_\_\_  
\_\_\_\_\_  
\_\_\_\_\_  
\_\_\_\_\_  
\_\_\_\_\_  
Signature of the Keeper Date of Action

## 6. Function or Use

Historic Functions (enter categories from instructions)

Domestic/Single Dwelling

Commerce/Business/Store/Post Office

Agriculture/Processing

Agriculture/Agricultural Outbuilding

Current Functions (enter categories from instructions)

Domestic/Single Dwelling

Storage

Storage

Agriculture/Agricultural Outbuilding

## 7. Description

Architectural Classification

(enter categories from instructions)

Other

Materials (enter categories from instructions)

foundation Brick

walls Wood/Weatherboard

roof Metal

other

Describe present and historic physical appearance.

The Clarkson Farm Complex is located on U.S. Highway 52 approximately one and a half miles south of its intersection with U.S. Highway 521 in the Heineman community of Williamsburg County. The complex consists of the Clarkson residence and six outbuildings. The main house and three of the out-buildings (a smokehouse, a pumphouse, and a stable/garage) are on the east side of the highway; the other three outbuildings (a store, a garage, and a tenant house) are on the west side of the highway.

### Main House

The Clarkson residence, built c. 1905 by the owner, William Nicoll Clarkson, is a two-story frame building resting on a brick pier foundation. It sits back approximately 80 feet from Highway 52. The house has a standing-seam metal gable roof which is oriented laterally. The clapboard house is an elaboration and expansion of a traditional I-house. A rear ell, with a gable roof positioned perpendicular to the roof of the main body of the house, creates an L-shaped plan. An earlier one-story residence, built c. 1896, is incorporated into the rear of the ell. Exterior brick wall chimneys are located at the north and south gable ends of the house and at the rear of the ell. All have corbelled caps. A brick flue extends from the east roof slope of the front block of the house. Windows throughout the house feature one-over-one lights, except for some in the earlier residence which have six-over-six lights. All windows feature heavy wood-framed wire screens.

The main facade of the house faces west. The entrance is centrally located and contains panelled, narrow double doors, flanked by sidelights and surmounted by a transom divided into seven lights. Brick piers support a two-story porch that extends across the principal facade and continues along the north, south and a portion of the east facades. Turned balusters extend between the turned porch posts. A spindle-work cornice baluster runs just below the roof line of the porches. A metal pent roof extends from each porch level. Beaded board is utilized for the porch ceilings. On the second floor, directly above the entrance, are panelled, wider double doors leading

**8. Statement of Significance**

Certifying official has considered the significance of this property in relation to other properties:

nationally     statewide     locally

Applicable National Register Criteria     A     B     C     D

Criteria Considerations (Exceptions)     A     B     C     D     E     F     G

Areas of Significance (enter categories from instructions)

Agriculture  
Commerce  
Architecture

Period of Significance

c. 1896-1928

Significant Dates

c. 1896  
1905  
1928

Cultural Affiliation

N/A

Significant Person

Architect/Builder

Clarkson, William N.

State significance of property, and justify criteria, criteria considerations, and areas and periods of significance noted above.

The Clarkson Farm Complex, located in a rural farming area of Williamsburg County, includes a main house, store, smokehouse, garage, stable/garage, tenant house, and pecan grove, dating from c. 1896 to c. 1928. Constructed by William Nicoll Clarkson (1871-1956), this collection of resources is significant as an intact late nineteenth/early twentieth century agricultural/commercial complex. Additionally, the main house, built ca. 1905, is a significant example of an elaborated and expanded I-house, a type found throughout South Carolina but most commonly in the Piedmont.

ADDITIONAL INFORMATION

William Nicoll Clarkson, born in the Suttons community of Williamsburg County, moved to Heineman c. 1890 and worked as a store clerk. After three years Clarkson bought out the owner and established his own store at Heineman; he married Kate Montgomery in 1894.(1) In January 1896 he purchased land on the east side of the Murray's Ferry Road (now U.S. Highway 52) and built a small two-room house and a store (facing west).(2) Subsequent purchases increased this parcel to 175 acres and acquisition of additional acreage about a mile to the north increased Clarkson's land holdings to approximately 725 acres.(3)

Clarkson produced most of the lumber used in constructing the house and outbuildings from pine on his property, cut at his sawmill there.(4) Within a few years the house was too small for Clarkson's family, and an expansion which began in 1900 was complete by 1905. The original two-room house was rotated to face east, moved back from the road, and enlarged to its present two-story configuration. With the exception of the roof and masonry, the house and outbuildings were built by Clarkson, farm laborers, and his two oldest sons.(5)

Clarkson quickly established his influence in the community and county. In addition to his success as a farmer, cotton gin operator, and local

## 9. Major Bibliographical References

See continuation sheet

### Previous documentation on file (NPS):

- preliminary determination of individual listing (36 CFR 67) has been requested
- previously listed in the National Register
- previously determined eligible by the National Register
- designated a National Historic Landmark
- recorded by Historic American Buildings Survey # \_\_\_\_\_
- recorded by Historic American Engineering Record # \_\_\_\_\_

See continuation sheet

### Primary location of additional data:

- State historic preservation office
- Other State agency
- Federal agency
- Local government
- University
- Other

### Specify repository:

SC Department of Archives and History

## 10. Geographical Data

Acreage of property 9.9 acres

### UTM References

A 

|      |   |   |         |   |   |   |   |          |   |   |   |   |   |   |
|------|---|---|---------|---|---|---|---|----------|---|---|---|---|---|---|
| 1    | 7 | 5 | 9       | 9 | 0 | 8 | 2 | 3        | 7 | 1 | 3 | 7 | 5 | 6 |
| Zone |   |   | Easting |   |   |   |   | Northing |   |   |   |   |   |   |

C 

|      |  |  |         |  |  |  |  |          |  |  |  |  |  |  |
|------|--|--|---------|--|--|--|--|----------|--|--|--|--|--|--|
|      |  |  |         |  |  |  |  |          |  |  |  |  |  |  |
| Zone |  |  | Easting |  |  |  |  | Northing |  |  |  |  |  |  |

B 

|      |  |  |         |  |  |  |  |          |  |  |  |  |  |  |
|------|--|--|---------|--|--|--|--|----------|--|--|--|--|--|--|
|      |  |  |         |  |  |  |  |          |  |  |  |  |  |  |
| Zone |  |  | Easting |  |  |  |  | Northing |  |  |  |  |  |  |

D 

|      |  |  |         |  |  |  |  |          |  |  |  |  |  |  |
|------|--|--|---------|--|--|--|--|----------|--|--|--|--|--|--|
|      |  |  |         |  |  |  |  |          |  |  |  |  |  |  |
| Zone |  |  | Easting |  |  |  |  | Northing |  |  |  |  |  |  |

See continuation sheet

### Verbal Boundary Description

The boundary of the nomination is shown as the black line on the accompanying Williamsburg County Tax Map, Sheet 70, Parcel 1, drawn at a scale of 1"=330'.

See continuation sheet

### Boundary Justification

The nominated property includes the main house, historic outbuildings, and their immediate settings as well as the historic landscape in the vicinity of the complex.

See continuation sheet

## 11. Form Prepared By

name/title Andrew W. Chandler, National Register Manager

organization SC Department of Archives and History date 28 April 1988

street & number 1430 Senate St, PO Box 11669 telephone (803) 734-8608

city or town Columbia state SC zip code 29211

United States Department of the Interior  
National Park ServiceNational Register of Historic Places  
Continuation SheetSection number 7 Page 2

onto the second floor porch. These doors, which are protected by wood-framed wire screen doors, also have a multi-light transom and sidelights.

A porte cochere, constructed c. 1924, extends beyond the porch on the north facade. A flight of steps leads down from the porch to the porte cochere. The pressed metal roof of the porte cochere is supported by four battered piers, resting on high brick bases. A concrete drive leads from the highway through double wooden gates to the porte cochere.

A rear (west elevation) ell with an intersecting gable roof extends from the main block of the house. A portion of the first floor porch is enclosed with wire screen. Adjoining the ell at the rear is the original one-story house.

The east facade includes the main facade of the c. 1896 residence. This house rests on brick piers. A shed roof porch, supported by wooden posts, extends across the central two-thirds of the facade. Turned balusters extend between the porch posts. A flight of wooden lead up to the porch. Bracketed wooden posts support a shed roof that extends over the steps. Originally, there were two entries along the principal facade. The one entering the north (dining) room has been closed; however, its surround is still recognizable. The door to the south room (kitchen) remains intact. The standing seam gable roof is laterally oriented. The corners of the house on the north end are canted, with a window placed on each of the three wall surfaces. The two rooms of this house are served by a back-to-back fireplace. A corbelled brick chimney rises from the center of the roof ridge. A doorway to each of the two rooms of this building joins it to the rear of the ell of the primary building. A rear extension of this building is probably an enclosure of what would have been part of the first story porch on the north facade of the main house.

The interior floor plan of the main block is typical of an I-house. A center hallway separates two rooms of equal size on each floor. The rear ell provides two additional rooms. Both of the first floor rooms along the front feature coved ceilings, marked by a picture mold and a cornice mold. A wooden mantel with bevel-edged mirror is placed on the end wall of the north room (parlor). The central stairway features turned balusters and a wooden handrail. A multipaned door at the back wall of the hallway originally led to the rear porch. It now leads to a modern enlarged enclosure of the rear porch, the terminus of which featured entry into the original c. 1896 house.

United States Department of the Interior  
National Park Service

National Register of Historic Places  
Continuation Sheet

Section number 7 Page 3

---

Clarkson Store

Directly opposite the house, across the highway, is a rectangular store building (c. 1896). The store sits back approximately 30 feet from the highway. This building rests on a brick foundation, has clapboard walls, and has a metal gable roof. A brick chimney is located in the center of the roof ridge. A brick flue projects from the north roof slope. The double entrance doors are centrally located and surmounted by a transom. Two sash windows with six-over-six lights are located on each side of the entrance. A porch extends across the front of the store and is an addition of 1928. The metal hip roof of the porch is supported by four brick pillars, the outer two of which contain date tablets. The one to the left of the entrance is inscribed "1893", the founding date of Clarkson's mercantile business; the other "1928", the date the store was moved to its present location. A single window with louvered shutters is located in the gable wall surface. At the rear of the north facade are two windows, sheltered by wood awnings roofed in metal and held in position by lattice-work supports. Just beneath the eave are two small vent windows designed for light and circulation.

The store's interior, basically intact with much of the shelving and glass display cases still in place, contains a large open business space. Floors are of hardwood, and walls and ceiling feature beaded board. To the rear are two rooms, the larger of which formerly housed Clarkson's business office and the Heinemann post office and which still contains a metal, free-standing safe. Since its historical use was discontinued, it has been used for storage.

Garage

Also on the west side of the highway, and north of the store, is a garage built c. 1928. This garage sits back approximately 30 feet from the highway. The rectangular building has brick walls and a jerkinhead gable metal roof. The gable wall surfaces are clapboard covered with pressed metal simulating brick construction. The two present-day garage openings do not face the highway as they did originally, but are on the south facade of the structure. The east facade openings were bricked in when the others were opened.

Tenant House

Further to the north on the west side of the highway is a tenant house (c. 1928). The building faces east and is sited approximately 80 feet from the highway. The frame dwelling with clapboard walls has a

United States Department of the Interior  
National Park ServiceNational Register of Historic Places  
Continuation SheetSection number 7 Page 4

---

standing seam, cross-gable roof. A brick chimney is located at the juncture of the roof intersections. A shed roof shelters a porch across the facade. Free-standing wood posts support the porch roof. The dwelling is fenestrated with four-over-four, double-hung, sash windows, which flank a single wooden, panelled door.

Stable/Garage

Directly to the rear of the porte cochere, within the fenced enclosure around the main residence, is a stable that was converted to a garage in 1924. The weatherboard building has a standing seam metal gable roof. Exposed rafter ends are visible along the south eave. Wooden double doors are centrally located. The stable/garage has a concrete floor with "1924" inscribed. The interior has been sealed with beaded-board paneling. A shed roof extension is placed along the north wall of this building.

Pumphouse

Just to the north of the porte cochere, beyond the fenced yard enclosure, is a rectangular, brick pumphouse. The building also has a standing seam metal gable roof, and small wooden entrance door centrally located on the south side.

Smokehouse

East of the rear ell of the residence, and within the fenced yard enclosure, is a weatherboard smokehouse with corrugated metal roof. The rectangular structure rests on a low brick foundation, and has a metal gable roof. An entrance door is located at the west gable end of the smokehouse.

Wellhouse

North of the residence, on the extreme northern edge of the nominated property, is a concrete and weatherboard wellhouse with corrugated metal roof. The rectangular structure rests on a low concrete foundation, and has a metal gable roof with raised venting at the ridge line. This wellhouse contained an artesian well system which served the numerous outbuildings in the farm complex.

United States Department of the Interior  
National Park Service

National Register of Historic Places  
Continuation Sheet

Section number 7 Page 5

---

Surroundings

The grounds around the residence are enclosed by a fence. Across the front of the property an open-work brick wall, with a concrete top rail, is punctuated by brick posts with pyramidal concrete caps. A picket gate opens onto a concrete walk leading up to the house. A picket double-gate opens to a driveway leading to the porte cochere. The side and rear portions of the fence are picket, with the same intersecting brick posts. A pecan grove, planted in 1922, is to the south of the house and is a contributing property.

Condition/Alterations

The main residence is in good condition and has undergone relatively few alterations. Known alterations include:

- 1) removal of shutters, c. 1930
- 2) partial screening of first floor porch, south facade, c. 1930
- 3) small rear addition (1968) located between c. 1896 house and c. 1905 main house.

The tenant house is vacant, overgrown with vegetation, and appears to be in a state of deterioration, though according to owner it is structurally sound. The other structures are basically unaltered and in good condition.

A noncontributing modern wooden shed is located to the north of the stable/garage and within the nominated acreage.



United States Department of the Interior  
National Park Service

National Register of Historic Places  
Continuation Sheet

Section number 8 Page 2

---

merchant, he served as a trustee of the Heineman School District, a director of the Farmers Bank of Greeleyville, a member of the tax equalization board for Laws Township, depot agent, and postmaster for Heineman; the post office was in a rear room in his store.(6) Clarkson also served in the South Carolina House of Representatives from 1932 to 1934.(7)

The complex has remained in the same family since it was established. In addition, it was the lifelong home of Miss Emily Clarkson, a locally significant educator.

Commerce: The Clarkson Store, built ca. 1896, is representative of a disappearing resource, and is significant as one of few surviving rural commercial buildings of its period in the Pee Dee region. The store, originally located on the east side of the Murray's Ferry Road directly north of the house, was moved across the highway in 1928 when the road was paved.(8) The store's new position faced the main house, within view of the front porch; it was also enlarged and the brick porch pillars were added. It housed a business office and the Heineman post office as well as the store, which operated until c. 1962.(9)

Architecture: The main house is an excellent example of an early twentieth century expansion and elaboration of the I-house, a vernacular form common to South Carolina. Basic elements of this form are present (side-facing gable roof, central hallway, two stories, two-room plan), but the plan has been expanded. In addition, decorative elements typical of the late nineteenth and early twentieth centuries have been incorporated in a two-story porch which is featured on all elevations of the house. The result is a larger and more sophisticated version of this traditional vernacular form.

United States Department of the Interior  
National Park Service

National Register of Historic Places  
Continuation Sheet

Section number 8 Page 3

---

NOTES

(1) Samuel D. Clarkson, Jr., "The Clarkson Place," unpublished manuscript (1987), National Register files, State Historic Preservation Office, S. C. Department of Archives and History, Columbia, S.C.

(2) Deed Book V, p. 424, Williamsburg County Deeds, County Records on Microfilm, S. C. Department of Archives and History, Columbia, S. C.

(3) Deed Books X, pp. 113 and 195; AA, p. 169; EE, p. 581, Williamsburg County Deeds, County Records on Microfilm, S. C. Department of Archives and History, Columbia, S. C.; Clarkson, "The Clarkson Place," unpublished manuscript.

(4) Interview with Samuel D. Clarkson, Jr., Greeleyville, S. C., 7 June 1987.

(5) Ibid.; Clarkson, "The Clarkson Place," unpublished manuscript.

(6) Ibid.; William Willis Boddie, History of Williamsburg (Columbia, S. C.: The State Company, 1923), pp. 502-503.

(7) Walter B. Edgar, editor, Biographical Directory of the South Carolina House of Representatives, Volume 1, Session Lists, 1692-1973 (Columbia, S. C.: University of South Carolina Press, 1974), p. 542.

(8) Clarkson, "The Clarkson Place," unpublished manuscript.

(9) Interviews with Samuel D. Clarkson, Jr., Greeleyville, S. C., 1987-1988.

United States Department of the Interior  
National Park Service

National Register of Historic Places  
Continuation Sheet

Section number 8 Page 4

---

BIBLIOGRAPHY

Boddie, William Willis. History of Williamsburg. Columbia, S. C.:  
The State Company, 1923.

Clarkson, Samuel D., Jr. "The Clarkson Place." Unpublished manuscript  
(1987). National Register files, State Historic Preservation  
Office, South Carolina Department of Archives and History,  
Columbia, S. C.

\_\_\_\_\_. Greeleyville, S. C. Interviews, June 1987-  
April 1988.

Columbia, S. C. South Carolina Department of Archives and History.  
County Records on Microfilm. Williamsburg County Deeds.

Edgar, Walter B., editor. Biographical Directory of the South Carolina  
House of Representatives, Volume I, Session Lists, 1692-1973.  
Columbia, S. C.: University of South Carolina Press, 1974.

**United States Department of the Interior  
National Park Service**

**National Register of Historic Places  
Continuation Sheet**

PHOTOGRAPHS

Section number \_\_\_\_\_ Page 1

---

The following information is the same for each of the photographs:

Name of property: Clarkson Farm Complex  
Location of property: Williamsburg County, South Carolina  
Photographer: Staff, SC Department of Archives and History  
Location of negative: SC Department of Archives and History

Additional information for each photograph follows:

1. Main House (West or main facade)  
April 1988
2. Main House (View from southwest)  
April 1988
3. Main House (Southwest oblique view)  
April 1988
4. Main House (North facade)  
April 1988
5. Main House (Porch detail)  
April 1988
6. Main House (View through porte cochere)  
April 1988
7. Main House (Porte cochere from porch; north side)  
April 1988
8. Main House (East facade; c. 1896 portico)  
April 1988
9. Main House (Porch, looking north)  
April 1988
10. Main House (Central hall stairway)  
April 1988
11. Main House (Parlor; mantel)  
April 1988

**United States Department of the Interior  
National Park Service**

**National Register of Historic Places  
Continuation Sheet**

PHOTOGRAPHS

Section number \_\_\_\_\_ Page 2

---

12. Main House (Parlor; detail of coved ceiling)  
April 1988
13. Smokehouse (Northwest oblique view)  
April 1988
14. Stable/Garage (View from southwest)  
April 1988
15. Store (View from front porch of main residence)  
April 1988
16. Store (View from northeast)  
April 1988
17. Garage (View from southeast)  
April 1988
18. Pecan Grove (View from northwest)  
April 1988
19. Tenant House (View from southeast)  
April 1988
20. Main House (Historic Photo, c. 1915)

CLARKSON FARM COMPLEX  
WILLIAMSBURG COUNTY, S. C.  
NOT TO SCALE

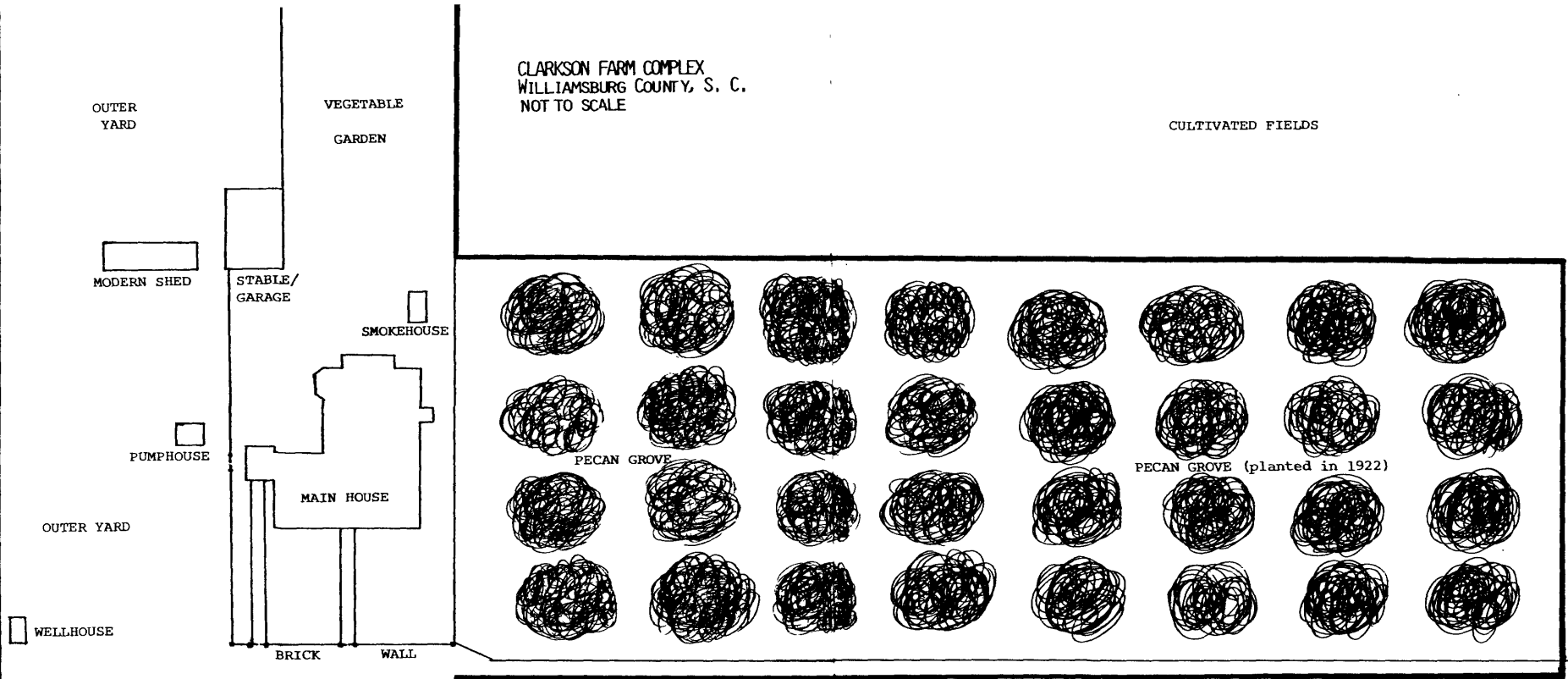

U. S. HIGHWAY 52

U. S. HIGHWAY 52

TO CHARLESTON →

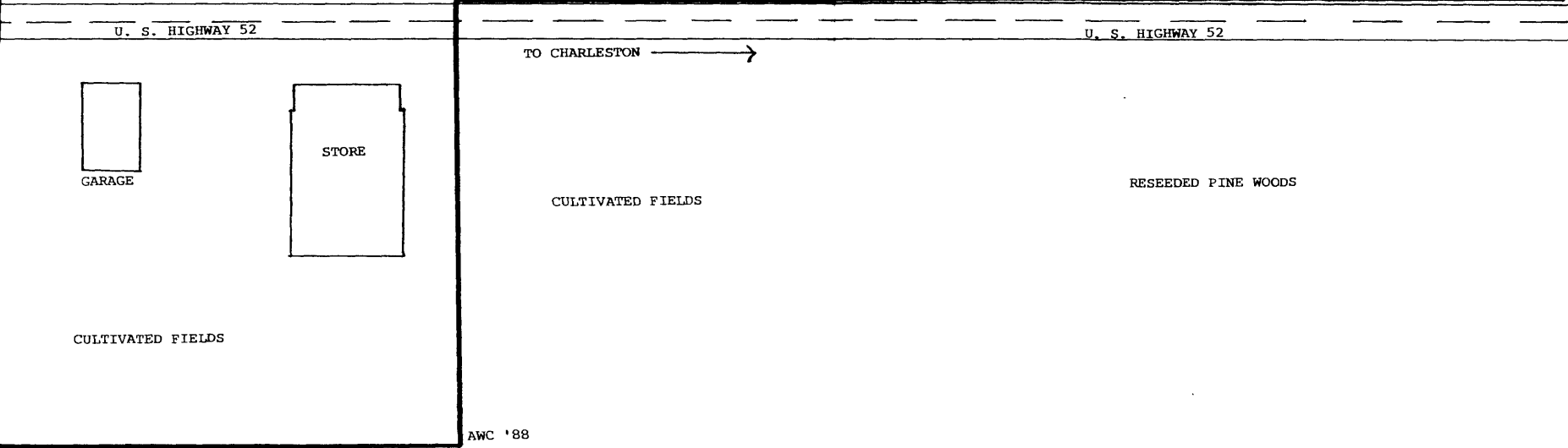

AWC '88

CLARKSON FARM COMPLEX  
WILLIAMSBURG COUNTY, S. C.  
NOT TO SCALE

CULTIVATED

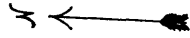

CULTIVATED FIELDS

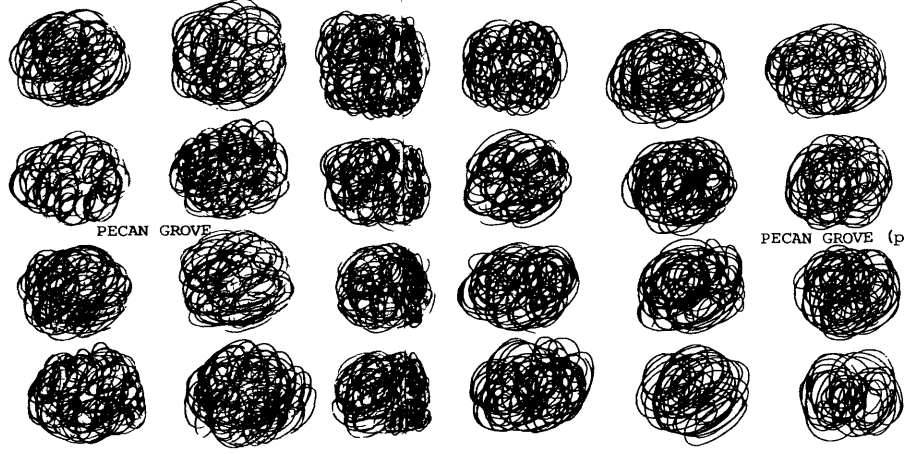
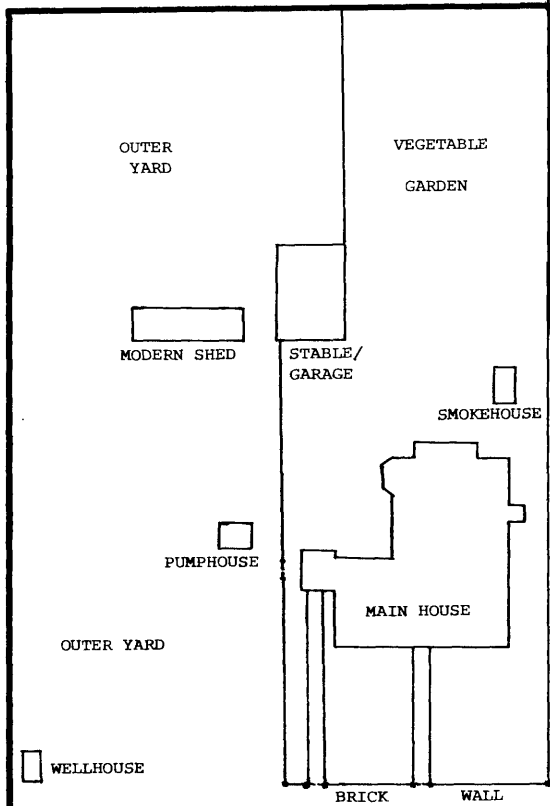

← TO KINGSTREE

U. S. HIGHWAY 52

U. S. HIGHWAY 52

TO CHARLESTON →

CULTIVATED FIELDS

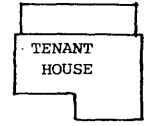
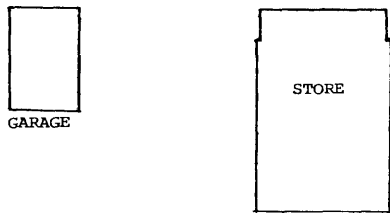

CULTIVATED FIELDS

CULTIVATED FIELDS

RESEEDED PINE W

United States Department of the Interior  
National Park Service

National Register of Historic Places  
Continuation Sheet

Section number \_\_\_\_\_ Page \_\_\_\_\_

SUPPLEMENTARY LISTING RECORD

NRIS Reference Number: 88001706  
Clarkson Farm Complex  
Property Name

Date Listed: 10/6/88  
Williamsburg SC  
County State

N/A  
Multiple Name

-----  
This property is listed in the National Register of Historic Places in accordance with the attached nomination documentation subject to the following exceptions, exclusions, or amendments, notwithstanding the National Park Service certification included in the nomination documentation.

*Amy Schladt*  
Signature of the Keeper

10/6/88  
Date of Action

=====  
Amended Items in Nomination:

The area of significance should be checked as "local."

Discussed and concurred in by South Carolina SHPO on October 5, 1988.

DISTRIBUTION:  
National Register property file  
Nominating Authority (without nomination attachment)