

80002173

**United States Department of the Interior
Heritage Conservation and Recreation Service**

**National Register of Historic Places
Inventory—Nomination Form**

For HCRS use only
received JAN 29 1980
date entered APR 17 1980

See instructions in *How to Complete National Register Forms*
Type all entries—complete applicable sections

1. Name

historic St. Mary's Church of the Purification - Church Complex

and/or common

2. Location

street & number County Highway 15 ___ not for publication

(Marystown) Shakopee

city, town Louisville Township vicinity of Second congressional district

state Minnesota code 22 county Scott code 139

3. Classification

Category	Ownership	Status	Present Use	
<input type="checkbox"/> district	<input type="checkbox"/> public	<input checked="" type="checkbox"/> occupied	<input type="checkbox"/> agriculture	<input type="checkbox"/> museum
<input checked="" type="checkbox"/> building(s)	<input checked="" type="checkbox"/> private	<input type="checkbox"/> unoccupied	<input type="checkbox"/> commercial	<input type="checkbox"/> park
<input type="checkbox"/> structure	<input type="checkbox"/> both	<input type="checkbox"/> work in progress	<input type="checkbox"/> educational	<input checked="" type="checkbox"/> private residence
<input type="checkbox"/> site	Public Acquisition	Accessible	<input type="checkbox"/> entertainment	<input checked="" type="checkbox"/> religious
<input type="checkbox"/> object	<input type="checkbox"/> in process	<input checked="" type="checkbox"/> yes: restricted	<input type="checkbox"/> government	<input type="checkbox"/> scientific
	<input type="checkbox"/> being considered	<input type="checkbox"/> yes: unrestricted	<input type="checkbox"/> industrial	<input type="checkbox"/> transportation
		<input type="checkbox"/> no	<input type="checkbox"/> military	<input checked="" type="checkbox"/> other: <u>community center</u>

4. Owner of Property

name Church of St. Mary's

street & number Marystown Route 2

city, town Shakopee ___ vicinity of state Minnesota 55379

5. Location of Legal Description

courthouse, registry of deeds, etc. Recorder's Office, Scott County Courthouse

street & number 428 South Holmes

city, town Shakopee state Minnesota 55379

6. Representation in Existing Surveys

title Statewide Survey of Historic Resources has this property been determined eligible? ___ yes ___ no

date 1979 ___ federal state ___ county ___ local

depository for survey records Minnesota Historical Society -- 240 Summit Avenue-Hill House

city, town St. Paul state Minnesota 55102

7. Description

Condition

excellent

good

fair

deteriorated

ruins

unexposed

Check one

unaltered

altered

Check one

original site

moved date _____

Describe the present and original (if known) physical appearance

The church complex of St. Mary's of the Purification is located in the small unincorporated village of Marystown, four miles south of Shakopee in Louisville Township. The surrounding area is primarily agricultural. The complex of four church-related buildings (church, school, rectory, and convent) makes up a large part of the settlement.

St. Mary's Church was built in 1882 to replace earlier stone and log churches. It is of rubblestone construction and designed in the Romanesque mode. The building is a hall-type parish church designed on the Latin cross plan. It has an intersecting gable roof and rudimentary transepts. A spire and cross cap the roof of the entrance tower. The hooded round windows, pointed spire, and distinctive rubblestone construction are the building's most striking design features. The interior of the church was destroyed by fire in 1917 and remodeled at that time.

St. Mary's School is located just south of the church and was constructed in 1893, replacing an earlier frame school building. The two story red brick building is set on a limestone foundation. It is three bays across and four bays deep and has a hip roof with a slightly projecting central pavilion. Contrasting yellow brick arches decorate window and door openings. Double windows flank the central pavilion on both floors. All windows are double hung with four over four lights. A small arched window is centered in the gable. The central doorway has been partially bricked over and turned into a window. One second floor window on the south side has been enlarged to a doorway, and an exterior stairway has been added. A two story red brick section was added on the north side of the building in 1935 and now houses the entrance and stairwell.

The church rectory, located north of the church, is a two story red brick residence constructed in 1910. It has a square plan with a hip roof and dormer facing the street. The five bay house has a central hall and full front porch supported by columns. Large five-part windows flank the doorway. A bay window is located on the south side of the building on the first floor. A frame garage has been added to the rear of the building.

The two story frame Sisters' Convent was constructed in 1921 and is situated back from the road, west and south of the other buildings. The large building is sheathed with narrow siding that has been painted white. It has a hip roof with exaggerated gables on each facade. The building is designed on a square plan. It is five bays across and has simple decoration. The front porch is original, but was enclosed in recent years.

Lesser buildings located on the property include a frame garage northeast of the convent, a small frame pumphouse southwest of the rectory, a heating plant west of the school, and a small brick building southwest of the church. The church cemetery is behind the church.

All of the buildings are well maintained and in use. The church and rectory continue their original functions. The school is now used as a meeting place and community center. The convent is leased as a residence.

8. Significance

Period	Areas of Significance—Check and justify below			
<input type="checkbox"/> prehistoric	<input type="checkbox"/> archeology-prehistoric	<input type="checkbox"/> community planning	<input type="checkbox"/> landscape architecture	<input checked="" type="checkbox"/> religion
<input type="checkbox"/> 1400-1499	<input type="checkbox"/> archeology-historic	<input type="checkbox"/> conservation	<input type="checkbox"/> law	<input type="checkbox"/> science
<input type="checkbox"/> 1500-1599	<input type="checkbox"/> agriculture	<input type="checkbox"/> economics	<input type="checkbox"/> literature	<input type="checkbox"/> sculpture
<input type="checkbox"/> 1600-1699	<input checked="" type="checkbox"/> architecture	<input checked="" type="checkbox"/> education	<input type="checkbox"/> military	<input type="checkbox"/> social/ humanitarian
<input type="checkbox"/> 1700-1799	<input type="checkbox"/> art	<input type="checkbox"/> engineering	<input type="checkbox"/> music	<input type="checkbox"/> theater
<input checked="" type="checkbox"/> 1800-1899	<input type="checkbox"/> commerce	<input checked="" type="checkbox"/> exploration/settlement	<input type="checkbox"/> philosophy	<input type="checkbox"/> transportation
<input checked="" type="checkbox"/> 1900-	<input type="checkbox"/> communications	<input type="checkbox"/> industry	<input type="checkbox"/> politics/government	<input type="checkbox"/> other (specify)
		<input type="checkbox"/> invention		

Specific dates

Builder/Architect

Statement of Significance (in one paragraph)

The church complex of St. Mary's of the Purification is significant as a well-preserved complex of church-related buildings associated with the German population that settled the north, central, and western regions of rural Scott County. St. Mary's was organized in 1855 as the first parish in Scott County. The town was laid out and named for the church shortly thereafter in a pattern that was repeated in all regions of the county during the subsequent ten years. Small Catholic settlements such as St. Mary's were the primary centers serving surrounding rural communities. These small hamlets and the rural areas surrounding them are the most ethnically homogeneous parts of Scott County. The four buildings comprising the St. Mary's complex were constructed at intervals during the late nineteenth and early twentieth centuries as the community grew and needs changed. Marystown remains a thriving, closely knit, viable, German community, with approximately one hundred families in the parish today. As a center continuously uniting and serving the residents of Marystown and the surrounding area and as a representative of the Catholic hamlet type of settlement in the county, the St. Mary's complex is worthy of preservation.

9. Major Bibliographical References

- Klein, James, History of St. Mary's of the Purification, Marystown, Scott County, Minnesota, Diamond Jubilee pamphlet, June 12, 1930.
- Neill, Edward D., History of the Minnesota Valley, Minneapolis: North Star Publishing Co., 1882.

10. Geographical Data **UTM NOT VERIFIED**

Acreeage of nominated property 3.73 **ACREAGE NOT VERIFIED**
Quadrangle name New Prague Quadrangle scale 15

UMT References

A	<u>1</u> <u>5</u>	<u>4</u> <u>5</u> <u>7</u> <u>1</u> <u>5</u> <u>0</u>	<u>4</u> <u>9</u> <u>5</u> <u>1</u> <u>7</u> <u>7</u> <u>5</u>	B			
	Zone	Easting	Northing		Zone	Easting	Northing
C				D			
E				F			
G				H			

Verbal boundary description and justification

Begin at a point 500 feet north of the southeast corner of Sec. 35, T115N, R23W; commence north 500 feet, thence west 325 feet, thence south 500 feet, thence east 355 feet to point of beginning.

List all states and counties for properties overlapping state or county boundaries

state	code	county	code
state	code	county	code

11. Form Prepared By

name/title Britta Bloomberg, Research Historian-Survey

organization Minnesota Historical Society-SHPO date July 1979

street & number 240 Summit Avenue-Hill House telephone (612) 296-0101

city or town St. Paul state Minnesota 55102

12. State Historic Preservation Officer Certification

The evaluated significance of this property within the state is:

national state local

As the designated State Historic Preservation Officer for the National Historic Preservation Act of 1966 (Public Law 89-665), I hereby nominate this property for inclusion in the National Register and certify that it has been evaluated according to the criteria and procedures set forth by the Heritage Conservation and Recreation Service.

State Historic Preservation Officer signature

Russell W. Fridley

title State Historic Preservation Officer

date 1-9-80

For HCPS use only

I hereby certify that this property is included in the National Register

date

Keeper of the National Register

Attest:

date

Chief of Registration

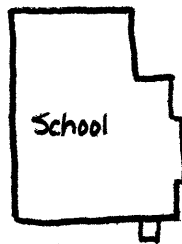
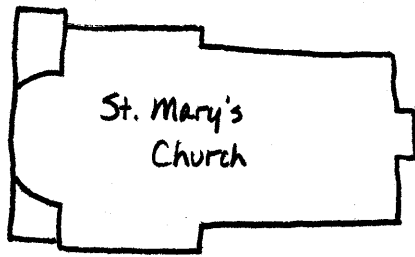
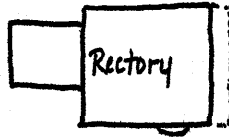

Cemetery

County Road

(15)



St. Mary's of the Purification,
Church Complex