

OCT 03 1988

MISSISSIPPI HISTORIC BRIDGE SURVEY

1. Name of Bridge: Owens Creek Bridge

2. Location

Code 021County Claiborne USGS Quadrangle UticaTown/vicinity Utica vicinity

UTM coordinates:

Zone 15 Easting 714300 Northing 3552625Acreage less than one Owner Claiborne County

Verbal boundary description:

Includes the 20.2 by 76.2 ft. bridge spanning Owens Creek
on the old county road crossing (adjacent to the present
crossing) in Section 20, Township 13 North, Range 5 West

3. Description

Number of spans 1 Length overall 76.2 ft. (23.2 m)

Span types:

(1) Warren pony truss length 76.2 ft. (23.2 m)(2) length (3) length

Truss span components:

Top chords 2 channel beams and 1 plateEnd posts 2 channel beams and 1 plateBottom chords 2 angle barsHip verticals Intermediate posts 2 angle barsDiagonals 2 angle barsCounters Connections rivetsPiers creosote-treated wooden postsCondition fairDate of construction 1917Builder unknownSource State Highway Department Bridge Inventory

4. Location of Legal Description

Courthouse, Office of the Chancery Clerk

Registry of Deeds, etc.: Claiborne County CourthouseStreet & Number: Main StreetCity, Town: Port Gibson State: Mississippi

Profile Sketch

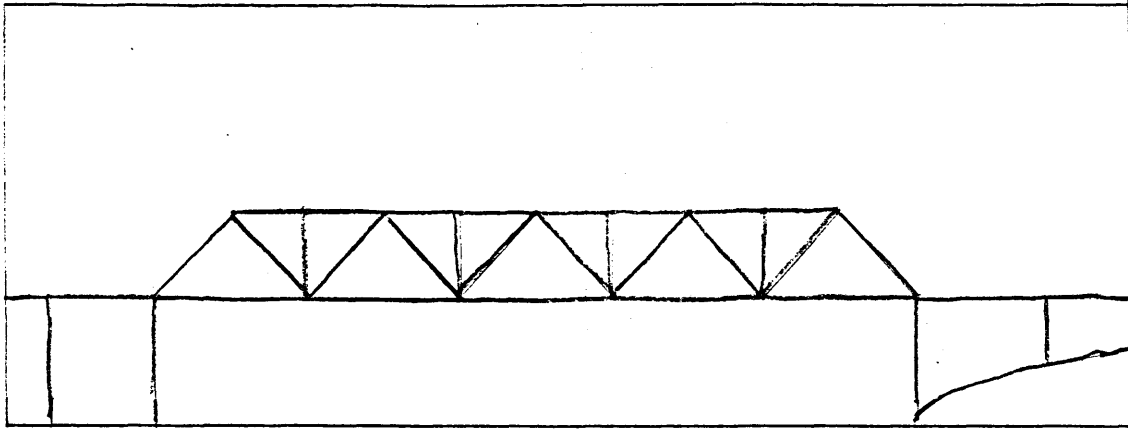

5. Significance

Level of significance:

Local ____; State x; National ____

Statement of significance:

This bridge consists of one Warren pony truss span, which was a commonly used truss type in early 20th century Mississippi. This particular bridge is significant in that it is representative of this type of truss, that is to say that it embodies "the distinctive characteristics of a type, period or method of construction." It was preserved by a 1983 agreement with the Claiborne County Board of Supervisors.

6. Form prepared by:

Jack D. Elliott, Jr.
Historical Archaeologist
Division of Historic Preservation
Mississippi Department of Archives and History
P.O. Box 571
Jackson, Mississippi 39205