

**United States Department of the Interior
National Park Service**

**National Register of Historic Places
Inventory—Nomination Form**

For NPS use only
received **JUL 17 1987**
date entered **AUG 26 1987**

See instructions in *How to Complete National Register Forms*
Type all entries—complete applicable sections

1. Name

historic Mangels, William F., Four-Row Carousel - Oregon Historic Wooden Carousels TR
and/or common Forestry Center Carousel
Number of contributing resources: 5 of 6
Number of non-contributing resources: 0

2. Location

street & number 4033 SW Canyon Road N/A not for publication
city, town Portland N/A vicinity of First Congressional District
state Oregon code 41 county Multnomah code 051

3. Classification

Category	Ownership	Status	Present Use
<input type="checkbox"/> district	<input type="checkbox"/> public	<input checked="" type="checkbox"/> occupied	<input type="checkbox"/> agriculture <input type="checkbox"/> museum
<input type="checkbox"/> building(s)	<input checked="" type="checkbox"/> private	<input type="checkbox"/> unoccupied	<input type="checkbox"/> commercial <input type="checkbox"/> park
<input type="checkbox"/> structure	<input type="checkbox"/> both	<input type="checkbox"/> work in progress	<input type="checkbox"/> educational <input type="checkbox"/> private residence
<input type="checkbox"/> site	Public Acquisition	Accessible	<input checked="" type="checkbox"/> entertainment <input type="checkbox"/> religious
<input checked="" type="checkbox"/> object	<u>N/A</u> in process	<input type="checkbox"/> yes: restricted	<input type="checkbox"/> government <input type="checkbox"/> scientific
	<u>N/A</u> being considered	<input checked="" type="checkbox"/> yes: unrestricted	<input type="checkbox"/> industrial <input type="checkbox"/> transportation
		<input type="checkbox"/> no	<input type="checkbox"/> military <input type="checkbox"/> other:

4. Owner of Property

name Duane and Carol Perron (owners of carousel only) (Continued)
street & number 6693 SE Scott Drive
city, town Portland N/A vicinity of state Oregon 97215

5. Location of Legal Description

courthouse, registry of deeds, etc. City of Portland Building Permits Department
street & number 1120 SW 5th Avenue
city, town Portland state Oregon 97205

6. Representation in Existing Surveys

title Statewide Inventory of Historic Properties has this property been determined eligible? yes no
date 1986 federal state county local
depository for survey records State Historic Preservation Office, 525 Trade Street SE
city, town Salem state Oregon 97310

7. Description

Condition		Check one	Check one
<input checked="" type="checkbox"/> excellent	<input type="checkbox"/> deteriorated	<input checked="" type="checkbox"/> unaltered	<input type="checkbox"/> original site
<input type="checkbox"/> good	<input type="checkbox"/> ruins	<input type="checkbox"/> altered	<input checked="" type="checkbox"/> moved
<input type="checkbox"/> fair	<input type="checkbox"/> unexposed		date <u>1975, 1978</u>

Describe the present and original (if known) physical appearance

The four-row carousel by the William F. Mangels Company Carousel Works, manufactured about 1914, has 16 lighted sweeps which can hold 42 horses mounted on brass poles. The wooden platform has a diameter of 45 feet, and the center pole reaches a height of 18 feet. The wooden horses on the carousel were created by the company's leading carvers, Marcus Charles Illions and Charles Carmel. They are embellished with glass eyes and jeweled trappings. The array combines standers and jumpers. Also on the platform are two single-seat chariots, the sides of which are superbly modeled as mythical gryphons,

The machine is crested with 16 wooden rounding boards, some of which have painted scenes, and 16 mirrored shields. Beveled mirrors and lights also decorate the panels which are hung around the hub of the machine.

The carousel is powered by an electric motor that converts power via V-belts to a large flywheel. The manual friction clutch transfers the power to a bevel and pinion gear that turns a shaft which in turn moves a sprocket to rotate the machine. All gears and mechanical parts are original to the carousel. The engine generates a rotation speed of approximately 6mph.¹

Because it is operated as an outdoor machine, the mechanism is covered with a canvas canopy. The original finish of the rounding boards was badly worn. Present treatment, including Oregon landscape scenes, is a result of Perrons' restoration in 1978.

¹ Statement of Duane Perron, owner, November 7, 1986.

8. Significance

Period	Areas of Significance—Check and justify below			
<input type="checkbox"/> prehistoric	<input type="checkbox"/> archeology-prehistoric	<input type="checkbox"/> community planning	<input type="checkbox"/> landscape architecture	<input type="checkbox"/> religion
<input type="checkbox"/> 1400–1499	<input type="checkbox"/> archeology-historic	<input type="checkbox"/> conservation	<input type="checkbox"/> law	<input type="checkbox"/> science
<input type="checkbox"/> 1500–1599	<input type="checkbox"/> agriculture	<input type="checkbox"/> economics	<input type="checkbox"/> literature	<input type="checkbox"/> sculpture
<input type="checkbox"/> 1600–1699	<input type="checkbox"/> architecture	<input type="checkbox"/> education	<input type="checkbox"/> military	<input type="checkbox"/> social/
<input type="checkbox"/> 1700–1799	<input checked="" type="checkbox"/> art	<input type="checkbox"/> engineering	<input type="checkbox"/> music	<input type="checkbox"/> humanitarian
<input type="checkbox"/> 1800–1899	<input type="checkbox"/> commerce	<input type="checkbox"/> exploration/settlement	<input type="checkbox"/> philosophy	<input type="checkbox"/> theater
<input checked="" type="checkbox"/> 1900–	<input type="checkbox"/> communications	<input type="checkbox"/> industry	<input type="checkbox"/> politics/government	<input type="checkbox"/> transportation
		<input type="checkbox"/> invention		<input checked="" type="checkbox"/> other (specify) recreation

Specific dates c. 1914 **Builder/Architect** William F. Mangels Company Carousel Works

Statement of Significance (in one paragraph)

The Oregon Historic Wooden Carousels Theme Resource nomination is comprised of five hand-crafted carousels of American manufacture presently operating in the state of Oregon. The nominated carousels range in date from 1904 to 1926, a period which spans much of the last half of the golden age of carousels (1875-1935) and the heyday of amusement parks. The common characteristics of carousels in the group are wooden platforms, wooden rounding boards, hand-carved animals, and a counter clockwise rotation pattern. Each is now electrically powered, using friction clutch or hydraulic clutch mechanical systems. Collectively and individually, the machines meet National Register Criterion C as well-preserved examples of a recreational genre illustrative of the development of animal carving as a "functional" art form wherein the carvers competed to create the most novel and colorful attractions.

A mid-sized machine measuring 45 feet in diameter, the William F. Mangels four-row carousel is a rare example of its class. Mangels' carousel works produced a large number of the 24 lavishly decorated carousels operating at New York's popular Coney Island Amusement Park during the park's heyday. A leading entrepreneur of the outdoor amusement industry, Mangels was the inventor of thrill rides, such as the Whip and the Tickler. From the turn-of-the-century onward, his master carver was Russian-born Marcus Charles Illions, whose work, outstanding for its design and execution, may be seen in the carousel's array of horses in dramatic poses, feathery, wind-swept manes and elaborate trappings. It is believed the hand of carver Charles Carmel may be distinguished in the work also.

The mechanism of Mangels' 16-sweep machine is noteworthy. Mangels was an accomplished inventor and mechanic. In 1907, he patented an improved galloping-horse action machine of which this carousel is an example. Mangels produced a strongly built mechanism, and earned himself an excellent reputation as a carousel maker. Another reason for Mangels' success was that he used the carving services of two of the best known and admired carvers; Charles Carmel and Marcus Illions.

Marcus Charles Illions had been apprenticed to Charles I. D. Loeff. In 1902, Illions became involved with supplying carousel horses for William F. Mangels, and continued to do so even after starting his own carousel company. Illions is considered to be one of the most flamboyant and talented of the carousel carvers. He is noted for exquisitely carved manes, and for the wildness in the expression of his horses' faces. It is said that his horses "not only embody the sensitivity that was a permanent characteristic of his work, but display fantasies of frozen movement that transcend craftsmanship to create original works of art." (Weedon and Ward, Fairground Art.)

9. Major Bibliographical References

- Dinger, Charlotte, Art of the Carousel (Green Village, New Jersey: Carousel Art, Inc., 1983), 14, 125-126, 175.
Fried, Frederick, A Pictorial Historic of the Carousel (Vestal Press, New York, 1964).
Weedon, Geoff and Ward, Richard, Fairground Art (Abbeville Press, Inc., New York, 1985).

10. Geographical Data

Acreeage of nominated property less than one

Quadrangle name Portland, Oregon-Washington

Quadrangle scale 1:52500

UTM References

A

1	0	5	2	2	6	7	5	5	0	3	9	2	2	5
Zone			Easting					Northing						

B

Zone			Easting					Northing						

C

Zone			Easting					Northing						

D

Zone			Easting					Northing						

E

Zone			Easting					Northing						

F

Zone			Easting					Northing						

G

Zone			Easting					Northing						

H

Zone			Easting					Northing						

Verbal boundary description and justification

See continuation sheet

List all states and counties for properties overlapping state or county boundaries

state N/A code county code

state N/A code county code

11. Form Prepared By

name/title Jean Skinner

organization Portland Carousel Museum

date December 12, 1986

street & number 25 SW Salmon Street

telephone (503) 241-2560

city or town Portland

state Oregon 97204

12. State Historic Preservation Officer Certification

The evaluated significance of this property within the state is:

national state local

As the designated State Historic Preservation Officer for the National Historic Preservation Act of 1966 (Public Law 89-665), I hereby nominate this property for inclusion in the National Register and certify that it has been evaluated according to the criteria and procedures set forth by the National Park Service.

State Historic Preservation Officer signature

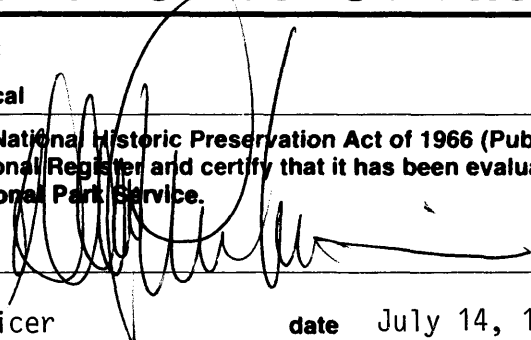

title Deputy State Historic Preservation Officer

date July 14, 1987

For NPS use only

I hereby certify that this property is included in the National Register

date

Keeper of the National Register

Attest:

date

Chief of Registration

**United States Department of the Interior
National Park Service**

**National Register of Historic Places
Continuation Sheet**

Section number 8 Page 2

Charles Carmel spent most of his working career associated with the William F. Mangels Company. The quality of his work was considered to be consistently high. Carmel horses were well-proportioned, their manes carved in a windswept style, and they followed accepted poses of the day. An extensive use of glass jewels also became a distinctive feature of Carmel's work. It is known that Carmel and Illions worked in association on several of Mangels carousels, and their work was coordinated through standardization of such accessories as feathers, jewels, and a checker-board design on the saddle blankets.

The carousel originally was installed at Emerson Park in Auburn, New York during 1914. After years of storage, Harry and Carol Koch purchased the machine and placed it in service. In 1978, the carousel was purchased again and brought to Portland, Oregon. The carousel has been operating at the World Forestry Center in Washington Park for the past eight years.

United States Department of the Interior
National Park Service

National Register of Historic Places Continuation Sheet

Section number 10 Page 1

The nominated property is approximately 4,534 square feet, to include the carousel and the circular concrete pad on which it is mounted and the grassy area surrounding it which is enclosed by a six-foot high cyclone fence.

The area may be located as follows:

Commencing at the center of Section 5, Township 1S, Range 1E, Willamette Meridian, in Portland, Multnomah County, Oregon, thence North $89^{\circ} 53' 25''$ West along the East-West half section line of said Section 5, 1698.21' to a point on the City of Portland, Oregon's westerly boundary; thence South $0^{\circ} 03' 15''$ along said westerly boundary, 878.00 feet to a point; thence North $81^{\circ} 43' 45''$ East, 518.00 feet to a point very near the center of the carousel.

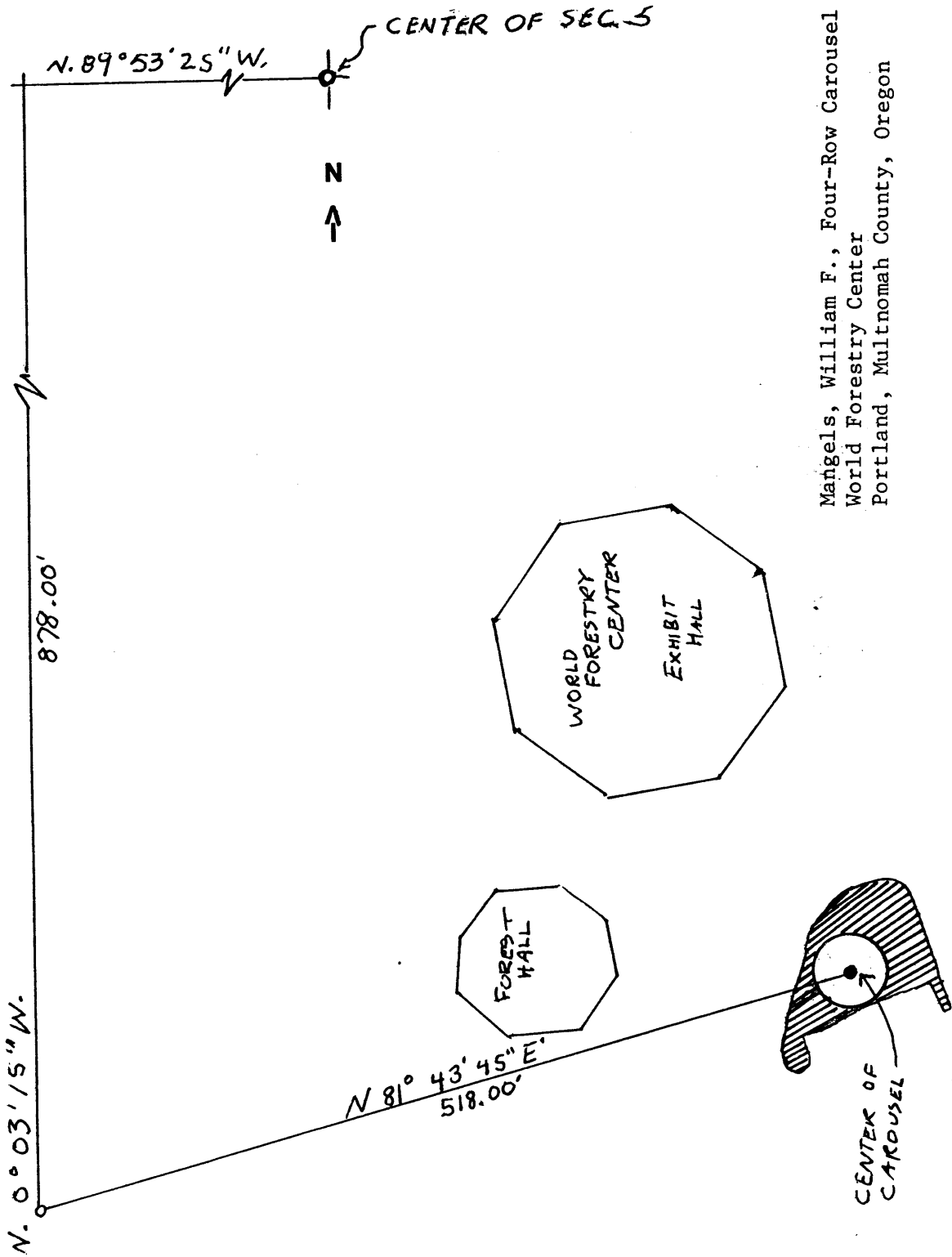

Mangels, William F., Four-Row Carousel
 World Forestry Center
 Portland, Multnomah County, Oregon