

United States Department of the Interior
National Park Service

For NPS use only

National Register of Historic Places
Inventory—Nomination Form

received FEB 10 1986
date entered MAR 13 1986

See instructions in *How to Complete National Register Forms*
Type all entries—complete applicable sections

1. Name

historic First Presbyterian Church

and/or common same

2. Location

street & number 433 Ocoee Street, N.W. N/A not for publication

city, town Cleveland N/A vicinity of

state Tennessee code 047 county Bradley code 011

3. Classification

Category	Ownership	Status	Present Use
<input type="checkbox"/> district	<input type="checkbox"/> public	<input checked="" type="checkbox"/> occupied	<input type="checkbox"/> agriculture
<input checked="" type="checkbox"/> building(s)	<input checked="" type="checkbox"/> private	<input type="checkbox"/> unoccupied	<input type="checkbox"/> commercial
<input type="checkbox"/> structure	<input type="checkbox"/> both	<input type="checkbox"/> work in progress	<input type="checkbox"/> educational
<input type="checkbox"/> site	Public Acquisition	Accessible	<input type="checkbox"/> entertainment
<input type="checkbox"/> object	<input checked="" type="checkbox"/> in process	<input checked="" type="checkbox"/> yes: restricted	<input type="checkbox"/> government
	<input checked="" type="checkbox"/> being considered	<input type="checkbox"/> yes: unrestricted	<input type="checkbox"/> industrial
		<input type="checkbox"/> no	<input type="checkbox"/> military
			<input type="checkbox"/> museum
			<input type="checkbox"/> park
			<input type="checkbox"/> private residence
			<input checked="" type="checkbox"/> religious
			<input type="checkbox"/> scientific
			<input type="checkbox"/> transportation
			<input type="checkbox"/> other:

4. Owner of Property

name Trustees of First Presbyterian Church

street & number 433 Ocoee Street, N.W.

city, town Cleveland N/A vicinity of state Tennessee

5. Location of Legal Description

courthouse, registry of deeds, etc. Bradley County Courthouse

street & number Courthouse Square

city, town Cleveland state Tennessee 37311

6. Representation in Existing Surveys

title Bradley County Survey has this property been determined eligible? yes no

date 1983 - 1984 federal state county local

depository for survey records Tennessee Historical Commission

city, town Nashville state Tennessee

7. Description

Condition		Check one	Check one
<input checked="" type="checkbox"/> excellent	<input type="checkbox"/> deteriorated	<input type="checkbox"/> unaltered	<input checked="" type="checkbox"/> original site
<input type="checkbox"/> good	<input type="checkbox"/> ruins	<input checked="" type="checkbox"/> altered	<input type="checkbox"/> moved date _____
<input type="checkbox"/> fair	<input type="checkbox"/> unexposed		

Describe the present and original (if known) physical appearance

The First Presbyterian Church is located near the downtown area of Cleveland (pop. 26,652) in Bradley County, Tennessee. Constructed in around 1856, the one story red brick church is rectangular in plan with an asphalt shingle gable roof. A focal point of the church is the square, frame belltower. The tower is surmounted by a belfry with windows and a copper steeple with finials. Large stained glass windows, a molded brick cornice and a distyle in antis portico comprise the major design elements on the exterior. The interior exhibits paneled and molded wood trim. Although stained glass windows were added in around 1919 and a brick addition was built on the west (rear) in 1935, the First Presbyterian Church retains much of its architectural integrity.

The east facade presents a temple form with a recessed portico or distyle in antis. Two square brick columns with capitals and four pilasters accentuate the symmetrically proportioned facade. The entry is flanked by tall stained glass windows surrounded with wood casings and capped by a contiguous lintel board. Iron tie rods with five-pointed stars are situated near the bottom of the windows and below the eaves. Two smaller stained glass windows with paneled aprons and wide lintel boards and two double leaf paneled doors capped by transom lights embellish the portico. The pedimented gable of the facade is distinguished by molded brick raking and horizontal cornices. This treatment is carried over onto the north and south elevations. Part of the rear (west) addition is visible from this view. A large stained glass window, a double leaf entry with a pedimented lintel, and one 1/1 double hung sash window comprise the design elements of the addition.

The north elevation displays five stained glass windows with wide lintel boards and wood casings. At the southwest section of this elevation is a one story shed roof porch that leads into the 1935 addition.

Four stained glass windows, similar to those on the facade and north elevation, characterize the design of the south elevation. A two story (plus basement) gable roof addition projects from the southwest corner. The addition displays two 1/1 double hung sash windows on each floor and two multi-pane windows at the basement level. A brick and concrete porch with a metal balustrade is located at the intersection of the old and new sections.

No original features of the First Presbyterian Church are extant on the west elevation. Only the 1935 addition is visible. Several windows of various sizes are located on this elevation.

The large rectangular stained glass windows compliment the finely crafted woodwork of the interior. A molded wood entablature, fluted pilasters, and paneled wainscoting, altar, and pews embellish the sanctuary of the church. Two paneled doors with architrave molding and scroll pediments flank the chancel area. Several ceiling medallions further enhance the interior of the church. Both the sanctuary and altar are part of the original plan, while the chancel is located in the 1935 addition.

The small flat lot on which the church is located is minimally landscaped. Situated on the southeast portion of the lot is the original 1859 church bell. Removed from the belfry in 1979, it is still used.

8. Significance

Period	Areas of Significance—Check and justify below			
<input type="checkbox"/> prehistoric	<input type="checkbox"/> archeology-prehistoric	<input type="checkbox"/> community planning	<input type="checkbox"/> landscape architecture	<input type="checkbox"/> religion
<input type="checkbox"/> 1400-1499	<input type="checkbox"/> archeology-historic	<input type="checkbox"/> conservation	<input type="checkbox"/> law	<input type="checkbox"/> science
<input type="checkbox"/> 1500-1599	<input type="checkbox"/> agriculture	<input type="checkbox"/> economics	<input type="checkbox"/> literature	<input type="checkbox"/> sculpture
<input type="checkbox"/> 1600-1699	<input checked="" type="checkbox"/> architecture	<input type="checkbox"/> education	<input type="checkbox"/> military	<input type="checkbox"/> social/ humanitarian
<input type="checkbox"/> 1700-1799	<input type="checkbox"/> art	<input type="checkbox"/> engineering	<input type="checkbox"/> music	<input type="checkbox"/> theater
<input checked="" type="checkbox"/> 1800-1899	<input type="checkbox"/> commerce	<input type="checkbox"/> exploration/settlement	<input type="checkbox"/> philosophy	<input type="checkbox"/> transportation
<input type="checkbox"/> 1900-	<input type="checkbox"/> communications	<input type="checkbox"/> industry	<input type="checkbox"/> politics/government	<input type="checkbox"/> other (specify)
		<input type="checkbox"/> invention		

Specific dates ca. 1856 **Builder/Architect** John and James Cowan

Statement of Significance (in one paragraph)

The First Presbyterian Church in Cleveland, Bradley County, Tennessee is being nominated under National Register criterion C for its local architectural significance. Begun in 1856 by local contractors, John and James Cowan, the one story brick church is an interesting interpretation of ecclesiastical Greek Revival architecture. Its well-executed design is evident in the temple type facade and a distyle in antis portico that displays brick columns and pilasters. A pedimented gable with molded cornice trim and a frame belfry enhance the appearance of the church. The interior is characterized by molded and paneled woodwork. The First Presbyterian Church was altered in 1919 and 1935, but still retains much of its architectural integrity.

In 1837 the first two churches in Cleveland were established. Both the Methodists and Presbyterians organized congregations in the town of 400 people and held their first services in the courthouse. On November 11, 1837, the Reverend Ralph E. Tedford and the Reverend L. R. Morrison founded the First Presbyterian Church. Cleveland was beginning to develop as a trading center and in January of 1838 it was named the seat of Bradley County. That same month, the town commissioners were authorized to reserve from public sale lots on which churches could be built. The First Presbyterian Church received lot 86 and proceeded to erect a frame building.

The congregation worshipped in the frame church until around 1856 when it was decided to build a new church. A covenant drawn by church members stated that the congregation should "erect a Presbyterian Church Building more in accordance with the other improvements of the town and in keeping with its progress in population and prosperity than the one now in use." It was signed on February 3, 1855 by various church members who also pledged to help pay for the new building.

On March 3, 1856, a contract was executed between a three man building committee and John and James Cowan. The contract required that all work on the new church be completed within one year. Specifications called for a one story structure with a 60' by 40' plan. Foundations were to be three bricks thick while the church, itself, would be constructed of red brick (two bricks thick) and timber girders. An "ornamental cornice" and a wood shingle roof were required for the new church. Columns around a 8' by 24' recessed entry were to be constructed of fluted stone while two front entries would be 5' by 12', including transom windows. Both the facade and the five bay side elevations were to have triple hung sash windows with 36 lights. Although there were plans for a finished interior and a belfry, these were not required to be built in this contract. Only part of the interior would be completed, including two doors at a rear gallery. The contractors were paid \$3,000.00.

9. Major Bibliographical References

See Continuation Sheet

10. Geographical Data

Acreeage of nominated property less than one acre

Quadrangle name East Cleveland, Tennessee

Quadrangle scale 1:24,000

UTM References

A

1	6	6	9	3	6	8	0	3	8	9	2	9	0	0
Zone	Easting				Northing									

B

Zone	Easting				Northing									

C

Zone	Easting				Northing									

D

Zone	Easting				Northing									

E

Zone	Easting				Northing									

F

Zone	Easting				Northing									

G

Zone	Easting				Northing									

H

Zone	Easting				Northing									

Verbal boundary description and justification

The nominated property is rectangular in shape and less than one acre in size. It is bounded on the east by Ocoee Street, N.W., and on the north, west, and south by adjacent property lines. This includes enough land to protect the historical setting and architectural integrity of the First Presbyterian Church. (see tax map)

List all states and counties for properties overlapping state or county boundaries

state N/A code N/A county N/A code N/A

state N/A code N/A county N/A code N/A

11. Form Prepared By

name/title Fred Heselmeier

organization First Presbyterian Church

date December, 1985

street & number 433 Ocoee Street

telephone (615) 476-5584

city or town Cleveland, Bradley County

state Tennessee

12. State Historic Preservation Officer Certification

The evaluated significance of this property within the state is:

national state local

As the designated State Historic Preservation Officer for the National Historic Preservation Act of 1966 (Public Law 89-665), I hereby nominate this property for inclusion in the National Register and certify that it has been evaluated according to the criteria and procedures set forth by the National Park Service.

Deputy State Historic Preservation Officer signature Herbert L. Hagen

title Executive Director, Tennessee Historical Commission

date 1/31/86

For NPS use only

I hereby certify that this property is included in the National Register

Entered in the National Register

date 3-13-86

for Keeper of the National Register

Attest:

date

Chief of Registration

**United States Department of the Interior
National Park Service**

**National Register of Historic Places
Inventory—Nomination Form**

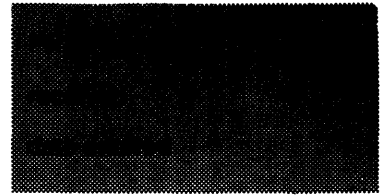

Continuation sheet First Presbyterian Church Item number 8 Page 2

The new First Presbyterian Church was dedicated on October 22, 1858 by the Reverend James N. Bradshaw. An early photograph shows brick columns although most other building specifications were carried out as in the contract. The multipane windows were removed in 1919 and stained glass windows were installed in their place. The original west (rear) is now obscured by a 1935 addition.

The First Presbyterian Church is in excellent condition and continues to be used for religious services. Two other churches in Cleveland have already been listed on the National Register. The 1873 Victorian Gothic St. Luke's Episcopal Church (NR 1982) and the 1893 Victorian Romanesque Broad Street United Methodist Church (NR 1984) represent different eras and designs. These two churches and the First Presbyterian Church provide a good representation of ecclesiastical architecture in Cleveland.

**United States Department of the Interior
National Park Service**

**National Register of Historic Places
Inventory—Nomination Form**

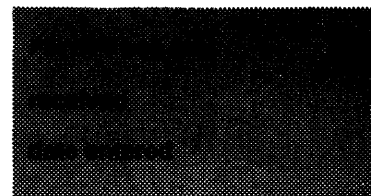

Continuation sheet First Presbyterian Church Item number 9 Page 2

MAJOR BIBLIOGRAPHICAL REFERENCES:

First Presbyterian Church. Cleveland, Tennessee. Building Contract, 3 March 1856 and covenant, 3 February 1855.

Goodspeeds' History of East Tennessee. Nashville: The Goodspeed Publishing Company, 1887, reprint ed., Nashville: Charles and Randy Eller Booksellers, 1972.

Lillard, Roy G. (ed.). The History of Bradley County. Kingsport, Tennessee: The Kingsport Press, 1976.

_____. Bradley County. Memphis: Memphis State University Press, 1980.

Snell, William R. (ed.). Hard Times Remembered. Cleveland, Tennessee: Bradley County Historical Society, 1983.

Wooten, John Morgan. Centennial of the First Presbyterian Church in Cleveland 1837-1937. Cleveland, Tennessee: By the Author, 1937.

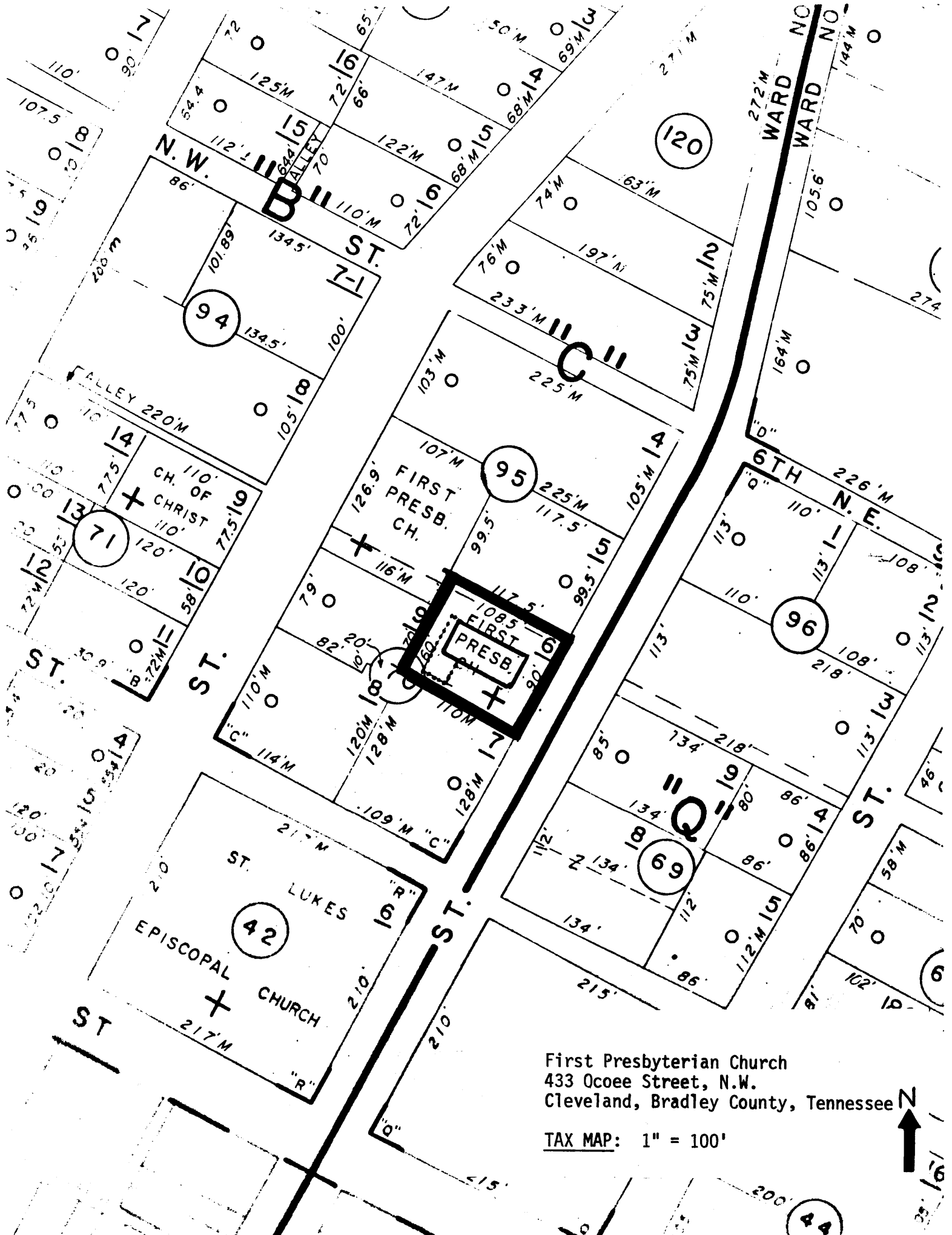

First Presbyterian Church
 433 Ocoee Street, N.W.
 Cleveland, Bradley County, Tennessee

TAX MAP: 1" = 100'

