

**United States Department of the Interior
Heritage Conservation and Recreation Service**

**National Register of Historic Places
Inventory—Nomination Form**

See instructions in *How to Complete National Register Forms*
Type all entries—complete applicable sections



1. Name

historic Nichols House

and/or common Same

2. Location

street & number 2 miles west of Ponchatoula on ^{LA} Hwy. 22 not for publication

city, town Ponchatoula vicinity of congressional district 6th - Henson Moore

state Louisiana code 022 county Tangipahoa code 105

3. Classification

Category	Ownership	Status	Present Use	
<input type="checkbox"/> district	<input type="checkbox"/> public	<input checked="" type="checkbox"/> occupied	<input type="checkbox"/> agriculture	<input type="checkbox"/> museum
<input checked="" type="checkbox"/> building(s)	<input checked="" type="checkbox"/> private	<input type="checkbox"/> unoccupied	<input type="checkbox"/> commercial	<input type="checkbox"/> park
<input type="checkbox"/> structure	<input type="checkbox"/> both	<input type="checkbox"/> work in progress	<input type="checkbox"/> educational	<input checked="" type="checkbox"/> private residence
<input type="checkbox"/> site	Public Acquisition	Accessible	<input type="checkbox"/> entertainment	<input type="checkbox"/> religious
<input type="checkbox"/> object	<input type="checkbox"/> in process	<input checked="" type="checkbox"/> yes: restricted	<input type="checkbox"/> government	<input type="checkbox"/> scientific
	<input type="checkbox"/> being considered	<input type="checkbox"/> yes: unrestricted	<input type="checkbox"/> industrial	<input type="checkbox"/> transportation
		<input type="checkbox"/> no	<input type="checkbox"/> military	<input type="checkbox"/> other:

4. Owner of Property

name Raymond Schaffer
Star Route, Box 26A

street & number

city, town Ponchatoula vicinity of state Louisiana

5. Location of Legal Description

courthouse, registry of deeds, etc. Tangipahoa Parish Courthouse

street & number

city, town Amite state Louisiana

6. Representation in Existing Surveys

title LA Historic Sites Survey has this property been determined eligible? yes no

date 1979 federal state county local

depository for survey records State Historic Preservation Office

city, town Baton Rouge state Louisiana

7. Description

Condition

excellent
 good
 fair

deteriorated
 ruins
 unexposed

Check one

unaltered
 altered

Check one

original site
 moved date _____

Describe the present and original (if known) physical appearance

The Nichols House is located approximately two miles west of the town of Ponchatoula in a flat rural setting. The house is approached by means of an axial alley of live oaks three hundred feet long.

The house itself is an extremely late version of the traditional creole raised plantation house plan. There are four large rooms in the front and two cabinets in the rear with a small gallery between. (This rear gallery has since been enclosed.) The main gallery, which encompasses the front and sides of the house, is 90 feet across the front. It consists of milled Stick Style posts with triple stop chamferring and double foil capitals.

The house has a board and batten exterior, plate glass windows, and handsome brick chimneys. The two large front doorways have been reworked with new doors and lights.

The interior features beaded board on the walls and ceilings. This boarding is angled so as to form a diamond pattern on the dining room ceiling. Other interior features include transom doors and heavy pine Renaissance Revival mantels, with burl wood entablatures, and Fleurs de Lis cut into central wooden keystone motifs.

8. Significance

Period	Areas of Significance—Check and justify below			
<input type="checkbox"/> prehistoric	<input type="checkbox"/> archeology-prehistoric	<input type="checkbox"/> community planning	<input type="checkbox"/> landscape architecture	<input type="checkbox"/> religion
<input type="checkbox"/> 1400–1499	<input type="checkbox"/> archeology-historic	<input type="checkbox"/> conservation	<input type="checkbox"/> law	<input type="checkbox"/> science
<input type="checkbox"/> 1500–1599	<input type="checkbox"/> agriculture	<input type="checkbox"/> economics	<input type="checkbox"/> literature	<input type="checkbox"/> sculpture
<input type="checkbox"/> 1600–1699	<input checked="" type="checkbox"/> architecture	<input type="checkbox"/> education	<input type="checkbox"/> military	<input type="checkbox"/> social/
<input type="checkbox"/> 1700–1799	<input type="checkbox"/> art	<input type="checkbox"/> engineering	<input type="checkbox"/> music	<input type="checkbox"/> humanitarian
<input checked="" type="checkbox"/> 1800–1899	<input type="checkbox"/> commerce	<input type="checkbox"/> exploration/settlement	<input type="checkbox"/> philosophy	<input type="checkbox"/> theater
<input type="checkbox"/> 1900–	<input type="checkbox"/> communications	<input type="checkbox"/> industry	<input type="checkbox"/> politics/government	<input type="checkbox"/> transportation
		<input type="checkbox"/> invention		<input type="checkbox"/> other (specify)

Specific dates	Ca. 1880	Builder/Architect	Edwin Nichols
-----------------------	----------	--------------------------	---------------

Statement of Significance (in one paragraph) Criterion C

The Nichols House is significant in the area of architecture because it is the only example of the traditional creole raised plantation house in the Ponchatoula area. It is also the grandest residential property in the area, being the only one with an oak alley and the only one with such elaborate Stick Style details. In addition its 90-foot front gallery is unequalled in the vicinity.

The home's builder was apparently Edwin Nichols, who purchased the site about 1880 for \$700. Nichols was originally from Chicago. Several years later he sold it to Thomas Murray for \$3500. Since then the property has passed through the hands of numerous owners. The present owners obtained it in 1970.

9. Major Bibliographical References

Tangipahoa Parish Conveyance Records.

10. Geographical Data

UTM NOT VERIFIED

Acreeage of nominated property approx. .7 acres

ACREAGE NOT VERIFIED

Quadrangle name _____ *per 5/29/80 phone call.* Quadrangle scale _____

UMT References

A

1	5	7	4	2	6	4	0	3	3	7	0	1	1	0
Zone			Easting				Northing							

B

Zone			Easting				Northing							

C

Zone			Easting				Northing							

D

Zone			Easting				Northing							

E

Zone			Easting				Northing							

F

Zone			Easting				Northing							

G

Zone			Easting				Northing							

H

Zone			Easting				Northing							

Verbal boundary description and justification

The boundaries encompass the house, alley of live oaks and the adjacent field from which the house is viewed. The nominated property is bounded by a 600' by 500' rectangle. (see attached sketch map.)

List all states and counties for properties overlapping state or county boundaries

state _____ code _____ county _____ code _____

state _____ code _____ county _____ code _____

11. Form Prepared By

name/title Raymond Schaffer

organization _____ date October 1979

street & number Star Route, Box 26A telephone _____

city or town Ponchatoula state Louisiana

12. State Historic Preservation Officer Certification

The evaluated significance of this property within the state is:

national state local

As the designated State Historic Preservation Officer for the National Historic Preservation Act of 1966 (Public Law 89-665), I hereby nominate this property for inclusion in the National Register and certify that it has been evaluated according to the criteria and procedures set forth by the Heritage Conservation and Recreation Service.

State Historic Preservation Officer signature [Signature]

title State Historic Preservation Officer date 3/21/80

For HCRS use only

I hereby certify that this property is included in the National Register

[Signature] date 5/31/80

Keeper of the National Register

Attest: [Signature] date 5/27/80

Chief of Registration

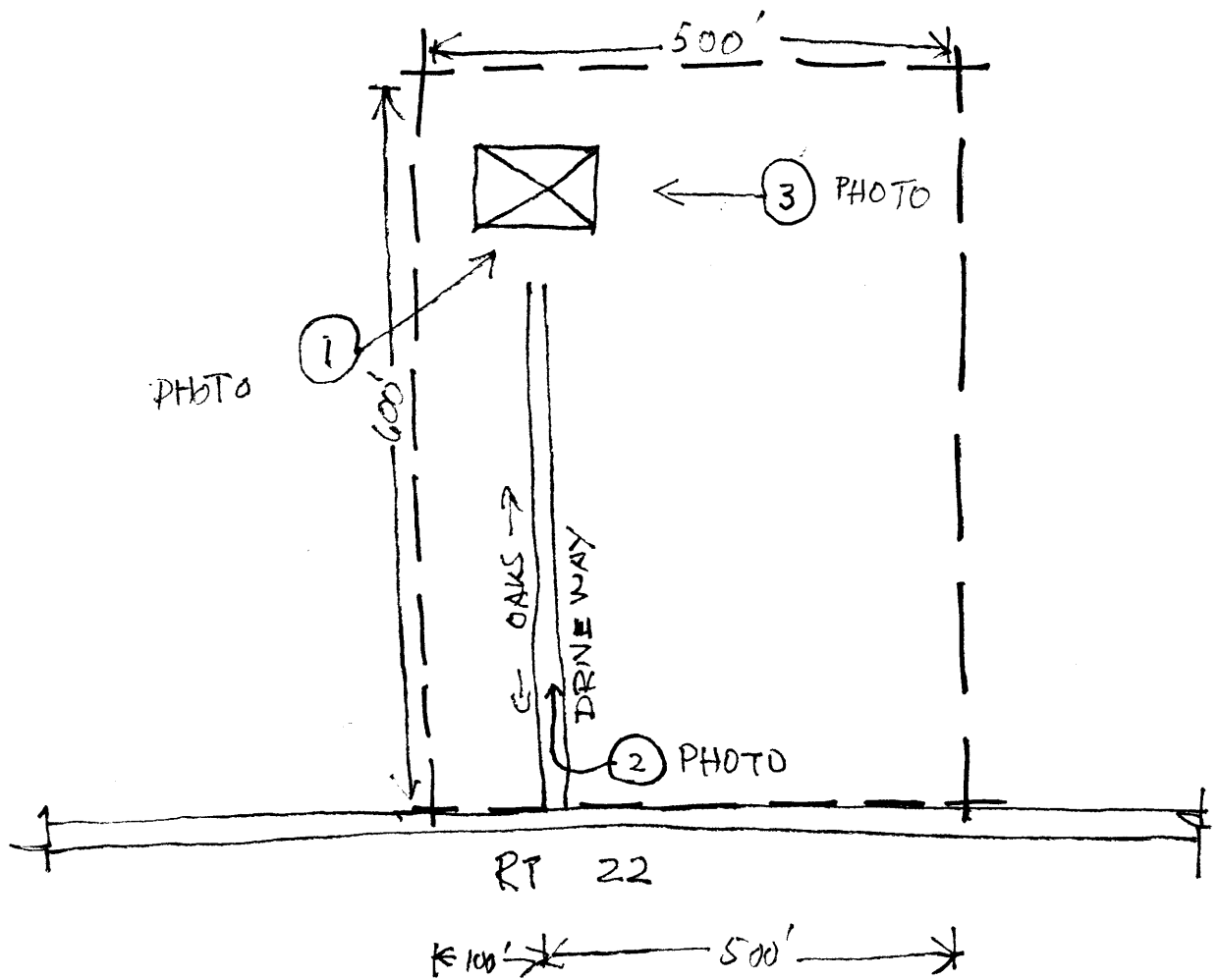

SKETCH MAP

